

# BAJA CALIFORNIA

virtually undiscovered, hiding in plain sight, with endless miles of wild coastline, seas alive with whales, and **tiny pristine islands dotting the coast**. What our expeditions reveal is a southern reflection of the **wilderness** found in Alaska's Inside Passage—North America at its wildest. And it is largely unknown: **a place Sven Lindblad found on a nautical map and sailed into nearly 40 years ago**. We're still one of the few to explore the Sea of Cortez and the only expedition company entering Magdalena Bay. Our guests discover a region still pristine, still beautiful. | **2021 Expedition Season**

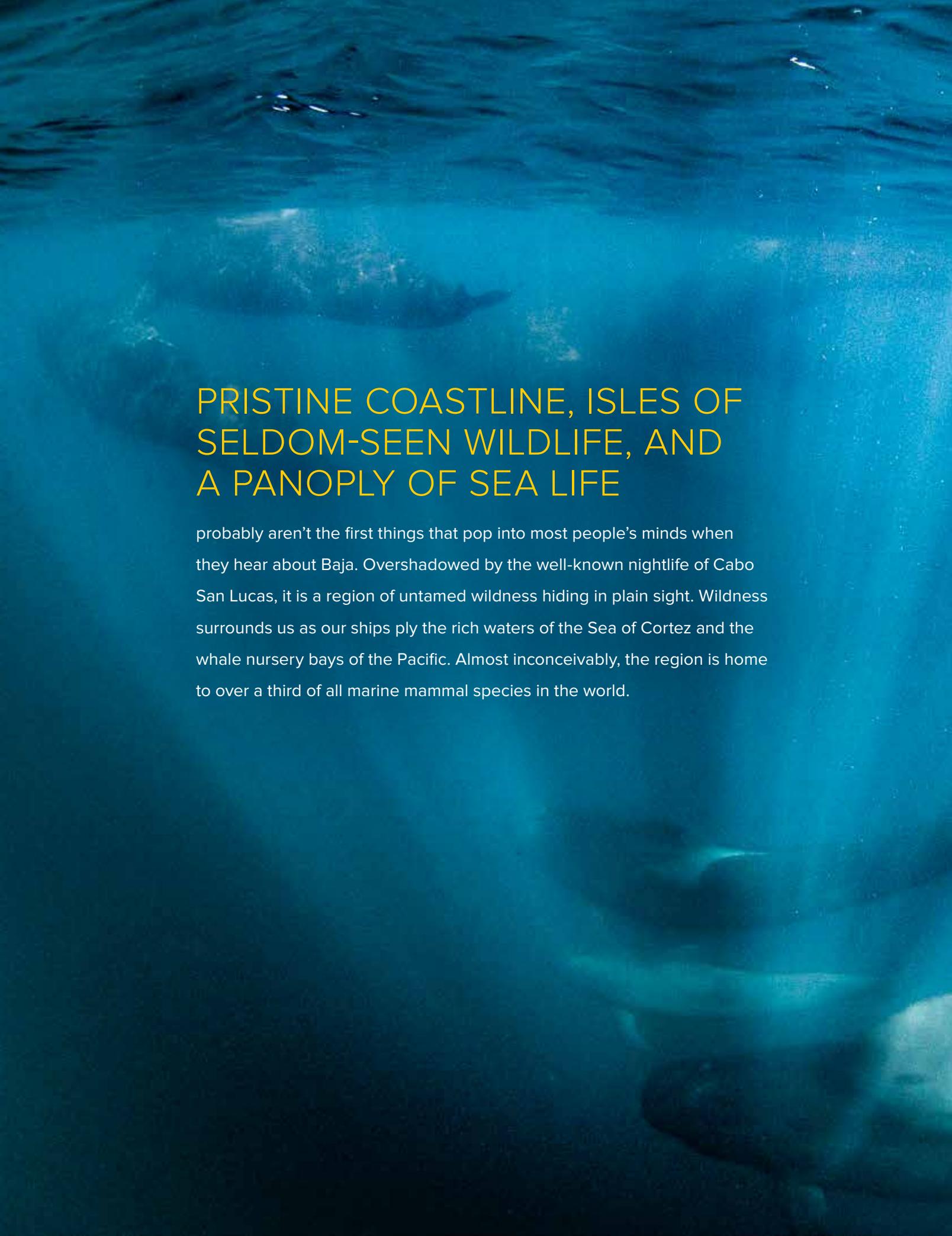

An underwater photograph showing a whale breaching the surface of the water. The whale's head and back are visible above the surface, creating a splash. The water is a deep, clear blue. The text is overlaid on the lower half of the image.

## PRISTINE COASTLINE, ISLES OF SELDOM-SEEN WILDLIFE, AND A PANOPLY OF SEA LIFE

probably aren't the first things that pop into most people's minds when they hear about Baja. Overshadowed by the well-known nightlife of Cabo San Lucas, it is a region of untamed wildness hiding in plain sight. Wildness surrounds us as our ships ply the rich waters of the Sea of Cortez and the whale nursery bays of the Pacific. Almost inconceivably, the region is home to over a third of all marine mammal species in the world.

An underwater photograph showing several whales swimming in clear, deep blue water. The whales are seen from below, with their dark bodies and white underbellies visible. The water is bright and clear, with some light rays filtering through. The whales are moving in various directions, creating a sense of depth and movement.

## TABLE OF CONTENTS

- 2** Where Awesome Is
- 4** The Perfect Platform
- 6** Where Families Connect
- 8** National Geographic Photography
- 10** SoCal to Baja
- 16** Among the Great Whales
- 18** Exploring the Sea of Cortez
- 20** A Remarkable Journey
- 24** The Whales of Magdalena Bay
- 26** Serenity in the Sea of Cortez
- 28** Extensions
- 29** *National Geographic Sea Lion*
- 30** *National Geographic Venture*
- 32** Special Offers
- 33** Reservation Information





## DISCOVER THE POWER AND PURITY OF WILDNESS IN BAJA

**IN THE SEA OF CORTEZ MASSIVE PODS OF LEAPING** dolphins roil the sea's surface in a spectacle of biomass. Mobula rays swirl just beneath our Zodiacs, launching themselves into the air in a dazzling display. As we don snorkeling gear and climb into the water, sea lions leap off rocks to perform undersea acrobatics around us. Making landfall on desert isles, we hike through forests of giant cacti on sun-drenched hillsides and venture into desert *arroyos* that hold water long after storms, giving way to rivers of desert blossoms. Visit island sanctuaries for breeding seabirds covered with nests, filled with a symphony of bird calls so loud your naturalist needs to shout to be heard. On the Pacific side of the peninsula hike, leap, and slide down wind- and wave-sculpted dunes that stretch along the coast. And be among the privileged few to enter the birthing lagoons of the California gray whales for life-affirming close encounters with gentle mothers and curious calves.

“This morning we awoke just north of the islands of Los Islotes. Among the rocks that jut out from the water, we find the local cabal of California sea lions, brown pelicans, blue-footed boobies, various cormorants, and even peregrine falcons. At Isla San Francisco, we went hiking, kayaking, stand-up paddleboarding, snorkeling, and swimming off this beautiful island. As the sun set, we prepped for a Baja-style BBQ on the beach. Faces alight from the orange and red glow off the horizon, we ate, drank, and laughed about what will remain an unforgettable journey in an unforgettable land.”

— KAYVON MALEK  
Undersea Specialist  
Daily Expedition Report, Baja



## THE PERFECT MOBILE BASE CAMP FOR EXPLORING

WITH OPEN DECKS THAT TAKE FULL ADVANTAGE OF THE SUN AND ocean breezes, and create front row seats on the remarkable spectacle of marine life in Baja, our nimble expedition ships are uniquely suited to make the most of being in this remote, soul-satisfying geography. All are equipped with fleets of Zodiacs, kayaks, and stand-up paddleboards to explore the desert island shores and beneath the calm sea, vivid with life. The 50-cabin *National Geographic Venture* is outfitted with the amenities and ability to cover great distances—reflected in their farther-ranging itineraries—while still using its small scale to sail among the islands and channels where we've been finding whales for nearly 40 years. And the 31-cabin *National Geographic Sea Lion* offers an immediacy and intimacy with the landscapes—reflected in the Baja itineraries for which she is perfectly adapted. She is the only expedition ship operating in Baja small enough to slip past the shifting sandbars and anchor inside Magdalena Bay, a nursery for gray whale mothers and calves, to give those aboard the experience of waking up and drifting off to sleep to the sounds of nearby gray whales.



# NEW!

## SEE YOUR KIDS BECOME NATIONAL GEOGRAPHIC GLOBAL EXPLORERS

### WHETHER IT'S GETTING WITHIN ARM'S REACH OF WILD

gray whales or exploring secluded coves and inlets by kayak, shared activities in Baja's wild and exciting environment can bring a family together. And now that our National Geographic Global Explorers program is launching in Baja, there's no better way for families to explore the region. Our program for kids and teens is the only program of its kind in Baja, giving families a unique way to explore and connect with each other and the natural world. Developed in conjunction with National Geographic Education, it's designed to help kids and teens under 18 develop the attitudes, skills, and knowledge of an explorer. They're invited to engage in a variety of cool activities, guided by a National Geographic certified field educator, and can collect 'points' on their way to become a National Geographic Global Explorer—with the certification to prove it! Guests under 18 (and their families) will:

- ✓ Develop their observation skills by watching out for specific wildlife, and recording observations in their Field Notebook
- ✓ Have fun with cool activities like earning their Zodiac driving 'license'
- ✓ Connect with nature through direct contact with wildlife above and below the sea
- ✓ Use their creativity to become good storytellers—with photos, videos, music, writing, drawing, and more—to communicate all they'll see and do
- ✓ Participate in all or some of the activities based on their interests, and still have plenty of time to share a family adventure



**Our exclusive program** for families is the only one of its kind in Baja travel. Families discover a unique way to explore and connect with each other and the natural world. And kids engage in a variety of cool optional activities, guided by a National Geographic certified field educator. Visit [expeditions.com/family](https://expeditions.com/family) for program details.





# DOING WHATEVER IT TAKES TO MAKE YOUR EXPERIENCE EXTRAORDINARY

**WHETHER IT MEANS STAYING UP UNTIL THE WEE HOURS TO SCAN FOR PASSING** whales of uncommon species so you won't miss out on rare sightings; taking advantage of an opportunity to snap photos of a pod of leaping dolphins, or holding an impromptu stargazing, our team is dedicated to revealing Baja and making sure your experience is exceptional. Benefit from the personalities and knowledge of an expedition leader, a team of naturalists, an undersea specialist, a Lindblad-National Geographic certified photo instructor (CPI), and a video chronicler, plus a wellness specialist to enhance the revitalizing effects of life in the Sea of Cortez.

▶ Learn more at [expeditions.com/expertbios](https://expeditions.com/expertbios) for full bios on our staff



*Representing our expert team for the 2020/2021 season, clockwise from left: Carlos Navarro, undersea specialist; Alex Krowiak, CPI/naturalist; Annie Fiske, expedition leader; Paul North, undersea specialist; Stella Bohnert, assistant expedition leader.*



## IN A LAND WITH PERFECT LIGHT, BENEFIT FROM EXPEDITION PHOTOGRAPHY

MAKE THE MOST OF THE UNRIVALED PHOTO OPS OF BAJA CALIFORNIA'S wild islands, whales, dolphins, pelicans, and sea birds with our Expedition Photography program. Every expedition features a Lindblad Expeditions-National Geographic certified photo instructor who offers assistance,



instructions and shooting tips in the field. Their expertise will inspire you and help you improve your skills—no

matter your current skill or interest level—and ensure you return home with incredible photos. See pages 20-21 to learn about our special Photo Expeditions, joined by a National Geographic photographer.

### Exclusive Onboard Gear Locker

Dive into the onboard B&H Photo Video Gear Locker to field test new glass, camera bodies, and more—free. Plus, ask your Expedition Specialist about pre-voyage discounts and benefits.



# THE PACIFIC COAST THROUGH AN EXPLORER'S LENS





**WATCH THE METROPOLIS OF L.A. FADE AWAY AS YOU SAIL**

south on *National Geographic Venture*, one of the newest ships in our fleet, on an expedition into the origins of California and the nation. Venture first to the Channel Islands, a gem of the National Parks system, to hike a river of pine cones to one of only two groves of Torrey Pines on Earth. Sail into the Baja Peninsula’s wine region, with some areas originally planted by the Spanish in the 16th century. In the Guadalupe Valley, grapes grow in the arid climate with thick skins, producing a deep color and full-bodied, robust taste you’ll sample over lunch at a private vineyard. See other evidence of Spanish colonialism while strolling cobblestone streets to plazas laid out centuries ago.

While the cultural experiences are deeply rewarding, the region’s spectacular nature is the main draw. Explore the desert and islands lush with amazingly adapted plants and creatures—setting foot on the shores is akin to a walk in the “land of the lost.” Searching among the 20 whale species known to cruise these waters including humpbacks and huge blues, our flexible itinerary allows us to “brake” for whales and to spend time among these gentle cetaceans. In Cabo Pulmo, you’ll don snorkeling gear to explore the thriving life on the only hard coral reef in North America—a brilliant example of marine conservation. Last season, our visit to the Vizcaino Biosphere Reserve, with its world-renowned fishing cooperatives and resident elephant seals was a surprise highlight.

Enjoy daily morning stretch classes on deck and wellness treatments in *National Geographic Venture*’s spa, too. Count on an extraordinary experience—your entire expedition team is committed to doing whatever it takes.

# FROM SOUTHERN CALIFORNIA TO BAJA: SAILING THE PACIFIC COAST

**12 Days/11 Nights—Aboard *National Geographic Venture***  
PRICING FROM \$7,930 (See pages 30-31 for details.)

Enter a time machine: see the SoCal coast as it is and as it was, while making time-warping discoveries. Depart Los Angeles' bustling port for the nearby Channel Islands to witness intact wildness, complete with thriving endemic species, mere nautical miles from a sprawling megalopolis. Making our way south, we encounter world-class food and wine and lessons in sustainability. Scour the horizon for migrating whales and birds. And enjoy daily morning stretch classes on deck as we slip back into the era of historic missions punctuating desert landscapes where ancient cacti stand sentinel. Count on your entire expedition team to do whatever it takes to ensure an unforgettable voyage.

## EXPEDITION HIGHLIGHTS

- ▶ Discover one of the nation's best-kept secrets, Channel Islands National Park.
- ▶ See why everyone is talking about the vineyards of Valle de Guadalupe.
- ▶ Explore the waters and experience the wildlife of peninsular Vizcaino Biosphere Reserve; meet the fishermen of Isla Natividad's model fishing co-op.
- ▶ Roam the ever-shifting sand dunes of Isla Magdalena, home to over 40 bird species.
- ▶ Snorkel in Cabo Pulmo National Marine Park, the only hard coral reef in North America; featuring over 220 species of fish.

## SWIM WITH WHALE SHARKS

Fall under the spell of enchanting La Paz on our new extension, delving into the region's rich history through its cuisine, architecture, and charming museums. Then cap it off with a thrilling, once-in-a-lifetime swim with the largest fish on the planet, the gentle giant whale shark. Learn more on page 28 or at [expeditions.com/whaleshark](https://expeditions.com/whaleshark)

*Torrey pine on Santa Rosa Island, Channel Islands National Park.*

**DAY 1: LOS ANGELES/EMBARK**

Arrive in Los Angeles, where you'll embark the *National Geographic Venture*. (D)

**DAY 2: CHANNEL ISLANDS NATIONAL PARK**

Home to diverse, endemic flora and fauna, birds, and 11 land mammal species, there is plenty to see in Channel Islands National Park. (B,L,D)

**DAY 3: ENSENADA AND THE VALLE DE GUADALUPE, MEXICO**

Vineyards and culinary marvels await in one of the world's hottest up-and-coming wine regions. See what the hype is all about as we visit a family-run vineyard for a private tour, tasting, and lunch. (B,L,D)

**DAY 4: SAN QUINTÍN EXPLORATION**

A day exploring in the Bahía de San Quintín and surrounding islands—home to 400+ species of plants, animals, and birds, including 23 seabird species. (B,L,D)

**DAYS 5 & 6: EXPLORING THE VIZCAINO BIOSPHERE RESERVE**

As we continue our journey along the Baja coast, we explore the nutrient-rich waters surrounding Vizcaino Peninsula. Whether encountering the resident northern elephant seals of Islas San Benito or learning about the story of the fishing co-ops of Isla Natividad and their shift towards sustainable fishing practices in the region, this seldom-visited section of Baja offers a bounty of opportunities



*Blue whale.*

for exploring. We may opt to visit Guerrero Negro to the north, check on the wildlife which call Isla Cedros home, or navigate our way around the tip of the peninsula to remote bays opening to the southwest. (B,L,D)

**DAY 7: AT SEA**

As we travel south along the Pacific coast of the peninsula, there is a chance of seeing a wide variety of marine life, including the largest animal on Earth, the blue whale. Hear naturalist talks, and learn photography tips and tricks during this day at sea. (B,L,D)

**DAY 8: BAHÍA MAGDALENA**

Explore the ever-shifting sand dunes of Isla Magdalena, on a cross-island walk to one of the most pristine beaches in the Pacific. Birders take note: these fertile shorelines are home to over 40 species of birds. (B,L,D)

**DAY 9: LOS CABOS AND GORDA BANKS**

Cruise past Friars Rocks and visit the historic



town center of San José del Cabo before cruising Gorda Banks seamount or La Fortuna, renowned gathering places for whales, dolphins, and other marine life. (B,L,D)

**DAYS 10 & 11: CABO PULMO/ LOS ISLOTES**

Snorkel the pristine reefs of Cabo Pulmo National Park and chat with locals about their advocacy to protect this unique place. With luck, swim with curious sea lions at Los Islotes before relaxing ashore. Swim, kayak, or hike on a nearby uninhabited island and end the day with a beach barbeque, bonfire, and star-filled sky. (B,L,D)

**DAY 12: LA PAZ/DISEMBARK/ SAN JOSÉ DEL CABO/U.S.**

Disembark in La Paz and transfer to Los Cabos airport for flights home. (B)



*Guests kayaking.*

**EXPEDITION DETAILS**

**DATES:** 2020 Nov. 30 2021 Dec. 5

**SPECIAL OFFERS**

Book now and receive a **\$350 AIR CREDIT** per person on the 2020 departure. Plus we will **waive the solo premium** on solo cabins on the 2020 departure. See page 32 or call for details.

THE LUXURY OF CHOICE IN  
EXPLORING A CAPITAL OF WILDNESS







**BAJA AND THE SEA OF CORTEZ IS A VAST WILDERNESS IN**

which you could roam free for weeks on end and not even come close to experiencing all its grandeur. Over nearly four decades exploring the region, we've finely honed experiences that offer travelers with varied interests ways to indulge their curiosities.

**Baja California & the Sea of Cortez:  
Among the Great Whales**

Enjoy the exhilaration of encountering California gray whales in Magdalena Bay, where hundreds come to breed and give birth. They are remarkably unafraid of our presence and, at times, even seek us out with very close contact. Then, venture into the Sea of Cortez to explore its pristine desert isles and snorkel with sea lions.

**Exploring the Sea of Cortez:  
A Living Sea & Desert Isles**

The isolated isles in the Sea of Cortez isles are commonly referred to as the "Galápagos of Mexico" because of their unique and endemic species. Roam freely among these diverse islands and bays, relying on our decades of experience to read the wind, waves, and wildlife habits to go where encounters are best. You won't see the gray whales on this voyage, but you will see plenty of other marine life, as the Sea of Cortez teems with it.

**Baja California: A Remarkable Journey**

Over nearly two weeks experience the full spectrum of opportunity in Baja on both the Pacific side among the gray whales and over an in-depth exploration of the Sea of Cortez. Get up close to wild whales, see acrobatic dolphins galore, and explore the undersea. Witness great seabird colonies and hike beautiful desert islands. And capture it all with help from a certified photo instructor.

# BAJA CALIFORNIA & THE SEA OF CORTEZ: AMONG THE GREAT WHALES

**8 Days/7 Nights—Aboard *National Geographic Venture***

PRICING FROM \$6,270 (See pages 30-31 for details.)

Seeing gray whales in their natural habitat is one of the great delights of this voyage, as you venture out in small boats among these magnificent creatures. In the Sea of Cortez, search for a variety of whales, plus dolphins, blue-footed boobies, pelicans, cormorants, and magnificent frigatebirds. You'll also snorkel among sea lions, join naturalists on hikes amid iconic cardon cactus and sculpted sand dunes, and see a variety of desert flora and fauna.

## EXPEDITION HIGHLIGHTS

- ▶ Explore along Baja's Pacific Coast and the Sea of Cortez for opportunities to observe humpbacks, gigantic blue whales, sperm whales, pilot whales, and more.
- ▶ Your floating base camp brings you into the breeding grounds of gray whales to observe their calves on intimate water-level encounters, and from the ship's bow along with expert naturalists.
- ▶ Go snorkeling amid sea lions and schools of king angelfish in the Sea of Cortez and in extraordinary Cabo Pulmo National Marine Park.
- ▶ Kayak clear blue waters on the lookout for a variety of bird species including magnificent frigatebirds.
- ▶ Hike or walk diverse landscapes, including sand dunes, a cactus forest, and deserted islands.
- ▶ Stroll the "Malecon" in vibrant La Paz and dine splendidly; in Loreto visit the first mission in the New World.



### LA PAZ FIESTA

You're invited to a lively celebration of Baja culture—a guest favorite in 2020. End a day of exploration by dining on specialties from a renowned chef, hearing local musicians, and taking in an enchanting dance performance in the shadow of a historic cathedral.

*Gray whale, Magdalena Bay.*

**DAY 1: U.S./LORETO, MEXICO/  
SAN CARLOS/EMBARK**

Upon arrival in Loreto, transfer to San Carlos and embark our ship. Tonight, we'll anchor off the coast of Isla Santa Margarita. (D)

**DAY 2: BAHÍA ALMEJAS/REHUSA  
CHANNEL/ISLA MAGDALENA**

Awake in Bahía Almejas, the southernmost part of the Bay. We'll observe a large frigatebird colony en route to the spectacular whale grounds of Bahía Almejas. Whales here tend to be very active, seemingly oblivious to our presence, so settle in for some great experiences. Later we'll reposition to Isla Magdalena to explore the ever-shifting sand dunes on a cross-island walk to one of the most pristine beaches in the Pacific. Bird-watching can be excellent here. (B,L,D)

**DAY 3: BOCA DE SOLEDAD**

Each winter, gray whales travel south from their Arctic feeding grounds to breed, give birth, and raise their calves in these sheltered waters. Today, we transfer by motorcoach to this northern extension of Bahía Magdalena where we will spend the full day interacting with these majestic creatures. Together with savvy local Mexican fishermen, we'll venture out in local pangas to view the numerous mother-calf pairs. We will likely encounter a variety of shorebirds feeding voraciously on the shoreline while frigatebirds and pelicans soar overhead. (B,L,D)

**DAY 4: BAHÍA MAGDALENA &  
CRUISING**

Kickstart your day with a morning stretch hosted by our onboard wellness specialist on the sun deck. After breakfast, if conditions permit, we'll explore the mangrove system

via kayak, stand-up paddleboard, and Zodiac, and learn how these ecosystems support their surroundings. This afternoon, we'll sail out through "La Entrada" as we leave Magdalena Bay behind. Traveling south along the coast of the peninsula, there is a chance of seeing a wide variety of marine life, including humpback whales. Hear naturalist talks and learn photography basics. (B,L,D)



*Sand dunes, Magdalena Island.*

**DAY 5: GORDA BANKS/CABO PULMO**

Awake to a majestic sunrise over the iconic Friars Rocks at Land's End. We'll spend the rest of the morning searching the seas of Gorda Banks seamount, a renowned gathering place for whales, dolphins, and other sea life. Later we'll set out to snorkel the pristine reefs of Cabo Pulmo National Marine Park, one of the most successful national marine parks in the world, and chat with locals about their advocacy to protect this unique place. (B,L,D)

**DAY 6: LOS ISLOTES AND LA PAZ**

Awake this morning off the rocky island of Los Islotes, where we'll don flippers, a mask, and snorkel and swim with curious sea lions. Then we'll reposition to the colorful city of La Paz to garner insight into the culture of Mexico, soak in the vibrant street art, and stroll the lively "Malecon." Dinner will be an unforgettable cultural experience, featuring local cuisine, dancing, and folklore. (B,L,D)



**DAY 7: EXPLORING THE SEA OF  
CORTEZ**

Our plan is flexible as we explore some of the Sea's many uninhabited islands. We may go ashore at Isla San Francisco, where a sweeping arc of white sand beach beckons you to kayak or stand-up paddleboard. Or, hike to the nearby ridge for unparalleled views over Isla Danzante with your naturalist. You may also visit the abandoned salt works on Isla Carmen. You'll get a chance to see the great wildlife diversity offered in the Sea of Cortez, and with some luck, blue or fin whales. (B,L,D)

**DAY 8: LORETO/DISEMBARK/U.S.**

Disembark in Loreto after breakfast and transfer to the city center. Visit the first mission in Baja California and the nearby museum to learn more about what makes this town so special. Enjoy free time to explore the quaint shops and vibrant side streets. After lunch, transfer to Loreto Airport for flights home. (B,L)

**EXPEDITION DETAILS**

**DATES:** 2021 Jan. 9\*, 16, 23\*, 30; Feb. 6\*, 13, 20\*, 27; Mar. 6\*

\*These departures travel in the reverse.

Note: The exact order of stops may vary in order to maximize your experience.

**BLUE & FIN WHALE LORETO EXTENSION**

Further your exploration of this richly varied region with this exciting two-night extension. Visit [expeditions.com/loreto](http://expeditions.com/loreto) for details.



*Swim with graceful sea lions.*



*Blue whale fluking.*

# EXPLORING THE SEA OF CORTEZ: A LIVING SEA & DESERT ISLES

**8 Days/7 Nights—Aboard *National Geographic Venture***

PRICING FROM \$6,690 (See pages 30-31 for details.)

The pristine desert islands dotting the Sea of Cortez are places of incredible biodiversity set amid a UNESCO World Heritage Marine Site dubbed “the world’s aquarium” by Jacques Cousteau. Each of these islands is a world unto itself, with a palpable feel of rugged isolation. Hike among forests of cacti and along desert *arroyos* in bloom as you search for endemic flora and fauna. Watch for swirling plunge-diving brown pelicans, blue-footed and brown boobies, and the frenetic aerial activity of gulls and terns that often alerts us to large pods of acrobatic dolphins. With a flexible itinerary, decades of experience, and deep knowledge of wildlife habits, this unique journey combines the beauty and biodiversity of this legendary region with a stimulating sense of adventure.

## EXPEDITION HIGHLIGHTS

- ▶ Experience a voyage of pure discovery in a UNESCO World Heritage Site, with a flexible itinerary chosen by the region’s most knowledgeable staff to maximize wildlife sightings.
- ▶ Venture further north in the Sea of Cortez to explore remote and seldom visited islands, such as Isla Rasa, a breeding ground for 90 percent of the world’s Heermann’s gulls and a large population of elegant and royal terns.
- ▶ Search for pods of dolphins and other marine life. With luck, catch a leaping Mobula ray as it ejects from the sea and belly-flops back in the water.
- ▶ Explore water-level caves by kayak, hike uninhabited beaches, stand-up paddleboard, and snorkel among tropical fish and acrobatic sea lions.

## BE OUR GUEST

Spend the night in lovely Loreto with our compliments. Book the Dec. 20, 2020 departure and receive a free 2-day/1-night Loreto Mission & Hike pre-voyage extension. Visit a 17th century Jesuit mission with an interesting array of icons. Then, explore the Sierra de la Giganta foothills on a pre-lunch hike. Call for details.

## NATIONAL GEOGRAPHIC EXPERT

A National Geographic Expert will join the **Apr. 12, 2021** departure.

*Learn more about staff and guest speakers at [expeditions.com/experts](https://expeditions.com/experts).*



*California sea lions basking in the sun.*

**DAY 1: U.S./LORETO, MEXICO/ EMBARK**

Arrive in Loreto and embark our ship. (D)

**DAYS 2–7: EXPLORING THE SEA OF CORTEZ**

Our routing is designed with flexibility in mind, to maximize opportunities for wildlife sightings. It will most likely include the islands and activities listed below, although the order may vary. (B,L,D)

**ISLAS SAN ESTEBAN AND SAN PEDRO MÁRTIR:**

Walk up a desert wash, to search for desert songbirds such as the handsome black-throated sparrow, listen for the cascading song of the canyon wren and search for the endemic pinto chuckwalla—a plump, harmless desert lizard. Later visit Isla San Pedro Mártir, a 1,000-foot-high guano-covered island that is home to thousands of seabirds: brown pelicans, magnificent frigatebirds, Brandt’s cormorants; and California sea lions.

**ISLA SAN MARCOS:**

At Isla San Marcos, there is a beautiful shoreline for swimming, snorkeling, and kayaking. In the afternoon, we are again in rich waters. We are on the lookout for pods of dolphins—with common and bottlenose being the most frequently encountered species. With luck they will join us as we go, riding the bow wave and sometimes leaping from the water.

**ISLA SAN JOSÉ:**

One of the larger islands in the Sea of Cortez, San José, offers several landing possibilities depending on conditions and the whim of the moment. Photograph the ochre cliffs of the island’s eastern shore, hike an “enchanted,” cactus-laden *arroyo*, or visit the abandoned salt works to the west.



**BAHÍA LORETO MARINE PARK:**

This morning we’ll search the waters south of Isla Carmen for fin whales, which researchers have recently concluded may be a resident population. Bottlenose and common dolphins are frequently encountered. Later we visit an island of Bahía Loreto Marine Park, with ample time for kayaking, snorkeling, stand-up paddleboarding, and possibly hiking. In the evening, enjoy a beach barbecue under the desert sky.

**ISLAS LOS ISLOTES AND SAN FRANCISCO:**

At Los Islotes, don flippers, a mask and snorkel and swim with curious sea lions. We have a



leisurely afternoon to swim, kayak, or hike at Isla San Francisco. Look skyward for yellow-footed gulls, brown pelicans, and blue-footed boobies.

**DAY 8: LORETO/DISEMBARK/U.S.**

Disembark and explore Loreto, where we will have the opportunity to visit the first mission in Baja California, as well as the nearby museum to learn more about what makes this town so special. Enjoy free time to explore quaint shops and vibrant side streets. After lunch, transfer to Loreto Airport for flights home. (B,L)

**EXPEDITION DETAILS**

**DATES:** 2020 Dec. 20, 27

2021 Apr. 12; Dec. 19, 26

**SPECIAL OFFERS:**

Book the Dec. 20, 2020 departure and receive a free 2-day/1-night extension in Loreto. See page 32 for details.



*Surfacing bottlenose dolphins in the Sea of Cortez, Baja California.*

# BAJA CALIFORNIA: A REMARKABLE JOURNEY

**15 Days/14 Nights—Aboard *National Geographic Venture* and *National Geographic Sea Lion***

PRICING FROM \$10,610 (See pages 29-31 for details.)

Embark on a comprehensive expedition that explores both the Pacific side of Baja California and the islands in the Sea of Cortez. Venture into the gray whale lagoons for up-close encounters, and then spend ample time exploring the Sea of Cortez and all its marine mammals. See scores of blue-footed boobies and pelicans, kayak into quiet grottos, and visit charming seaside towns.

## EXPEDITION HIGHLIGHTS

- ▶ Get up-close views of gray whale mothers and their growing calves as they prepare for their journey back to Arctic feeding grounds.
- ▶ Kayak clear blue waters to search for wildlife, including magnificent frigatebirds, and investigate the intricacies of the shoreline.
- ▶ Snorkel the living sea: observe large schools of vibrantly colored fish, swim among playful sea lions, and much more.
- ▶ With more time for adventure, rely on your expedition leader to take you where wildlife will be at its best—including the remote oceanic island of San Pedro Mártir with clouds of nesting seabirds and crowds of sea lions onshore, and expanses of sea where huge pods of dolphins gather.

## NATIONAL GEOGRAPHIC PHOTOGRAPHERS

National Geographic photographer **Ralph Lee Hopkins** joins the **Mar. 15, 2021** photo expedition aboard *National Geographic Sea Lion*. Ralph is the founder and director of the Expedition Photography program for the Lindblad-National Geographic alliance. For more than 20 years he has lead expeditions from the Arctic to Antarctica and points in between.

**Krista Rossow** will be aboard the **Mar. 29, 2021** photo expedition. For more than a decade, Krista has worked as a photographer, photo editor, and educator for National Geographic, seeing the camera as a tool for understanding new cultures, meeting the locals, and exploring the natural world.

*Read full bios and find out more about Photo Expeditions at [expeditions.com/photo](https://expeditions.com/photo).*



*Kayaking the calm water in the Sea of Cortez.*

**DAY 1: U.S./LORETO, MEXICO/  
SAN CARLOS/EMBARK**

Upon arrival in Loreto, transfer to San Carlos and embark our ship. (D)

**DAY 2: BAHÍA MAGDALENA**

Explore the ever-shifting sand dunes of Isla Magdalena, on a cross-island walk to one of the most pristine beaches in the Pacific. Bird-watching in this area can be excellent. We may observe pelicans and cormorants skimming the waters of the bay, or terns wheeling and darting as frigatebirds ride the thermals above, looking for an easy meal. Along the beaches, resident great blue herons feed on these fertile shorelines next to migratory shorebirds, including whimbrels and willets, as they refuel for their northbound journeys. (B,L,D)



*Gray whale, Laguna San Ignacio.*

**DAYS 3 & 4: LAGUNA SAN IGNACIO**

Laguna San Ignacio is a large bay and favored haunt of the gray whales in Baja. The ship will anchor at the mouth of this remote and important locale, while we observe the mother and calf pairs in local pangas. For some reason, the whales here seem to be friendlier than they are elsewhere. It's not unusual for mothers and calves to approach our boats, the calves often playing hide and seek—sometimes even welcoming a touch or a friendly chin scratch. (B,L,D)

**DAY 5: AT SEA**

As we travel south along the Pacific coast of the peninsula, there is a chance of seeing a wide variety of marine life. (B,L,D)

**DAYS 6–14: ISLANDS OF THE SEA OF CORTEZ**

Cruise past the spectacular Friars Rocks at Land's End. For those who wish, we will arrange a visit to the historic town center of San José del Cabo. Isla San Pedro Mártir, Los Islotes, Isla San Francisco—these are some of the melodious names of islands scattered throughout this beautiful sea. After over 40 years of exploration here, we are still discovering new places and experiencing exciting events: bow-riding bottlenose dolphins, or sperm whales near our ship; a pod of fin whales feeding around a convergence zone; or perhaps, with luck, the largest animal on earth—the blue whale. The best areas for whale watching remain consistent—the waters south of Isla Carmen, Canal de



Ballenas up north, and near the mouth of Bahía Concepción. Whether on the Bridge of the ship, in Zodiacs, or kayaks, we will be in prime position to observe them all. (B,L,D)

**DAY 15: LORETO/DISEMBARK/U.S.**

Disembark in Loreto after breakfast and transfer to the city center. You'll have the opportunity to visit the first mission in Baja California, as well as the nearby museum to learn more about what makes this town so special. Enjoy free time to explore quaint shops and vibrant side streets. After lunch, transfer to Loreto Airport for flights home. (B,L)

**EXPEDITION DETAILS**

**DATES:** *National Geographic Venture:*

2021 Mar. 15\*, 29 📷

*National Geographic Sea Lion:*

2021 Mar. 15 📷

📷 Photo Expedition

\*This departure travels in reverse.



*Guest photographing at sunrise.*

# WHALES, BEACHES, YOGA, HIKES & SERENITY







THE TWO ESCAPES FEATURED HERE OFFER YOU THE BEST of Baja in a convenient five- or four-night timeframe. Is getting up close with the local wildlife your main priority? Simply choose the **Escape to Magdalena Bay**, aboard *National Geographic Sea Lion*, perfectly sized to enter and anchor in the Bay's protected waters, placing us among the gray whale mothers and calves drawn to the calm nursery lagoons. Curious, playful, and friendly, they often approach the small Zodiacs we deploy for close-up views and mutual curiosity. At night you can stand on deck under stars and hear the whales breathing around the ship. By day, watch diving pelicans and ospreys, and marvel at the major air dolphins catch as they leap from the water. Plus there are sand dunes to wander, stretches of beach to bike, mangroves to kayak, and many species of birds to spot and add to your life list.

Interested in wellness? Our **Serenity Escape** aboard *National Geographic Venture* is ideal. Enjoy sunrise yoga on deck and a host of outdoor activities in and among idyllic desert isles in the Sea of Cortez. Choose beach yoga or Boot Camp. Go paddleboarding or kayaking. Geek out on a trail walk with a naturalist, or hike high up for an exhilarating panorama of the Sea of Cortez. And while you're there, you can easily add a rare experience to your "Been there, done that" list—swimming with whale sharks, the world's largest fish.

Choose either Escape and save 10% when you travel with a group of six or more. Make a milestone birthday or anniversary extra special by celebrating in pure wildness in a place not too far from home.

# WILD BAJA ESCAPE: THE WHALES OF MAGDALENA BAY

**6 Days/5 Nights—Aboard *National Geographic Sea Lion***

PRICING FROM \$3,740 (See page 29 for details.)

This is no ordinary whalewatching experience: we'll literally anchor among the gray whales in Bahía Magdalena, where mothers and calves relax after the longest mammal migration on earth. We'll see and hear them around the ship, and venture out in expedition landing craft for exhilarating up-close encounters. We'll visit multiple sites in the 70-mile-long bay to maximize our opportunities for interactions. While whales may be the highlight, this area is home to so much more. Explore the mangroves by kayak. Fat-tire bike along remote beaches (we've got a fleet of bikes aboard). Beachcomb endless crescents of sand, studded with thousands of sand dollars. And revel in the vastness and serenity as you view the many species of birds in this world-renowned region.

## EXPEDITION HIGHLIGHTS

- ▶ Live among gigantic gray whale mothers and their calves in the nursery waters of Bahía Magdalena. See them from the ship and local pangas, delighting in up-close encounters.
- ▶ Kayak and paddleboard stunning mangroves, or beachcomb along endless beaches.
- ▶ Explore diverse landscapes; fat-tire bike along desert island terrain.
- ▶ Scan the skies for bird species, from diving pelicans to magnificent frigatebirds.

## EXPERIENCE & EXPERTISE



Our expert expedition team will illuminate the wonders of Magdalena Bay from every possible angle. Your expedition leader, undersea specialist, Lindblad-National Geographic certified photo instructor and naturalists, plus a wellness specialist and video chronicler, are dedicated to ensuring an incredible voyage.

*Visit our website to read staff bios for this expedition.*



*Lindblad Guests with a California gray whale.*

**DAY 1: U.S./LORETO, MEXICO/  
SAN CARLOS/EMBARK**

Upon arrival in Loreto, transfer to San Carlos and embark *National Geographic Sea Lion*. Tonight we'll anchor off the coast of Isla Santa Margarita. (D)

**DAY 2: BAHÍA ALMEJAS/REHUSA  
CHANNEL/ISLA MAGDALENA**

Awake in Bahía Almejas, the southernmost part of the Bay. We'll make a special stop to view a large frigatebird colony on Isla Santa Margarita before heading out on our first whale watching trip of the voyage. The whales in Bahía Almejas tend to be very active, seemingly oblivious to our presence. As we explore this bay and the Rehusa Channel via local panga, our team will do whatever it takes to provide you with memorable and meaningful experiences. During lunch, we'll sail toward Isla Magdalena to explore the ever-shifting sand dunes on a cross-island walk to one of the most pristine beaches in the Pacific. Take a dip or tally the treasure found on what we affectionately call "sand dollar beach." (B,L,D)

**DAY 3: TRANSIT THE HULL CANAL/  
BOCA DE SOLEDAD**

Spend the morning transiting the scenic, winding Hull Canal. Within its narrow channels, bordered by mangroves and sand dunes, and filled with abundant wildlife, we'll hang out on deck with our keen-eyed naturalists to spot species and hear expert commentary. Weather permitting, we'll explore the vast mangrove

system via kayak and expedition landing craft. Bird-watching here can be excellent. Among the species we might see are diving pelicans, wheeling cormorants, terns, great blue herons, ibis, whimbrels, and willets. It's not unusual to see 40 species of birds in just one day along these fertile shorelines. This afternoon, we'll head out to explore the breeding grounds of Boca de Soledad. (B,L,D)



Treasures from "sand dollar beach."

**DAYS 4 & 5: BOCA DE SOLEDAD**

Each winter, during their long migration, gray whales travel south from their Arctic feeding grounds to breed and give birth to their calves in these sheltered waters. "Grand Central" for California gray whales, we'll spend two full days observing, and with luck, interacting with these majestic creatures. Together with savvy local fishermen we've known for years, we'll venture out in Zodiacs to view the numerous mother-calf pairs that thrive in this region. We'll also have an opportunity to explore the beaches, and if you're feeling up to it, grab one of our fat-tire bikes to roam the seemingly endless beaches. (B,L,D)



**DAY 6: SAN CARLOS/DISEMBARK/  
LORETO/U.S.**

After breakfast, disembark our ship and transfer to Loreto's city center. Choose to visit the first mission in Baja California, as well as the nearby museum to learn more about what makes this town so special. Enjoy free time to explore the quaint shops and vibrant side streets. After lunch, transfer to Loreto Airport for flights home. (B,L)

**EXPEDITION DETAILS**

**DATES:** 2021 Jan. 14, 19, 29;  
Feb. 3, 8, 13, 28; Mar 5, 10

**BLUE & FIN WHALE LORETO EXTENSION**

Further your exploration of this richly varied region with this exciting two-night extension. Visit [expeditions.com/loreto](http://expeditions.com/loreto) for details.



Guest photographing at sunrise.

# WILD BAJA ESCAPE: SERENITY & SEA LIFE IN THE SEA OF CORTEZ

**5 Days/4 Nights—Aboard *National Geographic Venture***

PRICING FROM \$2,880 (See pages 30-31 for details.)

A genuinely innovative hybrid—a four-night getaway that feels like an authentic escape from the everyday. Through spa therapies, healthful menus, and fitness classes, experience the balance between mind and body. De-stress, detox or simply play or workout in the uninhabited wilds of Isla San Francisco and Isla Partida in the beautiful Sea of Cortez. With the new 50-cabin *National Geographic Venture* as your mobile base camp, go where the wild things—and few others—are. Breathe deep, push hard, and chill at a BBQ under the stars.

## EXPEDITION HIGHLIGHTS

- ▶ Paddle pristine coves and inlets on kayaks and stand-up paddleboards.
- ▶ Snorkel with sea lions, beachcomb desert shores, or explore by Zodiac.
- ▶ Zen out with Beach Yoga, or do Boot Camp workouts with a wellness instructor; or geek out on trail walks with naturalists.
- ▶ Hike at your chosen speed high into the hills for exhilarating panoramas of the Sea of Cortez; take your best photos ever.
- ▶ Choose from a menu of treatments and massages.

▶ VIEW THE EXHILARATING WELLNESS EXPERIENCE ON THIS WILD BAJA ESCAPE ADVENTURE: [EXPEDITIONS.COM/BAJAWELLNESS](https://www.nationalgeographic.com/expeditions/bajawellness)

## EXPERIENCE & EXPERTISE



We've been exploring the Sea of Cortez for decades, and love the islands here. Our team of naturalists is uniquely able to help you discover this stunning wild region. And to make the most of your time and energy, we'll be adding workout classes and relaxing treatments to the mix—a unique and rewarding combination.

Visit our website to read staff and guest speaker bios for this expedition.

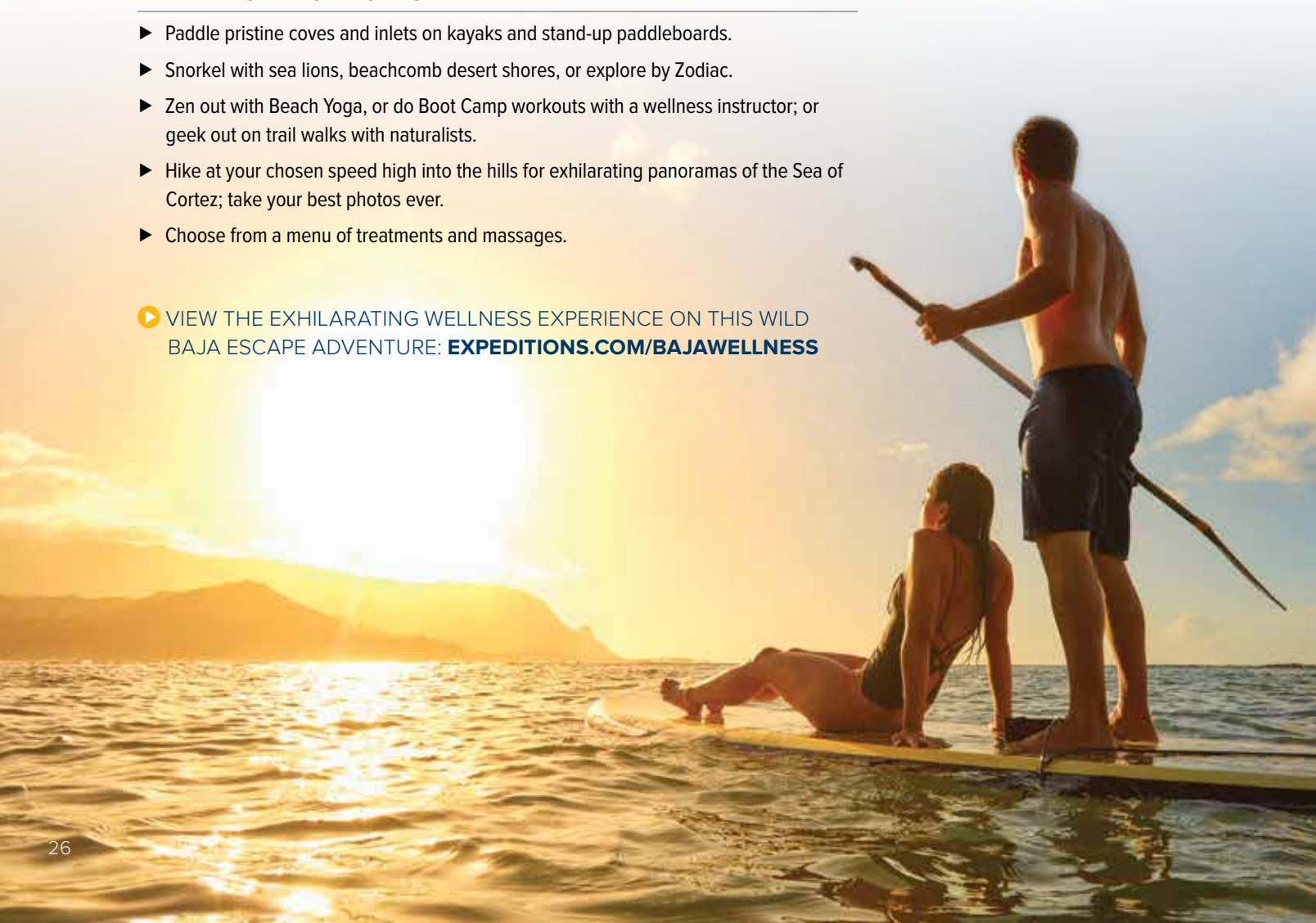

**DAY 1: U.S./SAN JOSÉ DEL CABO,  
MEXICO/LA PAZ/EMBARK**

Upon arrival to Los Cabos airport, transfer to La Paz, where you'll embark *National Geographic Venture* this afternoon. Set sail on arrival for a sunset cruise of Bahía La Paz en route to Isla San Francisco. (D)



*Beach barbecue and bonfire under the stars.*

**DAYS 2 & 3: SAN JOSÉ CHANNEL/  
ISLA SAN FRANCISCO**

Witness a spectacular Baja sunrise this morning, while searching for marine mammals in the upper San José Channel. Hear naturalist talks and learn photography basics during an early morning at sea. Before lunch, go ashore at Isla San Francisco, where a sweeping arc of white sand beach beckons you to roll out a yoga mat. Explore nearby tide pools with your naturalists, or spend the afternoon stand-up paddleboarding, snorkeling, and kayaking. Hike to the nearby ridge for unparalleled views just before sunset. Wind down with an on-deck yoga class or a chair massage, then go ashore for a beach barbecue dinner followed by a

bonfire under the stars. However you choose to spend these days, you'll be rewarded with a sense of well-being that comes only from spending quality time in nature. (B,L,D)

**DAY 4: ISLA PARTIDA AND  
LOS ISLOTES**

Watch the cliffs light up as your wellness specialist leads a morning yoga or qi gong class, on deck. Explore as much or as little as you like, with the ship as your mobile base camp—taking advantage of every wellness option, including hiking with your wellness specialist for mindfulness and stretching on the trail. Explore the dramatically eroded shoreline of Isla Partida on a one-way kayak journey or join a challenging hike up a rocky *arroyo* to the crest of the island. Meander a different *arroyo* with your naturalists to learn about the geology and natural history, then learn to paddleboard, or hone skills you already possess. Snorkel



*Guests snorkel with a playful sea lion.*



with playful and curious sea lions or photograph their antics from a Zodiac. (B,L,D)

**DAY 5: LA PAZ/DISEMBARK/  
SAN JOSÉ DEL CABO/U.S.**

Disembark in downtown La Paz this morning and transfer to Los Cabos airport for flights home. (B)

**EXPEDITION DETAILS**

**DATES:** 2020 Dec. 11, 15 2021 Jan. 4

**SPECIAL OFFER:**

Book six or more under one booking and save 10%. See page 32 or call for details.

**NEW! SWIM WITH WHALE SHARKS**

Enhance your Baja experience with this thrilling two-night extension. See page 28.



*Mobula rays, Los Islotes.*

## OPTIONAL EXTENSIONS

## MAKE THE MOST OF YOUR TIME IN BAJA



## LA PAZ + WHALE SHARKS

**3 DAYS/2 NIGHTS POST-VOYAGE**

Call for pricing

Fall under the spell of enchanting La Paz as you delve into the region's rich history through its cuisine, architecture, and charming museums. Visit the airy, immense cathedral of La Paz and learn the story of its 70-year construction. Stroll along the cobblestone streets of a small mining village and indulge in curated menus and inspiring meals. Cap it off with a thrilling, once-in-a-lifetime swim with the largest fish on the planet, the gentle giant whale shark. Available on *From Southern California to Baja* (page 12) and *Wild Baja Escape: Serenity & Sea Life in the Sea of Cortez* (page 26).

## LORETO + BLUE WHALES

**3 DAYS/2 NIGHTS POST-VOYAGE**

Call for pricing

Add an exploration of Loreto's inland wildness to your coastal expedition, and discover the region's human history through its missions and villages. Visit stunning San Javier, a mission built in the 1700s by Jesuits and see the surrounding town, with streets and buildings largely untouched since 1875, then hike outside the village to experience Baja's inland wildness. In the Loreto National Marine Reserve, board local boats for a chance to see magnificent blue and fin whales, the two largest animals on Earth. Hike through the fascinating ecosystems of the desert and canyons of the Sierra de la Gigante. Available on all departures of *Baja California & the Sea of Cortez: Among the Great Whales* (page 16) and *Wild Baja Escape: the Whales of Magdalena Bay* (page 24).





## NATIONAL GEOGRAPHIC SEA LION

**CAPACITY:** 62 guests in 31 outside cabins.

**REGISTRY:** United States. **OVERALL LENGTH:** 152 feet.

**PUBLIC AREAS:** Our ship features a library; global market; lounge with full-service bar and facilities for films, slide shows and presentations; observation deck; partially covered sun deck with chairs and tables, and LEXspa. Our “open bridge” provides guests an opportunity to meet our officers and captain, and learn about navigation.

**MEALS:** Served in single seatings with unassigned tables for an informal atmosphere and easy mingling. Breakfasts are wide-selection buffets, and lunch is often served family-style. Dinners are primarily served plated. Menu emphasizes local fare.

**CABINS:** All cabins face outside with windows, private facilities, and climate controls.

**EXPEDITION EQUIPMENT:** A fleet of 5 Zodiacs and 20 kayaks, Remotely Operated Vehicle (ROV), hydro-phone, splash-cam, bow camera, video microscope, paddleboards, and snorkeling gear for all guests (where applicable).

**SPECIAL FEATURES:** Guest internet access, Lindblad-National Geographic certified photo instructor, video chronicler, undersea specialist, and ship physician.

**WELLNESS:** The vessel is staffed by a wellness specialist and features exercise equipment, LEXspa, and outdoor stretching area.

**CATEGORY 1:** Main Deck #300-305—Conveniently positioned between the dining room and lounge, these cabins feature two single lower beds, and a large view window.

**CATEGORY 2:** Bridge Deck #100-104; Upper Deck #200-212, 215—These well-located cabins include two lower single beds and a view window.

**CATEGORY 3:** Bridge Deck #105, 106; Upper Deck #214, 216, 217, 219—These cabins feature a seating unit with table and two large view windows. Upper Deck cabins include two lower single beds which can convert to a double bed and a pull-out single bed for a third person; Bridge Deck cabins include two lower single beds only.

Note: Solo Occupancy cabins are available in Categories 1 and 2 only. Third person rates are available in certain categories at one half the double occupancy rate.

Shared Accommodations: Shares can be arranged at the double occupancy rate in Categories 1 and 2 only.

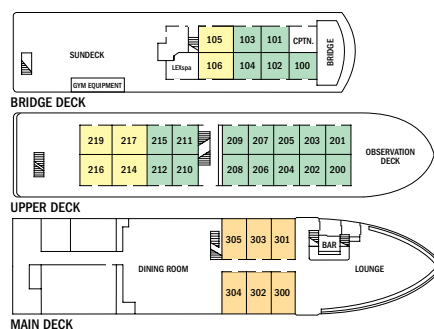

Prices are per person, double occupancy unless indicated as solo.

ITINERARY	YEAR	CAT. 1	CAT. 2	CAT. 3	CAT. 1 SOLO	CAT. 2 SOLO	ADVANCE PAYMENT	NOTE
Baja California: A Remarkable Journey – Page 20	2021	\$10,610	\$12,210	\$13,680	\$15,920	\$18,320	\$1,500	Sample Airfares: Round-trip Los Angeles/Loreto: Economy from \$650; Business from \$1,140.
Wild Baja Escape: The Whales of Magdalena Bay – Page 24	2021	\$3,740	\$4,370	\$4,930	\$5,620	\$6,550	\$750	Sample Airfares: Round-trip Los Angeles/Loreto: Economy from \$475; Business from \$1,140.

Prices quoted in this brochure are valid as of the time of printing, are subject to modification, and are not guaranteed until booking and required deposit are made. See our website at [expeditions.com](http://expeditions.com) for the most up-to-date pricing.



# NATIONAL GEOGRAPHIC VENTURE

**CAPACITY:** 50 cabins accommodating 100 guests  
**REGISTRY:** United States. **OVERALL LENGTH:** 238 feet.

Sister ships *National Geographic Venture* (launched 2019) and *National Geographic Quest* are the latest additions to our fleet. Designed with over 50 years of expedition heritage and built in the U.S.A., they set a new standard in exploration and comfort.

**PUBLIC AREAS:** Global gallery; fitness center; LEXspa; lounge with full service bar and facilities for films and presentations; observation deck; mudroom with lockers for expedition gear; and a partially covered sundeck with chairs and tables. Our “open Bridge” provides guests an opportunity to meet our officers and captain, and learn about navigation.

**MEALS:** Served in single seatings with unassigned tables for an informal atmosphere and easy mingling. Breakfast and lunch are wide-selection buffets with chef-action stations, while dinners are primarily served plated. Menu emphasizes local fare.

**CABINS:** All cabins face outside with windows or portholes, private facilities, and climate controls. Category 4 cabins have step-out balconies.

**EXPEDITION EQUIPMENT:** A fleet of 8 Zodiacs and 24 kayaks, Remotely Operated Vehicle (ROV), hydrophone, splash-cam, underwater video camera, video microscope, paddleboards, and snorkeling gear for all guests (where applicable).

**SPECIAL FEATURES:** Guest internet access, elevator, Lindblad-National Geographic certified photo instructor, video chronicler, undersea specialist, and ship physician.

**WELLNESS:** The vessel is staffed by a wellness specialist and features a gym with an elliptical machine, treadmill, exercycles, handweights, and resistance bands. Treatments in the LEXspa are available by appointment.

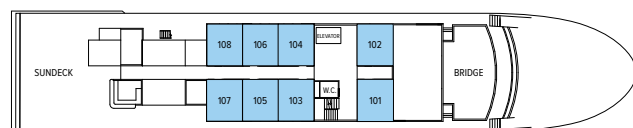

OBSERVATION DECK

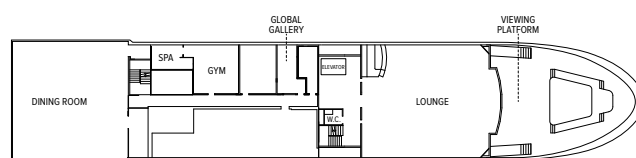

LOUNGE DECK



UPPER DECK

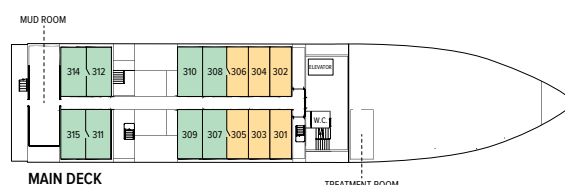

MAIN DECK





Left to right: Captain Cook raises a glass; *National Geographic Venture*; our lounge is the hub of the expedition community; viewing platform; Category 5 cabin; Category 4 cabin with lower single beds (which can be converted to a Queen) and a private step-out balcony. Select cabins connect via an inside doorway.

**CATEGORY 1:** Main Deck #301-306 Cabins feature two lower single beds that can convert to a Queen, a writing desk, and two portholes.

**CATEGORY 2:** Main Deck #307-315 Cabins feature two lower single beds that can convert to a Queen, a writing desk, and two portholes.

**CATEGORY 3:** Upper Deck #201-206 Cabins feature two lower single beds that can convert to a Queen, a writing desk, and two large view windows.

**CATEGORY 4:** Upper Deck #207-229 Cabins feature two lower single beds that can convert to a Queen, a writing desk, sliding glass door, and small, private balcony.

**CATEGORY 5 (SUITE):** Observation Deck #101-108 Cabins feature two lower single beds that can convert to a Queen, large view windows, an expanded bathroom, writing desk, ample storage space, and a convertible sofa bed to accommodate a third person.

**NOTE:** Solo Occupancy cabins are available in Categories 1 and 2 only. Third person rates are available in Category 5 cabins at one half the double occupancy rate.

**Connecting Cabins via internal doorway access:** Main Deck: #312-314, #311-315, #306-308, #305-307; Upper Deck: #224-226, #225-227

Prices are per person, double occupancy unless indicated as solo.

ITINERARY	YEAR	CAT. 1	CAT. 2	CAT. 3	CAT. 4	CAT. 5 SUITE	CAT. 1 SOLO	CAT. 2 SOLO	ADVANCE PAYMENT	NOTE
<b>Baja California and the Sea of Cortez: Among The Great Whales – Page 16</b>	2021	\$6,270	\$6,990	\$7,570	\$8,350	\$9,270	\$9,550	\$10,400	\$750	Sample Airfares: Round-trip Los Angeles/Loreto: Economy from \$650; Business from \$1,140.
<b>Exploring the Sea of Cortez: A Living Sea &amp; Desert Isles – Page 18</b>	2021	\$6,690	\$7,350	\$7,850	\$8,690	\$9,590	\$9,990	\$10,950	\$750	Sample Airfares: Round-trip Los Angeles/Loreto: Economy from \$475; Business from \$1,140.
<b>Exploring the Sea of Cortez: A Living Sea &amp; Desert Isles – Holiday Departures – Page 18</b>	2020	\$6,690	\$7,350	\$7,850	\$8,690	\$9,590	\$9,990	\$10,950	\$750	Sample Airfares: Round-trip Los Angeles/Loreto: Economy from \$475; Business from \$1,140.
	2021	\$6,890	\$7,570	\$8,090	\$8,950	\$9,880	\$10,290	\$11,280		
<b>Baja California: A Remarkable Journey – Page 20</b>	2021	\$11,650	\$12,890	\$13,760	\$15,350	\$16,890	\$17,450	\$19,290	\$1,500	Sample Airfares: Round-trip Los Angeles/Loreto: Economy from \$650; Business from \$1,140.
<b>Wild Baja Escape: Serenity &amp; Sea Life in the Sea of Cortez – Page 26</b>	2020/21	\$2,880	\$3,560	\$4,190	\$4,590	\$4,990	\$4,100	\$5,200	\$750	Sample Airfares: Round-trip Los Angeles/Los Cabos: Economy from \$475; Business from \$1,140.

Prices quoted in this brochure are valid as of the time of printing, are subject to modification, and are not guaranteed until booking and required deposit are made. For current rates and details visit [expeditions.com](http://expeditions.com) for the most up-to-date pricing. For best pricing book early.

# TAKE ADVANTAGE OF OUR SPECIAL OFFERS

**\$350 AIRFARE CREDIT & SOLO TRAVELER SAVINGS:** Book by Jul. 31, 2020 to receive a \$350 air credit per person on the Nov. 30, 2020 departure of *From Southern California to Baja: Sailing the Pacific Coast*. Plus, we have waived the solo premium on solo cabins on the 2020 departure. Valid for new bookings only, subject to availability, and may not be combined with other offers, or extensions. Call for details.

**GET THE GROUP ON BOARD: SAVE 10%** When you gather a group of 6 or more under one booking, you make memories together and save 10% on the voyage total— valid on *Wild Baja Escape: Serenity & Sea Life in the Sea of Cortez* and *Wild Baja Escape: The Whales of Magdalena Bay* departures when you book by Jul. 31, 2020.

**OR SAVE 5%** when traveling as a group of 8 or more people on all other departures. Take advantage of these great savings, while enjoying traveling with your friends and family. This savings is applicable on voyage fares only, and not on extensions or airfare. Deposit, final payment, and cancellation policies for group travel vary from our regular policies.



**BRINGING THE KIDS:** We believe sharing an expedition with your kids or grandkids is a life-enhancing experience. So take \$500 off for each child under the age of 18.

## INCLUSIVE PRICING

We include just about everything you have the opportunity to do as part of your expedition aboard ship and ashore. The only things not included are those of a personal nature—alcohol, internet usage, tips to the crew, wellness treatments and other specialized arrangements.

### ABOARD SHIP

- ✓ All meals and non-alcoholic beverages
- ✓ Cappuccinos, lattes & complimentary environmentally friendly refillable water bottle
- ✓ 24-hour coffee, tea & soda on demand
- ✓ Hors d'oeuvres & snacks during lounge recap
- ✓ Fitness center
- ✓ Fully stocked library
- ✓ The guidance and company of our expedition staff
- ✓ On-board physician

### ASHORE

- ✓ Meals on land, as indicated in itinerary
- ✓ Special access permits, park fees, port taxes
- ✓ Transfers to and from group flights
- ✓ The expertise of our expedition staff

### ACTIVITIES

- ✓ All excursions
- ✓ Zodiac & kayak explorations
- ✓ Snorkeling and paddleboarding
- ✓ Lectures & presentations in the lounge
- ✓ Morning stretch classes with wellness specialist



## BE PART OF OUR EXPEDITION COMMUNITY

Join in! Here's how:

- ✓ Check our daily blog for interesting posts, video clips and Photos of The Week: [expeditions.com/blog](https://expeditions.com/blog)
- ✓ Like us on Facebook: hear what our travelers have to say, get inspired and chime in: [facebook.com/LindbladExpeditions](https://facebook.com/LindbladExpeditions)
- ✓ Preview an expedition before you go or subscribe to our videos on [youtube.com/lindbladexpeditions](https://youtube.com/lindbladexpeditions)
- ✓ Follow us [@LindbladExp](https://twitter.com/LindbladExp) and our founder, Sven Lindblad [@SvenLEX](https://twitter.com/SvenLEX), on Twitter; and on Instagram [@SOLindblad](https://www.instagram.com/SOLindblad) for his interesting view of the world.
- ✓ Check out Expedition Snapshots from guests—and upload your own on the [expeditions.com](https://expeditions.com) homepage.



## PHOTOGRAPHERS, THIS ONE'S FOR YOU— BAJA CALIFORNIA: A REMARKABLE JOURNEY

Whether you're a beginner or advanced, smartphone or DSLR user, grab the chance to improve your skills on an itinerary designed by and for photo enthusiasts. It's *Baja California: A Remarkable Journey*; details and the National Geographic photographers on board on pages 8-9.

### RESERVATION INFORMATION

**Terms & Conditions:** For complete terms and conditions please visit [expeditions.com/terms](http://expeditions.com/terms)

**Pricing:** For best pricing book early. Prices quoted in this brochure are valid as of the time of printing, are subject to modification, and are not guaranteed until booking and required deposit is made. Under normal conditions, the total expedition price is guaranteed at the time of booking. However, our expedition pricing is determined far in advance of initial departure on the basis of then-existing projections of fuel and other costs. In the event of increases in those costs including, but not limited to, increases in the price of fuel, currency fluctuations, increases in government taxes or levies, or increased security costs, we reserve the right to adjust the price of your expedition or add a surcharge to cover such unexpected increases. We will always provide an explanation of the reason for increase in pricing. Visit [expeditions.com](http://expeditions.com) or call for the most up-to-date pricing.

**Pricing Includes:** All accommodations aboard ship or in hotels per itinerary or similar; all meals and nonalcoholic beverages aboard ship; meals on land as indicated, accompanied by nonalcoholic beverages; air transportation where indicated as included; shore excursions; sightseeing and entrance fees; special access permits; transfers to and from group flights; use of snorkeling equipment and wetsuits (where applicable); use of kayaks and/or stand-up paddleboards (where available); use of cross-country skis or snowshoes (where available); tips (except to ship's crew); taxes and service charges; services of a ship physician and services of our expedition staff. Unused services or items included in our programs are non-refundable.

**Not Included:** Air transportation (except where specified as included), extensions, passport, visa, immigration fees, meals not indicated, travel protection plan, items of a personal nature, such as internet access, voyage chronicle, and laundry.

**Airfare:** For all programs, airfare is an additional cost unless otherwise indicated. We will gladly assist in making your air arrangements for a \$50 per person service fee.

**Reservations:** Final payment is required at the time of reservation. Receipt of advance payment indicates your acceptance of the terms and conditions. Visit [expeditions.com/terms](http://expeditions.com/terms) for complete details.

**Final Payment:** For expeditions aboard all ships final payment is due in full 90 days prior to departure. Payment schedules may vary for certain longer voyages due to high demand for these voyages. We reserve the right to cancel your reservation if payment has not been received by final payment due date.

**Travel Protection Plan:** We strongly recommend that you take advantage of our Travel Protection Plan. This plan offers comprehensive coverage to protect you from cancellation fees, costs incurred due to trip delays/interruption, medical

assistance, and damaged or lost baggage, and provides medical assistance and evacuation during your travels. Our Travel Protection Plan is available for U.S. residents only, and may be purchased any time prior to final payment due date. If you are not satisfied for any reason, you may return your plan within 10 days after purchase. Your premium will be refunded if canceled within 10 days, provided you have not already departed on the trip or filed a claim. When so returned, the coverage under the plan is void from the original date of purchase.

**Responsibility and Other Terms & Conditions:** Certain provisions concerning, among other things, limitations of Lindblad Expeditions' and the National Geographic Expeditions' (a division of National Geographic Partners, LLC) liability for loss of property, injury, illness, or death during the voyage will be provided to all guests on the ship's ticket sent prior to departure, and are also available on our website at [expeditions.com/terms](http://expeditions.com/terms), or upon request. By registering for a trip, the guest agrees to all such terms and conditions.

**Note:** Itineraries and prices listed in this brochure are as of publication date and are subject to change.

**Smoking and Vaping Policy:** Smoking and Vaping are allowed only in designated outdoor areas.

**Cancellation Policy:** Cancellation penalties may apply after payment is received. Please visit [expeditions.com/terms](http://expeditions.com/terms) for complete cancellation policies.

©2020 Lindblad Expeditions

Lindblad Expeditions and the Eye are the trademarks of Lindblad Expeditions. All rights reserved.

NATIONAL GEOGRAPHIC and the Yellow Border are the trademarks of the National Geographic Society. All rights reserved.

Photo Credits: Tom Bean/Alamy, Alexandra C. Daley-Clark, Stewart Cohen, Sarah Culler, Rab Cummings, Jennifer Davidson, Bennett Goldberg, Ralph Lee Hopkins, Rich Kirchner, Liz Leyden, Jeremy Lindblad, Jeff Litton, Emily Mount, Carlos J. Navarro, Sean Neilson, Michael S. Nolan, Ryder Redfield, Rich Reid, Marco Ricca, Susan Seubert, Jack Swenson, Rikki Swenson, David Vargas.

**For Reservations:**  
Contact your travel advisor or Lindblad Expeditions  
**1.800.EXPEDITION (1.800.397.3348)**

**Reservation Hours: Monday – Friday 9am – 9pm ET  
Saturday & Sunday 10am – 5pm ET**

**Lindblad Expeditions, Inc., 96 Morton Street, New York, NY 10014**

**Phone: 212.261.9000 • Fax: 212.265.3770**

**For additional information and online reservations,  
visit us on the Web: [www.expeditions.com](http://www.expeditions.com)**

Account Number:

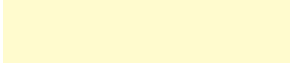

1.800.EXPEDITION | WWW.EXPEDITIONS.COM

♻️ Printed on 10% recycled content paper with soy-based inks. We recommend that you pass this along for others to enjoy or recycle.

BAJ-030



DISCOVER REMOTE  
WILDNESS CLOSE TO  
HOME IN WINTER 2021