

# BAJA & THE SEA OF CORTEZ

FULL EXPEDITIONS  
OR QUICK ESCAPES

**NEW!** WHALE SHARK &  
BLUE WHALE ADVENTURES

SPECIAL AIR &  
GROUP SAVINGS—  
DETAILS INSIDE



Loreto Bay, SEA OF CORTEZ  
25.79° N, 111.07° W

# THE FIST-PUMPING, PULSE-RACING HIGH YOU GET FROM SPORTS, WITHOUT BEING ON THE SIDELINES

You know the charge you get when you come upon something wild and unexpected, something rare and beautiful? We live for those moments. We sail to the ends of the earth to find them, to discover them anew, and conjure them for you.

**THAT'S THE EXHILARATION OF DISCOVERY**



*Cover: Gray whale © Michael S. Nolan. Above: Leaping bottlenose dolphin © Ralph Lee Hopkins.*

## TABLE OF CONTENTS

- 2** Where Awesome Is
- 4** Culture on the Coast
- 6** Our Ships
- 8** Meet the Experts
- 9** National Geographic Photography
- 10** Sailing the Pacific Coast
- 12** Among the Great Whales
- 14** Remarkable Journey
- 16** Whales & Wildness
- 18** Wild Escapes
- 20** Whales of Magdalena Bay
- 22** Serenity in the Sea of Cortez
- 24** Extensions
- 25** *National Geographic Sea Lion*
- 26** *National Geographic Venture*
- 28** Special Offers
- 29** Reservation Information





THE WILDNESS, WILDLIFE &  
BEAUTY OF BAJA CALIFORNIA





**WHEN MOST PEOPLE THINK OF BAJA, THEY THINK OF THE** California grays which migrate yearly to the calving lagoons on the west side of the peninsula, with which we experience joyful encounters. But in our nearly 40 years exploring the Sea of Cortez, our teams have reported astonishing variety too, including pygmy sperm and false killer whales; the largest and second largest of the whales—blue whales and fin whales; plus Bryde’s and sperm whales, and thousands of common, bottlenose, and spinner dolphins.

The desert islands in the Sea of Cortez are dotted with giant cardon cacti that beckon like emphatic greeters, urging us to explore their exotic landscape. There are forests of giant cacti here, with crenate ribs and ranks of star-bursting spires to guard the most precious desert commodity—moisture. In spring they bloom in bright colors and rarified scents. And the Channel Islands between California and Baja offer awe-inspiring adventure, with over 2,000 species of plants and animals—a true wildlife spectacle spread across the sea from Santa Barbara to L.A.’s San Pedro neighborhood yet known to few.

Our Baja team reveals the wildlife, unravels the desert’s vast biological mysteries for you, and guides you over and under the surface to experience the wonders of this pristine nexus where the desert meets the sea.



“ **This morning we awoke just north of the islands of Los Islotes. Among the rocks that jut out from the water, we find the local cabal of California sea lions, brown pelicans, blue-footed boobies, various cormorants, and even peregrine falcons. At Isla San Francisco, we went hiking, kayaking, stand-up paddleboarding, snorkeling, and swimming off this beautiful island. As the sun set, we prepped for a Baja-style BBQ on the beach. Faces alight from the orange and red glow off the horizon, we ate, drank, and laughed about what will remain an unforgettable journey in an unforgettable land.**”

— KAYVON MALEK  
Undersea Specialist  
Daily Expedition Report, Baja



## EXPERIENCE BAJA IN FULL: LOVELY LORETO & LIVELY LA PAZ\*

THE BAJA PENINSULA, STRETCHING 775 MILES INTO THE PACIFIC, has more coastline than its northern neighbor. Exploring it is a form of time travel, revealing an earlier California, before development backed sovereign wildness into a corner.

And, if towering cacti are the citizens of Baja's desert isles, the quintessential towns we visit introduce us to the Peninsula's citizenry and human history. Most of our expeditions now either begin or end in the charming town of Loreto, spectacularly sited, backed by the Sierra de la Giganta mountain range. Downtown Loreto contains the Loreto Mission, the first mission in Baja California. The Jesuits were active here in the late 17th century/early 18th century. And the simple, lovely Loreto Museum, containing a collection of artifacts from the Spanish colonial period, illuminates the region's history.

The lively port town of La Paz invites you to follow your curiosity—into the discoveries that strolling in an intriguing town with a maze of quaint streets always yields. By day the promenade is sun-struck and beach vibe-y, the perfect place to wander among the acclaimed public sculptures and eco-travelers heading to the Sea of Cortez, Cabo Pulmo, and more, aboard yachts and day boats. By night, the promenade glows with lights, strolling couples and families, vendors selling all manner of souvenirs and curiosities, from crafts to vivid and entertaining velvet Elvis paintings. You'll have the chance to explore even more of La Paz and Loreto on **optional extensions, featured on page 24.**

*\*Note: Destinations and activities may vary and are not included on all Baja itineraries. Please see full day-by-days or call for details.*

# THE PERFECT MOBILE BASE CAMP FOR EXPLORING

**WITH GENEROUS DECKS THAT TAKE FULL ADVANTAGE OF** the sun and ocean breezes, and create front row seats on the remarkable spectacle of marine life in Baja, our brand-new expedition ship *National Geographic Venture* is uniquely designed to make the most of being in this remote, soul-satisfying geography. Because there is much to discover here—cactus forests, desert islands, beautifully indented shores, a calm sea with vivid life beneath the surface, and more, *National Geographic Venture* is equipped so you can explore—a fleet of Zodiacs, kayaks, paddleboards, plus snorkeling gear for all and hydrophones for whale listening. In addition, an undersea specialist/videographer captures video for you to enjoy in the comfort of the ship's lounge. And a Lindblad-National Geographic certified photo instructor is aboard to help you capture the moments at the heart of your experience.

▶ See our NEW ship, *National Geographic Venture* [expeditions.com/Venture](https://expeditions.com/Venture)

“We are thrilled with our brand-new sister ships, *National Geographic Quest* and *National Geographic Venture*, designed to give a complement of 100 guests the same intimate, inclusive experience the 62-guest *National Geographic Sea Bird* and *National Geographic Sea Lion* (below) have provided for 35 years. They've introduced a generation to Alaska, Baja, British Columbia, the San Juan Islands and more—and to the profound joys of up-close, personal exploring with expert naturalists, and a collegial expedition community.”

— SVEN-OLOF LINDBLAD  
CEO & Founder





## OUR SHIPS



# DOING WHATEVER IT TAKES TO MAKE YOUR EXPERIENCE EXTRAORDINARY

WHETHER IT MEANS STAYING UP UNTIL THE WEE HOURS TO SCAN FOR passing whales of uncommon species so you won't miss out on rare sightings, taking advantage of an opportunity to snap photos of a pod of leaping dolphins, or holding an impromptu stargazing, our team is dedicated to revealing Baja and making sure your experience is exceptional. Benefit from the personalities and knowledge of an expedition leader, naturalists, an undersea specialist, a Lindblad-National Geographic certified photo instructor, and a video chronicler, plus a wellness specialist to enhance the revitalizing effects of life in the Sea of Cortez.

▶ Learn more at [expeditions.com/expertbios](https://expeditions.com/expertbios) for full bios on our staff



*Representing our expert team for the 2019/20 season, clockwise from left: Carlos Navarro, undersea specialist; James Hyde, naturalist; Annie Fiske, expedition leader; Paul North, undersea specialist; Stella Bohnert, assistant expedition leader.*



## IN A LAND WITH PERFECT LIGHT, BENEFIT FROM EXPEDITION PHOTOGRAPHY

### MAKE THE MOST OF THE UNRIVALED PHOTO OPS OF BAJA

California's wild islands, whales, dolphins, pelicans, and sea birds with our Expedition Photography program. Every expedition features



a Lindblad Expeditions-National Geographic certified photo instructor who offers assistance,

instructions and shooting tips in the field. Their expertise will inspire you and help you improve your skills—no matter your current skill or interest level—and ensure you return home with incredible photos.

### Exclusive Onboard Gear Locker

Dive into the onboard B&H Photo Video Gear



Locker to field test new glass, camera bodies, and more—free. Plus, ask your Expedition Specialist about pre-voyage discounts and benefits.



# FROM SOUTHERN CALIFORNIA TO BAJA: SAILING THE PACIFIC COAST

**12 DAYS/11 NIGHTS—ABOARD NATIONAL GEOGRAPHIC VENTURE**  
PRICING FROM \$9,390 (See pages 26-27 for details.)

Enter a time machine: see the SoCal coast as it is and as it was, while making time-warping discoveries. Depart Los Angeles's bustling port for the nearby Channel Islands to witness intact wildness, complete with thriving endemic species, mere nautical miles from a sprawling megalopolis. Making our way south we encounter world-class food and wine, and lessons in sustainability. Scour the horizon for migrating whales and birds. And enjoy daily morning stretch classes on deck as we slip back into the era of historic missions punctuating desert landscapes where ancient cacti stand sentinel. Count on your entire expedition team to do whatever it takes to ensure you an unforgettable voyage.

## EXPEDITION HIGHLIGHTS

- ▶ Discover one of the nation's best-kept secrets, Channel Islands National Park.
- ▶ See why everyone is talking about the vineyards of Valle de Guadalupe.
- ▶ Learn about the region's industry with a private tour of the world's largest salt mine in Guerrero Negro; and meet the fishermen of Isla Natividad's model fishing co-op.
- ▶ Explore the ever-shifting sand dunes of Isla Magdalena and count the 40 species of birds inhabiting this area.
- ▶ Snorkel in Cabo Pulmo National Marine Park, the only hard coral reef in North America; featuring over 220 species of fish.

## EXPERIENCE & EXPERTISE



Our experienced team aboard the *National Geographic Venture* is key to an in-depth experience. An expedition leader, naturalists, a Lindblad-National Geographic certified photo instructor and undersea specialist, plus a wellness specialist and video chronicler, all contribute to your understanding of the Pacific Coast wonders. Select departures will feature a National Geographic photographer or expert.

*Visit our website to read staff bios for this expedition.*

*Torrey pine on Santa Rosa Island, Channel Islands National Park.*

**DEC. 12: LOS ANGELES/EMBARK**

Arrive in Los Angeles, where you'll embark the *National Geographic Venture*. (D)

**DEC. 13: CHANNEL ISLANDS NATIONAL PARK**

Home to diverse, endemic flora and fauna; with more than 600 plant species, 140 birds and 11 land mammal species, there is plenty to see in Channel Islands National Park. (B,L,D)

**DEC. 14: ENSENADA AND THE VALLE DE GUADALUPE**

Vineyards and culinary marvels await as we explore one of the world's hottest up-and-coming wine regions, the Valle de Guadalupe. See what the hype is all about as we visit a family-run vineyard for a private tour, tasting, and lunch. (B,L,D)

**DEC. 15: SAN QUINTÍN EXPLORATION**

A day exploring in the Bahía de San Quintín and surrounding islands—home to 400+ species, including 23 sea birds. (B,L,D)

**DEC. 16: OJO DE LIEBRE LAGOON/ GUERRERO NEGRO**

In the morning explore the colorful Ojo de Liebre Lagoon. Next, tour the world's largest salt works, producing seven million tons of salt each year. Learn more about this community's efforts as it works to balance this booming industry with the fragile environment that surrounds. (B,L,D)

**DEC. 17: ISLAS SAN BENITO/ISLA NATIVIDAD**

Awake to the beauty of the Islas San Benito,

home to hundreds of breeding elephant seals. Spend the morning ashore marveling at these magnificent creatures, then sail to Isla Natividad, a model community for sustainability. Their exemplary protection of the land and surrounding Vizcaino Biosphere is admired and will be imitated by other communities. Meet with residents of Isla Natividad when they come aboard to share their story. (B,L,D)

**DEC. 18: AT SEA**

As we travel south along the Pacific coast of the peninsula, there is a chance of seeing a wide variety of marine life, including the largest animal on Earth, the blue whale. Hear naturalist talks, and learn photography tips and tricks during this day at sea. (B,L,D)

**DEC. 19: BAHÍA MAGDALENA**

Explore the ever-shifting sand dunes of Isla Magdalena, on a cross-island walk to one of the most pristine beaches in the Pacific. Birders take note: It's not unusual to see as many as forty species of birds in a single day along these fertile shorelines. (B,L,D)

**DEC. 20: LOS CABOS AND GORDA BANKS**

Cruise past Friars Rocks and visit the historic town center of San José del Cabo before cruising Gorda Banks seamount or La Fortuna, renowned gathering places for whales, dolphins, and other marine life. (B,L,D)

**DEC. 21 AND 22: CABO PULMO/ LOS ISLOTES**

Snorkel the pristine reefs of Cabo Pulmo



National Park and chat with locals about their advocacy to protect this unique place. With luck, swim with curious sea lions at Los Islotes before relaxing ashore. Swim, kayak, or hike on a nearby uninhabited island and end the day with a beach barbeque, bonfire, and star-filled sky. (B,L,D)

**DEC. 23: LA PAZ/DISEMBARK/ SAN JOSÉ DEL CABO**

Disembark in La Paz and transfer to Los Cabos airport for flights home. (B)

**EXPEDITION DETAILS**

**DATE:** 2019 Dec. 12

**SPECIAL OFFER**

Book by **Aug. 31, 2019** and receive a **\$350 AIR CREDIT** per person. See page 28 or call for details.

**NATIONAL GEOGRAPHIC EXPERT**

Marine biologist and filmmaker **Greg Marshall** will join the Dec. 12, 2019 departure.

**NEW! SWIM WITH WHALE SHARKS**

Enhance your experience with this thrilling two-night extension. See page 24.

See what it's like! Watch the video at [expeditions.com/pac-coast](http://expeditions.com/pac-coast)



# BAJA CALIFORNIA & THE SEA OF CORTEZ: AMONG THE GREAT WHALES

**8 DAYS/7 NIGHTS—ABOARD NATIONAL GEOGRAPHIC VENTURE**

PRICING FROM \$5,990 (See pages 26-27 for details.)

Seeing gray whales in their natural habitat is one of the great delights of this voyage, as you venture out in small boats among these magnificent creatures. In the Sea of Cortez, search for a variety of whales, plus dolphins, blue-footed boobies, pelicans, cormorants, and magnificent frigatebirds. You'll also snorkel among sea lions, join naturalists on hikes amid barrel cacti and sculpted sand dunes, and see a variety of desert flora and fauna.

## EXPEDITION HIGHLIGHTS

- ▶ Explore the breeding grounds of gray whales and observe their calves on an intimate close-up encounter.
- ▶ Go snorkeling amid sea lions, brilliant blue damselfish, and schools of king angelfish.
- ▶ Kayak clear blue waters on the lookout for a variety of bird species including magnificent frigatebirds.
- ▶ Explore diverse landscapes, including sand dunes, a cactus forest, and deserted islands.

## EXPERIENCE & EXPERTISE



Our expert expedition team will illuminate the wonders of Baja California and the Sea of Cortez from every possible angle. Your expedition leader, undersea specialist, Lindblad-National Geographic certified photo instructor and naturalists, plus a wellness specialist and video chronicler, are dedicated to ensuring an incredible voyage. Certain departures feature a National Geographic photographer or expert.

*Visit our website to read staff bios for this expedition.*

*Gray whale, Magdalena Bay.*

**DAY 1: LORETO/SAN CARLOS/EMBARK**  
Upon arrival in Loreto, transfer to San Carlos and embark *National Geographic Venture*. Tonight, we'll anchor off the coast of Isla Santa Margarita. (D)

**DAY 2: BAHÍA ALMEJAS/REHUSA CHANNEL/ISLA MAGDALENA**  
Awake anchored in Bahía Almejas, the southernmost part of the Bay. We'll stop at a large frigatebird colony enroute to the spectacular whale grounds of Bahía Almejas. Whales here tend to be very active, seemingly oblivious to our presence so settle in for some great experiences. During lunch, the ship will reposition to Isla Magdalena where we'll explore the ever-shifting sand dunes on a cross-island walk to one of the most pristine beaches in the Pacific. Bird-watching can be excellent along these fertile shorelines.

**DAY 3: BOCA DE SOLEDAD**  
Each winter, gray whales travel south from their Arctic feeding grounds to breed, give birth, and raise their calves in these sheltered waters. We'll spend the full day interacting with these majestic creatures. Together with savvy local Mexican fishermen we've known for years, we'll venture out in Zodiacs to view the numerous mother-calf pairs thriving here. Bird-watching can be excellent here and we will likely encounter a variety of shorebirds feeding voraciously on the shoreline while frigatebirds and pelicans soar overhead. (B,L,D)

**DAY 4: THE HULL CANAL & CRUISING**  
Kickstart your morning with morning stretch hosted by our onboard wellness specialist on

the sundeck. After breakfast, we'll explore the vast mangrove system via kayak, stand-up paddleboard, and Zodiac, and learn how these massive ecosystems support their surroundings. This afternoon, we'll sail out through "La Entrada" as we leave Magdalena Bay behind. Traveling south along the coast of the peninsula, there is a chance of seeing a wide variety of marine life, including the largest animal on Earth, the blue whale. Hear naturalist talks and learn photography basics. (B,L,D)

**DAY 5: GORDA BANKS/CABO PULMO**  
Ease into the day with a majestic sunrise over the iconic Friars Rocks at Land's End. We'll spend the rest of the morning searching the seas of Gorda Banks seamount, a renowned gathering place for whales, especially humpbacks, dolphins, and other sea life. Following lunch, we'll set out to snorkel the pristine reefs of Cabo Pulmo National Marine Park, one of the most successful national marine parks in the world, and chat with locals about their advocacy to protect this unique place. (B,L,D)

**DAY 6: LOS ISLOTES AND LA PAZ**  
Awake this morning off the rocky island of Los Islotes, where we'll don flippers, a mask, and snorkel (which we provide) and swim with curious sea lions. Then we'll reposition to the colorful city of La Paz to garner insight into the culture of Mexico, soak in the vibrant street art, and stroll the lively "Malecon" on a guided walking tour. Dinner will be an unforgettable cultural experience, complete with local cuisine, dancing, and folklore. (B,L,D)



**DAY 7: EXPLORING THE SEA OF CORTEZ**

Our plan is flexible as we explore some of the sea's many uninhabited islands. Our Captain and Expedition Leader will choose the perfect combination of activities for the day. We may go ashore at Isla San Francisco, where a sweeping arc of white sand beach beckons you to kayak or stand-up paddleboard. Or, hike to the nearby ridge for unparalleled views over Isla Danzante with your naturalist. You may also visit the abandoned salt works on Isla Carmen. You'll get a chance to see the great diversity offered in the Sea of Cortez, and with some luck, spot the amazing wildlife. (B,L,D)

**DAY 8: LORETO/DISEMBARK**  
Disembark in Loreto after breakfast and transfer to the city center. Visit the first mission in Baja California and the nearby museum to learn more about what makes this town so special. Enjoy free time to explore the quaint shops and vibrant side streets. After lunch, transfer to Loreto Airport for flights home. (B,L)

## EXPEDITION DETAILS

**DATES:** 2020 Jan 11\*, 18, 25\*; Feb. 1, 8\*, 15, 22\*, 29; Mar. 7\*

\*These departures travel in reverse.

Note: The exact order of stops may vary in order to maximize your experience.

## NATIONAL GEOGRAPHIC EXPERT

Marine biologist and filmmaker **Tierney Thys** will join the Jan. 11, 2020 departure.

## NEW! LORETO POST-EXTENSION

Further your exploration of this charming and richly varied region with this exciting two-night extension. See page 24.



*Leaping bottlenose dolphin in the Sea of Cortez, Baja California.*

# BAJA CALIFORNIA: A REMARKABLE JOURNEY

**15 DAYS/14 NIGHTS—ABOARD NATIONAL GEOGRAPHIC VENTURE**  
PRICING FROM \$11,530 (See pages 26-27 for details.)

Embark on a comprehensive photo expedition that explores both the Pacific side of Baja California and the islands in the Sea of Cortez. Venture into the gray whale lagoons for up-close encounters, and then spend ample time exploring the Sea of Cortez and all its marine mammals. See scores of blue-footed boobies and pelicans, kayak into quiet grottos, and visit charming seaside towns.

## EXPEDITION HIGHLIGHTS

- ▶ Get up-close views of gray whale mothers and their growing calves as they prepare for their journey back to Arctic feeding grounds.
- ▶ Kayak clear blue waters to search for wildlife, including magnificent frigatebirds, and an opportunity for investigating the intricacies of the shoreline by kayak.
- ▶ Snorkel the living sea: observe large schools of vibrantly colored fish, swim among playful sea lions, and much more.
- ▶ With more time for adventure, rely on your expedition leader to take you where wildlife will be at its best—including the remote oceanic island of San Pedro Mártir with clouds of nesting seabirds and crowds of sea lions onshore, and expanses of sea where huge pods of dolphins gather.

## EXPERIENCE & EXPERTISE

**35+**  
**YEARS**  
EXPERIENCE

Our expert 10-person expedition team will illuminate the wonders of Baja & the Sea of Cortez from every possible angle. Your expedition leader, undersea specialist, three Lindblad-National Geographic certified photo instructors and naturalists, plus a wellness specialist and video chronicler, are dedicated to ensuring an incredible voyage. A National Geographic photographer is on board to provide guidance and instruction throughout your voyage.

*Visit our website to read staff bios for this expedition.*

*Kayaking the calm water  
in the Sea of Cortez.*



**DAY 1: LORETO/SAN CARLOS/ DISEMBARK**

Upon arrival in Loreto, transfer to San Carlos and embark the *National Geographic Venture*. (D)

**DAY 2: BAHÍA MAGDALENA**

Explore the ever-shifting sand dunes of Isla Magdalena, on a cross-island walk to one of the most pristine beaches in the Pacific. Bird-watching here can be excellent—magnificent frigatebirds, pelicans, cormorants, terns, great blue herons, ibis, whimbrels, and willets are among the species we might see. It's not unusual to see forty species of birds in just one day along these fertile shorelines where they refuel for their destinations ahead. (B,L,D)



Gray whale, Laguna San Ignacio.

**DAY 3 AND 4: LAGUNA SAN IGNACIO**

Laguna San Ignacio is a large bay and favored haunt of the gray whales in Baja. The ship will anchor at the mouth of this remote and important locale, while we observe the mother and calf pairs in our Zodiacs and local pangas. For some reason, the whales here seem to be friendlier than they are elsewhere. It's not unusual for mothers and calves to approach our boats, the calves often playing hide and seek—sometimes even welcoming a touch or a friendly chin scratch. (B,L,D)

**DAY 5: AT SEA**

As we travel south along the Pacific coast of the peninsula, there is a chance of seeing a wide variety of marine life, including the largest animal on Earth, the blue whale. (B,L,D)

**DAYS 6–14: ISLANDS OF THE SEA OF CORTEZ**

Cruise past the spectacular Friars Rocks at Land's End. For those who wish, we will arrange



Common dolphin.

a visit to the historic town center of San José del Cabo. Isla San Pedro Mártir, Los Islotes, Isla San Francisco—these are some of the melodious names of islands scattered throughout this beautiful sea. After over 20 years of exploration here, we are still discovering new places and experiencing exciting events: bow-riding bottlenose dolphins, or sperm whales near our ship; a pod of fin whales feeding around a convergence zone. The best areas for whale watching remain consistent—the waters south of Isla Carmen, Canal de Ballenas up north, and near the mouth of Bahía Concepción. Whether on the bridge of the ship, on Zodiacs, or kayaks, we will be in prime position to observe them all. (B,L,D)

**DAY 15: LORETO/DISEMBARK**

Disembark in Loreto after breakfast and transfer to the city center. You'll have the opportunity to visit the first mission in Baja California, as well as the nearby museum to learn more about what makes this town so special. Enjoy free time to explore quaint shops and vibrant side streets. After lunch, transfer to Loreto Airport for flights home. (B,L)



**EXPEDITION DETAILS**

**DATES:** 2020 Mar. 16\* 📷 30 📷

📷 Photo Expedition

\*This departure travels in reverse.

**NATIONAL GEOGRAPHIC PHOTOGRAPHER**

Jonathan Kingston's (right) work has appeared in *National Geographic*, *The New York Times*, *The New Yorker*, and *The Wall Street Journal*. Join him on the Mar. 16 departure. Michael Melford (left)



is an award-winning photographer who has produced more than 50 stories for *National Geographic* and *National Geographic Traveler* magazines over the past 30 years. He will be on board the Mar. 30 departure. Read their bios and find more experts at [expeditions.com/photo](http://expeditions.com/photo)



Guests photographing at sunrise.

# WHALES & WILDNESS: SPRING IN THE SEA OF CORTEZ

**8 DAYS/7 NIGHTS—ABOARD NATIONAL GEOGRAPHIC VENTURE**

PRICING FROM \$6,570 (See pages 26-27 for details.)

Watch whales and dolphins from the deck of our intimate, 50-cabin expedition ship, and at water level from nimble Zodiacs. Spring in the Sea of Cortez can be a great time to see large pods of dolphins and various species of whales—blue, sperm, pilot, or fin—all in the same week. Hike uninhabited beaches and desert landscapes. Observe myriad seabirds. Kayak in pristine waters, snorkel among reef fish, and enjoy the serenity of a sunset beach barbecue under a starry sky. This unique journey is designed with a flexible itinerary, with our staff choosing sites based on conditions and to maximize wildlife sightings, adding a stimulating sense of adventure to each day.

## EXPEDITION HIGHLIGHTS

- ▶ Only one departure per season!
- ▶ Search for pods of dolphins and various species of whales: blue, fin, sperm, humpback, pilot, or Bryde's.
- ▶ Choose to stand-up paddleboard, kayak, swim, and snorkel with sea lions or hike the diverse desert landscapes.

## EXPERIENCE & EXPERTISE

**35+**  
**YEARS**  
EXPERIENCE

Our 10-person team aboard *National Geographic Venture* will illuminate the wonders of the Sea of Cortez

from every possible angle. Your expedition leader, undersea specialist, Lindblad-National Geographic certified photo instructor and naturalists, plus a wellness specialist and video chronicler, are dedicated to ensuring an incredible voyage.

*Visit our website to read staff bios for this expedition.*

*California sea lions basking in the sun.*

**APR. 13: LORETO/EMBARK**

Arrive in Loreto and embark *National Geographic Venture*. (D)

**APR. 14–19: EXPLORING THE SEA OF CORTEZ**

Our routing is designed with flexibility in mind, to maximize opportunities for wildlife sightings. It will most likely include the islands and activities listed below, although the order may vary. (B,L,D)

**ISLAS SAN ESTEBAN AND SAN PEDRO MÁRTIR:**

Walk up a desert wash to search for desert birds and the endemic pinto chuckwalla—a plump, harmless desert lizard. Later visit Isla San Pedro Mártir, a 1,000-foot-high guano-covered island that is home to thousands of seabirds: brown pelicans, magnificent frigatebirds, Brandt’s cormorants, and California sea lions.

**ISLA SAN MARCOS:**

At Isla San Marcos, there is a beautiful shoreline for swimming, snorkeling, and kayaking. In the afternoon, we are again in rich whale waters, near the mouth of Bahía Concepción, where we have excellent possibilities of sighting several species of whales, including fin or sperm.



*Kayaking, Isla San Marcos.*

**ISLA SAN JOSÉ:**

One of the larger islands in the Sea of Cortez, San José, offers several landing possibilities depending on conditions and the whim of the moment. Photograph the ochre cliffs of the island’s eastern shore, hike an “enchanted” *arroyo*, or visit the abandoned salt works to the west.

**BAHÍA LORETO MARINE PARK:**

This morning we’ll search for whales in the waters south of Isla Carmen, an area that has proven to be one of the best for finding blue whales, and often, bottlenose and common dolphins. In the afternoon we visit one of the islands of Bahía Loreto Marine Park, with ample time for kayaking, snorkeling, stand-up paddleboarding, and possibly, hiking. In the evening, enjoy a beach barbecue under the desert sky.



**ISLAS LOS ISLOTES AND SAN FRANCISCO:**

At Los Islotes, don flippers, a mask and snorkel (which we’ll gladly provide) and swim with curious sea lions. We have a leisurely afternoon to swim, kayak, or hike at Isla San José. Endemic yellow-footed gulls, brown pelicans, and blue-footed boobies are all part of the landscape. Finish the day with a relaxing beach barbecue complete with a bonfire and a star-filled sky.

**APR. 20: LORETO/DISEMBARK**

Disembark in Loreto after breakfast and transfer to the city center. Here you’ll have the opportunity to visit the first mission in Baja California, the Loreto Mission, as well as the nearby museum to learn more about what makes this town so special. Enjoy some free time to explore the quaint shops and vibrant side streets. After lunch, transfer to Loreto Airport for flights home. (B,L)

**EXPEDITION DETAILS**

**DATE:** 2020 Apr. 13

**NATIONAL GEOGRAPHIC PHOTOGRAPHER**

Photographer, marine biologist, and conservationist **Octavio Aburto** will join the Apr. 13 departure.



*Swim with graceful sea lions.*



*Beach barbecue.*

WHALES, BEACHES, YOGA,  
HIKES, AND SERENITY





THE TWO ESCAPES FEATURED HERE OFFER YOU THE BEST of Baja in a convenient five- or four-night timeframe. Is getting up close with the local wildlife your main priority? Simply choose the **Escape to Magdalena Bay**, aboard *National Geographic Sea Lion*, perfectly sized to enter and anchor in the Bay's protected waters, placing us among the gray whale mothers and calves drawn to the calm nursery lagoons. Curious, playful, and friendly, they often approach the small expedition landing crafts we deploy for close-up views and mutual curiosity. At night you can stand on deck under stars and hear the whales breathing around the ship. By day, watch diving pelicans and ospreys, and marvel at the major air dolphins can catch as they leap from the water.

And there are sand dunes to wander, stretches of beach to bike, mangroves to kayak, and many species of birds to spot and add to your life list.

Interested in wellness? Our **Serenity Escape** aboard *National Geographic Venture* is ideal. Enjoy sunrise yoga on deck and a host of outdoor activities in and among idyllic desert isles in the Sea of Cortez. Choose beach yoga or Boot Camp. Go paddleboarding or kayaking. Geek out on a trail walk with a naturalist, or hike high up for an exhilarating panorama of the Sea of Cortez. And while you're there, you can easily add a rare experience to your "Been there, done that" list—swimming with whale sharks, the world's largest fish.

Choose either Escape and save 10% when you travel with a group of six or more. Make a milestone birthday or anniversary extra special by celebrating in pure wildness in a place not too far from home.

NEW

# WILD BAJA ESCAPE: THE WHALES OF MAGDALENA BAY

**6 DAYS/5 NIGHTS—ABOARD NATIONAL GEOGRAPHIC SEA LION**

PRICING FROM \$3,740 (See page 25 for details.)

This is no ordinary whalewatching experience: we'll literally anchor among the gray whales in Bahía Magdalena, where mothers and calves relax after the longest mammal migration on earth. We'll see and hear them around the ship, and venture out in expedition landing craft for exhilarating up-close encounters. We'll visit multiple sites in the 70-mile-long bay to maximize our opportunities for interactions. While whales may be the highlight, this area is home to so much more. Explore the mangroves by kayak. Fat-tire bike along remote beaches (we've got a fleet of bikes aboard). Beachcomb endless crescents of sand, studded with thousands of sand dollars. And revel in the vastness and serenity as you view the many species of birds in this world-renowned region.

## EXPEDITION HIGHLIGHTS

- ▶ Live among gigantic gray whale mothers and their calves in the nursery waters of Bahía Magdalena. See them from and around the ship, delighting in up-close encounters.
- ▶ Kayak and paddleboard stunning mangroves, or beachcomb along endless beaches.
- ▶ Explore diverse landscapes; fat-tire bike along desert island terrain.
- ▶ Scan the skies for bird species, from diving pelicans to magnificent frigatebirds.

## EXPERIENCE & EXPERTISE

**35+**  
YEARS  
EXPERIENCE

Our expert expedition team will illuminate the wonders of Magdalena Bay from every possible angle. Your expedition leader, undersea specialist,

Lindblad-National Geographic certified photo instructor and naturalists, plus a wellness specialist and video chronicler, are dedicated to ensuring an incredible voyage.

*Visit our website to read staff bios for this expedition.*

National Geographic Sea Lion *sharing Magdalena Bay with spyhopping gray whale.*



**DAY 1: LORETO/SAN CARLOS/EMBARK**  
Upon arrival in Loreto, transfer to San Carlos and embark *National Geographic Sea Lion*. Tonight we'll anchor off the coast of Isla Santa Margarita. (D)

**DAY 2: BAHÍA ALMEJAS/REHUSA CHANNEL/ISLA MAGDALENA**

Awake in Bahía Almejas, the southernmost part of the Bay. We'll make a special stop to view a large frigatebird colony on Isla Santa Margarita before heading out on our first whale watching trip of the voyage. The whales in Bahía Almejas tend to be very active, seemingly oblivious to our presence. As we explore this bay and the Rehusa Channel via local panga, our team will do whatever it takes to provide you with memorable and meaningful experiences. During lunch, we'll sail toward Isla Magdalena to explore the ever-shifting sand dunes on a cross-island walk to one of the most pristine beaches in the Pacific. Take a dip or tally the treasure found on what we affectionately call "sand dollar beach." (B,L,D)

**DAY 3: TRANSIT THE HULL CANAL/ BOCA DE SOLEDAD**

Spend the morning transiting the scenic winding Hull Canal. Within its narrow channels, bordered by mangroves and sand dunes, and filled with abundant wildlife, we'll hang out on deck with our keen-eyed naturalists to spot species and hear expert commentary. Weather permitting, we'll explore the vast mangrove system via kayak and expedition landing craft. Bird-watching here can be excellent. Among the species we might see are diving pelicans, wheeling cormorants, terns, great blue herons,

ibis, whimbrels, and willets. It's not unusual to see forty species of birds in just one day along these fertile shorelines. This afternoon, we'll head out to explore the breeding grounds of Boca de Soledad. (B,L,D)



Treasures from "sand dollar beach."

**DAYS 4 AND 5: BOCA DE SOLEDAD**

Each winter, during their long migration, gray whales travel south from their Arctic feeding grounds to breed and give birth to their calves in these sheltered waters. "Grand Central" for California gray whales, we'll spend two full days observing, and with luck, interacting with these majestic creatures. Together with savvy local fishermen we've known for years, we'll venture out in expedition landing craft to view the numerous mother-calf pairs that thrive in this region. We'll also have an opportunity to explore the beaches, and if you're feeling up to it, grab one of our fat-tire bikes to roam the seemingly endless beaches. (B,L,D)

**DAY 6: LOPEZ MATEOS/DISEMBARK/ LORETO**

After breakfast, disembark our ship and transfer to Loreto's city center. Choose to visit the first mission in Baja California, as well as



the nearby museum to learn more about what makes this town so special. Enjoy free time to explore the quaint shops and vibrant side streets. After lunch, transfer to Loreto Airport for flights home. (B,L)

**EXPEDITION DETAILS**

**DATES:** 2020 Jan. 17, 22, 27; Feb. 1, 6, 11, 16, 21; Mar. 2, 7, 12, 17

**SPECIAL OFFER:**

Groups traveling with six or more adults will receive 10% off on select departures. See page 28 or call for details.

**NATIONAL GEOGRAPHIC EXPERT**

Travel with film producer and marine biologist **John Francis** on the Jan. 22 & 27, 2020 departures.

**NEW! LORETO POST-EXTENSION**

Further your exploration of this charming and richly varied region with this exciting two-night extension. See page 24.



Guests kayaking under mangroves.

# WILD BAJA ESCAPE: SERENITY & SEA LIFE IN THE SEA OF CORTEZ

**5 DAYS/4 NIGHTS—ABOARD NATIONAL GEOGRAPHIC VENTURE**

PRICING FROM \$2,780 (See pages 26-27 for details.)

A genuinely innovative hybrid—a four-night getaway that feels like an authentic escape from the everyday. Through spa therapies, healthful menus, and fitness classes, experience the balance between mind and body. De-stress, detox or simply play or workout in the uninhabited wilds of Isla San Francisco and Isla Partida in the beautiful Sea of Cortez. With the brand-new 50-cabin *National Geographic Venture* as your mobile base camp, go where the wild things—and few others—are. Breathe deep, push hard, and chill at a BBQ under the stars.

## EXPEDITION HIGHLIGHTS

- ▶ Paddle pristine coves and inlets on kayaks and stand-up paddleboards.
- ▶ Snorkel with sea lions, beachcomb desert shores, or explore by Zodiac.
- ▶ Zen out with Beach Yoga, or do Boot Camp workouts with a wellness instructor; or geek out on trail walks with naturalists.
- ▶ Hike high into the hills for exhilarating panoramas of the Sea of Cortez; take your best photos ever.
- ▶ Choose from a menu of treatments and massages.

▶ VIEW THE EXHILARATING WELLNESS EXPERIENCE ON THIS WILD BAJA ESCAPE ADVENTURE: [EXPEDITIONS.COM/BAJAWELLNESS](https://www.nationalgeographic.com/expeditions.com/bajawellness)

## EXPERIENCE & EXPERTISE



We've been exploring the Sea of Cortez for decades, and love the islands here. Our team of naturalists is uniquely able to help you discover this stunning wild region. And to make the most of your time and energy, we'll be adding workout classes and relaxing treatments to the mix—a unique and rewarding combination.

*Visit our website to read staff and guest speaker bios for this expedition.*

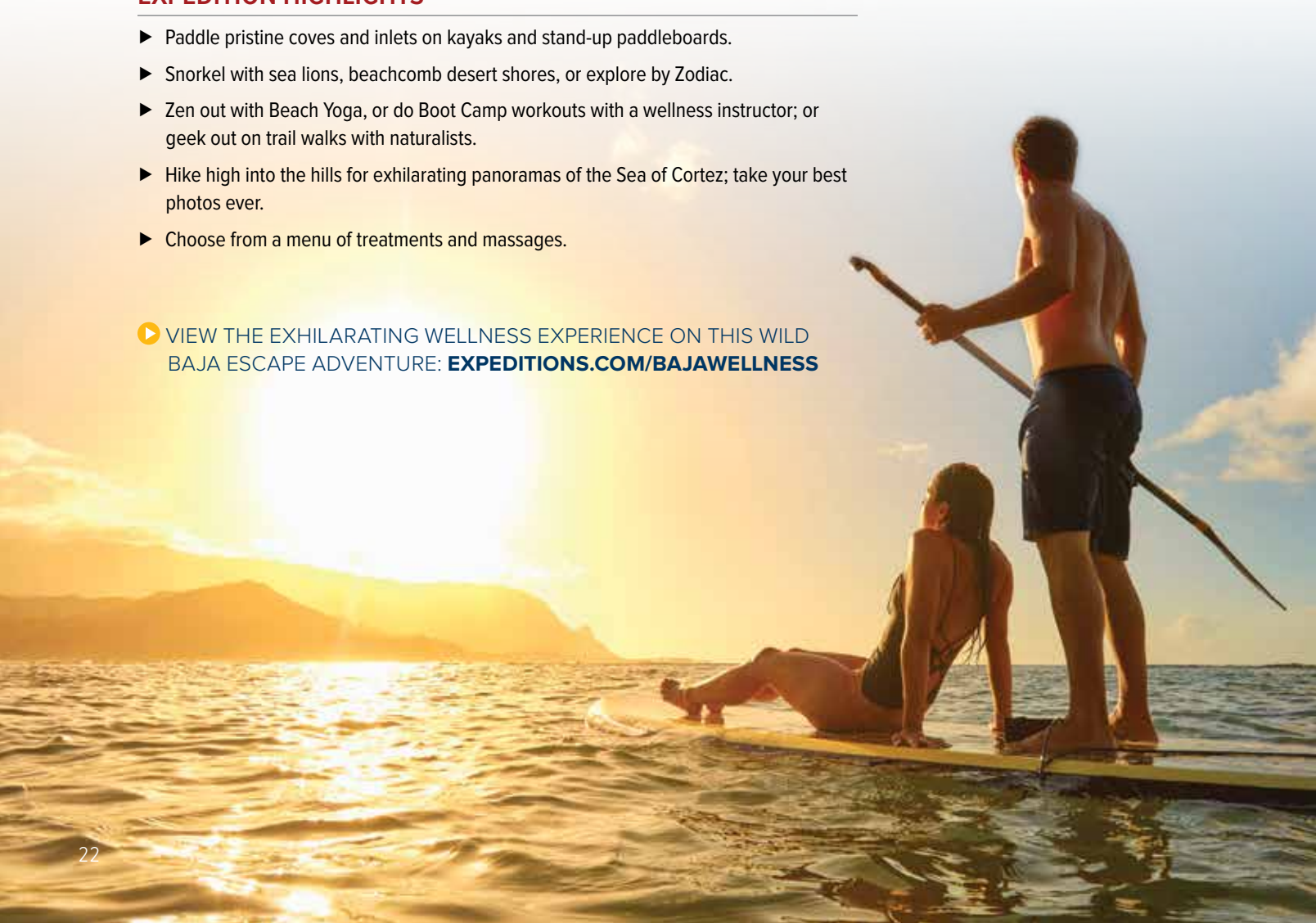



**DAY 1: SAN JOSÉ DEL CABO/LA PAZ/  
EMBARK**

Upon arrival to Los Cabos airport, transfer to La Paz, where you'll embark *National Geographic Venture* this afternoon. Set sail on arrival for a sunset cruise of Bahía La Paz en route to Isla San Francisco. (D)



*Beach barbecue and bonfire under the stars.*

**DAYS 2 AND 3: SAN JOSÉ CHANNEL/  
ISLA SAN FRANCISCO**

Witness a spectacular Baja sunrise this morning, while searching for marine mammals in the upper San José Channel. Hear naturalist talks and learn photography basics during an early morning at sea. Before lunch, go ashore at Isla San Francisco, where a sweeping arc of white sand beach beckons you to roll out a yoga mat. Explore nearby tide pools with your naturalists, or spend the afternoon stand-up paddleboarding, snorkeling, and kayaking. Hike to the nearby ridge for unparalleled views just before

sunset. Wind down with an on-deck yoga class or a chair massage, then go ashore for a beach barbecue dinner followed by a bonfire under the stars. However you choose to spend these days, you'll be rewarded with a sense of well-being that comes only from spending quality time in nature. (B,L,D)

**DAY 4: ISLA PARTIDA AND  
LOS ISLOTES**

Watch the cliffs light up as your wellness specialist leads a morning yoga or qi gong class, on deck. Explore as much or as little as you like, with the ship as your mobile base camp—taking advantage of every wellness option, including hiking with your wellness specialist for mindfulness and stretching on the trail. Explore the dramatically eroded shoreline of Isla Partida on a one-way kayak journey or join a challenging hike up a rocky *arroyo* to the crest of the island. Meander a different *arroyo* with your naturalists to learn about the geology and natural history, then learn to paddleboard, or hone skills you already possess. Snorkel with playful and curious sea lions or photograph their antics from a Zodiac. (B,L,D)

**DAY 5: LA PAZ/DISEMBARK/  
SAN JOSÉ DEL CABO**

Disembark in downtown La Paz this morning and transfer to Los Cabos airport for flights home. (B)



**EXPEDITION DETAILS**

**DATES:** 2019 Dec. 23, 29; 2020 Jan. 2, 6

**SPECIAL OFFERS:**

Book six or more under one booking and save 10%. See page 28 or call for details.

**NEW! SWIM WITH WHALE SHARKS**

Enhance your Baja experience with this thrilling two-night extension. See page 24.



*Whale shark.*



*Mobula rays, Los Islotes.*

# OPTIONAL EXTENSIONS

## MAKE THE MOST OF YOUR TIME IN BAJA

### LA PAZ + WHALE SHARKS

#### 3 DAYS/2 NIGHTS PRE- OR POST-VOYAGE

From \$740

Fall under the spell of enchanting La Paz as you delve into the region's rich history through its cuisine, architecture, and charming museums. Visit the airy, immense cathedral of La Paz and learn the story of its 70-year construction. Stroll along the cobblestone streets of a small mining village and indulge in curated menus and inspiring meals. Cap it off with a thrilling, once-in-a-lifetime swim with the largest fish on the planet, the gentle giant whale shark. Available on *From Southern California to Baja: Sailing the Pacific Coast* (page 10) and *Wild Baja Escape: Serenity & Sea Life in the Sea of Cortez* (page 23).



### LORETO + BLUE WHALES

#### 3 DAYS/2 NIGHTS POST-VOYAGE

From \$1,190

Add an exploration of Loreto's inland wildness to your coastal expedition, and discover the region's human history through its missions and villages. Visit stunning San Javier, a mission built in the 1700s by Jesuits and see the surrounding town, with streets and buildings largely untouched since 1875, then hike outside the village to experience Baja's inland wildness. In the Loreto National Marine Reserve board local boats for a chance to see magnificent blue and fin whales, the two largest animals on Earth. Hike through the fascinating ecosystems of the desert and canyons of the Sierra de la Gigante. Available on most departures of *Baja California & the Sea of Cortez: Among the Great Whales* (page 13) and *Wild Baja Escape: the Whales of Magdalena Bay* (page 20).





## NATIONAL GEOGRAPHIC SEA LION

**CAPACITY:** 62 guests in 31 outside cabins.

**REGISTRY:** United States. **OVERALL LENGTH:** 152 feet.

**PUBLIC AREAS:** Our ship features a library; global market; lounge with full-service bar and facilities for films, slide shows and presentations; observation deck; partially covered sun deck with chairs and tables, and LEXspa. Our “open bridge” provides guests an opportunity to meet our officers and captain, and learn about navigation.

**MEALS:** Served in single seatings with unassigned tables for an informal atmosphere and easy mingling. Breakfasts are wide-selection buffets, and lunch is often served family style. Dinners are primarily served plated. Menu emphasizes local fare.

**CABINS:** All face outside with windows, private facilities, and climate controls.

**EXPEDITION EQUIPMENT:** Bow camera, hydrophone, kayaks, fleet of paddleboards, splash-cam, underwater video camera, video microscope, wet suits and snorkel gear, and expedition landing craft.

**SPECIAL FEATURES:** Guest internet access. A certified photo instructor and a video chronicler are on board all voyages. A ship’s doctor is on board in Baja. An undersea specialist is on board in Baja and Alaska.

**WELLNESS:** The vessel is staffed by a wellness specialist and features exercise equipment, LEXspa, and outdoor stretching area.

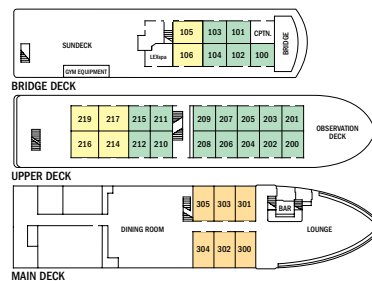

**CATEGORY 1:** Main Deck #300-305—Conveniently positioned between the dining room and lounge, these cabins feature two single lower beds, and a large view window.

**CATEGORY 2:** Bridge Deck #100-104; Upper Deck #200-212, 215—These well-located cabins include two lower single beds and a view window.

**CATEGORY 3:** Bridge Deck #105, 106; Upper Deck #214, 216, 217, 219—These cabins feature a seating unit with table and two large view windows. Upper Deck cabins include two lower single beds which can convert to a double bed and a pull-out single bed for a third person; Bridge Deck cabins include two lower single beds only.

Note: Solo Occupancy cabins are available in Categories 1 and 2 only. Third person rates are available in certain categories at one half the double occupancy rate.

Shared Accommodations: Shares can be arranged at the double occupancy rate in Categories 1 and 2 only.

Prices are per person, double occupancy unless indicated as solo.

ITINERARY	YEAR	CAT. 1	CAT. 2	CAT. 3	CAT. 1 SOLO	CAT. 2 SOLO	ADVANCE PAYMENT	NOTE
Wild Baja Escape: The Whales of Magdalena Bay – Page 20	2020	\$3,740	\$4,370	\$4,930	\$5,620	\$6,550	\$750	Sample Airfares: Round-trip Los Angeles/Loreto; Economy from \$475; Business from \$1,140.

Prices quoted in this brochure are valid as of the time of printing, are subject to modification, and are not guaranteed until booking and required deposit is made. See our website at [expeditions.com](http://expeditions.com) for the most up-to-date pricing.



# NATIONAL GEOGRAPHIC VENTURE

**CAPACITY:** 50 cabins accommodating 100 guests  
**REGISTRY:** United States. **OVERALL LENGTH:** 238 feet.

*National Geographic Venture* begins her inaugural season in Baja California and is the latest addition to our fleet. Designed with over 50 years of expedition heritage and built in the U.S.A., she will set a new standard in exploration and comfort.

**PUBLIC AREAS:** Global gallery; fitness center; LEXspa; lounge with full service bar and facilities for films and presentations; observation deck; mudroom with lockers for expedition gear; and a partially covered sundeck with chairs and tables. Our “open bridge” provides guests an opportunity to meet our officers and captain, and learn about navigation.

**MEALS:** Served in single seatings with unassigned tables for an informal atmosphere and easy mingling. Breakfast and lunch are wide-selection buffets with chef-action stations, while dinners are primarily served plated. Menu emphasizes local fare.

**CABINS:** All cabins face outside with windows or portholes, private facilities, and climate controls. Category 4 cabins have step-out balconies.

**EXPEDITION EQUIPMENT:** A fleet of 8 Zodiacs and 24 kayaks, Remotely Operated Vehicle (ROV), hydrophone, splash-cam, underwater video camera, video microscope, paddleboards, and snorkeling gear for all guests (where applicable).

**SPECIAL FEATURES:** Guest internet access, elevator, Lindblad-National Geographic certified photo instructor, video chronicler, undersea specialist, and ship physician.

**WELLNESS:** The vessel is staffed by a wellness specialist and features a gym with an elliptical machine, treadmill, exercycles, handweights, and resistance bands. Treatments in the LEXspa are available by appointment.

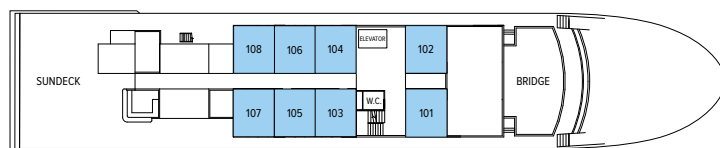

OBSERVATION DECK

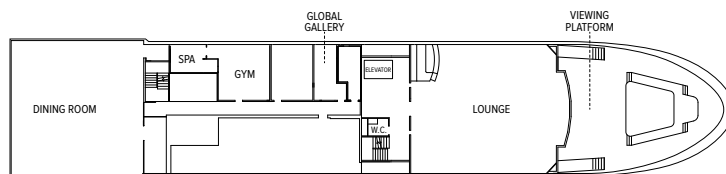

LOUNGE DECK



UPPER DECK

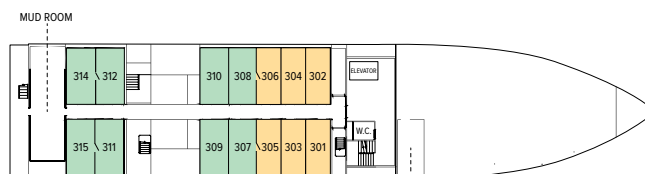

MAIN DECK

TREATMENT ROOM



Left to right: Captain Cook raises a glass; *National Geographic Venture*; our lounge is the hub of the expedition community; viewing platform; Category 5 cabin; Category 4 cabin with lower single beds (which can be converted to a Queen) and a private step-out balcony. Select cabins connect via an inside doorway.

**CATEGORY 1:** Main Deck #301-306 Cabins feature two lower single beds that can convert to a Queen, a writing desk, and two portholes.

**CATEGORY 2:** Main Deck #307-315 Cabins feature two lower single beds that can convert to a Queen, a writing desk, and two portholes.

**CATEGORY 3:** Upper Deck #201-206 Cabins feature two lower single beds that can convert to a Queen, a writing desk, and two large view windows.

**CATEGORY 4:** Upper Deck #207-229 Cabins feature two lower single beds that can convert to a Queen, a writing desk, sliding glass door, and small, private balcony.

**CATEGORY 5 (SUITE):** Observation Deck #101-108 Cabins feature two lower single beds that can convert to a Queen, large view windows, an expanded bathroom, writing desk, ample storage space, and a convertible sofa bed to accommodate a third person.

**NOTE:** Solo Occupancy cabins are available in Categories 1 and 2 only. Third person rates are available in Category 5 cabins at one half the double occupancy rate.

**Connecting Cabins via internal doorway access:** Main Deck: #312-314, #311-315, #306-308, #305-307; Upper Deck: #224-226, #225-227

Prices are per person, double occupancy unless indicated as solo.

ITINERARY	YEAR	CAT. 1	CAT. 2	CAT. 3	CAT. 4	CAT. 5 SUITE	CAT. 1 SOLO	CAT. 2 SOLO	ADVANCE PAYMENT	NOTE
From Southern California to Baja: Sailing the Pacific Coast – Page 10	2019	\$9,390	\$10,630	\$11,870	\$13,230	\$14,710	\$14,090	\$16,070	\$1,000	We will gladly assist in making your air arrangements. Please call for airfares from your departure city.
Baja California and the Sea of Cortez: Among The Great Whales – Page 12	2020	\$5,990	\$6,770	\$7,230	\$7,990	\$8,880	\$9,150	\$9,990	\$750	Sample Airfares: Round-trip Los Angeles/Loreto: Economy from \$475; Business from \$1,140.
Baja California: A Remarkable Journey – Page 14	2020	\$11,530	\$12,750	\$13,610	\$15,180	\$16,740	\$17,300	\$19,130	\$1,500	Sample Airfares: Round-trip Los Angeles/Loreto: Economy from \$475; Business from \$1,140.
Whales & Wildness: Spring in the Sea of Cortez – Page 16	2020	\$6,570	\$7,200	\$7,700	\$8,590	\$9,450	\$9,860	\$10,820	\$750	Sample Airfares: Round-trip Los Angeles/Loreto: Economy from \$475; Business from \$1,140.
Wild Baja Escape: Serenity & Sea Life in the Sea of Cortez – Page 22	2019	\$2,780	\$3,560	\$4,190	\$4,720	\$5,190	\$4,180	\$5,350	\$750	Sample Airfares: Round-trip Los Angeles/Los Cabos: Economy from \$475; Business from \$1,140.
	2020	\$2,780	\$3,390	\$3,990	\$4,490	\$4,950	\$3,980	\$5,090		

Prices quoted in this brochure are valid as of the time of printing, are subject to modification, and are not guaranteed until booking and required deposit is made. See our website at [expeditions.com](http://expeditions.com) for the most up-to-date pricing.

# TAKE ADVANTAGE OF OUR SPECIAL OFFERS

## From Southern California to Baja: Sailing the Pacific Coast—

**\$350 AIRFARE CREDIT:** Book by Aug. 31, 2019 to receive a \$350 air credit per person. Valid for new bookings only, subject to availability, and may not be combined with other offers, or extensions. Call for details.

**GET THE GROUP ON BOARD: SAVE 10%** When you gather a group of 6 or more under one booking, you make memories together and save 10% on the voyage total—on *Wild Baja Escape: Serenity & Sea Life in the Sea of Cortez* and *Wild Baja Escape: The Whales of Magdalena Bay* departures.

**OR SAVE 5%** when traveling as a group of 8 or more people on all other departures. Take advantage of these great savings, while enjoying traveling with your friends and family. This savings is applicable on voyage fares only, and not on extensions or airfare. Deposit, final payment, and cancellation policies for group travel vary from our regular policies.

**BRINGING THE KIDS:** We believe sharing an expedition with your kids or grandkids is a life-enhancing experience. So take \$500 off for each child under the age of 18.



## INCLUSIVE PRICING

We include just about everything you have the opportunity to do as part of your expedition aboard ship and ashore. The only things not included are those of a personal nature—alcohol, internet usage, tips to the crew, wellness treatments and other specialized arrangements.

### ABOARD SHIP

- ✓ All meals and non-alcoholic beverages
- ✓ Cappuccinos, lattes & complimentary environmentally friendly refillable water bottle
- ✓ 24-hour coffee, tea & soda on demand
- ✓ Hors d'oeuvres & snacks during lounge recap
- ✓ Fitness center
- ✓ Fully stocked library
- ✓ The guidance and company of our expedition staff

### ASHORE

- ✓ Meals on land, as indicated in itinerary
- ✓ Special access permits, park fees, port taxes
- ✓ Transfers to and from group flights
- ✓ The expertise of our expedition staff

### ACTIVITIES

- ✓ All excursions
- ✓ Zodiac & kayak explorations
- ✓ Snorkeling and paddleboarding
- ✓ Lectures & presentations in the lounge
- ✓ Morning stretch classes with wellness specialist

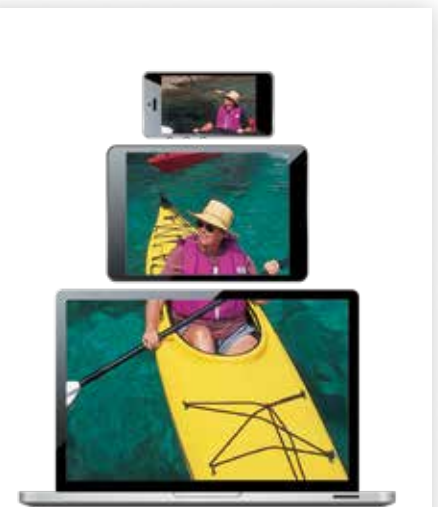

## BE PART OF OUR EXPEDITION COMMUNITY

Join in! Here's how:

- ✓ Check our daily blog for interesting posts, video clips and Photos of The Week: [expeditions.com/blog](http://expeditions.com/blog)
- ✓ Like us on Facebook: hear what our travelers have to say, get inspired and chime in: [facebook.com/LindbladExpeditions](https://facebook.com/LindbladExpeditions)
- ✓ Preview an expedition before you go or subscribe to our videos on [youtube.com/lindbladexpeditions](https://youtube.com/lindbladexpeditions)
- ✓ Follow us [@LindbladExp](https://twitter.com/LindbladExp) and our founder, Sven Lindblad [@SvenLEX](https://twitter.com/SvenLEX), on Twitter; and on Instagram [@SOLindblad](https://instagram.com/SOLindblad) for his interesting view of the world.
- ✓ Check out Expedition Snapshots from guests—and upload your own on the [expeditions.com](http://expeditions.com) homepage.





## PHOTOGRAPHERS: THIS ONE'S FOR YOU

Whether you're a beginner or advanced, smartphone or DSLR user, grab the chance to improve your skills on an itinerary designed by and for photo enthusiasts. It's *Baja California: A Remarkable Journey*; details and the National Geographic photographers on board on pages 14-15.

### RESERVATION INFORMATION

**Terms & Conditions:** For complete terms and conditions please visit [www.expeditions.com/terms](http://www.expeditions.com/terms)

**Costs Include:** All accommodations aboard ship or in hotels per itinerary or similar, all meals and non-alcoholic beverages aboard ship, meals on land as indicated accompanied by non-alcoholic beverages, air transportation where indicated as included, shore excursions, sightseeing and entrance fees, special access permits, transfers to and from group flights, use of kayaks, tips (except gratuities to ship's crew), taxes and service charges, services of a ship physician and services of our expedition staff. Unused services or items included in our programs are non-refundable.

**Not Included:** Air transportation (except where shown as included), extensions, passport, visa, immigration fees, meals not indicated, alcoholic beverages, travel protection plan, items of a personal nature, such as e-mail, voyage DVD, laundry.

**Airfare:** For all programs, airfare is an additional cost unless otherwise indicated. Sample airfares are subject to change. We will gladly assist in making your air arrangements for a \$50 per person service fee.

**Reservations:** To reserve your place, an advance payment is required at the time of reservation. See pages 25 and 27 for individual itinerary details.

**Final Payment:** Payment is due no later than 90 days prior to departures, depending on the expedition. Payment schedules may vary for certain longer voyages, due to high demand. We reserve the right to cancel your reservation if payment has not been received by final payment due date.

**Travel Protection Plan:** We strongly recommend that you take advantage of our Travel Protection Plan. This plan offers comprehensive coverage to protect you from cancellation fees, costs incurred due to trip delays/interruption, medical assistance, and damaged or lost baggage, and provides medical assistance and evacuation during your travels. Our Travel Protection Plan is available for U.S. and Canadian residents only, and may be purchased any time prior to final payment due date. If you are not satisfied for any reason, you may return your plan within 10 days after purchase. Your premium will be refunded if canceled within 10 days, provided you have not already departed on the trip or filed a claim. When so returned, the coverage under the plan is void from the original date of purchase.

**Responsibility and Other Terms & Conditions:** Certain provisions concerning, among other things, limitations of Lindblad Expeditions' and the National Geographic Society's liability for loss of property, injury, illness or death during the

voyage will be provided to all guests on the ship's ticket sent prior to departure, and are also available on our website at [www.expeditions.com/terms](http://www.expeditions.com/terms), or upon request. By registering for a trip, the guest agrees to all such terms and conditions.

**Note:** Itineraries and prices listed in this brochure are as of publication date and are subject to change. Under normal conditions the total expedition price is guaranteed at the time of booking. However, our expedition pricing is determined far in advance of initial departure on the basis of then-existing projections of fuel and other costs. In the event of increases in those costs, including but not limited to increases in the price of fuel, currency fluctuations, increases in government taxes or levies, or increased security costs, we reserve the right to adjust the price of your expedition or add a surcharge to cover such unexpected increases. We will always provide an explanation of the reason for increase in costs.

**Cancellation Policy:** Cancellation penalties may apply after payment is received. Please visit [www.expeditions.com/terms](http://www.expeditions.com/terms) for complete cancellation policies.

©2019 Lindblad Expeditions

Lindblad Expeditions and the Eye are the trademarks of Lindblad Expeditions. All rights reserved.

NATIONAL GEOGRAPHIC and the Yellow Border are the trademarks of the National Geographic Society. All rights reserved.

Photo Credits: Bernard Barcos/Alamy, Tom Bean/Alamy, John Bodner, Linda Burback, Marc Cappelletti, Alexandra C. Daley-Clark, David Cothran, Sarah Culler, Rab Cummings, Bennett Goldberg, Ralph Lee Hopkins, Jonathan Kingston, Jeremy Lindblad, Sven-Olof Lindblad, Jeff Litton, Jeff Mauritzen, Emily Mount, Carlos J. Navarro, Michael S. Nolan, Ryder Redfield, Rich Reid, Marco Ricca, Rikki Swenson, David Vargas.

### For Reservations:

Contact your travel advisor or Lindblad Expeditions  
**1.800.EXPEDITION (1.800.397.3348)**

Reservation Hours: Monday – Friday 9am – 9pm ET  
Saturday & Sunday 10am – 5pm ET

Lindblad Expeditions, Inc., 96 Morton Street, New York, NY 10014  
Phone: 212.261.9000 • Fax: 212.265.3770

For additional information and online reservations,  
visit us on the Web: [www.expeditions.com](http://www.expeditions.com)

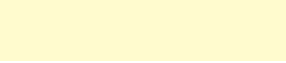
Account Number: 

**1.800.EXPEDITION | WWW.EXPEDITIONS.COM**

 Printed on 10% recycled content paper with soy-based inks. We recommend that you pass this along for others to enjoy or recycle.

BAJ-069

## EXPLORE THE CALIFORNIA COAST

Voyage from LA to La Paz and discover  
Channel Islands National Park along the way.

With a \$350 Air Credit

Plus Choose to Swim with the Whale Sharks

See page 10 for Details.

