

BAJA & THE SEA OF CORTEZ



THE FAMILY
THAT EXPLORES
TOGETHER
MAKES 4EVER
MEMORIES

TAKE THE KIDS
& TAKE 25% OFF
IN WINTER 2020

PLUS
MORE OFFERS
FOR FRIENDS
& SOLO
TRAVELERS

ABOARD NATIONAL GEOGRAPHIC VENTURE, NATIONAL GEOGRAPHIC QUEST
& NATIONAL GEOGRAPHIC SEA LION | 2020-2021

Isla los Islotes, BAJA CALIFORNIA SUR, MEXICO

24.59° N 110.40° W

That's the **exhilaration** of discovery.

Cover: Long-beaked Common Dolphin, Sea of Cortez. © Ralph Lee Hopkins
Above: Los Islotes, Baja California Sur, Mexico. © Michael S. Nolan

TABLE OF CONTENTS

- 2** Where Awesome Is
- 4** Our Ships
- 6** Meet the Experts
- 7** National Geographic Photography
- 8** Among the Great Whales
- 10** Whales of Magdalena Bay
- 12** A Remarkable Journey
- 14** Exploring the Sea of Cortez
- 16** Serenity in the Sea of Cortez
- 17** Extensions
- 18** National Geographic Quest/Venture
- 20** National Geographic Sea Lion
- 21** Reservation information

SPECIAL FAMILY AND GROUP SAVINGS.
SEE THE INSERT FOR DETAILS.



THE WILDNESS, WILDLIFE &
BEAUTY OF BAJA CALIFORNIA





WHEN MOST PEOPLE THINK OF BAJA, THEY THINK OF THE California grays which migrate yearly to the calving lagoons on the west side of the peninsula, with which we experience joyful encounters. But in our nearly 40 years exploring the Sea of Cortez, our teams have reported astonishing variety too, including pygmy sperm and false killer whales; the largest and second largest of the whales—blue whales and fin whales; plus Bryde’s and sperm whales, and thousands of common, bottlenose, and spinner dolphins.

The desert islands in the Sea of Cortez are dotted with giant cardon cacti that beckon like emphatic greeters, urging us to explore their exotic landscape. There are forests of giant cacti here, with crenate ribs and ranks of star-bursting spires to guard the most precious desert commodity—moisture. In spring they bloom in bright colors and rarified scents.

Our Baja team reveals the wildlife, unravels the desert’s vast biological mysteries for you, and guides you over and under the surface to experience the wonders of this pristine nexus where the desert meets the sea.



“ This morning we awoke just north of the islands of Los Islotes. Among the rocks that jut out from the water, we find the local cabal of California sea lions, brown pelicans, blue-footed boobies, various cormorants, and even peregrine falcons. At Isla San Francisco, we went hiking, kayaking, stand-up paddleboarding, snorkeling, and swimming off this beautiful island. As the sun set, we prepped for a Baja-style BBQ on the beach. Faces alight from the orange and red glow off the horizon, we ate, drank, and laughed about what will remain an unforgettable journey in an unforgettable land.”

— KAYVON MALEK
Undersea Specialist
Daily Expedition Report, Baja

THE PERFECT MOBILE BASE CAMP FOR EXPLORING

WITH GENEROUS DECKS THAT TAKE FULL ADVANTAGE OF the sun and ocean breezes, and create front row seats on the remarkable spectacle of marine life in Baja, our brand-new expedition ship *National Geographic Venture* is uniquely designed to make the most of being in this remote, soul-satisfying geography. Because there is much to discover here—cactus forests, desert islands, beautifully indented shores, a calm sea with vivid life beneath the surface, and more, *National Geographic Venture* is equipped so you can explore—a fleet of Zodiacs, kayaks, paddleboards, plus snorkeling gear for all and hydrophones for whale listening. In addition, an undersea specialist/videographer captures video for you to enjoy in the comfort of the ship's lounge. And a Lindblad-National Geographic certified photo instructor is aboard to help you capture the moments at the heart of your experience.

▶ See our NEW ship, *National Geographic Venture*
expeditions.com/Venture

“ We are thrilled with our brand-new sister ships, *National Geographic Quest* and *National Geographic Venture*, designed to give a complement of 100 guests the same intimate, inclusive experience the 62-guest *National Geographic Sea Bird* and *National Geographic Sea Lion* (below) have provided for 35 years. They've introduced a generation to Alaska, Baja, British Columbia, the San Juan Islands and more—and to the profound joys of up-close, personal exploring with expert naturalists, and a collegial expedition community.”

— SVEN-OLOF LINDBLAD
CEO & Founder



▶ Learn more about the *National Geographic Sea Lion*
expeditions.com/SEALION

OUR SHIPS



DOING WHATEVER IT TAKES TO MAKE YOUR EXPERIENCE EXTRAORDINARY

WHETHER IT MEANS STAYING UP UNTIL THE WEE HOURS TO SCAN FOR passing whales of uncommon species so you won't miss out on rare sightings, taking advantage of an opportunity to snap photos of a pod of leaping dolphins, or holding an impromptu stargazing, our team is dedicated to revealing Baja and making sure your experience is exceptional. Benefit from the personalities and knowledge of an expedition leader, a team of naturalists, an undersea specialist, a Lindblad-National Geographic certified photo instructor (CPI), and a video chronicler, plus a wellness specialist to enhance the revitalizing effects of life in the Sea of Cortez.

▶ Learn more at expeditions.com/expertbios for full bios on our staff



Representing our expert team for the 2019/20 season, clockwise from left: Carlos Navarro, undersea specialist; James Hyde, CPI/naturalist; Annie Fiske, expedition leader; Paul North, undersea specialist; Stella Bohnert, assistant expedition leader.



IN A LAND WITH PERFECT LIGHT, BENEFIT FROM EXPEDITION PHOTOGRAPHY

MAKE THE MOST OF THE UNRIVALED PHOTO OPS OF BAJA

California's wild islands, whales, dolphins, pelicans, and sea birds with our Expedition Photography program. Every expedition features a Lindblad Expeditions-National Geographic certified photo instructor



who offers assistance, instructions and shooting tips in the field. Their expertise will inspire you and

help you improve your skills—no matter your current skill or interest level—and ensure you return home with incredible photos.

Exclusive Onboard Gear Locker

Dive into the onboard B&H Photo Video Gear



Locker to field test new glass, camera bodies, and more—free. Plus, ask your Expedition Specialist about pre-voyage discounts and benefits.



So many reasons
to be on board!

BAJA CALIFORNIA & THE SEA OF CORTEZ: AMONG THE GREAT WHALES

8 Days/7 Nights—Aboard *National Geographic Venture*

Pricing from \$5,990 (See pages 18-19 for details.)

Our experience in this region has enabled us to add even more to this itinerary, an expedition team favorite. We now range more widely—**increasing our chances to spot some of the more than 20 whale species that inhabit the area, while allowing us time to linger among the gray whales for incredible, up-close encounters.** Experience the human side of Baja, too, in La Paz and lovely Loreto. And, we've created a new opportunity: snorkel the pristine reefs of Cabo Pulmo, one of the most successful national marine parks in the world.

NATIONAL GEOGRAPHIC EXPERT

Marine biologist and filmmaker **Tierney Thys** will join the **Jan. 11 2020** departure. As past Director of Research for Sea Studios Foundation, Tierney helped produce the award-winning PBS series *Strange Days on Planet Earth* and *Shape of Life*.

Learn more about staff and guest speakers at expeditions.com/experts.

EXPEDITION HIGHLIGHTS

- ▶ Explore along Baja's Pacific Coast and the Sea of Cortez to exponentially increase your chances of seeing humpbacks, gigantic blue whales, sperm, pilot whales, and more.
- ▶ Your floating base camp brings you into the breeding grounds of gray whales to observe their calves on intimate water-level encounters, and from the ship's bow along with expert naturalists.
- ▶ Go snorkeling amid sea lions and schools of king angelfish in the Sea of Cortez and in extraordinary Cabo Pulmo National Marine Park.
- ▶ Kayak clear blue waters on the lookout for a variety of bird species including magnificent frigatebirds.
- ▶ Hike or walk diverse landscapes, including sand dunes, a cactus forest, and deserted islands.
- ▶ Stroll the "Malecon" in vibrant La Paz and dine splendidly; in Loreto visit the first mission in the New World.

California gray whale, Baja California.

DAY 1: LORETO/SAN CARLOS/EMBARK
Upon arrival in Loreto, transfer to San Carlos and embark our ship. Tonight, we'll anchor off the coast of Isla Santa Margarita. (D)

DAY 2: BAHÍA ALMEJAS/REHUSA CHANNEL/ISLA MAGDALENA
Awake in Bahía Almejas, the southernmost part of the Bay. We'll observe a large frigatebird colony enroute to the spectacular whale grounds of Bahía Almejas. Whales here tend to be very active, seemingly oblivious to our presence so settle in for some great experiences. Later we'll reposition to Isla Magdalena to explore the ever-shifting sand dunes, on a cross-island walk to one of the most pristine beaches in the Pacific. Bird-watching can be excellent here. (B,L,D)

DAY 3: BOCA DE SOLEDAD
Each winter, gray whales travel south from their Arctic feeding grounds to breed, give birth, and raise their calves in these sheltered waters. We'll spend the full day interacting with these majestic creatures. Together with savvy local Mexican fishermen, we'll venture out in local pangas to view the numerous mother-calf pairs. We will likely encounter a variety of shorebirds while frigatebirds and pelicans soar overhead. (B,L,D)

DAY 4: THE HULL CANAL & CRUISING
Kickstart your day with a morning stretch hosted by our onboard wellness specialist on the sun deck. After breakfast, we'll explore the vast mangrove system via kayak, stand-up paddleboard, and Zodiac, and learn how these massive ecosystems support their surroundings. This afternoon, we'll sail out through "La Entrada" as we leave Magdalena Bay behind. Traveling south along the coast of the peninsula, there is a chance of seeing a wide variety of marine life. Hear naturalist talks and learn photography basics. (B,L,D)

DAY 5: GORDA BANKS/CABO PULMO
Awake to a majestic sunrise over the iconic Friars Rocks at Land's End. We'll spend the rest of the morning searching the seas of Gorda Banks seamount, a renowned gathering place for whales, dolphins, and other sea life. Later we'll set out to snorkel the pristine reefs of Cabo Pulmo National Marine Park, one of the most successful national marine parks in the world, and chat with locals about their advocacy to protect this unique place. (B,L,D)

DAY 6: LOS ISLOTES AND LA PAZ
Awake this morning off the rocky island of Los Islotes, where we'll don flippers, a mask, and snorkel and swim with curious sea lions. Then we'll reposition to the colorful city of La Paz to garner insight into the culture of Mexico, soak in the vibrant street art, and stroll the lively "Malecon" on a guided walking tour. Dinner will be an unforgettable cultural experience, featuring local cuisine, dancing, and folklore. (B,L,D)

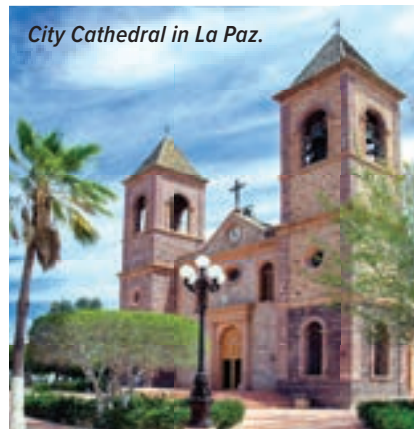

City Cathedral in La Paz.

DAY 7: EXPLORING THE SEA OF CORTEZ
Our plan is flexible as we explore some of the Sea's many uninhabited islands. We may go ashore at Isla San Francisco, where a sweeping



arc of white sand beach beckons you to kayak or stand-up paddleboard. Or, hike to the nearby ridge for unparalleled views over Isla Danzante with your naturalist. You may also visit the abandoned salt works on Isla Carmen. You'll get a chance to see the great diversity offered in the Sea of Cortez, and with some luck, spot the amazing wildlife. (B,L,D)

DAY 8: LORETO/DISEMBARK
Disembark in Loreto after breakfast and transfer to the city center. Visit the first mission in Baja California and the nearby museum to learn more about what makes this town so special. Enjoy free time to explore the quaint shops and vibrant side streets. After lunch, transfer to Loreto Airport for flights home. (B,L)

EXPEDITION DETAILS

DATES: 2020 Jan. 11*, 18, 25*; Feb. 1, 8*, 15, 22*, 29; Mar. 7*
2021 Jan. 9*, 16, 23*, 30; Feb. 6*, 13, 20*, 27; Mar. 6*

*These departures travel in the reverse.
Note: The exact order of stops may vary in order to maximize your experience.

SPECIAL OFFERS:

Book by Dec. 31, 2019 and receive a **\$350 AIR CREDIT** on the Jan. 11, 18 and Feb. 8, 2020 departures. Plus, we will waive the premium on solo cabins for solo travelers on select 2020 departures for savings of up to \$3,000.

EXCLUSIVE FAMILY OFFER: On select 2020 departures, take 25% off children or grandchildren age 22 and under with two full paying adults.

See insert on page 11 for offer details or call an Expedition Specialist.

BLUE & FIN WHALE LORETO EXTENSION

Further your exploration of this richly varied region with this exciting two-night extension. Visit expeditions.com/loreto for details.



Surfacing bottlenose dolphin in the Sea of Cortez, Baja California.

Thrilling and shorter!

WILD BAJA ESCAPE: THE WHALES OF MAGDALENA BAY

6 DAYS/5 NIGHTS —ABOARD NATIONAL GEOGRAPHIC SEA LION

Pricing from \$3,740 (See page 20 for details.)

This is no ordinary whalewatching experience: we'll literally anchor among the gray whales in Bahía Magdalena, where mothers and calves relax after the longest mammal migration on earth. We'll see and hear them around the ship, and venture out in expedition landing craft for exhilarating up-close encounters. We'll visit multiple sites in the 70-mile-long bay to maximize our opportunities for interactions. While whales may be the highlight, this area is home to so much more. Explore the mangroves by kayak. Fat-tire bike along remote beaches (we've got a fleet of bikes aboard). Beachcomb endless crescents of sand, studded with thousands of sand dollars. And revel in the vastness and serenity as you view the many species of birds in this world-renowned region.

EXPEDITION HIGHLIGHTS

- ▶ Live among gigantic gray whale mothers and their calves in the nursery waters of Bahía Magdalena. See them from the ship and local pangas, delighting in up-close encounters.
- ▶ Kayak and paddleboard stunning mangroves, or beachcomb along endless beaches.
- ▶ Explore diverse landscapes; fat-tire bike along desert island terrain.
- ▶ Scan the skies for bird species, from diving pelicans to magnificent frigatebirds.

EXPERIENCE & EXPERTISE

35+
YEARS
EXPERIENCE

Our expert expedition team will illuminate the wonders of Magdalena Bay from every possible angle. Your expedition leader, undersea specialist, Lindblad-National Geographic certified photo instructor and naturalists, plus a wellness specialist and video chronicler, are dedicated to ensuring an incredible voyage.

Visit our website to read staff bios for this expedition.



Lindblad Guests with a California gray whale.

DAY 1: LORETO/SAN CARLOS/EMBARK
Upon arrival in Loreto, transfer to San Carlos and embark *National Geographic Sea Lion*. Tonight we'll anchor off the coast of Isla Santa Margarita. (D)

DAY 2: BAHÍA ALMEJAS/REHUSA CHANNEL/ISLA MAGDALENA

Awake in Bahía Almejas, the southernmost part of the Bay. We'll make a special stop to view a large frigatebird colony on Isla Santa Margarita before heading out on our first whale watching trip of the voyage. The whales in Bahía Almejas tend to be very active, seemingly oblivious to our presence. As we explore this bay and the Rehusa Channel via local panga, our team will do whatever it takes to provide you with memorable and meaningful experiences. During lunch, we'll sail toward Isla Magdalena to explore the ever-shifting sand dunes on a cross-island walk to one of the most pristine beaches in the Pacific. Take a dip or tally the treasure found on what we affectionately call "sand dollar beach." (B,L,D)

DAY 3: TRANSIT THE HULL CANAL/BOCA DE SOLEDAD

Spend the morning transiting the scenic winding Hull Canal. Within its narrow channels, bordered by mangroves and sand dunes, and filled with abundant wildlife, we'll hang out on deck with our keen-eyed naturalists to spot species and hear expert commentary. Weather permitting, we'll explore the vast mangrove system via kayak and expedition landing craft. Bird-watching here can be excellent. Among the species we might see are diving pelicans, wheeling cormorants, terns, great blue herons, ibis, whimbrels, and willets. It's not unusual to see forty species of birds in just one day along these fertile shorelines.

This afternoon, we'll head out to explore the breeding grounds of Boca de Soledad. (B,L,D)



Treasures from "sand dollar beach."

DAYS 4 AND 5: BOCA DE SOLEDAD

Each winter, during their long migration, gray whales travel south from their Arctic feeding grounds to breed and give birth to their calves in these sheltered waters. "Grand Central" for California gray whales, we'll spend two full days observing, and with luck, interacting with these majestic creatures. Together with savvy local fishermen we've known for years, we'll venture out in expedition landing craft to view the numerous mother-calf pairs that thrive in this region. We'll also have an opportunity to explore the beaches, and if you're feeling up to it, grab one of our fat-tire bikes to roam the seemingly endless beaches. (B,L,D)

DAY 6: LOPEZ MATEOS/DISEMBARK/LORETO

After breakfast, disembark our ship and transfer to Loreto's city center. Choose to visit the first mission in Baja California, as well as the nearby museum to learn more about what makes this town so special. Enjoy free time to explore the quaint shops and vibrant side streets. After lunch, transfer to Loreto Airport for flights home. (B,L)



EXPEDITION DETAILS

DATES: 2020 Jan. 22, 27; Feb. 1, 6, 11, 16, 21; Mar. 2, 7, 12, 17
2021 Jan. 14, 19, 24, 29; Feb. 3, 8, 13, 18, 23, 28; Mar 5, Mar. 10

SPECIAL OFFERS:

EXCLUSIVE FAMILY OFFER: On select 2020 departures, take 25% off children or grandchildren age 22 and under with two full paying adults.

SOLO TRAVELER SAVINGS: Save up to \$2,000 when we waive the solo premium on solo cabins on select 2020 departures. See insert on page 11 for offer details or call an Expedition Specialist.

NATIONAL GEOGRAPHIC EXPERT

Travel with film producer and marine biologist **John Francis** on the Jan. 22 & 27, 2020 departures.

NEW! LORETO POST-EXTENSION

Further your exploration of this charming and richly varied region with this exciting two-night extension. See page 17.



Guests kayaking under mangroves.

BAJA CALIFORNIA: A REMARKABLE JOURNEY

15 Days/14 Nights—Aboard *National Geographic Venture* and *National Geographic Sea Lion*

Pricing from \$10,610 (See pages 18-20 for details.)

Embark on a comprehensive expedition that explores both the Pacific side of Baja California and the islands in the Sea of Cortez. Venture into the gray whale lagoons for up-close encounters, and then spend ample time exploring the Sea of Cortez and all its marine mammals. See scores of blue-footed boobies and pelicans, kayak into quiet grottos, and visit charming seaside towns.

EXPEDITION HIGHLIGHTS

- ▶ Get up-close views of gray whale mothers and their growing calves as they prepare for their journey back to Arctic feeding grounds.
- ▶ Kayak clear blue waters to search for wildlife, including magnificent frigatebirds, and investigate the intricacies of the shoreline.
- ▶ Snorkel the living sea: observe large schools of vibrantly colored fish, swim among playful sea lions, and much more.
- ▶ With more time for adventure, rely on your expedition leader to take you where wildlife will be at its best—including the remote oceanic island of San Pedro Mártir with clouds of nesting seabirds and crowds of sea lions onshore, and expanses of sea where huge pods of dolphins gather.

NATIONAL GEOGRAPHIC PHOTOGRAPHERS

Jonathan Kingston's work has appeared in *National Geographic* magazine, *The New York Times*, *The New Yorker*, and *The Wall Street Journal*. Join him on the **Mar. 16, 2020** departure.

Michael Melford is an award-winning photographer who has produced more than 50 stories for *National Geographic* and *National Geographic Traveler* magazines over the past 30 years. He will be on board the **Mar. 30, 2020** departure. Read full bios and find out more about Photo Expeditions at expeditions.com/photo.

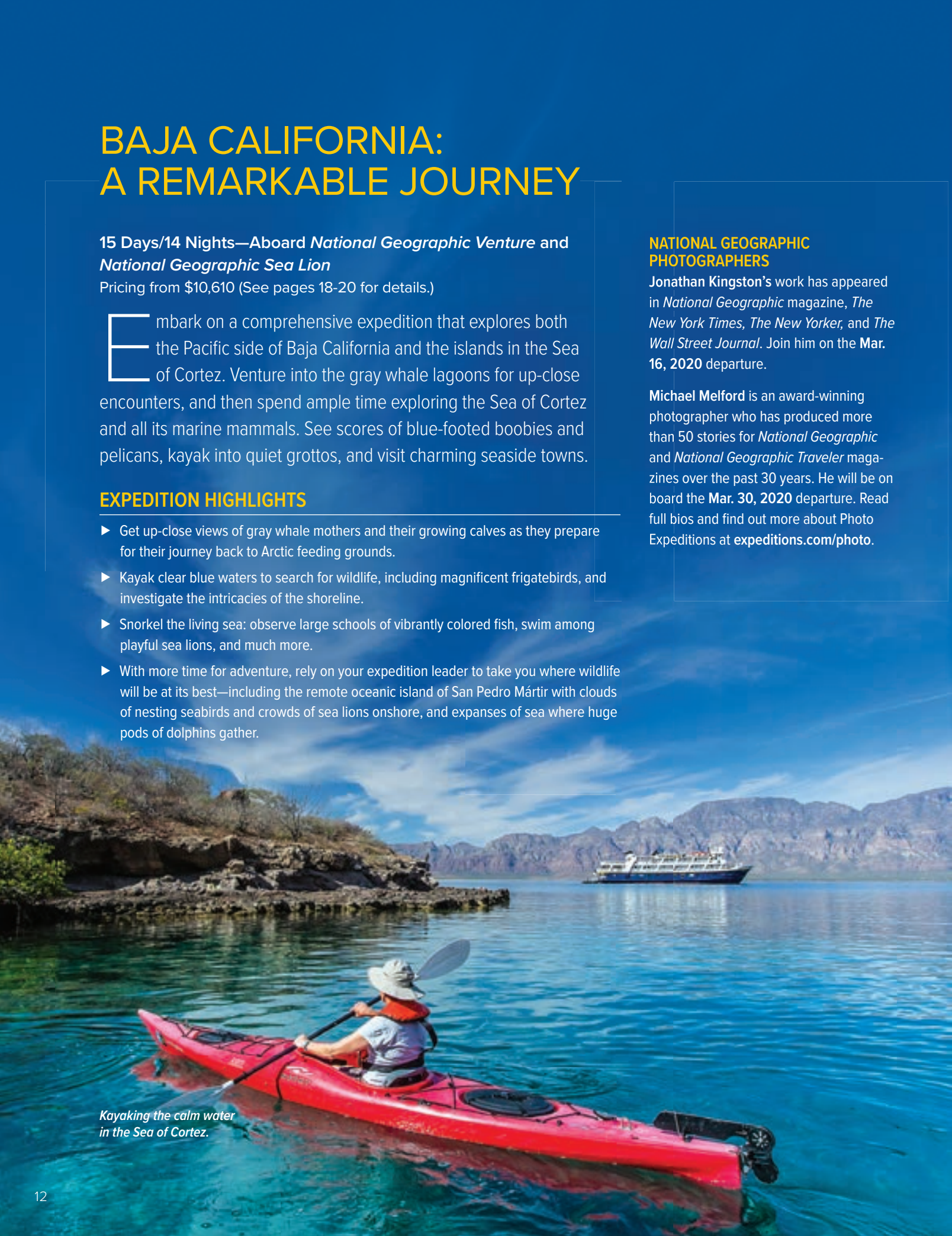

Kayaking the calm water
in the Sea of Cortez.

DAY 1: LORETO/SAN CARLOS/EMBARK
Upon arrival in Loreto, transfer to San Carlos and embark our ship. (D)

DAY 2: BAHÍA MAGDALENA
Explore the ever-shifting sand dunes of Isla Magdalena, on a cross-island walk to one of the most pristine beaches in the Pacific. Bird watching in this area can be excellent. We may observe pelicans and cormorants skimming the waters of the bay, or terns wheeling and darting as frigatebirds ride the thermals above, looking for an easy meal. Along the beaches, resident great blue herons feed on these fertile shorelines next to migratory shorebirds, including whimbrels and willets, as they refuel for their northbound journeys. (B,L,D)



California Gray Whale just below the surface.

DAYS 3 & 4: LAGUNA SAN IGNACIO
Laguna San Ignacio is a large bay and favored haunt of the gray whales in Baja. The ship will anchor at the mouth of this remote and important locale, while we observe the mother and calf pairs in local pangas. For some reason, the whales here seem to be friendlier than they are elsewhere. It's not unusual for mothers and calves to approach our boats, the calves often playing hide and seek—sometimes even welcoming a touch or a friendly chin scratch. (B,L,D)

DAY 5: AT SEA
As we travel south along the Pacific coast of the peninsula, there is a chance of seeing a wide variety of marine life, including the largest animal on Earth, the blue whale. (B,L,D)

DAYS 6–14: ISLANDS OF THE SEA OF CORTEZ
Cruise past the spectacular Friars Rocks at Land's End. For those who wish, we will arrange a visit to the historic town center of San José del Cabo. Isla San Pedro Mártir, Los Islotes, Isla San Francisco—these are some of the melodious names of islands scattered throughout this beautiful sea. After over 40 years of exploration here, we are still discovering new places and experiencing exciting events: bow-riding bottlenose dolphins, or sperm whales near our ship; a pod of fin whales feeding around a convergence zone. The best areas for whale watching remain consistent—the waters south of Isla Carmen, Canal de Ballenas up north, and near the mouth of Bahía Concepción. Whether on the Bridge of the ship, on expedition landing craft, or kayaks, we will be in prime position to observe them all. (B,L,D)

DAY 15: LORETO/DISEMBARK
Disembark in Loreto after breakfast and transfer to the city center. You'll have the opportunity to visit the first mission in Baja California, as well as the nearby museum to learn more about what makes this town so special. Enjoy free time to explore quaint shops and vibrant side streets. After lunch, transfer to Loreto Airport for flights home. (B,L)



EXPEDITION DETAILS
DATES: 2020 Mar. 16* 📷, 30 📷
2021 Mar. 15*, 15* 📷, 29 📷
📷 Photo Expedition

*These departures travel in reverse.
†This departure is aboard the 62-guest *National Geographic Sea Lion*.
See page 20 for details.

SPECIAL OFFERS:
Groups traveling with eight or more adults will receive 5% off on select departures. See insert on page 11 for offer details or call an Expedition Specialist.



Guests photographing at sunrise.

EXPLORING THE SEA OF CORTEZ: A LIVING SEA & DESERT ISLES

8 Days/7 Nights—Aboard *National Geographic Venture* and *National Geographic Quest*

Pricing from \$6,570 (See pages 18-19 for details.)

The pristine desert islands dotting the Sea of Cortez are places of incredible biodiversity set amid a UNESCO World Heritage Marine Site dubbed “the world’s aquarium” by Jacques Cousteau. Each of these islands is a world unto itself, with a palpable feel of rugged isolation. Hike among forests of cacti and along desert *arroyos* in bloom as you search for endemic flora and fauna. Watch for swirling plunge-diving brown pelicans, blue-footed and brown boobies, and the frenetic aerial activity of gulls and terns that often alerts us to large pods of acrobatic dolphins. With a flexible itinerary, decades of experience, and deep knowledge of wildlife habits, this unique journey combines the beauty and biodiversity of this legendary region with a stimulating sense of adventure.

EXPEDITION HIGHLIGHTS

- ▶ Experience a voyage of pure discovery in a UNESCO World Heritage Site, with a flexible itinerary chosen by the region’s most knowledgeable staff to maximize wildlife sightings.
- ▶ Venture further north in the Sea of Cortez to explore remote and seldom visited islands, such as Isla Rasa, a breeding ground for 90% of the world’s Heermann’s gulls and a large population of elegant terns.
- ▶ Search for pods of dolphins and other marine life. With luck, catch a leaping mobula ray as they eject from the sea and belly-flop back in the water.
- ▶ Explore water-level caves by kayak, hike uninhabited beaches, stand-up paddleboard, and snorkel among tropical fish and acrobatic sea lions.

NATIONAL GEOGRAPHIC EXPERT

Marine biologist, photographer, and conservationist **Octavio Aburto** will join the **Apr. 13, 2020** departure. Octavio focuses his photographic outreach and scientific research on the conservation of marine habitats and commercially important species and their fisheries.

Learn more about staff and guest speakers at expeditions.com/experts.

California sea lions basking in the sun.

DAY 1: LORETO/EMBARK

Arrive in Loreto and embark our ship. (D)

DAYS 2–7: EXPLORING THE SEA OF CORTEZ

Our routing is designed with flexibility in mind, to maximize opportunities for wildlife sightings. It will most likely include the islands and activities listed below, although the order may vary. (B,L,D)



Pinto Chuckwalla, Isla San Esteban.

ISLAS SAN ESTEBAN AND SAN PEDRO MÁRTIR:

Walk up a desert wash, to search for desert songbirds such as the handsome black-throated sparrow, listen for the cascading

song of the canyon wren, and search for the endemic pinto chuckwalla—a plump, harmless desert lizard. Later visit Isla San Pedro Mártir, a 1,000-foot-high guano-covered island that is home to thousands of seabirds: brown pelicans, magnificent frigatebirds, Brandt’s cormorants; and California sea lions.

ISLA SAN MARCOS:

At Isla San Marcos, there is a beautiful shoreline for swimming, snorkeling, and kayaking. In the afternoon, we are again in rich waters. We are on the lookout for pods of dolphins—with common and bottlenose being the most frequently encountered species. With luck they will join us as we go, riding the bow wave and sometimes leaping from the water.

ISLA SAN JOSÉ:

One of the larger islands in the Sea of Cortez, San José, offers several landing possibilities depending on conditions and the whim of the moment. Photograph the ochre cliffs of the island’s eastern shore, hike an “enchanted,” cactus-laden *arroyo*, or visit the abandoned salt works to the west. Snorkel with sea lions and discover rare wildlife among the desert islands.

BAHÍA LORETO MARINE PARK:

This morning we’ll search the waters south of Isla Carmen for fin whales, which researchers



have recently concluded may be part of a resident population. Bottlenose and common dolphins are frequently encountered. Later we visit an island of Bahía Loreto Marine Park, with ample time for kayaking, snorkeling, stand-up paddleboarding, and possibly hiking. In the evening, enjoy a beach barbecue under the desert sky.

ISLAS LOS ISLOTES AND SAN FRANCISCO:

At Los Islotes, don flippers, a mask and snorkel (which we’ll gladly provide) and swim with curious sea lions. We have a leisurely afternoon to swim, kayak, or hike at Isla San Francisco. Look skyward for yellow-footed gulls, brown pelicans, and blue-footed boobies.

DAY 8: LORETO/DISEMBARK

Disembark and explore Loreto, where we will have the opportunity to visit the first mission in Baja California, as well as the nearby museum to learn more about what makes this town so special. Enjoy free time to explore quaint shops and vibrant side streets. After lunch, transfer to Loreto Airport for flights home. (B,L)



Kayaking, Isla San Marcos.

EXPEDITION DETAILS

DATES: 2020 *National Geographic Quest:* Apr. 12; *National Geographic Venture:* Apr. 13; Dec. 20, 27
2021 *National Geographic Venture:* Apr. 12

SPECIAL OFFERS:

EXCLUSIVE FAMILY OFFER: On select 2020 departures, take 25% off children or grandchildren age 22 and under with two full paying adults.

SOLO TRAVELER SAVINGS: Save more than \$3,000 when we waive the solo premium on solo cabins on the Apr. 12, 2020 departure.

See insert on page 11 for offer details or call an Expedition Specialist.

WILD BAJA ESCAPE: SERENITY & SEA LIFE IN THE SEA OF CORTEZ

5 Days/4 Nights—Aboard *National Geographic Venture*

Pricing from \$2,780 (See pages 18-19 for details.)

A genuinely innovative hybrid—a four-night getaway that feels like an authentic escape from the everyday. De-stress, detox or simply play or workout in the uninhabited wilds of Isla San Francisco and Isla San José in the beautiful Sea of Cortez. With the brand-new 50-cabin *National Geographic Venture* as your mobile base camp, go where the wild things—and few others—are. Breathe deep, push hard, and chill at a BBQ under the stars.



Swimming with graceful sea lions.

DAY 1: SAN JOSÉ DEL CABO/LA PAZ/ EMBARK

Arrive in Los Cabos and transfer to La Paz, where you'll embark *National Geographic Venture* this afternoon. Set sail for a sunset cruise of Bahía La Paz en route to Isla San Francisco. (D)

DAYS 2 & 3: SAN JOSÉ CHANNEL/ ISLA SAN FRANCISCO

Witness a spectacular Baja sunrise this morning, while searching for marine mammals in the upper San José Channel. Hear naturalist talks and learn photography basics during an early morning at sea. Before lunch, go ashore at Isla San Francisco, where a sweeping arc of white sand beach beckons you to roll out a yoga mat. Explore nearby tide pools with your naturalists, or spend the afternoon stand-up paddleboarding, snorkeling, and kayaking. Hike to the nearby ridge for unparalleled views just before sunset. Wind down with an on-deck yoga class or a chair massage,

then go ashore for a beach barbecue dinner followed by a bonfire under the stars. (B,L,D)

DAY 4: ISLA SAN JOSÉ AND LOS ISLOTES

Watch the cliffs light up as your wellness specialist leads a morning yoga or qi gong class, on deck. Explore as much or as little as you like, with the ship as your mobile base camp—taking advantage of every wellness option, including hiking with your wellness specialist for mindfulness and stretching on the trail. Enjoy Isla San José as you set out on foot to explore the *arroyos*. Or, grab a kayak or paddleboard and see what you can find along the beautiful shorelines. Snorkel with playful and curious sea lions or photograph their antics from a Zodiac. (B,L,D)

DAY 5: LA PAZ/DISEMBARK/ SAN JOSÉ DEL CABO

Disembark in downtown La Paz and transfer to Los Cabos airport for flights home. (B)



EXPEDITION DETAILS

DATES: 2019 Dec. 23, 29 2020 Jan. 2, 6; Dec. 12, 16 2021 Jan. 3

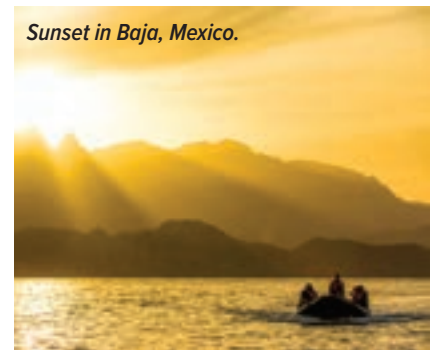

Sunset in Baja, Mexico.

SPECIAL OFFERS:

EXCLUSIVE FAMILY OFFER: On select 2020 departures, take 25% off children or grandchildren age 22 and under with two full paying adults.

SOLO TRAVELER SAVINGS: We will waive the solo premium on solo cabins on select departures for a savings of up to \$1,400.

See insert on page 11 for offer details or call an Expedition Specialist.

SWIM WITH WHALE SHARKS

Enhance your Baja experience with this thrilling two-night extension. Learn more at expeditions.com/whaleshark

OPTIONAL EXTENSIONS

MAKE THE MOST OF YOUR TIME IN BAJA



LA PAZ + WHALE SHARKS

3 DAYS/2 NIGHTS POST-VOYAGE

From \$740

Fall under the spell of enchanting La Paz as you delve into the region's rich history through its cuisine, architecture, and charming museums. Visit the airy, immense cathedral of La Paz and learn the story of its 70-year construction. Stroll along the cobblestone streets of a small mining village and indulge in curated menus and inspiring meals. Cap it off with a thrilling, **once-in-a-lifetime swim with the largest fish on the planet, the gentle giant whale shark.**

Available on *Wild Baja Escape: Serenity & Sea Life in the Sea of Cortez* (page 16).

Wow!

LORETO + BLUE WHALES

3 DAYS/2 NIGHTS POST-VOYAGE

From \$1,190

Add an exploration of Loreto's inland wildness to your coastal expedition, and discover the region's human history through its missions and villages. Visit stunning San Javier, a mission built in the 1700s by Jesuits and see the surrounding town, with streets and buildings largely untouched since 1875, then hike outside the village to experience Baja's inland wildness. In the Loreto National Marine Reserve board local boats for a chance to see magnificent blue and fin whales, the two largest animals on Earth. Hike through the fascinating ecosystems of the desert and canyons of the Sierra de la Gigante. Available on most departures of *Baja California & the Sea of Cortez: Among the Great Whales* (page 8) and *Wild Baja Escape: the Whales of Magdalena Bay* (page 10).





NATIONAL GEOGRAPHIC VENTURE & NATIONAL GEOGRAPHIC QUEST

CAPACITY: 50 cabins accommodating 100 guests
REGISTRY: United States. **OVERALL LENGTH:** 238 feet.

Sister ships *National Geographic Venture* and *National Geographic Quest* (launched 2019) are the latest additions to our fleet.. Designed with over 50 years of expedition heritage and built in the U.S.A., they set a new standard in exploration and comfort.

PUBLIC AREAS: Global gallery; fitness center; LEXspa; lounge with full service bar and facilities for films and presentations; observation deck; mudroom with lockers for expedition gear; and a partially covered sundeck with chairs and tables. Our “open bridge” provides guests an opportunity to meet our officers and captain, and learn about navigation.

MEALS: Served in single seatings with unassigned tables for an informal atmosphere and easy mingling. Breakfast and lunch are wide-selection buffets with chef-action stations, while dinners are primarily served plated. Menu emphasizes local fare.

CABINS: All cabins face outside with windows or portholes, private facilities, and climate controls. Category 4 cabins have step-out balconies.

EXPEDITION EQUIPMENT: A fleet of 8 Zodiacs and 24 kayaks, Remotely Operated Vehicle (ROV), hydrophone, splash-cam, underwater video camera, video microscope, paddleboards, and snorkeling gear for all guests (where applicable).

SPECIAL FEATURES: Guest internet access, elevator, Lindblad-National Geographic certified photo instructor, video chronicler, undersea specialist, and ship physician.

WELLNESS: The vessel is staffed by a wellness specialist and features a gym with an elliptical machine, treadmill, exercycles, handweights, and resistance bands. Treatments in the LEXspa are available by appointment.

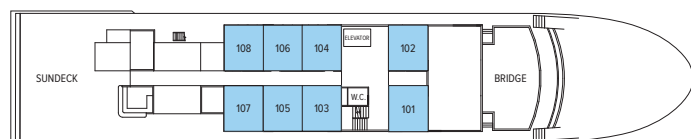

OBSERVATION DECK

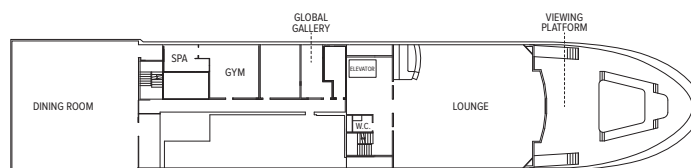

LOUNGE DECK



UPPER DECK



MAIN DECK



Left to right: Captain Cook raises a glass; *National Geographic Venture*; our lounge is the hub of the expedition community; viewing platform; Category 5 cabin; Category 4 cabin with lower single beds (which can be converted to a Queen) and a private step-out balcony. Select cabins connect via an inside doorway.

CATEGORY 1: Main Deck #301-306 Cabins feature two lower single beds that can convert to a Queen, a writing desk, and two portholes.

CATEGORY 2: Main Deck #307-315 Cabins feature two lower single beds that can convert to a Queen, a writing desk, and two portholes.

CATEGORY 3: Upper Deck #201-206 Cabins feature two lower single beds that can convert to a Queen, a writing desk, and two large view windows.

CATEGORY 4: Upper Deck #207-229 Cabins feature two lower single beds that can convert to a Queen, a writing desk, sliding glass door, and small, private balcony.

CATEGORY 5 (SUITE): Observation Deck #101-108 Cabins feature two lower single beds that can convert to a Queen, large view windows, an expanded bathroom, writing desk, ample storage space, and a convertible sofa bed to accommodate a third person.

NOTE: Solo Occupancy cabins are available in Categories 1 and 2 only. Third person rates are available in Category 5 cabins at one half the double occupancy rate.

Connecting Cabins via internal doorway access: Main Deck: #312-314, #311-315, #306-308, #305-307; Upper Deck: #224-226, #225-227

Prices are per person, double occupancy unless indicated as solo.

ITINERARY	YEAR	CAT. 1	CAT. 2	CAT. 3	CAT. 4	CAT. 5 SUITE	CAT. 1 SOLO	CAT. 2 SOLO	ADVANCE PAYMENT	NOTE
Baja California and the Sea of Cortez: Among The Great Whales – Page 8	2020	\$5,990	\$6,770	\$7,230	\$7,990	\$8,880	\$9,150	\$9,990	\$750	Sample Airfares: Round-trip Los Angeles/Loreto: Economy from \$650; Business from \$1,140.
	2021	\$6,270	\$6,990	\$7,570	\$8,350	\$9,270	\$9,550	\$10,400		
Baja California: A Remarkable Journey – Page 12	2020	\$11,530	\$12,750	\$13,610	\$15,180	\$16,740	\$17,300	\$19,130	\$1,500	Sample Airfares: Round-trip Los Angeles/Loreto: Economy from \$650; Business from \$1,140.
	2021	\$11,650	\$12,890	\$13,760	\$15,350	\$16,890	\$17,450	\$19,290		
Exploring the Sea of Cortez: A Living Sea & Desert Isles – Page 14	2020	\$6,570	\$7,200	\$7,700	\$8,590	\$9,450	\$9,860	\$10,820	\$750	Sample Airfares: Round-trip Los Angeles/Loreto: Economy from \$475; Business from \$1,140.
	2021	\$6,690	\$7,350	\$7,850	\$8,690	\$9,590	\$9,990	\$10,950		
Wild Baja Escape: Serenity & Sea Life in the Sea of Cortez – Page 16	2019/20	\$2,780	\$3,560	\$4,190	\$4,720	\$5,190	\$4,180	\$5,350	\$750	Sample Airfares: Round-trip Los Angeles/Los Cabos: Economy from \$475; Business from \$1,140.
	2020/21	\$2,880	\$3,560	\$4,190	\$4,590	\$4,990	\$4,100	\$5,200		

Prices quoted in this brochure are valid as of the time of printing, are subject to modification, and are not guaranteed until booking and required deposit are made. For current rates and details visit expeditions.com for the most up-to-date pricing. For best pricing book early.



NATIONAL GEOGRAPHIC SEA LION

CAPACITY: 62 guests in 31 outside cabins.

REGISTRY: United States. **OVERALL LENGTH:** 152 feet.

PUBLIC AREAS: Our ship features a library; global market; lounge with full-service bar and facilities for films, slide shows and presentations; observation deck; partially covered sun deck with chairs and tables, and LEXspa. Our “open bridge” provides guests an opportunity to meet our officers and captain, and learn about navigation.

MEALS: Served in single seatings with unassigned tables for an informal atmosphere and easy mingling. Breakfasts are wide-selection buffets, and lunch is often served family style. Dinners are primarily served plated. Menu emphasizes local fare.

CABINS: All face outside with windows, private facilities, and climate controls.

EXPEDITION EQUIPMENT: Bow camera, hydrophone, kayaks, fleet of paddleboards, splash-cam, underwater video camera, video microscope, wet suits and snorkel gear, and expedition landing craft.

SPECIAL FEATURES: Guest internet access. A certified photo instructor and a video chronicler are on board all voyages. A ship’s doctor is on board in Baja. An undersea specialist is on board in Baja and Alaska.

WELLNESS: The vessel is staffed by a wellness specialist and features exercise equipment, LEXspa, and outdoor stretching area.

CATEGORY 1: Main Deck #300-305—Conveniently positioned between the dining room and lounge, these cabins feature two single lower beds, and a large view window.

CATEGORY 2: Bridge Deck #100-104; Upper Deck #200-212, 215—These well-located cabins include two lower single beds and a view window.

CATEGORY 3: Bridge Deck #105, 106; Upper Deck #214, 216, 217, 219—These cabins feature a seating unit with table and two large view windows. Upper Deck cabins include two lower single beds which can convert to a double bed and a pull-out single bed for a third person; Bridge Deck cabins include two lower single beds only.

Note: Solo Occupancy cabins are available in Categories 1 and 2 only. Third person rates are available in certain categories at one half the double occupancy rate.

Shared Accommodations: Shares can be arranged at the double occupancy rate in Categories 1 and 2 only.

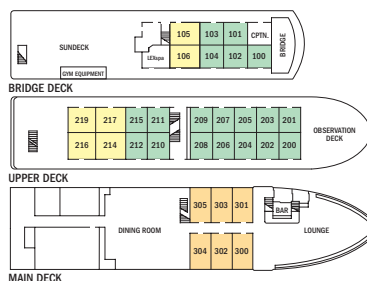

Prices are per person, double occupancy unless indicated as solo.

ITINERARY	YEAR	CAT. 1	CAT. 2	CAT. 3	CAT. 1 SOLO	CAT. 2 SOLO	ADVANCE PAYMENT	NOTE
Wild Baja Escape: The Whales of Magdalena Bay – Page 10	2020/21	\$3,740	\$4,370	\$4,930	\$5,620	\$6,550	\$750	Sample Airfares: Round-trip Los Angeles/Loreto: Economy from \$475; Business from \$1,140.
Baja California: A Remarkable Journey – Page 12	2021	\$10,610	\$12,210	\$13,680	\$15,920	\$18,320	\$1,500	Sample Airfares: Round-trip Los Angeles/Loreto: Economy from \$650; Business from \$1,140.

Prices quoted in this brochure are valid as of the time of printing, are subject to modification, and are not guaranteed until booking and required deposit are made. See our website at expeditions.com for the most up-to-date pricing.

INCLUSIVE PRICING MEANS VALUE + EXPERIENCES

We include just about everything you have the opportunity to do as part of your expedition aboard ship and ashore. The only things not included are those of a personal nature—alcohol, internet usage, tips to the crew, wellness treatments, and other specialized arrangements.

ABOARD SHIP

- ✓ All meals and non-alcoholic beverages
- ✓ Cappuccinos, lattes & complimentary environmentally friendly refillable water bottle
- ✓ 24-hour coffee, tea & soda on demand
- ✓ Hors d'oeuvres & snacks during lounge recap
- ✓ Fitness center
- ✓ Fully stocked library
- ✓ The guidance and company of our expedition staff

ASHORE

- ✓ Meals on land, as indicated in itinerary
- ✓ Special access permits, park fees, port taxes
- ✓ Transfers to and from group flights
- ✓ The expertise of our expedition staff

ACTIVITIES

- ✓ All excursions
- ✓ Expedition landing craft & kayak explorations
- ✓ Snorkeling and paddleboarding
- ✓ Lectures & presentations in the lounge
- ✓ Morning stretch classes with wellness specialist

RESERVATION INFORMATION

Terms & Conditions: For complete terms and conditions please visit www.expeditions.com/terms

Costs Include: All accommodations aboard ship or in hotels per itinerary or similar, all meals and non-alcoholic beverages aboard ship, meals on land as indicated accompanied by non-alcoholic beverages, air transportation where indicated as included, shore excursions, sightseeing and entrance fees, special access permits, transfers to and from group flights, use of kayaks, tips (except gratuities to ship's crew), taxes and service charges, services of a ship physician and services of our expedition staff. Unused services or items included in our programs are non-refundable.

Not Included: Air transportation (except where shown as included), extensions, passport, visa, immigration fees, meals not indicated, alcoholic beverages, travel protection plan, items of a personal nature, such as e-mail, voyage DVD, laundry.

Airfare: For all programs, airfare is an additional cost unless otherwise indicated. Sample airfares are subject to change. We will gladly assist in making your air arrangements for a \$50 per person service fee.

Reservations: To reserve your place, an advance payment is required at the time of reservation.

Final Payment: Payment is due no later than 90 days prior to departures, depending on the expedition. Payment schedules may vary for certain longer voyages, due to high demand. We reserve the right to cancel your reservation if payment has not been received by final payment due date.

Travel Protection Plan: We strongly recommend that you take advantage of our Travel Protection Plan. This plan offers comprehensive coverage to protect you from cancellation fees, costs incurred due to trip delays/interruption, medical assistance, and damaged or lost baggage, and provides medical assistance and evacuation during your travels. Our Travel Protection Plan is available for U.S. and Canadian residents only, and may be purchased any time prior to final payment due date. If you are not satisfied for any reason, you may return your plan within 10 days after purchase. Your premium will be refunded if canceled within 10 days, provided you have not already departed on the trip or filed a claim. When so returned, the coverage under the plan is void from the original date of purchase.

Responsibility and Other Terms & Conditions: Certain provisions concerning, among other things, limitations of Lindblad Expeditions' and the National Geographic Society's liability for loss of property, injury,

illness or death during the voyage will be provided to all guests on the ship's ticket sent prior to departure, and are also available on our website at www.expeditions.com/terms, or upon request. By registering for a trip, the guest agrees to all such terms and conditions.

Note: Itineraries and prices listed in this brochure are as of publication date and are subject to change. Under normal conditions the total expedition price is guaranteed at the time of booking. However, our expedition pricing is determined far in advance of initial departure on the basis of then-existing projections of fuel and other costs. In the event of increases in those costs, including but not limited to increases in the price of fuel, currency fluctuations, increases in government taxes or levies, or increased security costs, we reserve the right to adjust the price of your expedition or add a surcharge to cover such unexpected increases. We will always provide an explanation of the reason for increase in costs.

Cancellation Policy: Cancellation penalties may apply after payment is received. Please visit www.expeditions.com/terms for complete cancellation policies.

©2019 Lindblad Expeditions

Lindblad Expeditions and the Eye are the trademarks of Lindblad Expeditions. All rights reserved.

NATIONAL GEOGRAPHIC and the Yellow Border are the trademarks of the National Geographic Society. All rights reserved.

Photo Credits: Terry Allen/Alamy, Marc Cappelletti, David Cothran, Sarah Culler, Rab Cummings, Jennifer Davidson, Kyle Furey, Bennett Goldberg, Eric Guth, Ralph Lee Hopkins, D. Hurst/Alamy, Sven-Olof Lindblad, Jeff Litton, Michael S. Nolan, Gary D. Paige, Rich Reid, Ryder Redfield, Marco Ricca, Shutterstock, Ian Strachan, Rikki Swenson, David Vargas.

**For Reservations:
Contact your travel advisor or Lindblad Expeditions
1.800.EXPEDITION (1.800.397.3348)**

**Reservation Hours: Monday – Friday 9am – 9pm ET
Saturday & Sunday 10am – 5pm ET**

**Lindblad Expeditions, Inc., 96 Morton Street, New York, NY 10014
Phone: 212.261.9000 • Fax: 212.265.3770**

**For additional information and online reservations,
visit us on the Web: www.expeditions.com**

Account Number:

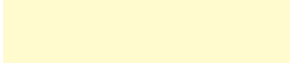

1.800.EXPEDITION | WWW.EXPEDITIONS.COM

 Printed on 10% recycled content paper with soy-based inks. We recommend that you pass this along for others to enjoy or recycle.

BAJ-110

SEE INSERT FOR SPECIAL OFFER DETAILS

 Baja Offers For Families in
Small Groups or Large, Friends
Traveling Together And Solo
Travelers Too!

