

EXPLORING CALIFORNIA

FROM SAN FRANCISCO
TO MONTEREY BAY

CHANNEL ISLANDS
NATIONAL PARK

SOCAL COAST TO
CHANNEL ISLANDS
& DOWN TO BAJA

2019-2020 VOYAGES | [EXPEDITIONS.COM](https://www.lindblad.com/expeditions)

WHEN CALIFORNIA W



Map of California as an island, by Joan Vinckeboons, ca. 1650—from the Glen McLaughlin Collection at Stanford University.

AS AN ISLAND



THE MYTH OF CALIFORNIA AS AN ISLAND PERSISTED AMONG CARTOGRAPHERS

for centuries. Glen McLaughlin, collector of nearly 800 Island of California maps (including his first purchase, seen here) now held by Stanford University, described his fascination, “I was intrigued by the mythical representation of my chosen state and the map became a great conversation starter as guests would remind me that California was still a mythical place in their minds due to its lifestyle, freedom, opportunity, creativity, and climate—in short a paradise on earth.”

In 2013 Rebecca Solnit, author of *Infinite City: A San Francisco Atlas*, received research access to the McLaughlin collection and in an essay entitled ‘An Island Is Anything Surrounded By Difference: Thoughts on Maps and History,’ mused “To me an island is anything surrounded by difference...and California—a densely populated landscape of great biological diversity and richness surrounded by ocean, desert, and mountains...is all kinds of island.”

This is the California our expeditions seek to discover—not disconnected from the continent, looking like a large green vegetable, but a distinct and separate entity nonetheless, with its own ecology, and arguably its own cultures, as well. Join us as we head out, equipped with 21st-century maps and technology to make a series of exhilarating, perhaps even surprising, discoveries in this captivating region.

**Wild California Escape:
San Francisco to Monterey Bay
PAGE 10**



**Wild California Escape:
Channel Islands National Park
PAGE 14**



**From Southern California to Baja:
Sailing the Pacific Coast
PAGE 18**



SPECIAL OFFER:

- Book any 2019 departure in this brochure by Oct. 31, 2019 and receive a 16" x 11.3" print of this 1605 map, with our compliments. See page 24 for offer details.



THE NEW GOLD RUSH: DISCOVER THE CALIFORNIA COAST





WHEN YOU LOOK AT CALIFORNIA THROUGH AN EXPLORER'S LENS, there's so much to discover—an exciting prospect for 'left coast' lovers, and proof that far-reaching travel is closer than you think. While many have marveled at the Oz-like view of the San Francisco skyline on approach to the city, few know how dazzling it is when viewed from the deck of the *National Geographic Venture* as we embark on our Bay Area exploration. Or how much 'wild' there is to discover. Angel Island, for example, invites our kayaks to trace its rugged coastline or hikers to marvel at its panoramic views. Heading north to Monterey, we experience the coastal wildness and then examine its biodiversity in-depth on a behind-the-scenes visit to California's acclaimed Monterey Bay Aquarium.

It's stunning to think that the kind of wildness we find on the Channel Islands exists merely a few nautical miles from the second-most densely populated city—39.6 million residents—in the U.S. And that it's one of the least known and largest of our national parks. Voyage from Los Angeles to La Paz, and you'll travel back in time, watching the coast grow wilder, seeing where Hernan Cortes and the Jesuit missionaries who followed in his wake, explored, mapped, and catalogued flora and fauna. And as a voyage finale, snorkel Cabo Pulmo National Marine Park, the only hard coral reef in North America, with over 220 species of fish.



“The morning sun illuminated a pod of dolphins drawn to our wake, creating stark silhouettes of common dolphins and California sea lions leaping over the surface of the glassy water. Closer to shore, harbor seals hid amongst giant kelp and waves crashed against sandstone cliffs. The land called to us in the afternoon with hikes up Cherry Canyon and, for some, encounters with the endemic island fox. With a perfect mix of sea and sand, today was the best introduction to the possibilities hidden in the Channel Islands.

— EMILY PICKERING
Naturalist/Expedition Diver
Daily Expedition Report, 12/8/18





ONE OF THE RICHEST & MOST BIO-DIVERSE REGIONS IN THE WORLD

CALIFORNIA SPANS A NUMBER OF ECO-REGIONS AND MARINE



habitats. It has over 2,000 endemic species. And it boasts superlatives: the largest, tallest, and oldest trees in the nation, plus the rarest—the Torrey Pines that we see on two Channel Islands. Cupped within the span of coastline from San Pedro to L.A., these islands are home to 145 endemic plant and animal species. With acres of trails to hike, sea caves to paddle and snorkel, plus stunning landscapes and bird colonies to photograph, the Channel Islands, explored on two of our itineraries, will prove an exhilarating discovery. California also has endangered species, and on a visit to the Monterey Aquarium, you'll encounter one of the most appealing: sea otters. And while visiting California vineyards is hardly unusual on a visit to the Bay Area, understanding the forces of nature underlying California wine country's *terroir* is bound to heighten your savor. One of the most interesting eco-systems we explore lies in the Baja region where a peninsula divides the Pacific from the Gulf of California. It's where the desert meets the sea, and where a living sea teems with leaping dolphins, diving sea birds, and playful sea lions carving tunnels through huge schools of jackfish. It's where towering cacti stand sentinel, and the golden hour bathes the landscape in a light so effulgent photographers practically weep. Home to the Gold Rush, the psychedelic era, and the silicon boom, California is, by nature, a virtual island of spectacular natural and cultural richness.



SHIPS NIMBLE ENOUGH TO GET YOU DEEP INTO AWESOME PLACES

OUR AUTHENTIC EXPEDITION SHIPS ARE DESIGNED TO provide up-close experiences in the planet's wild, remote places. All our ships are equipped with a full roster of cool tools: a fleet of expedition landing craft, kayaks, and stand-up paddleboards. In addition, video tech enables our undersea specialist to dive, capture the deep, and present the world beneath the ship to you in onboard presentations—for a full 360° sense of California.

Our expedition landing craft enable us to land where there are no docks, ports, or piers. It's this kind of access that lets you discover what you might otherwise miss: quiet inlets and indented shorelines to paddle; bike-friendly trails; hiking paths that lead past an endemic fox. You'll experience California with all your senses, whether you're on deck scanning the horizon for sea birds or watching the sunsets paint an *arroyo* pink at a beach BBQ. Unparalleled access is what gives you incredible stories to share, a priceless stock of memories, and thanks to Lindblad-National Geographic certified photo instructors aboard each departure, the best photos of your life.

▶ See each of our ships ahead—on pages 22-25

“We are delighted to introduce you to our ships: the brand-new 100-guest *National Geographic Venture*, and her sister ship, *National Geographic Quest*; and the 62-guest sister ships, *National Geographic Sea Bird* and *National Geographic Sea Lion* (below). Each is designed to give a complement of guests an intimate, inclusive experience of the awesome geographies featured in this brochure. Each is well-adapted to its specific itinerary, able to give you the exhilaration of authentic, personal exploring with expert naturalists, and curious, intelligent fellow guests. Choose the voyage that interests you, assured that any of our purpose-built ships will provide an incomparable feeling.”

— SVEN-OLOF LINDBLAD
CEO & Founder



OUR SHIPS



DISCOVER A SIDE OF THE BAY AREA KNOWN TO FEW

EMBARK ON A VOYAGE AMONG THE WILDNESS, CULTURE, AND SERENITY

of these spectacular bays. Explore historic Angel Island, which served as a staging ground for San Francisco's immigrants for decades and is now taken over by wilderness. Fall under the spell of California's wine country and enjoy an exclusive interactive cooking demonstration at the famed Culinary Institute of America at Greystone's campus in St. Helena. Go on a private, behind-the-scenes tour at the Monterey Bay Aquarium and hear about the ongoing research at this premier institution. And throughout, take in the stunning vistas on hikes, kayaking excursions, or with a cocktail in hand on the deck of our ship.



EXPEDITION HIGHLIGHTS

Get a rare insider look at the Monterey Bay Aquarium • Sail past San Francisco's glittering skyline at a sunset cocktail party • Hike to the summit of historic Angel Island for spectacular views • Discover the rolling vineyards and quaint towns of California wine country • See endangered sea otters • Participate in a local conservation project • Kayak and stand-up paddleboard picturesque shorelines • Learn the history of Cannery Row, once lined with numerous sardine-canning factories and the setting of a Steinbeck novel • Visit the historic Mare Island Naval Shipyard, closed to the public for 150 years • Spot otters, seals, sea lions, and myriad seabirds





NEW

ITINERARY: WILD CALIFORNIA ESCAPE: SAN FRANCISCO TO MONTEREY BAY

6 DAYS/5 NIGHTS—ABOARD *NATIONAL GEOGRAPHIC VENTURE*
PRICING FROM \$3,770

(SEE PAGES 22-23 FOR DETAILS)

EXPEDITION DETAILS

2019 Date: Nov. 21

SPECIAL OFFERS:

- CALIFORNIA ISLAND MAP, YOUR GIFT Printed on premium fine art paper, this archival Map of California as an Island by Joan Vinckeboons, ca. 1650 (see page 2) is a definite conversation piece. Receive it as our thank you for booking this voyage.
- Book by Sep. 30, 2019 and receive a \$350 air credit per person. Plus, we will waive the solo premium on solo cabins for this departure.
- Book six or more under one booking and save 10%. See page 26 or call for details.

ITINERARY AT A GLANCE

Day 1	San Francisco/Embark
Day 2	Angel Island
Day 3	Monterey Bay and Point Lobos State Natural Reserve
Day 4	Monterey Bay Conservation Program
Day 5	Vallejo, California Wine Country
Day 6	San Francisco/Disembark

▶ Visit expeditions.com/SF_escape for a day-by-day itinerary.

WILD CALIFORNIA ESCAPE: SAN FRANCISCO TO MONTEREY BAY

EXCELLENT VINTAGE

Explore the golden rolling hills of wine country pausing in charming towns nestled among the vineyards to sample local vintages and cheeses.

Vallejo-California
Wine Country

Angel Island

Treasure Island

San Francisco

GATEWAY TO AMERICA

Angel Island once served as an entrypoint for immigrants. Learn its history, hike to the island's summit for spectacular San Francisco views, or explore the rugged coast by kayak.

GET COOKING

Partake in an interactive cooking demonstration at the famed Culinary Institute of America at St. Helena and then enjoy lunch and a wine tasting.

HISTORY IN A CAN

Learn about Cannery Row, the Steinbeck setting and former site of sardine canning facilities—now a haven for endangered sea otters and other marine wildlife.

MAKE A DIFFERENCE

Roll up your sleeves during a day of work on a local conservation project in Monterey Bay while learning about the region's natural and cultural heritage.

Monterey Bay

BEHIND-THE-SCENES

Get a private tour of the inner workings of the famed Monterey Bay Aquarium and learn about ongoing research.

Monterey

Point Lobos State
Marine Park





DISCOVER A RICHLY BIODIVERSE NATIONAL PARK UNLIKE ANY OTHER

TO REACH THE AWE-INSPIRING CHANNEL ISLANDS NATIONAL PARK, YOU NEED A ship—and everything you want to truly explore them is aboard ours. A welcoming crew, smart naturalists, a wellness specialist, and even a Lindblad-National Geographic certified photo instructor ensure an enriching, immersive experience and the pictures to prove it—and our paddleboards, kayaks, and expedition landing craft get you up-close to otherwise inaccessible beauty and wildness. You'll actively explore unmarred landscapes, revel in pure nature, and rejuvenate mind, body, and soul with our well-being programs. Discover inspiring islands and learn their intriguing human and geological history from a Channel Islands National Park Ranger. Experience natural wonders by day, then enjoy a sunset cocktail party on deck, and pass nights under a dazzling sky of stars.



EXPEDITION HIGHLIGHTS

See dolphins, sea lions, seals, and whales • Search for endemic mammals like the island fox • Enjoy lunch in a Torrey Pine grove, one of only two on Earth • Get the inside story and history of the Catalina Island Conservancy from a local ranger • See the largest nesting colony of brown pelicans in the U.S. • Photograph the famous rock arches of Anacapa • Kayak and stand-up paddleboard rocky shorelines and among kelp beds • Choose activities from challenging summit hikes to relaxing shoreline strolls • Recharge with daily yoga, morning stretching, or meditation

ITINERARY: WILD CALIFORNIA ESCAPE: CHANNEL ISLANDS NATIONAL PARK

5 DAYS/4 NIGHTS—ABOARD *NATIONAL GEOGRAPHIC SEA BIRD*,
NATIONAL GEOGRAPHIC SEA LION, *NATIONAL GEOGRAPHIC QUEST*,
AND *NATIONAL GEOGRAPHIC VENTURE*

PRICING FROM \$2,620

(SEE PAGES 22-25 FOR DETAILS)

EXPEDITION DETAILS

2019 Dates: Sep. 25, 28; Oct. 2; Dec. 3

2020 Dates: Apr. 11, 15; Oct. 11, 16; Nov. 17, 21

Limited availability

SPECIAL OFFER:

- CALIFORNIA ISLAND MAP, YOUR GIFT Printed on premium fine art paper, this archival Map of California as an Island by Joan Vinckeboons, ca. 1650 (see page 2) is a definite conversation piece. Receive it as our thank you for booking this voyage.
- Book six or more under one booking and save 10%.
See page 26 or call for details.

ITINERARY AT A GLANCE

Day 1	Los Angeles/Embark
Day 2	Anacapa and Santa Cruz Islands, Channel Islands National Park
Day 3	Santa Rosa Island
Day 4	Santa Catalina Island
Day 5	Los Angeles/Disembark

▶ Visit expeditions.com/channel for a day-by-day itinerary.

San Miguel

Santa Rosa

RARE FLORA

Hike to one of only two naturally occurring groves of Torrey Pines anywhere in the world on Santa Rosa Island.



INSPIRATION POINT

Soak in the views from the base of Anacapa Lighthouse, built in 1912, the last major light station to be built on the west coast.

Santa Cruz

Anacapa

Los Angeles

ENDEMICS GALORE

An incredible biological hotspot, the Channel Islands have over 2,000 species of plants and animals, including 145 endemics.

KAYAK, HIKE & CRUISE

Explore the dramatic rocky shorelines of Anacapa by expedition landing craft, and hike into the rugged interior for inspiring photo ops.

Santa
Catalina

WESTERN HISTORY

Explore Catalina's history of smugglers and gold rushers, and learn about the modern Catalina Island Conservancy, protecting nearly 90 percent of the island.



INVITING ISOLATED ISLES & AN ENCHANTING COAST AMID A LIVING SEA

ENTER A TIME MACHINE: SEE THE SOCAL COAST AS IT IS AND AS IT WAS, WHILE making time-warping discoveries. Depart Los Angeles's bustling port for the nearby Channel Islands to witness intact wildness, complete with thriving endemic species, mere nautical miles from a sprawling megalopolis. Making our way south, we encounter world-class food and wine, and lessons in sustainability. Scour the horizon for migrating whales and birds. And enjoy daily morning stretch classes on deck as we slip back into the era of historic missions punctuating desert landscapes where ancient cacti stand sentinel. Count on your entire expedition team to do whatever it takes to ensure you an unforgettable voyage.



EXPEDITION HIGHLIGHTS

Discover the incredible biodiversity of Channel Islands National Park, including 145 endemic species • Tour and sample wines at the vineyards of Valle de Guadalupe • Visit the world's largest salt mine in Guerrero Negro and see how it fits into this fragile environment • Meet with the local fisherman of Isla Natividad's fishing co-op • Explore the ever-shifting sand dunes of Isla Magdalena • See daybreak over the famous rock arches of Cabo San Lucas • Snorkel the only hard coral reef in North America, featuring over 220 species of fish • See a great variety of marine life, including the possibility of blue whales, the largest animal on Earth • Visit a colony of breeding elephant seals • Snorkel with playful California sea lions • Choose from a variety of ways to explore, from challenging hikes to casual beach strolls • **EXCLUSIVE OPPORTUNITY:** Travel with a National Geographic expert! Join marine biologist and filmmaker Greg Marshall on the Dec. 12, 2019 departure.



FROM SOUTHERN CALIFORNIA TO
BAJA: SAILING THE PACIFIC COAST





ITINERARY: FROM SOUTHERN CALIFORNIA TO BAJA: SAILING THE PACIFIC COAST

12 DAYS/11 NIGHTS—ABOARD *NATIONAL GEOGRAPHIC VENTURE*
PRICING FROM \$9,390

(SEE PAGES 22-23 FOR DETAILS)

EXPEDITION DETAILS

2019 Date: Dec. 12

SPECIAL OFFER:

- CALIFORNIA ISLAND MAP, YOUR GIFT Printed on premium fine art paper, this archival Map of California as an Island by Joan Vinckeboons, ca. 1650 (see page 2) is a definite conversation piece. Receive it as our thank you for booking this voyage.
- Book by Sep. 30, 2019 and receive a \$350 air credit per person. Plus, we will waive the solo premium on solo cabins for this departure. See page 26 or call for details.

ITINERARY AT A GLANCE

Day 1	Los Angeles/Embark
Days 2 & 3	Channel Islands National Park
Day 4	Ensenada and the Valle de Guadalupe
Day 5	San Quintín Exploration
Days 6 & 8	Guerrero Negro/Islas San Benito/Isla Natividad/At Sea
Day 9	Bahia Magdalena
Day 10	Los Cabos and Gorda Banks
Days 11 & 12	Cabo Pulmo/Los Islotes
Day 13	La Paz/Disembark/San Jose Del Cabo

▶ Visit www.expeditions.com/latolapaz for a day-by-day itinerary.

FROM SOUTHERN CALIFORNIA TO BAJA: SAILING THE PACIFIC COAST

Channel Islands National Park

BIODIVERSITY HOTSPOT

Discover some of the 2,000 species of plants and animals of the Channel Islands, including 145 endemics.

Los Angeles

A LIVING SEA

Search for whales, dolphins, and other marine life along Gorda Banks, a renowned gathering spot for cetaceans.

Ensenada

CULINARY MARVELS

Enjoy a private tour and tasting at Valle de Guadalupe, one of the world's hottest up-and-coming wine regions.

*Bahía
San Quintín*

BIRD ISLANDS

Explore San Quintín and surrounding islands, a bird sanctuary with over 400 species of plants, mammals, and birds, including 23 seabirds.

Islas San Benitos

SALT FLATS

See the world's largest saltworks at Guerrero Negro, which produces seven million tons of salt each year, and learn about local conservation efforts.

Isla
Natividad

Guerrero Negro

UNDERSEA GARDEN

Snorkel colorful, pristine reefs of Cabo Pulmo National Park before ending the day with a beach bonfire BBQ at a nearby island.

SEAL HAVEN

Observe the breeding elephant seals that occupy the beaches of Islas San Benitos, plus meet the welcoming people of Isla Natividad who have created a model sustainable community.

Bahía Magdalena

La Paz

SHIFTING SANDS

Hike across the ever-shifting dunes of Bahía Magdalena, home to 40 different bird species.

San José del Cabo

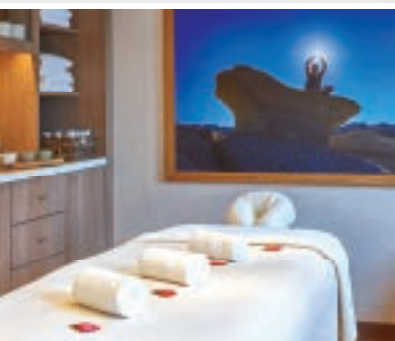

NATIONAL GEOGRAPHIC QUEST & NATIONAL GEOGRAPHIC VENTURE

CAPACITY: 50 cabins accommodating 100 guests
REGISTRY: United States. **OVERALL LENGTH:** 238 feet.

Sister ships *National Geographic Quest* and *National Geographic Venture* (launched 2018) are the latest additions to our fleet. Designed with over 50 years of expedition heritage and built in the U.S.A., both ships will set a new standard in exploration and comfort.

PUBLIC AREAS: Global gallery; fitness center; LEXspa; lounge with full service bar and facilities for films and presentations; observation deck; mudroom with lockers for expedition gear, and a partially covered sundeck with chairs and tables. Our “open Bridge” provides guests an opportunity to meet our officers and captain and learn about navigation.

MEALS: Served in single seatings with unassigned tables for an informal atmosphere and easy mingling. Breakfast and lunch are wide-selection buffets with chef-action stations, while dinners are primarily served plated. Menu emphasizes local fare.

CABINS: All cabins face outside with windows or portholes, private facilities and climate controls. Category 4 cabins have step-out balconies.

EXPEDITION EQUIPMENT: A fleet of 8 Zodiacs and 24 kayaks, Remotely Operated Vehicle (ROV), hydrophone, splash-cam, underwater video camera, video microscope, paddleboards.

SPECIAL FEATURES: Guest internet access, elevator, Lindblad-National Geographic certified photo instructor, a video chronicler and undersea specialist.

WELLNESS: The vessel is staffed by a Wellness Specialist and features a gym with an elliptical machine, treadmill, exercycles, handweights and resistance bands. Treatments in the LEXspa are available by appointment.

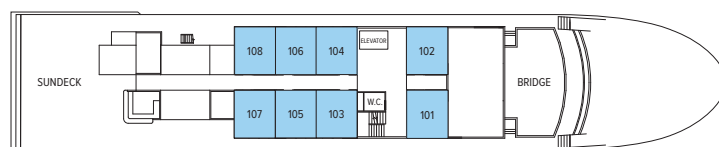

OBSERVATION DECK

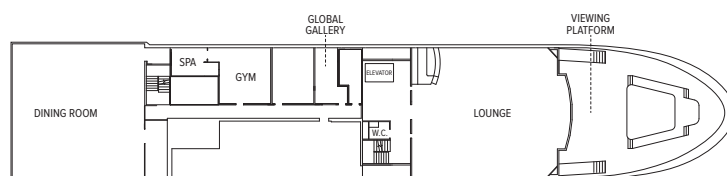

LOUNGE DECK



UPPER DECK



MAIN DECK



Left to right: Massage room; *National Geographic Venture*; global gallery; viewing platform; Category 5 cabin; Category 4 cabin with lower single beds (which can be converted to a Queen) and a private step-out balcony. Select cabins connect via an inside doorway.

CATEGORY 1: Main Deck #301-306 Cabins feature two lower single beds that can convert to a Queen, a writing desk, and two portholes.

CATEGORY 2: Main Deck #307-315 Cabins feature two lower single beds that can convert to a Queen, a writing desk, and two portholes.

CATEGORY 3: Upper Deck #201-206 Cabins feature two lower single beds that can convert to a Queen, a writing desk, and two large view windows.

CATEGORY 4: Upper Deck #207-229 Cabins feature two lower single beds that can convert to a Queen, a writing desk, sliding glass door, and small, private balcony.

CATEGORY 5 (SUITE): Observation Deck #101-108 Cabins feature two lower single beds that can convert to a Queen, large view windows, an expanded bathroom, writing desk, ample storage space, and a convertible sofa bed to accommodate a third person.

NOTE: Solo Occupancy cabins are available in Categories 1 and 2 only. Third person rates are available in Category 5 cabins at one half the double occupancy rate.

Connecting Cabins via internal doorway access: Main Deck: #312-314, #311-315, #306-308, #305-307; Upper Deck: #224-226, #225-227

Prices are per person, double occupancy unless indicated as solo.

ITINERARY	YEAR	CAT. 1	CAT. 2	CAT. 3	CAT. 4	CAT. 5 SUITE	CAT. 1 SOLO	CAT. 2 SOLO	ADVANCE PAYMENT	NOTE
Wild California Escape: San Francisco to Monterey Bay – Page 10	2019	\$3,770	\$4,600	\$5,280	\$5,960	\$6,640	\$5,650	\$6,930	\$750	We will gladly assist in making your air arrangements. Please call for airfares from your departure city.
Wild California Escape: Channel Islands National Park – Page 14	2019	\$3,010	\$3,680	\$4,220	\$4,770	\$5,310	\$4,520	\$5,540	\$750	We will gladly assist in making your air arrangements. Please call for airfares from your departure city.
	2020	\$3,100	\$3,790	\$4,350	\$4,910	\$5,470	\$4,660	\$5,710		
From Southern California to Baja: Sailing the Pacific Coast – Page 18	2019	\$9,390	\$10,630	\$11,870	\$13,230	\$14,710	\$14,090	\$16,070	\$1,000	We will gladly assist in making your air arrangements. Please call for airfares from your departure city.

Prices quoted in this brochure are valid as of the time of printing, are subject to modification, and are not guaranteed until booking and required deposit is made. For current rates and details visit expeditions.com, call an Expedition Specialist, or your Travel Advisor. For best pricing book early.



NATIONAL GEOGRAPHIC SEA BIRD & NATIONAL GEOGRAPHIC SEA LION

CAPACITY: 62 guests in 31 outside cabins.

REGISTRY: United States. **OVERALL LENGTH:** 152 feet.

PUBLIC AREAS: Our twin sister ships feature a library; global market; lounge with full-service bar and facilities for films, slide shows and presentations; observation deck; partially covered sun deck with chairs and tables, and LEXspa. Our “open Bridge” provides guests an opportunity to meet our officers and captain and learn about navigation.

MEALS: Served in single seatings with unassigned tables for an informal atmosphere and easy mingling. Breakfasts are wide-selection buffets and lunch is often served family style. Dinners are primarily served plated. Menu emphasizes local fare.

CABINS: All face outside with windows, private facilities and climate controls.

EXPEDITION EQUIPMENT: Bow camera, hydrophone, kayaks, fleet of paddleboards, splash-cam, underwater video camera, video microscope, and expedition landing craft.

SPECIAL FEATURES: Guest internet access. A certified photo instructor and a video chronicler are on board all voyages. An undersea specialist is on board in California and Baja.

WELLNESS: The vessel is staffed by a wellness specialist and features exercise equipment, LEXspa and outdoor stretching area.

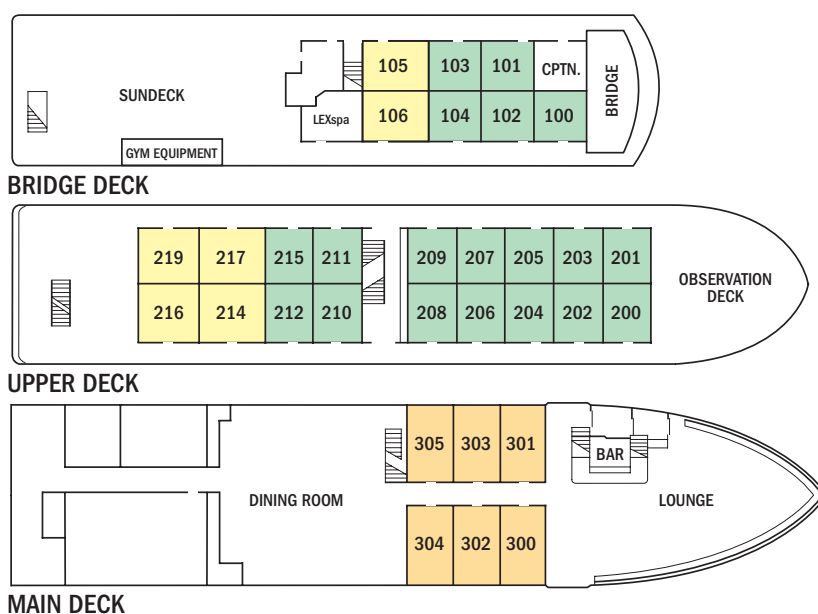



Left to right: Bartender in our newly refurbished lounge; *National Geographic Sea Bird*; dining room where meals are served in single seating with unassigned tables for easy mingling; nightly Recap in the lounge; Category 2 cabin freshly redesigned; twin beds can be pushed together to form a double bed in Category 3 cabins on the upper decks.

CATEGORY 1: Main Deck #300-305—Conveniently positioned between the dining room and lounge, these cabins feature two single lower beds, and a large view window.

CATEGORY 2: Bridge Deck #100-104; Upper Deck #200-212, 215—These well-located cabins include two lower single beds and a view window.

CATEGORY 3: Bridge Deck #105, 106; Upper Deck #214, 216, 217, 219—These cabins feature a seating unit with table and two large view windows. Upper Deck cabins

include two lower single beds which can convert to a double bed and a pull-out single bed for a third person; Bridge Deck cabins include two lower single beds only.

Note: Solo Occupancy cabins are available in Categories 1 and 2 only. Third person rates are available in certain categories at one half the double occupancy rate.

Shared Accommodations: Shares can be arranged at the double occupancy rate in Categories 1 and 2 only.

Prices are per person, double occupancy unless indicated as solo.

ITINERARY	YEAR	CAT. 1	CAT. 2	CAT. 3	CAT. 1 SOLO	CAT. 2 SOLO	ADVANCE PAYMENT	NOTE
Wild California Escape: Channel Islands National Park – Page 14	2019	\$2,620	\$3,200	\$3,670	\$3,930	\$4,820	\$750	We will gladly assist in making your air arrangements. Please call for airfares from your departure city.
	2020	\$2,990	\$3,490	\$3,940	\$4,490	\$5,240		

Prices quoted in this brochure are valid as of the time of printing, are subject to modification, and are not guaranteed until booking and required deposit is made. For current rates and details visit expeditions.com, call an Expedition Specialist, or your Travel Advisor. For best pricing book early.

TAKE ADVANTAGE OF OUR SPECIAL OFFERS

\$350 AIR CREDIT: Book now to receive a \$350 air credit per person on the Nov. 21, 2019 departure of *Wild California Escape: San Francisco to Monterey Bay* and the Dec. 12, 2019 departure of *From Southern California to Baja: Sailing the Pacific Coast*. Valid for new bookings only, subject to availability, and may not be combined with other offers, or extensions. Call for details.

GET THE GROUP ONBOARD: Save 10% when traveling as a group of 6 or more people on all departures of *Wild California Escape: Channel Islands National Park* and *Wild California Escape: San Francisco to Monterey Bay*. On all other departures, save 5% when traveling as a group of 8 or more people. Take advantage of these great savings, while enjoying traveling with your friends and family. This savings is applicable on voyage fares only, and not on extensions or airfare. Deposit, final payment, and cancellation policies for group travel vary from our regular policies.

SOLO SAVINGS: Book by Oct. 31, 2019 and we will waive the solo premium on solo cabins on all departures of *Wild California Escape: San Francisco to Monterey Bay* and *From Southern California to Baja: Sailing the Pacific Coast*. New bookings only. Subject to availability. May not be combined with other offers or extensions. Call for details.

COMPLIMENTARY CALIFORNIA MAP: Book any 2019 departure of any voyage in this brochure and receive a 16" x 11.3" print of the 1605 map featured on pages 2-3 with our compliments. One map per booking while supplies last. Call for details.

BRINGING THE KIDS: We believe sharing an expedition with your kids or grandkids is a life-enhancing experience. So, take \$500 off for each child under the age of 18.

COMBINING OFFERS: Certain offers may be combinable, up to two savings opportunities except where noted otherwise. For example, travel with a group of 8 or more on back-to-back expeditions, and take advantage of both savings!



INCLUSIVE PRICING MEANS VALUE + EXPERIENCES

We include just about everything you have the opportunity to do as part of your expedition aboard ship and ashore. The only things not included are those of a personal nature—internet usage, wellness treatments and other specialized arrangements.

ABOARD SHIP

- ✓ All meals, and non-alcoholic beverages
- ✓ Cappuccinos, lattes & complimentary refillable water bottle
- ✓ 24-hour coffee, tea & soda
- ✓ Hors d'oeuvres & snacks during recap
- ✓ Fitness Center
- ✓ Fully stocked library
- ✓ The guidance and company of our expedition staff

ASHORE

- ✓ Meals on land, as indicated in itinerary
- ✓ Special access permits, park fees, port taxes
- ✓ Transfers to and from group flights
- ✓ The expertise of our expedition staff

ACTIVITIES

- ✓ All shore activities
- ✓ Expedition landing craft, kayak and stand-up paddleboard explorations
- ✓ Snorkeling, including wetsuits, masks, fins (on select itineraries only)
- ✓ Lectures & presentations in the lounge

Photo Credits: Alamy, Ralph Clevenger, Bennett Goldberg, Ralph Lee Hopkins, Jonathan Kingston, Marc Muench, Michael S. Nolan, Rich Reid, Ian Shive, iStock, David Vargas

RESERVATION INFORMATION

Terms & Conditions: For complete terms and conditions please visit www.expeditions.com/terms

Costs Include: All accommodations aboard ship or in hotels per itinerary or similar, all meals and nonalcoholic beverages aboard ship, meals on land as indicated, air transportation where indicated as included, all shore excursions except flightseeing, sightseeing and entrance fees, special access permits, transfers to and from group flights, use of kayaks (where available), tips (except to ship's crew), taxes and service charges, services of a ship physician, and services of our expedition staff.

Not Included: Air transportation (except where shown as included), extensions, passport, visa, immigration fees, meals not indicated, travel protection plan, items of a personal nature such as alcoholic beverages, internet access, voyage DVD, flightseeing, laundry. Gratuities to ship's crew are at your discretion.

Airfare: For all programs, airfare is an additional cost unless otherwise indicated. Sample airfares are subject to change. We will gladly assist in making your air arrangements for a \$50 per person service fee.

Reservations: To reserve your place, an advance payment is required at the time of reservation. A per-person deposit begins at \$750 and is dependent upon itinerary.

Final Payment: For expeditions aboard all ships, payment is due 90 days prior to departure. Payment schedules may vary for certain longer voyages, due to high demand for these voyages. We reserve the right to cancel your reservation if payment has not been received by final payment due date.

Travel Protection Plan: We strongly recommend that you take advantage of our Travel Protection Plan. This plan offers comprehensive coverage to protect you from cancellation fees, costs incurred due to trip delays/interruption, medical assistance, and damaged or lost baggage, and provides medical assistance and evacuation during your travels. Our Travel Protection Plan is available for U.S. and Canadian residents only, and may be purchased any time prior to final payment due date. If you are not satisfied for any reason, you may return your plan within 10 days after purchase. Your premium will be refunded if canceled within 10 days, provided you have not already departed on the trip or filed a claim. When so returned, the coverage under the plan is void from the original date of purchase.

Responsibility and Other Terms & Conditions: Certain provisions concerning, among other things, limitations of Lindblad Expeditions' and the National Geographic Society's liability for loss of property, injury, illness or death during the voyage will be provided to all guests on the ship's ticket sent prior to departure, and are also available on our website at www.expeditions.com/terms, or upon request. By registering for a trip, the guest agrees to all such terms and conditions.

Note: Itineraries and prices listed in this brochure are as of publication date and are subject to change. Under normal conditions the total expedition price is guaranteed at the time of booking. However, our expedition pricing is determined far in advance of initial departure on the basis of then-existing projections of fuel and other costs. In the event of increases in those costs, including but not limited to increases in the price of fuel, currency fluctuations, increases in government taxes or levies, or increased security costs, we reserve the right to adjust the price of your expedition or add a surcharge to cover such unexpected increases. We will always provide an explanation of the reason for increase in costs.

Cancellation Policy: Cancellation penalties may apply after payment is received. Please visit www.expeditions.com/terms for complete cancellation policies.

Unused services or items included in our programs are non-refundable.

©2019 Lindblad Expeditions

Lindblad Expeditions and the Eye are the trademarks of Lindblad Expeditions. All rights reserved.

NATIONAL GEOGRAPHIC and the Yellow Border are the trademarks of the National Geographic Society. All rights reserved.

For Reservations: Contact your travel advisor or Lindblad Expeditions

1.800.EXPEDITION (1.800.397.3348)

Reservation Hours: Monday – Friday 9am – 9pm ET

Saturday & Sunday 10am – 5pm ET

Lindblad Expeditions, Inc., 96 Morton Street, New York, NY 10014

Phone: 212.261.9000 • Fax: 212.265.3770

For additional information and online reservations, visit us on the Web: www.expeditions.com



96 MORTON STREET, NEW YORK, NY 10014

PRSRT STD
U.S. POSTAGE
PAID
LINDBLAD
EXPEDITIONS

Account Number:



1.800.EXPEDITION | WWW.EXPEDITIONS.COM

Printed on 10% recycled content paper with soy-based inks. We recommend that you pass this along for others to enjoy or recycle.

CAL-079



SOLO TRAVELER'S OFFER:

Book solo cabins on select departures and we will waive the premium. (See page 24 for details)