

FAMILY EXPEDITIONS

INSPIRING POSSIBILITIES FOR EXPLORING TOGETHER

GALÁPAGOS
BAJA & THE
SEA OF CORTEZ
ALASKA

PLUS
THE NATIONAL
GEOGRAPHIC
GLOBAL
EXPLORERS
PROGRAM



ABOARD THE LINDBLAD-NATIONAL GEOGRAPHIC FLEET | 2018/19



Lindblad
Expeditions



NATIONAL
GEOGRAPHIC™



Lindblad
Expeditions



NATIONAL
GEOGRAPHIC™

Lindblad Expeditions and National Geographic have joined forces to further inspire the world through expedition travel. Our collaboration in exploration, research, technology and conservation will provide extraordinary travel experiences and disseminate geographic knowledge around the globe.

DEAR TRAVELER,

There are so many possibilities to consider when planning your family travel—and there is so much family to consider, too. When my two youngest kids—a girl and a boy, three years apart—were school age, it was like having two different species in the house, with precious little connecting their interests. Add parents and extended family to the equation, and you're up to three or more different species!



Wildness is a great equalizer, allowing old and young to share experiences with equal joy. In this era of devices and seemingly limitless connectivity, it's become far too easy for family members to spend more time with their phones and tablets than each other. Expedition travel, with its mix of fresh daily sights, wildlife, undersea wonders, and activities for every age and fitness level, is the perfect antidote—to disconnect your family from the screens, the headphones and the tech-noise, and re-connect you with each other. And kids and teens will find a new outlet for their curiosity and interest on our Galápagos and Alaska expeditions—our new National Geographic Global Explorers program, developed in conjunction with National Geographic Education. You'll find details on this exciting optional program on pages 4-5.

In addition to a superb experience, we also offer families a priceless commodity: ease. As a parent, I know that there's much to be said for seamless and hassle-free. Our team provides that: every detail—from flights to food to gear— is taken care of, so all you have to do is relax and enjoy the adventure.

On behalf of our expedition teams worldwide, I hope you will choose to join us in your choice of the three marvelous geographies featured in this brochure, or any other Lindblad-National Geographic expedition that might suit your family.

All the best,

Sven-Olof Lindblad

AN EXPEDITION—THE MOST EXCITING

Put simply, an expedition is smart fun for all ages, and for all types of families, from tiny to clan-sized. Being aboard ship creates a fresh context for families to be together, or come together, if they're far-flung or chronically schedule-challenged. Inherently diverse and active, an expedition offers remarkable experiences to share, with daily opportunities to do things together, or to follow separate interests—and meet at dinner to share the day's stories. And because our expeditions attract families, the community that forms on board is uniquely welcoming. We have 50 years of expedition experience and have learned a lot about optimizing opportunities for our guests; and we are dedicated to ensuring the quality of your family's experience. Here are some key reasons why families choose us:



& INTERESTING EXPERIENCE TO SHARE

- ✓ **Ease & convenience** Whether you're a hyper-busy parent planning the family vacation around a dozen other tasks, or the clan's travel planner determining where the family is going this year, we make your task easy. We create a seamless experience—from booking round-trip flights and transfers, to a richly rewarding itinerary, and shipboard life that includes kid-friendly meals;
- ✓ **Choice & flexibility** We offer activities tiered for every fitness level and age group to ensure multigenerational fun (yes, even teens respond well!). And that means every day your family members can choose what to do—photography walks, hiking, kayaking, snorkeling and more. And with whom to do it—you're free to gravitate to the expedition naturalists whose personality and interests match yours, or theirs. Relaxing with a book, in a hammock or deck chair is always an option, too;
- ✓ **Environment** Our expedition ships, ranging from small to yacht-scale, are ideal for families, providing the perfect balance of intimacy and independence for kids; they are uniquely warm environments as well; our staff and crew are wonderful with kids; and our naturalists are such role models they're often followed about by a small band of admirers;
- ✓ **Expert photographers** Lindblad-National Geographic certified photo instructors are on every departure with tips, camera setting instruction and advice to help every interested family member—whether they're using their smartphone, a DSLR or point & shoot—snap the moments that capture the heart of their expedition. Want a family portrait? They can help with that, too.
- ✓ **Family travel discount** We invite you to take \$500 off the cost of your expedition for each child traveling with you under the age of 18 and enjoy a 5% savings for groups of 8 or more;
- ✓ **Exclusive family program for kids and teens** National Geographic Global Explorers launched in Galápagos in 2017, and is rolling out to Southeast Alaska in 2018. Developed in conjunction with National Geographic Education, it's unique in travel—turn the page to learn all about it, including what some recent 'explorers' have to say.



From top: Family members capturing wildlife shots from the ship's bow; our naturalists provide expert interpretation on hikes; kids of all ages discover the unique flora, fauna, and ice we see on our expeditions.

NATIONAL GEOGRAPHIC GLOBAL EXPLORERS



Developed in conjunction with National Geographic Education, this unique exploration based program provides an unforgettable ‘smart fun’ experience. Working with our National Geographic certified field educators, kids and teens will engage in activities—science, exploring, and storytelling—adapted for their age, and designed to develop the attitudes, skills, and knowledge of an explorer. In addition to exclusive learning opportunities, every departure guarantees

flexibility and fun for all ages with kid-friendly menus, a choice of hikes and activities, and much more. Guests under 18 (and their families) are invited to:

- ✓ **First and foremost, have fun!** They'll have the opportunity to take part in all kinds of cool activities—swim, snorkel, paddleboard, kayak and more with newfound friends, and develop lifelong memories.
- ✓ **Benefit from National Geographic certified field educators:** Our naturalists, designated as National Geographic certified field educators, optimize daily learning opportunities and fun for families.
- ✓ **Connect with nature:** They'll have direct contact with wildlife and wonders above and below the sea, such as snorkeling with sea lions in Galápagos, or identifying whale flukes from the ship's bow in Southeast Alaska.
- ✓ **Learn to be a storyteller:** Through photos, videos, music, writing, drawing and more, kids and teens will be encouraged to think outside the box and use their creativity to tell stories about the unique things they'll do and see along the way.
- ✓ **Develop their observation skills:** Daily “In the Field: Spot It!” activities will prompt kids to watch out for a particular item, like a creature with scales or a giant coral head on land, then record their observations in their region-specific Field Notebook, pictured at far right.

“Loved it! A very good way to get kids engaged, to make friends, and make any ‘downtime’ fun! The staff also did a good job of catering to different ages.”

—Guest on National Geographic Endeavour II

A DAY IN THE LIFE OF A NATIONAL GEOGRAPHIC GLOBAL EXPLORER ON & OFF SHIP

Morning

- Rise and shine! Head for the National Geographic Global Explorers bulletin board to get your In the Field: Spot It! observation clues, new inspiration for a Storytelling Challenge, and other daily details
- After breakfast, hop in our expedition landing craft, and head out to hike among fascinating wildlife and plants. In Alaska, spot a bald eagle or sea otters. In Galápagos, observe sunbathing marine iguanas. Jot your species sightings and thoughts in your Field Notebook



- Or head with a National Geographic certified field educator to collect plankton from your expedition landing craft, then view it under the video microscope aboard

Midday

- After lunch, be a digital storyteller! Meet your Lindblad-National Geographic certified photo instructor or the ship's video chronicler in the Lounge and learn how to use your smartphone to create impressive slow-motion and time-lapse videos—then test out those skills later on in the field

Afternoon

- It's time to drive! Learn to operate our expedition landing craft and earn your "license"



Evening

- Before dinner, head to the Lounge to recap what you saw and did in your Field Notebook. Add the day's points to your points tally so that you can keep track of your progress on being certified as a National Geographic Global Explorer
- After dinner, head to the top deck to stargaze with a naturalist who will be your guide to the night sky. Does the sky look different than above your home? Draw a star map in your Field Notebook.



ENCHANTED GALÁPAGOS

By Sophie Lasquite Lenoir, Global Explorer, 8 years old, Switzerland



"I love animals and I love to travel. Going to the Galápagos Islands was amazing because there were so many animals. Everywhere I looked, they were there. I saw animals I have never seen before like giant tortoises, marine iguanas, red-footed boobies, blue-footed boobies, fur seals and even a humpback whale. I participated in the National Geographic Global Explorers Program for children and I learned a lot. I could ask the naturalists any question I wanted and they explained everything. We also had a notebook where we wrote what we saw and stories about our day.

We had many activities and I really liked hiking and kayaking. Even though I did not know how to snorkel, the naturalists taught me. I also went to the bridge every day to speak to Captain Neira and his crew. They taught me how to navigate and drive the National Geographic Endeavour II. One evening, I stayed up until 10:15 p.m. to drive our ship across the equator. It was very bumpy until we crossed, then it became calm. I also learned how to drive a Zodiac and even got a license.

On the trip, I met children from other countries and we played and learned together. We even visited a local school. I would like to go back to the Galápagos again and volunteer at the Charles Darwin Research Station. When I saw the stuffed Lonesome George, I was very, very sad. I cannot believe he was the last one from Pinta Island and that the giant tortoises there disappeared because of people. All the animals are precious and our planet is so beautiful so we should protect them. I hope that I can help so I would like to return, soon! The Galápagos will stay in my heart forever."



Facing page: Looking for newly hatched waved albatrosses with a naturalist on Punta Suarez.

Above: On the bridge with Captain Eduardo Neira, teaching me how to navigate and drive our ship.

Below: The beautiful landscape of Bartolomé Island with Pinnacle Rock.

▶ SEE SOPHIE'S CHARMING VIDEO INTERVIEW AT [EXPEDITIONS.COM/SOPHIE](https://www.expeditions.com/sophie)



COOL TOOLS ABOARD ENSURE EXTRAORDINARY EXPERIENCES

Our expedition ships are uniquely equipped with cool tools for exploring. On every departure, kids of all ages, and their adults, can enjoy our tools to enhance their expedition experience. Kayaks; stand-up paddleboards; snorkel gear, including shorty wetsuits, in sizes for all (and yours for the duration of the voyage). In addition, video microscopes, bow cams and expedition landing craft exploring provide intriguing perspectives on the region you're exploring.



Clockwise from top left: Kids enjoy expedition landing craft forays in Southeast Alaska; a young guest gets up close to a grey whale in Bahia Magdalena, Baja California; a mother and daughter kayaking near National Geographic Sea Bird in Misty Fjords National Monument; Curious young California sea lion with snorkelers underwater at Los Islotes, Baja California.



TRAVEL WITH A+ EXPEDITION TEAMS

The comment cards we receive from families after every voyage consistently express the same sentiments: “Outstanding expedition team.” Wherever you choose to explore with us, count on benefiting from the expertise of our knowledgeable teams, consisting of an expedition leader, an assistant expedition leader, naturalists, an undersea specialist, a Lindblad-National Geographic certified photo instructor, a wellness specialist, and a video chronicler to capture the story of your expedition.



REPRESENTING OUR EXPERT EXPEDITION STAFF



A sampling of some of our expert staff, clockwise from left: Michael Nolan; Jonathan Aguas; Jen Martin, Mike Greenfelder; Jason Heilmann; Paula Tagle.



CERTIFIED FIELD EDUCATORS TAILOR SMART FUN



Cindy Manning.

Each Galápagos and Southeast Alaska departure which features the National Geographic Global Explorers program (which means any expedition with at least one traveler under 18 aboard!) will have a National Geographic certified field educator on the team, trained to optimize daily activities and FUN for kids.

Using the National Geographic Global Explorers bulletin board as headquarters for program info, our National Geographic certified field educators will select daily activities, tailored to the ages of participants, that maximize kids' learning experiences on- and off-ship. And these schedules and activities are designed with families in mind: enjoy kid-friendly menus, movie night with pizza, a choice of hikes, and more.

AN EXPEDITION MAKES MULTIG

Traveling by small ship offers the perfect balance of family togetherness and space for families to exercise their freedom and preferences—especially welcome when traveling as a clan. Even if you enjoy different activities during the day, you can count on the ship to bring you together. And the opportunity to gravitate to each other easily and naturally happens daily—over expedition landing craft forays, hikes, dinner, presentations, and nightly recaps. We're dedicated to creating memorable experiences for our guests, and as you'll see, being together onboard our ship will be a key one. Based on our many years of experience, we offer these tips for planning a fun and stress-free get-together for the clan.



GENERATIONAL TRAVEL EASY

When to start planning:

Set a date as early as possible, preferably a year in advance. Families with school-age children generally need to plan around the school schedule.



Decide on the budget.

Sticking to a budget is often one of the biggest hurdles for families traveling together. Lindblad-National Geographic's all-inclusive pricing makes it easier for families to plan, and group decision-making is at a minimum, eliminating potential friction. Lindblad offers a 5% savings when traveling as a group of 8 or more people. And, we believe sharing an expedition with kids or grandkids is a life-enhancing experience, so take \$500 off for each child under the age of 18.

How to organize: Pick a family 'point person' so that wires don't get crossed, and take an informal survey of what people are willing to spend, and when and where they would like to go.

Booking air flights: Take advantage of Lindblad's group flights and rates, with group transfers from the airport to the ship included.



Arranging activities:

Fortunately, this is not your problem. Itinerary design has always been a Lindblad-National Geographic art, and all activities are planned expressly

to make the most of your time, curiosity, and personal interests. From walking tours, to Zodiac and kayak forays, to exploring the undersea—we include just about everything as part of the expedition aboard ship and ashore.

Accommodating

meals: Again, problem solved! All meals aboard ship are served in a single seating with unassigned tables for an informal atmosphere.



Reconnect with your group over a shared meal together, or opt to mingle with others—the choice is yours.

Coordinating reservations & communicating

details to travelers: Access your expedition documents online—such as program extensions, hotels, flight guidelines, and more—are ready to be reviewed at your convenience. Travel forms can be filled out and submitted in seconds. Access our Expedition Guide, specifically tailored to your upcoming expedition, with in-depth information about the land, culture and people of the region, a detailed itinerary, a sample day, and much more.

Staying in touch: Friends or family members back home? Have them sign up for Daily Expedition Reports sent direct to their email, so they can follow along virtually. And take advantage of onboard computer kiosks for email and web browsing.

Keep all the family members happy: With a Lindblad-National Geographic certified photographer aboard to guide and instruct, you can take plenty of Facebook, Instagram or holiday card-worthy family photos to make the family reunion memorable.



GALÁPAGOS

10 DAYS/9 NIGHTS—ABOARD NATIONAL GEOGRAPHIC ENDEAVOUR II AND NATIONAL GEOGRAPHIC ISLANDER

PRICES FROM: \$6,960 to \$15,400 (See pages 25-26 for complete prices.)

In the Galápagos, no single site can be visited by the same ship more than once over a two-week period. The idea was developed in 2011, and Lindblad was the first voluntary adopter of this innovative new proposal by the Galápagos National Park, which had as its purpose to spread people out to allow for a more intimate experience. We have created an optimal balance during each week in terms of terrain and wildlife. If you wish to see all the sites, you could join for two weeks, but be assured there is no better week to experience Galápagos—just nuances from one week to the other.

EXPEDITION HIGHLIGHTS

- ▶ Snorkel amid shimmering fish, sea turtles, penguins, and playful sea lions.
- ▶ Walk among colonies of wildlife and birds unfazed by your presence.
- ▶ Explore the waters of the Galápagos by kayak, glass-bottom boat (*Endeavour II*), Zodiac, or paddleboard.
- ▶ Observe giant Galápagos tortoises in the wild.
- ▶ See page 20 for Galápagos extensions.

EXPERIENCE & EXPERTISE



We're celebrating 50 years of exploring Galápagos. We've introduced generations of travelers to its magic and mystery. We're committed to Galápagos; and have raised millions, along with our guests, for its conservation. And we're fully invested, too; we operate two ships based there year round. An expedition leader, our team of naturalists, a Lindblad-National Geographic certified photo instructor, undersea specialist, wellness specialist, and video chronicler all contribute to your experience of the wonders of Galápagos.

Visit our website to read staff bios.

Blue-footed boobies.



DAY 1: U.S./GUAYAQUIL, ECUADOR
 Depart for Guayaquil and upon arrival, transfer to the Hotel del Parque (*National Geographic Islander*) or Hilton Colón (*National Geographic Endeavour II*).

DAY 2: GUAYAQUIL/GALÁPAGOS
 This morning, fly to the Galápagos Islands and board *Islander* or *Endeavour II*. After lunch, we begin our exploration of the islands and their diverse wildlife. (B,L,D)

DAYS 3–8: EXPLORING THE GALÁPAGOS
 Listed below is a sample of the islands we may visit during our expedition.* (B,L,D Daily)

ISLA BARTOLOMÉ
 Walk to the top of Bartolomé’s volcanic cone for a stunning view of Pinnacle Rock and the surrounding golden sand beaches. After the hike, immerse yourself among schools of multicolored reef fish. You may also have the opportunity to swim with Galápagos penguins.

ISLA SANTIAGO
 Follow a path along a series of tide pools and underwater caverns in search of Galápagos fur seals, marine iguanas, sea lions, shore birds and Sally Lightfoot crabs.

ISLA SANTA CRUZ
 Santa Cruz is home to the Charles Darwin Research station; learn about the science done here and visit the neighboring captive breeding program for endangered species of Galápagos giant tortoises, by their partners in conservation, the Galápagos National Park Service. Later, travel into the highlands

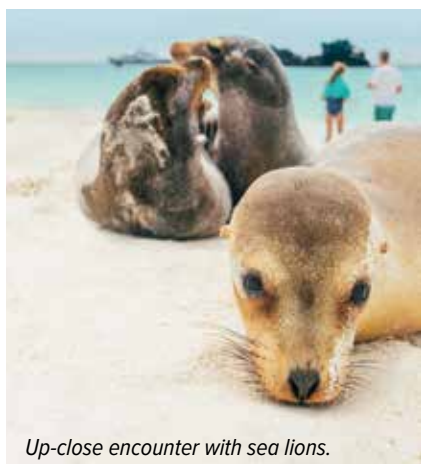

Up-close encounter with sea lions.

where wild tortoises forage, to observe and photograph these tortoises in the wild.

ISLA ISABELA
 Explore the largest island in the group, home to enormous marine iguanas, abundant sea turtles, the only species of flightless cormorant in the world, and the only penguin species that inhabits the equator. Cruise by Zodiac and hike against the backdrop of giant shield volcanoes, and snorkel in the cool, rich waters that often draw whales and dolphins to the area.

ISLA FLOREANA
 At Champion Islet, snorkel among sea lions, or peer into an underwater world in a glass-bottom boat or Zodiac while keeping an eye out for the endangered Floreana mockingbird. Those interested can visit Post Office Bay, founded by whalers in the 18th century—if you see a letter addressed to someone who lives near you, the tradition is to deliver it by hand.

ISLA FERNANDINA
 Discover the marine iguana haven of Punta Espinoza as we hike over lava flows. Galápagos hawks, sea lion nurseries and the rare Galápagos flightless cormorant will be found as we explore this island.

ISLA ESPAÑOLA
 See swallow-tailed gulls, Española mockingbirds, boobies, and, seasonally, waved albatross on this birder’s paradise. Walk among red and black marine iguanas and unique lava lizards, and observe sea lions up close on a pristine white-sand beach.

DAY 9: GALÁPAGOS/GUAYAQUIL
 After breakfast, disembark the ship and fly to Guayaquil. The evening is at your leisure at the Hotel del Parque (*Islander*) or Hilton Colón (*Endeavour II*).

DAY 10: GUAYAQUIL/U.S.
 Depart Guayaquil this morning, arriving home the same day. (B)

**Please note: All ship itineraries are subject to Galápagos National Park regulations. Our expeditions, which sail between Isla San Cristobal and Isla Baltra include Isla Santa Cruz and a hand-picked selection of these and other visitor sites.*



EXPEDITION DETAILS
DATES: 2018/2019: Expeditions depart Fridays on *National Geographic Endeavour II* and Saturdays on *National Geographic Islander*.

SPECIAL OFFERS:

- Early Booking Savings: Book by **Mar. 31, 2018** to guarantee 2018 prices for 2019 departures.
- Book by **Jul. 31, 2018** on select 2018 departures for **FREE ROUND-TRIP** economy group airfare from Miami to Galápagos; ask about other U.S. gateways. Upgrade to business class to Guayaquil for \$500 on select dates (space available). Call for details.
- Combine your Galápagos expedition with an Upper Amazon voyage and save 10%.

EXTEND YOUR ADVENTURE
 Combine your Galápagos expedition with **Machu Picchu & Peru’s Land of the Inca**. See pages 25 & 27 for details.

OPTIONAL EXTENSION—NEW
 Experience Ecuador’s fantastic culture, landscapes and wild nature on a six-day **Tropical Andes & Colonial Quito** adventure, featuring Mashpi Lodge, a National Geographic Unique Lodge of the World. Please call for details.

PERCENTAGE OF GUESTS UNDER 18	
JANUARY	4%
FEBRUARY	5%
MARCH	20%
APRIL	12%
MAY	4%
JUNE	25%
JULY	29%
AUGUST	22%
SEPTEMBER	2%
OCTOBER	3%
NOVEMBER	6%
DECEMBER	21%

EXPLORING ALASKA'S COASTAL WILDERNESS

8 DAYS/7 NIGHTS—ABOARD NATIONAL GEOGRAPHIC SEA LION, NATIONAL GEOGRAPHIC QUEST, AND NATIONAL GEOGRAPHIC VENTURE

PRICES FROM: \$5,990 to \$10,600 (See pages 29-31 for complete prices.)

Experience the remarkable beauty of Southeast Alaska on a voyage aboard the *National Geographic Sea Lion*, *National Geographic Quest*, or *National Geographic Venture* into a land of mist-shrouded fjords, tidewater glaciers, and islands teeming with wildlife. Search for killer whales and humpback whales, explore the coast by kayak, spend a full day in Glacier Bay National Park, and learn about Alaska's rich Tlingit heritage.

EXPEDITION HIGHLIGHTS

- ▶ Hike through lush forests to cascading waterfalls, and ride an expedition landing craft into secluded inlets to look for brown bears.
- ▶ Meet with our conservation partners from of the Alaska Whale Foundation to learn about the local whale population, and get a first-hand perspective on Alaska's indigenous people from a Tlingit cultural interpreter.
- ▶ Discover Alaska's seldom-seen, vibrant marine life revealed by our undersea specialist.
- ▶ Extend the adventure: include a 6-day pre- or post voyage stay at Denali's North Face Lodge. Visit expeditions.com/denali for extension information.
- ▶ See pages 22-23 for more Alaska itineraries, too.

EXPERIENCE & EXPERTISE

30+
YEARS
EXPERIENCE

Our unparalleled 6-person expedition team aboard the *Sea Lion* or 10-person teams aboard the *Quest* and *Venture* are key to an in-depth experience. An expedition leader, 4 naturalists (depending on the ship), a Lindblad-National Geographic certified photo instructor and undersea specialist, plus a wellness specialist and video chronicler all contribute to your understanding of Alaska's wonders. Certain departures will feature a National Geographic photographer or expert.

Visit our website to read staff and guest speaker bios for this expedition.

A humpback whale breaches.

DAY 1: SEATTLE/JUNEAU/EMBARK

Fly from Seattle to Juneau. Explore the newly constructed Alaska State Museum, with its sprawling collection of natural history and cultural artifacts, and explore downtown Juneau. Settle into your cabin before dinner. Later, explore the port of Juneau on your own. (D)

DAY 2: TRACY ARM—FORDS TERROR WILDERNESS

Voyage into Tracy or Endicott Arm, both spectacular fjords, with waterfalls cascading from glacially carved walls. See the soaring Dawes or South Sawyer Glacier up close and take a cruise in an expedition landing craft for an unbeatable view among sculpted icebergs. Keep an eye out for harbor seals, harbor porpoises and arctic terns. (B,L,D)



Petersburg.

DAY 3: PETERSBURG

Search for humpback whales as we head towards the small, true Alaskan fishing town of Petersburg on Mitkof Island. Explore a unique Southeast Alaskan ecosystem, the “muskeg,” with stunted trees and carnivorous plants. There is an opportunity for bike riding and an optional flightseeing excursion. Enjoy a crab feast this evening. (B,L,D)

DAY 4: FREDERICK SOUND AND CHATHAM STRAIT

Explore along the rugged coast seeking out humpback whales in their summer feeding grounds. Expert staff will interpret their life histories and behaviors. Later we'll explore the coast by kayak or go ashore to explore bear trails and salmon streams learning about the rainforest ecosystem as we go. (B,L,D)

DAY 5: ICY STRAIT AND THE INIAN ISLANDS

Explore among the Inian Islands, where an

abundance of Steller sea lions and sea otters reside. We'll search for marine mammals in the rich waters of Icy Strait and choose the perfect spot around Chichagof Island to hike where sightings of bald eagles are very common. (B,L,D)

DAY 6: GLACIER BAY NATIONAL PARK

By special permit, we explore Glacier Bay, a not-to-be-missed gem of Alaska. See glaciers that end abruptly at the water's edge and possibly observe them “calving”—tons of ice crashing into the sea—accompanied by an exhilaratingly thunderous sound. Wilderness abounds—mountain goats roam the steep cliffs and brown bears patrol the shore; Steller sea lions and puffins live in the icy waters. A native Tlingit cultural interpreter joins us to share the lore and legend of the area. We will also be joined by a National Park Service Ranger. (B,L,D)

DAY 7: SOUTHEAST ALASKA'S ISLANDS, BAYS AND FJORDS

Today, nature is our guide. We may explore an isolated beach to take a closer look at tide pools, beachcomb, or hike stunning forest trails, or see bear tracks worn into the soil while walking an isolated meadow. If conditions permit, we'll do some kayaking, always watching for marine and terrestrial life. (B,L,D)

DAY 8: SITKA/DISEMBARK/SEATTLE

After breakfast we disembark in Sitka, Southeast Alaska's only oceanfront town. Visit the onion-domed St. Michael's Russian Orthodox Church. At the Raptor Rehabilitation Center, we enjoy close-up views of bald eagles, owls and other species normally seen at a distance. Drive to the airport for our afternoon flight to Seattle. (B)



Steller sea lions.

**EXPEDITION DETAILS**

DATES: 2018 May 20*, 27; Jun. 3*, 10, 17*, 24; Jul. 1*, 8, 15*, 22, 29*; Aug. 5, 12*, 19 (*Sea Lion*) May 13*, 20, 27*; Jun. 3, 10*, 17, 24*; Jul. 1, 8*, 15, 22*, 29; Aug. 5*, 12, 19*, 26 (*Quest*) 2019 May 18*, 25; Jun. 1*, 8, 15*, 22, 29*; Jul. 6, 13*, 20, 27*; Aug. 3, 10*, 17 (*Sea Lion*) May 25*; Jun. 1, 8*, 15, 22*, 29; Jul. 6*, 13, 20*, 27; Aug. 3*, 10, 17*, 24 (*Quest*) May 19*, 26; Jun. 2*, 9, 16*, 23, 30*; Jul. 7, 14*, 21, 28*; Aug. 4, 11*, 18, 25*; Sep. 1 (*Venture*)

*These departures travel in the reverse order, from Sitka to Juneau, making all the same stops. Note: The exact order of stops may vary in order to maximize your experience.

SPECIAL OFFER:

Book now and receive **FREE ROUND-TRIP AIRFARE** between Seattle and Alaska on select May 2018 departures.

**ADD AN INLAND ADVENTURE—EXPLORE DENALI NATIONAL PARK FROM NORTH FACE LODGE**

7-day pre- or post-voyage extension

Visit www.expeditions.com/denali

EXPLORE TONGASS NATIONAL FOREST

Our Forest Service Special Use Permit for the Tongass National Forest enables you to hike and kayak in wild and remote areas of Southeast Alaska.

NATIONAL GEOGRAPHIC PHOTOGRAPHER

Join Alaska resident and marine mammal photographer **Flip Nicklin** on the Jun. 3 & 10, 2018 voyages aboard the *National Geographic Quest*.



BAJA CALIFORNIA AND THE SEA OF CORTEZ: AMONG THE GREAT WHALES

10 DAYS/9 NIGHTS—ABOARD NATIONAL GEOGRAPHIC VENTURE
PRICES FROM: \$7,530 to \$12,490 (See page 29 for complete prices.)

Seeing gray whales in their natural habitat is one of the great delights of this voyage. In Laguna San Ignacio, venture out in small boats among these magnificent creatures. In the Sea of Cortez, search for a variety of whales, plus dolphins, blue-footed boobies, pelicans, cormorants and magnificent frigatebirds. You'll also snorkel among sea lions, join naturalists on hikes amid barrel cacti and sculpted sand dunes, and see a variety of desert flora and fauna.

EXPEDITION HIGHLIGHTS

- ▶ Explore the entrance of Bahía Magdalena as well as the breeding grounds of Laguna San Ignacio, and observe gray whales and their calves with our naturalists.
- ▶ Go snorkeling amid sea lions, brilliant blue damselfish, and schools of king angelfish.
- ▶ Kayak clear blue waters on the lookout for a variety of bird species including magnificent frigatebirds.
- ▶ Explore diverse landscapes, including sand dunes, a cactus forest and deserted islands.
- ▶ And explore more, see page 21 for more options.

EXPERIENCE & EXPERTISE



Our expert 10-person expedition team will illuminate the wonders of the Sea of Cortez from every possible angle. Your expedition leader, undersea specialist, Lindblad-National Geographic certified photo instructor and naturalists, plus a wellness specialist and video chronicler, are dedicated to ensuring an incredible voyage. Certain departures feature a National Geographic photographer.

Visit our website to read staff bios for this expedition.

Gray whale, San Ignacio Lagoon.



DAY 1: DEPART US/SAN JOSE DEL CABO/LA PAZ

Upon arrival in San Jose del Cabo, transfer to La Paz and check in to the CostaBaja Resort & Spa, located on the shore of the Sea of Cortez, just south of Espíritu Island. (D)

DAY 2: LA PAZ/SAN CARLOS/EMBARK

This morning is on your own to relax and take advantage of the resort and spa amenities. Check-out in the late morning and depart for lunch at a local restaurant in La Paz. After lunch, transfer to San Carlos and embark the *National Geographic Venture*. (B,L,D)

DAY 3: BAHIA MAGDALENA

Explore the ever-shifting sand dunes of Isla Magdalena, on a cross-island walk to one of the most pristine beaches in the Pacific. Bird watching here can be excellent—magnificent frigatebirds, pelicans, cormorants, terns and great blue herons, ibis, whimbrels and willets are among the species we might see. It's not unusual to see forty species of birds in just one day along these fertile shorelines where they refuel for their destinations ahead. (B,L,D)

DAYS 4 & 5: LAGUNA SAN IGNACIO

Protected since 1993 as part of UNESCO's Whale Sanctuary of El Vizcaino, Laguna San Ignacio is one of the world's most important breeding sites for California gray whales. Each winter, during their long migration, gray whales travel south from their Arctic feeding

grounds to breed and raise their calves in these sheltered waters. Observe migrating whales from the ship and up close from local pangas and our Zodiacs. Watch for osprey, Brant geese and countless other breeding and migratory bird species, as well as bottlenose dolphins, during our explorations. (B,L,D)

DAY 6: AT SEA

As we travel south along the Pacific coast of the peninsula, there is a chance of seeing a wide variety of marine life, including the largest animal on Earth, the blue whale. Hear naturalist talks, and learn photography basics during a day at sea. (B,L,D)

DAY 7: LOS CABOS AND GORDA BANKS

This morning cruise past Friars Rocks at Land's End. This morning, choose to visit the historic town center of San José del Cabo, or join a birdwatching walk along the local estero. The afternoon is spent aboard ship in the area of Gorda Banks seamount or La Fortuna, gathering places for whales, especially humpbacks, dolphins and other sea life. (B,L,D)

DAY 8: LOS ISLOTES AND ISLA ESPIRITU SANTO

At Los Islotes, don flippers, a mask and snorkel (which we'll gladly provide) and swim with curious sea lions. We have a leisurely afternoon to swim, kayak or hike at Isla Espíritu Santo. Brown pelicans, gulls and boobies are all part



of the landscape. Finish the day with a relaxing beach barbecue complete with a bonfire and a star-filled sky. (B,L,D)

DAY 9: EXPLORING THE SEA OF CORTEZ

Our plan is flexible today, as we explore some of the Sea's many uninhabited islands. Go ashore at Isla San Francisco, where a sweeping arc of white sand beach beckons you to try out our fleet of kayaks and standup paddleboards. Hike to the nearby ridge for unparalleled views, or explore nearby tide pools with your Naturalists. One of the larger islands in the Sea of Cortez, San Jose offers several landing possibilities depending on conditions and the whim of the moment. Photograph the ochre cliffs of the island's eastern shore, hike an "enchanted" arroyo, or visit the abandoned salt works to the west. Search for whales, dolphins and other marine life this afternoon among the islands of the southern Sea of Cortez. (B,L,D)

DAY 10: LA PAZ/DISEMBARK/SAN JOSE DEL CABO/HOME

Disembark in La Paz after breakfast and transfer to Los Cabos airport for flights home (B)

EXPEDITION DETAILS

DATES: 2019 Jan. 12*, 19, 28*; Feb. 4, 13*, 20; Mar. 1*, 8

*These departures travel in the reverse order, from La Paz to San Carlos, making all the same stops.

NATIONAL GEOGRAPHIC EXPERT

Inventor of the Crittercam, biologist, conservationist, and Emmy Award-winning filmmaker **Greg Marshall** will join the Jan. 19 and 28, 2019 departures.



Guests kayaking, Espíritu Santo.

MAKE THE MOST OF YOUR TIME TOGETHER—EXPLORE MORE

The itineraries featured in this brochure are only part of the story—there are more options for you and yours. Plus, extensions in each geography offer more opportunities to see, do and learn together.

GALÁPAGOS + MACHU PICCHU & PERU'S LAND OF THE INCA

16 DAYS ABOARD NATIONAL GEOGRAPHIC ENDEAVOUR II OR NATIONAL GEOGRAPHIC ISLANDER

Embark on a sweeping adventure that combines the wildness of Galápagos with cultural and historic experiences of Machu Picchu & Peru's Land of the Inca. Walk and snorkel among the wildlife in Galápagos, then see daybreak over the ruins at Machu Picchu from the fabled Sun Gate. Discover Cusco's varied influences and visit the Sacred Valley of the Inca. Year-round, weekly departures following Galápagos.

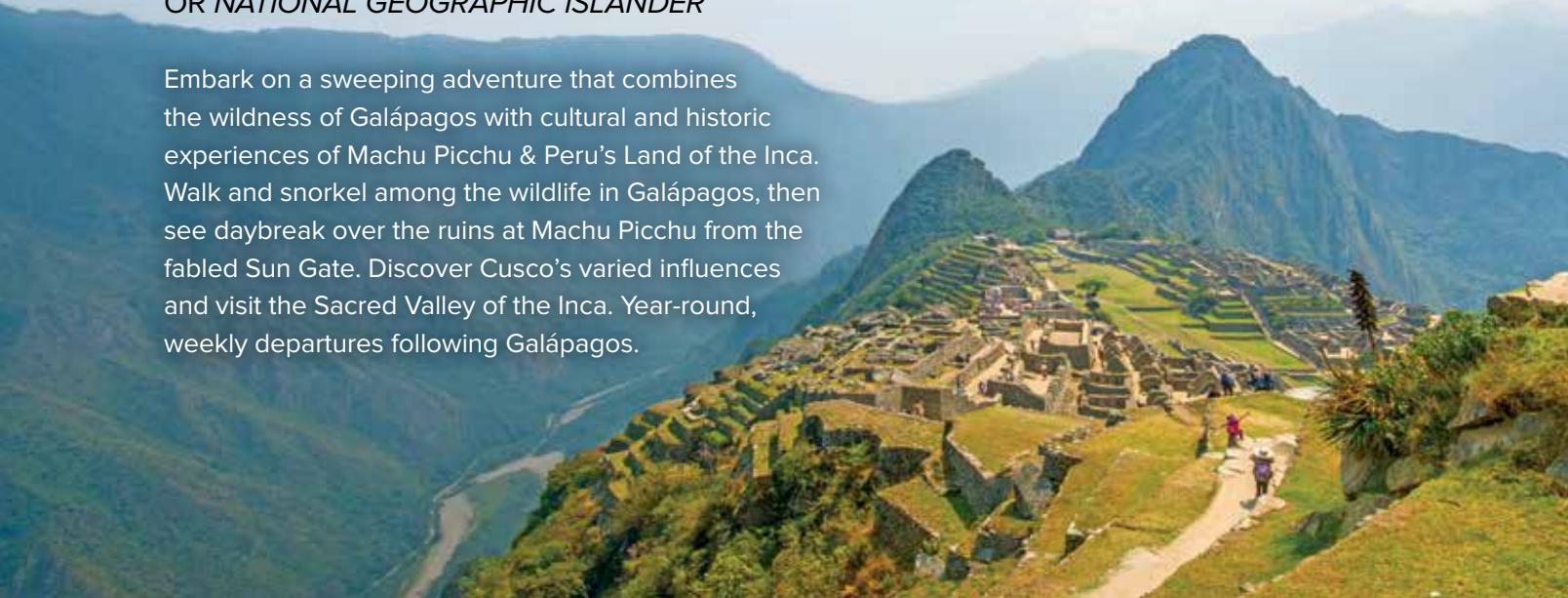

NEW! PRE-VOYAGE EXTENSION

6 DAYS IN TROPICAL ANDES & COLONIAL QUITO

Precede your Galápagos adventure with sojourn in the Andes. First, explore Quito, a UNESCO World Heritage site, from the historic Casa Gangotena on Plaza San Francisco. Then, immerse yourself in the heart of the Ecuadorian Chocó at Mashpi Lodge, a National Geographic Unique Lodge of the World, a family-friendly base on a 2,600-acre biodiversity reserve. Extensive hiking trails, a stunning open-air tram, observation towers, and even an ingenious aerial bicycle, are designed to get you all out into nature, sharing adventure.

 VISIT [EXPEDITIONS.COM/GALA](https://www.nationalgeographic.com/expeditions/gala) FOR ADDITIONAL INFORMATION, & SEE PAGE 25 & 27 FOR COMPLETE PRICES.

BAJA CALIFORNIA: A REMARKABLE JOURNEY

16 DAYS ABOARD *NATIONAL GEOGRAPHIC VENTURE*

The most comprehensive Baja California and the Sea of Cortez experience available: a photo expedition that begins in the gray whale birthing lagoons on the Pacific side of the Baja Peninsula and ventures into the Sea of Cortez for over a week of exploration. Get up close with California gray whales, and search for sperm, blue and fin whales. Hike the islands of the Sea of Cortez, searching for a variety of plant and bird species. Learn photo techniques from a National Geographic photographer and photo instructors that will last a lifetime and create stunning images.

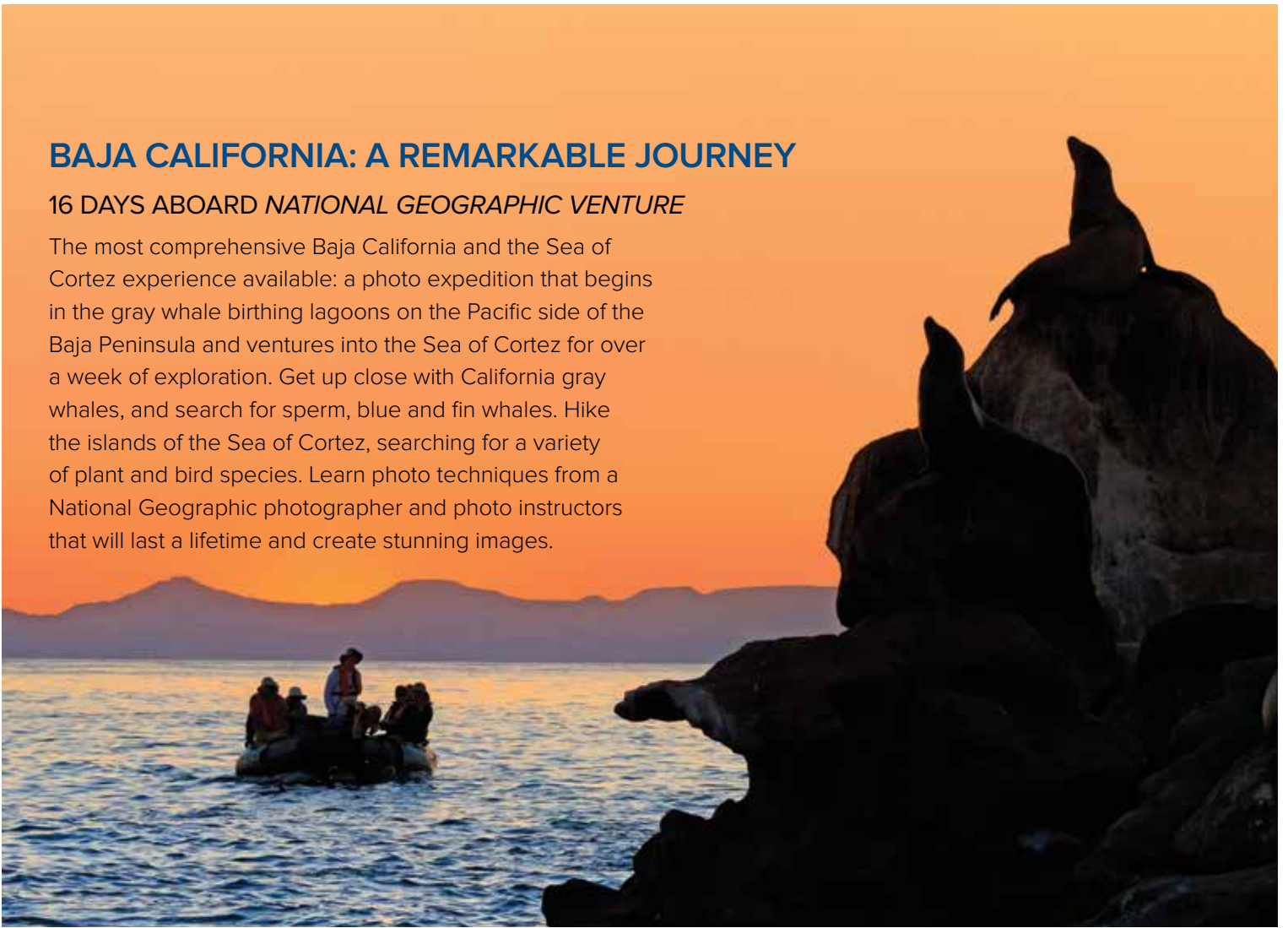

WHALES & WILDNESS: SPRING IN THE SEA OF CORTEZ

8 DAYS ABOARD *NATIONAL GEOGRAPHIC VENTURE*

The Sea of Cortez in spring is among the best times and places to see a great variety of whales—humpback, sperm, fin, and blue whales—plus large aggregations of dolphins. Kayak amid the Sea’s many islands, venturing into water-level caves. Hike uninhabited beaches. Snorkel among fish and acrobatic sea lions. And see wild cactus gardens in bloom. Voyage far from tourist infrastructure, free to follow the seasonal movements of wildlife, stopping to observe as long as we want. This is true expedition travel, where day-by-day plans are guided by the seasonal movements of birds and marine mammals—in one of the most exhilarating places on Earth.

▶ VISIT [EXPEDITIONS.COM/BAJA](https://www.expeditions.com/baja) FOR ADDITIONAL INFORMATION, AND SEE PAGE 29 FOR COMPLETE PRICES.

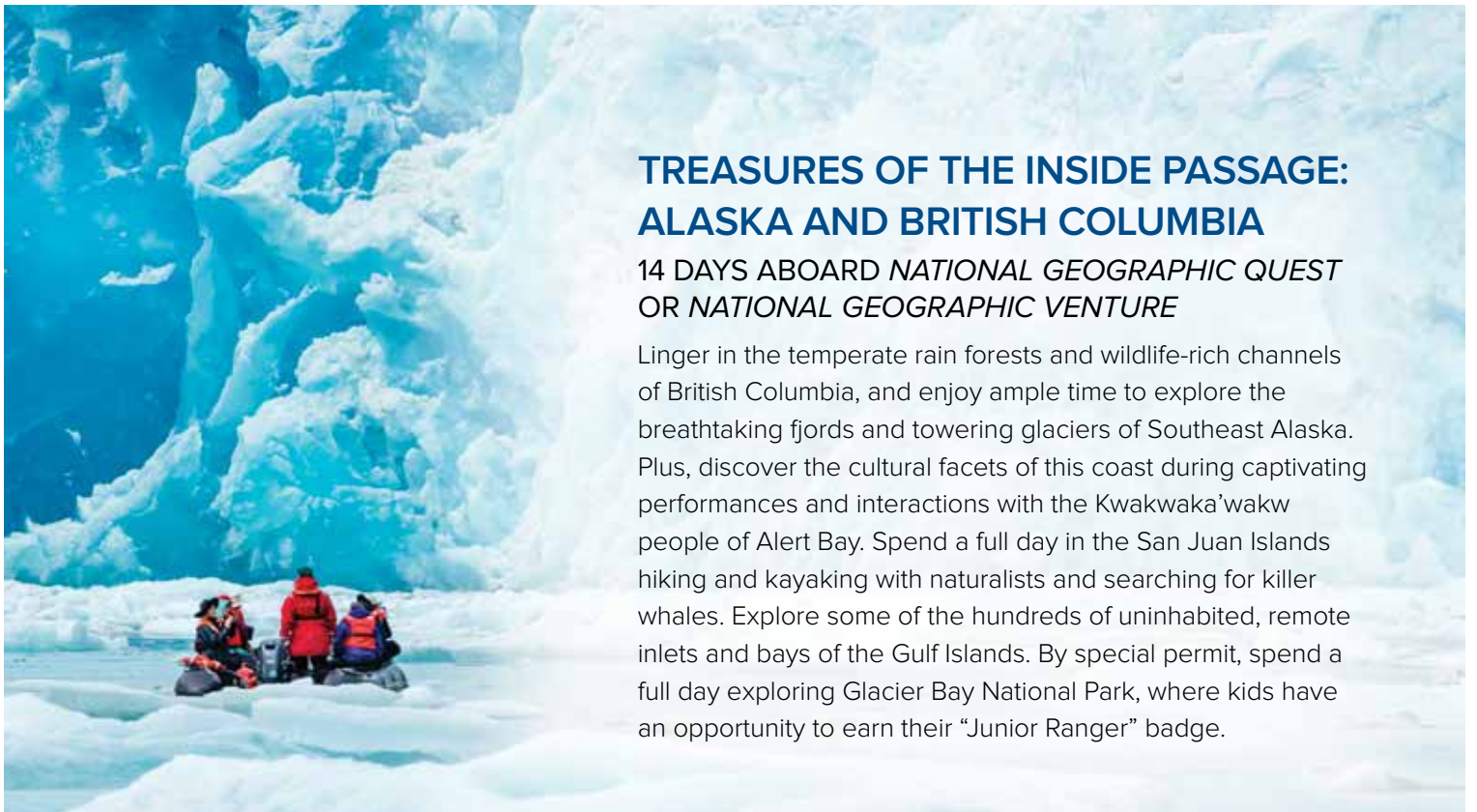

TREASURES OF THE INSIDE PASSAGE: ALASKA AND BRITISH COLUMBIA

14 DAYS ABOARD *NATIONAL GEOGRAPHIC QUEST*
OR *NATIONAL GEOGRAPHIC VENTURE*

Linger in the temperate rain forests and wildlife-rich channels of British Columbia, and enjoy ample time to explore the breathtaking fjords and towering glaciers of Southeast Alaska. Plus, discover the cultural facets of this coast during captivating performances and interactions with the Kwakwaka'wakw people of Alert Bay. Spend a full day in the San Juan Islands hiking and kayaking with naturalists and searching for killer whales. Explore some of the hundreds of uninhabited, remote inlets and bays of the Gulf Islands. By special permit, spend a full day exploring Glacier Bay National Park, where kids have an opportunity to earn their "Junior Ranger" badge.



A REMARKABLE JOURNEY TO ALASKA, BRITISH COLUMBIA & HAIDA GWAI

15 DAYS ABOARD *NATIONAL GEOGRAPHIC SEA BIRD*
OR *NATIONAL GEOGRAPHIC SEA LION*

Embark on a 15-day adventure between Sitka, Alaska, and Seattle, Washington exploring three of the most appealing wild regions in the Pacific Northwest: Alaska's Inside Passage, coastal British Columbia, and Haida Gwaii. You'll sail into mist-shrouded fjords and past crashing glaciers, see brown bears stalking shores, and eagles flying. And in Haida Gwaii you'll meet artisans and experience the resonance of their cultural heritage and artwork. With our special access to Gwaii Haanas National Park Reserve, National Marine Conservation Area Reserve, and Haida Heritage Site, you'll see ancient village sites, and the endemic species that make Haida Gwaii the 'Canadian Galápagos.'

WILD ALASKA ESCAPE

6 DAYS ABOARD NATIONAL GEOGRAPHIC SEA BIRD

Explore Alaska on an active, exciting expedition to see the region's iconic wildlife and epic landscapes. Take long hikes on world-class trails through forests of towering trees, kayak long routes deep into glacially carved fjords, and raft to an ancient Alaska native village—all with our nimble expedition ship as your moving basecamp. Choose to raft the Chilkat River with local guides and call at the ancient Chilkat Tlingit village of Klukwan. Explore Haines, the 'adventure capital of Alaska,' via raft, bicycle, or hiking boot. Take a flightseeing excursion for thrilling aerial views of Glacier Bay National Park. Paddle on long, naturalist-guided kayaking journeys into Alaska's dramatic bays, and zip around incredible bergs in Tracy or Endicott Arm—all in the compact timeframe of one week.



BIG PICTURE ALASKA

11 DAYS ABOARD NATIONAL GEOGRAPHIC SEA BIRD

Embark on an immersive, wide-ranging photo expedition that focuses on Alaska's famed Inside Passage. You'll experience the perfect mix of small-town life and the grand expanse of wild landscape that surrounds it. Raft through the Chilkat Bald Eagle Preserve, with the largest congregation of bald eagles in the world. Explore Glacier Bay National Park, Misty Fjords National Monument, and search for humpback whales in their summer feeding grounds. Kayak amid glacial ice, hike the Tongass National Forest and learn about the region's rich Tlingit heritage. Whether you're new to photography or a published pro eager to add Alaska to your portfolio, you'll find photo ops with outings timed to take advantage of morning and evening light, and insights into wildlife behavior that will help you create dynamic shots.

▶ VISIT [EXPEDITIONS.COM/ALASKA](https://www.nationalgeographic.com/expeditions/alaska) FOR ADDITIONAL INFORMATION, AND SEE PAGE 29 & 31 FOR COMPLETE PRICES.





NATIONAL GEOGRAPHIC ENDEAVOUR II

CAPACITY: 96 guests in 52 outside cabins.

REGISTRY: Ecuador. **OVERALL LENGTH:** 236 feet.

PUBLIC AREAS: Expansive forward lounge and bar accommodating all guests for presentations and gatherings, restaurant, large library with Mac kiosks, open-air observation deck, underwater gear area and open bridge, where guests can meet the captain and officers and learn about navigation. Ship refitted for Galápagos in 2016.

MEALS: Served in a single, unassigned seating in a sociable, informal atmosphere with Ecuadorian flair.

CABINS: All face outside with large windows, and feature twin beds that convert to a queen. With private facilities and climate control, nightstands, desk, and storage. Seven sets of cabins with a connecting door.

EXPEDITION EQUIPMENT: Zodiacs, glass-bottom boat, kayaks and stand-up paddleboards, snorkel gear and wet suits for both adults and children, video microscope and underwater video camera.

SPECIAL FEATURES: Shipboard doctor, Lindblad-National Geographic certified photo instructor, video chronicler, National Geographic Global Explorers program for kids and teens, snorkel instruction, Wi-Fi access, laundry service, Global Gallery.

WELLNESS: LEXSpa and fitness center, exercise classes, and wellness specialist.

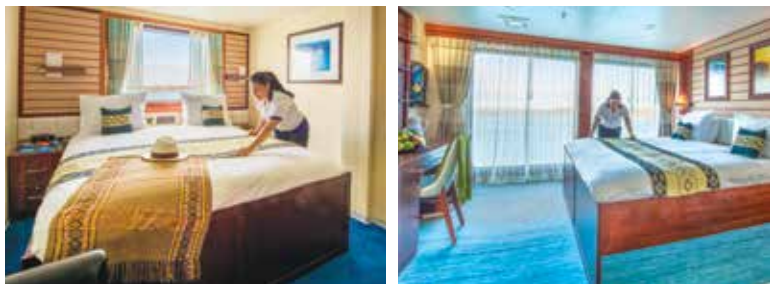

Clockwise from top: National Geographic Endeavour II features 52 cabins accommodating 96 guests; the new lounge's panoramic windows ensure stunning Galápagos views; Suite B, Category 4 cabin.

CATEGORY 1: Upper Deck, Forward #201, 202

CATEGORY 2: Upper Deck #211, 213-219, 221, 222, 224-229

CATEGORY 3: Lounge Deck #311, 313-319, 321, 322, 324, 326, 328, 330

CATEGORY 4: Bridge Deck #409, 411-414, 416, 418

SUITE A: Lounge Deck, Mid-Ship #320—with two windows, larger bath, arm chair. Connecting door to #322.

SUITE B: Bridge Deck, Mid-Ship #420, 422—with two floor-to-ceiling windows, larger bath, convertible sofa for a third person.

SUITE C: Bridge Deck, Mid-Ship #415—with two large windows, larger bath, separate sitting area with convertible sofa for a third person and arm chairs, largest cabin on ship.

CATEGORY 2 SOLO: Upper Deck #203-209—with a queen bed.

CATEGORY 3 SOLO: Lounge Deck #325, 327—with a queen bed.

NOTE: All cabins feature the option of two twins or a queen bed, plus large window(s), desk, chair, and closet.

CONNECTING CABINS: #226/228, 227/229, 315/317, 316/318, 320/322, 411/413, 416/418

TRIPLE OCCUPANCY: #224, 225, 326, 328 with fold-down upper third bed, Suites B and C with convertible sofa bed. Third person rates are one-half per person double occupancy rate.

SHARED ACCOMMODATIONS: Shares can be arranged at the double occupancy rate in Categories 1 and 2.

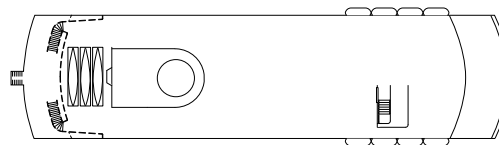

OBSERVATION DECK

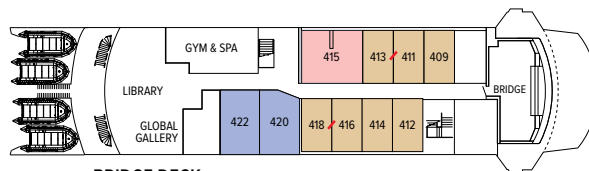

BRIDGE DECK

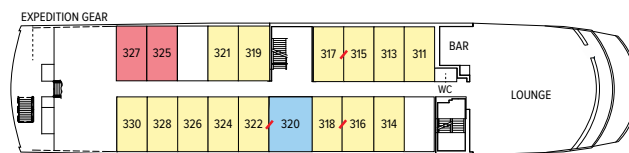

LOUNGE DECK

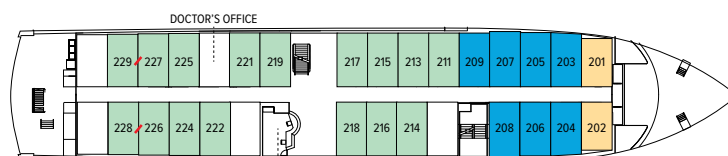

UPPER DECK

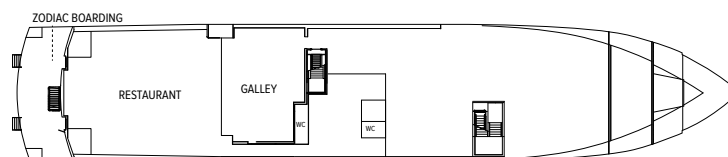

MAIN DECK

↗ indicates adjoining cabins

Prices are per person, double occupancy unless indicated as solo.

ITINERARY		CAT. 1	CAT. 2	CAT. 3	CAT. 4	SUITE A	SUITE B	SUITE C	CAT. 2 SOLO	CAT. 3 SOLO	ADVANCE PAYMENT	NOTE
Galápagos: Aboard <i>National Geographic Endeavour II</i> – 10 days/9 nights												
Departing Fridays throughout the year	2018/2019*	\$6,960	\$8,100	\$8,990	\$9,970	\$11,950	\$12,890	\$13,660	\$10,130	\$11,240	\$750	International and internal Ecuador tickets must be issued separately for all Galápagos voyages. Sample International Airfares: round-trip Miami/Guayaquil: Economy from \$500; Business from \$1,050. Sample Internal Airfares: Guayaquil/ Galápagos: Adult from \$520; children under 12 from \$260. Call for sample Peru airfare.
Holiday	Dec. 21 & 28, 2018 Dec. 20 & 27, 2019*	\$7,780	\$8,990	\$10,050	\$11,150	\$13,390	\$14,450	\$15,400	\$11,240	\$12,560	\$1,000	
Galápagos + Machu Picchu & The Land of the Inca – 16 days/15 nights												
Departing Fridays throughout the year*	2018/2019*	\$12,650	\$13,790	\$14,680	\$15,660	\$17,640	\$18,580	\$19,350	\$17,200	\$18,310	\$1,500	
Holiday	Dec. 14, 2018	\$13,380	\$14,520	\$15,410	\$16,390	\$18,370	\$19,310	\$20,080	\$17,930	\$19,040	\$1,500	
	Dec. 28, 2018	\$13,470	\$14,680	\$15,740	\$16,840	\$19,080	\$20,140	\$21,090	\$18,310	\$19,630		
	Dec. 20, 2019*	\$14,200	\$15,410	\$16,470	\$17,570	\$19,810	\$20,870	\$21,820	\$19,040	\$20,360		
Tropical Andes + Galápagos Aboard <i>National Geographic Endeavour II</i> – 14 days/13 nights – (Please call for dates and rates)												

*Early Booking Savings: 2018 prices guaranteed for 2019 departures if booked by Mar. 31, 2018. After Mar. 31, 2018, call or visit expeditions.com for new 2019 prices.



NATIONAL GEOGRAPHIC ISLANDER

CAPACITY: 48 guests in 24 outside cabins.

REGISTRY: Ecuador. **OVERALL LENGTH:** 164 feet.

PUBLIC AREAS: Open-air observation deck, second covered outside deck with hammocks, tables and chairs. Lounge and bar accommodating all guests for presentations and gatherings, dining room, library, Mac kiosks and internet. The captain and officers welcome guests to visit the open bridge.

MEALS: Served in a single, unassigned seating in a sociable, informal atmosphere with Ecuadorian flair.

CABINS: All have a window with an outside view, private facilities, ample storage and climate controls. Bed can be configured as two twins or as a single queen.

EXPEDITION EQUIPMENT: Zodiacs, a fleet of kayaks and stand-up paddleboards, snorkel gear and wet suits for both adults and children, video microscope and underwater video camera.

SPECIAL FEATURES: Shipboard doctor, Lindblad-National Geographic certified photo instructor, National Geographic Global Explorers program for kids and teens, video chronicler, snorkel instruction, Wi-Fi access, laundry service, Global Gallery.

WELLNESS: LEXSpa and fitness center, exercise classes, and wellness specialist.



Insets clockwise from top: Our hospitality staff is at your service and an integral part of your expedition; library; spacious and comfortable lounge.



Category 3 cabin; Category 5 cabin.

CATEGORY 1: Main Deck, Forward #201-206

CATEGORY 2: Main Deck #207-210

CATEGORY 3: Bridge Deck #303-306. Cabins 305 and 306 can accommodate a third person with sofa bed.

CATEGORY 4: Upper Deck #403-408—with outside, glassed-in terraces with windowed door and seating.

CATEGORY 5: Upper Deck, #401 and 402—forward facing with additional seating, desk, wrap-around windows, glassed-in terrace with seating. Largest cabins aboard.

NOTE: All cabins offer two twin beds that can be converted to a queen. Sole occupancy in categories 1 and 2 only. Third person rates for cabins 305 and 306 are one-half per person double occupancy rate.

SHARED ACCOMMODATIONS: Shares can be arranged at the double occupancy rate in Categories 1 and 2 only.

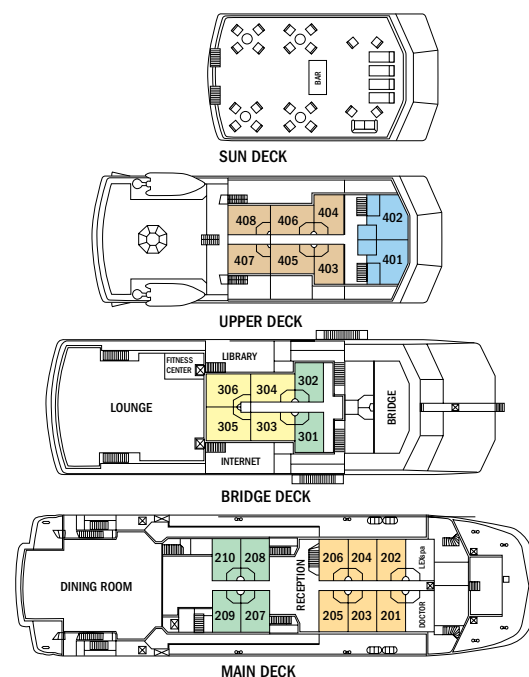

Prices are per person, double occupancy unless indicated as solo.

ITINERARY		CAT. 1	CAT. 2	CAT. 3	CAT. 4	CAT. 5	CAT. 1 SOLO	CAT. 2 SOLO	ADVANCE PAYMENT	NOTE
Galápagos: Aboard <i>National Geographic Islander</i> – 10 days/9 nights										
Departing Saturdays throughout the year	2018/2019*	\$7,330	\$8,290	\$9,170	\$9,750	\$11,860	\$10,990	\$12,440	\$750	International and internal Ecuador tickets must be issued separately for all Galápagos voyages. Sample International Airfares: round-trip Miami/Guayaquil: Economy from \$500; Business from \$1,050. Sample Internal Airfares: Guayaquil/Galápagos: Adult from \$520 Children (Under 12) from \$260. Call for sample Peru airfare.
Holiday	Dec. 22 & 29, 2018 Dec. 21 & 28, 2019*	\$8,390	\$9,440	\$10,270	\$10,900	\$13,070	\$12,590	\$14,160	\$1,000	
Galápagos + Machu Picchu & The Land Of The Inca – 16 days/15 nights										
Departing Saturdays throughout the year	2018/2019*	\$13,020	\$13,980	\$14,860	\$15,440	\$17,550	\$18,060	\$19,510	\$1,500	
Holiday	Dec. 29, 2018	\$14,810	\$15,860	\$16,690	\$17,320	\$19,490	\$20,390	\$21,960	\$1,500	
	Dec. 14, 2019*	\$13,750	\$14,710	\$15,590	\$16,170	\$18,280	\$18,790	\$20,240		
	Dec. 28, 2019*	\$14,080	\$15,130	\$15,960	\$16,590	\$18,760	\$19,660	\$21,230		
Tropical Andes + Galápagos aboard <i>National Geographic Islander</i> – 14 days/13 nights (Please call for dates and rates)										

*Early Booking Savings: 2018 prices guaranteed for 2019 departures if booked by Mar. 31, 2018. After Mar. 31, 2018, call or visit expeditions.com for new 2019 prices.



NATIONAL GEOGRAPHIC SEA BIRD & NATIONAL GEOGRAPHIC SEA LION

CAPACITY: 62 guests in 31 outside cabins.

REGISTRY: United States. **OVERALL LENGTH:** 152 feet.

PUBLIC AREAS: Our twin sister ships feature a library; global market; lounge with full-service bar and facilities for films, slide shows and presentations; observation deck; partially covered sun deck with chairs and tables, and LEXspa. Our “open bridge” provides guests an opportunity to meet our officers and captain and learn about navigation.

MEALS: Served in single seatings with unassigned tables for an informal atmosphere and easy mingling. Breakfasts are wide selection buffets and lunch is often served family style. Dinners are primarily served plated. Menu emphasizes local fare.

CABINS: All face outside with windows, private facilities and climate controls.

EXPEDITION EQUIPMENT: Bow camera, hydrophone, kayaks, fleet of paddleboards, splash-cam, underwater video camera, video microscope, wet suits and snorkle gear in Baja California, and expedition landing craft.

SPECIAL FEATURES: Guest internet access. A certified photo instructor and a video chronicler are on board all voyages. A ship’s doctor is on board in Baja. An undersea specialist is on board in Baja and Alaska.

WELLNESS: The vessel is staffed by a wellness specialist and features exercise equipment, LEXspa and outdoor stretching area.



Insets clockwise from top: Lounge with expedition library and flatscreen TVs for vibrant presentations; dinner is served in single seatings with unassigned tables for easy mingling; morning yoga on the back deck.



Left to right: Twin beds can be pushed together to form a double bed in Category 3 cabins on the Upper Deck; a comfortable Category 2 cabin redesigned.

CATEGORY 1: Main Deck #300-305—Conveniently positioned between the dining room & lounge, these cabins feature two single lower beds, and a large view window.

CATEGORY 2: Bridge Deck #100-104; Upper Deck #200-212, 215—These well-located cabins include two lower single beds & a view window.

CATEGORY 3: Bridge Deck #105, 106; Upper Deck #214, 216, 217, 219—These cabins feature a seating unit with table and two large view windows. Upper Deck cabins include two lower single beds which can convert to a double bed and a pull-out single bed for a third person; Bridge Deck cabins include two lower single beds only.

NOTE: Sole Occupancy cabins are available in Categories 1 and 2 only. Third person rates are available in certain categories at one half the double occupancy rate.

SHARED ACCOMMODATIONS: Shares can be arranged at the double occupancy rate in Categories 1 and 2 only.

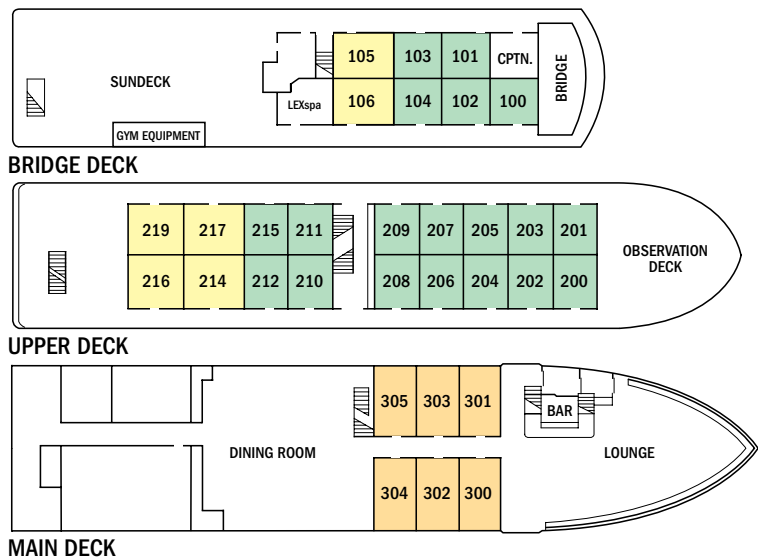

Prices are per person, double occupancy unless indicated as solo.

ITINERARY	YEAR	CAT. 1	CAT. 2	CAT. 3	CAT. 1 SOLO	CAT. 2 SOLO	ADVANCE PAYMENT	NOTE
Exploring Alaska's Coastal Wilderness – Page 22	2018/19	\$5,990	\$6,890	\$7,990	\$8,990	\$10,340	\$750	Sample Airfares: Seattle/Juneau/Sitka/Seattle or vice versa: Economy from \$350; Business from \$800.
A Remarkable Journey to Alaska, British Columbia & Haida Gwaii – Page 22	2018	\$10,900	\$12,450	\$14,530	\$16,350	\$19,860	\$1,500	Sample Airfares: Seattle/Sitka: Economy from \$200; Business from \$350.
Wild Alaska Escape – Page 23	2018/19	\$4,290	\$4,990	\$5,990	\$6,440	\$7,490	\$750	Sample Airfares: Seattle/Juneau/Sitka/Seattle or vice versa: Economy from \$350; Business from \$600.
Big Picture Alaska – Page 23	2018/19	\$8,990	\$10,490	\$11,890	\$13,490	\$15,740	\$1,000	Sample Airfares: Seattle/Ketchikan/Sitka/Seattle or vice versa: Economy from \$360; Business from \$750.

NEW SHIPS



NATIONAL GEOGRAPHIC QUEST & NATIONAL GEOGRAPHIC VENTURE

CAPACITY: 100 Guests in 50 cabins.
REGISTRY: United States. **OVERALL LENGTH:** 238 feet.

Sister ships *National Geographic Quest* and *National Geographic Venture* (launching 2019) will be the latest additions to our fleet. Designed with over 50 years of expedition heritage and built in the U.S.A., both ships will set a new standard in exploration and comfort.

PUBLIC AREAS: Global gallery; fitness center; LEXspa; lounge with full service bar and facilities for films and presentations; observation deck; mudroom with lockers for expedition gear, and a partially covered sundeck with chairs and tables. Our “open bridge” provides guests an opportunity to meet our officers and captain and learn about navigation.

MEALS: Served in single seatings with unassigned tables for an informal atmosphere and easy mingling. Breakfast and lunch are wide selection buffets with chef action stations, while dinners are primarily served plated. Menu emphasizes local fare.

CABINS: All cabins face outside with windows or portholes, private facilities and climate controls. Category 4 cabins have step-out balconies.

EXPEDITION EQUIPMENT: A fleet of 8 Zodiacs and 24 kayaks, Remotely Operated Vehicle (ROV), hydrophone, splash-cam, underwater video camera, video microscope, paddleboards, snorkeling gear for all guests (where applicable).

SPECIAL FEATURES: Guest internet access, elevator, Lindblad-National Geographic certified photo instructor, a video chronicler and undersea specialist. A ship’s doctor is on board in Baja.

WELLNESS: The vessel is staffed by a Wellness Specialist and features a gym with an elliptical machine, treadmill, exercycles, handweights and resistance bands. Treatments in the LEXspa are available by appointment.



Insets clockwise from top: The lounge, with 270° views, is the hub of the expedition community; a spacious and open sun deck provides unparalleled views.



Left to right: Category 5 cabin is our most spacious; Category 4 cabin with lower single beds (which can be converted to a Queen) and a private step-out balcony. Select cabins connect via an inside doorway; Standard bathroom.

CATEGORY 1: Main Deck #301-306 Cabins feature two lower single beds that can convert to a Queen, a writing desk and two portholes.

CATEGORY 2: Main Deck #307-315 Cabins feature two lower single beds that can convert to a Queen, a writing desk and two portholes.

CATEGORY 3: Upper Deck #201-206 Cabins feature two lower single beds that can convert to a Queen, a writing desk and two large view windows.

CATEGORY 4: Upper Deck #207-229 Cabins feature two lower single beds that can convert to a Queen, a writing desk, sliding glass door, and small, private balcony.

CATEGORY 5 (SUITE): Observation Deck #101-108 Cabins feature two lower single beds that can convert to a Queen, large view windows, an expanded bathroom, writing desk, ample storage space, and a convertible sofa bed to accommodate a third person.

NOTE: Sole Occupancy cabins are available in Categories 1 and 2 only. Third person rates are available in Category 5 cabins at one half the double occupancy rate.

Connecting Cabins via internal doorway access: Main Deck: #312-314, #311-315, #306-308, #305-307; Upper Deck: #224-226, #225-227.

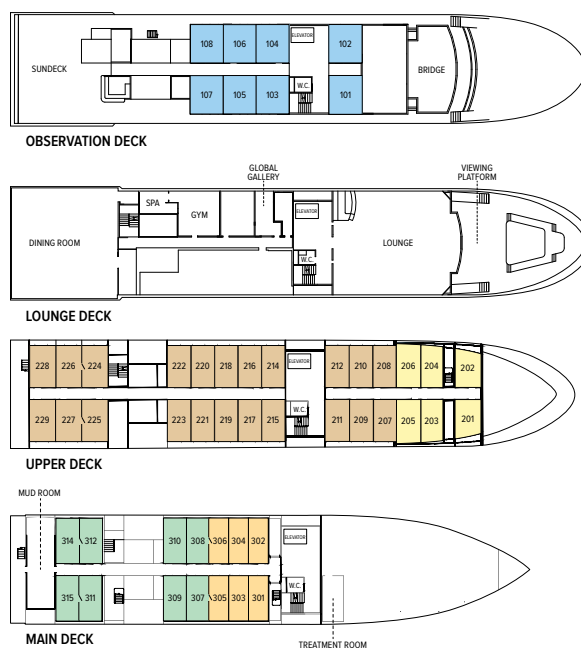

Prices are per person, double occupancy unless indicated as solo.

ITINERARY	YEAR	CAT. 1	CAT. 2	CAT. 3	CAT. 4	CAT. 5 SUITE	CAT. 1 SOLO	CAT. 2 SOLO	ADVANCE PAYMENT	NOTE
Exploring Alaska's Coastal Wilderness – Page 16	2018/19	\$6,590	\$7,290	\$7,790	\$8,690	\$9,590	\$9,990	\$10,600	\$750	Sample Airfares: Seattle/Juneau/Sitka/Seattle or vice versa: Economy from \$350; Business from \$800.
Treasures of the Inside Passage: Alaska and British Columbia – Page 22	2018/19	\$9,990	\$10,640	\$11,190	\$11,990	\$12,890	\$14,990	\$15,960	\$1,000	Sample Airfares: Seattle/Juneau/Sitka/Seattle or vice versa: Economy from \$350; Business from \$800.
Baja California and the Sea of Cortez: Among The Great Whales – Page 18	2019	\$7,530	\$8,330	\$8,900	\$9,930	\$10,960	\$11,290	\$12,490	\$750	Sample Airfares: Round-trip Los Angeles/Los Cabos/Los Angeles: Economy from \$370. Business from \$1,100.
Baja California: A Remarkable Journey – Page 21	2019	\$11,990	\$13,260	\$14,160	\$15,790	\$17,420	\$17,990	\$19,890	\$1,500	Sample Airfares: Round-trip Los Angeles/Los Cabos/Los Angeles: Economy from \$370. Business from \$1,100.
Whales & Wildness: Spring in the Sea of Cortez – Page 21	2019	\$6,380	\$6,990	\$7,480	\$8,340	\$9,170	\$9,570	\$10,500	\$750	Sample Airfares: Round-trip Los Angeles/Los Cabos/Los Angeles: Economy from \$370. Business from \$1,100.

TAKE ADVANTAGE OF OUR SPECIAL OFFERS



SPECIAL OFFERS: Offers are available on select departures, and based on availability at the time of booking. On voyages with complimentary air offers, airfare is based on economy group flights that must be ticketed by Lindblad Expeditions. In the case that Lindblad's group or charter flights are no longer available at time of booking, we

reserve the right to issue a credit. All offers are valid for new bookings only, subject to availability at the time of booking, and may not be combined with other offers and pre- and post-extensions. Call for details.

BRINGING THE KIDS: We believe sharing an expedition with your kids or grandkids is a life-enhancing experience. So take \$500 off for each child under the age of 18.

BACK-TO-BACK SAVINGS: Save 10% on any consecutive journeys taken on board our expedition ships. This savings is applicable on voyage fares only, and are not valid on extensions or airfare.

TRAVELING AS A GROUP: Save 5% when traveling as a group of 8 or more people. Take advantage of these great savings, while enjoying traveling with your friends and family. This savings is applicable to voyage fares only, and is not valid on extensions or airfare. Deposit, final payments, and cancellation policies for group travel vary from our regular policies.

COMBINING OFFERS: Certain offers may be combinable, up to two savings opportunities except where noted otherwise. For example, travel with a group of 8 or more on back-to-back expeditions, and take advantage of both savings!

INCLUSIVE PRICING

We include just about everything you have the opportunity to do as part of your expedition aboard ship and ashore. The only things not included are those of a personal nature—alcohol, internet usage, tips to the crew, wellness treatments and other specialized arrangements.

ABOARD SHIP

- ✓ All meals and non-alcoholic beverages*
- ✓ Cappuccinos, lattes & complimentary refillable water bottle
- ✓ 24-hour coffee, tea & soda on demand
- ✓ Hors d'oeuvres & snacks during lounge recap
- ✓ Sauna
- ✓ Fitness center
- ✓ Fully stocked library
- ✓ The guidance and company of our expedition staff

ASHORE

- ✓ Meals on land, as indicated in itinerary
- ✓ Special access permits, park fees, port taxes
- ✓ Transfers to and from group flights
- ✓ The expertise of our expedition staff

ACTIVITIES

- ✓ All excursions
- ✓ Zodiac & kayak explorations
- ✓ Snorkeling and paddleboarding (where indicated)
- ✓ Lectures & presentations in the lounge

Note: Amenities vary across fleet, and are provided where applicable.

BE PART OF OUR EXPEDITION COMMUNITY

Join in! Here's how:

- ✓ Check our daily blog for interesting posts, video clips and Photos of The Week: expeditions.com/blog
- ✓ Like us on Facebook: hear what our travelers have to say, get inspired and chime in: facebook.com/LindbladExpeditions
- ✓ Preview an expedition before you go or subscribe to our videos on youtube.com/lindbladexpeditions
- ✓ Follow us @LindbladExp and our founder, Sven Lindblad @SvenLEX, on Twitter; and on Instagram @SOLindblad for his interesting view of the world.
- ✓ Check out Expedition Snapshots from guests—and upload your own on the expeditions.com homepage.



RESERVATION INFO

Costs Include: All accommodations aboard ships or in hotels per itinerary or similar, all meals and non-alcoholic beverages aboard ship, meals on land as indicated, air transportation where indicated as included, shore excursions, sightseeing and entrance fees, special access permits, transfers to and from group flights, use of snorkeling equipment and wetsuits (where applicable), use of kayaks and/or stand-up paddleboards (where available), use of cross-country skis or snowshoes (where available), tips (except to ship's crew), taxes and service charges, services of a ship physician on most voyages, and services of our expedition staff.

Not Included: Air transportation (except where shown as included), extensions, passport, visa, immigration fees, scuba diving (where available), meals not indicated, travel protection plan, items of a personal nature, such as alcoholic beverages, internet access, voyage DVD (where available) and laundry. Gratuities to ship's crew are at your discretion.

Airfare: For all programs, airfare is an additional cost unless otherwise indicated. Sample airfares are subject to change. We will gladly assist in making your air arrangements for a \$50 per person service fee.

TERMS & CONDITIONS

Reservations: To reserve your place, an advance payment is required at the time of reservation. The per person advance payment amount varies by program, and is outlined in our brochures, as well as on our website. Holiday departure dates and certain longer voyages may carry additional advance deposit requirements due to high demand for these voyages. Payment is accepted by Visa, MasterCard, American Express, Discover, or by check.

Receipt of your initial payment indicates your acceptance of our complete Terms and Conditions. We require written notice at the time of reservation for any physical condition, diet, or treatment requiring special attention.

Once your reservation is confirmed, we urge you to use your personalized online account for important information to help you prepare for your voyage. Managing your documents online will facilitate fast and accurate communication, and allow you to provide us with pertinent details we require, in order to complete your reservation. Your online account gives you access to your Expedition Guide, which includes valuable information specific to your voyage. You can also use your online account to make easy payments, view recommended flights and reading material, packing list, and so much more.

Final Payment: For expeditions aboard all ships with the exception of *Explorer* and *Orion*, final payment is due 90 days prior to departure.

Payment schedules may vary for Holiday departures and certain longer voyages, due to high demand for these voyages. We reserve the right to cancel your reservation if payment has not been received by final payment due date.

Travel Protection Plan: We recommend that you take advantage of our Travel Protection Plan. This plan offers comprehensive coverage to protect you from cancellation fees, costs incurred due to trip delays/interruption, damaged or lost luggage, medical assistance, and evacuation during your travels. Our Travel Protection Plan is available for U.S. and Canadian residents only, and may be purchased any time prior to final payment due date. If you are not satisfied for any reason, you may return your plan within 10 days after purchase. Your premium will be refunded if canceled within 10 days, provided you have not already departed on the trip or filed a claim. When so returned, the coverage under the plan is void from the original date of purchase.

Smoking Policy: Smoking is allowed only in designated outdoor areas.

Entry and Visa Requirements: All guests are advised to verify travel documents (passport/transit visa/entry visa) for the country through which they are transiting and/or entering. Reliable and most current information regarding international travel can be found by contacting the consulate/embassy of the country(s) you are visiting or transiting through. We will not be responsible if you are denied entry or transit into a country if you are unable to provide valid documents as per the country's requirement.

Responsibility and Other Terms & Conditions: Certain other provisions concerning, among other things, limitations of Lindblad Expeditions' and the National Geographic Society's liability for loss of property, injury, illness or death during the voyage will be provided to all guests on the ship's ticket sent prior to departure, and are also available on our website at www.expeditions.com/terms, or upon request. By registering for a trip, the guest agrees to all such terms and conditions.

Note: Itineraries and prices listed in this brochure are valid as of publication date, and are subject to change. Under normal conditions, the total expedition cost is guaranteed at the time of booking. However, the published price is determined far in advance of initial departure on the basis of then-existing projections of fuel and other costs. In the event we determine that current costs create an unsustainable financial model, including but not limited to increases in the price of fuel, currency fluctuations, increases in government taxes or levies, or increased security costs, we reserve the right to pass on these costs to you, to cover such unexpected increases. We will always provide a transparent accounting of the reason for such an increase in costs.

CANCELLATION POLICY	
FOR EXPEDITIONS ON ALL SHIPS WITH THE EXCEPTION OF <i>ORION</i> & <i>EXPLORER</i>	
Number of Days Prior to Expedition Start	Per Person Cancellation Fee
120 or more days	\$350*
119–90 days	Advance payment cost
89–60 days	25% of total fare
59–45 days	50% of total fare
44–0 days	No refund

*\$350 or \$750 will be refunded in the form of a Lindblad Expeditions Travel Certificate. This cancellation policy applies to expeditions, extensions (with the exception of Denali), as well as all other additional services. The effective date of a cancellation will be the date on which your cancellation notice is received. Any revisions you make within the cancellation penalty period, such as departure date or choice of voyage, are subject to cancellation fees. Note: Airline cancellation policies vary by carrier, as well as the type of fare used to issue your ticket. Cancellation policy for certain longer voyages and Holiday departures may vary due to high demand for these voyages. Our group cancellation and Denali cancellation policies are listed in the Terms and Conditions section of our website, or you may call us for details. We stress the importance of purchasing a travel protection plan to protect yourself from fees in the event you need to cancel your reservation.

United States Tour Operators Association
\$1 Million Travelers Assistance Program

Lindblad Expeditions, as an Active Member of USTOA, is required to post \$1 Million with USTOA to be used to reimburse, in accordance with the terms and conditions of the USTOA \$1 Million Travelers Assistance Program, the advance payments of Lindblad Expeditions customers in the unlikely event of Lindblad Expeditions bankruptcy, insolvency or cessation of business. Further, you should understand that the \$1 Million posted by Lindblad Expeditions may be sufficient to provide only a partial recovery of the advance payments received by Lindblad Expeditions. More details of the USTOA Travelers Assistance Program may be obtained by writing to USTOA at 345 Seventh Avenue, Suite 1801, New York, New York 10001, or by email to information@ustoa.com or by visiting their website at www.USTOA.com.



We are proud to be a Founding Member of Adventure Collection—a family of the world's most trusted and experienced active travel companies. Each member company of Adventure Collection is dedicated to enriching the lives of its guests and to giving back to the areas in which it travels. For more information visit www.AdventureCollection.com.



©2018 Lindblad Expeditions

Lindblad Expeditions and the Eye are the trademarks of Lindblad Expeditions. All rights reserved. NATIONAL GEOGRAPHIC and the Yellow Border are the trademarks of the National Geographic Society. All rights reserved.

Photo Credits: Alamy; Marc Cappelletti; Stewart Cohen; Alexandra C. Daley-Clark; Jennifer Davidson; Mike Greenfelder; Eric Guth; Malou Lasquite; Jeff Litton; Ralph Lee Hopkins; Sven-Olof Lindblad; Michael Kleinberg, Mashpi Lodge; Michael S. Nolan; Pete Pederson; Rich Reid; Jacob Riglin; Rikki Swenson, Paul Souders; Max Seigal; David Spiegel; Mark Thiessen; Marco Ricca; David Vargas; Christian Saa.

For Reservations:
Contact your travel advisor or Lindblad Expeditions
1.800.EXPEDITION (1.800.397.3348)

Reservation Hours: Monday – Friday 9am – 10pm ET
Saturday & Sunday 10am – 5pm ET

Lindblad Expeditions, Inc., 96 Morton Street, New York, NY 10014
Phone: 212.261.9000 • Fax: 212.265.3770

email: explore@expeditions.com For additional information and online reservations, visit us on the Web: www.expeditions.com



96 Morton Street
New York, NY 10014

PRSR STD
U.S. POSTAGE
PAID
LINDBLAD
EXPEDITIONS

Account Number:

Expedition Code: 2FAMFUA8

1.800.EXPEDITION | WWW.EXPEDITIONS.COM

♻️ Printed on 10% recycled content paper with soy-based inks. We recommend that you pass this along for others to enjoy or recycle.

FAM-018

SPECIAL SAVINGS:
\$500 PER CHILD UNDER 18
& 5% OFF FOR GROUPS
OF 8 OR MORE

▶ **GO TO WWW.EXPEDITIONS.COM/AWARDS**
TO SEE OUR COMMENDATIONS



How big is your wingspan?

