

POLAR AND SOLAR ADVENTURES

HOLIDAY DATES
& SPECIAL OFFERS

PLUS
NEW SHIP
NEW TRIPS



FALL-WINTER 2018-19



Lindblad
Expeditions



NATIONAL
GEOGRAPHIC™



Lindblad
Expeditions



NATIONAL
GEOGRAPHIC™

Lindblad Expeditions and National Geographic have joined forces to further inspire the world through expedition travel. Our collaboration in exploration, research, technology and conservation will provide extraordinary travel experiences and disseminate geographic knowledge around the globe.



DEAR TRAVELER,

The information arrayed for you here—the inspiring photos, the carefully described itineraries, the maps and the ships—are signposts, pointing you to exciting possibilities, and providing what you need to make your travel decision. But there's still a gap—between the possibilities we describe and the actual experiences you'll have. They're indescribable in a brochure. Only one thing can bridge the gap—your imagination.

So, I invite you to challenge your imagination. Look at the photos and try them on for size. Imagine being among 100,000 three-foot-tall birds, a nation of king penguins. Or standing in a field in the Galápagos highlands watching giant tortoises grazing through the grass. Imagine a whale a mere arm's distance away, at water level, making eye contact. Or the sun setting on life along the Mekong, as you take it all in from your private patio. Our expeditions contain all these experiences and more.

Imagine that you could take a mere few days and have the kind of extraordinary experiences that usually involve longer durations. Our new short itineraries enable you to do just that—to make the most of your precious getaways.

Our ships are perfectly designed for exploration—ideally sized to navigate shallow coves or narrow waterways, and equipped with cool tools for up-close encounters. And they're also perfectly designed for experiencing daily life in a new way, developing new habits like taking morning coffee on the bridge with the Captain and his officers. Making new friends over cards in the Observation Lounge. Or talking photography to your heart's content with a National Geographic photographer.

This year we welcome the brand-new 50-cabin *National Geographic Venture* to the fleet. And if you've ever delighted in that 'new car smell,' you might want to imagine how exhilarating being the first aboard a brand-new ship might be.

I hope you will enjoy playing the imagination game as you view this brochure. And that you'll join us for the real thing. The exhilarating discoveries that follow when you take a leap of imagination will revitalize, perhaps even transform you.

I promise you unforgettable experiences.

All the best,



Sven-Olof Lindblad

**BE SPONTANEOUS—HOLIDAY A NEW WAY
PLUS FIND FREE AIR ON 40+ DEPARTURES**

Find out more in this brochure and online.

WHAT'S INSIDE FOR YOU

SUMMER LIVES HERE: 2
Costa Rica, Belize, Baja,
Galápagos, Peru, Upper Amazon

**GET THE MOST OUT OF
GETTING AWAY:** 22
Base Camp Baja, Channel Islands,
Wild Galápagos, Peru Escape

SOUTHERN WILDNESS: 28
Antarctica, South Georgia
and the Falklands, Patagonia

**WHERE THE PAST INFORMS
THE PRESENT:** 40
Pacific Northwest, Caribbean,
South Pacific, Vietnam & Cambodia

DECK PLANS 52

EXTENSIONS 67

**SPECIAL OFFERS, INCLUSIVE
PRICING, EXPEDITIONS.COM** 68

RESERVATION INFORMATION 69

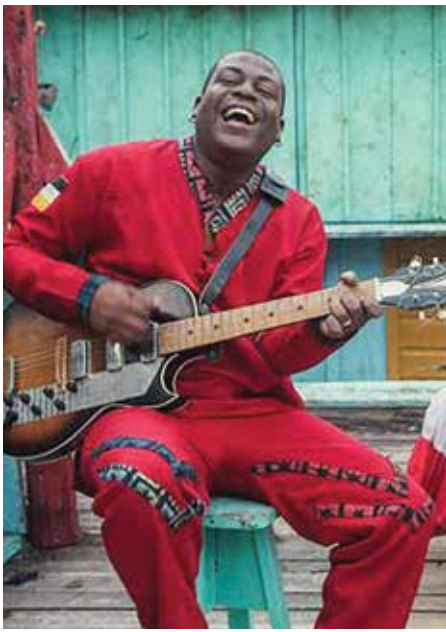



SEEKING SUMMER? IT LIVES HERE

Here is where tropical or equatorial warmth bathes lush landscapes, azure waters reflect pristine shores, and a fascinating parade of wildlife, from porpoising dolphins to courting blue-footed boobies, are waiting for you to observe and photograph. When the leaves start to turn and the temperature begins to drop where many of us live, the wild regions we explore in fall and winter—Galápagos, Baja, Costa Rica, Belize—are ripe for solar adventure. Explore with us and you'll discover these places in a different, more in-depth way, rewarding you with experiences a typical beach vacation cannot.

Snap a selfie with the world's most welcoming wildlife in Galápagos. Explore coral reefs and Mayan ruins in Belize and Guatemala. Transit the historic Panama Canal over two extraordinary days and venture into Costa Rica's tropical wilderness. Or join an inaugural season voyage aboard the brand-new *National Geographic Venture* in Baja California. Remember, winter was hard and summer is waiting—so choose yours.

Clockwise from top left: Garifuna musician, Belize; sloth, Costa Rica; a blue-footed booby shows off its wingspan, Galápagos; yoga in Baja California; Half Moon Caye, an island and natural monument in the Lighthouse Reef Atoll, Belize.

COSTA RICA & THE PANAMA CANAL

8 DAYS/7 NIGHTS—ABOARD NATIONAL GEOGRAPHIC QUEST

PRICES FROM: \$5,990 to \$9,890 (See page 63 for complete prices.)

Immerse yourself in natural wonders along the Pacific coast of Costa Rica and Panama on a voyage aboard the *National Geographic Quest*. Venture into the forests of Osa Peninsula; search for monkeys, frogs, sloths and brightly colored birds; and take an optional horseback ride on a pristine beach. Cap off your voyage with a crossing of the legendary Panama Canal.

EXPEDITION HIGHLIGHTS

- ▶ Discover hidden pools and waterfalls deep within the rain forest of the Osa Peninsula.
- ▶ Explore the tiny islands of the Gulf of Panama and snorkel off Isla Coiba.
- ▶ Examine the fascinating lock system that made the Panama Canal one of the greatest engineering achievements of its era.
- ▶ Meet and support inspiring local families on the remote Osa Peninsula.
- ▶ Add a pre- or post-voyage land extension and explore Costa Rica and Panama in-depth. See pages 6-7.

EXPERIENCE & EXPERTISE



Every expedition sails with a veteran expedition leader and a handpicked team of local naturalists including a Lindblad-National Geographic certified photo instructor. Each naturalist is deeply knowledgeable about Costa Rica and Panama and dedicated to sharing their passion for the region with you. Other key members of our 10-person expedition team include a wellness specialist, ship physician and a video chronicler. National Geographic experts are on select departures.

Visit our website to read staff bios for this expedition.



Keel-billed toucan.

DAY 1: U.S./SAN JOSÉ, COSTA RICA/ PUERTO CALDERA/EMBARK

Upon arrival in San José, transfer by land to Puerto Caldera and embark our ship *National Geographic Quest*. (D)

DAY 2: CORCOVADO NATIONAL PARK

Anchor off the Osa Peninsula to see some of the most pristine lowland rain forest on the Pacific coast. In the environs of Corcovado National Park, swim in waterfall pools, take an optional horseback ride on the coast, or trek through the rain forest for a chance to see four species of monkeys—howler, spider, capuchin, and squirrel. (B,L,D)



Golden-mantled howler monkeys.

DAY 3: OSA PENINSULA

Go ashore in the pristine waters of Playa Blanca. Head inland to meet and share with inspiring local families living in remote communities and working with cocoa, heart of palm, and sugar cane. Hike mature rain forest or kayak in peaceful waters in Golfo Dulce, the only tropical fjord on the continent. In the evening, enjoy drinks ashore and, hopefully, a beautiful sunset. (B,L,D)

DAY 4: GOLFO DULCE

Spend the day exploring the mangrove-fringed Golfo Dulce, on Costa Rica's southwest coast. Visit Casa Orquídeas, a tropical paradise of ornamental palms, bromeliads, heliconias, and orchids, closed to the general public and reached by boat only. Keep your eye out for tanagers, parrots, and toucans. Later, explore the placid bay, ideal for kayaking, stand-up paddleboarding, Zodiac rides, and swimming. (B,L,D)

DAY 5: COIBA NATIONAL PARK, PANAMA

The first stop in Panama this morning is at the remote Isla Coiba, one of the many islands of Coiba National Park, a UNESCO World Heritage site. Once a penal colony, the island



has long been protected and accessible by special permit only. Among its many endemic species are the Coiba Island agouti and the mantled howler monkey, as well as four varieties of sea turtle. Discover rich marine life while snorkeling, go kayaking or hiking, try stand-up paddleboarding, or simply relax on the beach. (B,L,D)

DAY 6: GULF OF PANAMA ISLETS/ PANAMA CANAL TRANSIT

Today, explore the tiny islets of the Gulf of Panama by Zodiac or kayak. Here we might spot frigatebirds, brown pelicans, neotropical cormorants, and brown boobies. Set sail for the Panama Canal this afternoon. Stretching more than 50 miles, the canal was a colossal engineering feat completed in 1914. It is still traversed by some 14,000 ships every year. As cargo ships tend to pass through the canal during the day, we'll most likely begin our crossing at night, when the canal is dramatically lit. (B,L,D)

DAY 7: GATÚN LAKE/PANAMA CANAL TRANSIT

By special arrangement, *National Geographic Quest* will anchor in Gatun Lake near the

Barro Colorado Nature Monument overnight. Today, choose hikes and Zodiac cruises at the Smithsonian Tropical Research Institute facility on Barro Colorado Island, or take a boat ride to the mouth of the Chagres River, for hikes on the Rainforest Discovery Center trails. This evening, continue through the complex lock system of the canal. (B,L,D)

DAY 8: COLÓN/PANAMA CITY/U.S.

After breakfast, disembark in Colón and transfer to the airport in Panama City for your flight home. (B)

EXPEDITION DETAILS

DATES: 2018 Dec. 8, 15*, 22, 29*

2019 Jan. 5, 12*, 19, 26*; Feb. 2; Mar. 29*

*These departures travel in reverse order, from Panama City to San José, making all the same stops.

SPECIAL OFFERS:

Book by **Oct. 31, 2018** and receive round-trip international airfare between Miami and San Jose/Panama City on select departures, or instead choose a complimentary two-day extension in Panama City.



Panama Canal.

THERE'S MORE TO EXPLORE—GO FURTHER

Make the most of your Costa Rica and Panama expedition with one of these extensions. Take advantage of your proximity to see, do, and learn more about this region's incredible diversity.

MONTEVERDE CLOUD FOREST + COSTA RICA TO PANAMA

11 DAYS/10 NIGHTS—LAND EXCURSION + NATIONAL GEOGRAPHIC QUEST

PRICES FROM: \$7,790 to \$11,920 (See page 63 for complete prices.)

DAY 1: MIAMI/SAN JOSE, COSTA RICA
Depart Miami mid-morning on a non-stop flight to San José, Costa Rica. Upon arrival, a short drive brings us to the Costa Rica Marriott Hotel. (D)

DAYS 2 AND 3: MONTEVERDE CLOUD FOREST

A scenic drive takes us to Monteverde Cloud Forest, an acclaimed private reserve. Bathed in cool, year-round moisture, the forest is covered with mosses and 300 species of orchids. Walk trails rich with butterflies and bird life. Ascend the Skywalk, a series of

suspension bridges, for a bird's-eye view of the rain forest canopy. Learn about life in the early Monteverde community from an original Quaker homesteader. Spend each night at a charming, family-owned lodge. (B,L,D)

DAY 4: MONTEVERDE/ PUERTO CALDERA/EMBARK
Visit a butterfly farm before transferring to Puerto Caldera to embark our ship. (B,L,D)

DAYS 4-11: FOLLOW COSTA RICA & THE PANAMA CANAL ITINERARY ON PAGE 4.



Guests explore on the Skywalk in Monteverde.

EXPEDITION DETAILS

DATES: 2018 Dec. 5, 19
2019 Jan. 2, 16, 30

PANAMA TO COSTA RICA + MONTEVERDE, ARENAL VOLCANO & TORTUGUERO

15 DAYS/14 NIGHTS—ABOARD NATIONAL GEOGRAPHIC QUEST

PRICES FROM: \$10,410 to \$14,810 (See page 63 for complete prices.)

DAYS 1-7 COSTA RICA & THE PANAMA CANAL ITINERARY IN REVERSE ON PAGE 4.

Note: days 8-15 can be taken as a stand-alone expedition. See page 7.

DAY 8: PUERTO CALDERA/ MONTEVERDE

Disembark and transfer to bird watch and search for American crocodiles. Later, visit the Bat Jungle exhibit or hear from an early Quaker settler. (B,L,D)

DAYS 9 AND 10: MONTEVERDE/ARENAL

Enjoy a visit to a butterfly farm and a tour of the Monteverde reserve. Get a new perspective on the region as you sail across Lake Arenal. Check into your hotel and relax in the naturally heated pools. (B,L,D)

DAYS 11 AND 12: ARENAL/TORTUGUERO

Walk the Arenal Hanging Bridges, strung through two miles of dense rain forest canopy. Then, a charter flight will bring us to Tortuguero, a spectacular lowland forest on Costa Rica's northeast coast. Tour the wildlife-rich canals of Tortuguero National Park in small guided boats. Later, check into a rustic lodge at the water's edge for dinner. (B,L,D)

DAYS 13 AND 14: TORTUGUERO/ SAN JOSÉ

Enjoy a visit to the Sea Turtle Conservancy to learn the area's history and go for a stroll through the carless village. Then, partake in a workshop on preparing chocolate at Sibu Chocolatier. The day ends with a farewell dinner. (B,L,D)



Kayaking in the canals of Tortuguero National Park.

DAY 15: SAN JOSÉ/U.S.

Transfer to San José airport for flights home. (B)

EXPEDITION DETAILS

DATES: 2018 Dec. 15, 29
2019 Jan. 12, 26; Mar. 29

EXPLORING COSTA RICA: CLOUD FOREST TO THE CARIBBEAN

9 DAYS/8 NIGHTS—LAND-ONLY EXCURSION

PRICES FROM: \$4,720 per person double occupancy and \$5,220 solo occupancy

EXPEDITION HIGHLIGHTS

- ▶ Walk trails with butterflies and birds, and watch for the rare resplendent quetzal.
- ▶ Ascend a series of suspension bridges for a bird's-eye view of the forest canopy.
- ▶ Monteverde's cloud forest is sprinkled with moss, 300 species of orchids and abundant wildlife.

DAY 1: U.S./SAN JOSÉ

Fly to the airport in San José, Costa Rica and transfer to your hotel. Meet your naturalist guide and enjoy a welcome dinner. (D)

DAY 2: SAN JOSÉ/TÁRCOLES RIVER/MONTEVERDE

Search for American crocodiles on the Tárcoles River before venturing to the nearby Bat Jungle exhibit. We'll check into a family-owned retreat with expansive grounds and picturesque views of the cloud forest. (B,L,D)

DAY 3: MONTEVERDE

Begin the day at a butterfly farm where we'll have the opportunity to see dozens of local species. After lunch, we'll tour the Monteverde Cloud Forest Reserve and search for monkeys, hummingbirds and possibly the rare resplendent quetzal. (B,L,D)

DAY 4: MONTEVERDE/ARENAL

After breakfast, drive to Lake Arenal and cross in small boats for a fresh perspective on the volcano. On the lake's far side, check into an elegant hotel surrounded by gardens and pastures with grazing animals and views of the smoldering Arenal Volcano. (B,L,D)

DAY 5: ARENAL VOLCANO

Walk the Arenal Hanging Bridges strung more than two miles through the rain forest canopy. Later, relax in the naturally heated thermal pools at your hotel. (B,L,D)

DAY 6: ARENAL/TORTUGUERO

A charter flight will bring us to Tortuguero, a spectacular lowland forest on Costa Rica's northeast coast. Tour the wildlife-rich canals of Tortuguero National Park in small guided boats. Later, check into a rustic lodge at the water's edge for dinner. (B,L,D)

DAYS 7 AND 8: TORTUGUERO/SAN JOSÉ

Today, continue to explore the Tortuguero National Park canals by boat or kayak to spot monkeys, caiman and myriad bird species. Enjoy a visit to the Sea Turtle Conservancy to learn the area's history and go for a stroll through the carless village. Then, partake in a workshop on preparing chocolate at Sibú Chocolatier. Both



days end with a delicious dinner prepared at the lodge, including a farewell dinner. (B,L,D)

DAY 9: SAN JOSÉ/U.S.

After breakfast, transfer to the San José airport for flights home. (B)

EXPEDITION DETAILS

DATES: 2018 Dec. 21

2019 Jan. 4, 18; Feb. 1; Apr. 4

EXTEND YOUR ADVENTURE

Take advantage of your proximity—add this Exploring Costa Rica: Cloud Forest to the Caribbean journey as a Post-Extension for the [Belize to Tikal](#) ship-based expedition, see pages 8-9.



Arenal Volcano.

BELIZE TO TIKAL: REEFS, RIVERS, AND RUINS OF THE MAYA WORLD

9 DAYS/8 NIGHTS—ABOARD NATIONAL GEOGRAPHIC QUEST

PRICES FROM: \$5,760 to \$9,270 (See page 63 for complete prices.)

Embark on a unique land-and-sea expedition to discover Maya ruins overgrown with tropical rain forest and incredible, seldom-seen reefs. Snorkel among some of the 65 species of stony coral and 500 species of fish on the Belize Barrier Reef with the 50-cabin *National Geographic Quest* as your base for exploration. Then venture to the ancient Maya ruins of Tikal to explore the stories and archaeological sites of these stone temples swathed in rain forest and teeming with wildlife.

EXPEDITION HIGHLIGHTS

- ▶ Venture into the jungles of Guatemala with local experts to discover the spectacular temples and pyramids of both Tikal and Yaxha.
- ▶ Spot rainbow-colored fish, turtles, and rays while snorkeling or diving the corals of the Belize Barrier Reef, one of the largest barrier reef systems in the world.
- ▶ Explore Belize's coastal rivers by Zodiac, to sight toucans, green iguanas and other wildlife.

SPECIAL MUSICAL FEATURE:

Our ethnomusicologist, Jacob Edgar, has arranged for a performance by the internationally renowned Garifuna Collective, the premier representative of Garifuna music from Belize on the international stage.



Tikal temple.

DAY 1: DEPART U.S./GUATEMALA/ EMBARK

Arrive in Guatemala City and connect to our charter flight to Puerto Barrios. Transfer to Puerto Santo Tomás, where you'll embark *National Geographic Quest*. (D)

DAY 2: MONKEY RIVER AND LAUGHING BIRD CAYE NATIONAL PARK, BELIZE

Board Zodiacs this morning and explore one of Belize's coastal rivers in search of toucans, green iguanas and other wildlife. This afternoon, anchor near one of the cayes within Laughing Bird Caye National Park. Snorkel, kayak, or try stand-up paddleboarding. Certified scuba divers may opt to join a reef dive (at an additional cost). (B,L,D)

DAY 3: EXPLORING THE BELIZE BARRIER REEF

Spanning more than 200 miles, the Belize Barrier Reef offers countless opportunities for exploration by ship and ashore on one of the many cayes. Don mask, fins and snorkel or paddle a kayak on a turquoise lagoon. Conditions permitting, have a beach barbecue lunch or dinner ashore. (B,L,D)

DAY 4: COCKSCOMB BASIN WILDLIFE SANCTUARY AND MANATEE OR SITTEE RIVER

Devote your morning to exploring Cockscomb Basin Wildlife Sanctuary, internationally recognized as the world's first jaguar reserve. Hike one of the many nature trails with your naturalists, photograph colorful tropical plants,

scan the forest for its abundant birdlife, and be on the lookout for the tracks of deer, tapirs, wildcats and other wildlife. Afterward, stop at a traditional Maya handicraft center. This afternoon, take a Zodiac cruise along the mangrove channels of one of Belize's coastal rivers. Internationally acclaimed drumming group, The Garifuna Collective, performs this evening. (B,L,D)

DAY 5: LIGHTHOUSE REEF ATOLL
Snorkel, dive, kayak, and stand-up paddleboard inside the fringing reef that surrounds Lighthouse Reef Atoll. This lagoon is dotted with hundreds of coral patches and is known for its high diversity of corals and fishes. (B,L,D)

DAY 6: PUERTO SANTO TOMAS, GUATEMALA/DISEMBARK/FLORES
Disembark this morning for our charter flight to Flores. Lunch at a picturesque restaurant overlooking Lake Petén Itzá, before transferring to the Hotel Camino Real Tikal. Check-in on arrival, then take an optional bird-watching walk with your naturalists, or a sunset boat ride on the lake. (B,L,D)

DAY 7: TIKAL NATIONAL PARK
Today is dedicated to exploring Tikal, a UNESCO World Heritage site and one of the largest and most impressive archaeological sites and urban centers of the pre-Columbian Maya civilization. Delve deep into Maya history and architecture as you explore the many temples, including Temple I, which rises 154 feet from the jungle floor, and the North and South Acropolis. (B,L,D)



DAY 8: YAXHÁ

Visit Yaxhá, the third largest ruin in the Maya world, beautifully situated on a ridge overlooking Yaxhá Lake. One of the few Maya sites still known by its Mayan name, "green waters" Yaxhá is spread out over nine plazas. This little-visited site contains hundreds of structures, dozens of stelae, multiple pyramid temples and ball courts. Stop at a traditional Guatemalan restaurant for lunch today. (B,L,D)

DAY 9: FLORES/GUATEMALA CITY/ HOME

Depart on a charter flight to Guatemala City this morning, where you'll connect to international flights home. (B)

EXPEDITION DETAILS

DATES: 2019 Feb. 13, 18, 23, 28; Mar. 5, 10, 15, 20

SPECIAL OFFERS:

Book by **Oct. 31, 2018** and receive **FREE ROUND-TRIP** economy group airfare between Miami and Guatemala City or \$350 air credit.

EXTEND YOUR ADVENTURE

Combine your Belize to Tikal expedition with a two-day/two-night in [Antiqua, Guatemala](#) (see page 67) OR join a 9-day/8-night extension [Exploring Costa Rica: Cloud Forest to the Caribbean](#). See page 7 for details.

NATIONAL GEOGRAPHIC EXPERT

Join expert archaeologist **Richard Hansen** on the Feb. 23, 2019 departure for a deeper look into Maya civilization.



Lighthouse Reef Atoll.

BAJA CALIFORNIA AND THE SEA OF CORTEZ: AMONG THE GREAT WHALES

10 DAYS/9 NIGHTS—ABOARD NATIONAL GEOGRAPHIC VENTURE
PRICES FROM: \$7,530 to \$12,490 (See page 63 for complete prices.)

Seeing gray whales in their natural habitat is one of the great delights of this voyage. In Laguna San Ignacio, venture out in small boats among these magnificent creatures. In the Sea of Cortez, search for a variety of whales, plus dolphins, blue-footed boobies, pelicans, cormorants and magnificent frigatebirds. You'll also snorkel among sea lions, join naturalists on hikes amid barrel cacti and sculpted sand dunes, and see a variety of desert flora and fauna.

EXPEDITION HIGHLIGHTS

- ▶ Explore the entrance of Bahía Magdalena as well as the breeding grounds of Laguna San Ignacio, and observe gray whales and their calves with our naturalists.
- ▶ Go snorkeling amid sea lions, brilliant blue damselfish, and schools of king angelfish.
- ▶ Kayak clear blue waters on the lookout for a variety of bird species including magnificent frigatebirds.
- ▶ Explore diverse landscapes, including sand dunes, a cactus forest and deserted islands.

EXPERIENCE & EXPERTISE



Our expert 10-person expedition team will illuminate the wonders of the Sea of Cortez from every possible angle. Your expedition leader, undersea specialist, Lindblad-National Geographic certified photo instructor and naturalists, plus a wellness specialist and video chronicler, are dedicated to ensuring an incredible voyage. Certain departures feature a National Geographic photographer or expert.

Visit our website to read staff bios for this expedition.

Gray whale, San Ignacio Lagoon.



DAY 1: DEPART US/SAN JOSÉ DEL CABO/LA PAZ

Upon arrival in San José del Cabo, transfer to La Paz and check in to the CostaBaja Resort & Spa, located on the shore of the Sea of Cortez, just south of Espíritu Island. (D)

DAY 2: LA PAZ/SAN CARLOS/EMBARK

This morning is on your own to relax and take advantage of the resort and spa amenities. Check-out in the late morning and depart for lunch at a local restaurant in La Paz. After lunch, transfer to San Carlos and embark the *National Geographic Venture*. (B,L,D)

DAY 3: BAHÍA MAGDALENA

Explore the ever-shifting sand dunes of Isla Magdalena, on a cross-island walk to one of the most pristine beaches in the Pacific. Bird watching here can be excellent—magnificent frigatebirds, pelicans, cormorants, terns and great blue herons, ibis, whimbrels and willets are among the species we might see. It's not unusual to see forty species of birds in just one day along these fertile shorelines where they refuel for their destinations ahead. (B,L,D)

DAYS 4 & 5: LAGUNA SAN IGNACIO

Protected since 1993 as part of UNESCO's Whale Sanctuary of El Vizcaíno, Laguna San Ignacio is one of the world's most important breeding sites for California gray whales. Each winter, during their long migration, gray whales travel south from their Arctic feeding

grounds to breed and raise their calves in these sheltered waters. Observe migrating whales from the ship and up close from local pangas and our Zodiacs. Watch for osprey, Brant geese and countless other breeding and migratory bird species, as well as bottlenose dolphins, during our explorations. (B,L,D)

DAY 6: AT SEA

As we travel south along the Pacific coast of the peninsula, there is a chance of seeing a wide variety of marine life, including the largest animal on Earth, the blue whale. Hear naturalist talks and learn photography basics during a day at sea. (B,L,D)

DAY 7: LOS CABOS AND GORDA BANKS

This morning cruise past Friars Rocks at Land's End. This morning, choose to visit the historic town center of San José del Cabo, or join a birdwatching walk along the local estero. The afternoon is spent aboard ship in the area of Gorda Banks seamount or La Fortuna, gathering places for whales, especially humpbacks, dolphins and other sea life. (B,L,D)

DAY 8: LOS ISLOTES AND ISLA ESPIRITU SANTO

At Los Islotes, don flippers, a mask and snorkel (which we'll gladly provide) and swim with curious sea lions. We have a leisurely afternoon to swim, kayak or hike at Isla Espíritu Santo. Brown pelicans, gulls and boobies are all part



of the landscape. Finish the day with a relaxing beach barbecue complete with a bonfire and a star-filled sky. (B,L,D)

DAY 9: EXPLORING THE SEA OF CORTEZ

Our plan is flexible today, as we explore some of the Sea's many uninhabited islands. Go ashore at Isla San Francisco, where a sweeping arc of white sand beach beckons you to try out our fleet of kayaks and standup paddleboards. Hike to the nearby ridge for unparalleled views, or explore nearby tide pools with your Naturalists. One of the larger islands in the Sea of Cortez, San José offers several landing possibilities depending on conditions and the whim of the moment. Photograph the ochre cliffs of the island's eastern shore, hike an "enchanted" arroyo, or visit the abandoned salt works to the west. Search for whales, dolphins and other marine life this afternoon among the islands of the southern Sea of Cortez. (B,L,D)

DAY 10: LA PAZ/DISEMBARK/SAN JOSÉ DEL CABO/HOME

Disembark in La Paz after breakfast and transfer to Los Cabos airport for flights home. (B)

EXPEDITION DETAILS

DATES: 2019 Jan. 12*, 19, 28*; Feb. 4, 13*, 20; Mar. 1*, 8

*These departures travel in the reverse order, from La Paz to San Carlos, making all the same stops.

NATIONAL GEOGRAPHIC EXPERT

Inventor of the Crittercam, biologist, conservationist, and Emmy Award-winning filmmaker **Greg Marshall** will join the Jan. 19 and 28, 2019 departures.



Guests kayaking, Espíritu Santo.

BAJA CALIFORNIA: A REMARKABLE JOURNEY

16 DAYS/15 NIGHTS—ABOARD NATIONAL GEOGRAPHIC VENTURE
PRICES FROM: \$11,990 to \$19,890 (See page 63 for complete prices.)

Embark on a comprehensive photo expedition that explores both the Pacific side of Baja California and the islands in the Sea of Cortez. Venture into the gray whale lagoons for up close encounters, and then spend ample time exploring the Sea of Cortez and all its marine mammals. See scores of blue-footed boobies and pelicans, kayak into quiet grottos, and visit charming seaside towns.

EXPEDITION HIGHLIGHTS

- ▶ Get up-close views of gray whale mothers and their growing calves as they prepare for their journey back to Arctic feeding grounds.
- ▶ Kayak clear blue waters to search for wildlife, including magnificent frigatebirds, and possibly explore water-level caves by kayak.
- ▶ Snorkel the living sea: Observe large schools of vibrantly colored fish, swim among playful sea lions, and much more.
- ▶ With more time for adventure, rely on your expedition leader to take you where wildlife will be at its best—including the remote oceanic island of San Pedro Mártir with clouds of nesting seabirds and crowds of sea lions onshore.

EXPERIENCE & EXPERTISE



Our expert 10-person expedition team will illuminate the wonders of Baja & the Sea of Cortez from every possible angle. Your expedition leader, undersea specialist, three Lindblad-National Geographic certified photo instructors and naturalists, plus a wellness specialist and video chronicler, are dedicated to ensuring an incredible voyage. A National Geographic photographer is on board to provide guidance and instruction throughout your voyage.

Visit our website to read staff bios for this expedition.



Kayaking the calm water in the Sea of Cortez.

DAY 1: DEPART U.S./SAN JOSÉ DEL CABO/LA PAZ

Upon arrival in San José del Cabo, transfer to La Paz and check in to the CostaBaja Resort & Spa. (D)

DAY 2: LA PAZ/SAN CARLOS/EMBARK

This morning is on your own, to relax and take advantage of the resort and spa amenities. Check-out in the late morning, and depart for lunch at a local restaurant in La Paz. After lunch, transfer to San Carlos and embark the *National Geographic Venture*. (B,L,D)



Elegant terns, Isla Rasa.

DAY 3: BAHÍA MAGDALENA

Explore the ever-shifting sand dunes of Isla Magdalena, on a cross-island walk to one of the most pristine beaches in the Pacific. Bird watching here can be excellent—magnificent frigatebirds, pelicans, cormorants, terns and great blue herons, ibis, whimbrels and willets are among the species we might see. It's not unusual to see forty species of birds in just one day along these fertile shorelines where they refuel for their destinations ahead. (B,L,D)

DAYS 4 AND 5: LAGUNA SAN IGNACIO

Laguna San Ignacio is a large bay and favored haunt of the gray whales in Baja. The ship will linger in this remote and important locale, while we observe the mother and calf pairs—from the ship, and from water level in our expedition landing craft and local pangas. For some reason, the whales here seem to be friendlier than they are elsewhere. It's not unusual for mothers and calves to approach our boats, the calves often playing hide and seek—sometimes even wanting to be petted and scratched. (B,L,D)



Common dolphin.

DAY 6: AT SEA

As we travel south along the Pacific coast of the peninsula, there is a chance of seeing a wide variety of marine life, including the largest animal on Earth, the blue whale. (B,L,D)

DAYS 7–15: ISLANDS OF THE SEA OF CORTEZ

Cruise past the spectacular Friars Rocks at Land's End. For those who wish, we will arrange a visit to the historic town center of San José del Cabo. Espíritu Santo, Los Islotes, San Pedro Mártir—these are some of the melodious names of these islands scattered throughout this beautiful sea. After over 20 years of exploration here, we are still discovering new places and experiencing exciting events: bowriding bottlenose dolphins, or sperm whales near our ship; a pod of fin whales feeding around a convergence zone. The best areas for whale watching remain consistent—the waters south of Isla Carmen, Canal de Ballenas up north, and near the mouth of Bahía Concepción. Whether



on the bridge of the ship, on expedition landing craft or kayaks, we will be in prime position to observe them all. (B,L,D)

DAY 16: LA PAZ/DISEMBARK/SAN JOSÉ DEL CABO/HOME

Disembark in La Paz after breakfast and transfer to Los Cabos airport for flights home. (B)

EXPEDITION DETAILS

DATES: 2019 Mar. 17 📷 30* 📷

📷 Photo Expedition

*This departure travels in the reverse order, from La Paz to San Carlos, making all the same stops.

NATIONAL GEOGRAPHIC PHOTOGRAPHERS



National Geographic photographer **Ralph Lee Hopkins** joins the Mar. 17, 2019 departure, and National Geographic photographer and marine

biologist **Flip Nicklin** will join the Mar. 30, 2019 departure. Read their bios and find more experts on our website.

Learn more at expeditions.com/photo



A guest photographing the diverse landscape of the region.

GALÁPAGOS

10 DAYS/9 NIGHTS—ABOARD NATIONAL GEOGRAPHIC ENDEAVOUR II AND NATIONAL GEOGRAPHIC ISLANDER

PRICES FROM: \$6,960 to \$16,670 (See pages 57 and 59 for complete prices.)

In the Galápagos, no single site can be visited by the same ship more than once over a two-week period. The idea was developed in 2011, and Lindblad was the first voluntary adopter of this innovative new proposal by the Galápagos National Park, which had as its purpose to spread people out to allow for a more intimate experience. We have created an optimal balance during each week in terms of terrain and wildlife. If you wish to see all the sites, you could join for two weeks, but be assured there is no better week to experience Galápagos—just nuances from one week to the other.

EXPEDITION HIGHLIGHTS

- ▶ Snorkel amid shimmering fish, sea turtles, penguins, and playful sea lions.
 - ▶ Walk among colonies of wildlife and birds unfazed by your presence.
 - ▶ Explore the waters of the Galápagos by kayak, glass-bottom boat (*Endeavour II*), Zodiac, or paddleboard.
 - ▶ Observe giant Galápagos tortoises in the wild.
 - ▶ Enhance your expedition with a pre-voyage extension in the Andes, or continue to iconic Machu Picchu or the Amazon for a complete adventure.
- See pages 16-21, or visit expeditions.com.

EXPERIENCE & EXPERTISE

50
YEARS
EXPERIENCE

We're celebrating 50 years of exploring Galápagos. We've introduced generations of travelers to its magic and mystery. We're committed to Galápagos; and have raised millions, along with our guests, for its conservation. And we're fully invested, too; we operate two ships based there year round. An expedition leader, our team of naturalists, a Lindblad-National Geographic certified photo instructor, undersea specialist, wellness specialist, and video chronicler all contribute to your experience of the wonders of Galápagos.

Visit our website to read staff bios.

Blue-footed boobies.



DAY 1: U.S./GUAYAQUIL, ECUADOR

Depart for Guayaquil and upon arrival, transfer to the Hotel del Parque (*National Geographic Islander*) or Hilton Colón (*National Geographic Endeavour II*).

DAY 2: GUAYAQUIL/GALÁPAGOS

This morning, fly to the Galápagos Islands and board *Islander* or *Endeavour II*. After lunch, we begin our exploration of the islands and their diverse wildlife. (B,L,D)

DAYS 3–8: EXPLORING THE GALÁPAGOS

Listed below is a sample of the islands we may visit during our expedition.* (B,L,D Daily)

ISLA BARTOLOMÉ

Walk to the top of Bartolomé’s volcanic cone for a stunning view of Pinnacle Rock and the surrounding golden sand beaches. After the hike, immerse yourself among schools of multicolored reef fish. You may also have the opportunity to swim with Galápagos penguins.

ISLA SANTIAGO

Follow a path along a series of tide pools and underwater caverns in search of Galápagos fur seals, marine iguanas, sea lions, shore birds and Sally Lightfoot crabs.

ISLA SANTA CRUZ

Santa Cruz is home to the Charles Darwin Research station; learn about the science done here and visit the neighboring captive breeding program for endangered species of Galápagos giant tortoises, by their partners in conservation, the Galápagos National Park Service. Later, travel into the highlands



Encounter sea lions up close.

where wild tortoises forage, to observe and photograph these tortoises in the wild.

ISLA ISABELA

Explore the largest island in the group, home to enormous marine iguanas, abundant sea turtles, the only species of flightless cormorant in the world, and the only penguin species that inhabits the equator. Cruise by Zodiac and hike against the backdrop of giant shield volcanoes, and snorkel in the cool, rich waters that often draw whales and dolphins to the area.

ISLA FLOREANA

At Champion Islet, snorkel among sea lions, or peer into an underwater world in a glass-bottom boat or Zodiac while keeping an eye out for the endangered Floreana mockingbird. Those interested can visit Post Office Bay, founded by whalers in the 18th century—if you see a letter addressed to someone who lives near you, the tradition is to deliver it by hand.

ISLA FERNANDINA

Discover the marine iguana haven of Punta Espinoza as we hike over lava flows. Galápagos hawks, sea lion nurseries and the rare Galápagos flightless cormorant will be found as we explore this island.

ISLA ESPAÑOLA

See swallow-tailed gulls, Española mockingbirds, boobies, and, seasonally, waved albatross on this birder’s paradise. Walk among red and black marine iguanas and unique lava lizards, and observe sea lions up close on a pristine white-sand beach.

DAY 9: GALÁPAGOS/GUAYAQUIL

After breakfast, disembark the ship and fly to Guayaquil. The evening is at your leisure at the Hotel del Parque (*Islander*) or Hilton Colón (*Endeavour II*).

DAY 10: GUAYAQUIL/U.S.

Depart Guayaquil this morning, arriving home the same day. (B)

**Please note: All ship itineraries are subject to Galápagos National Park regulations. Our expeditions, which sail between Isla San Cristobal and Isla Baltra include Isla Santa Cruz and a hand-picked selection of these and other visitor sites*



EXPEDITION DETAILS

DATES: 2018/2019: Expeditions depart Fridays on *National Geographic Endeavour II* and Saturdays on *National Geographic Islander*.

SPECIAL OFFERS:

- New for 2019: Your bar tab and WiFi are included. See page 68 for details.
- Book by **Oct. 31, 2018** on select 2018 departures for **FREE ROUND-TRIP** economy group airfare from Miami to Galápagos; ask about other U.S. gateways. Upgrade to business class to Guayaquil for \$500 on select dates (space available). See page 68.
- Combine your Galápagos expedition with an Upper Amazon voyage and save 10%.

NATIONAL GEOGRAPHIC PHOTOGRAPHER

Travel with Pulitzer-Prize winner and National Geographic Photographer **Jay Dickman** on the Nov. 23 & 30, 2018 departures aboard *National Geographic Endeavour II*. See his bio and more at expeditions.com/photo.

EXTEND YOUR ADVENTURE

Combine your Galápagos expedition with **Machu Picchu & Peru’s Land of the Inca** or the **Upper Amazon**. See page 16-21 for details.

OPTIONAL EXTENSION

Experience Ecuador’s fantastic culture, landscapes and wild nature on a six-day **Tropical Andes & Colonial Quito** adventure, featuring

Mashpi Lodge, a National Geographic Unique Lodge of the World. See page 20 for details.

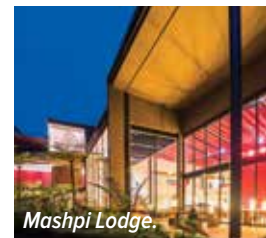

Mashpi Lodge.

MACHU PICCHU AND PERU'S LAND OF THE INCA

8 DAYS/7 NIGHTS—LAND-ONLY EXCURSION

PRICES FROM: \$5,690 per person double occupancy and \$7,070 solo occupancy (Call for pricing details, including holiday rates.)

Machu Picchu is a life-list must, offering an ideal mix of ancient culture, award-winning cuisine and stunning archaeological sites. You'll experience colorful contemporary Lima, historic Cusco, the Sacred Valley of the Inca—and your adventure culminates with two days to marvel at Machu Picchu.

EXPEDITION HIGHLIGHTS

- ▶ Explore the Sacred Valley of the Inca and discover Cusco's rich heritage.
- ▶ See daybreak over Machu Picchu from the fabled Sun Gate.
- ▶ Overnight adjacent to Machu Picchu at the Belmond Sanctuary Lodge.
- ▶ Stroll colorful markets, explore magnificent cathedrals and hear local musicians.
- ▶ Add Galápagos before or the Upper Amazon after for a seamless adventure. See pages 14-15 and 18-19, or visit expeditions.com.

EXPERIENCE & EXPERTISE



For the 30 years we've been exploring here, we've highlighted how Inca cultural heritage influences contemporary life in Peru.

This expedition has been developed with the insight and depth we've obtained from decades in the region. You can be assured that the exhaustive attention to detail that goes into all our ship-based expeditions has gone into planning this exhilarating land journey. Your Peruvian expedition team will be of the same caliber as those on our ships. And your accommodations have been carefully chosen for their location, ambiance, and comfort.

Machu Picchu.

DAY 1: U.S./LIMA, PERU

Upon arrival this evening in Lima, check-in at the conveniently located Wyndham Costa del Sol Lima Airport Hotel.

**DAY 2: LIMA/CUSCO/SACRED VALLEY**

Board a short scenic flight to Cusco this morning, and continue to Moray—a visually stunning Inca site with dramatic agricultural terraces in the heart of the fabled and fertile Urubamba Valley. After lunch and an opportunity to experience a local market, check-in at Sol y Luna, our base for two nights. This serene Relais & Chateaux hotel offers individual adobe casitas set in a verdant garden. (B,L,D)

DAY 3: SACRED VALLEY

Spend the day exploring the archaeological sites and culture of the Sacred Valley in the company of National Geographic expert Peter Frost, who has lived and worked in Peru for decades. He or a colleague joins us for a talk at our hotel and a visit to the massive Inca stone fortress of Ollantaytambo, set above a thriving Inca community. Lunch is at a working, family-owned hacienda, where we are treated to a show of Peruvian Paso horses, and National Geographic grantee Nilda Callañaupa, founder of El Centro de Textiles Tradicionales de Cusco, demonstrates Inca weaving traditions. (B,L,D)

DAY 4: SACRED VALLEY/MACHU PICCHU

Marvel at the dramatic scenery and life along the river en route this morning by train to Machu Picchu, the Inca royal retreat famously introduced to the world by Hiram Bingham in the April 1913 issue of *National Geographic*

magazine. Check-in at the historic 31-room Belmond Sanctuary Lodge, adjacent to the World Heritage site, with the leisure to explore over two days in the company of our hand-picked tour director and local guides. Lunch and dinner at the hotel. (B,L,D)

DAY 5: MACHU PICCHU/CUSCO

Awaken this morning at Machu Picchu, where options include an early hike to the Sun Gate, the ancient final checkpoint to Machu Picchu on the Inca Trail. After lunch, return by train and bus to Cusco—the center of the Inca universe and a burgeoning cultural capital. Check-in at the Belmond Hotel Monasterio on Plaza Nazarenas in the heart of Cusco for two nights. Occupying a monastery founded in 1592, our hotel—like much of colonial Cusco—is built atop Inca stones. (B,L,D)

DAY 6: CUSCO

Explore the magnificently ornate 17th-century cathedral, sacred Inca Temple of the Sun, and other treasures of Cusco. Visit nearby Sacsayhuamán, where a series of imposing terrace walls, the most impressive yet, command views over the city. Relax, shop, or visit one of Cusco's many churches and museums this afternoon. Dinner is on your own tonight. (B,L)

DAY 7: CUSCO/LIMA

Return to vibrant coastal Lima this morning, where we stroll the Plaza Mayor and delight in a private farewell lunch with a special musical presentation at Casa Aliaga, one of the oldest houses in Lima. After a visit to the extraordinary Larco Museum, dedicated to pre-Columbian art, check-in at Belmond Miraflores Park, set



along the fashionable seaside promenade. Dinner is on your own. (B,L)

DAY 8: LIMA/U.S.

After breakfast, transfer to the airport for flights home—or onto Iquitos and Amazon. (B)

EXPEDITION DETAILS

DATES: Expeditions depart weekly, year-round.

EXTEND YOUR ADVENTURE

Take advantage of your proximity—extend this Peru journey with a [Galápagos](#) expedition (pages 14-15). Or combine it with the [Upper Amazon](#) expedition (pages 18-19) and take advantage of a 10% savings.

NATIONAL GEOGRAPHIC EXPERT

Gain insights from National Geographic archaeology grantee **Peter Frost** or a colleague on our departures.



UPPER AMAZON

10 DAYS/9 NIGHTS—ABOARD *DELFIN II*

PRICES FROM: \$6,990 to \$10,980 (See page 66 for complete prices.)

Voyage to the headwaters of the mighty Amazon in the heart of Peru's rain forest aboard the elegant riverboat *Delfin II*. Slip through an intricate network of jungle waterways in a skiff or kayak, spotting diverse birds, as well as caimans, tamarins, and sloths. Skim past massive lily pads, peer up at towering ceiba trees, and witness glorious sunsets on the still waters of the Amazon River basin.

EXPEDITION HIGHLIGHTS

- ▶ Explore the flooded forest of Pacaya-Samiria National Reserve with a team of experienced naturalists.
- ▶ Spot elusive Amazon wildlife, including pink and gray dolphins, monk saki monkeys, piranhas, and scarlet macaws.
- ▶ Get acquainted with native *ribereños* on a visit to a community at the river's edge.
- ▶ Gaze at the wilderness from the comfort of the *Delfin II*, and enjoy delicious, local meals.
- ▶ Learn from a Lindblad-National Geographic certified photo instructor on board.
- ▶ Add Galápagos or Machu Picchu & Peru's Land of the Inca or combine all three South American adventures. Call for details or visit expeditions.com.

EXPERIENCE & EXPERTISE

35+
YEARS
EXPERIENCE

We have conducted numerous Amazon expeditions in our history, and launched our first voyage aboard the beautiful, 28-guest *Delfin II* in

August 2010. In order to provide expedition leadership in this pristine region, we tapped our tenured expedition leaders to lead our Amazon voyages, providing our guests with the same in-depth interpretation they find on our other expeditions. Our veteran team is highly knowledgeable about this region, and trained to illuminate all the discoveries you'll make.

Visit our website to read staff bios for this expedition.



Red-and-green macaw.

DAY 1: U.S./LIMA, PERU

Arrive in Lima in the late evening and transfer to our conveniently located hotel, Wyndham Costa del Sol Lima Airport Hotel.

DAY 2: LIMA/IQUITOS/NAUTA/EMBARK

Enjoy a morning tour of Lima, then fly to Iquitos and continue overland to the riverside village of Nauta, where the *Delfin II* awaits. Settle into your cabin, and gather for a welcome dinner of fine Peruvian cuisine on board. Tonight, step out on deck to gaze at the magnificent Amazon night sky. (B,L,D)

DAYS 3–8: PACAYA-SAMIRIA NATIONAL RESERVE

Spend this week exploring the Pacaya-Samiria National Reserve, a pristine swath of jungle—stretching more than five million acres, and harboring some of the Amazon’s most fascinating flora and fauna. Bordered by the Marañón and the Ucayali, these two powerful rivers converge to create the famed Amazon, which floods annually with nutrient-rich waters. The Pacaya-Samiria rivers are known locally as the Mirrored Forest for the reflections created by the glassy water.

Set out into this remarkable wilderness on daily excursions by skiff, kayak, and when the water level permits, by foot on dry land. Skim past giant lily pads afloat on black-water lakes, and venture deep into the rain forest on narrow tributaries. Spot sloths and monkeys, including variably colored saddleback tamarins, noisy howlers, and shaggy-tailed monk saki monkeys. Watch for an astounding variety

of birds, from tanagers and hummingbirds to parrots and endangered scarlet macaws. In the river, look for signs of the massive *paiche* fish, the Amazon’s largest; rare pink dolphins; and the infamous piranhas.

Enjoy an opportunity to swim in a lake in the reserve’s interior. Seek out *Victoria amazonica*, a giant water lily that grows in small lagoons. Go on a bird-watching hike, listening for the vocal oropendola and then look for its telltale yellow tail. Watch the sun set and listen to a cacophonous symphony of nocturnal animals calling out across the treetops. Then slip through the forest in a skiff as night falls, using a spotlight to find caimans, frogs, fishing bats and other creatures of the night.

One of the unexpected joys of traveling in the upper Amazon of Peru is the interaction we have with the local *ribereños*, the traditional people who live on the riverbanks. Visit one of the communities and see the projects that we support through a local non-profit, including a variety of handicrafts, women’s health initiative and sustainable farming. (B,L,D)

DAY 9: DISEMBARK/NAUTA/IQUITOS/LIMA

Disembark in Nauta, stopping at the Amazon Rescue Center on the drive to Iquitos. Fly to Lima, where we visit Museo Larco and celebrate with a farewell dinner. Overnight at the Wyndham Costa del Sol Lima Airport Hotel. (B,L,D)

DAY 10: LIMA/U.S.

After breakfast, transfer to the airport for your flight home. (B)

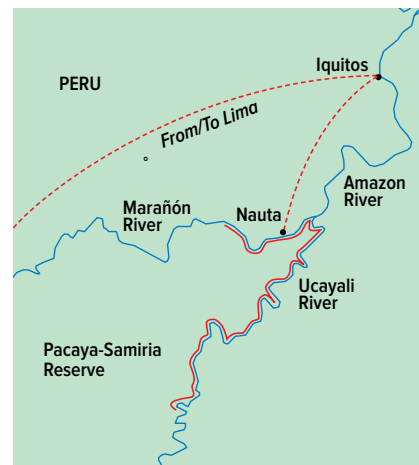
**EXPEDITION DETAILS**

DATES: 2018 Aug. 25; Sep. 1; Nov. 3; Dec. 8, 15
 2019 Jan. 5, 12, 26; Feb. 2, 16, 23; Mar. 2, 9, 16; Apr. 27; May 4, 11, 18; Jun. 8, 15, 22; Aug. 10, 24; Oct. 26; Nov. 2, 9, 30; Dec. 7, 14
 Photo Expedition

EXTEND YOUR ADVENTURE & SAVE

Make the most of your time in the region by combining your Upper Amazon expedition with a voyage to the [Galápagos](#) and/or [Machu Picchu & the Land of the Inca](#) and take advantage of a 10% savings. See page 21 for details.

NATIONAL GEOGRAPHIC PHOTOGRAPHER

Join National Geographic Photographers [Krista Rossow](#) (Jan. 19 and 26, 2019) or [Kike Calvo](#) (Mar. 9 and 16, 2019). Learn more at [expeditions.com/photo](#).



The riverboat *Delfin II* sails the Upper Amazon.



Rainforest canopy walkway.

GALÁPAGOS + MACHU PICCHU & PERU'S LAND OF THE INCA

16 DAYS/15 NIGHTS—ABOARD NATIONAL GEOGRAPHIC ENDEAVOUR II AND NATIONAL GEOGRAPHIC ISLANDER + LAND EXCURSION

PRICES FROM: \$12,650 to \$21,960 (See pages 57 and 59 for complete prices.)

EXPEDITION HIGHLIGHTS

- ▶ Walk and snorkel among the abundant and fearless wildlife of Galápagos.
- ▶ See daybreak over the ruins at Machu Picchu from the fabled Sun Gate.
- ▶ Discover Cusco's varied influences and visit the Sacred Valley of the Inca.

Days 1–8: As per Galápagos itinerary on page 15

Day 9: Galápagos/Guayaquil/Lima, Peru

Day 10: Lima/Cusco/Sacred Valley

Day 11: Sacred Valley

Day 12: Sacred Valley/Machu Picchu

Day 13: Machu Picchu/Cusco

Day 14: Cusco

Day 15: Cusco/Lima

Day 16: Lima/U.S.



Bartolomé Island, Galápagos.



Machu Picchu.

EXPEDITION DETAILS

DATES: Year-round, weekly departures following Galápagos aboard *National Geographic Endeavour II* and *National Geographic Islander*.

SPECIAL OFFER:

Book by Oct. 31, 2018 on select dates for **FREE ROUND-TRIP** economy group airfare from Miami to Galápagos/Lima to Cusco (up to \$2,100 value); ask about other U.S. gateways. Upgrade to business class to Guayaquil for \$500 on select dates (space available). Call for details.

TROPICAL ANDES + GALÁPAGOS

FEATURING MASHPI LODGE, A NATIONAL GEOGRAPHIC UNIQUE LODGE OF THE WORLD

14 DAYS/13 NIGHTS—PRE-VOYAGE + ABOARD NATIONAL GEOGRAPHIC ENDEAVOUR II AND NATIONAL GEOGRAPHIC ISLANDER

PRICES FROM: \$9,150 to \$18,890

EXPEDITION HIGHLIGHTS

- ▶ Explore colonial Quito, a UNESCO World Heritage site.
- ▶ Discover the Ecuadorian Chocó, one of the world's top five biodiversity hotspots.
- ▶ Stay at Mashpi Lodge, set in a 2,600-acre biodiversity reserve.
- ▶ Experience the wonders of Galápagos.

Day 1: U.S./Quito, Ecuador

Day 2: Quito

Day 3: The Andes/Mashpi Lodge

Day 4: Mashpi Lodge

Day 5: Mashpi Lodge/Quito

Day 6: Quito/Galápagos/Embark

Days 7–14: As per Galápagos itinerary on page 15



Mashpi Lodge.

EXPEDITION DETAILS

DATES: Weekly departures as pre-voyage extension for either *National Geographic Islander* or *National Geographic Endeavour II* in Galápagos. Please call for details.

GALÁPAGOS + UPPER AMAZON

18 DAYS/17 NIGHTS—ABOARD NATIONAL GEOGRAPHIC ENDEAVOUR II AND DELFIN II

PRICES FROM: \$13,950 to \$24,090 (Call for complete pricing.)

EXPEDITION HIGHLIGHTS

- ▶ Walk and snorkel among the abundant, iconic Galápagos wildlife that is unfazed by your presence.
- ▶ Hike pristine islands, kayak their peaceful shorelines, and explore the Galápagos undersea.
- ▶ In the Amazon, discover an entirely different kind of biodiversity—macaws, monkeys, sloths, and more, plus meet the *ribereños*—inhabitants of the jungle we explore.

Day 1: U.S./Guayaquil, Ecuador

Day 2: Guayaquil/Galápagos/Embark

Days 3–8: Explore Galápagos Aboard *National Geographic Endeavour II*

Day 9: Galápagos/Disembark/
Guayaquil/Lima, Peru

Day 10: Lima/Nauta/Embark

Days 11–16: Explore Pacaya-Samiria
National Reserve Aboard *Delfin II*

Day 17: Nauta/Disembark/Lima

Day 18: Lima/U.S.

EXPEDITION DETAILS

DATES: 2018 Aug. 17; Nov. 30, Dec. 7

2019 Jan. 4, 18, 25; Feb. 8, 15, 22;

Mar. 1, 8; Apr. 19, 26; May 3, 10, 31;

Jun. 7, 14; Aug. 2, 16; Oct. 18, 25; Nov. 1, 22,

29; Dec. 6

Photo Expedition



A monk saki monkey, perched high in a tree.

SPECIAL OFFERS:

- Book by **Oct. 31, 2018** on select dates for **FREE ROUND-TRIP** economy group airfare from Miami to Galápagos/Lima to Iquitos (up to \$2,100 value); ask about other U.S. gateways. Upgrade to business class to Guayaquil for \$500 on select dates (space available). See our website or call for details.
- **SAVE 10%** when you book Galápagos + Upper Amazon.

MACHU PICCHU & PERU'S LAND OF THE INCA + UPPER AMAZON

16 DAYS/15 NIGHTS—A LAND + RIVER EXPEDITION ABOARD *DELFIN II*

PRICES FROM: \$12,680 to \$16,490 (See page 66 for pricing information.)

EXPEDITION HIGHLIGHTS

- ▶ See daybreak over the magnificent ruins at Machu Picchu from the fabled Sun Gate.
- ▶ Stay at the Belmond Sanctuary Hotel next to Machu Picchu.
- ▶ Discover Cusco, capital of the Inca empire, and the vast Sacsayhuamán Fortress.
- ▶ Balance your archeological and cultural expedition with a wildlife and nature expedition into the green heart of the Amazon.

Day 1: U.S./Lima, Peru

Day 2: Lima/Cusco/Sacred Valley

Day 3: Sacred Valley Of The Inca

Day 4: Sacred Valley/Machu Picchu

Day 5: Machu Picchu/Cusco

Day 6: Cusco

Day 7: Cusco/Lima

Day 8: Lima/Iquitos/Nauta/Embark

Days 9–14: Explore Pacaya-Samiria
National Reserve Aboard *Delfin II*

Day 15: Nauta/Iquitos/Lima

Day 16: Lima/U.S.

EXPEDITION DETAILS

DATES: 2018 Aug. 19, 25; Oct. 7; Dec. 2, 9

2019 Jan. 20, 26; Feb. 9, 17, 23; Mar. 3, 9; Apr.

20, 28; May 4; Jun. 1, 9, 15; Aug. 4, 11, 18; Oct.

19, 26; Nov. 2, 24, 30; Dec. 8



Traditional textiles abound.

SPECIAL OFFER:

Book by **Oct. 31, 2018** and **SAVE 10%**.
Call for details.



GET THE MOST OUT OF GETTING AWAY

What does getting away mean to you? What are you seeking? Is it a temporary respite from the clang and clamor of contemporary life, or something more in-depth and meaningful? We believe our new shorter getaways are a perfect blend of both—offering you respite and reward; the tonic of wildness; and through our partnership with **exhale**, the balm of wellness, too. Join one of our new Basecamp getaways—five-day, ship-based adventures that are part safari and part adult summer camp for a vibrant take on wildness and wellness. Engage in exhale yoga, Beach Boot Camp, Barre + Cardio, and more fitness options, plus kayaking, paddleboarding, snorkeling with sea lions, beach BBQs, and more—and return home renewed and revitalized.

Or choose to experience the thrill of Galápagos, its wildlife, and wonders—the signature Lindblad Expeditions-National Geographic Galápagos experience—in fewer than the usual 10 days. Or discover two iconic wonders at once: experience the best of Galápagos and Machu Picchu in nine action-packed days. Whichever option you choose, you'll return to home or office transformed by all you've seen, done, and learned.

Clockwise from top left: Machu Picchu, Peru; beach BBQ and bonfire under the stars, Baja; snorkeling in Galápagos; stand-up paddleboards are perfect for exploring the sculpted coastline of Espíritu Santo.



BASE CAMP BAJA

5 DAYS/4 NIGHTS—ABOARD NATIONAL GEOGRAPHIC VENTURE

PRICES FROM: \$2,650 to \$5,090 (See page 63 for complete prices.)

A genuinely innovative hybrid—a 4-night getaway that feels like an authentic escape from the everyday. Use it to exult in sun and pristine nature; to de-stress or detox. Or to simply play or workout in the uninhabited wilds of Espiritu Santo and Isla Partida in the beautiful Sea of Cortez. With the brand-new 50-cabin *National Geographic Venture* as your mobile base camp, go where the wild things—and few others—are. Breathe deep, push hard. And chill at a BBQ under stars.

DAY 1: US/SAN JOSÉ DEL CABO/LA PAZ/EMBARK

Fly to Los Cabos airport and transfer to La Paz, where you'll embark *National Geographic Venture* this afternoon. Set sail on arrival, for a sunset cruise of Bahía La Paz en route to Isla Espiritu Santo. (D)

DAY 2: SAN JOSÉ CHANNEL/ISLA SAN FRANCISCO

Witness a spectacular Baja sunrise this morning, while searching for marine mammals in the upper San José Channel. Hear naturalist talks and learn photography basics during an early morning at sea. Before lunch, go ashore at Isla San Francisco, where a sweeping arc of white sand beach beckons you to try yoga or qi gong with your wellness specialist. Explore nearby tide pools with your naturalists, or spend the afternoon stand-up paddleboarding, snorkeling and kayaking. Hike to the nearby ridge for unparalleled views just before sunset. (B,L,D)

DAYS 3 AND 4: ISLA ESPÍRITU SANTO, ISLA PARTIDA AND LOS ISLOTES

Wake up anchored in one of Isla Espiritu Santo's beautiful bays and watch the cliffs light up as your wellness specialist leads a morning yoga or qi gong class, on deck, or on shore. For two full days, explore as much or as little as you like, with the ship as your mobile base camp—taking advantage of every exhale wellness option, including hiking with your exhale instructor for mindfulness and stretching on the trail. Explore the dramatically eroded shoreline of Isla Partida on a one-way kayak journey or



BBQ at sunset.

join a challenging hike up a rocky arroyo to the crest of the island. Meander a different arroyo with your naturalists to learn about the geology and natural history, then learn to paddleboard, or hone skills you already possess. Snorkel with playful and curious sea lions or photograph their antics from expedition landing craft. Wind down with an on-deck Chill Yoga or a chair massage, then go ashore for a beach barbecue dinner followed by a bonfire under the stars. However you choose to spend



these days, you'll be rewarded with a sense of well-being that comes only from spending quality time in nature. (B,L,D)

DAY 5: LA PAZ/DISEMBARK/SAN JOSÉ DEL CABO

Disembark in downtown La Paz this morning and transfer to Los Cabos airport for flights home. (B)

EXPEDITION DETAILS

DATES: 2018 Dec. 22, 26, 30

2019 Jan. 3, 7

See what it's like! Watch the Base Camp video at expeditions.com/bajawellness

SPECIAL OFFER:

Book six or more under one booking and save 10%. Call for details.



Guests paddleboarding, Espiritu Santo.

NEW! BASE CAMP CHANNEL ISLANDS

5 DAYS/4 NIGHTS—ABOARD NATIONAL GEOGRAPHIC SEA LION

PRICES FROM: \$2,490 to \$4,590 (See page 61 for complete prices.)

Our itinerary is a plan, but flexibility and spontaneity are a big part of it. Our ace spotters are always ‘on it,’ and if they sight a blue whale, they’ll let you know—so you won’t miss a thing nature has to offer. If conditions cancel one option, a landing for example, our nimble team will have another. They might surprise you with a BBQ on deck or a dance party under stars. Your Base Camp getaway might be compact, but it’s a genuine expedition.

DAY 1: LOS ANGELES, CA/EMBARK

Board the *National Geographic Sea Lion* in Los Angeles; set sail in the early evening—enjoy an exhale presentation on mindfulness, cocktails and a sunset cruise. (D)

DAY 2: ANACAPA AND SANTA CRUZ ISLANDS, CHANNEL ISLANDS NATIONAL PARK

Wake at anchor off East Anacapa Island, home to the Anacapa Lighthouse, built in 1912. Join your exhale instructor on deck for morning yoga. Spend the day your way: a mindfulness hike with exhale instructors and post-hike exhale stretch session, birding, or working with your certified photo instructor. Opt for a strenuous hike, kayaking or paddleboarding on Santa Cruz Island. Scuba certified? Our team will arrange diving and gear rental.

Head back to the ship to refresh for cocktail hour and Recap, a presentation, a pre-dinner neck and shoulder massage on deck (first come, first serve), and dinner. (B,L,D)

DAY 3: SANTA ROSA ISLAND, CHANNEL ISLANDS NATIONAL PARK

Start the day with an exhale Beach Boot Camp class ashore. Later tide pool, kayak, or hike one of the many trails. Join our naturalists for a more strenuous hike to the base of the Torrey Pines, considered one of the world’s rarest pines, and one of only two naturally occurring groves in the world.

The day ends with a pre-dinner Chill Yoga session on deck, followed by a cocktail party as

we cruise around San Miguel Island at sunset: where over 30,000 pinnipeds, and up to five different species, haul out on the beaches at various times of the year. (B,L,D)

DAY 4: SANTA CATALINA ISLAND

Catalina Island was first developed as a tourist destination in the 1920s by chewing gum magnate William Wrigley, Jr. In 1972 his son Philip and daughter Dorothy established the Catalina Island Conservancy and later gave the Conservancy control of nearly 90 percent of the island to manage and protect.

Start the day with barre + cardio class on deck. After breakfast, join a Conservancy member for a talk and guided walk featuring spectacular views of the coastline. Search for the elusive Santa Cruz Island fox and view the impressive sight of the island’s largest



mammals—bison—descended from fourteen bison brought here in 1929 for the filming of *The Vanishing American*. Kayak, stand-up paddleboard, or, if certified, scuba dive. After lunch, arrive in Avalon Harbor where the afternoon is your own. Explore downtown Avalon by bike. Stroll up Avalon Canyon to visit the Wrigley Memorial and The Botanic Garden. Or visit the famous Catalina Casino. Return to the ship for sunset yoga on deck, a farewell dinner, and a last evening at sea, under stars. (B,L,D)

DAY 5: LOS ANGELES/DISEMBARK

Disembark after breakfast onboard. (B)

EXPEDITION DETAILS

DATES: 2018 Oct. 17, 24



Santa Cruz Island, Channel Islands National Park, California: Potato Harbor.

NEW! WILD GALÁPAGOS ESCAPE

7 DAYS/6 NIGHTS—ABOARD NATIONAL GEOGRAPHIC ISLANDER

PRICES FROM: \$5,450 to \$9,520 (See page 59 for complete prices.)

Pack a ton of adventure into one action-packed week. With multiple adventures each day on land and undersea—including options for walks and hikes, kayaking, paddle-boarding and snorkeling—you'll be assured of the full Lindblad-National Geographic Galápagos experience.



DAY 1: DEPART U.S./GUAYAQUIL, ECUADOR

Arrive in Guayaquil and transfer to the 44-room Hotel del Parque. Call for recommended international flights or additional nights at the hotel.

DAY 2: GUAYAQUIL/GALÁPAGOS/ EMBARK

Fly to Baltra in the center of Galápagos, a little world unto itself in the Tropical Pacific. We are welcomed by our naturalist staff and start exploring the islands. (B,L,D)

DAY 3-6: GALÁPAGOS

Listed below is a sample of islands we may visit during our expedition.* (B,L,D Daily)

ORTH SEYMOUR

Encounter nesting frigatebirds, plus land and marine iguanas, and enjoy a beautiful coastal walk.

SANTA CRUZ

Call at Puerto Ayora, the largest town and headquarters of both the Galápagos National Park and Charles Darwin Research Station. Head to the lush, green highlands to see giant tortoises roaming in the wild.

ISABELA

Toast crossing the Equator at Volcán Ecuador, northernmost of Isabela's six great shield volcanoes. Keep an eye open for whales and dolphin as you ply these rich waters, once the haunt of whalers and pirates.

FERNANDINA

One of the most active oceanic volcanoes in the world, it's the youngest and most pristine island in Galápagos—and home to the strange flightless cormorant and the largest marine iguanas.

SAN CRISTOBAL

Search for red-footed boobies and the endemic mockingbird and lava lizard—found only on this easternmost island. Explore Baquerizo Moreno, where sea lions thrive in the middle of town.

ESPAÑOLA

Home to swallow-tailed gulls, Española mockingbirds, Nazca boobies and seasonally, the world's only population of waved albatross at Punta Suarez.

FLOREANA

Follow a trail past a rose-pink across Punta Cormorant to Post Office Bay, founded by 18th-century whalers, on this mysterious island adorned with green, rolling hills and freshwater springs.

DAY 7: DISEMBARK/BALTRA/ GUAYAQUIL/DEPART

Return by air to Guayaquil, where we enjoy dayrooms at the Hotel del Parque before flights

home—or continue to Quito for an optional two-night extension. You may also opt to overnight and fly home on Day 8 at no additional cost. Ask your Expedition Specialist for details. (B)

** Please note: Our expeditions begin and end at Baltra, and include visits to Isla Santa Cruz and a careful selection of diverse islands. Each of our itineraries offers an optimal balance of wildlife, landscapes and experiences. All ship itineraries are subject to Galápagos National Park regulations.*

EXPEDITION DETAILS

DATES: 2018 Nov. 24, 29

2019 Apr. 27; May 2, 11, 16; Aug. 31; Sep. 5, 14, 19; Oct. 31

SPECIAL OFFER:

Celebrate these new itineraries with **FREE ROUND-TRIP AIRFARE** between Ecuador and Galápagos.



NEW! WILD GALÁPAGOS AND PERU ESCAPE

9 DAYS/8 NIGHTS—ABOARD NATIONAL GEOGRAPHIC ISLANDER

PRICES FROM: \$6,250 to \$10,030 (See page 59 for complete prices.)

Experience the best of Galápagos, and Machu Picchu too, in nine action-packed days. Starting in Lima, stay two nights in the Sacred Valley, enjoy fabled Machu Picchu and see Cusco, imperial capital of the Inca. Then journey to Galápagos to actively explore each day on land and under the sea, and encounter the abundant, iconic wildlife, unfazed by your presence.

DAY 1: DEPART U.S./LIMA, PERU

Arrive in Lima, Peru's thriving capital, and transfer to the convenient Lima Airport Holiday Inn. You may also opt to arrive a day or two early. Please ask an Expedition Specialist about recommended flights from Miami and other alternative gateways.

DAY 2: LIMA/CUSCO/SACRED VALLEY

Fly to Cusco and explore this Inca imperial city. Continue through the fabled and fertile Urubamba Valley to Tambo del Inka. National Geographic Grantee Nilda Callañaupa, founder of El Centro de Textiles Tradicionales de Cusco, joins us to demonstrate Inca weaving traditions. Dinner tonight is at the hotel. (B,L,D)

DAY 3: MACHU PICCHU

Drive to Ollantaytambo, where we board our train to Machu Picchu. Set at less than 8,000 feet in the "eyebrow of the jungle," the sanctuary is surrounded by tropical mountain forest with diverse birds and orchids. We linger after day-visitors are gone, returning to Machu Picchu Pueblo for the train back to the Sacred Valley and Tambo del Inka this evening. Dinner is served aboard the first-class train. (B,L,D)

DAY 4: SACRED VALLEY/GUAYAQUIL

Bid farewell to Peru and continue to Ecuador for part two of our expedition with flights from Cusco via Lima to Guayaquil, Ecuador's largest city. Overnight at Hotel del Parque. (B,L,D)

DAY 5-8: GUAYAQUIL/GALÁPAGOS

Fly on Day 5 to Galápagos, where we start exploring Darwin's iconic islands. Each day we join our naturalists on interpretive walks, swim,

snorkel, or explore by kayak or Zodiac—all the while witnessing incredible interactions between animals in their natural habitat. Part of the magic of any Galápagos voyage is the varied nature of the terrain and wildlife that each island offers, and this itinerary offers an optimal balance of experiences. Start exploring on Isla Santa Cruz with a trip over the highlands of **Santa Cruz**. We search for penguins on stark black lava at Sullivan Bay on **Isla Santiago**, swim in a secluded cove on **Isla Santa Fe**, snorkel in crystal-clear water at **Sombrero Chino**, sail across the Equator into the flooded caldera at **Isla Genovesa**, a seabird paradise, or wander among sea lions and land iguanas on **Isla Plaza Sur**.

DAY 9: DISEMBARK/BALTRA/ GUAYAQUIL/DEPART

Fly to Guayaquil, where dayrooms are reserved



at the Hotel del Parque. Spend the night and return home on Day 10 at no additional cost—or continue to Quito. Ask your Expedition Specialist.

**Please note: Our expeditions begin and end at Baltra, and include visits to Isla Santa Cruz and a careful selection of diverse islands. Each of our itineraries offers an optimal balance of wildlife, landscapes and experiences. All ship itineraries are subject to Galápagos National Park regulations.*

EXPEDITION DETAILS

DATES: 2018: Dec. 1

2019: May 4, 18; Sep 7, 21; Nov 2

SPECIAL OFFER:

Celebrate these new itineraries with **FREE ROUND-TRIP AIRFARE** between Ecuador and Galápagos.





DISCOVER THE THRILLS OF AUSTRAL SUMMER



As the land awakens, our ships return like migrating birds to the farthest ends of the Earth, venturing deep into the vast landscapes of Antarctica and Patagonia. Join us, and with these spectacular and seldom-seen settings as backdrop, you'll check off bucket-list achievements few ever will: round Cape Horn, walk in the footsteps of Ernest Shackleton, marvel at Torres del Paine, or witness the massive Pio XI glacier up close.

And come face to face with the iconic wildlife so marvelously adapted to living in isolation—herds of guanaco, soaring Andean condors, comical elephant seals, fierce leopard seals, and penguins of every kind. Plus, in South

Georgia, a spectacle unlike any other: 100,000 king penguins all convened on a single beach. Go once to any of these untrammled destinations and we guarantee, just like our veteran expedition teams, you'll be compelled to come back.



Clockwise from top left: Adélie penguins porpoising through the surf, Antarctica; a herd of guanacos, Torres del Paine National Park; a massive king penguin colony, South Georgia; a thrilling encounter with a humpback whale, Antarctica; get close up to a curious fur seal.



JOURNEY TO ANTARCTICA: THE WHITE CONTINENT

14 DAYS/11 NIGHTS—ABOARD NATIONAL GEOGRAPHIC EXPLORER AND NATIONAL GEOGRAPHIC ORION

PRICES FROM: \$13,890 to \$30,960 (See page 53 for complete *National Geographic Explorer* prices; see page 55 for *National Geographic Orion* prices.)

Traveling aboard the state-of-the-art *National Geographic Explorer* or *National Geographic Orion*, encounter the spectacular Antarctic Peninsula and the surrounding islands and waterways. Glide around enormous icebergs by Zodiac, photograph the penguin colonies, and kayak in complete tranquility.

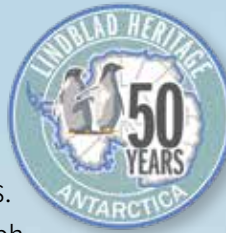

EXPEDITION HIGHLIGHTS

- ▶ Explore the world's last great wilderness in the company of a team of top naturalists celebrating Lindblad's 50-year heritage in Antarctica.
- ▶ View magnificent mountains, and huge glaciers. On shore, observe thousands of penguins: gentoo, Adélie, and chinstrap.
- ▶ Cruise aboard sturdy Zodiac landing craft in search of wildlife.
- ▶ Kayak in protected waters, paddling as penguins swim nearby.
- ▶ November departures on both ships offer the possibility to cross-country ski and snowshoe—on the frozen sea ice.
- ▶ Two days prior in warm Buenos Aires or Santiago? Or time post-voyage at Easter Island or Iguazú Falls? Call to discuss options or visit expeditions.com/antarcticaext

EXPERIENCE & EXPERTISE

**50
YEARS
EXPERIENCE**

Our dedicated staff is key to your experience. Representing diverse expertise, our knowledgeable expedition team allows for more activities

and interests to which you can gravitate. An expedition leader, a team of naturalists/historians, a National Geographic photographer, a Lindblad-National Geographic certified photo instructor, undersea specialist, video chronicler, and a wellness specialist all contribute to your experience of the wonders. And a Global Perspectives guest speaker adds relevant insight (*Explorer* only).

Visit our website to read staff and guest speaker bios for this expedition.

A pair of gentoo penguins welcomes guests.



DAYS 1 AND 2: U.S./BUENOS AIRES, ARGENTINA (EXPLORER) OR SANTIAGO, CHILE (ORION)

Depart on an overnight flight to Buenos Aires (*Explorer*) or Santiago (*Orion*). Settle into the Alvear Art Hotel (or similar) before seeing the city's Beaux-Arts palaces and the famous balcony associated with Eva Perón. Or check into the Mandarin Oriental Santiago (or similar) before our guided overview of this vibrant city backed by the inspiring Andes. (Day 2: L)

DAY 3: FLY TO USHUAIA/EMBARK

Fly by private charter to Ushuaia, the southernmost city in the world. Enjoy lunch on a catamaran cruise of the Beagle Channel. Embark *National Geographic Explorer* or *National Geographic Orion*. (B,L,D)

DAY 4: AT SEA/DRAKE PASSAGE

While crossing the legendary Drake Passage, spot albatross and other seabirds that glide alongside the ship. (B,L,D)

DAYS 5–10: EXPLORING ANTARCTICA

With long hours of daylight at this time of year, we have ample opportunity to explore the Antarctic Peninsula and the surrounding islands. In keeping with the nature of an expedition, the schedule is flexible so that we can take advantage of the unexpected—watching whales at play off the bow, taking an after-dinner

Zodiac cruise, or heading out on an unplanned excursion. We anticipate offering opportunities each day to hike, kayak among the ice floes, and experience close encounters with wildlife. You may have the thrill of watching our powerful ship crunch through the pack ice, or step ashore to thousands of Adélie and gentoo penguins. You'll learn how climate change affects the penguin populations, and how best to capture images of penguins from a National Geographic photographer. Back aboard, our undersea specialist may present video from that day's dive or show rare images taken up to 1,000 feet below the surface using our ROV. Our expert staff will craft an expedition where you will learn, see, and experience more. (B,L,D)

DAYS 11 AND 12: AT SEA

Enjoy the ship's amenities as the coast of Antarctica disappears from view. Round the southernmost tip of South America, and see the meeting of the Atlantic and Pacific Oceans. Celebrate your voyage at a farewell dinner on board. (B,L,D)

DAYS 13 AND 14: DISEMBARK

USHUAIA, ARGENTINA/BUENOS AIRES (*EXPLORER*) OR SANTIAGO, CHILE (*ORION*)/U.S. Disembark in Ushuaia. Fly by charter to Buenos Aires or Santiago and connect with your overnight flight home. (Day 13: B,L)

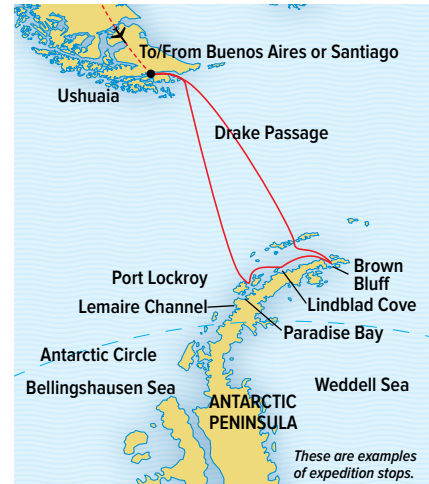

EXPEDITION DETAILS

DATES (*Explorer*): 2018 Dec. 6, 16[†], 26[†]; 2019 Jan. 5, 15, 25; Feb. 4; Nov. 27; Dec. 7, 17[†], 27[†]; 2020 Jan. 6, 16, 26; Feb. 5
DATES (*Orion*): 2018 Nov. 25; Dec. 5, 15[†]; 2019 Jan. 4, 14, 24; Feb. 3; Dec. 9, 19[†], 29[†]; 2020 Jan. 8, 28; Feb. 7

Orion departures route via Santiago instead of Buenos Aires. Visit our website.

[†]For holiday rates, see pages 53 and 55.

SPECIAL OFFERS:

Book by **Oct. 31, 2018** on select dates for **FREE ROUND-TRIP** economy group airfare Miami/Buenos Aires or Santiago; ask about other U.S. gateways. Plus, we will cover your bar tab and tips to the crew.

OPTIONAL EXTENSIONS

Prior to your voyage, add two days in **Buenos Aires (*Explorer*)** or two days in **Santiago (*Orion*)**. Add a four-day post-voyage extension to **Easter Island** (both ships), or three days post-voyage at **Iguazú Falls (*Explorer* only)**. See page 67 for details.

GLOBAL PERSPECTIVES GUEST SPEAKERS

Travel with polar explorer **Will Steger**, Dec. 16, 2018; social scientist **Carol Devine**, Dec. 6, 2018; **Susan Goldberg**, Editor In Chief of *National Geographic* magazine, Dec. 26, 2018; science writer **Robert Lee Hotz**, Jan. 5, 2019; mountaineer **Jamling Tenzing Norgay**, Jan. 15 and 25, 2019; adventurer **Jon Bowermaster**, Feb. 4, 2019.

NATIONAL GEOGRAPHIC PHOTOGRAPHERS

Travel with **Phil Schermeister**, Nov. 26, 2018; **Max Lowe**, Dec. 15 and 25, 2018; **Tim Laman**, Dec. 26, 2018; **Jonathan Irish**, Jan. 4 and 14, 2019; **Ken Garrett**, Jan. 5 and 15, 2019; **Susan Seubert**, Jan. 25 and Feb. 4, 2019.



Sunset, Lemaire Channel.

SOUTH GEORGIA AND THE FALKLANDS

19 DAYS/16 NIGHTS—ABOARD NATIONAL GEOGRAPHIC EXPLORER

PRICES FROM: \$16,990 to \$34,520 (See page 53 for complete *National Geographic Explorer* prices.)

Steeped in Shackleton and whaling lore, covered mostly in glaciers, South Georgia explodes with life: gentoo and king penguins, enormous elephant seals and a thriving fur seal population. Here on South Georgia you can observe one of the world's great wildlife spectacles: literally tens of thousands of stately king penguins on a single beach. The Falkland Islands are equally impressive, with colonies of nesting albatross and rockhopper penguins. This British Territory also adds a human element, with remote settlements and people living off the land.



EXPEDITION HIGHLIGHTS

- ▶ Weather permitting, hike in the footsteps of Sir Ernest Shackleton's fated Imperial Trans-Antarctica Expedition aboard *Endurance*.
- ▶ See stately king penguins—literally tens of thousands on a single beach in South Georgia.
- ▶ Observe magnificent black-browed albatross in the Falklands, and see Magellanic penguins peeking from their burrows.
- ▶ Paddle a kayak amid curious fur seals, and Zodiac cruise in South Georgia's isolated bays.
- ▶ You'll have the special opportunity to fly by private charter from the Falklands to Santiago, eliminating the sea crossing one-way.
- ▶ Two days prior in warm Buenos Aires? Or time post-voyage at Easter Island? Call or visit expeditions.com/southgeorgiaext

TRAVEL WITH EXPERTS

David Allen Sibley Author and illustrator of successful nature guides, including The New York Times best seller *The Sibley Guide to Birds*. **Oct. 22, 2018**



John Francis Marine biologist and former VP for Research, Conservation and Exploration at National Geographic. **Mar. 6, 2019**



Wildlife filmmaker **Bertie Gregory** is currently working on a new National Geographic digital series based on South Georgia. **Oct. 23, 2019**



A view of Gold Harbour and the Bertrab Glacier, South Georgia.



DAYS 1 AND 2: U.S./BUENOS AIRES, ARGENTINA

Depart on an overnight flight to Buenos Aires. Settle into the Alvear Art Hotel (or similar) before seeing the city's Beaux-Arts palaces and the famous balcony associated with Eva Perón. (Day 2: L)

DAY 3: FLY TO USHUAIA/EMBARK

Fly to Ushuaia, the southernmost city in the world. Enjoy lunch on a catamaran cruise of the Beagle Channel before embarking. (B,L,D)

DAY 4: AT SEA IN THE SOUTH ATLANTIC

Settle into shipboard life, listening to informal discussions from our naturalist staff to prepare for the wildness in the Falklands. Spend time on deck and on the bridge, scanning for petrels, penguins and albatross. (B,L,D)



Blue-eyed shags, Falkland Islands.

DAYS 5 AND 6: FALKLAND ISLANDS

Each Falkland Island is a variation on the theme of topographical beauty with white-sand beaches, vaulting cliffs, windswept moors, and the sunlit yellows and sage greens of waving tussock grass. The Falklands boast thousands of irresistible gentoo, rockhopper and Magellanic penguins, as well as magnificent albatross and fur seals. Walk along beautiful white-sand beaches, meander through tussock grass or sit atop a cliff and ponder the views. (B,L,D)

DAYS 7 AND 8: AT SEA

During our days at sea, we learn about the fascinating history of Antarctic exploration, as well as the flora, fauna and geology of South Georgia. Our naturalists help identify the seabirds that follow us: wandering albatross, prions and black-browed albatross. (B,L,D)

DAYS 9–15: SOUTH GEORGIA ISLAND

Explore the spectacular coastline of South

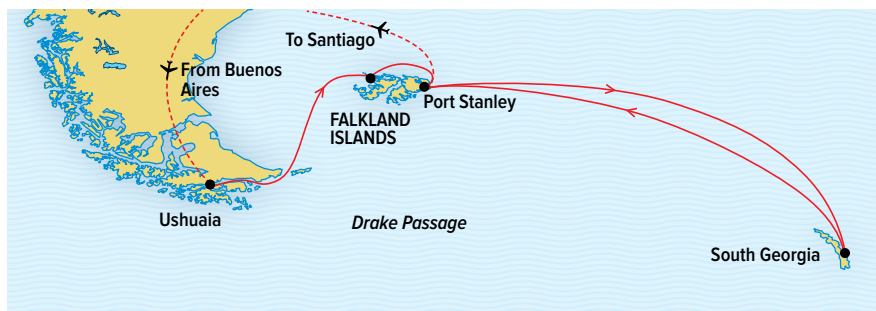

Georgia Island. In keeping with the nature of an expedition, our schedule is flexible with opportunities for walking, hiking, kayaking and Zodiac excursions. Sailing along the coast, we plan to offer activities every day including visits to Grytviken, the final resting place of Shackleton, and Stromness Harbour, where Shackleton, Tom Crean and Frank Worsley finally reached aid at a whaling station. See huge elephant seals, and on a single beach, you will see thousands of king penguins! (B,L,D)

DAYS 16 AND 17: AT SEA/FALKLANDS

With whales beneath and birds above, head up to the bridge, or spend these days enjoying the ship's spa, fitness center, library, and observation deck. After time at sea, our journey across the South Atlantic Ocean takes us once more to the island archipelago that teems with nature. Our afternoon visit to Port Stanley offers a chance to see the human face of the islands, to meet the hospitable locals, hoist a drink at a local pub, and stroll around this remote colonial town. (B,L,D)

DAYS 18 AND 19: DISEMBARK STANLEY, FALKLANDS/FLY TO SANTIAGO, CHILE/U.S.

After breakfast, disembark in the Falklands capital city of Stanley, and transfer to the airport at Mount Pleasant for our private

charter flight to Santiago to connect with your overnight flight home. (Day 18: B,L)

EXPEDITION DETAILS

DATES: 2018 Oct. 22; 2019 Mar. 6; Oct. 23; 2020 Mar. 6

SPECIAL OFFERS:

Book by **Oct. 31, 2018** to receive **FREE ROUND-TRIP AIRFARE** (Miami/Buenos Aires/Ushuaia and Falklands/Santiago/Miami). Plus, we will cover your bar tab and tips to the crew.

OPTIONAL EXTENSIONS

Prior to your voyage, add two days in **Buenos Aires**. Add a four-day post-voyage extension to **Easter Island**. See page 67 for details.

GLOBAL PERSPECTIVES GUEST SPEAKERS

Travel with renowned birder **David Allen Sibley**, Oct. 22, 2018, or **John Francis**, former VP for Research, Conservation and Exploration at National Geographic, Mar. 6, 2019. **Learn more at expeditions.com/experts**

NATIONAL GEOGRAPHIC PHOTOGRAPHER

Travel with **Jasper Doest**, Oct. 22, 2018; **Jeff Mauritzen**, Mar. 6, 2019; or **Bertie Gregory**, Oct. 23, 2019.



Male southern elephant seal pups, South Georgia.

ANTARCTICA, SOUTH GEORGIA, AND THE FALKLANDS

**24 DAYS/21 NIGHTS—ABOARD NATIONAL GEOGRAPHIC
EXPLORER AND NATIONAL GEOGRAPHIC ORION**

PRICES FROM: \$23,990 to \$49,990 (See page 53 for complete *National Geographic Explorer* prices; see page 55 for *National Geographic Orion* prices.)



This voyage has it all: the impossible beauty of Antarctic ice, the vast king penguin colonies of South Georgia, and the Falkland's amazing bird colonies. Traveling aboard one of our ice-class expedition ships *National Geographic Explorer* or *National Geographic Orion*, spend five days discovering the Antarctic Peninsula. Stroll through lively crowds of penguins in stunning South Georgia, and hike the shores of the Falkland Islands. Experience boundless wildlife and captivating beauty as you venture into some of the planet's most unspoiled landscapes.

EXPEDITION HIGHLIGHTS

- ▶ Trace the story of Sir Ernest Shackleton's fateful journey aboard *Endurance*, and toast at his gravesite in South Georgia.
- ▶ See three distinct regions, and benefit from our 50 years of experience here.
- ▶ November departures on both ships offer the possibility to cross-country ski and snowshoe—on the frozen sea ice.
- ▶ Two days prior in warm Buenos Aires or Santiago? Or time post-voyage at Easter Island or Iguazu Falls? Call to discuss options or visit expeditions.com/antarcticaext

FLY THE CROSSING!

Take advantage of a special opportunity on the Nov. 6, 2018 or Nov. 7, 2019 voyage. Fly by private charter one-way from Santiago, Chile to the Royal Air Force base in the Falklands, where you will embark *Explorer*—allowing us to convert a day at sea into a day along the Antarctic Peninsula. For itinerary details, go to: expeditions.com/flythecrossing

*Guests exploring Antarctica's
big ice by Zodiac.*

DAYS 1 AND 2: U.S./BUENOS AIRES, ARGENTINA (*EXPLORER*) OR SANTIAGO, CHILE (*ORION*)

Depart on an overnight flight to Buenos Aires (*Explorer*) or Santiago (*Orion*). Settle into the Alvear Art Hotel (or similar) before seeing the city's Beaux-Arts palaces and the famous balcony associated with Eva Perón. Or check into the Mandarin Oriental Santiago (or similar) before our guided overview of this vibrant city backed by the inspiring Andes. (Day 2: L)

DAY 3: FLY TO USHUAIA/EMBARK

Fly to Ushuaia, the southernmost city in the world. Enjoy lunch on a catamaran cruise of the Beagle Channel before embarking. (B,L,D)

DAY 4: AT SEA

Settle in to shipboard life as we sail to Antarctica. Keep a lookout for albatross that glide alongside the ship. (B,L,D)



Cross-country ski on the frozen sea in November (conditions permitting).

DAYS 5–10: ANTARCTICA

With long hours of daylight, we make the most of our days exploring the Antarctic Peninsula and surrounding islands. Our schedule is flexible, allowing us to take advantage of the unexpected. We'll spend these days on the "White Continent," exploring via Zodiac, kayak and on foot, and using our arsenal of tools for exploration. (B,L,D)

DAYS 11 AND 12: AT SEA (B,L,D)

DAYS 13–17: SOUTH GEORGIA ISLAND

This is the final resting place for explorer Sir Ernest Shackleton and we'll hoist a toast at his gravesite. Teeming wildlife and breathtaking scenery greet our ship. And at a vast

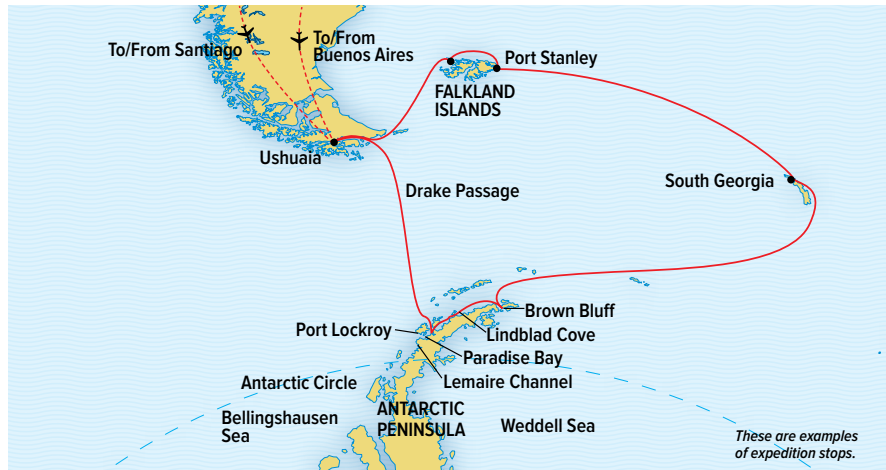

These are examples of expedition stops.

penguin colony you'll see tens of thousands of king penguins! (B,L,D)

DAYS 18 AND 19: AT SEA (B,L,D)

DAYS 20 AND 21: FALKLAND ISLANDS

The Falklands boast albatross, king cormorants, nesting rockhopper penguins, and Magellanic penguins in their green tussock grass burrows. Stroll the photogenic colonial town of Stanley and visit the evocative Anglican Cathedral with its archway of whalebones. (B,L,D)

DAY 22: AT SEA

On our final day at sea, enjoy one last chance to view the marine life of these southern waters. Toast our epic voyage at a festive farewell dinner. (B,L,D)

DAYS 23 AND 24: DISEMBARK USHUAIA, ARGENTINA/BUENOS AIRES (*EXPLORER*) OR SANTIAGO, CHILE (*ORION*)/U.S.

Disembark in Ushuaia. Fly by charter to Buenos Aires or Santiago and connect with your overnight flight home. (Day 23: B,L)



King penguins.

EXPEDITION DETAILS

DATES (*Explorer*): 2018 Nov. 6**; 2019 Feb 14; Nov. 7**; 2020 Feb. 15

DATES (*Orion*): 2018 Nov. 5*; 2019 Feb. 13; 2020 Feb. 17

*These voyages travel in reverse.

†The Nov. 6, 2018 & Nov. 7, 2019 voyages aboard *Explorer* travel in reverse, and fly direct to the Falklands for embarkation (Miami/Santiago/ Falklands, returning Ushuaia/Buenos Aires/ Miami). Visit our website for itinerary details.

Note: *Orion* departures route via Santiago instead of Buenos Aires. See page 67 for details

SPECIAL OFFERS:

Book select departures by **Oct. 31, 2018** for **FREE ROUND-TRIP** economy group airfare Miami/Buenos Aires (or Santiago). Plus, we will cover your bar tab and tips to the crew.

OPTIONAL EXTENSIONS

Prior to your voyage, add two days in **Buenos Aires (*Explorer*)** or two days in **Santiago (*Orion*)**. Add a four-day post-voyage extension to **Easter Island** (both ships), or three days post-voyage at **Iguazú Falls (*Explorer* only)**. See page 67 for details.

GLOBAL PERSPECTIVES GUEST SPEAKERS

Travel with mountaineer and adventurer **Peter Hillary** and ice artist **Zaria Forman**, Nov. 6, 2018; or author **Dyan deNapoli**, Feb. 14, 2019.

NATIONAL GEOGRAPHIC PHOTOGRAPHERS

Travel with award-winning photographers **Phil Schermeister**, Nov. 6, 2018; **Ralph Lee Hopkins**, Nov. 7, 2019; **Maria Stenzel**, Feb. 13, 2019; **Annie Griffiths**, Feb. 14, 2019.

EPIC PATAGONIA: FJORDS, PEAKS AND FORESTS

20 DAYS/17 NIGHTS—ABOARD *NATIONAL GEOGRAPHIC EXPLORER*

PRICES FROM: \$18,990 to \$36,210 (See page 53 for complete prices.)

Venture deep into Chile's glorious fjords past incandescent icebergs and massive glaciers. From the "land of fire," Tierra del Fuego, to the jagged spires of Torres del Paine National Park, have a comprehensive Patagonia experience at close range aboard *National Geographic Explorer*. Plus enjoy the unprecedented opportunity to visit Argentina's Staten Island—*Explorer* is one of the only ships ever permitted to visit this unique wild habitat since its recent designation by Argentina as a provincial reserve. We also enjoy Zodiac cruises at Observatory Island, a huge bird and marine mammal breeding colony.

EXPEDITION HIGHLIGHTS

- ▶ Beginning at the northern gateway to Patagonia, Puerto Montt, explore the Chilean fjords by Zodiac, kayak and on foot.
- ▶ Explore Patagonia's signature Torres del Paine National Park, with our naturalists.
- ▶ Venture through wildlife reserves not easily accessible to the public, including Karukinka Natural Park in Tierra del Fuego.
- ▶ By special permission, be one of the few people ever to explore Isla de los Estados (Staten Island), located at the extreme end of South America.
- ▶ Transit the legendary Beagle Channel and take in the view of Cape Horn.
- ▶ Two days prior in warm Santiago? Or post-voyage at Easter Island or Iguazu Falls? Call to discuss options or visit expeditions.com/patagoniaext

EXPERIENCE & EXPERTISE



Our experienced expedition leader and team of naturalists are your conduit to an extraordinary experience. The National Geographic photographer and Lindblad-National Geographic certified photo instructor on board, ours exclusively, are key to capturing the incredible wildlife. Our video chronicler will record the entire voyage. The undersea specialist will reveal the deep, while our wellness specialist helps you feel the "tonic of wildness." A Global Perspectives guest speaker adds relevant insight.

Visit our website to read staff and guest speaker bios for this expedition.



The Bernal Glacier and the freshwater lake at its terminus.

DAYS 1 AND 2: U.S./SANTIAGO, CHILE
Fly overnight to Santiago, and check in to the Mandarin Oriental. The Andes form an inspiring backdrop to our guided overview. (Day 2: L)

DAY 3: PUERTO MONTT/EMBARK
Fly from Santiago to Puerto Montt, Chile's northern gateway to Patagonia. Embark *National Geographic Explorer*. (B,L,D)



Colorful architecture, Chiloe Island.

DAY 4: ANCUD (CHILOÉ ISLAND)
Explore Chiloe's culture including its *palafitos*, colorful stilt houses along the water. Alternatively, visit a mixed colony of Magellanic and Humboldt penguins. (B,L,D)

DAY 5: PUMALÍN NATIONAL PARK
Pumalín's 750,000 acres in Chilean Patagonia are protected as one of the last remaining areas of the unusual *alerce* forest, consisting of huge trees similar in size to California redwoods. Walk the park trails to see them up close. (B,L,D)

DAYS 6-10: THE INSIDE PASSAGE & THE CHILEAN FJORDS
A vast area of snowcapped mountains, glaciers, thousands of islands, lakes, soaring granite walls, and waterfalls, the archipelago is virtually untouched by man. We make good use of our Zodiacs, kayaks and undersea technology. One highlight is the Pio XI Glacier, the longest glacier in the Southern Hemisphere outside Antarctica. Look for condors as our ship transits the White Narrows. (B,L,D)

DAY 11: PUERTO NATALES/TORRES DEL PAINE NATIONAL PARK
From Puerto Natales, drive to monumental Torres del Paine National Park, a UNESCO Biosphere reserve. Discover spectacular and wildlife-rich areas, covering 450,000 acres of glaciers, forests and grasslands, rivers and colorful lagoons. (B,L,D)

DAYS 12 AND 13: EXPLORING TIERRA DEL FUEGO/KARUKINKA NATURAL PARK
Tierra del Fuego is one of Patagonia's crown jewels. We have special permission from the Wildlife Conservation Society to visit Karukinka Natural Park, home to nesting black-browed albatross, condors, and elephant seals. (B,L,D)

DAY 14: THE CHILEAN FJORDS, BEAGLE CHANNEL & EXPLORING
Myriad fjords or *senos* indent the coast. We cruise deep into the *senos*, punctuated at the end by tidewater glaciers, to explore by Zodiac, kayak, and on foot. Transit the Beagle Channel and explore some of its many possibilities. (B,L,D)

DAY 15: CAPE HORN
Today we visit Cape Horn, the southernmost tip of the continent, and, conditions permitting, land there for panoramic views. (B,L,D)

DAYS 16-18: ISLA DE LOS ESTADOS (STATEN ISLAND), ARGENTINA
By special permission, *Explorer* is one of the only expedition ships ever to visit extraordinary Staten Island. Its mountainous, forested landscapes and rugged fjords are beautiful. Spot southern rockhopper and Magellanic penguins, fur seals and sea lions. See the San Juan de Salvamento "lighthouse at the end of the world," which inspired Jules Verne's novel by the same name. (B,L,D)



Rockhopper penguin.



DAYS 19 AND 20: USHUAIA/DISEMBARK/BUENOS AIRES/U.S.
Disembark in Ushuaia. Take a charter flight to Buenos Aires and connect to your overnight flight home. (Day 19: B,L)

EXPEDITION DETAILS

DATE: 2018 Oct. 6; 2019 Oct. 7

SPECIAL OFFERS:

Book by Oct. 31, 2018 for **FREE ROUND-TRIP** economy airfare Miami/Santiago, Buenos Aires/Miami, and internal flights Santiago/Puerto Montt, Ushuaia/Buenos Aires. Plus, we will cover your bar tab and tips to the crew.

EXTEND YOUR STAY—THREE DIFFERENT WAYS

Start your journey in **Santiago, Chile** discovering culture, cuisine, and superb wine on our two-day pre-voyage extension (from \$1,990). Or choose one of our post-voyage options: Spend three days exploring astounding **Iguazú Falls**, set in a beautiful subtropical forest that's home to toucans, parrots, butterflies, orchids, and endangered jaguars (from \$2,790). Or for four days steep in the mysteries of remote **Easter Island**, the site of more than 600 massive ancient stone statues (from \$4,390). See page 67 or visit expeditions.com/patagoniaext for details.

BEST OF CHILEAN PATAGONIA: FROM TORRES DEL PAINE TO CAPE HORN

INCLUDES ARGENTINA'S STATEN ISLAND

16 DAYS/13 NIGHTS—ABOARD NATIONAL GEOGRAPHIC ORION
PRICES FROM: \$15,660 to \$24,750 (See page 55 for complete prices.)

On this land and sea expedition, you'll savor the grandeur of Torres del Paine's sunrises and sunsets, its iconic landscapes, and profusion of wildlife during a three-day stay at the outstanding Tierra Patagonia Hotel & Spa, a National Geographic Unique Lodge of the World. Then explore fjords, glaciers, and panoramic vistas aboard *National Geographic Orion*. Venturing out on Zodiac forays, kayaking the pristine fjords, or hiking virgin trails, you'll breathe the rarefied air of a near-mythic region. Enjoy special access to Argentina's Isla de los Estados (Staten Island)—a seldom-seen island covered in wind-sculpted flora, with abundant South American fur seals and Magellanic penguins. Discover the vast parklands of Karukinka. And check viewing legendary Cape Horn off your life list, as well.

EXPEDITION HIGHLIGHTS

- ▶ Discover over several days the wildlife-rich, iconic landscapes of Torres del Paine, Patagonia's jewel. Stay three days at Tierra Patagonia Hotel & Spa, a National Geographic Unique Lodge of the World.
- ▶ Explore wild, windswept Isla de los Estados (Staten Island), which has largely been off limits to travelers since 1923.
- ▶ See storied places such as the Beagle Channel and Cape Horn.
- ▶ Venture through wildlife reserves not easily accessible to the public, including Karukinka Natural Park on Tierra del Fuego.
- ▶ After Patagonia, spend 4 days steeped in Easter Island's mysteries on select departures. Call or visit expeditions.com/easterislandext

EXPERIENCE & EXPERTISE

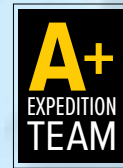

Our experienced expedition leader and team of naturalists are your conduit to an extraordinary experience.

And the National Geographic photographer and Lindblad-National Geographic certified photo instructor on board, ours exclusively, are key to capturing the incredible wildlife. Our video chronicler will record the entire voyage. The undersea specialist will reveal the deep, while our wellness specialist helps you feel the “tonic of wildness.”

Visit our website to read staff and guest speaker bios for this expedition.

Guanaco, Torres del Paine National Park.



DAYS 1 AND 2: U.S./SANTIAGO, CHILE

Fly overnight to Santiago, Chile. Check in to the Hotel Santiago by Mandarin before exploring the Plaza de Armas, the main square and nearby Presidential Palace, enjoying the vibrant city. (Day 2: L)

DAY 3: PUERTO NATALES

Fly to Punta Arenas, then drive to Puerto Natales, one of Patagonia's southern gateways, and check in to the Hotel Singular. Have an afternoon tour of town and dinner at the hotel. (B,L,D)

DAYS 4–6: TORRES DEL PAINE NATIONAL PARK

Drive to this UNESCO Biosphere reserve and spend three days at the Tierra Patagonia Hotel, discovering one of the most wildlife-rich areas in the Americas, covering 450,000 acres of glaciers, forests, grasslands, rivers, and colorful lagoons. Choose among a variety of possibilities, including walks and hikes, horseback riding, sailing among icebergs to the foot of the immense Grey Glacier, visiting the Salto Grande waterfall, and seeing the towers of the central massif from the Blue Lagoon. Look out for guanacos, gray foxes, rheas and Andean condors. (B,L,D)

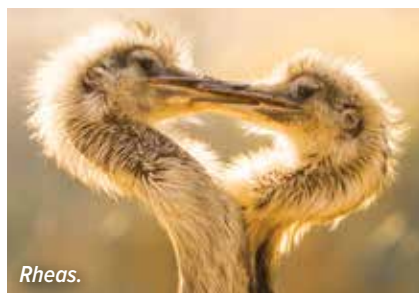

Rheas.

DAY 7: TORRES DEL PAINE NATIONAL PARK/PUERTO NATALES/EMBARK

We have a final morning to explore Torres del Paine. We then drive to Puerto Natales, where we embark *National Geographic Orion*. (B,L,D)

DAYS 8 AND 9: KIRKE NARROWS & EXPLORING CHILEAN FJORDS

Our Captain and local pilots guide us through Kirke Narrows, accessible only to a small ship such as *Orion*. We'll look to make stops in the extensive maze of channels and islands of the Chilean fjords, where we may go out to explore by Zodiac and kayak, or take a forest walk. (B,L,D)

DAY 10: EXPLORING TIERRA DEL FUEGO/KARUKINKA NATURAL PARK

Tierra del Fuego is one of Patagonia's crown jewels. We have special permission from the Wildlife Conservation Society to visit Karukinka Natural Park, home to nesting black-browed albatross, condors, and elephant seals. (B,L,D)



Karukinka Natural Park.

DAY 11: EXPLORING THE BEAGLE CHANNEL

Myriad fjords or *senos* indent the coast. Cruise deep into the *senos*, punctuated at the end by tidewater glaciers, to explore by Zodiac, kayak, and on foot. Transit the Beagle Channel, where we'll look to use our Zodiacs to land and explore one of the many intriguing sites. (B,L,D)

DAY 12: CAPE HORN

Visit Cape Horn, the southernmost tip of the continent, and, weather permitting, land there for panoramic views. (B,L,D)

DAYS 13 AND 14: ISLA DE LOS ESTADOS (STATEN ISLAND), ARGENTINA

Discover extraordinary Staten Island. Its mountainous, forested landscapes and rugged fjords are beautiful. Spot southern rockhopper and



Magellanic penguins, fur seals and sea lions. See the San Juan de Salvamento "lighthouse at the end of the world," which inspired Jules Verne's novel by the same name. (B,L,D)

DAYS 15 AND 16: USHUAIA/ DISEMBARK/SANTIAGO/U.S.

Disembark in Ushuaia. Take a charter flight to Santiago and connect to your overnight flight home. (Day 15: B,L)

EXPEDITION DETAILS

DATES: 2019 Nov. 27; 2020 Mar. 8*

*This voyage travels in reverse.

SPECIAL OFFER:

Travel aboard *National Geographic Orion* and we will cover your bar tab and all tips for the crew.

OPTIONAL EXTENSIONS

Add a post-voyage extension to [Easter Island](#), on select departures. See page 67 for details

NATIONAL GEOGRAPHIC PHOTOGRAPHER

Every departure travels with a National Geographic photographer to assist and inspire you. [Learn more at **expeditions.com/photo**](#).



Guests kayaking.





EXPLORE TIMELESS PLACES WHERE PAST & FUTURE ARE PRESENT



In the diverse geographies that follow, sweeping landscapes reveal storied histories and ancient traditions thriving under the protection of today's inhabitants. Venture through the Pacific Northwest's remote San Juan Islands and into Alert Bay, home of the Kwakwaka'wakw peoples—and feel ancient spirits echo in the drumbeats of a powerful ceremony, and in ceremonial artifacts, the crown jewel of this First Nations community. Journey up the Columbia and Snake Rivers, and sail in the wake of legendary explorers Lewis and Clark and their heritage of discovery,

journeying through geologic time etched in basalt. Or board the elegant *Sea Cloud*—a veritable destination in her own right—for a Caribbean antidote to the winter doldrums. Discover islands once used as pawns by the most powerful seafaring nations in the world and experience the diverse cultural flavors that twine them together. Cross an epic swath of the Pacific like the ancient Polynesians, the world's most brilliant navigators, as they set out from tiny islands to create an ocean nation and settle Hawaii. Or explore Vietnam and Cambodia—two rapidly blossoming countries with turbulent 20th-century histories—from the vantage point of the Mekong and the beautifully appointed river ship *Jahan*.

Clockwise from top left: Guests marvel at the sails and rigging of the historic yacht Sea Cloud, Caribbean; fish vendor in Mekong Delta market, Chau Doc, Vietnam; waves crash at Cape Disappointment, Oregon; guest photographs moai statues on the slopes of Rano Raraku on Easter Island.

EXPLORING BRITISH COLUMBIA AND THE SAN JUAN ISLANDS

8 DAYS/7 NIGHTS—ABOARD NATIONAL GEOGRAPHIC SEA BIRD AND NATIONAL GEOGRAPHIC VENTURE

PRICES FROM: \$4,690 to \$8,540 (See pages 61 and 63 for complete prices.)

Discover the powerful wilderness and warm charm of the Pacific Northwest aboard the 31-cabin *National Geographic Sea Bird* or 50-cabin *National Geographic Venture*—built from the keel up to explore places where wildlife lingers and larger ships cannot go. Venture to the spectacular San Juan Islands and sail through channels of British Columbia that teem with sea life, plus visit charming towns and First Nations heritage sites. This one-way voyage between Seattle and Vancouver allows ample time not only to experience the richness of the living culture of the Namgis First Nations of Alert Bay, but also time to linger in the verdant, photogenic fjords of British Columbia.

EXPEDITION HIGHLIGHTS

- ▶ Kayak, hike, and explore aboard expedition landing craft along the wildlife-rich coasts of Desolation Sound and the Gulf Islands.
- ▶ Learn the history of First Nations people through their art and powerful dance performances.
- ▶ Search for killer whales where they're most reliably found in the Northern Hemisphere.
- ▶ Enjoy a private reception at the museum of acclaimed natural history artist Robert Bateman.

EXPERIENCE & EXPERTISE



Our unparalleled 6-person expedition team aboard the *Sea Bird* and our 10-person team aboard the *Venture* are key to an in-depth experience. An expedition leader, four naturalists, a Lindblad-National Geographic certified photo instructor and undersea specialist, plus a wellness specialist and video chronicler, all contribute to your understanding of the Pacific Northwest wonders. Certain departures will feature a National Geographic photographer or expert.

Visit our website to read staff bios for this expedition.

Kayaking the calm waters of the San Juan Islands.

DAY 1: SEATTLE/EMBARK

Arrive in Seattle and transfer to the *National Geographic Sea Bird* or *National Geographic Venture* to begin your expedition. (D)

DAY 2: EXPLORING THE SAN JUAN ISLANDS

Today we'll visit the more remote of the San Juan Islands, an archipelago in northern Washington State perfect for kayaking, exploring by Zodiac, and hiking. Walks with our expert staff will familiarize you with the natural and cultural history of the rugged northwest coast region. (B,L,D)



Victoria, British Columbia.

DAY 3: FRIDAY HARBOR

Explore Friday Harbor, a picturesque town on San Juan Island. Visit the Whale Museum, with its fascinating collection of artifacts, artwork, and whale skeletons. Stop in at small shops and galleries. (B,L,D)

DAY 4: VICTORIA, BRITISH COLUMBIA

Clear into Canada in the charming city of Victoria and choose from several tailor-made options to explore based on your interests. Visit private gardens, bike along

the waterfront, stroll through Old Town or peruse the collections at local art galleries. In the evening, enjoy a private reception at the Robert Bateman Centre while taking in the incredible collection of paintings. (B,L,D)

DAY 5: EXPLORING THE GULF ISLANDS

Wake this morning among the Gulf Islands, a rich archipelago in the Strait of Georgia, and a yachter's paradise. We'll take our pick of perfect spots to kayak, hike, and search for wildlife. (B,L,D)

DAY 6: JOHNSTONE STRAIT/ALERT BAY

Sail through Johnstone Strait, a waterway cut through a magnificently wild and scenic area of mountains and islands. These ocean waters are also home to extraordinary marine mammals and bird watching. Today we visit one of the oldest First Nations village sites in British Columbia. Alert Bay on Cormorant Island has been and continues to be the home of the Kwakwaka'wakw people and a center for the living culture found throughout the Northwest Coast.

We will visit the U'mista Cultural Centre opened in 1980, which houses one of the northwest coast's finest collections of elaborately carved potlatch masks, regalia and coppers. We'll then make a stop to visit the Big House a short distance away where the Tsasala Cultural Group continues the sharing of culture, "educating the world about their songs, dances, teachings and values." (B,L,D)



DAY 7: DESOLATION SOUND

Desolation Sound, on the north end of British Columbia's Sunshine Coast, is a mecca for kayakers and small yachts. It's easy to understand why, with its calm, sheltered waters and outstanding natural beauty. There are many options and we'll pick the perfect bay where we can explore by foot, kayak or expedition landing craft. Tonight, enjoy captain's farewell dinner. (B,L,D)

DAY 8: VANCOUVER/DISEMBARK

Vancouver is British Columbia's largest city and the major port for all of western Canada. It lies in a stunning setting, surrounded almost completely by water, with snowcapped mountains rising vertically from its backyard. After breakfast, disembark the ship for connecting flights home. (B)



Killer whales in Johnstone Strait.

EXPEDITION DETAILS

DATES: 2018 Sep. 15, 22*, 29; Oct. 6*, 13, 20* (*Sea Bird*)

2019 Sep. 21, 28*; Oct. 5, 12* (*Venture*)

*These departures travel in the reverse order, from Vancouver to Seattle, making all the same stops.

Note: The exact order of stops may vary in order to maximize your experience.

SPECIAL OFFER:

Book now and receive a **\$500 air credit** on the Oct. 13 and 20, 2018 departures.

NATIONAL GEOGRAPHIC PHOTOGRAPHERS

Phil Schermeister joins the Sep. 15, 2018 voyage and Rich Reid joins the Oct. 13, 2018 voyage.

COLUMBIA & SNAKE RIVERS JOURNEY: HARVESTS, HISTORY, AND LANDSCAPES

7 DAYS/6 NIGHTS—ABOARD NATIONAL GEOGRAPHIC QUEST

PRICES FROM: \$4,890 to \$8,630 (See page 63 for complete prices.)

The powerful Columbia and Snake Rivers flow through some of the most geologically fascinating landscapes, carved over time by tumultuous floods and volcanic eruptions. Get an up-close look at towering canyons, massive waterfalls, ancient petroglyphs, and rocky shorelines where bighorn sheep roam free. Along the way you'll also travel through a series of eight locks, visit intriguing museums, and savor this fertile region's abundant bounty—from salmon fished right out of these waterways to award-winning wines and craft brews. And overlying it all: the intrepid spirit of Lewis and Clark and the Corps of Discovery. As you travel in their wake, your historian will weave tales of this dramatic episode in American history.

EXPEDITION HIGHLIGHTS

- ▶ Explore the Palouse River via kayak or Zodiac and hike around the impressive Palouse Falls.
- ▶ Take an exhilarating jet boat ride through the spectacularly scenic Hells Canyon, North America's deepest gorge.
- ▶ Visit a winery and a brewery, and enjoy locally sourced, sustainable food on board, from providers along the way.
- ▶ Absorb more Pacific Northwest on a pre- or post-voyage rewarding one-day wine tour or Portland city tour. Visit expeditions.com/portland for details.

EXPERIENCE & EXPERTISE

25+
YEARS
EXPERIENCE

Our unparalleled 8-person team aboard the *National Geographic Quest* is key to an in-depth experience in this region. An expedition leader, historian, geologist and naturalist/Lindblad-National Geographic certified photo instructor, plus a wellness specialist and video chronicler, will ensure comprehensive understanding and enjoyment of the places and people along our route. Certain departures will feature a National Geographic photographer or expert.

Visit our website to read staff bios for this expedition.

Reflection of the cliffs and Vista House in Oregon along the Columbia River at sunrise.

DAY 1: PORTLAND, OREGON/EMBARK

Board our ship and cruise the center of Portland on the Willamette River before reaching the Columbia River. (D)

DAY 2: ASTORIA

We begin our journey by navigating the Columbia to the mouth of the river at Astoria. At Fort Clatsop, where the explorers hunkered down for the wet winter of 1805-1806, we walk through the full-scale reconstructed fort. Visit the Columbia River Maritime Museum, which chronicles the history of river navigation and this port town. In the afternoon explore more of Lewis and Clark history with several options to choose from. (B,L,D)

DAY 3: COLUMBIA RIVER GORGE/ HOOD RIVER

This morning we begin our orientation to the Gorge. You'll get a fresh perspective on such highlights as Bonneville Lock and Dam, Beacon Rock, and Multnomah Falls. Continue through the Gorge to Hood River, where we'll visit the Western Antique Aeroplane & Automobile Museum (WAAAM). (B,L,D)

DAY 4: THE DALLES/MARYHILL MUSEUM

Visit the Columbia River Gorge Discovery Center to learn about the region's natural history. Hike or take bicycles along the beautiful river trail. In the afternoon we'll visit the Maryhill Museum with its impressive collection of Rodin sculptures and drawings, extensive collection of Native American baskets, and



other fascinating exhibits. End the day with a tour and tasting at a local vineyard and winery. (B,L,D)

DAY 5: EXPLORING THE PALOUSE RIVER

The still water of the Palouse River is the perfect mirror for the surrounding basalt cliffs as we set off cruising on our Zodiac and kayak adventures. Visit Palouse Falls, where cascading waters plunge into the pool below. Afterwards, sail up the Snake River, enjoying a taste of local specialties. (B,L,D)

DAY 6: CLARKSTON, WASHINGTON

At Clarkston, we find ourselves at the confluence of the Snake and Clearwater rivers, more than 450 miles from the sea. Travel by comfortable jet boat up the Snake River into one of North America's most scenic spots, spectacular Hells Canyon. (B,L,D)

DAY 7: CLARKSTON/DISEMBARK

Transfer to Lewiston, Idaho or Spokane, Washington for connecting flights home. (B)

EXPEDITION DETAILS

DATES: 2018 Sep. 17, 23*, 29; Oct. 5*, 11, 17*; 2019 Apr. 25; May 1*; Sep. 15, 21*, 27; Oct. 3*, 9, 15*

*These departures travel in the reverse order, from Clarkston, Washington to Portland, Oregon.

SPECIAL OFFER:

Book by **Oct. 31, 2018** and receive a **\$500 AIR CREDIT** on select departures. Call for details.

PRE- AND POST- OPTIONAL EXTENSIONS

Combine with an overnight stay in Portland and explore more...

Portland City Tour:

Half-day guided exploration of the city's must-see highlights, neighborhoods and lush parks.

Willamette Valley Wine Tour:

Combine the Portland City Tour with a visit to a few of the region's most acclaimed boutique wineries. See page 67 for details.

NATIONAL GEOGRAPHIC PHOTOGRAPHER

Join National Geographic photographer **Jonathan Kingston** on the Sep. 29 and Oct. 5, 2018 departures, or **Michael Hanson** on the Apr. 25 and May 1, 2019 departures.



Fremont Bridge across the Willamette at sunset, Portland.



Regional vineyard.

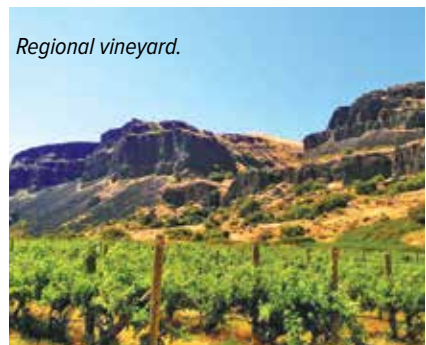

SAILING THE CARIBBEAN

8 DAYS/7 NIGHTS—ABOARD *SEA CLOUD*

PRICES FROM: \$8,730 to \$17,170 (See page 64 for complete prices.)

Set sail aboard the magnificent four-masted barque *Sea Cloud*, and explore the lush islands and vibrant cultures of the Lesser Antilles. Hike through the jungle trails of historic Fort Shirley in Cabrits National Park on Dominica, see an active volcanic crater in St. Lucia, and explore the idyllic Grenadines. Amid a spectacular tropical backdrop, enjoy opportunities to swim and snorkel at reefs and sandy beaches, and discover the hidden corners of the Caribbean Sea.

EXPEDITION HIGHLIGHTS

- ▶ Sail the sparkling Caribbean Sea aboard the historic square-rigger *Sea Cloud*.
- ▶ Swim and snorkel in pristine tropical waters, and explore remote cays and beaches.
- ▶ Explore an 18th-century fort, colonial outposts, and an intriguing mix of cultures with our expedition staff.
- ▶ Experience an array of natural wonders, including volcanoes and rain forests showcasing island birds and wildlife.

EXPERIENCE & EXPERTISE

30+
YEARS
EXPERIENCE

Lindblad Expeditions first sailed aboard *Sea Cloud* in the 1980s, and over the years has developed unparalleled expertise in operating expedition-style journeys aboard this superlative vessel. In addition to an expedition leader, you'll be joined by a naturalist/Lindblad-National Geographic certified photo instructor, a historian who will tell you about the Caribbean's cultures, and local guides on each island. Select departures will feature a National Geographic photographer or expert.

Visit our website to read staff and guest speaker bios for this expedition.

Sea Cloud under full sail.



DAY 1: U.S./BARBADOS/EMBARK

Arrive in Barbados and settle into your cabin aboard the elegant *Sea Cloud*. Cast off this afternoon, and enjoy dinner and our first Caribbean sunset. (D)

DAY 2: UNDER SAIL

Begin the morning on deck, where sailors climb the lines to raise the *Sea Cloud*'s sails by hand. Enjoy a full day skimming across the Caribbean. Relax with a book, photograph the ship's exquisite details, and attend talks by our experts on the natural history and culture of the islands we will soon explore. (B,L,D)

DAY 3: DOMINICA

Spend the day exploring Dominica, known as "the nature island" for its spectacular beauty and many protected reserves. Hike through enchanting rain forest. Join our historian in exploring the ruins of Fort Shirley, an 18th-century British garrison, and learn about Dominica's turbulent colonial history. Go swimming or snorkeling before casting off for a sunset seen from the sea. (B,L,D)

DAY 4: ÎLES DES SAINTES/UNDER SAIL

Distinctly French in character and culture, the shops, homes and people of Les Saintes are colorful, tasteful and delightful. Enjoy picture-postcard views from Fort Napoléon, with its cactus garden, iguanas and maritime museum. Then stroll through French colonial Terre-de-Haut and swim and snorkel from a nearby sandy beach. In the afternoon, we set sail in the Guadeloupe Channel for a short but powerful downwind reach, as the winds fill the square sails in a glorious spectacle. (B,L,D)



Les Pitons break through the otherworldly landscape of St. Lucia.

DAY 5: UNDER SAIL/BEQUIA

Sail aboard our magnificent ship in the morning and anchor at tiny Bequia by afternoon. Explore the charming waterfront and immerse yourself in this unique maritime culture. Go snorkeling at a nearby reef, swim along palm-backed beaches, or join our staff to visit a traditional model boat museum. In Port Elizabeth, we'll find local crafts, markets, and one of the best bookstores in the West Indies. (B,L,D)

DAY 6: UNDER SAIL/EXPLORING THE GRENADINES

Spend the morning aboard *Sea Cloud* under sail, exploring the idyllic Grenadine Islands, with their quintessential tropical cays. We'll have options to snorkel among myriad colorful fish, or enjoy the sheltered white-sand beaches of the area. (B,L,D)

DAY 7: LES PITONS, ST. LUCIA

Arrive at St. Lucia and anchor under the island's iconic twin peaks, Les Pitons, which rise dramatically above the sea. After exploring the fishing port of Soufrière, drive into St. Lucia's active volcanic crater and discover the otherworldly landscape of mud pools and sulfur springs. Take a tropical walk through botanical gardens alive with birds and the backdrop rush of Diamond Falls. Spend the afternoon sailing as we return to Barbados. (B,L,D)

DAY 8: DISEMBARK/BARBADOS/U.S.

Disembark, tour the island, and transfer to the airport for your return flight. (B,L)



EXPEDITION DETAILS

DATES: 2019 Feb. 12, 19, 26

SPECIAL OFFERS:

Book by **Oct. 31, 2018** and receive **FREE ROUND-TRIP** economy airfare between Miami and Barbados. Plus, we will cover your bar tab and tips for the crew on all *Sea Cloud* departures.



Crew climbs Sea Cloud's rigging.

NATIONAL GEOGRAPHIC PHOTOGRAPHER

Join naturalist and award-winning photographer **Robin Moore** on the Feb. 12, 2019 departure. Moore's images are displayed in the National Geographic Fine Art Galleries and have appeared in *National Geographic* magazine, *The New York Times*, *Newsweek*, and *TIME*.



SEE MORE ONLINE

Take a virtual tour of *Sea Cloud*, with 360-degree images, at expeditions.com/seacloudtour

Watch exciting aerial footage of *Sea Cloud* under sail at expeditions.com/seacloudsail

NEW

EASTER ISLAND TO TAHITI: TALES OF THE PACIFIC

20 DAYS/17 NIGHTS—ABOARD NATIONAL GEOGRAPHIC ORION

PRICES FROM: \$17,990 to \$39,390 (See page 55 for complete prices.)

Following in the wake of early Polynesian navigators, this voyage takes you to the farthest reaches of Oceania. From remote and enigmatic Easter Island, to the historically significant Pitcairn Islands through the “low islands” of the Tuamotu Archipelago to Tahiti, you’ll visit islands that are virtually inaccessible and untouched. The voyage begins in one of the most isolated landfalls of Polynesia: Easter Island. Walk the length of untouched tropical beaches, meet the descendants of H.M.S. *Bounty* mutineers, and drift dive or snorkel through an atoll pass.

EXPEDITION HIGHLIGHTS

- ▶ Dive or snorkel the stunning reefs of Fakarava, part of a UNESCO Biosphere Reserve, and the Pitcairn Islands, identified as one of most unspoiled reef systems in the world by National Geographic Explorer-in-Residence Eric Sala.
- ▶ Trace the legend of the ill-fated H.M.S. *Bounty* from Tahiti to Pitcairn Island, where descendants of its mutineers still live today.
- ▶ Explore the unusual geology and wildlife of Henderson Island, a UNESCO World Heritage site, and look for endemic bird species.
- ▶ Delve into the intriguing lost culture of Easter Island, and examine ancient burial sites and towering *moai* with an archaeologist.

EXPERIENCE & EXPERTISE

50
YEARS
EXPERIENCE

In 1967 Lars-Eric Lindblad set his sights on bringing travelers to Easter Island by air.

But with no airstrip to speak of, it seemed an impossible challenge. Yet Lars’ resolve was as strong as the facilities on the island were weak, and after much negotiation and planning he orchestrated the building of the airport that was crucial for tourism. Now, 50 years later, our deep connection and unrivaled knowledge of this enigmatic archipelago allows us to offer an in-depth experience that shines a light on the astonishing legacy of a long-lost culture.

Easter Island, shrouded in mystery and guarded by the famous moai statues.



**DAYS 1–5: U.S./SANTIAGO, CHILE/
EASTER ISLAND/EMBARK**

Depart the U.S. on an overnight flight to Santiago, Chile. Upon arrival, transfer to the Ritz Carlton in central Santiago then join your Lindblad-National Geographic staff this evening for a Welcome Reception. Early the next morning, fly to Easter Island where you will check into the Hanga Roa Eco Village & Spa for two nights. Explore volcanic calderas, jagged lava fields, and sweeping grasslands to discover the colossal *moai* statues, the astonishing legacy of a long-lost culture. Join archaeologists to examine these statues and discuss their meaning and creation; visit burial sites, quarries, and intricately carved ceremonial altars. Embark *National Geographic Orion*. (Day 3: L,D; Days 4-5: B,L,D)

DAYS 6–10: AT SEA/PITCAIRN ISLANDS

Set sail from Easter Island on our journey west, listening to talks by our experts as we sail for two days. We begin our exploration in Ducie Atoll, where we spend time watching for frigatebirds and boobies and snorkeling or diving among spectacular reefs. Our next stop is the UNESCO World Heritage site of Henderson Island, an uplifted atoll that is uninhabited and virtually untouched by humans. Discover the island’s four endemic bird species, rich flora and fauna, and fascinating geology.



Black pearls, Fakarava.

Many of the mutineers of the legendary *Bounty* made their home on Pitcairn Island in the late 18th century, and about 50 of their descendants still live here today. Meet the residents and hear a few words of the unusual Pitkern dialect—a combination of English “sailor speak” and Polynesian phrases. Visit the gravesite of the last surviving *Bounty* mutineer, John Adams, and see the *Bounty*’s anchor, which was salvaged in 1957. (B,L,D Daily)

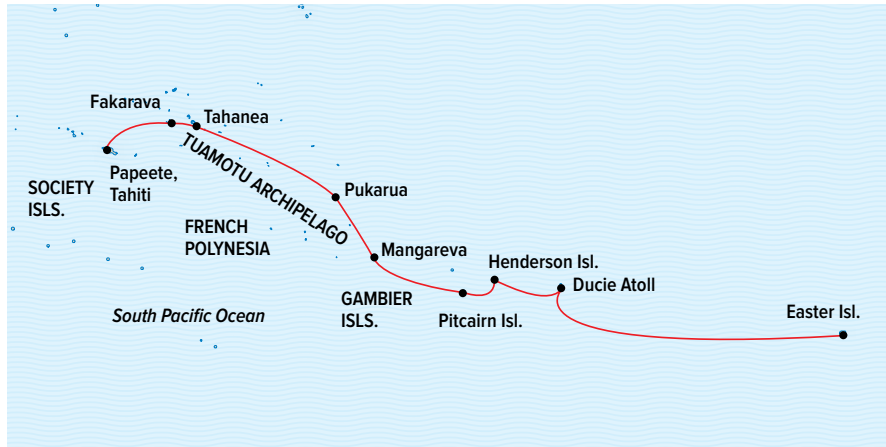

White fairy tern, Ducie Atoll.

**DAYS 11 AND 12: AT SEA/ MANGAREVA,
FRENCH POLYNESIA**

Spend a day at sea scanning the horizon with our naturalists, or relaxing on deck with a good book. We then arrive at Mangareva, the largest of the Gambier Islands, and famous for its black pearls. Venture underwater to snorkel or dive, meet islanders to learn about their culture and the missionaries who made their home here, or go on a hike with our naturalists. (B,L,D Daily)

**DAYS 13–18: AT SEA/TUAMOTU
ARCHIPELAGO**

We begin our exploration of the “Dangerous Archipelago” in Pukarua, where we’ll be greeted by traditional dancers. Navigate reefs and islets during a day at sea and then in true expedition mode, explore one of the uninhabited atolls such as Tahanea. Continue to Fakarava, one of the largest atolls in French Polynesia and part of a UNESCO Biosphere Reserve. Snorkel the protected reefs or ride the current into the lagoon on a world famous drift dive. (B,L,D Daily)

**DAYS 19 AND 20: PAPEETE/
DISEMBARK/U.S.**

Arrive in Papeete, French Polynesia and take a tour of Tahiti before your overnight flight home. (Day 19: B, L)

EXPEDITION DETAILS

DATES: 2018 Aug. 30*
2019 Mar. 25; Oct. 9*

*These voyages travel in reverse from Papeete to Easter Island. Aug. 30, 2018 and Oct. 9, 2019 departures are 19 days. See website for details.

SPECIAL OFFERS:

- Book by **Oct. 31, 2018** and receive **complimentary international airfare** between Los Angeles/Santiago and Papeete/Los Angeles. Plus, we will cover your bar tab and tips for the crew on all *Orion* departures.
- **SAVE 10%** when you book two or more voyages in South Pacific aboard *National Geographic Orion*. Call for details.

OPTIONAL EXTENSION

Arrange a pre-voyage stay—effortlessly. Arrive in Papeete and rest up at the InterContinental Tahiti before embarking. Available on the Aug. 30, 2018 and Oct.9, 2019 departures. Call for details.



Venture underwater to snorkel or dive.

VIETNAM AND CAMBODIA: ALONG THE MEKONG RIVER

15 DAYS/12 NIGHTS—ABOARD *JAHAN*

PRICES FROM: \$11,190 to \$16,910 (See page 65 for complete prices.)

Linked by the mighty Mekong River, Vietnam and Cambodia abound with magnificent carved temples, lush landscapes, and cities where rich imperial and colonial legacies mingle. Encounter the incomparable treasures of Angkor, and take a river voyage aboard the elegant *Jahan* between the Tonle Sap River and Vietnam's Mekong Delta. Explore traditional villages, and gain insight into the daily lives of farmers, monks, and craftspeople.

EXPEDITION HIGHLIGHTS

- ▶ Sail the Mekong River on a seven-night cruise aboard the elegant riverboat *Jahan*.
- ▶ Watch the sunrise at Angkor Wat, and spend two full days immersed in the splendor of Angkor's temples and palaces.
- ▶ Take in the magic of a private candlelit dinner at a temple of Angkor, and visit the residence of former U.S. ambassador Henry Cabot Lodge Jr.
- ▶ Explore the vibrant cities of Phnom Penh and Saigon, and experience rural life on visits to floating homes, farms, and traditional villages.
- ▶ You're traveling far; see more on an eight-day pre- or post-voyage extension. Discover Hoi An, Hue, Hanoi, and Halong Bay. Visit expeditions.com/vietnamext for details.

EXPERIENCE & EXPERTISE



Our expedition staff aboard the outstanding river boat *Jahan* consists of an expedition leader, experts on Southeast Asian cultures, a naturalist/Lindblad-National Geographic certified photo instructor, and an American doctor, along with top local guides in each region. National Geographic Expert **Paula Swart**, a long-time museum curator and an expert on Asian culture and history, will join the Jan. 14, 2019 departure.

Visit our website to read staff bios for this expedition.

Monks visit Bayon temple, known for its ancient stone faces.



DAYS 1-3: U.S./SIEM REAP, CAMBODIA
Depart in the evening, “lose” a day crossing the international date line, and arrive in Siem Reap on Day 3. Settle into our outstanding Khmer style hotel, La Résidence d’Angkor, on the banks of the Siem Reap River.

DAYS 4 AND 5: ANGKOR

Rise early to watch the sunrise over Angkor Wat. This 12th-century Khmer temple, one of the world’s largest religious monuments, is adorned with elaborate bas-reliefs and sculptures. Ride a *tuk-tuk*, or motorized rickshaw, to the walled city of Angkor Thom. Discover the shrines of Ta Prohm and the temple of Banteay Srei. Enjoy traditional Cambodian music and dance at a beautifully-lit private dinner at one of Angkor’s temples. Visit a workshop where local youth are trained in age-old Khmer arts. (Day 4: B,L,D; Day 5: B,D)

DAY 6: KAMPONG CHAM/EMBARK

Drive to the bustling town of Kampong Cham and embark the *Jahan*, our home for the next seven nights. (B,L,D)



Kids in a local school, Kampong Chhnang.

DAY 7: WAT HANCHEY OR KOH DACH/ ANGKOR BAN

At Wat Hanchey, see a variety of temples, including an 8th-century temple from the pre-Angkor Chenla period, or see the silk weaving village of Koh Dach. Continue to the village of Angkor Ban, with its traditional houses and friendly residents. (B,L,D)

DAY 8: KAMPONG CHHNANG/ KAMPONG TRALACH

Visit a village where artisans make traditional pottery, and board local boats to see the clustered houses and shops that float in midstream. At Kampong Tralach, take an oxcart ride through rice paddies to a local school. (B,L,D)

DAY 9: PHNOM PENH

Explore the Cambodian capital by *cyclo*

(bicycle taxi), and visit the Royal Palace and the National Museum of Cambodia. Learn about the reign of the Khmer Rouge on a visit to the Tuol Sleng Genocide Museum. This evening, enjoy an apsara dance performance. (B,L,D)



Banteay Srei temple abounds with fine carvings.

DAY 10: CRUISING THE MEKONG

Take in views of everyday life along the river, attend talks by our experts, and join our chefs to learn how to cook regional dishes. Cross the border into Vietnam. (B,L,D)

DAY 11: CHAU DOC OR TAN CHAU, VIETNAM

Chau Doc has one of Vietnam’s most interesting markets, with an astonishing variety of tropical fruits, vegetables and other goods. We continue to a floating market on the river and a fish farm, where we see fish being fed through trap doors in the floating platforms. In the afternoon, we continue sailing the Mekong. (B,L,D)

DAY 12: SA DEC/CAI BE

Take a local boat to experience rural life in the Mekong Delta. See the floating market of Cai Be, step into a rice “factory” to watch rice-based candies being made, and cruise among floating markets and fish farms. Tonight, enjoy a farewell dinner aboard the *Jahan*. (B,L,D)

DAY 13: MY THO/SAIGON/DISEMBARK

Disembark in My Tho and visit the Vinh Trang Pagoda. Then journey to Saigon (Ho Chi Minh City) and check into the Park Hyatt Saigon for two nights. Meet with a local expert on Vietnam’s modern development, and have a private dinner at the former residence of U.S. ambassador Henry Cabot Lodge Jr. (B,L,D)

DAYS 14 AND 15: SAIGON/U.S.

Embark on a tour of Saigon’s landmarks, including the Reunification Palace, headquarters of the South Vietnamese government during the Vietnam War. Visit the Cu Chi tunnels. Depart Saigon on Day 15, arriving home the same day. (B)



EXPEDITION DETAILS

DATES: 2019 Jan. 14, 22*, Feb. 11, 19*, 25

*These departures travel from Saigon to Siem Reap.

OPTIONAL EXTENSION

Venture further into Vietnam on an eight-day extension: [From Hoi An to Halong Bay](#). See page 67 for details.

GUEST SPEAKER

Frances Fitzgerald is the author of the National Book Award- and Pulitzer Prize-winning book *Fire in the Lake:*



The Vietnamese and the Americans in Vietnam. Join her on the Feb. 19, 2019 departure.

REVERSE ITINERARY AT-A-GLANCE

SAIGON TO SIEM REAP

Days 1-3: U.S./Saigon, Vietnam

Day 4: Saigon (B,D)

Day 5: Saigon/My Tho/Embark (B,L,D)

Day 6: Cai Be/Sa Dec (B,L,D)

Day 7: Chau Doc or Tan Chau (B,L,D)

Day 8: Phnom Penh, Cambodia (B,L,D)

Day 9: Sailing the Tonle Sap River/Kampong Chhnang (B,L,D)

Day 10: Kampong Tralach/Koh Dach or Wat Hanchey (B,L,D)

Day 11: Angkor Ban/Kampong Cham (B,L,D)

Day 12: Disembark/Siem Reap/Angkor (B,L,D)

Day 13: Angkor/Siem Reap (B,D)

Days 14 and 15: Angkor/Siem Reap/U.S. (B)



Bicycles are a typical form of transport.



NATIONAL GEOGRAPHIC EXPLORER

CAPACITY: 148 guests in 81 outside cabins.

REGISTRY: Bahamas. **OVERALL LENGTH:** 367 feet.

National Geographic Explorer is a state-of-the-art expedition ship, and the flagship of the Lindblad fleet. It is a fully stabilized, ice-class vessel, with an Ice-1A Super on the forward hull, enabling it to navigate polar passages while providing exceptional comfort. It carries kayaks and a fleet of Zodiac landing craft. An undersea specialist operates a remotely operated vehicle (ROV) and sophisticated video equipment, extending access to the underwater world.

PUBLIC AREAS: Bistro bar; chart room; restaurant; global gallery; library, lounge with full service bar and state-of-the-art facilities for films, slideshows and presentations; mudroom with lockers for expedition gear, and observation lounge. Our “open bridge” provides guests an opportunity to meet our officers and captain and learn about navigation.

CATEGORY 1: Main Deck with one or two portholes #301-308

CATEGORY 2: Main Deck with window #317-320, 335-336

CATEGORY 3: Main Deck with window #313-316, 321-328, 337-340, 342, 344, 346, 348, 350

CATEGORY 4: Upper and Veranda Decks with window #103-104, 107-108, 201-202, 204-207, 210, 212, 217, 226, 228

CATEGORY 5: Upper Deck with balcony #209, 211, 214, 216, 218, 220-222, 224

CATEGORY 6: Veranda Deck—Suite #101-102; Upper Deck—Suite with balcony #213

CATEGORY 7: Upper Deck—Suite with balcony #215, 219, 230

MEALS: Served in single seatings with unassigned tables for an informal atmosphere and easy mingling. Menu is international with local flair.

CABINS: All cabins face outside with windows or portholes, private facilities and climate controls. Some cabins have balconies.

EXPEDITION EQUIPMENT: Zodiac landing craft, kayaks, Remotely Operated Vehicle (ROV), hydrophone, splashcam, underwater video camera, crow’s nest remote controlled camera and video microscope.

SPECIAL FEATURES: A full-time doctor, undersea specialist, Global Perspectives guest speaker, National Geographic photographer, Lindblad-National Geographic certified photo instructor and video chronicler, internet café and laundry.

WELLNESS: The vessel is staffed by a wellness specialist and features a glass-enclosed fitness center, outdoor stretching area, two LEXspa treatment rooms and sauna.

CATEGORY A SOLO: Main Deck with window #309-312, 329-334

CATEGORY B SOLO: Upper and Veranda Decks with window #105-106, 203, 208

CATEGORY 3 TRIPLE: Main Deck with window #341, 343

SHARED ACCOMMODATIONS: Available in Categories 1 and 2.

NOTE: Cabins #209, 211, 214, 216-218, 220, 222, 224, 226, 228, 303-306—These cabins have one queen-sized bed. All other double cabins have two lower single beds; some can convert to a queen-sized bed. Note: Sole occupancy cabins available in Categories A and B. Third person rates are available in the designated triple occupancy cabins at one-half the double occupancy rate. Cabins #341, 343, 101, 102, 215, 219, and 230 can accommodate a third person.

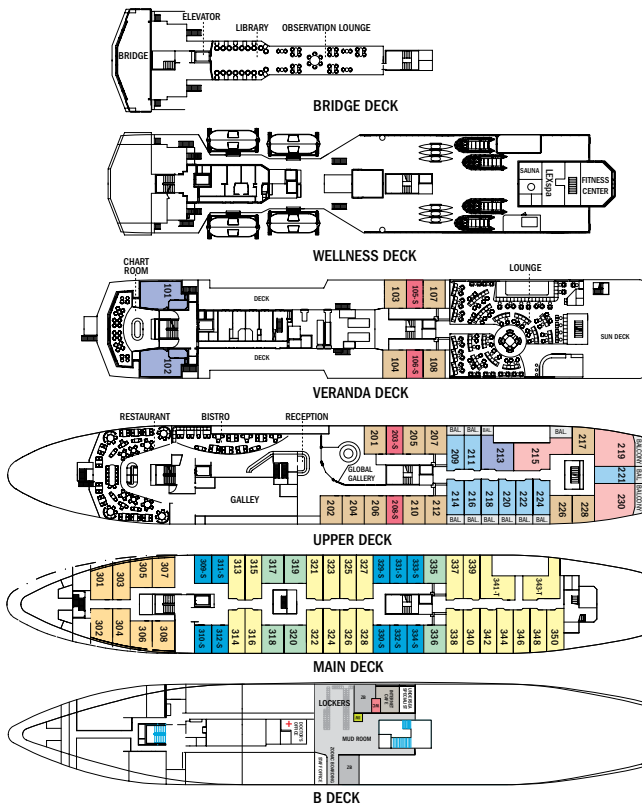

Clockwise from top: Category 6 Suite; standard bath; Category 5 cabin with balcony.

▶ TAKE A VIRTUAL VIDEO TOUR OF THE SHIP AT WWW.EXPEDITIONS.COM/EXPLORER

WITH COMPLIMENTS. YOUR BAR TAB AND ALL CREW GRATUITIES ARE INCLUDED.

Prices are per person, double occupancy unless indicated as solo.

ITINERARY	YEAR	CAT. 1	CAT. 2	CAT. 3	CAT. 4	CAT. 5	CAT. 6	CAT. 7	CAT. A SOLO	CAT. B SOLO	ADVANCE PAYMENT	NOTE
Journey to Antarctica – Page 30	2018/19	\$13,890	\$14,940	\$15,380	\$16,550	\$19,990	\$22,800	\$26,600	\$18,680	\$19,220	\$1,500	Includes one hotel night. Immigration fees are not included. Sample Airfares: round-trip Miami/Buenos Aires: Economy from \$1,100; Business from \$3,100. Charter airfare from \$890-\$960 (round-trip Buenos Aires/Ushuaia).
	2019/20	\$14,580	\$15,690	\$16,150	\$17,380	\$20,990	\$23,940	\$27,930	\$19,600	\$20,190		
Journey to Antarctica: Holiday departures – Page 30	2018	\$14,990	\$16,120	\$16,610	\$17,850	\$21,550	\$24,590	\$28,650	\$20,150	\$20,760	\$1,500	Includes one hotel night. Immigration fees are not included. Sample Airfares: round-trip Miami/Buenos Aires: Economy from \$1,100; Business from \$3,100. Charter airfare from \$890-\$960 (round-trip Buenos Aires/Ushuaia).
	2019	\$15,740	\$16,930	\$17,440	\$18,740	\$22,630	\$25,820	\$29,990	\$21,170	\$21,800		
South Georgia and the Falklands– Page 32	2018/19	\$16,990	\$18,130	\$19,130	\$20,350	\$24,580	\$28,350	\$32,880	\$22,660	\$23,910	\$2,500	Includes one hotel night. Immigration fees are not included. Sample Airfares: round-trip Miami/Buenos Aires, return Santiago/Miami: Economy from \$1,100; Business from \$3,100. Charter airfare from \$890-\$960 (Buenos Aires/Ushuaia, return Falklands/Santiago).
	2019/20	\$17,840	\$18,990	\$19,990	\$21,350	\$25,800	\$29,770	\$34,520	\$23,740	\$24,990		
Antarctica, South Georgia & Falklands – Page 34	2018/19	\$23,990	\$25,740	\$26,950	\$28,220	\$34,750	\$39,990	\$46,450	\$32,180	\$33,690	\$3,000	Includes one hotel night. Immigration fees are not included. Sample Airfares: round-trip Miami/Buenos Aires: Economy from \$1,100; Business from \$3,100. Charter airfare from \$890-\$960 (round-trip Buenos Aires/Ushuaia).
	2019/20	\$25,120	\$26,990	\$28,290	\$29,630	\$36,490	\$41,990	\$48,770	\$33,730	\$35,360		
Epic Patagonia: Fjords, Peaks, and Forests – Page 36	2018	\$18,990	\$20,420	\$21,250	\$22,520	\$26,630	\$30,990	\$35,500	\$25,520	\$26,560	\$2,500	Includes one hotel night in Santiago. Immigration fees are not included. Sample Airfares: Miami/Santiago, Buenos Aires/Miami: Economy from \$1,180; Business from \$3,600. Internal airfare from \$805 (Santiago/Puerto Montt, Ushuaia/Buenos Aires).
	2019	\$19,370	\$20,830	\$21,680	\$22,970	\$27,160	\$31,610	\$36,210	\$25,990	\$26,990		



NATIONAL GEOGRAPHIC ORION

CAPACITY: 102 guests in 53 outside cabins.

REGISTRY: Bahamas. **OVERALL LENGTH:** 338 feet.

The state-of-the-art *National Geographic Orion* is a fully stabilized, ice-class vessel with an ice reinforced hull. *Orion* is at home navigating polar ice, as well as island harbors in the South Pacific.

PUBLIC AREAS: Outdoor café, lounge with bar, restaurant, sun-deck, reception desk, observation lounge and library, global gallery, and marina platform. Our “open bridge” allows guests to meet our captain and officers and learn about navigation.

MEALS: All meals are served in a single seating with unassigned tables for an informal atmosphere and easy mingling. The cuisine is international with local flair, featuring tastes of the regions we explore.

CABINS: All cabins feature ocean views, private facilities,

CATEGORY 1: Main Deck with oval window
#316, 318, 319-321

CATEGORY 2: Main Deck with oval window
#302-312, 314, 315, 317

CATEGORY 3: Upper Deck—Suite with window
#401-412, 414-419

CATEGORY 4: Bridge Deck—Deluxe suite with window
#511, 515

CATEGORY 5: Bridge Deck—Suite with French balcony
#501, 503-506, 508

climate controls, internet access for your own laptop, and a flat-screen TV with interactive system. Some cabins have French balconies. Single cabins in Category 1 and Category 3 include #301, 322, 323, and 512.

EXPEDITION EQUIPMENT: Zodiac landing craft, a fleet of 24 double kayaks, crew’s nest camera, hydrophone, underwater video cameras, video microscope, and a Remotely Operated Vehicle (ROV). Plus, on South Pacific voyages, there is snorkeling gear for all guests, scuba gear for 24 guests, glass-bottom Zodiac, stand-up paddleboards and splash-cam.

SPECIAL FEATURES: Laundry, a full-time doctor, National Geographic photographer and Lindblad-National Geographic certified photo instructor, an undersea specialist and video chronicler.

WELLNESS: A wellness specialist, fitness center, LEXspa treatment room and sauna are on board.

CATEGORY 6: Bridge Deck—Owner’s suite with French balcony
#502, 507, 509*, 510

*Cabin 509 has two windows in lieu of a French balcony.

CATEGORY 1 SOLO: Main Deck with oval window or two portholes #301, 322, 323

CATEGORY 3 SOLO: Bridge Deck—Suite with two windows #512

NOTE: Sole occupancy cabins available in Categories 1 and 3. Shared accommodations available in Categories 1 and 2.

NOTE: Third person rates available at one-half the double occupancy rate in designated triple occupancy cabins.

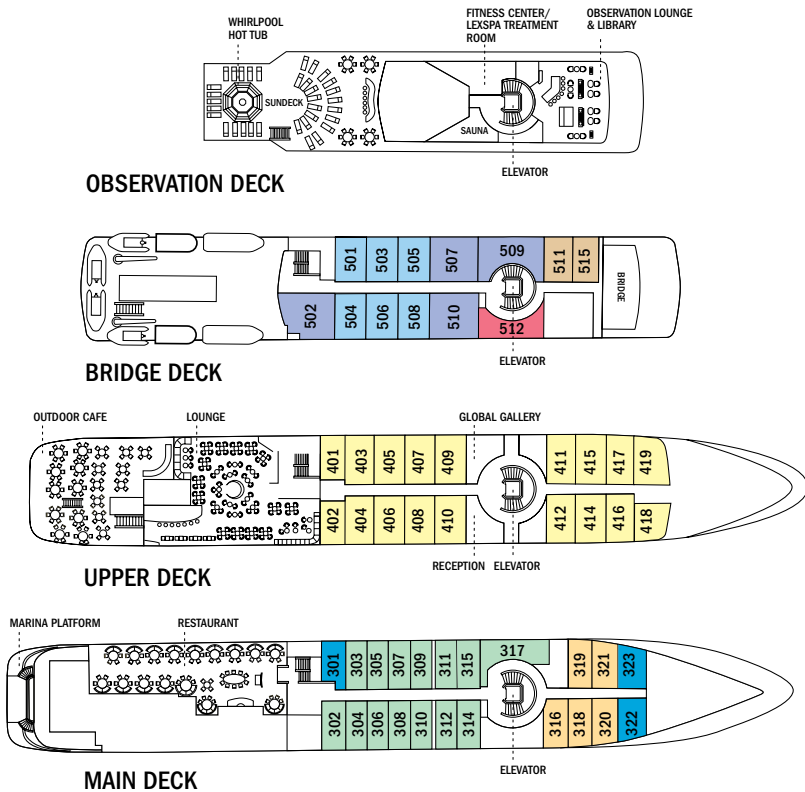

Clockwise from top: Spacious bathroom; main lounge and bar; category 3 suite.

▶ TAKE A VIRTUAL VIDEO TOUR OF THE SHIP AT WWW.EXPEDITIONS.COM/NGORION

WITH COMPLIMENTS. YOUR BAR TAB AND ALL CREW GRATUITIES ARE INCLUDED.

Prices are per person, double occupancy unless indicated as solo.

ITINERARY	YEAR	CAT. 1	CAT. 2	CAT. 3	CAT. 4	CAT. 5	CAT. 6	CAT. 1 SOLO	CAT. 3 SOLO	ADVANCE PAYMENT	NOTE
Journey to Antarctica – Page 30	2018/19	\$14,170	\$15,230	\$16,960	\$20,500	\$23,440	\$27,290	\$21,250	\$25,440	\$1,500	Includes one hotel night in Santiago. Immigration fees are not included. Sample Airfares: round-trip Miami/Santiago: Economy from \$1,000; Business from \$3,500. Charter Airfare from \$960-\$1,240 (round-trip Santiago/Ushuaia).
	2019/20	\$14,880	\$15,990	\$17,810	\$21,520	\$24,610	\$28,650	\$22,310	\$26,710		
Journey to Antarctica – Holiday departures – Page 30	2018	\$15,380	16,520	18,300	22,130	25,320	29,490	23,070	27,420	\$2,500	Includes one hotel night in Santiago. Immigration fees are not included. Sample Airfares: round-trip Miami/Santiago: Economy from \$1,000; Business from \$3,500. Charter Airfare from \$960-\$1,240 (round-trip Santiago/Ushuaia).
	2019	\$16,150	\$17,350	\$19,220	\$23,240	\$26,590	\$30,960	\$24,220	\$28,830		
Antarctica, South Georgia & Falklands – Page 34	2018/19	\$24,620	\$26,380	\$28,450	\$35,660	\$41,150	\$47,720	\$36,930	\$42,670	\$3,000	Includes one hotel night in Santiago. Immigration fees are not included. Sample Airfares: round-trip Miami/Santiago: Economy from \$1,000; Business from \$3,500. Charter Airfare from \$960-\$1,240 (round-trip Santiago/Ushuaia).
	2020	\$25,850	\$27,700	\$29,870	\$37,440	\$43,200	\$49,990	\$38,780	\$44,790		
Best of Chilean Patagonia: From Torres del Paine to Cape Horn – Page 38	2019/20	\$15,660	\$16,430	\$17,610	\$19,870	\$22,330	\$24,750	\$22,650	\$25,590	\$2,500	Includes one hotel night in Santiago, one hotel night in Puerto Natales and three hotel nights in Torres del Paine. Immigration fees are not included. Sample Airfares: Miami/Santiago Miami: from \$1,000; Business from \$3,500. Internal airfare from \$855 (Santiago/Puerto Natales, Ushuaia/Santiago).
Easter Island to Tahiti: Tales of the Pacific – Page 48	2018	\$17,990	\$21,350	\$25,370	\$27,490	\$32,820	\$37,970	\$26,990	\$37,990	\$2,500	Includes two hotel nights accommodations on Easter Island. Immigration fees are not included. Sample Airfares: Los Angeles/Santiago, Chile, Papeete/Los Angeles: Economy from \$1,800; Business from \$4,000; Santiago/Easter Island from \$950, subject to change.
	2019	\$18,590	\$21,990	\$26,250	\$28,450	\$33,970	\$39,300	\$27,890	\$39,390		



NATIONAL GEOGRAPHIC ENDEAVOUR II

OUR NEWEST SHIP IN GALÁPAGOS,
OFFERING EXPEDITION AMENITIES FOR 96 GUESTS

CAPACITY: 96 guests in 52 outside cabins.

REGISTRY: Ecuador. **OVERALL LENGTH:** 236 feet.

PUBLIC AREAS: Forward lounge and bar accommodating all guests for presentations and gatherings, restaurant, large library with Mac kiosks, open-air observation deck, underwater gear area and dual Zodiac boarding platform, and open bridge, where guests can meet the captain and officers and learn about navigation. Ship refitted for Galápagos in 2016.

MEALS: Served in a single, unassigned seating in a sociable, informal atmosphere with Ecuadorian flair.

CABINS: All face outside with large windows, and feature twin beds that convert to a queen. With private facilities and climate control, nightstands, desk, and storage. Seven sets of cabins with a connecting door.

EXPEDITION EQUIPMENT: Zodiacs, glass-bottom boat, kayaks and paddleboards, snorkel gear and wetsuits for both adults and children, video microscope and underwater video camera.

SPECIAL FEATURES: Lindblad-National Geographic certified

photo instructor, shipboard doctor, video chronicler, National Geographic Global Explorers family program, snorkel instruction, Wi-Fi access, laundry service, Global Gallery.

WELLNESS: LEXSpa and fitness center, exercise classes, and wellness specialist.

Clockwise from top: National Geographic Endeavour II, launched in December 2016, features 52 cabins accommodating 96 guests; gym; Suite C, largest on the ship; twin bed cabin.



CATEGORY 1: Upper Deck, Forward #201, 202

CATEGORY 2: Upper Deck #211, 213-219, 221, 222, 224-229

CATEGORY 3: Lounge Deck #311, 313-319, 321, 322, 324, 326, 328, 330

CATEGORY 4: Bridge Deck #409, 411-414, 416, 418

SUITE A: Lounge Deck, Mid-Ship #320—with two windows, larger bath, arm chair. Connecting door to #322.

SUITE B: Bridge Deck, Mid-Ship #420, 422—with two floor-to-ceiling windows, larger bath, convertible sofa for a third person.

SUITE C: Bridge Deck, Mid-Ship #415—with two large windows, larger bath, separate sitting area with convertible sofa for a third person and arm chairs, largest cabin on ship.

CATEGORY 2 SOLO: Upper Deck #203-209—with a queen bed.

CATEGORY 3 SOLO: Lounge Deck #325, 327—with a queen bed.

NOTE: All cabins feature the option of two twins or a queen bed, plus large window(s), desk, chair, and closet.

CONNECTING CABINS: #226/228, 227/229, 315/317, 316/318, 320/322, 411/413, 416/418

TRIPLE OCCUPANCY: #224, 225, 326, 328 with fold-down upper third bunk, Suites B and C with convertible sofa bed. Third person rates are one-half per person double occupancy rate.

SHARED ACCOMMODATIONS: Shares can be arranged at the double occupancy rate in Categories 1 and 2.

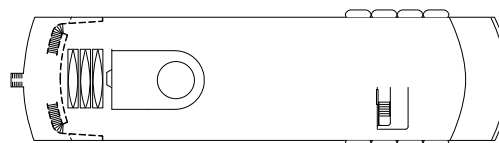

OBSERVATION DECK

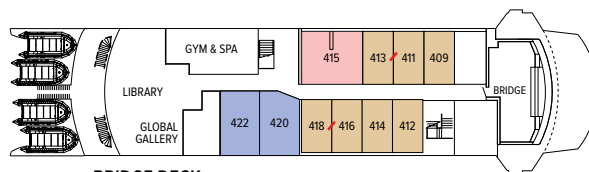

BRIDGE DECK

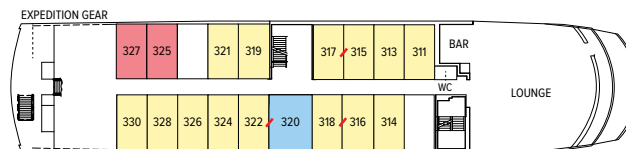

LOUNGE DECK

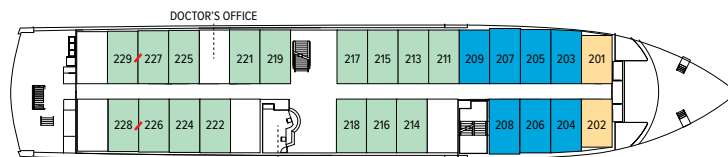

UPPER DECK

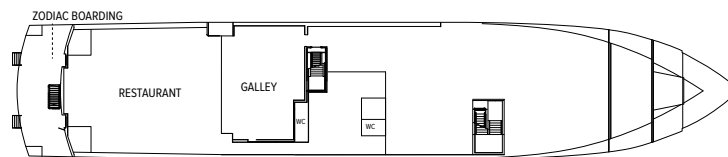

MAIN DECK

↗ indicates adjoining cabins

Prices are per person, double occupancy unless indicated as solo.

ITINERARY		CAT. 1	CAT. 2	CAT. 3	CAT. 4	SUITE A	SUITE B	SUITE C	CAT. 2 SOLO	CAT. 3 SOLO	ADVANCE PAYMENT	NOTE	
Galápagos: Aboard <i>National Geographic Endeavour II</i> – 10 days/9 nights – Pages 14-15													
Departing Saturdays throughout the year	2018	\$6,960	\$8,100	\$8,990	\$9,970	\$11,950	\$12,890	\$13,660	\$10,130	\$11,240	\$750	International and internal Ecuador tickets must be issued separately for all Galápagos voyages. Sample International Airfares: round-trip Miami/Guayaquil: Economy from \$500; Business from \$1,050. Sample Internal Airfares: Guayaquil/Galápagos: Adult from \$520; children under 12 from \$260. Call for sample Peru airfare.	
	2019*	\$7,190	\$8,450	\$9,450	\$10,590	\$12,690	\$13,690	\$14,490	\$10,690	\$11,880	\$750		
Holiday	Dec. 21 & 28, 2018	\$7,780	\$8,990	\$10,050	\$11,150	\$13,390	\$14,450	\$15,400	\$11,240	\$12,560	\$1,000		
	Dec. 20 & 27, 2019*	\$8,270	\$9,720	\$10,870	\$12,180	\$14,600	\$15,750	\$16,670	\$12,300	\$13,670	\$1,000		
Galápagos + Machu Picchu & The Land of the Inca – 16 days/15 nights – Page 20													
Departing Saturdays throughout the year	2018	\$12,650	\$13,790	\$14,680	\$15,660	\$17,640	\$18,580	\$19,350	\$17,200	\$18,310	\$1,500		
	2019*	\$13,080	\$14,340	\$15,340	\$16,480	\$18,580	\$19,580	\$20,380	\$17,980	\$19,170	\$1,500		
Holiday	Dec. 14, 2018	\$13,380	\$14,520	\$15,410	\$16,390	\$18,370	\$19,310	\$20,080	\$17,930	\$19,040	\$1,500		
	Dec. 28, 2018	\$13,470	\$14,680	\$15,740	\$16,840	\$19,080	\$20,140	\$21,090	\$18,310	\$19,630	\$1,500		
	Dec. 20, 2019*	\$14,890	\$16,340	\$17,490	\$18,800	\$21,220	\$22,370	\$23,290	\$20,120	\$21,490	\$1,500		
Galápagos + Upper Amazon - 18 days/17 nights - Page 21 (Please call for dates and rates)													
Tropical Andes + Galápagos Aboard <i>National Geographic Endeavour II</i> - 14 days/13 nights - Page 20 (Please call for dates and rates)													

*Price valid through Oct. 31, 2018.



NATIONAL GEOGRAPHIC ISLANDER

YACHT-SCALED AND TRIM, OFFERING EXPEDITION AMENITIES FOR JUST 48 GUESTS

CAPACITY: 48 guests in 24 outside cabins.

REGISTRY: Ecuador. **OVERALL LENGTH:** 164 feet.

PUBLIC AREAS: Open-air observation deck, second covered outside deck with hammocks, tables and chairs. Lounge and bar accommodating all guests for presentations and gatherings, dining room, library, Mac kiosks and Internet. The captain and officers welcome guests to visit the open bridge.

MEALS: Served in a single, unassigned seating in a sociable, informal atmosphere with Ecuadorian flair.

CABINS: All have a window with an outside view, private facilities, ample storage and climate controls. Bed can be configured as two twins or as a single queen.

EXPEDITION EQUIPMENT: Zodiacs, a fleet of kayaks and paddleboards, snorkel gear and wetsuits for both adults and children, video microscope and underwater video camera.

SPECIAL FEATURES: Shipboard doctor, Lindblad-National Geographic certified photo instructor, video chronicler, snorkel instruction, Wi-Fi access, laundry service, National Geographic Global Explorers family program, Global Gallery.

WELLNESS: LEXSpa and fitness center, exercise classes, and wellness specialist.

Clockwise from top: National Geographic Islander anchors close to shore; Category 1 cabin; Category 4 cabin; spacious and comfortable lounge.





CATEGORY 1: Main Deck, Forward #201-206

CATEGORY 2: Main Deck #207-210, Bridge Deck #301, 302

CATEGORY 3: Bridge Deck #303-306. Cabins 305 and 306 can accommodate a third person with sofa bed.

CATEGORY 4: Upper Deck #403-408—with outside, glassed-in terraces with windowed door and seating.

CATEGORY 5: Upper Deck, #401 and 402—forward facing with additional seating, desk, wrap-around windows, glassed-in terrace with seating. Largest cabins aboard.

NOTE: All cabins offer two twin beds that can be converted to a queen. Sole occupancy in categories 1 and 2 only. Third person rates for cabins 305 and 306 are one-half per person double occupancy rate.

SHARED ACCOMMODATIONS: Shares can be arranged at the double occupancy rate in Categories 1 and 2 only.

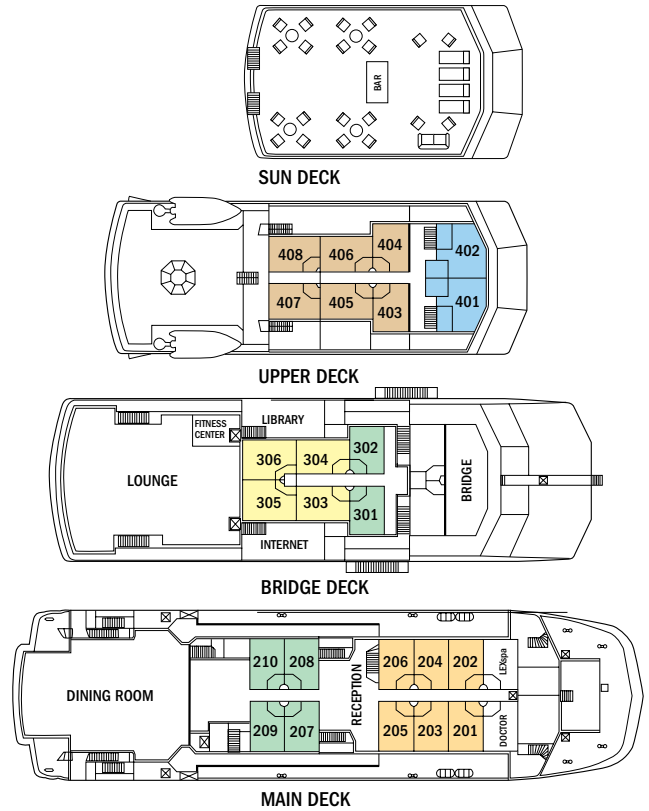

Prices are per person, double occupancy unless indicated as solo.

ITINERARY		CAT. 1	CAT. 2	CAT. 3	CAT. 4	CAT. 5	CAT. 1 SOLO	CAT. 2 SOLO	ADVANCE PAYMENT	NOTE	
Galápagos: Aboard <i>National Geographic Islander</i> – 10 days/9 nights – Page 14-15											
Departing Saturdays throughout the year	2018	\$7,330	\$8,290	\$9,170	\$9,750	\$11,860	\$10,990	\$12,440	\$750	International and internal Ecuador tickets must be issued separately for all Galápagos voyages. Sample International Airfares: round-trip Miami/Guayaquil: Economy from \$500; Business from \$1,050. Sample Internal Airfares: Guayaquil/Galápagos: Adult from \$520 Children (Under 12) from \$260. Call for sample Peru airfare.	
	2019*	\$7,550	\$8,650	\$9,590	\$10,150	\$12,350	\$11,390	\$12,990	\$750		
Holiday	Dec. 22 & 29, 2018	\$8,390	\$9,440	\$10,270	\$10,900	\$13,070	\$12,590	\$14,160	\$1,000		
	Dec. 21 & 28, 2019*	\$8,690	\$9,950	\$11,030	\$11,680	\$14,210	\$13,100	\$14,940	\$1,000		
Galápagos + Machu Picchu & The Land of the Inca – 16 days/15 nights – Page 20											
Departing Saturdays throughout the year	2018	\$13,020	\$13,980	\$14,860	\$15,440	\$17,550	\$18,060	\$19,510	\$1,500		
	2019*	\$13,440	\$14,540	\$15,480	\$16,040	\$18,240	\$18,680	\$20,280	\$1,500		
Holiday	Dec. 29, 2018	\$14,810	\$15,860	\$16,690	\$17,320	\$19,490	\$20,390	\$21,960	\$1,500		
	Dec. 14, 2019*	\$14,170	\$15,270	\$16,210	\$16,770	\$18,970	\$19,210	\$20,810	\$1,500		
	Dec. 28, 2019*	\$14,580	\$15,840	\$16,920	\$17,570	\$20,100	\$20,390	\$22,230	\$1,500		
Tropical Andes + Galápagos aboard <i>National Geographic Islander</i> – 14 days/13 nights – Page 20 (Please call for dates and rates)											
New! Wild Galápagos Escape – 7 days/6 nights – Page 26											
Nov. 24 & 29	2018	\$5,450	\$6,140	\$6,770	\$7,180	\$8,690	\$8,070	\$9,100	\$750	Galápagos flights included. International must be issued separately. Sample international airfares: round-trip Miami/Guayaquil: Economy \$500.	
Apr. 27; May 2, 11, 16; Aug. 31; Sep. 5, 14, 19; Oct. 31	2019*	\$5,630	\$6,420	\$7,090	\$7,490	\$9,060	\$8,370	\$9,520	\$750		
New! Wild Galápagos & Peru Escape – 9 days/8 nights – Page 27											
Dec. 1	2018	\$6,250	\$6,800	\$7,300	\$7,630	\$8,840	\$8,780	\$9,600	\$750	Galápagos flights included. International and internal Peru tickets must be issued separately. Sample international airfares: round-trip Miami/Lima/Guayaquil Economy \$500. Sample Lima/Cusco/Lima plus Lima/Guayaquil from \$935.	
May 4, 18; Sep. 7, 21; Nov. 2	2019*	\$6,470	\$7,100	\$7,630	\$7,950	\$9,210	\$9,110	\$10,030	\$750		

*Price valid through Oct. 31, 2018.



NATIONAL GEOGRAPHIC SEA BIRD AND NATIONAL GEOGRAPHIC SEA LION

CAPACITY: 31 outside-facing cabins accommodating 62 guests.

REGISTRY: United States. **OVERALL LENGTH:** 152 feet.

PUBLIC AREAS: Our twin sister ships feature a library; global market; lounge with full-service bar and facilities for films, slide shows and presentations; observation deck; partially covered sun deck with chairs and tables, and LEXspa. Our “open bridge” provides guests an opportunity to meet our officers and captain and learn about navigation.

MEALS: Served in single seatings with unassigned tables for an informal atmosphere and easy mingling. Breakfast is a wide selection buffet and lunch is often served family style. Menu emphasizes local fare.

CABINS: All face outside with windows, private facilities and climate controls.

EXPEDITION EQUIPMENT: Bow camera, hydrophone, kayaks, snorkeling gear, fleet of paddleboards, splash-cam, underwater video chronicler, ship’s doctor, wet suits in Baja and expedition landing craft.

SPECIAL FEATURES: Guest Internet access. A Lindblad-National Geographic certified photo instructor and a video chronicler are on board all voyages. A ship’s doctor is on board in Baja and Costa Rica/Panama. An undersea specialist is on board in Baja and Alaska.

WELLNESS: The vessel is staffed by a wellness specialist and features exercise equipment, LEXspa and outdoor stretching area.

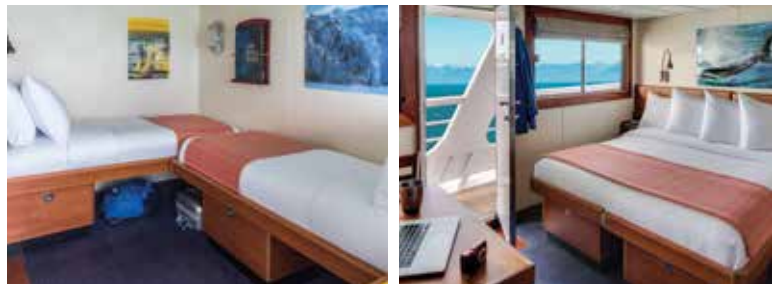

Insets clockwise from top: National Geographic Sea Bird can access hard to reach locations; lounge with expedition library and flatscreen TVs for vibrant presentations; twin beds can be pushed together to form a double bed in Category 3 cabins on the Upper Deck; a comfortable Category 2 cabin freshly redesigned.



Left to right: Spacious and comfortable lounge; morning yoga on the back deck; staff member serving signature cocktails in the bar.

CATEGORY 1: Main Deck #300-305—Conveniently positioned between the dining room & lounge, these cabins feature two single lower beds, and a large view window.

CATEGORY 2: Bridge Deck #100-104; Upper Deck #200-212, 215—These well-located cabins include two lower single beds & a view window.

CATEGORY 3: Bridge Deck #105, 106; Upper Deck #214, 216, 217, 219—These cabins feature a seating unit with table and two large view windows. Upper Deck cabins include two lower single beds which can convert to a double bed and a pull-out single bed for a third person; Bridge Deck cabins include two lower single beds only.

NOTE: Sole Occupancy cabins are available in Categories 1 and 2 only. Third person rates are available in certain categories at one half the double occupancy rate.

SHARED ACCOMMODATIONS: Shares can be arranged at the double occupancy rate in Categories 1 and 2 only.

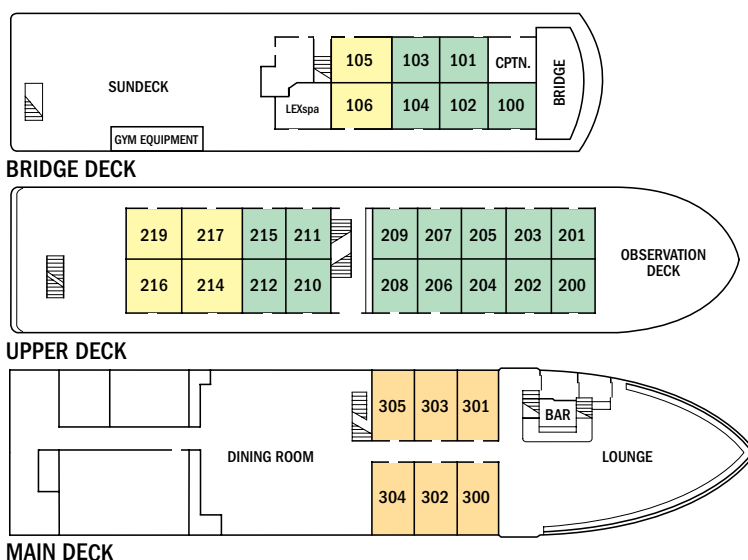

Prices are per person, double occupancy unless indicated as solo.

ITINERARY	YEAR	CAT. 1	CAT. 2	CAT. 3	CAT. 1 SOLO	CAT. 2 SOLO	ADVANCE PAYMENT	NOTE
Base Camp Channel Islands – Page 25	2018	\$2,490	\$3,050	\$3,490	\$3,740	\$4,590	\$750	We will gladly assist in making your air arrangements. Please call for airfares from your departure city.
Exploring British Columbia and the San Juan Islands – Page 42	2018	\$4,690	\$5,390	\$6,690	\$7,040	\$8,090	\$750	We will gladly assist in making your air arrangements. Please call for airfares from your departure city.



NATIONAL GEOGRAPHIC QUEST AND NATIONAL GEOGRAPHIC VENTURE

CAPACITY: 50 cabins accommodating 100 guests.
REGISTRY: United States. **OVERALL LENGTH:** 238 feet.

Sister ships *National Geographic Quest* and *National Geographic Venture* (launching 2018) will be the latest additions to our fleet. Designed with over 50 years of expedition heritage and built in the U.S.A., both ships will set a new standard in exploration and comfort.

PUBLIC AREAS: Global gallery; fitness center; LEXspa; lounge with full service bar and facilities for films and presentations; observation deck; mudroom with lockers for expedition gear, and a partially covered sundeck with chairs and tables. Our “open bridge” provides guests an opportunity to meet our officers and captain and learn about navigation.



MEALS: Served in single seatings with unassigned tables for an informal atmosphere and easy mingling. Breakfast and lunch are wide selection buffets with chef action stations, while dinners are primarily served plated. Menu emphasizes local fare.

CABINS: All cabins face outside with windows or portholes, private facilities and climate controls. Category 4 cabins have step-out balconies.

EXPEDITION EQUIPMENT: A fleet of 8 Zodiacs and 24 kayaks, Remotely Operated Vehicle (ROV), hydrophone, splash-cam, underwater video camera, video microscope, paddleboards, snorkeling gear for all guests (where applicable).

SPECIAL FEATURES: Guest internet access, elevator, Lindblad-National Geographic certified photo instructor, a video chronicler, ship's doctor and undersea specialist.

WELLNESS: The vessel is staffed by a Wellness Specialist and features a gym with an elliptical machine, treadmill, exercycles, handweights and resistance bands. Treatments in the LEXspa are available by appointment.



Insets top to bottom: The lounge, with 270° views, is the hub of the expedition community; a spacious and open sun deck will provide unparalleled views.



Left to right: Category 5 cabin is our most spacious; Category 4 cabin with lower single beds (which can be converted to a Queen) and a private step-out balcony. Select cabins connect via an inside doorway.

CATEGORY 1: Main Deck #301-306 Cabins feature two lower single beds that can convert to a Queen, a writing desk and two portholes.

CATEGORY 2: Main Deck #307-315 Cabins feature two lower single beds that can convert to a Queen, a writing desk and two portholes.

CATEGORY 3: Upper Deck #201-206 Cabins feature two lower single beds that can convert to a Queen, a writing desk and two large view windows.

CATEGORY 4: Upper Deck #207-229 Cabins feature two lower single beds that can convert to a Queen, a writing desk, sliding glass door, and small, private balcony.

CATEGORY 5 (SUITE): Observation Deck #101-108 Cabins feature two lower single beds that can convert to a Queen, large view windows, an expanded bathroom, writing desk, ample storage space, and a convertible sofa bed to accommodate a third person.

NOTE: Sole Occupancy cabins are available in Categories 1 and 2 only. Third person rates are available in Category 5 cabins at one half the double occupancy rate.

Connecting Cabins via internal doorway access: Main Deck: #312-314, #311-315, #306-308, #305-307; Upper Deck: #224-226, #225-227

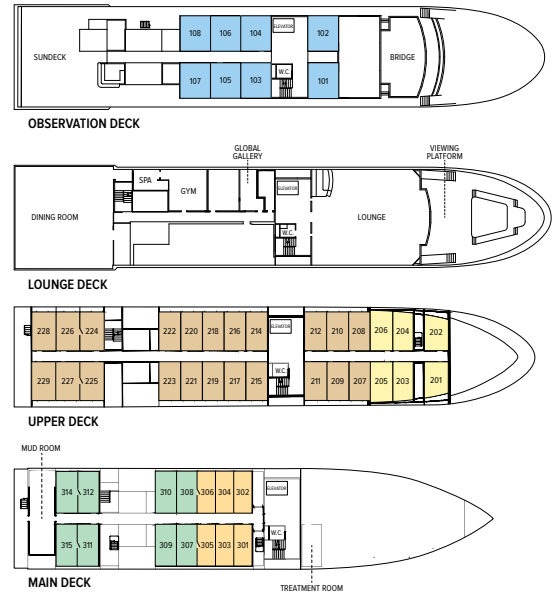

Prices are per person, double occupancy unless indicated as solo.

ITINERARY	YEAR	CAT. 1	CAT. 2	CAT. 3	CAT. 4	CAT. 5 SUITE	CAT. 1 SOLO	CAT. 2 SOLO	ADVANCE PAYMENT	NOTE
Costa Rica and the Panama Canal – Page 4	2018/19	\$5,990	\$6,590	\$6,990	\$7,790	\$8,690	\$8,990	\$9,890	\$750	Sample Airfares: Miami/Panama City, San José/Miami or vice versa: Economy from \$500; Business from \$1,200.
Monteverde Cloud Forest + Costa Rica to Panama – Page 6	2018/19	\$7,790	\$8,390	\$8,790	\$9,590	\$10,490	\$11,020	\$11,920	\$1,000	Sample Airfares: Miami/San José, Panama City/Miami Economy from \$500; Business from \$1,200.
Panama to Costa Rica + Monteverde, Arenal & Tortuguero – Page 6	2018/19	\$10,410	\$11,010	\$11,410	\$12,210	\$13,110	\$13,910	\$14,810	\$1,500	Sample Airfares: Miami/Panama City, San José/Miami: Economy from \$500; Business from \$1,200.
Belize to Tikal: Reefs, Rivers & Ruins of the Maya World – Page 8	2019	\$5,760	\$6,180	\$6,600	\$7,030	\$8,180	\$8,640	\$9,270	\$750	Sample Airfares: Miami/Guatemala City/Miami: Economy from \$475; Business from \$1,050. Charter airfare (Flores/Guatemala): \$275, subject to change.
Baja California and the Sea of Cortez: Among The Great Whales – Page 10	2019	\$7,530	\$8,330	\$8,900	\$9,930	\$10,960	\$11,290	\$12,490	\$1,000	Sample Airfares: Round-trip Los Angeles/Los Cabos/Los Angeles: Economy from \$370. Business from \$1,100.
Baja California: A Remarkable Journey – Page 12	2019	\$11,990	\$13,260	\$14,160	\$15,790	\$17,420	\$17,990	\$19,890	\$1,500	Sample Airfares: Round-trip Los Angeles/Los Cabos/Los Angeles: Economy from \$370. Business from \$1,100.
Base Camp Baja – 4 Nights – Page 24	2018/19	\$2,650	\$3,390	\$3,990	\$4,490	\$4,950	\$3,980	\$5,090	\$750	Sample Airfares: Round-trip Los Angeles/Los Cabos/Los Angeles: Economy from \$370. Business from \$1,098.
Exploring British Columbia and the San Juan Islands – Page 42	2019	\$4,990	\$5,690	\$6,190	\$6,990	\$7,790	\$7,490	\$8,540	\$750	We will gladly assist you in making your air arrangements. Please call for airfares from your departure city.
Columbia and Snake Rivers Journey: Harvests, History & Landscapes – Page 44	2018	\$4,890	\$5,690	\$6,650	\$7,390	\$8,190	\$7,340	\$8,540	\$750	We will gladly assist in making your air arrangements. Please call for airfares from your departure city.
	2019	\$4,940	\$5,750	\$6,720	\$7,460	\$8,270	\$7,410	\$8,630		

SEA CLOUD

CAPACITY: 58 guests in 30 cabins including two Owner's Suites.

REGISTRY: Malta. **OVERALL LENGTH:** 360 feet.

Built in 1931 by Wall Street businessman E. F. Hutton for his wife, Marjorie Merriweather Post, *Sea Cloud* carries 30 sails measuring a total of 32,000 sq. ft.

PUBLIC AREAS: The covered Lido Bar is a superb place to congregate and enjoy the outdoors. The open-air "Blue Lagoon" is a wonderful place to relax. There is a sumptuous lounge and guests are welcome on the "open bridge" to learn how *Sea Cloud* is navigated and sailed.

MEALS: Served in single seatings, meals focus on local and Continental cuisine. Wines are included at lunch and dinner. Refreshments are always available.

CABINS: The Main Deck cabins have antique and period-style furniture. These are the ship's original cabins, including the Owner's Suites originally occupied by E.F. Hutton and Marjorie Merriweather Post. Cabins on the Promenade and Captain's Decks offer modern, stylish, comfortable furniture.

CATEGORY 1 SOLO: #16-17: Upper and lower single beds and a porthole. These cabins once housed the ship's officers.

CATEGORY 1: #28-29: Cabins have two single beds, a window and showers.

CATEGORY 2: #18-25: Cabins have two single beds, a window and showers.

CATEGORY 3: #32-37: Cabins have two single beds (which can be pushed together to make a queen-size bed, with one side against the wall), a window and showers.

CATEGORY 4: #30-31: Cabins have a queen-size bed, a forward-facing window and showers.

ORIGINAL/DELUXE CATEGORY B: Original and deluxe cabins, #5, 6, 9, 10: Located on the Main Deck, these large cabins, originally occupied by guests (and the nannies, #9-10) of the owner, have a mix of bed types, decorative motifs, bathrooms with tub or shower. All have portholes.

ORIGINAL/DELUXE CATEGORY A: Original/deluxe cabins, #3, 4, 7, 8: Located on the Main Deck, these very large cabins, originally occupied by guests of the owner, have a mix of bed types, decorative motifs, bathrooms with bathtubs. All have portholes.

OWNER'S SUITES: Original owner's suites #1-2: These incomparable suites were occupied by Marjorie Merriweather Post (#1) and E.F. Hutton (#2). They have king-size beds and grand marble bathrooms with bathtubs.



Insets clockwise from top: *Sea Cloud* under full sail; Original/Deluxe Category A cabin; Owner's Suite which is one of the original cabins.

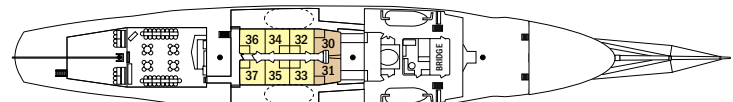

CAPTAIN'S AND LIDO DECK

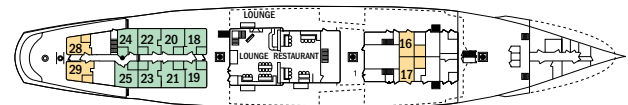

PROMENADE DECK

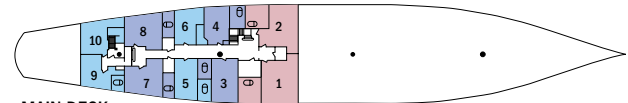

MAIN DECK

WITH COMPLIMENTS. YOUR BAR TAB AND ALL CREW GRATUITIES ARE INCLUDED.

Prices are per person, double occupancy unless indicated as solo.

ITINERARY	YEAR	CAT. 1	CAT. 2	CAT. 3	CAT. 4	ORIGINAL/DELUXE CAT. B	ORIGINAL/DELUXE CAT. A	OWNER'S SUITES	CAT. 1 SOLO	ADVANCE PAYMENT	NOTE
Sailing the Caribbean – Page 46	2019	\$8,730	\$9,980	\$12,090	\$12,610	\$14,130	\$14,890	\$17,170	\$13,100	\$1,000	Sample Airfares: Round-trip Miami/Barbados: Economy from \$220; Business from \$1,000.

JAHAN

CAPACITY: 48 guests in 24 outside cabins.
REGISTRY: Vietnam. **OVERALL LENGTH:** 230 feet.

PUBLIC AREAS: The ship is fully air-conditioned. Outdoor areas include the Terrace Deck, with both covered and open-air spaces, a small swimming pool, and a full service bar. The lounge, located on the Upper Deck, has a library and facilities for films, slide shows, and presentations. Guests are welcome on the “open bridge” to meet the captain and officers and learn about navigation.

CABINS: Every cabin is exceptionally spacious and comfortable. All face outside, and all have glass doors and private balconies for enjoying the scenery along the Mekong River and its tributaries. There is a mix of twin-bedded and queen-size bedded cabins. Each has private facilities and hair dryer, individual climate control, and a mini bar. A choice of pillows is provided on request.

SPECIAL FEATURES: There is a spa, offering a choice of massage treatments, and fitness room with steam bath and treadmill, stationary bicycle, and elliptical trainer. The boutique has a fine selection of local artwork and textiles. Morning Tai Chi classes are offered on the Terrace Deck. DVD and iPod players are available on request.

CATEGORY 1: Main Deck #103-112. Each of these large cabins has a private balcony with floor-to-ceiling glass doors that let in abundant light. Cabins 103-104 have twin beds (which can be pushed together on request), and #105-112 have queen-size beds.

CATEGORY 2: Upper Deck #201-208. Each of these large cabins has a private balcony with floor-to-ceiling glass doors that let in abundant light. Cabins 201-202 have twin beds (which can be pushed together on request), and 203-208 have queen-size beds.

CATEGORY 3: Main Deck #113-114 and Upper Deck #209-210. Each exceptionally large cabin has a queen-size bed and a private balcony with floor-to-ceiling glass doors that let in abundant light. There is a television and private DVD player. Each balcony has two sun beds and a table.

SUITES: Upper Deck #211-212. These are the largest and finest accommodations on board. Each has a queen-size bed, a private balcony with floor-to-ceiling glass doors that let in abundant light, a television, a DVD player, and a private Jacuzzi.



Insets clockwise from top: The new river ship Jahan; Category 2 cabin; Category 3 cabin.

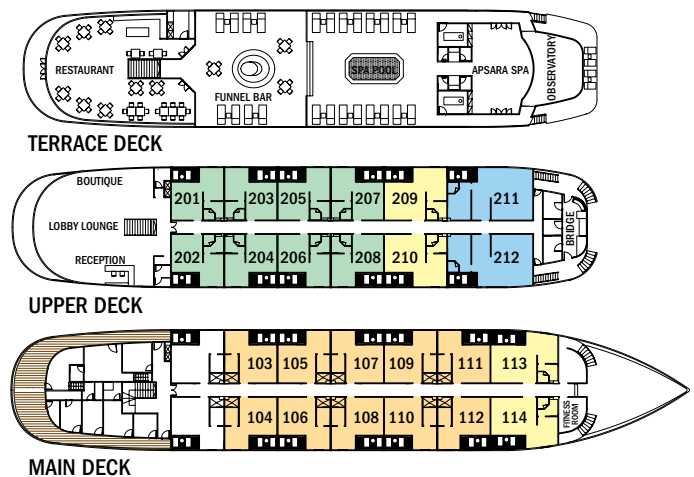

Prices are per person, double occupancy unless indicated as solo.

ITINERARY	YEAR	CAT. 1	CAT. 2	CAT. 3	SUITES	CAT. 1 SOLO	ADVANCE PAYMENT	NOTE
Vietnam and Cambodia: Along the Mekong River – Page 50	2019	\$11,190	\$12,030	\$14,130	\$16,910	\$16,790	\$1,500	Sample Airfares: U.S./Siem Reap, returning Saigon/U.S. or vice versa. Economy from \$950; Business from \$3,500.

DELFIN II

CAPACITY: 28 guests in 14 outside suites.
REGISTRY: Peru. **OVERALL LENGTH:** 120 feet.

PUBLIC AREAS: With sweeping views, public areas include an air-conditioned presentation room, open-air lounge and bar up top, and dining room with a 270-degree panorama. With a small library, exercise room and spa. Open bridge, where you are welcome to visit and watch the river go by.

MEALS: The air-conditioned dining room's large windows provide panoramic views. Beautifully prepared meals are served in a single seating with unassigned tables. Often special dishes will include sustainable products of the rain forest and sauces made with exotic regional fruits.

SUITES: Elegant, air-conditioned guest suites on the Main and Upper Decks all offer exceptional vistas. Each spacious suite has a minimalist décor with a luxurious overtone.

EXPEDITION EQUIPMENT: 10-person skiffs—with individual seat cushions and plenty of leg room. Fleet of safe, nimble kayaks for up-close, personal exploration. Rain ponchos are kept handy in the skiffs. Rubber boots are provided when needed.

SUITES: UPPER & MAIN DECK #1-6; 11-14 — Most suites have two twin beds which can convert to a king. Each includes a large view window, a closet, easy chair and desk. Bathrooms include a large shower, separate toilet and sink area. Suites 4/6 and 3/5 are available as interconnecting.

MASTER SUITES: UPPER & MAIN DECK #7, 8, 15, 16 — The Master Suites feature all of the amenities listed above plus oversized windows which provide incredible 90 degree views. The Master Suites on the Main Deck and Upper Deck feature two twin beds which can convert to a king.

SOLE OCCUPANCY & SHARED ACCOMMODATIONS: Due to the limited number of cabins available, sole occupancy and shares are on a request basis only; please call for availability and rates.



Insets clockwise from top left: Delfin II on the river; the dining room provides big views and outstanding cuisine; spacious suites offer comfort and panoramic views.

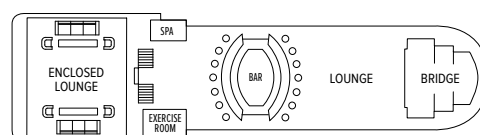

OBSERVATION DECK

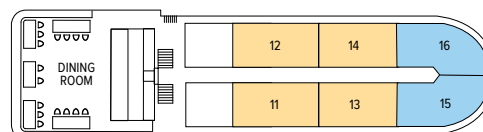

UPPER DECK

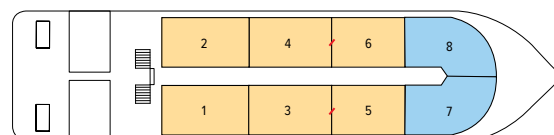

MAIN DECK

red arrow indicates adjoining cabins

Prices are per person, double occupancy.

ITINERARY	YEAR	SUITE	MASTER SUITE	ADVANCE PAYMENT	NOTE
Upper Amazon: Exploring Peru's Pacaya-Samiria Reserve – Pages 18-19					
Upper Amazon: Exploring Peru's Pacaya-Samiria Reserve	2018	\$6,990	\$8,260	\$750	International and internal Peru tickets must be issued separately for all Amazon voyages. Sample International Airfares: Round-trip Miami/Lima/Miami: Economy from \$530; Business from \$1,200. Sample Internal Airfare: Lima/Iquitos/Lima: From \$440.
	2019	\$7,190	\$8,590	\$750	
Upper Amazon: Exploring Peru's Pacaya-Samiria Reserve Dec. 29, 2018	2018	\$7,680	\$8,690	\$1,000	
Machu Picchu and Peru's Land of the Inca + Upper Amazon – Page 21					
Upper Amazon + Machu Picchu and Peru's Land of the Inca	2018	\$12,680	\$13,950	\$1,500	International and internal Peru tickets must be issued separately for all Amazon voyages. Sample International Airfares: Round-trip Miami/Lima/Miami: Economy from \$530; Business from \$1,200. Sample Internal Airfare: Lima/Cusco/Lima: From \$435. Lima/Iquitos/Lima From \$440.
	2019	\$12,880	\$14,280	\$1,500	
Upper Amazon + Machu Picchu and Peru's Land of the Inca Holiday: Dec 22, 2018	2018	\$14,100	\$16,490	\$1,500	
Galápagos + Upper Amazon – Page 21	2018 2019	Back-to-back expeditions combining Galápagos + Upper Amazon are available on a number of 2018-2019 dates. Please call for rates.			

WHY HURRY HOME? CONTINUE THE ADVENTURE

Explore more facets of these fascinating regions before or after your voyage. Call or visit our website for solo pricing, day-by-day itineraries, and more.



EASTER ISLAND

**POST-VOYAGE:
4 DAYS/4 NIGHTS**

2018/19*: \$4,390 per person, double occupancy

Add it on: Antarctica; Antarctica, South Georgia, and the Falklands; Epic Patagonia: Fjords, Peaks, and Forests; and Best of Chilean Patagonia

More info at [expeditions.com/antarcticaext](https://www.expeditions.com/antarcticaext)



HANOI, HALONG BAY, HOI AN, AND HUE

**POST-VOYAGE:
2 DAYS/1 NIGHT**

2019*: \$6,390 per person, double occupancy

Add it on: Vietnam and Cambodia

More info at [expeditions.com/vietnamext](https://www.expeditions.com/vietnamext)



SANTIAGO CITY, WINE & CULINARY HIGHLIGHTS

**PRE-VOYAGE:
2 DAYS/2 NIGHTS**

2018/19*: \$1,990 per person, double occupancy

Add it on: Antarctica; Antarctica, South Georgia, and the Falklands; and Epic Patagonia: Fjords, Peaks, and Forests

More info at [expeditions.com/antarcticaext](https://www.expeditions.com/antarcticaext)



IGUAZÚ FALLS

**POST-VOYAGE:
3 DAYS/3 NIGHTS**

2018/19*: \$2,790 per person, double occupancy

Add it on: Antarctica; Antarctica, South Georgia, and the Falklands; and Epic Patagonia: Fjords, Peaks, and Forests

More info at [expeditions.com/antarcticaext](https://www.expeditions.com/antarcticaext)



BUENOS AIRES

**PRE-VOYAGE:
2 DAYS/2 NIGHTS**

2018/19*: \$1,890 per person, double occupancy

Add it on: Antarctica; Antarctica, South Georgia, and the Falklands; and South Georgia and the Falklands

More info at [expeditions.com/antarcticaext](https://www.expeditions.com/antarcticaext)



ANTIGUA, GUATEMALA CITY

**POST-VOYAGE:
2 DAYS/2 NIGHTS**

2019*: \$750 per person, double occupancy

Add it on: Belize to Tikal

More info at [expeditions.com/antigua](https://www.expeditions.com/antigua)



PORTLAND, WILLAMETTE VALLEY

**PRE- OR POST-VOYAGE:
2 DAYS/1 NIGHT**

2018/19*: Call or visit our website for pricing

Add it on: Columbia and Snake Rivers Journey

More info at [expeditions.com/portland](https://www.expeditions.com/portland)

*Airfare is not included on all extensions.

TAKE ADVANTAGE OF OUR SPECIAL OFFERS

SPECIAL OFFERS—BOOK BY OCT. 31, 2018: Offers are available on select departures, and based on availability at the time of booking. On voyages with complimentary air offers, airfare is based on economy group flights that must be ticketed by Lindblad Expeditions. In the case that Lindblad's group or charter flights are no longer available at time of booking, we reserve the right to issue a credit. All offers are valid for new bookings only, subject to availability at the time of booking, and may not be combined with other offers and pre- and post-extensions. Call for details.

WITH COMPLIMENTS: We will cover your bar tab and tips to the ship's crew on all departures aboard *National Geographic Explorer*, *National Geographic Orion*, and *Sea Cloud*.

GALÁPAGOS 2019—BAR TAB AND WIFI INCLUDED: Travel aboard any 2019 *National Geographic Islander* or *National Geographic Endeavour II* voyage and we will cover your bar tab. Complimentary bar offer excludes certain premium brands of alcohol. Also, enjoy free WiFi, up to one hour a day per person aboard any 2019 *National Geographic Islander* and *National Geographic Endeavour II* departure. Visit our website or call for details.

INCLUSIVE PRICING

We include just about everything you have the opportunity to do as part of your expedition aboard ship and ashore. The only things not included are those of a personal nature—alcohol*, internet usage, tips to the crew*, wellness treatments, and other specialized arrangements.

ABOARD SHIP

- ✓ All meals and non-alcoholic beverages*
- ✓ Cappuccinos, lattes & complimentary refillable water bottle
- ✓ 24-hour coffee, tea & soda on demand
- ✓ Hors d'oeuvres & snacks during lounge recap
- ✓ Sauna
- ✓ Fitness center
- ✓ Fully stocked library
- ✓ The guidance and company of our expedition staff

ASHORE

- ✓ Meals on land, as indicated in itinerary
- ✓ Special access permits, park fees, port taxes
- ✓ Transfers to and from group flights
- ✓ The expertise of our expedition staff

ACTIVITIES

- ✓ All excursions
- ✓ Zodiac & kayak explorations
- ✓ Snorkeling and paddleboarding (where indicated)
- ✓ Lectures & presentations in the lounge

Note: Amenities vary across fleet, and are provided where applicable.

**All departures aboard Explorer, Orion, Sea Cloud, and starting in 2019 Endeavour II and Islander include alcoholic beverages aboard ship (excepting certain super-premium brands of alcohol). Departures aboard Explorer, Orion, and Sea Cloud also include tips to the ship's crew.*

BRINGING THE KIDS: We believe sharing an expedition with your kids or grandkids is a life-enhancing experience. So take \$500 off for each child under the age of 18.

BACK-TO-BACK SAVINGS: Save 10% on any consecutive journeys taken on board our expedition ships. This savings is applicable on voyage fares only, and are not valid on extensions or airfare.

TRAVELING AS A GROUP: Save 5% when traveling as a group of 8 or more people. Take advantage of these great savings, while enjoying traveling with your friends and family. This savings is applicable to voyage fares only, and is not valid on extensions or airfare. Deposit, final payments, and cancellation policies for group travel vary from our regular policies.

COMBINING OFFERS: Certain offers may be combinable, up to two savings opportunities except where noted otherwise. For example, travel with a group of 8 or more on back-to-back expeditions, and take advantage of both savings!

BE PART OF OUR EXPEDITION COMMUNITY

Join in! Here's how:

- ✓ Check our daily blog for interesting posts, video clips and Photos of The Week: expeditions.com/blog
- ✓ Like us on Facebook: hear what our travelers have to say, get inspired and chime in: facebook.com/LindbladExpeditions
- ✓ Preview an expedition before you go or subscribe to our videos on youtube.com/lindbladexpeditions
- ✓ Follow us @LindbladExp and our founder, Sven Lindblad @SvenLEX, on Twitter; and on Instagram @SOLindblad for his interesting view of the world.
- ✓ Check out Expedition Snapshots from guests—and upload your own on the expeditions.com homepage.



Photo Credits: Tobias Bernhard, Marc Cappelletti, David Cothran, Stewart Cohen, Karnnapus Dangsakol, Jennifer Davidson, Danita Delimont, Matthew Williams-Ellis, Kyle Furey, Bill Gozansky, Andrey Gudkov, Eric Guth, Erinn Hartman, Ralph Lee Hopkins, Jonathan Irish, Jonathan Kingston, Bob Krist, Rich Lindie, Sven-Olof Lindblad, Jeff Litton, Michael Manning, John Michaels, Luciano Mortula, Juan Carlos Muñoz, Steve Murray, Michael S. Nolan, Charles O'Rear, Douglas Peebles, Kseniya Ragozina, Ryder Redfield, Rich Reid, Marco Ricca, Jacob Riglin, Tui De Roy, Kevin Schafer, Christian Schoissinger, Ian Shive, David Spiegel, Rikki Swenson, David Tipling, David Vargas, Dirk Weyer, Ariadne Van Zandbergen, Jarno Gonzalez Zarraonandia

RESERVATION INFO

Costs Include: All accommodations aboard ships or in hotels per itinerary or similar, all meals and non-alcoholic beverages* aboard ship, meals on land as indicated, air transportation where indicated as included, shore excursions, sightseeing and entrance fees, special access permits, transfers to and from group flights, use of snorkeling equipment and wetsuits (where applicable), use of kayaks and/or stand-up paddleboards (where available), use of cross-country skis or snowshoes (where available), tips (except to ship's crew*), taxes and service charges, services of a ship physician on most voyages, and services of our expedition staff. Note: Unused services or items included in our program are non-refundable. *All departures aboard *National Geographic Explorer*, *National Geographic Orion*, and *Sea Cloud* include alcoholic beverages aboard ship (excepting certain super-premium brands of alcohol) and tips to the ship's crew.

Not Included: Air transportation (except where shown as included), extensions, passport, visa, immigration fees, scuba diving (where available), meals not indicated, travel protection plan, items of a personal nature, such as alcoholic beverages*, internet access, voyage DVD (where available) and laundry. Gratuities* to ship's crew are at your discretion. Note: *All departures aboard *Explorer*, *Orion*, and *Sea Cloud* include alcoholic beverages aboard ship (excepting certain super-premium brands of alcohol) and tips to the ship's crew.

Airfare: For all programs, airfare is an additional cost unless otherwise indicated. Sample airfares are subject to change. We will gladly assist in making your air arrangements for a \$50 per person service fee.

TERMS & CONDITIONS

Reservations: To reserve your place, an advance payment is required at the time of reservation. The per person advance payment amount varies by program, and is outlined in our brochures, as well as on our website. Holiday departure dates and certain longer voyages may carry additional advance deposit requirements due to high demand for these voyages. Payment is accepted by Visa, MasterCard, American Express, Discover, or by check.

Receipt of your initial payment indicates your acceptance of our complete Terms and Conditions. We require written notice at the time of reservation for any physical condition, diet, or treatment requiring special attention.

Once your reservation is confirmed, we urge you to use your personalized online account for important information to help you prepare for your voyage. Managing your documents online will facilitate fast and accurate communication, and allow you to provide us with pertinent details we require, in order to complete your reservation. Your online account gives you access to your Expedition Guide, which includes valuable information specific to your voyage. You can also use your online account to make easy payments, view recommended flights and reading material, packing list, and so much more.

Final Payment: For expeditions aboard all ships with the exception of *Explorer* and *Orion*, final payment is due 90 days prior to departure. For expeditions aboard *Explorer* and *Orion*, payment is due 120 days prior to departure.

Payment schedules may vary for Holiday departures and certain longer voyages, due to high demand for these voyages. We reserve the right to cancel your reservation if payment has not been received by final payment due date.

Travel Protection Plan: We recommend that you take advantage of our Travel Protection Plan. This plan offers comprehensive coverage to protect you from cancellation fees, costs incurred due to trip delays/interruption, damaged or lost luggage, medical assistance, and evacuation during your travels. Our Travel Protection Plan is available for U.S. and Canadian residents only, and may be purchased any time prior to final payment due date. If you are not satisfied for any reason, you may return your plan within 10 days after purchase. Your premium will be refunded if canceled within 10 days, provided you have not already departed on the trip or filed a claim. When so returned, the coverage under the plan is void from the original date of purchase.

Smoking Policy: Smoking is allowed only in designated outdoor areas.

Entry and Visa Requirements: All guests are advised to verify travel documents (passport/transit visa/entry visa) for the country through which they are transiting and/or entering. Reliable and most current information regarding international travel can be found by contacting the consulate/embassy of the country(s) you are visiting or transiting through. We will not be responsible if you are denied entry or transit into a country if you are unable to provide valid documents as per the country's requirement.

Responsibility and Other Terms & Conditions: Certain other provisions concerning, among other things, limitations of Lindblad Expeditions' and the National Geographic Society's liability for loss of property, injury, illness or death during the voyage will be provided to all guests on the ship's ticket sent prior to departure, and are also available on our website at www.expeditions.com/terms, or upon request. By registering for a trip, the guest agrees to all such terms and conditions.

Note: Itineraries and prices listed in this brochure are valid as of publication date, and are subject to change. Under normal conditions, the total expedition cost is guaranteed at the time of booking. However, the published price is determined far in advance of initial departure on the basis of then-existing projections of fuel and other costs. In the event we determine that current costs create an unsustainable financial model, including but not limited to increases in the price of fuel, currency fluctuations, increases in government taxes or levies, or increased security costs, we reserve the right to pass on these costs to you, to cover such unexpected increases. We will always provide a transparent accounting of the reason for such an increase in costs.

CANCELLATION POLICY

FOR EXPEDITIONS ON ALL SHIPS WITH THE EXCEPTION OF *ORION* & *EXPLORER*

Number of Days Prior to Expedition Start	Per Person Cancellation Fee
120 or more days	\$350*
119-90 days	Advance payment cost
89-60 days	25% of total fare
59-45 days	50% of total fare
44-0 days	No refund

FOR EXPEDITIONS ABOARD *ORION* & *EXPLORER*

Number of Days Prior to Expedition Start	Per Person Cancellation Fee
180 or more days	\$750*
179-120 days	Advance payment cost
119-90 days	25% of total fare
89-60 days	50% of total fare
59-0 days	No Refund

*\$350 or \$750 will be refunded in the form of a Lindblad Expeditions Travel Certificate.

This cancellation policy applies to expeditions, extensions (with the exception of Denali), as well as all other additional services. The effective date of a cancellation will be the date on which your cancellation notice is received. Any revisions you make within the cancellation penalty period, such as departure date or choice of voyage, are subject to cancellation fees.

Note: Airline cancellation policies vary by carrier, as well as the type of fare used to issue your ticket.

Cancellation policy for certain longer voyages and Holiday departures may vary due to high demand for these voyages. Our group cancellation and Denali cancellation policies are listed in the Terms and Conditions section of our website, or you may call us for details. We stress the importance of purchasing a travel protection plan to protect yourself from fees in the event you need to cancel your reservation.

United States Tour Operators Association \$1 Million Travelers Assistance Program



Lindblad Expeditions, as an Active Member of USTOA, is required to post \$1 Million with USTOA to be used to reimburse, in accordance with the terms and conditions of the USTOA \$1 Million Travelers Assistance Program, the advance payments of Lindblad Expeditions customers in the unlikely event of Lindblad Expeditions bankruptcy, insolvency or cessation of business. Further, you should understand that the \$1 Million posted by Lindblad Expeditions may be sufficient to provide only a partial recovery of the advance payments received by Lindblad Expeditions. More details of the USTOA Travelers Assistance Program may be obtained by writing to USTOA at 345 Seventh Avenue, Suite 1801, New York, New York 10001, or by email to information@ustoa.com or by visiting their website at www.USTOA.com.

We are proud to be a Founding Member of Adventure Collection—a family of the world's most trusted and experienced active travel companies. Each member company of Adventure Collection is dedicated to enriching the lives of its guests and to giving back to the areas in which it travels. For more information visit www.AdventureCollection.com.



©2018 Lindblad Expeditions

Lindblad Expeditions and the Eye are the trademarks of Lindblad Expeditions. All rights reserved.

NATIONAL GEOGRAPHIC and the Yellow Border are the trademarks of the National Geographic Society. All rights reserved.

For a list of Lindblad Expeditions' selected honors and awards, go to WWW.EXPEDITIONS.COM/AWARDS

For Reservations:

Contact your travel advisor or Lindblad Expeditions

1.800.EXPEDITION (1.800.397.3348)

Reservation Hours: Monday – Friday 9am – 10pm ET

Saturday & Sunday 10am – 5pm ET

Lindblad Expeditions, Inc., 96 Morton Street, New York, NY 10014

Phone: 212.261.9000 • Fax: 212.265.3770

email: explore@expeditions.com For additional information and online reservations, visit us on the Web: www.expeditions.com



96 Morton Street
New York, NY 10014

PRSR STD
U.S. POSTAGE
PAID
LINDBLAD
EXPEDITIONS

Account Number:

Expedition Code:

1.800.EXPEDITION | WWW.EXPEDITIONS.COM

♻️ Printed on 10% recycled content paper with soy-based inks. We recommend that you pass this along for others to enjoy or recycle.

FWE-068

HOLIDAY GETAWAYS

SOME DATES STILL AVAILABLE | BOOK NOW!

HAPPY HOLIDAYS IN ANTARCTICA
FREE AIR & MORE: SEE INSIDE

OR FELIZ NAVIDAD IN
COSTA RICA, GALÁPAGOS
OR BAJA
OFFER ON EACH: SEE INSIDE

