

WILD, STRANGE & WONDERFUL GALÁPAGOS

FIFTY YEARS IN GALÁPAGOS AND YOU

GET EVERYTHING IT HAS TO OFFER
FREE AIR TOO

CELEBRATING

50 YEARS

ABOARD NATIONAL GEOGRAPHIC ISLANDER AND
NATIONAL GEOGRAPHIC ENDEAVOUR II | 2017-18



SVEN OLOF-LINDBLAD

A LETTER TO TRAVELERS ►



In 1967, I landed on South Plaza Island in the Galápagos Islands with no idea what to really expect.

As we anchored our boat, there was a cacophony of sounds emanating from the island—raucous bird cries and melodic barking, if there is such a thing.



With almost uncontrollable excitement, we boarded our dinghy to go ashore. The landing was covered with sea lions who rose up to stare at us as if they had never before seen a human. They barked enthusiastically, and some hurled themselves into the water surrounding our craft, leaping, twisting in the water in what seemed like intense glee.

Later, I would learn that indeed these sea lions had seen very few, if any, humans. And their display of curiosity made that conclusion undeniable.

As we explored the island, we were immediately struck by one powerful observation: Not a single creature displayed even the slightest hint of fear as we walked by. Boobies on nests simply stared at us as we passed within a few feet; land iguanas just kept eating their cactus fruit. The sea lions, particularly the young ones, tried to approach us to investigate the new creatures.

It was enthralling beyond description, beautiful, exciting and, on many occasions, just downright comical.

This was clearly paradise for anyone who enjoys the company of wild animals going about their business.

Since that first landing, I have returned 50 or so times

as a boat driver, a naturalist, an expedition leader, a conservation partner, and as someone who has come to feel a strong bond with this most special place—not only with its animals, but with the people and institutions that in one form or another create a living and purpose through protecting this world jewel.

So I suppose it could be said that, for us as a company and for me as an individual, Galápagos is not simply a business but a deep-rooted relationship built over five decades.



However, what matters most now is: what does this mean for you as an individual or with your spouse, family, or friends?

First of all, it is worth noting that the sites themselves that you may visit have not really changed very much in 50 years. 95% of the land mass is still national park. The animals are still fearless and each new generation of sea lions is still as curious and boisterous as the generation before them.

Now back to you. What I have discovered over the years is that people come in very different ways. Way more families travel at certain times of year; couples, groups of friends and solo travelers throughout the year. It's a place for the ages and all ages. I was there most recently in June. There was a 93-year-old, spritely grandmother who had four generations with her. There was a three-generation family who brought along a toddler who, by the way, became everyone's favorite guest.



There was a young couple from India who had become fascinated with Galápagos in high school, learning about Darwin's theories. And a delightful couple in their 70s who had come from New Zealand, had been here before and longed to return.

By the third day it felt like we were all family heading off each day in different directions and reconvening each evening to share our stories.

This recognition of difference when it comes to how you wish to conduct your day with an ever-evolving common bond is a remarkable tonic.

We have learned that pace, emphasis, and a diversity of opportunity matters a great deal to people. Some want to move more slowly on land, some with greater pace. Some want to focus on photography, some want to spend as much time as possible snorkeling. Others want to kayak or use our paddleboards. And some want to do it all.

What will appear seamless to most is actually quite complicated, requiring a robust staff to support the activity, including naturalists, LEX/NG photo instructors, an expedition leader, someone who films the undersea and presents what's down there, and a video chronicler to document the time. The staff is paired with a team of navigators, chefs, laundrymen and all manner of people to serve your every need.

This entire community is totally dedicated to your welfare and fully understands that this is their total priority. Many have been with us for decades and are a kind of extended family.



These bonds and their tenures matter a great deal. You will undoubtedly be surprised when the barman instantly knows on day two how you like your drink without needing to ask. The ladies who clean your room (which, by the way, is done three times a day) learn to know where you like things. The bridge is always open to you if you're interested in navigation, and the officers are delighted to respond to your curiosity.

When it comes to kids, Ecuadorians are culturally very family-oriented and go out of their way to ensure they have a good time while not hesitating to remind them of the rules the captain lays down for safety.

When we are in the town of Puerto Ayora where we visit the Charles Darwin Research Station and the highlands, there are noticeable smiles from people recognizing you come from our ships. We have, over the years, together with extraordinary participation by our guests, supported a wide array of important work, whether it be for the CDRS, or for financing and training community entrepreneurs, to funding scholarships at a unique school dedicated to a curriculum for future leadership in the islands.

We believe in them and they in us, and often you'll see some of them come aboard during the evening in the community to share insights of their work.

Our naturalists are, I believe, the finest teams in the islands. Part of what we do for them is support individual development. We have regular gatherings with them to hone skills. We offer training at National Geographic headquarters to certify them as photo instructors and Field Educators. And they have the opportunity to join us in other geographies periodically, either as naturalists or simply as a benefit to broaden their horizons. So don't be



surprised if your naturalist starts talking to you over a drink about their time in Antarctica or the wildlife of the Amazon or the architecture of Angkor Wat.

I believe the essence of experience is multifaceted. It manifests itself in large and small ways but ultimately is rooted in the concept of humanity and achieving shared goals.

Everyone who operates in the Galápagos has access to the same geography. What's done about it differs wildly.

I am not a great believer in the word 'best', as that is of course a matter of opinion. What I can tell you without reservation is that I do not believe any other organization is as thoughtful as we are. And that this is a personal quest in many ways. My father brought me here in 1967. I have brought my kids here on numerous occasions. And now my daughter is working for the summer at the school I referred to earlier, as Galápagos has become her favorite place on earth. I suspect it could become yours, too.

All the best,



Sven-Olof Lindblad



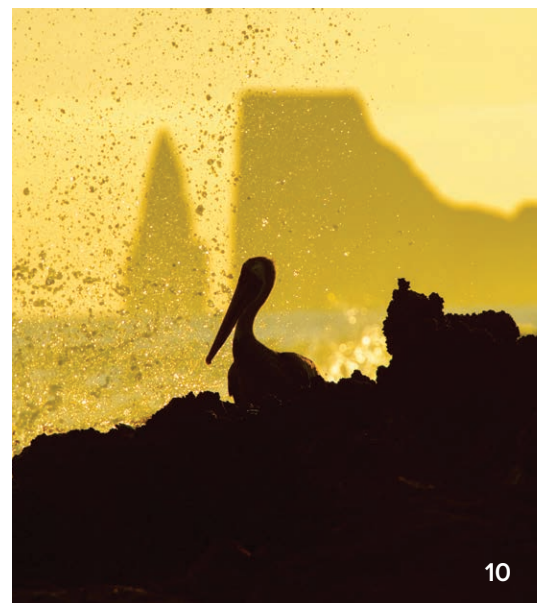

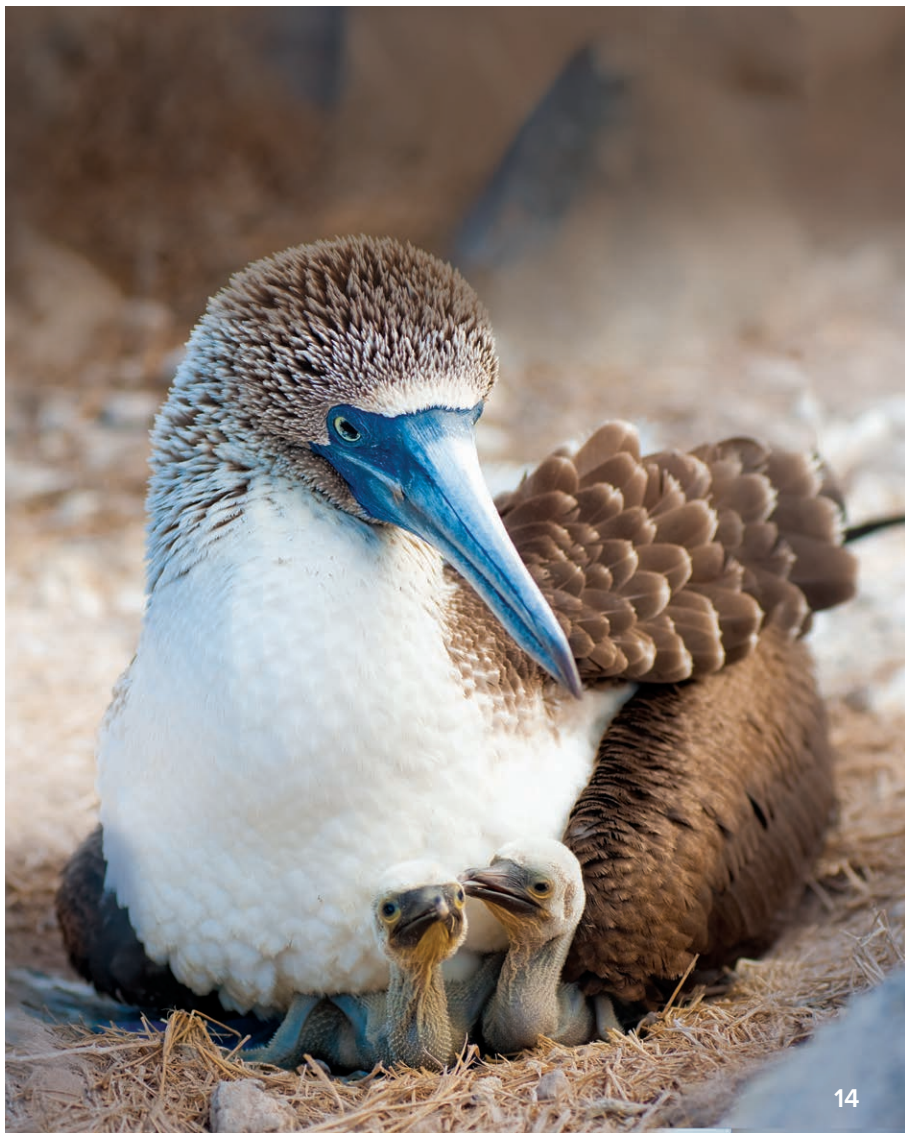



50 YEARS OF EXPLORING & PR

Ever since Lars-Eric Lindblad led the first international tourist expedition to Galápagos in 1967, we've introduced generations of guests to these strange and wonderful islands. Our unrivalled knowledge of, passion for, and personal connection to Galápagos guarantees you a deeply rewarding experience.

Because Galápagos is always in season *National Geographic Islander* and *National Geographic Endeavour II* sail weekly, year-round. You can schedule your expedition when it's the right time for you, certain that it will be the right time in Galápagos.

Clockwise from top left: guests landing at Isla Bartolomé, circa 1970; Lars-Eric on deck; our conservation commitment deepened in 2004 with the Lindblad Expeditions-National Geographic alliance; Sven and his daughter Isabella in the islands; heading ashore at Bartolomé, unchanged all these years later.





ESERVING IN GALÁPAGOS

And if traveling with a company that's committed to the preservation of the places it explores is important to you, you'll be happy to know that our commitment to Galápagos is long-standing. Lars-Eric Lindblad supported Galápagos conservation from the beginning—volunteering in 1968 to pay the salaries of the first wardens of the new Galápagos National Park. In the intervening years, together with our guests, we've raised more than \$7.8 million for local projects that will help protect Galápagos for generations to come. These initiatives include eradicating introduced mammals, a first-ever for any large oceanic island, tracking giant tortoises, rehabilitating sea turtles, and many more.

▶ INTERESTED IN GALÁPAGOS CONSERVATION HISTORY? FIND THE COMPLETE CHRONOLOGY AT [EXPEDITIONS.COM/GALA50](https://www.nationalgeographic.com/expeditions/gala50)

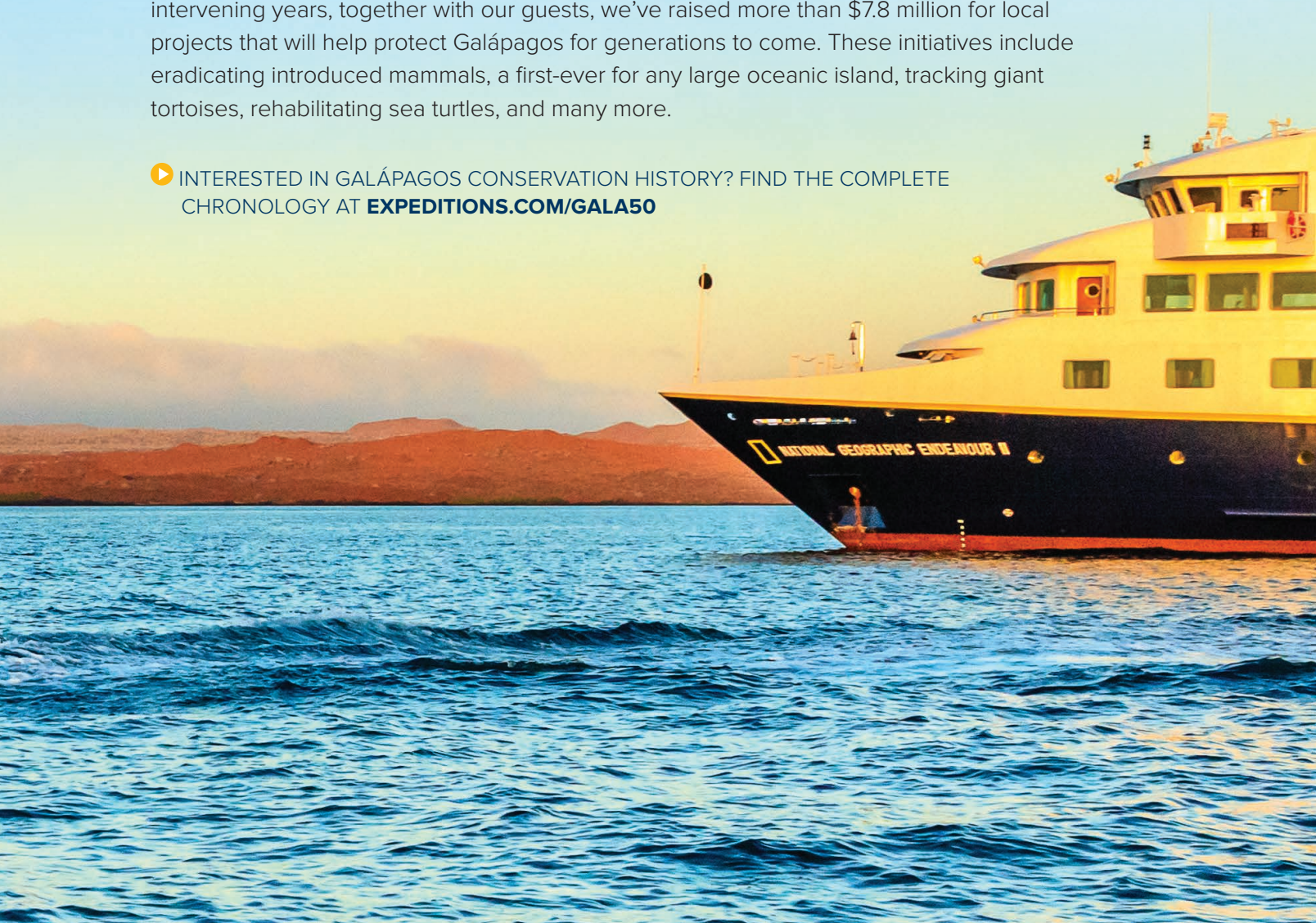

EVERY DAY IS FILLED WITH ADVENTURE

The kind of flexibility and daily choice we offer, plus an expedition team dedicated to making the most of your time, curiosity and interests, is why exploring Galápagos with us is so engaging and enriching. Each day you can choose from an array of activities, activity levels, and staff members to join. Swim, snorkel, and Zodiac cruise. Take an energetic hike into an island's interior, or a meandering photo walk along the shore. Explore on a paddleboard or in a kayak. Or just relax in a lounge chair on deck, or with a wellness treatment.





▶ SEE WHAT A DAY IN GALÁPAGOS LOOKS LIKE AT [EXPEDITIONS.COM/EXPERIENCE](https://www.expeditions.com/experience)

Clockwise from top left: explore by kayak; encounter a rare whale shark; Jeremy Lindblad (middle) tempted by photographic opportunities; learn from the most experienced naturalist team; snorkel with green turtles.



ENCOUNTER FASCINATING WIL

Sea lions, sea turtles, penguins, tons of fish, multiple shark species, and even blue-footed boobies plunge-diving for dinner. The photos shown here, many shot by Sven Lindblad on expedition this past June, show how exhilarating the Galápagos undersea is—thanks to nutrient-rich waters and effective conservation. Galápagos was designated the first-ever UNESCO World Heritage site in 1978; in 2001, the Galápagos Marine Reserve was included in the World Heritage site designation; and in 2016 the marine reserve was greatly extended.



And it's all yours to explore: our ships are equipped with complete snorkel gear for all, including shorty wetsuits, yours for the duration of the expedition. And you'll have plenty of opportunity to use your gear—we offer a daily, and sometimes twice daily, snorkeling option, in diverse spots within the archipelago for fresh discoveries.

Prefer to stay dry? No worries, *National Geographic Endeavour II* is equipped with a glass-bottom boat. Or let our undersea specialists be your 'eyes.' During the voyage, they snorkel, shoot video, and present it on the Lounge's TV screens during evening Recap for all to enjoy.



DLIFE IN GALÁPAGOS



NEW! SCUBA DIVING FOR EXPERIENCED DIVERS

We recommend it highly—for those with intermediate and advanced experience. Our dive option is at additional cost, by advance reservation only, available on select *National Geographic Endeavour II* departures. Operated with an experienced local dive shop licensed by the park, our Scuba colleagues provide equipment, transportation by dive boat and experienced dive masters with the program coordinated by your expedition leader aboard. Call an Expedition Specialist for details, diving rates, and departure dates.



From top left: green turtle close up; playful sea lions; a group of snorkelers; diver photographing undersea.

SHARE THE ADVENTURE WITH AN EXCEPTIONAL EXPEDITION TEAM

No matter where your interests lie, or how you like to explore, chances are, you'll find members of our diverse team that match your style. Many of our naturalists were born and bred in the Galápagos Islands, and others moved to the islands from the mainland or other countries decades ago. Each has a deep understanding of Galápagos' natural and human history, and are experts in relevant areas: ornithology, geology, zoology, and the undersea. Hand-picked and Lindblad-trained, many of them also have traveled and worked with Lindblad in other parts of the world's great natural history destinations, bringing a global perspective to their Galápagos expertise.



*Clockwise from top left:
Carlos Romero, Jason
Heilmann, Paula Tagle,
Jonathan Aguas, Juan
Carlos Avila.*



LINDBLAD EXPEDITIONS' NATURALISTS ARE CERTIFIED NATIONAL GEOGRAPHIC FIELD EDUCATORS

▶ MEET THE TEAM AT [EXPEDITIONS.COM/GALATEAM](https://www.expeditions.com/galateam)

AND GIVE KIDS THE CHANCE TO BECOME A NATIONAL GEOGRAPHIC GLOBAL EXPLORER

Developed in conjunction with National Geographic Education, our unique exploration-based program is designed to develop the skills, attitudes, and mindset of an explorer. Kids and teens can engage in a variety of cool activities—guided by naturalists who are National Geographic-certified Field Educators. From recording wildlife sightings in their Field Notebook to collecting and observing plankton, each activity is adapted for their age. Along the way, they'll collect 'points' to become a National Geographic Global Explorer—with the certification to prove it! Kids can choose to participate in some or all—leaving time for families to explore together and connect.

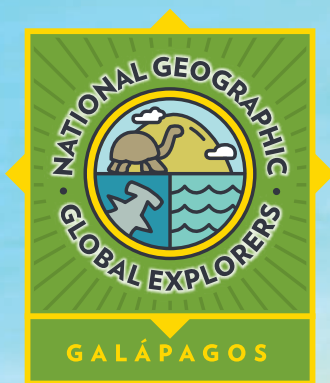

CHOOSE TO SHARE AN EXPEDITION WITH YOUR KIDS
OR GRANDKIDS, AND TAKE **\$500 OFF** PER CHILD
SEE PAGE 24 FOR DETAILS

▶ VISIT [EXPEDITIONS.COM/FAMILY](https://www.expeditions.com/family) TO LEARN MORE

AND BENEFIT FROM OUR EXCLUSIVE PHOTO PROGRAM

Lindblad-National Geographic certified photo instructors are on every Galápagos departure—to assist you with camera settings, composition basics and useful tips. Because each is also a naturalist, they'll teach you about the wildlife so you can learn to anticipate behaviors that make for great photos. Smart phone, point & shoot camera and DSLR users will find themselves developing their observation skills, and taking home their best photos ever.



LEARN WITH NAT GEO PHOTOGRAPHERS ON SELECT 2018 EXPEDITIONS



RAINFOREST, ANDES & ISLANDS PHOTO EXPEDITION: ECUADOR & PERU

Ralph Lee Hopkins leads a photo expedition packed with a full curriculum of mind-expanding photo ops in 3 locations: Quito & Mashpi Ecuador; Galápagos; and Machu Picchu & Peru's Land of the Inca. **May 7** (Mashpi Pre); **May 11** (Galápagos); **May 19** (Peru Post), **2018**



NAT GEO PHOTOGRAPHER JAY DICKMAN

Travel with this Pulitzer-prize winning photographer, veteran National Geographic magazine contributor, and diver aboard *Endeavour II*, **Nov. 23 & 30, 2018**.



FIRST-EVER VIDEO EXPEDITION

National Geographic emerging explorer, popular expedition leader, and a principal filmmaker on the groundbreaking *Planet Earth II*, Sandesh Kadur, joins *Endeavour II*, **Jun. 1 & 9, 2018**.



Photographing a Galapagos giant tortoise in the highlands.

CONNECT WITH INTERESTING PEOPLE

When you travel with us you're a part of something larger. And, there's always something interesting going on. Here are some specific examples and dates:



SUSAN LINDEE

Penn historian of science and acclaimed One Day University professor explores Darwin's life-changing visit to Galapagos, ideas and legacy, aboard *National Geographic Endeavour II*, **Nov 3, 2017**.



JAMES GIBBS

Leading tortoise biologist and co-leader of the Giant Tortoise Restoration Initiative joins *National Geographic Islander* for two voyages with expedition leader Lynn Fowler, **Nov. 25 & Dec. 2, 2017**.



MIKE JACKSON

Popular naturalist and author (*Galapagos: A Natural History*) joins the expert team aboard *Endeavour II*, **Dec. 8, 2017**.

DON'T MISS OUT—A FEW CABINS LEFT ON OUR 2017 PHOTO EXPEDITION

Top underwater photographer **Brian Skerry** plus six A+ National Geographic Photographers head out on **Nov. 24 & Dec. 1, 2017** departures—or stay aboard for the full 17-day expedition. Be there!

▶ VISIT EXPEDITIONS.COM/PHOTO TO LEARN MORE





Clockwise from top left: readying the dining room; Ecuadorian food presented with international flair; manager hotel operations Ana Esteves; Kicker Rock at sunset; enjoying a quiet moment in the library.



OUR SHIPS: EACH IS INTEGRAL TO YOUR GALÁPAGOS BLISS

For many ship operators in Galápagos, the ship is the main event. For us, our ships are tools, focused on enabling you to get out and explore the islands' many wonders. That said, as you'll discover, life aboard is pretty wonderful—on *National Geographic Islander*, our 48-guest yacht-scaled, mahogany-and-brass ode to the elegant maritime tradition; and on our 96-guest *National Geographic Endeavour II*, newly refitted and equipped for 21st century expedition travel. Count on expansive decks that let you savor the sea, stars, and wildlife sightings that make ship travel so remarkable. Enjoy welcoming public spaces, and gracious dining rooms with no assigned seating for easy mingling. Onboard libraries that cater to your curiosity and your need to tuck up with a good book. Wellness spas and treatments to restore mind and body. And cossetting cabins for perfect endings to your active, inspiring days.



“We are working with Lava Java, a local farm in the highlands of Santa Cruz Island, with an incredibly resilient vertical organic agriculture that uses less water, and has a self-composting system. They grow some of the lettuce we serve aboard our ships, and the chilies, cacao, flat leaf kale, heirloom cherry tomatoes, cilantro, basil and other herbs, as well. In the very near future, we will be able to offer the first-ever farm-to-table dining in Galápagos. Eliminating the importing of produce helps protect the islands against invasive species. In addition, it contributes to creating local jobs, and to the economic growth of the local farmers.”

—Ana Esteves, Manager Hotel Operations, Lindblad Expeditions

GALÁPAGOS

10 DAYS/9 NIGHTS—ABOARD *NATIONAL GEOGRAPHIC ENDEAVOUR II*, AND *NATIONAL GEOGRAPHIC ISLANDER*

DATES: 2017 & 2018: Expeditions depart Fridays on the *National Geographic Endeavour II* and Saturdays on the *National Geographic Islander*.

PRICES FROM: \$6,960 to \$15,400 (See pages 21 and 23 for complete prices.)

• 50th ANNIVERSARY YEAR - FREE ROUND-TRIP AIR

Nearly every departure from Aug. 18–Dec. 9, 2017 aboard both *National Geographic Endeavour II* and *National Geographic Islander* includes free round-trip air from Miami to Ecuador and on to Galápagos. Plus, free air on select 2018 departures through May—more than 50 departure dates to choose!

• MAKE THE MOST OF YOUR TIME & SAVE

Combine your Galápagos expedition with either a trip to Machu Picchu & Peru's Land of the Inca (page 16) or a voyage to the Upper Amazon (page 17) and receive free round-trip air for the entire program, including your flights in Peru, on select 2017-18 departures. Plus, save 10% when you combine your Galápagos voyage with an Upper Amazon voyage.

• TAKE THE KIDS & SAVE \$500

Share the wonder with kids or grand-kids under 18 and take \$500 off the double occupancy rate per kid.

See page 24 or call for offer details.

EXPEDITION HIGHLIGHTS

- ▶ Snorkel amid shimmering fish, sea turtles, penguins, and playful sea lions
- ▶ Walk among colonies of wildlife and birds unfazed by your presence
- ▶ Observe giant Galápagos tortoises in the wild
- ▶ Explore the waters of the Galápagos by kayak, glass-bottom boat, Zodiac, or paddleboard

EXPERIENCE & EXPERTISE

50
YEARS
EXPERIENCE

We're celebrating 50 years of exploring Galápagos. We've introduced generations of travelers to its magic and mystery. We're committed to Galápagos; and have raised millions, along with our guests, for its conservation. And we're fully invested, too; we operate two ships based there year round. An expedition leader, our team of naturalists, a Lindblad-National Geographic certified photo instructor, undersea specialist, wellness specialist, and video chronicler all contribute to your experience of the wonders of Galápagos.

Visit our website to read staff bios.

Blue-footed boobies.



DAY 1: U.S./GUAYAQUIL, ECUADOR
Depart for Guayaquil and upon arrival, transfer to the Hotel Hilton Colón.

DAY 2: GUAYAQUIL/GALÁPAGOS
This morning, fly to the Galápagos Islands and board *National Geographic Endeavour II* or *National Geographic Islander*. After lunch, we begin our exploration of the islands and their diverse wildlife. (B,L,D)

DAYS 3–8: EXPLORING THE GALÁPAGOS
Listed below is a sample of the islands we may visit during our expedition.* (B,L,D Daily)

ISLA BARTOLOMÉ

Walk to the top of Bartolomé's volcanic cone for a stunning view of Pinnacle Rock and the surrounding golden sand beaches. After the hike, immerse yourself among schools of multicolored reef fish. You may also have the opportunity to swim with Galápagos penguins.

ISLA SANTIAGO

Follow a path along a series of tide pools and underwater caverns in search of Galápagos fur seals, marine iguanas, sea lions, shore birds and Sally Lightfoot crabs.

ISLA SANTA CRUZ

Santa Cruz is home to the Charles Darwin Research station; learn about the science done here and visit the neighboring captive breeding program for endangered species of Galápagos giant tortoises, by their partners in conservation, the Galápagos National Park Service. Later, travel into the highlands where wild tortoises forage, to observe and photograph these tortoises in the wild.

ISLA ISABELA

Explore the largest island in the group, home to enormous marine iguanas, abundant sea turtles, the only species of flightless cormorant in the world, and the only penguin species that inhabits the equator. Cruise by Zodiac and hike against the backdrop of giant shield volcanoes, and snorkel in the cool, rich waters that often draw whales and dolphins to the area.

ISLA FLOREANA

At Champion Islet, snorkel among sea lions, or peer into an underwater world in a

glass-bottom boat or Zodiac while keeping an eye out for the endangered Floreana mockingbird. Those interested can visit Post Office Bay, founded by whalers in the 18th century—if you see a letter addressed to someone who lives near you, the tradition is to deliver it by hand.



Up-close encounter with a tortoise.

ISLA FERNANDINA

Discover the marine iguana haven of Punta Espinoza as we hike over lava flows. Galápagos hawks, sea lion nurseries and the rare Galápagos flightless cormorant will be found as we explore this island.

ISLA ESPAÑOLA

See swallow-tailed gulls, Española mockingbirds, boobies, and, seasonally, waved albatross on this birder's paradise. Walk among vivid green and red marine iguanas and unique lava lizards, and observe sea lions up close on a pristine white-sand beach.

DAY 9: GALÁPAGOS/GUAYAQUIL

After breakfast, disembark the ship and fly to Guayaquil. The evening is at your leisure at the Hotel Hilton Colón. (B)

DAY 10: GUAYAQUIL/U.S.

Depart Guayaquil this morning, arriving home the same day. (B)

**Please note: All ship itineraries are subject to Galápagos National Park regulations. Our expeditions, which sail between Isla San Cristobal and Isla Baltra include Isla Santa Cruz and a hand-picked selection of these and other visitor sites.*



EXPEDITION DETAILS

DATES: 2017 & 2018: Expeditions depart Fridays on *National Geographic Endeavour II* and Saturdays on *National Geographic Islander*.

SPECIAL OFFERS:

- Book by **December 31, 2017** on select 2017 departures for **FREE ROUND-TRIP** economy group airfare from Miami to Galápagos; ask about other U.S. gateways. Upgrade to business class to Guayaquil for \$500 on select dates (space available). See page 24 or call for details.
- Combine your Galápagos expedition with an Upper Amazon voyage and **SAVE 10%**.

EXTEND YOUR ADVENTURE

Combine your Galápagos expedition with **Machu Picchu & Peru's Land of the Inca** or the **Upper Amazon**. See page 16-17 for details.

OPTIONAL EXTENSION—NEW

Experience Ecuador's fantastic culture, landscapes and wild nature on a six-day **Tropical Andes & Colonial Quito** adventure, featuring Mashpi Lodge, a National Geographic Unique Lodge of the World. See page 18-19 for details.

EPIC GALÁPAGOS PHOTO EXPEDITION



Join our largest team of National Geographic photographers ever on an exclusive photo expedition, departing Nov. 24 & Dec. 1, 2017. Award-winning

National Geographic fellow **Brian Skerry** (pictured) will add the entirely new element of undersea photography, and a scuba option will be offered. Come for the first or second week, or join the full 17-day epic expedition, with exclusive excursions, at a 10% discount.

Learn more at expeditions.com/galaphoto.

GALÁPAGOS + MACHU PICCHU & PERU'S LAND OF THE INCA

16 DAYS/15 NIGHTS—ABOARD *NATIONAL GEOGRAPHIC ENDEAVOUR II* AND *NATIONAL GEOGRAPHIC ISLANDER*

PRICES FROM: \$12,650 to \$21,960 (See pages 21 and 23 for complete prices.)

EXPEDITION HIGHLIGHTS

- ▶ Walk and snorkel among the abundant and fearless wildlife of Galápagos
- ▶ See daybreak over the ruins at Machu Picchu from the fabled Sun Gate
- ▶ Discover Cusco's varied influences and visit the Sacred Valley of the Inca

DAYS 1-8: AS PER GALÁPAGOS ITINERARY ON PAGES 14-15.



DAY 9: GALÁPAGOS/GUAYAQUIL/LIMA, PERU

Depart Galápagos this morning and fly to Lima, Peru via Guayaquil, arriving in the evening. Overnight at the comfortable and conveniently located Wyndham Costa del Sol Lima Airport Hotel. (B,L)

DAY 10: LIMA/CUSCO/SACRED VALLEY OF THE INCA

Fly to Cusco then drive to Moray, a stunning Inca site believed to have been an agricultural laboratory where Incan priests would test soils and crops. Lunch at Parador Moray, overlooking the ruins. En route to the hotel, walk through a typical local market before an optional visit to the pottery studio Pablo Seminario, featuring ceramics made with ancient Peruvian techniques and designs. Check into Sol y Luna Hotel. (B,L,D)

DAY 11: SACRED VALLEY OF THE INCA

Visit the massive Inca stone fortress of Ollantaytambo. Lunch is at Casa Orihuela, a

working, family-owned hacienda, then visit the family's private museum. See a Peruvian Paso horse demonstration, with Marinera dancers and live music. Attend a traditional weaving demonstration by National Geographic grantee Nilda Callañaupa. After dinner at the hotel, see a folkloric dance performance. (B,L,D)

DAY 12: SACRED VALLEY/MACHU PICCHU

Enjoy the views from the valley to Machu Picchu via train with large picture windows. Spend the day exploring Machu Picchu's extraordinary structures with your guide. Overnight at the historic 31-room Belmond Sanctuary Lodge set next to the archaeological site. (B,L,D)

DAY 13: MACHU PICCHU/CUSCO

Hike to the Sun Gate this morning, the ancient final checkpoint to Machu Picchu, and watch daybreak over the sacred ruins. Explore Machu Picchu on your own or with your guide. After lunch return to Cusco and check into the Belmond Monasterio, beautifully situated in the center, for two nights. Check into the Belmond Monasterio Hotel for two nights. (B,L,D)

DAY 14: CUSCO

Explore the Inca Empire's capital city of Cusco and visit the magnificent 17th-century cathedral and convent of Koricancha, and the vast Sacsayhuaman fortress, a UNESCO World Heritage site. This afternoon is at leisure to discover the city. Dinner is on your own. (B,L)

Cusco Cathedral.



DAY 15: CUSCO/LIMA

Return to Lima and visit the Larco Museum and stroll the Plaza Mayor. Lunch is in traditional Latin American style. Experience the music of the Andes at a presentation of indigenous instruments. Dinner is on your own. Overnight at the Belmond Miraflores Park Hotel. (B,L)

DAY 16: LIMA/U.S.

After breakfast, transfer to the airport for your flight home. (B)

EXPEDITION DETAILS

DATE: Year-round, weekly departures following Galápagos aboard *National Geographic Endeavour II* and *National Geographic Islander*.

NATIONAL GEOGRAPHIC EXPERT

Gain insights from National Geographic historian **Peter Frost** (or a colleague) on our Machu Picchu & Peru's Land of the Inca departures.

SPECIAL OFFERS:

Book by December 31, 2017 on select 2017 and 2018 dates for **FREE ROUNDTRIP** economy group airfare from Miami to Galápagos/Lima plus flights to Cusco (up to \$2,100 value); ask about other U.S. gateways. Upgrade to business class to Guayaquil on select dates for \$500 (space available). See page 24 or call for details.

GALÁPAGOS + UPPER AMAZON

18 DAYS/17 NIGHTS—ABOARD NATIONAL GEOGRAPHIC ENDEAVOUR II AND DELFIN II

PRICES FROM: \$13,950 to \$24,090 (Call for dates and pricing.)

EXPEDITION HIGHLIGHTS

- ▶ Walk and snorkel among the abundant, iconic Galápagos wildlife that is unfazed by your presence
- ▶ Hike pristine islands, kayak their peaceful shorelines, and explore the Galápagos undersea
- ▶ In the Amazon, discover an entirely different kind of biodiversity—macaws, monkeys, sloths, and more, plus meet the *ribereños*—inhabitants of the jungle we explore

DAYS 1-8: PER GALÁPAGOS ITINERARY ON PAGES 14-15.

DAY 9: GALÁPAGOS/GUAYAQUIL/LIMA, PERU

Depart Galápagos this morning and fly to Lima, Peru via Guayaquil, arriving in the evening. Overnight at the conveniently located Wyndham Costa del Sol Lima Airport Hotel. (B,L)

DAY 10: LIMA/IQUITOS/NAUTA/EMBARK

Enjoy a morning tour of Lima, then fly to Iquitos and continue overland to the riverside village of Nauta, where the *Delfin II* awaits. Settle into your cabin, and gather for a welcome dinner of fine Peruvian cuisine on board. Tonight, step out on deck to gaze at the magnificent Amazon night sky. (B,L,D)

DAYS 11-16: PACAYA-SAMIRIA NATIONAL RESERVE

Spend this week exploring the Pacaya-Samiria National Reserve, a pristine swath



Blue and yellow macaw in flight.

of jungle—one of the largest in South America—stretching more than five million acres, and harboring some of the Amazon's most fascinating flora and fauna. Bordered by the Marañón and the Ucayali, two powerful rivers that converge to create the famed Amazon, which floods annually with nutrient-rich waters.

Set out into this remarkable wilderness on daily excursions by skiff, kayak, and, when the water level permits, hikes on terra firma. Skim past giant lily pads afloat on black-water lakes, and venture deep into the rain forest on narrow tributaries. Spot sloths and monkeys, including variably colored saddleback tamarins, noisy howlers, and shaggy-tailed monk saki monkeys. Watch for an astounding variety of birds, from tanagers and hummingbirds to parrots and endangered scarlet macaws. In the river, look for massive *paiche* fish, the Amazon's largest.

Enjoy an opportunity to swim in a lake in the reserve's interior. Go on a bird-watching hike, listening for the vocal oropendola and then look for its telltale yellow tail. Watch the sun set and listen to a cacophonous symphony of nocturnal animals calling out across the treetops. Then slip through the forest in a skiff as night falls, using a spotlight to find caimans, frogs, fishing bats and other creatures of the night.

Pay a visit to communities on the reserve's



Explore aboard the intimate, 28-guest Delfin II.

edge, and meet the Amazon *ribereños* in their dugout canoes, and in their stilt-home villages. One of the unexpected joys of this region is our interaction with local people. Engage with women, men, and youth eager to share their community improvement projects, many of them supported by the Lindblad-National Geographic Fund and our local partner, Minga Peru. (B,L,D)

DAY 17: NAUTA/IQUITOS/LIMA

This morning, disembark in Nauta, and return to Iquitos overland for an afternoon flight to Lima, and overnight at the Wyndham Costa del Sol Lima Airport Hotel. (B,L)

DAY 18: LIMA/U.S.

After breakfast, transfer to the airport for your flight home. (B)

SPECIAL OFFERS:

Book by December 31, 2017 on select dates for **FREE ROUND-TRIP** economy group airfare from Miami to Galápagos/Lima, plus flights to Iquitos (up to \$2,100 value); ask about other U.S. gateways. Upgrade to business class to Guayaquil for \$500 on select dates. See page 24 for details.

SAVE 10% on combinations of **Upper Amazon + Galápagos** or **Upper Amazon + Machu Picchu & Peru's Land of the Inca**.



CELEBRATING
50
YEARS

MAKE THINGS EVEN
MORE INTERESTING

MASHPI, A NATIONAL GEOGRAPHIC UNIQUE LODGE OF THE WORLD

To celebrate our 50th Anniversary we're offering a new pre-voyage extension, **Tropical Andes & Colonial Quito**, on select departures of both *National Geographic Islander* and *National Geographic Endeavour II*. Experience Ecuador's fantastic culture, landscapes and wild nature on a six-day adventure, including a stay in both colonial Quito, a UNESCO World Heritage site, and the spectacularly diverse Ecuadorian Chocó, one of the world's top five biodiversity hotspots. Log on or call an Expedition Specialist for details.

 FIND INFO AT [EXPEDITIONS.COM/MASHPI](https://www.nationalgeographic.com/expeditions/mashpi)



NEW PRE-VOYAGE EXTENSION

TROPICAL ANDES & COLONIAL QUITO

6 DAYS/5 NIGHTS

PRICES FROM \$2,190 to \$3,690

DAY 1: U.S./QUITO, ECUADOR

Fly to Quito, where we are met by our guide, and transfer to Casa Gangotena on Plaza San Francisco.

DAY 2: QUITO

Tour the dazzling churches and monuments of old town—largest and best preserved colonial center in the Americas—and visit a revitalized traditional market with a local non-profit. Take the afternoon to relax or explore on your own before a welcome dinner at the award-winning Restaurant Cedrón at Casa Gangotena. (B, D)

DAY 3: THE ANDES/MASHPI

Journey 70 miles north across the Equator through dramatic Andean valleys to Mashpi Lodge, set in tropical forest at 3,000 feet. After check-in and lunch, join resident naturalists on a nature walk. (B, L, D)

DAY 4: MASHPI

We have the day to explore, where options and excursions arranged for us include a ride across the canopy in the aerial tram or innovative sky-bike, naturalist-led walks to waterfalls on well-constructed trails, a visit to the hummingbird feeders, and butterfly farm and the life center. Birds like endemic mountain tanagers, trogons, motmots, hummingbirds flock around the lodge verandas, and the surrounding forest is spectacular. Keep an eye open for the Chocó toucan, one of dozens of spectacular bird species endemic to this bio-region. The bird list tops 400 species. (B, L, D)

DAY 5: MASHPI/QUITO

Return to Casa Gangotena after a second morning to explore. Dinner and the rest of the evening is at leisure in Quito to prepare for our upcoming adventures in Galápagos. (B, L)

DAY 6: QUITO/GALÁPAGOS/EMBARK

Early this morning, transfer to the airport for the flight to Guayaquil and on to Galápagos with fellow travelers. (B)

Clockwise from top left: Mashpi is a true wilderness retreat, set on 3,200 acres of tropical forest; The Chocó toucan is just one of many spectacular endemic birds; the aerial tram brings you close to nature; wall-to-wall windows are throughout the lodge.





NATIONAL GEOGRAPHIC ISLANDER

YACHT-SCALED AND TRIM, OFFERING EXPEDITION AMENITIES FOR JUST 48 GUESTS

CAPACITY: 48 guests in 24 outside cabins.

REGISTRY: Ecuador. **OVERALL LENGTH:** 164 feet.

PUBLIC AREAS: Open-air observation deck, second covered outside deck with hammocks, tables and chairs. Lounge and bar accommodating all guests for presentations and gatherings, dining room, library, Mac kiosks and Internet. The captain and officers welcome guests to visit the open bridge.

MEALS: Served in a single, unassigned seating in a sociable, informal atmosphere with Ecuadorian flair.

CABINS: All have a window with an outside view, private facilities, ample storage and climate controls. Bed can be configured as two twins or as a single queen.

EXPEDITION EQUIPMENT: Zodiacs, a fleet of kayaks and paddleboards, snorkel gear and wet suits for both adults and children, video microscope and underwater video camera.

SPECIAL FEATURES: Shipboard doctor, Lindblad-National Geographic certified photo instructor, video chronicler, snorkel instruction. Wi-Fi access, laundry service, National Geographic Global Explorer family program, Global Gallery.

WELLNESS: New LEXspa and fitness center, exercise classes, and wellness specialist.



Clockwise from top: National Geographic Islander anchors close to shore; spacious and comfortable lounge; library; relaxing on the covered stern deck.



Category 4 cabin; Category 5 cabin.

CATEGORY 1: Main Deck, Forward #201-206

CATEGORY 2: Main Deck #207-210

CATEGORY 3: Bridge Deck #303-306. Cabins 305 and 306 can accommodate a third person with sofa bed.

CATEGORY 4: Upper Deck #403-408—with outside, glassed-in terraces with windowed door and seating.

CATEGORY 5: Upper Deck, #401 and 402—forward facing with additional seating, desk, wrap-around windows, glassed-in terrace with seating. Largest cabins aboard.

NOTE: All cabins offer two twin beds that can be converted to a queen. Sole occupancy in categories 1 and 2 only. Third person rates for cabins 305 and 306 are one-half per person double occupancy rate.

SHARED ACCOMMODATIONS: Shares can be arranged at the double occupancy rate in Categories 1 and 2 only.

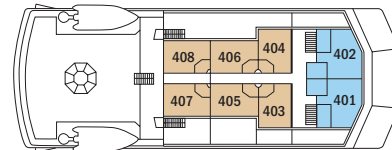

UPPER DECK

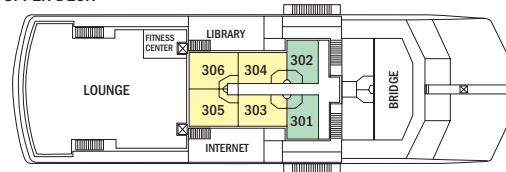

BRIDGE DECK

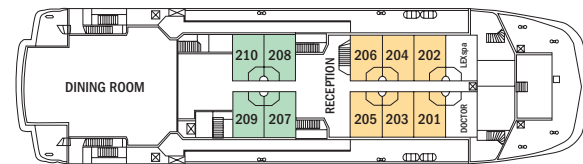

MAIN DECK

Prices are per person, double occupancy unless indicated as solo.

ITINERARY	CAT. 1	CAT. 2	CAT. 3	CAT. 4	CAT. 5	CAT. 1 SOLO	CAT. 2 SOLO	ADVANCE PAYMENT	NOTE	
2017/18 Galápagos: Aboard <i>National Geographic Islander</i> – 10 days/9 nights – Page 14										
Departing Saturdays throughout the year	\$7,330	\$8,290	\$9,170	\$9,750	\$11,860	\$10,990	\$12,440	\$750	International and internal Ecuador tickets must be issued separately for all Galápagos voyages. Sample International Airfares: round-trip Miami/Guayaquil: Economy from \$500; Business from \$1,050. Sample Internal Airfares: Guayaquil/Galápagos: Adult from \$520 Children (Under 12) from \$260. Call for sample Peru airfare.	
Holiday: Dec. 30, 2017; Dec. 22 & 29, 2018	\$8,390	\$9,440	\$10,270	\$10,900	\$13,070	\$12,590	\$14,160	\$1,000		
2017/18 Galápagos + Machu Picchu & The Land Of The Inca – 16 days/15 nights – Page 16										
Departing Saturdays throughout the year	\$13,020	\$13,980	\$14,860	\$15,440	\$17,550	\$18,060	\$19,510	\$1,500		
Holiday: Dec. 23, 2017; Dec. 22, 2018	\$14,810	\$15,860	\$16,690	\$17,320	\$19,490	\$20,390	\$21,960	\$1,500		

NEW SHIP



NATIONAL GEOGRAPHIC ENDEAVOUR II

OUR NEWEST SHIP IN GALÁPAGOS,
OFFERING EXPEDITION AMENITIES FOR 96 GUESTS

CAPACITY: 96 guests in 52 outside cabins.
REGISTRY: Ecuador. **OVERALL LENGTH:** 236 feet.

PUBLIC AREAS: New forward lounge and bar accommodating all guests for presentations and gatherings, restaurant, large library with Mac kiosks, open-air observation deck, underwater gear area and dual Zodiac boarding platform, and open bridge, where guests can meet the captain and officers and learn about navigation. Ship refitted for Galápagos in 2016.

MEALS: Served in a single, unassigned seating in a sociable, informal atmosphere with Ecuadorian flair.

CABINS: All face outside with large windows, and feature twin beds that convert to a queen. With private facilities and climate control, nightstands, desk, and storage. Seven sets of cabins with a connecting door.

EXPEDITION EQUIPMENT: Nine Zodiacs, glass-bottom boat, kayaks and paddleboards, snorkel gear and wet suits for both adults and children, video microscope and underwater video camera.

SPECIAL FEATURES: Shipboard doctor, Lindblad-National Geographic certified photo instructor, video chronicler, National Geographic Global Explorer family program, snorkel instruction. Wi-Fi access, laundry service, Global Gallery.

WELLNESS: New LEXSpa and fitness center, exercise classes, and wellness specialist.

Clockwise from top: National Geographic Endeavour II features 52 cabins accommodating 96 guests; gym; Category 4 cabin; Suite C.



CATEGORY 1: Upper Deck, Forward #201, 202

CATEGORY 2: Upper Deck #211, 213-219, 221, 222, 224-229

CATEGORY 3: Lounge Deck #311, 313-319, 321, 322, 324, 326, 328, 330

CATEGORY 4: Bridge Deck #409, 411-414, 416, 418

SUITE A: Lounge Deck, Mid-Ship #320—with two windows, larger bath, arm chair. Connecting door to #322.

SUITE B: Bridge Deck, Mid-Ship #420, 422—with two floor-to-ceiling windows, larger bath, convertible sofa for a third person.

SUITE C: Bridge Deck, Mid-Ship #415—with two large windows, larger bath, separate sitting area with convertible sofa for a third person and arm chairs, largest cabin on ship.

CATEGORY 2 SOLO: Upper Deck #203-209—with a queen bed.

CATEGORY 3 SOLO: Lounge Deck #325, 327—with a queen bed.

NOTE: All cabins feature the option of two twins or a queen bed, plus large window(s), desk, chair, and closet.

CONNECTING CABINS: #226/228, 227/229, 315/317, 316/318, 320/322, 411/413, 416/418

TRIPLE OCCUPANCY: #224, 225, 326, 328 with fold-down upper third bunk, Suites B and C with convertible sofa bed. Third person rates are one-half per person double occupancy rate.

SHARED ACCOMMODATIONS: Shares can be arranged at the double occupancy rate in Categories 1 and 2.

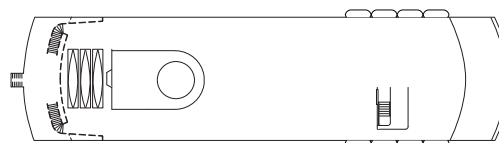

OBSERVATION DECK

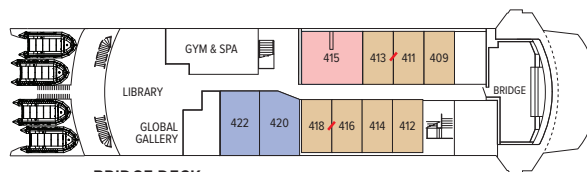

BRIDGE DECK

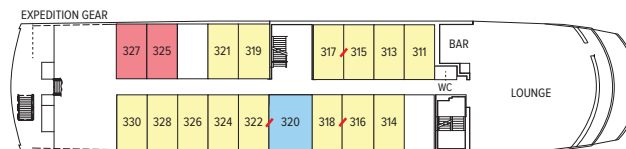

LOUNGE DECK

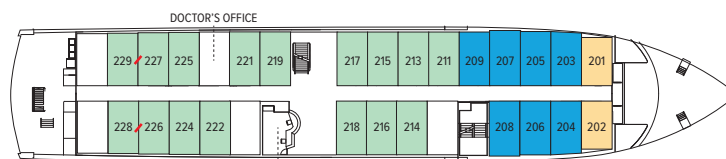

UPPER DECK

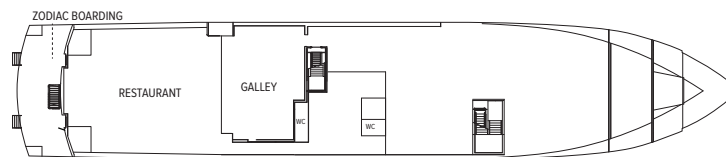

MAIN DECK

↗ indicates adjoining cabins

Prices are per person, double occupancy unless indicated as solo.

ITINERARY		CAT. 1	CAT. 2	CAT. 3	CAT. 4	SUITE A	SUITE B	SUITE C	CAT. 2 SOLO	CAT. 3 SOLO	ADVANCE PAYMENT	NOTE	
2017/18 Galápagos: Aboard <i>National Geographic Endeavour II</i> – 10 days/9 nights – Page 14													
Departing Fridays throughout the year	2017	\$6,960	\$7,940	\$8,740	\$9,590	\$11,440	\$12,280	\$12,980	\$9,930	\$10,930	\$750	International and internal Ecuador tickets must be issued separately for all Galápagos voyages. Sample International Airfares: round-trip Miami/Guayaquil: Economy from \$500; Business from \$1,050. Sample Internal Airfares: Guayaquil/Galápagos: Adult from \$520; children under 12 from \$260. Call for sample Peru airfare.	
	2018	\$6,960	\$8,100	\$8,990	\$9,970	\$11,950	\$12,890	\$13,660	\$10,130	\$11,240	\$750		
Holiday	Dec. 29, 2017	\$7,780	\$8,880	\$9,780	\$10,720	\$12,810	\$13,760	\$14,530	\$11,120	\$12,240	\$1,000		
	Dec. 21 & 28, 2018	\$7,780	\$8,990	\$10,050	\$11,150	\$13,390	\$14,450	\$15,400	\$11,240	\$12,560	\$1,000		
2017/18 Galápagos + Machu Picchu & The Land of the Inca – 16 days/15 nights – Page 16													
Departing Fridays throughout the year	2017	\$12,650	\$13,630	\$14,430	\$15,280	\$17,130	\$17,970	\$18,670	\$17,000	\$18,000	\$1,500		
	2018	\$12,650	\$13,790	\$14,680	\$15,660	\$17,640	\$18,580	\$19,350	\$17,200	\$18,310	\$1,500		
Holiday	Dec. 15, 2017	\$13,380	\$14,360	\$15,160	\$16,010	\$17,860	\$18,700	\$19,400	\$17,730	\$18,730	\$1,500		
	Dec. 29, 2017	\$14,200	\$15,300	\$16,200	\$17,140	\$19,230	\$20,180	\$20,950	\$18,920	\$20,040	\$1,500		
	Dec. 14, 2018	\$13,380	\$14,520	\$15,410	\$16,390	\$18,370	\$19,310	\$20,080	\$17,930	\$19,040	\$1,500		
	Dec. 28, 2018	\$13,470	\$14,680	\$15,740	\$16,840	\$19,080	\$20,140	\$21,090	\$18,310	\$19,630	\$1,500		
2017 Epic Galápagos Photo Expedition Aboard <i>National Geographic Endeavour II</i> – 17 days/16 nights													
Nov. 24, 2017—with 10% back-to-back savings		\$12,530	\$14,290	\$15,730	\$17,260	\$20,590	\$22,100	\$23,360	\$17,870	\$19,670	\$1,500		
2017/18 Galápagos + Upper Amazon – 18 days/17 nights – Page 17 please call for dates and rates													

EXCLUSIVE INCENTIVES + OUR INCLUSIVE PRICING

CELEBRATE OUR 50TH YEAR WITH FREE ROUND-TRIP AIR

on nearly every departure from Aug. 18–Dec. 9, 2017 aboard both *National Geographic Endeavour II* and *National Geographic Islander*. Plus, select departures aboard both ships through May 2018—more than 50 departure dates to choose from. **UPGRADE TO BUSINESS CLASS FOR \$500** on select departures, limited availability.* Call for details.

MAKE THE MOST OF YOUR TIME IN THE REGION AND SAVE

Combine your Galápagos expedition with either a voyage to the *Upper Amazon* (page 17) or a trip to *Machu Picchu & Peru's Land of the Inca* (page 16) and receive **FREE ROUND-TRIP AIR** from Miami on select departures, including domestic air in Ecuador and Peru. **SAVE 10%** when you combine your Galápagos voyage with an Upper Amazon voyage.



TAKE THE KIDS & SAVE \$500 Share the wonder of Galápagos with kids under 18 and take \$500 off the double occupancy rate per kid. Our connecting cabins, triples and suites book quickly, so act fast.

BRING FAMILY OR FRIENDS Like to explore with like-minded others, or want to bring the whole clan? **SAVE 5%** when traveling as a group of 8 or more—whether it's your friends, book club, member organization, or extended family. Private charters are also available. Call an Expedition Specialist for details.

BACK-TO-BACK SAVINGS: SAVE 10% on any consecutive journeys taken aboard one of our expedition ships. These savings are applicable on voyage fares only, and are not valid on extensions or airfare.

***BOOK BY DECEMBER 31, 2017** to take advantage of the Galápagos Free Air & Business Class Upgrade Offers on select departures. On voyages with complimentary air offers, airfare is based on round-trip economy group flights that must be ticketed by Lindblad Expeditions. All offers are valid for new bookings only, subject to availability at the time of booking, and may not be combined with other offers and pre- and post-extensions. In the case that Lindblad's group or charter flights are no longer available at time of booking, we reserve the right to issue a credit certificate. Call for details about business class upgrades.

NO EXTRA CHARGES FOR ACTIVITIES

All the daily activities—from Zodiac explorations to kayaking, paddleboarding, hiking, and snorkeling—and all shore activities are included in the price. And the ship carries complete snorkeling gear (wet suit, mask, snorkel, fins).

INCLUDED IN THE PRICE

- ✓ Meals on board and on land, as indicated in itinerary
- ✓ Special access permits, park fees, port taxes
- ✓ Round-trip airport to hotel transfers for group flights
- ✓ Two nights hotel accommodation at the Hilton Colón Guayaquil
- ✓ Access to the VIP lounge at Baltra Airport in Galápagos

AND FREELY ENJOY THE FOLLOWING ABOARD SHIP

- ✓ Daily stretching class with wellness specialist
- ✓ Mac computers for downloading your camera's memory card
- ✓ Fitness Center with elliptical, treadmill, stationary bicycle, free weights, bands & more
- ✓ Access to navigational bridge
- ✓ Services of an onboard doctor
- ✓ All meals—from breakfast, lunch & dinner in the dining room, to outdoor BBQs, hors d'oeuvres and snacks during daily recap, tea-time cookies and all-day fruit
- ✓ All non-alcoholic beverages including unlimited cappuccinos, latte, coffee, tea & soda
- ✓ Complimentary refillable water bottle

NO CHARGE FOR THE BEST EXPERTS IN THE ISLANDS

- ✓ The knowledgeable guidance and company of our expedition staff, plus all lectures and presentations, and daily recaps and briefings are open to all and included in the price.

COMBINE OFFERS: Certain offers may be combinable, up to two savings opportunities except where noted otherwise. For example, travel with a group of 8 or more on back-to-back expeditions, and take advantage of both savings!

RESERVATION INFORMATION

Cost Includes: All accommodations aboard ships or in hotels per itinerary or similar, all meals and nonalcoholic beverages aboard ship, meals on land as indicated, air transportation where indicated as included, shore excursions, sightseeing and entrance fees, special access permits, transfers to and from group flights, use of snorkeling equipment and wet suits, use of kayaks and stand-up paddleboards, tips (except to ship's crew), taxes and service charges, services of a ship physician and services of our expedition staff.

Combined Itineraries Costs Include: Hotel nights as described; sightseeing; portage; services of local guides and tour leaders.

Not Included: Air transportation (except where shown as included), extensions, optional Scuba excursions, passport, visa, immigration fees, meals not indicated, travel protection plan, items of personal nature, such as alcoholic beverages, e-mail, voyage DVD, laundry. Gratuities to ship's crew are at your discretion.

Airfare: For all programs, airfare is an additional cost unless otherwise noted. We will gladly assist in making your air arrangements for a \$50 per person service fee.

TERMS & CONDITIONS

Reservations: To reserve your place, an advance payment is required at the time of reservation. The advance payment amount varies by program. Payment is accepted by Visa, MasterCard, American Express, Discover or by check. Receipt of your initial payment indicates your acceptance of our complete Terms and Conditions. We require written notice at the time of reservation for any physical condition, diet, or treatment requiring special attention. Once your reservation is confirmed, we urge you to use your personalized online account for important information to help you prepare for your voyage. Managing your documents online will facilitate fast and accurate communication, and allow you to provide us with pertinent details we require, in order to complete your reservation. Your online account gives you access to your Expedition Guide, which includes valuable information specific to your voyage. You can also use your online account to make easy payments, view recommended flights and reading material, packing list, and so much more.

Final Payment: Due no later than 90 days prior to departures.

Travel Protection Plan: We recommend that you take advantage of our Travel Protection Plan. This plan offers comprehensive coverage to protect you from cancellation fees, costs incurred due to trip delays/interruption, damaged or lost luggage, medical assistance, and evacuation during your travels. Our Travel Protection Plan is available for U.S. and Canadian residents only, and may be purchased any time prior to final payment due date. If you are not satisfied for any reason, you may return your plan within 10 days after purchase. Your premium will be refunded if cancelled within 10 days, provided you have not already departed on the trip or filed a claim. When so returned, the coverage under the plan is void from the original date of purchase.

Smoking Policy: Allowed only in designated outdoor areas.

Responsibility and Other Terms & Conditions: Among other things, limitations of Lindblad Expeditions' and the National Geographic Society's liability for loss of property, injury, illness or death during the voyage will be provided to all guests on the ship's ticket sent prior to departure, and are also available on our website at www.expeditions.com/terms, or upon request. By registering for a trip, the guest agrees to all such terms and conditions.

Entry and Visa Requirements:

All guests are advised to verify travel documents (passport/transit visa/entry visa) for the country through which they are transiting and/or entering. Reliable and most current information regarding international travel can be found by contacting the consulate/embassy of the country(s) you are visiting or transiting through. We will not be responsible if you are denied entry or transit into a Country, if you are unable to provide valid documents as per the Country's requirement.

©2017 Lindblad Expeditions

Lindblad Expeditions and the Eye are the trademarks of Lindblad Expeditions. All rights reserved. NATIONAL GEOGRAPHIC and the Yellow Border are the trademarks of the National Geographic Society. All rights reserved.

Photo Credits: Alamy, Gonzalo Azumendi/Agefotostock, Jonathan Aguas, Gaby Bohórquez, Stewart Cohen, Walter Dardenne, Jennifer Davidson, Tui De Roy/Minden Pictures, Mauricio Handler/ National Geographic Creative, Ralph Lee Hopkins, Sven-Olof Lindblad, Richard Maack, Cynthia Manning, Mashpi Lodge, Michael Melford, National Geographic Creative, Michael S. Nolan, R. Aaron Raymond, Marco Ricca, Jacob Riglin, Krista Rossow, Kevin Schafer, Darrel Schoeling, David Vargas.

CANCELLATION POLICY

Number of Days Prior to Expedition Start	Per Person Cancellation Fee
120 or more days	\$350*
119–90 days	Advance payment cost
89–60 days	25% of trip cost
59–45 days	50% of trip cost
44–0 days	100% - No refund

*\$350 will be refunded in LEX Travel Certificate. This cancellation policy applies to expeditions, extensions, as well as all other additional services. The effective date of a cancellation will be the date on which your notice is received. Note: Airline cancellation policies vary by carrier, as well as the type of fare used to issue your ticket. Any revisions you make within the cancellation penalty period, such as departure date or choice of voyage, are subject to cancellation fees. Additional Terms and Conditions may apply. For complete terms, please visit our website at www.expeditions.com/terms.

We are proud to be a Founding  Member of Adventure Collection —a family of the world's most trusted and experienced active travel companies. Each member company of Adventure Collection is dedicated to enriching the lives of its guests and to giving back to the areas in which it travels. For more information visit www.AdventureCollection.com.

Lindblad Expeditions, as an  Active Member of the United States Tour Operators Association ("USTOA"), is required to post \$1 Million with USTOA to be used to reimburse, in accordance with the terms and conditions of the USTOA Travelers Assistance Program, the advance payments of Lindblad Expeditions customers in the unlikely event of Lindblad Expeditions bankruptcy, insolvency or cessation of business. Complete details of the USTOA Travelers Assistance Program may be obtained by writing to USTOA at 275 Madison Avenue, Suite 2014, NY, NY 10016, or by e-mail to information@ustoa.com or by visiting their website at www.USTOA.com.

For Reservations: Contact your travel advisor or Lindblad Expeditions

**1.800.EXPEDITION
(1.800.397.3348)**

Reservation Hours:

Mon. - Fri. 9am-8pm ET,

Sat. & Sun. 10am-5pm ET

Lindblad Expeditions, Inc.,

96 Morton Street, New York, NY 10014

Phone: 212.261.9000

Email: explore@expeditions.com

For additional information and online reservations, visit us on the Web:

www.expeditions.com.



96 Morton Street
New York, NY 10014

PRSR STD
U.S. POSTAGE
PAID
LINDBLAD
EXPEDITIONS

Account Number:



Expedition Code:



1.800.EXPEDITION | WWW.EXPEDITIONS.COM

Printed on 10% recycled content paper with soy-based inks. We recommend that you pass this along for others to enjoy or recycle.

GAL-077

CELEBRATE OUR 50TH ANNIVERSARY WITH FREE AIR

SELECTED HONORS & AWARDS

- » Condé Nast Traveler’s Readers’ Choice Award—Top Small Ship Cruise Lines, 2015, 2014
- » Porthole Cruise Magazine Readers’ Choice Awards: Best Expedition Cruise Line, 2015
- » The Tourism Cares Travel Philanthropy Awards: Legacy in Travel Philanthropy, 2015
- » World Travel Awards: World’s Leading Green Cruise Line, 2015
- » Condé Nast Traveler’s 2014 Readers’ Poll—Top 20 Small Cruise Ships in the World, 2014
- » Condé Nast Traveler World Savers “Doing it All” Award, 2013
- » Condé Nast Traveler Readers’ Choice Award—Top 25 Cruise Lines, 2013
- » Condé Nast Traveler “Gold List”, 2013, 2009, 2008, 2007, 2006, 2005
- » Virtuoso “Sustainable Tourism Leadership-Supplier” Award, 2013
- » Travel + Leisure “World’s Best” Award for Small-Ship Cruise Lines, 2013, 2012, 2011, 2010, 2009, 2008
- » Travel + Leisure “World’s Best for Families” Award for Small-Ship Cruise Lines, 2012, 2011, 2010, 2009
- » Cruise Critic Editor’s Pick Awards “Best for Adventure,” 2013, 2012, 2011, 2010
- » Climate Champion Award to Sven Lindblad by Clean Air-Cool Planet, 2009
- » Tourism for Tomorrow “Global Tourism Business Award,” 2007

▶ GO TO WWW.EXPEDITIONS.COM/AWARDS FOR AN EXTENDED LIST

