

GALÁPAGOS

WHERE NATURE
& MAGIC MEET



ABOARD NATIONAL GEOGRAPHIC ISLANDER AND
NATIONAL GEOGRAPHIC ENDEAVOUR II | 2018/2019





Lindblad
Expeditions



NATIONAL
GEOGRAPHIC™

Lindblad Expeditions and National Geographic have joined forces to further inspire the world through expedition travel. Our collaboration in exploration, research, technology and conservation will provide extraordinary travel experiences and disseminate geographic knowledge around the globe.



DEAR TRAVELER,

There is more and more theory emerging about the power and relevance of our need as humans to connect with nature. That's true for adults and, most certainly, for kids.

A good friend of mine, Richard Louv, who wrote the international best seller *Last Child in the Woods*, coined the phrase “nature-deficit disorder.” By that he meant that in our evolving high-tech world, children are becoming ever more disconnected and, as a scientist, he suggests that this has far-reaching consequences in their development. I highly recommend this book and his subsequent one, *The Nature Principle—Human Restoration and the End of Nature-Deficit Disorder*.

I write this here only to say that connection with nature in this particular place—Galápagos—is perhaps at its greatest possible level. And, if you are a family, the joy and benefits are beyond measure.

We take the responsibility of curating, if you will, our guests' time here very seriously and have been doing so for 50 years.

You deserve for us to do whatever it takes to ensure your connection with this awesomely wild place will be an experience and a memory that will stay with you forever.

All the best,



Sven-Olof Lindblad

**NEW! WILD GALÁPAGOS ESCAPE
AN EVOLUTION IN GALÁPAGOS TRAVEL**

We are delighted to announce two new 2018-19 itineraries aboard *National Geographic Islander* that provide our hallmark experience in Galápagos in a shorter timeframe. Choose a new seven-day Galápagos expedition, or a nine-day adventure combining Galápagos and Peru, including Machu Picchu. Limited departures. **For details and pricing, please visit expeditions.com/gala_itinerary.**

(The cover—an enchanting moment with my daughter Isabella and above with my son Eric.)





1



2

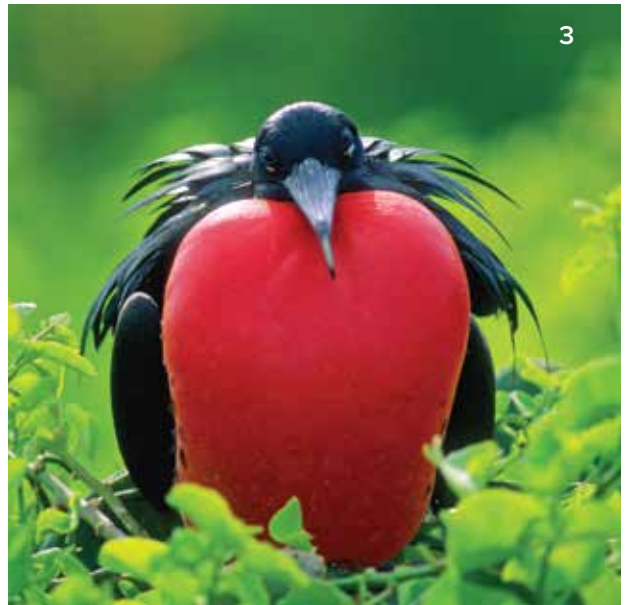

3



5



4

1. Blue-footed booby and chicks

2. Nazca Booby

3. Adult male great frigatebird

4. Galápagos sea lions

5. Sally Lightfoot crab

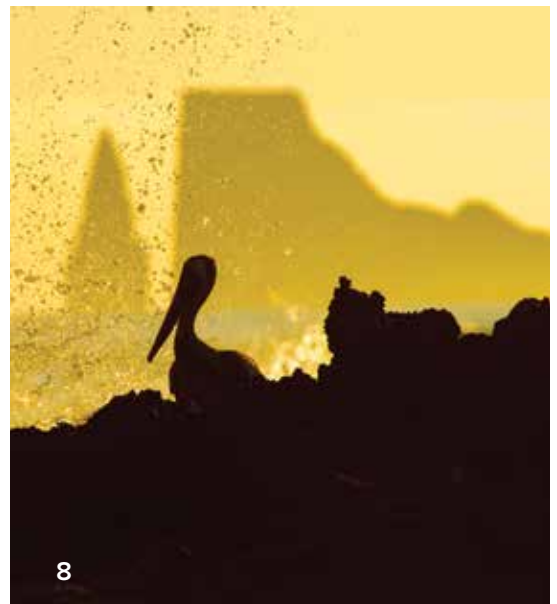
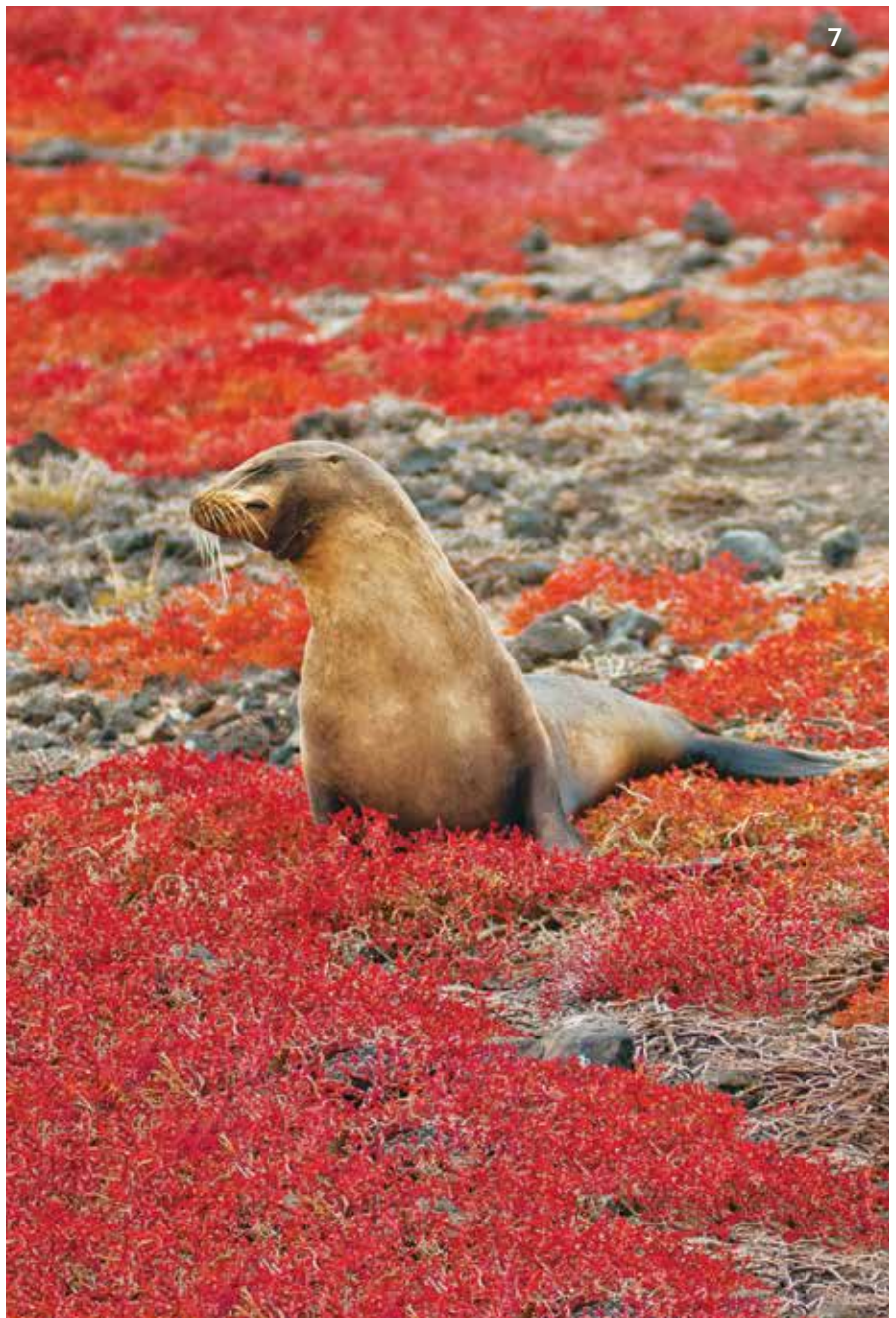

6. Galápagos giant tortoise

7. Galápagos sea lion

8. Brown pelican

9. Marine iguana

10. Galápagos penguin

JOIN US FOR AMAZING & GET



FROM THE FIELD:

“Our itinerary called for us to leave Punta Espinoza at noon for a 1:30 arrival at Punta Vincente Roca on Isabela Island. We had a full afternoon of activities planned, so guests and the expedition team were eager to get there. But fortunately, we have permission to be flexible and spontaneous in our day-to-day explorations. One of the naturalists spotted a distinct shape in the distance, and alerted expedition leader, Paula Tagle, on the bridge. She and the Captain made the decision to detour over for a close sighting. Another naturalist on the team suited up and grabbed the video gear—and soon all guests were invited onto the bridge to spend time observing a fascinating creature seldom seen in Galápagos waters—a giant Mola—as the naturalists described what’s known about this mysterious ocean sunfish. Later that evening, guests were treated to up-close video footage. Consensus: weird, wonderful, and a thrilling discovery!”

—Peggy C., letter to Sven Lindblad, January, 2018

MAGNIFICENTLY WEIRD, TOO



EXCLUSIVELY OURS:

NATIONAL GEOGRAPHIC GLOBAL EXPLORERS PROGRAM



Developed in conjunction with National Geographic Education, our unique exploration-based program is designed to develop the attitudes, skills and knowledge of an explorer. Kids and teens can engage in a variety of cool activities—guided by a National Geographic certified field educator. From recording wildlife sightings in their Field Notebook to collecting and observing plankton, each activity is adapted for their age. Along the way, they'll collect 'points' to become a National Geographic Global Explorer—with the certification to prove it! Kids can choose to participate in some or all—leaving time for families to explore together and connect. Kids under 18 can:

- ✓ **Learn to drive** a Zodiac and get a “license”
- ✓ **Benefit from** National Geographic certified field educators on every departure
- ✓ **Capture a moment** of wonder—in words, drawings, photos or movies—to develop story skills
- ✓ **Take a Spanish lesson**, or learn about culture and cuisine aboard ship
- ✓ **Participate in “In the Field: Spot It!”** activities to locate and observe wildlife based on cues

Charles Darwin kept fourteen field notebooks to record his shore excursions during the voyage of the HMS Beagle. Kids receive their own exclusively developed and designed Field Notebook at the beginning of their Galápagos expedition, to record like Darwin did! Illustrated with photos and facts, the Notebook encourages them to observe what's around them, jot down their stories, and stretch their minds—collecting “points” for activities on their way to becoming a certified National Geographic Global Explorer. And, it's a lasting personal keepsake of their incredible Galápagos experience.



▶ SEE WHAT A DAY IN GALÁPAGOS LOOKS LIKE AT [EXPEDITIONS.COM/FAMILY](https://www.nationalgeographic.com/expeditions.com/family)



Galápagos is Lindblad-National Geographic's number one family destination and the range of activities we offer is one reason why.



PERCENTAGE OF GUESTS UNDER 18	
JANUARY	4%
FEBRUARY	5%
MARCH	20%
APRIL	12%
MAY	4%
JUNE	25%
JULY	29%
AUGUST	22%
SEPTEMBER	2%
OCTOBER	3%
NOVEMBER	6%
DECEMBER	21%



EVERY DAY IS FILLED WITH ADVENTURE

Our expeditions are designed to optimize your individual experience of Galápagos. What would you like to do today? Which of the many activities on offer—from walks to more energetic hikes, to Zodiac shore cruises, to paddling adventures—suits your interests today? Our operation is geared to get you off the ship, out exploring and actively experiencing all the kaleidoscopic wonders Galápagos offers, from swimming with sea lions off a pristine arc of beach, to snorkeling with a passing flotilla of Pacific green sea turtles. Make it yours.

▶ LEARN MORE AT [EXPEDITIONS.COM/GALA](https://www.expeditions.com/gala)





Clockwise from upper left: Paddle the new fleet of versatile kayaks; snorkel with schools of King Angelfish; paddle in historic Buccaneer's Cove, Isla Santiago; hike to the viewpoint of Tagus Cove, Isla Isabela; encounter a rare whale shark and other marine wonders in the rich waters.

THE HEART OF THE EXPERIENCE

The warmth, humanity and dedication of our expedition team, officers, and crew is unequalled. Plus, our connection to the larger Galápagos community through our 50-year commitment to conservation connects you, too. Be a part of it all as you explore and experience.



Full-time Lindblad-National Geographic naturalist guides and Expedition Leaders include Paula Tagle, Carlos Romero, Jonathan Aguas, Juan Carlos Avila and Jason Heilman, 65 years in Galápagos among them.



SHARING CULTURE THROUGH FOOD



Dine daily on produce sourced, in large part, from local farms in the highlands of Santa Cruz Island, with an incredibly resilient vertical organic agriculture that uses less water, and has a self-composting system. Thanks to the efforts of Ana Esteves (left) our director of hotel services, we are working towards 100% Galápagos sourced dining, helping to protect the islands against invasive species.





Wander up and be welcomed on the bridge whenever you wish, a feature of all our expeditions.

EXCLUSIVELY OURS: GALÁPAGOS PHOTO EXPEDITIONS



2018

Travel with an all-star roster of National Geographic photographers: **Ralph Lee Hopkins** (May 11), **Sandesh Kadur** (Jun. 1 & 8), and **Jay Dickman** (Nov. 23 & 30) aboard *National Geographic Endeavour II*.



2019

Travel with an all-star roster of National Geographic photographers: **Todd Gipstein** (Jan. 18 & 25), **Jonathan Irish** (May 24 & 31), **Thomas Peschak** (Nov. 29 & Dec. 6) aboard *National Geographic Endeavour II*.

GALÁPAGOS

10 DAYS/9 NIGHTS—ABOARD NATIONAL GEOGRAPHIC ENDEAVOUR II AND NATIONAL GEOGRAPHIC ISLANDER

PRICES FROM: \$6,960 to \$16,670 (See pages 17 & 21 for complete prices.)

In the Galápagos, no single site can be visited by the same ship more than once over a two-week period. The idea was developed in 2011, and Lindblad was the first voluntary adopter of this innovative new proposal by the Galápagos National Park, which had as its purpose to spread people out to allow for a more intimate experience. We have created an optimal balance during each week in terms of terrain and wildlife. If you wish to see all the sites, you could join for two weeks, but be assured there is no better week to experience Galápagos—just nuances from one week to the other.

EXPEDITION HIGHLIGHTS

- ▶ Snorkel amid shimmering fish, sea turtles, penguins, and playful sea lions.
 - ▶ Walk among colonies of wildlife and birds unfazed by your presence.
 - ▶ Explore the waters of the Galápagos by kayak, glass-bottom boat (*Endeavour II*), Zodiac, or paddleboard.
 - ▶ Observe giant Galápagos tortoises in the wild.
 - ▶ Enhance your expedition with a pre-voyage extension in the Andes, or continue to iconic Machu Picchu or the Amazon for a complete adventure.
- See pages 22-23, or visit expeditions.com.

EXPERIENCE & EXPERTISE

50
YEARS
EXPERIENCE

We're celebrating 50 years of exploring Galápagos. We've introduced generations of travelers to its magic and mystery. We're committed to Galápagos; and have raised millions, along with our guests, for its conservation. And we're fully invested, too; we operate two ships based there year round. An expedition leader, our team of naturalists, a Lindblad-National Geographic certified photo instructor, undersea specialist, wellness specialist, and video chronicler all contribute to your experience of the wonders of Galápagos.

Visit our website to read staff bios.

Blue-footed boobies.



DAY 1: U.S./GUAYAQUIL, ECUADOR

Depart for Guayaquil and upon arrival, transfer to the Hotel del Parque (*National Geographic Islander*) or Hilton Colón (*National Geographic Endeavour II*).

DAY 2: GUAYAQUIL/GALÁPAGOS

This morning, fly to the Galápagos Islands and board *Islander* or *Endeavour II*. After lunch, we begin our exploration of the islands and their diverse wildlife. (B,L,D)

DAYS 3–8: EXPLORING THE GALÁPAGOS

Listed below is a sample of the islands we may visit during our expedition.* (B,L,D Daily)

ISLA BARTOLOMÉ

Walk to the top of Bartolomé’s volcanic cone for a stunning view of Pinnacle Rock and the surrounding golden sand beaches. After the hike, immerse yourself among schools of multicolored reef fish. You may also have the opportunity to swim with Galápagos penguins.

ISLA SANTIAGO

Follow a path along a series of tide pools and underwater caverns in search of Galápagos fur seals, marine iguanas, sea lions, shore birds and Sally Lightfoot crabs.

ISLA SANTA CRUZ

Santa Cruz is home to the Charles Darwin Research station; learn about the science done here and visit the neighboring captive breeding program for endangered species of Galápagos giant tortoises, by their partners in conservation, the Galápagos National Park Service. Later, travel into the highlands

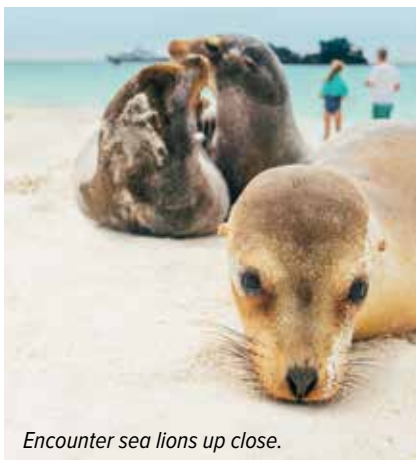

Encounter sea lions up close.

where wild tortoises forage, to observe and photograph these tortoises in the wild.

ISLA ISABELA

Explore the largest island in the group, home to enormous marine iguanas, abundant sea turtles, the only species of flightless cormorant in the world, and the only penguin species that inhabits the equator. Cruise by Zodiac and hike against the backdrop of giant shield volcanoes, and snorkel in the cool, rich waters that often draw whales and dolphins to the area.

ISLA FLOREANA

At Champion Islet, snorkel among sea lions, or peer into an underwater world in a glass-bottom boat or Zodiac while keeping an eye out for the endangered Floreana mockingbird. Those interested can visit Post Office Bay, founded by whalers in the 18th century—if you see a letter addressed to someone who lives near you, the tradition is to deliver it by hand.

ISLA FERNANDINA

Discover the marine iguana haven of Punta Espinoza as we hike over lava flows. Galápagos hawks, sea lion nurseries and the rare Galápagos flightless cormorant will be found as we explore this island.

ISLA ESPAÑOLA

See swallow-tailed gulls, Española mockingbirds, boobies, and, seasonally, waved albatross on this birder’s paradise. Walk among red and black marine iguanas and unique lava lizards, and observe sea lions up close on a pristine white-sand beach.

DAY 9: GALÁPAGOS/GUAYAQUIL

After breakfast, disembark the ship and fly to Guayaquil. The evening is at your leisure at the Hotel del Parque (*Islander*) or Hilton Colón (*Endeavour II*).

DAY 10: GUAYAQUIL/U.S.

Depart Guayaquil this morning, arriving home the same day. (B)

**Please note: All ship itineraries are subject to Galápagos National Park regulations. Our expeditions, which sail between Isla San Cristobal and Isla Baltra include Isla Santa Cruz and a hand-picked selection of these and other visitor sites*



EXPEDITION DETAILS

DATES: 2018/2019: Expeditions depart Fridays on *National Geographic Endeavour II* and Saturdays on *National Geographic Islander*.

SPECIAL OFFERS:

- New for 2019: Your bar tab and WiFi are included. See our website or page 24 for details.
- Book by **Jul. 31, 2018** on select 2018 departures for **FREE ROUND-TRIP** economy group airfare from Miami to Galápagos; ask about other U.S. gateways. Upgrade to business class to Guayaquil for \$500 on select dates (space available). See page 24.
- Combine your Galápagos expedition with an Upper Amazon voyage and save 10%.

NEW: GALÁPAGOS WILD ESCAPE

Now experience Galápagos on a compact 7-day expedition. Or add Peru and Machu Picchu on compact nine-day sojourn. Find details at expeditions.com/gala_itinerary. Want more to explore? Add an extension. Call an Expedition Specialist for details.

EXTEND YOUR ADVENTURE

Combine your Galápagos expedition with [Machu Picchu & Peru’s Land of the Inca](#) or the [Upper Amazon](#). See page 22-23 for details.

OPTIONAL EXTENSION—NEW

Experience Ecuador’s fantastic culture, landscapes and wild nature on a six-day [Tropical Andes & Colonial Quito](#)

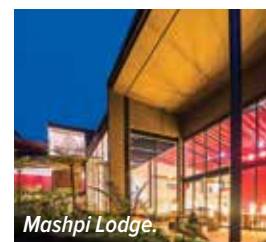

Mashpi Lodge.

adventure, featuring Mashpi Lodge, a National Geographic Unique Lodge of the World. See page 23 for details.



Relaxing on the covered Upper Deck.

LIFE ABOARD NATIONAL GEOGRAPHIC ISLANDER

Our vintage mahogany-and-brass ode to the elegant maritime tradition, *Islander* is as close to a private yacht expedition as you can get, plus you get the benefits of our 50 years of expertise, the caliber of our naturalist team, the warmth of our staff, and the cool tools for exploring with which she is equipped. Accommodating just 48 guests, *National Geographic Islander* inspires a real *esprit de corps*. There's just something about *Islander's* scale, the glow of her patina, her team, and the guests she attracts that's alchemical—it creates something special every single voyage. The attentiveness and graciousness of the staff, cabin service three times daily, the relaxed informality; combined with the pleasures of convening in the Lounge, and entering the Dining Room for each day's fare creates a round of satisfying rituals that foster a real sense of being 'at home.'



Category 5 cabin.



“My wife and I took the one week Galápagos excursion on the Lindblad National Geographic Islander in mid-February. It was a fantastic experience, exceeded our admittedly high expectations and... we can recommend highly.. ”

—Cruise Critic Member Alerion28, sailed February 2017

ISLANDER GUEST EXCLUSIVE: HOTEL DEL PARQUE, GUAYAQUIL



Set in a lovingly restored 19th-century building along the Río Daule, Hotel del Parque is a serene tropical refuge, where the calls of parrots and spider monkeys replace the sounds of a busy port city. Enjoy exclusive after-hours access to the cobble streets, exhibits and lush gardens of Guayaquil's

Parque Histórico. With 44 beautifully appointed rooms, two courtyards, a 19th-century chapel, and an excellent Café facing the river, this exquisite hotel is a perfect golden-age complement to your *Islander* voyage. **New for 2018.**





NATIONAL GEOGRAPHIC ISLANDER

YACHT-SCALED AND TRIM, OFFERING EXPEDITION AMENITIES FOR JUST 48 GUESTS

CAPACITY: 48 guests in 24 outside cabins.

REGISTRY: Ecuador. **OVERALL LENGTH:** 164 feet.

PUBLIC AREAS: Open-air observation deck, second covered outside deck with hammocks, tables and chairs. Lounge and bar accommodating all guests for presentations and gatherings, dining room, library, Mac kiosks and Internet. The captain and officers welcome guests to visit the open bridge.

MEALS: Served in a single, unassigned seating in a sociable, informal atmosphere with Ecuadorian flair.

CABINS: All have a window with an outside view, private facilities, ample storage and climate controls. Bed can be configured as two twins or as a single queen.

EXPEDITION EQUIPMENT: Zodiacs, a fleet of kayaks and paddleboards, snorkel gear and wetsuits for both adults and children, video microscope and underwater video camera.

SPECIAL FEATURES: Shipboard doctor, Lindblad-National Geographic certified photo instructor, video chronicler, snorkel instruction, Wi-Fi access, laundry service, National Geographic Global Explorers family program, Global Gallery.

WELLNESS: LEXSpa and fitness center, exercise classes, and wellness specialist.

Clockwise from top: National Geographic Islander anchors close to shore; Category 1 cabin; Category 4 cabin; spacious and comfortable lounge.





Spacious Dining Room with 270-degree panorama.

CATEGORY 1: Main Deck, Forward #201-206

CATEGORY 2: Main Deck #207-210, Bridge Deck #301, 302

CATEGORY 3: Bridge Deck #303-306. Cabins 305 and 306 can accommodate a third person with sofa bed.

CATEGORY 4: Upper Deck #403-408—with outside, glassed-in terraces with windowed door and seating.

CATEGORY 5: Upper Deck, #401 and 402—forward facing with additional seating, desk, wrap-around windows, glassed-in terrace with seating. Largest cabins aboard.

NOTE: All cabins offer two twin beds that can be converted to a queen. Sole occupancy in categories 1 and 2 only. Third person rates for cabins 305 and 306 are one-half per person double occupancy rate.

SHARED ACCOMMODATIONS: Shares can be arranged at the double occupancy rate in Categories 1 and 2 only.

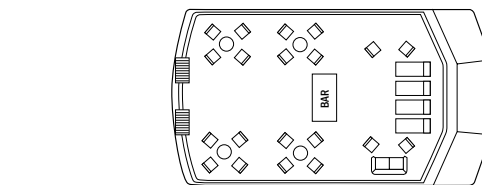

SUN DECK

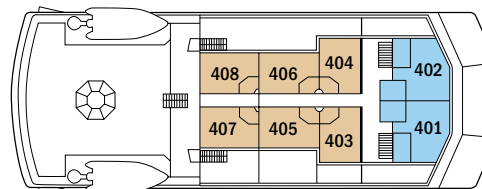

UPPER DECK

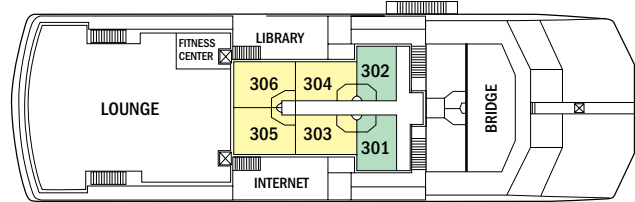

BRIDGE DECK

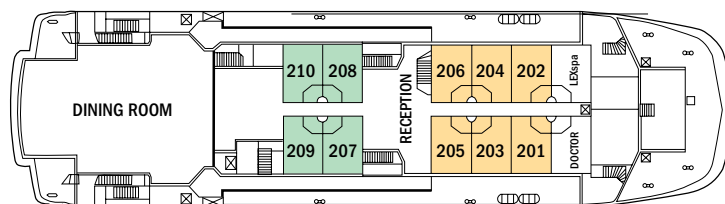

MAIN DECK

Take the kids and save \$1,000 + FREE AIR on select July and August 2018 departures aboard *National Geographic Islander*.

Prices are per person, double occupancy unless indicated as solo.

ITINERARY		CAT. 1	CAT. 2	CAT. 3	CAT. 4	CAT. 5	CAT. 1 SOLO	CAT. 2 SOLO	ADVANCE PAYMENT	NOTE	
Galápagos: Aboard <i>National Geographic Islander</i> – 10 days/9 nights – Page 12-13											
Departing Saturdays throughout the year	2018	\$7,330	\$8,290	\$9,170	\$9,750	\$11,860	\$10,990	\$12,440	\$750	International and internal Ecuador tickets must be issued separately for all Galápagos voyages. Sample International Airfares: round-trip Miami/Guayaquil: Economy from \$500; Business from \$1,050. Sample Internal Airfares: Guayaquil/Galápagos: Adult from \$520 Children (Under 12) from \$260. Call for sample Peru airfare.	
	2019*	\$7,550	\$8,650	\$9,590	\$10,150	\$12,350	\$11,390	\$12,990	\$750		
Holiday	Dec. 22 & 29, 2018	\$8,390	\$9,440	\$10,270	\$10,900	\$13,070	\$12,590	\$14,160	\$1,000		
	Dec. 21 & 28, 2019*	\$8,690	\$9,950	\$11,030	\$11,680	\$14,210	\$13,100	\$14,940	\$1,000		
Galápagos + Machu Picchu & The Land of the Inca – 16 days/15 nights – Page 23											
Departing Saturdays throughout the year	2018	\$13,020	\$13,980	\$14,860	\$15,440	\$17,550	\$18,060	\$19,510	\$1,500		
	2019*	\$13,440	\$14,540	\$15,480	\$16,040	\$18,240	\$18,680	\$20,280	\$1,500		
Holiday	Dec. 29, 2018	\$14,810	\$15,860	\$16,690	\$17,320	\$19,490	\$20,390	\$21,960	\$1,500		
	Dec. 14, 2019*	\$14,170	\$15,270	\$16,210	\$16,770	\$18,970	\$19,210	\$20,810	\$1,500		
	Dec. 28, 2019*	\$14,580	\$15,840	\$16,920	\$17,570	\$20,100	\$20,390	\$22,230	\$1,500		
Tropical Andes + Galápagos aboard <i>National Geographic Islander</i> – 14 days/13 nights – Page 23 (Please call for dates and rates)											

*Price valid through October 31, 2018.



National Geographic Endeavour II, Cabin 420 Suite B.
One of two cabins with floor-to-ceiling windows.

LIFE ABOARD NATIONAL GEOGRAPHIC ENDEAVOUR II



Dining Room.

Completely refitted, christened and launched in Galápagos in 2017, the new *National Geographic Endeavour II* is a floating basecamp for exploring the islands. Originally built to carry 136 passengers, she now accommodates just 96 guests in 52 thoughtfully appointed cabins, including dedicated solo cabins, connecting cabins and suites. Designed and equipped with the benefit of our 50 years in Galápagos, she is the perfect platform for exploring these islands, with a fleet of Zodiacs, kayaks, and stand-up paddleboards for personal forays. With her spacious marina platform, she ensures

swift deployment of all guests aboard—to get you out there on daily adventures. And *Endeavour II* also carries a glass-bottom boat, granting everyone not inclined to the daily snorkeling options, a window on the undersea, with a naturalist at the helm to illuminate the vivid life there.



Heading ashore at first light.

ENDEAVOUR II EXCLUSIVE: + THE UPPER AMAZON

Fall under the spell of the Amazon and discover the pulse and flow of the world's mightiest river, by seamlessly linking your Galápagos *Endeavour II* voyage to an Upper Amazon expedition aboard the lovely *Delfin II*. Fly free round-trip from Miami on select dates; and save 10% by combining two expeditions.



Delfin II.

Squirrel monkeys in Peru's Pacaya-Samiria National Preserve, where you spend a full week.





NATIONAL GEOGRAPHIC ENDEAVOUR II

OUR NEWEST SHIP IN GALÁPAGOS,
OFFERING EXPEDITION AMENITIES FOR 96 GUESTS

CAPACITY: 96 guests in 52 outside cabins.

REGISTRY: Ecuador. **OVERALL LENGTH:** 236 feet.

PUBLIC AREAS: New forward lounge and bar accommodating all guests for presentations and gatherings, restaurant, large library with Mac kiosks, open-air observation deck, underwater gear area and dual Zodiac boarding platform, and open bridge, where guests can meet the captain and officers and learn about navigation. Ship refitted for Galápagos in 2016.

MEALS: Served in a single, unassigned seating in a sociable, informal atmosphere with Ecuadorian flair.

CABINS: All face outside with large windows, and feature twin beds that convert to a queen. With private facilities and climate control, nightstands, desk, and storage. Seven sets of cabins with a connecting door.

EXPEDITION EQUIPMENT: Zodiacs, glass-bottom boat, kayaks and paddleboards, snorkel gear and wetsuits for both adults and children, video microscope and underwater video camera.

SPECIAL FEATURES: Lindblad-National Geographic certified

photo instructor, shipboard doctor, video chronicler, National Geographic Global Explorers family program, snorkel instruction, Wi-Fi access, laundry service, Global Gallery.

WELLNESS: LEXSpa and fitness center, exercise classes, and wellness specialist.

Clockwise from top: National Geographic Endeavour II, launched in December 2016, features 52 cabins accommodating 96 guests; gym; Suite C, largest on the ship; twin bed cabin.



CATEGORY 1: Upper Deck, Forward #201, 202

CATEGORY 2: Upper Deck #211, 213-219, 221, 222, 224-229

CATEGORY 3: Lounge Deck #311, 313-319, 321, 322, 324, 326, 328, 330

CATEGORY 4: Bridge Deck #409, 411-414, 416, 418

SUITE A: Lounge Deck, Mid-Ship #320—with two windows, larger bath, arm chair. Connecting door to #322.

SUITE B: Bridge Deck, Mid-Ship #420, 422—with two floor-to-ceiling windows, larger bath, convertible sofa for a third person.

SUITE C: Bridge Deck, Mid-Ship #415—with two large windows, larger bath, separate sitting area with convertible sofa for a third person and arm chairs, largest cabin on ship.

CATEGORY 2 SOLO: Upper Deck #203-209—with a queen bed.

CATEGORY 3 SOLO: Lounge Deck #325, 327—with a queen bed.

NOTE: All cabins feature the option of two twins or a queen bed, plus large window(s), desk, chair, and closet.

CONNECTING CABINS: #226/228, 227/229, 315/317, 316/318, 320/322, 411/413, 416/418

TRIPLE OCCUPANCY: #224, 225, 326, 328 with fold-down upper third bunk, Suites B and C with convertible sofa bed. Third person rates are one-half per person double occupancy rate.

SHARED ACCOMMODATIONS: Shares can be arranged at the double occupancy rate in Categories 1 and 2.

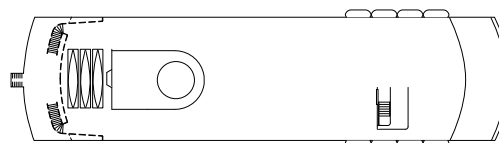

OBSERVATION DECK

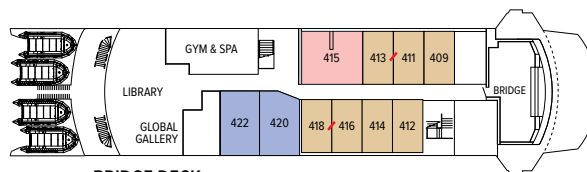

BRIDGE DECK

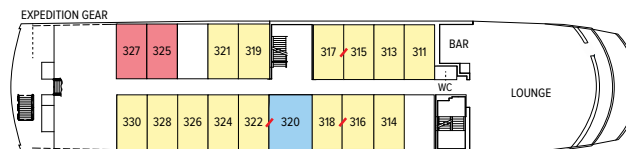

LOUNGE DECK

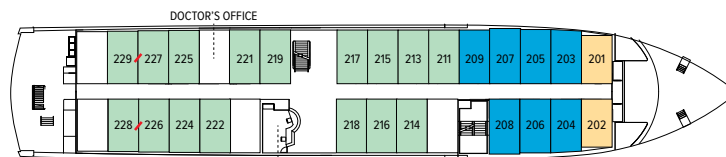

UPPER DECK

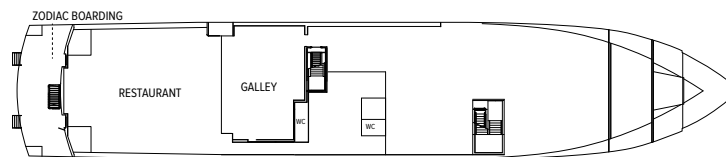

MAIN DECK

↗ indicates adjoining cabins

Prices are per person, double occupancy unless indicated as solo.

ITINERARY		CAT. 1	CAT. 2	CAT. 3	CAT. 4	SUITE A	SUITE B	SUITE C	CAT. 2 SOLO	CAT. 3 SOLO	ADVANCE PAYMENT	NOTE	
Galápagos: Aboard National Geographic Endeavour II – 10 days/9 nights – Page 12-13													
Departing Saturdays throughout the year	2018	\$6,960	\$8,100	\$8,990	\$9,970	\$11,950	\$12,890	\$13,660	\$10,130	\$11,240	\$750	International and internal Ecuador tickets must be issued separately for all Galápagos voyages. Sample International Airfares: round-trip Miami/Guayaquil: Economy from \$500; Business from \$1,050. Sample Internal Airfares: Guayaquil/Galápagos: Adult from \$520; children under 12 from \$260. Call for sample Peru airfare.	
	2019*	\$7,190	\$8,450	\$9,450	\$10,590	\$12,690	\$13,690	\$14,490	\$10,690	\$11,880	\$750		
Holiday	Dec. 21 & 28, 2018	\$7,780	\$8,990	\$10,050	\$11,150	\$13,390	\$14,450	\$15,400	\$11,240	\$12,560	\$1,000		
	Dec. 20 & 27, 2019*	\$8,270	\$9,720	\$10,870	\$12,180	\$14,600	\$15,750	\$16,670	\$12,300	\$13,670	\$1,000		
Galápagos + Machu Picchu & The Land of the Inca – 16 days/15 nights – Page 22													
Departing Saturdays throughout the year	2018	\$12,650	\$13,790	\$14,680	\$15,660	\$17,640	\$18,580	\$19,350	\$17,200	\$18,310	\$1,500		
	2019*	\$13,080	\$14,340	\$15,340	\$16,480	\$18,580	\$19,580	\$20,380	\$17,980	\$19,170	\$1,500		
Holiday	Dec. 14, 2018	\$13,380	\$14,520	\$15,410	\$16,390	\$18,370	\$19,310	\$20,080	\$17,930	\$19,040	\$1,500		
	Dec. 28, 2018	\$13,470	\$14,680	\$15,740	\$16,840	\$19,080	\$20,140	\$21,090	\$18,310	\$19,630	\$1,500		
	Dec. 20, 2019*	\$14,890	\$16,340	\$17,490	\$18,800	\$21,220	\$22,370	\$23,290	\$20,120	\$21,490	\$1,500		
Galápagos + Upper Amazon - 18 days/17 nights - Page 23 (Please call for dates and rates)													
Tropical Andes + Galápagos Aboard National Geographic Endeavour II - 14 days/13 nights - Page 23 (Please call for dates and rates)													

*Price valid through October 31, 2018.

GALÁPAGOS + MACHU PICCHU & PERU'S LAND OF THE INCA

16 DAYS/15 NIGHTS—ABOARD NATIONAL GEOGRAPHIC ENDEAVOUR II AND NATIONAL GEOGRAPHIC ISLANDER

PRICES FROM: \$12,650 to \$23,290 (See pages 17 and 21 for complete prices.)

EXPEDITION HIGHLIGHTS

- ▶ Walk and snorkel among the abundant and fearless wildlife of Galápagos
- ▶ See daybreak over the ruins at Machu Picchu from the fabled Sun Gate
- ▶ Discover Cusco's varied influences and visit the Sacred Valley of the Inca

DAYS 1-8: AS PER GALÁPAGOS ITINERARY ON PAGE 13.



Machu Picchu.

DAY 9: GALÁPAGOS/GUAYAQUIL/LIMA, PERU

Depart Galápagos this morning and fly to Lima, Peru via Guayaquil, arriving in the evening. Overnight at the comfortable and conveniently located Wyndham Costa del Sol Lima Airport Hotel. (B,L)

DAY 10: LIMA/CUSCO/SACRED VALLEY OF THE INCA

Fly to Cusco then drive to Moray, a stunning Inca site believed to have been an agricultural laboratory where Incan priests would test soils and crops. Lunch at Parador Moray, overlooking the ruins. En route to the hotel, walk through a typical local market before an optional visit to the pottery studio Pablo Seminario, featuring ceramics made with ancient Peruvian techniques and designs. Check into Sol y Luna Hotel. (B,L,D)

DAY 11: SACRED VALLEY OF THE INCA

Visit the massive Inca stone fortress of Ollantaytambo. Lunch is at Casa Orihuela, a working, family-owned hacienda, then visit the family's private museum. See a Peruvian Paso horse demonstration, with Marinera dancers and live music. Attend a traditional weaving demonstration by National Geographic grantee Nilda Callañaupa. After dinner at the hotel, see a folkloric dance performance. (B,L,D)

DAY 12: SACRED VALLEY/MACHU PICCHU

Enjoy the views from the valley to Machu Picchu via train with large picture windows. Spend the day exploring Machu Picchu's extraordinary structures with your guide. Overnight at the historic 31-room Belmond Sanctuary Lodge set next to the archaeological site. (B,L,D)

DAY 13: MACHU PICCHU/CUSCO

Hike to the Sun Gate this morning, the ancient final checkpoint to Machu Picchu, and watch daybreak over the sacred ruins. Explore Machu Picchu on your own or with your guide. After lunch return to Cusco and check into the Belmond Monasterio, beautifully situated in the center, for two nights. (B,L,D)

DAY 14: CUSCO

Explore the Inca Empire's capital city of Cusco and visit the magnificent 17th-century cathedral and convent of Koricancha, and the vast Sacsayhuaman fortress, a UNESCO World Heritage site. This afternoon is at leisure to discover the city. Dinner is on your own. (B,L)



Cusco Cathedral.

DAY 15: CUSCO/LIMA

Return to Lima and visit the Larco Museum and stroll the Plaza Mayor. Lunch is in traditional Latin American style. Experience the music of the Andes at a presentation of indigenous instruments. Dinner is on your own. Overnight at the Belmond Miraflores Park Hotel. (B,L)

DAY 16: LIMA/U.S.

After breakfast, transfer to the airport for your flight home. (B)

EXPEDITION DETAILS

DATES: Year-round, weekly departures following Galápagos aboard *National Geographic Islander* and *National Geographic Endeavour II*. Learn more at expeditions.com/gala



Traditional textiles abound.

NEW! TROPICAL ANDES + GALÁPAGOS

FEATURING MASHPI, A NATIONAL GEOGRAPHIC UNIQUE LODGE OF THE WORLD

14 DAYS/13 NIGHTS—PRE-VOYAGE + ABOARD NATIONAL GEOGRAPHIC ENDEAVOUR II AND NATIONAL GEOGRAPHIC ISLANDER

PRICES FROM: \$9,350 to \$25,680

EXPEDITION HIGHLIGHTS

- ▶ Explore colonial Quito, a UNESCO World Heritage site.
- ▶ Discover the Ecuadorian Chocó, one of the world's top five biodiversity hotspots.
- ▶ Stay at Mashpi Lodge, set in a 2,600-acre biodiversity reserve.
- ▶ Experience the wonders of Galápagos.

Day 1: U.S./Quito, Ecuador

Day 2: Quito

Day 3: The Andes/Mashpi Lodge

Day 4: Mashpi Lodge

Day 5: Mashpi Lodge/Quito

Day 6: Quito/Galápagos/Embark

Day 7–14: As per Galápagos itinerary on page 13

▶ LEARN MORE AT EXPEDITIONS.COM/MASHPI



Mashpi Lodge.

EXPEDITION DETAILS

Weekly departures as pre-voyage extension for either *National Geographic Islander* or *National Geographic Endeavour II* in Galápagos. Please call for details.



NEW PHOTO EXPEDITION

Join National Geographic photographer **Ralph Lee Hopkins** May 7, 2018.

GALÁPAGOS + UPPER AMAZON

18 DAYS/17 NIGHTS—ABOARD NATIONAL GEOGRAPHIC ENDEAVOUR II AND DELFIN II

PRICES FROM: \$13,950 to \$25,260 (Call for complete pricing.)

EXPEDITION HIGHLIGHTS

- ▶ Walk and snorkel among the abundant, iconic Galápagos wildlife that is unfazed by your presence.
- ▶ Hike pristine islands, kayak their peaceful shorelines, and explore the Galápagos undersea.
- ▶ In the Amazon, discover an entirely different kind of biodiversity—macaws, monkeys, sloths, and more, plus meet the *riberaños*—inhabitants of the jungle we explore.

Day 1: U.S./Guayaquil, Ecuador

Days 2: Guayaquil/Galápagos/Embark

Day 3-8: Explore Galápagos Aboard *National Geographic Endeavour II*

Day 9: Galápagos/Disembark/Guayaquil/Lima, Peru

Day 10: Lima/Nauta/Embark

Day 11-16: Explore Pacaya-Samiria National Reserve Aboard *Delfin II*

Day 17: Nauta/Disembark/Lima

Day 18: Lima/U.S.

EXPEDITION DETAILS

DATES: 2018 Apr. 20; May 13, 18; Jun 22, 29; Aug 10, 17; Oct. 5, 19, 26; Nov. 30, Dec. 7, 21
2019 Jan. 4, 11, 18, 25; Feb. 8, 15, 22; Mar. 1, 8; Apr. 19, 26; May 3, 10, 31; Jun. 7, 14; Aug. 10, 17, 24; Oct. 18, 25; Nov. 1, 22, 29; Dec. 6

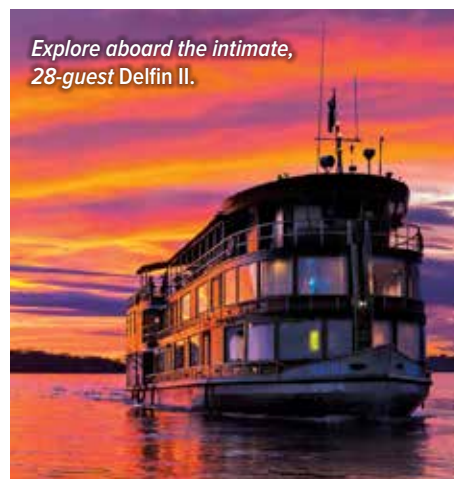

Explore aboard the intimate, 28-guest Delfin II.

SPECIAL OFFERS:

Book by **Jul. 31, 2018**, and **SAVE 10%**.
New bookings only. Call for details.

▶ LEARN MORE AT EXPEDITIONS.COM/AMAZON

EXCLUSIVE INCENTIVES + OUR INCLUSIVE PRICING

FREE ROUND-TRIP AIR on select departures aboard both ships through Dec. 2018. Upgrade to Business Class for \$500 on these dates, subject to availability.

MAKE THE MOST OF YOUR TIME IN THE REGION AND SAVE Combine your Galápagos expedition with either a voyage to the *Upper Amazon* (page 23) or a trip to *Machu Picchu & Peru's Land of the Inca* (page 22) and receive **FREE ROUND-TRIP AIR** from Miami on select departures, including domestic air in Ecuador and Peru. **SAVE 10%** when you combine your Galápagos voyage or Peru expedition with an Upper Amazon voyage.

TAKE THE KIDS & SAVE \$500 Share the wonder of Galápagos with kids under 18 and take \$500 off the double occupancy rate per kid. Our connecting cabins, triples and suites book quickly, so act fast. **Double the offer, \$1,000 savings on select July and August 2018 Islander departures.**



BRING FAMILY OR FRIENDS Like to explore with like-minded others, or want to bring the whole clan? **SAVE 5%** when traveling as a group of 8 or more—whether it's your friends, book club, member organization, or extended family. Private charters are also available. Call an Expedition Specialist for details.

BAR TAB AND WIFI INCLUDED Travel aboard any 2019 *National Geographic Islander* or *National Geographic Endeavour II* voyage and we will cover your bar tab. Complimentary bar offer excludes certain premium brands of alcohol. Free WiFi, up to one hour a day per person aboard any 2019 *National Geographic Islander* and *National Geographic Endeavour II* departure. Visit our website or call for details.

NO EXTRA CHARGES FOR ACTIVITIES

- ✓ All the daily activities—from Zodiac explorations to kayaking, paddleboarding, hiking, and snorkeling
- ✓ All shore activities are included in the price
- ✓ Ship carries complete snorkeling gear (wetsuit, mask, snorkel, fins)

INCLUDED IN THE PRICE

- ✓ Meals on board and on land, as indicated in itinerary
- ✓ Special access permits, park fees, port taxes
- ✓ Round-trip airport to hotel transfers for group flights
- ✓ Two night hotel accommodations at the Hotel del Parque or Hilton Colón Guayaquil

AND FREELY ENJOY THE FOLLOWING ABOARD SHIP

- ✓ Stretching class with wellness specialist
- ✓ Mac computers for downloading your camera's memory card
- ✓ Fitness Center with elliptical, treadmill, stationary bicycle, free weights, bands & more
- ✓ Access to navigational bridge
- ✓ Services of an onboard doctor
- ✓ All meals—from breakfast, lunch & dinner in the dining room, to outdoor BBQs, hors d'oeuvres and snacks during daily recap, tea-time cookies and all-day fruit
- ✓ All non-alcoholic beverages including unlimited cappuccinos, latte, coffee, tea & soda
- ✓ Complimentary refillable water bottle

NO CHARGE FOR THE BEST EXPERTS IN THE ISLANDS

- ✓ The knowledgeable guidance and company of our expedition staff, plus all lectures and presentations, daily recaps and briefings are open to all and included in the price.

***BOOK BY JULY 31, 2018** to take advantage of the Galápagos Free Air & Business Class Upgrade Offers on select departures. On voyages with complimentary air offers, airfare is based on round-trip economy group flights from Miami that must be ticketed by Lindblad Expeditions. All offers are valid for new bookings only, subject to availability at the time of booking, and may not be combined with other offers and pre- and post-extensions. In the case that Lindblad's group or charter flights are no longer available at time of booking, we reserve the right to issue a credit certificate. Call for details about business class upgrades.

COMBINE OFFERS: Certain offers may be combinable, up to two savings opportunities except where noted otherwise. For example, travel with a group of 8 or more on back-to-back expeditions, and take advantage of both savings!

RESERVATION INFORMATION

Cost Includes: All accommodations aboard ships or in hotels per itinerary or similar, all meals and nonalcoholic beverages aboard ship, meals on land as indicated, air transportation where indicated as included, shore excursions, sightseeing and entrance fees, special access permits, transfers to and from group flights, use of snorkeling equipment and wet suits, use of kayaks and stand-up paddleboards, tips (except to ship's crew), taxes and service charges, services of a ship physician and services of our expedition staff.

Combined Itineraries Costs Include: Hotel nights as described; sightseeing; portage; services of local guides and tour leaders.

Not Included: Air transportation (except where shown as included), extensions, optional Scuba excursions, passport, visa, immigration fees, meals not indicated, travel protection plan, items of personal nature, such as alcoholic beverages, e-mail, voyage DVD, laundry. Gratuities to ship's crew are at your discretion.

Airfare: For all programs, airfare is an additional cost unless otherwise noted. We will gladly assist in making your air arrangements for a \$50 per person service fee.

TERMS & CONDITIONS

Reservations: To reserve your place, an advance payment is required at the time of reservation. The advance payment amount varies by program. Payment is accepted by Visa, MasterCard, American Express, Discover or by check. Receipt of your initial payment indicates your acceptance of our complete Terms and Conditions. We require written notice at the time of reservation for any physical condition, diet, or treatment requiring special attention. Once your reservation is confirmed, we urge you to use your personalized online account for important information to help you prepare for your voyage. Managing your documents online will facilitate fast and accurate communication, and allow you to provide us with pertinent details we require, in order to complete your reservation. Your online account gives you access to your Expedition Guide, which includes valuable information specific to your voyage. You can also use your online account to make easy payments, view recommended flights and reading material, packing list, and so much more.

Final Payment: Due no later than 90 days prior to departures.

Travel Protection Plan: We recommend that you

take advantage of our Travel Protection Plan. This plan offers comprehensive coverage to protect you from cancellation fees, costs incurred due to trip delays/interruption, damaged or lost luggage, medical assistance, and evacuation during your travels. Our Travel Protection Plan is available for U.S. and Canadian residents only, and may be purchased any time prior to final payment due date. If you are not satisfied for any reason, you may return your plan within 10 days after purchase. Your premium will be refunded if cancelled within 10 days, provided you have not already departed on the trip or filed a claim. When so returned, the coverage under the plan is void from the original date of purchase.

Smoking Policy: Allowed only in designated outdoor areas.

Responsibility and Other Terms & Conditions:

Among other things, limitations of Lindblad Expeditions' and the National Geographic Society's liability for loss of property, injury, illness or death during the voyage will be provided to all guests on the ship's ticket sent prior to departure, and are also available on our website at www.expeditions.com/terms, or upon request. By registering for a trip, the guest agrees to all such terms and conditions.

Entry and Visa Requirements:

All guests are advised to verify travel documents (passport/transit visa/entry visa) for the country through which they are transiting and/or entering. Reliable and most current information regarding international travel can be found by contacting the consulate/embassy of the country(s) you are visiting or transiting through. We will not be responsible if you are denied entry or transit into a Country, if you are unable to provide valid documents as per the Country's requirement.

©2017 Lindblad Expeditions

Lindblad Expeditions and the Eye are the trademarks of Lindblad Expeditions. All rights reserved. NATIONAL GEOGRAPHIC and the Yellow Border are the trademarks of the National Geographic Society. All rights reserved.

Photo Credits: Gonzalo Azumendi/agefotostock, Stewart Cohen, Christian Delvoie, Jennifer Davidson, Danita Delimont/Alamy, Jay Dickman, Matthew Williams-Ellis, Nick Fox/Shutterstock, Ralph Lee Hopkins, Sven-Olof Lindblad, Jeff Litton, Cynthia Manning, Michael S. Nolan, Stefanie Payne, Marco Ricca, Jacob Riglin, Krista Rossow, Andy Rouse/Alamy, Alex Rowbotham/Alamy, Kevin Schafer, Darrel Schoelgel, David Vargas.

CANCELLATION POLICY

Number of Days Prior to Expedition Start	Per Person Cancellation Fee
120 or more days	\$350*
119–90 days	Advance payment cost
89–60 days	25% of trip cost
59–45 days	50% of trip cost
44–0 days	100% - No refund

*\$350 will be refunded in Lindblad Expeditions Travel Certificate. This cancellation policy applies to expeditions, extensions, as well as all other additional services. The effective date of a cancellation will be the date on which your notice is received. Note: Airline cancellation policies vary by carrier, as well as the type of fare used to issue your ticket. Any revisions you make within the cancellation penalty period, such as departure date or choice of voyage, are subject to cancellation fees. Additional Terms and Conditions may apply. For complete terms, please visit our website at www.expeditions.com/terms.

We are proud to be a Founding  Member of Adventure Collection —a family of the world's most trusted and experienced active travel companies. Each member company of Adventure Collection is dedicated to enriching the lives of its guests and to giving back to the areas in which it travels. For more information visit www.AdventureCollection.com.

Lindblad Expeditions, as an Active Member of the United States Tour Operators Association ("USTOA"), is required to post \$1 Million with USTOA to be used to reimburse, in accordance with the terms and conditions of the USTOA Travelers Assistance Program, the advance payments of Lindblad Expeditions customers in the unlikely event of Lindblad Expeditions bankruptcy, insolvency or cessation of business. Complete details of the USTOA Travelers Assistance Program may be obtained by writing to USTOA at 275 Madison Avenue, Suite 2014, NY, NY 10016, or by e-mail to information@ustoa.com or by visiting their website at www.USTOA.com.

For Reservations: Contact your travel advisor or Lindblad Expeditions

1.800.EXPEDITION
(1.800.397.3348)

Reservation Hours:

Mon. - Fri. 9am-8pm ET,

Sat. & Sun. 10am-5pm ET

Lindblad Expeditions, Inc.,

96 Morton Street, New York, NY 10014

Phone: 212.261.9000

Email: explore@expeditions.com

For additional information and online reservations, visit us on the Web:

www.expeditions.com.



96 Morton Street
New York, NY 10014

PRSR STD
U.S. POSTAGE
PAID
LINDBLAD
EXPEDITIONS

Account Number:



1.800.EXPEDITION | WWW.EXPEDITIONS.COM

♻️ Printed on 10% recycled content paper with soy-based inks. We recommend that you pass this along for others to enjoy or recycle.

GAL-138

BOOK NOW—FOR FREE AIR ON SELECT DATES | ANNOUNCING 2019 DEPARTURES

CELEBRATING
50
YEARS



▶ GO TO WWW.EXPEDITIONS.COM/AWARDS
FOR A LIST OF OUR HONORS & AWARDS