



# COLUMBIA & SNAKE RIVERS

AN ALL-FIVE-SENSES JOURNEY  
THROUGH AMERICANA

ABOARD NATIONAL GEOGRAPHIC QUEST | 2018 & 2019



Lindblad  
Expeditions



NATIONAL  
GEOGRAPHIC™



Lindblad  
Expeditions



NATIONAL  
GEOGRAPHIC™

Lindblad Expeditions and National Geographic have joined forces to further inspire the world through expedition travel. Our collaboration in exploration, research, technology and conservation will provide extraordinary travel experiences and disseminate geographic knowledge around the globe.

DEAR TRAVELER,

There is a wealth of discovery to be made along the Columbia and Snake Rivers—geological marvels, gastronomical delights, scenic vistas, and of course the historic legacy of the Lewis and Clark expedition, which mantles this corner of America. Our carefully crafted voyage seamlessly blends it all into a unique and meaningful experience, one enhanced by our team's ability to weave the Lewis and Clark story into the tapestry of subsequent life in the Pacific Northwest. The vineyards you'll visit, the locks you'll transit, even the vintage airplanes you'll see that once flew mail routes along the river, add deep layers of insight to your sense of the region's history.

Transiting the gorge by ship allows us to see time layered in the riverbanks, where Ice Age floods and epic landslides carved and altered much of the route we travel—something your expedition's geologist will cover. And the brand-new *National Geographic Quest*, which sails these waterways for the first time starting this April, ensures you up-close views of rugged shorelines and soaring basalt cliffs thanks to her unobstructed observation deck and suite of exploration tools including kayaks and Zodiacs.

And we will be celebrating an important event this season: the year 2018 has been designated the Year of the Bird by National Geographic in partnership with a broad range of conservation organizations, to celebrate the 100-year anniversary of the passage of the Migratory Bird Treaty Act in 1918. This visionary act of legislation mandated the protection of nearly 1,000 species of migratory birds in danger of extinction from commercial exploitation at the time of its passage. Key birders on our expedition team, aboard select departures, have been designated **Year of The Bird Ambassadors** to help you spot and identify the species you'll encounter.

Our entire team—expedition and hotel staff—will contribute to your knowledge and appreciation of the region, as they introduce you to wildlife, vistas and to Oregon and Washington's burgeoning food and wine scene. We meet new local vintners and brewers every season, and provide tastings aboard, with our compliments. You'll dine on food grown in the area's rich soil and learn about the sustainable farmers and providers we source from.

And there's more—natural beauty is on display all season long here. Our autumn departures take full advantage of the fall foliage—a highlight for photographers—while our spring departures reveal the lush, verdant results of a wet winter. Don't consider yourself a photographer? You might find traveling with a Lindblad-National Geographic certified photo instructor aboard opens new possibilities for you, and that you'll be thrilled with the photos you take home.

No other travel company offers the uniquely multi-faceted history and cultural experience that we do. And we promise if you choose to join us, you'll make a big deposit in your memory bank.

All the best,



Sven-Olof Lindblad

**SPECIAL AIRFARE SAVINGS**

Book now on select departures  
and receive a \$500 air credit.

See page 12.



*Palouse Falls and surrounding canyons, geological marvels in southeastern Washington state.*

# COLUMBIA & SNAKE RIVERS JOURNEY: HARVESTS, HISTORY, AND LANDSCAPES

7 DAYS/6 NIGHTS—ABOARD NATIONAL GEOGRAPHIC QUEST

PRICES FROM: \$4,890 to \$8,630 (See page 11 for complete prices.)

The powerful Columbia and Snake Rivers flow through some of the most geologically fascinating landscapes, carved over time by tumultuous floods and volcanic eruptions. Get an up-close look at towering canyons, massive waterfalls, ancient petroglyphs, and rocky shorelines where bighorn sheep roam free. Along the way you'll also travel through a series of eight locks, visit intriguing museums, and savor this fertile region's abundant bounty—from salmon fished right out of these waterways to award-winning wines and craft brews. And overlying it all: the intrepid spirit of Lewis & Clark and the Corps of Discovery. As you travel in their wake, your historian will weave tales of this dramatic episode in American history.

## EXPEDITION HIGHLIGHTS

- ▶ Follow the path of Lewis and Clark's expedition, stopping at some of their campsites and learning about the Nez Perce people they encountered.
- ▶ Explore the Palouse River via kayak or Zodiac and hike around the impressive Palouse Falls.
- ▶ Take an exhilarating jet boat ride through the spectacularly scenic Hells Canyon, North America's deepest gorge.
- ▶ Enjoy locally sourced, sustainable food on board, from providers along the way, so it's literally as fresh as can be.
- ▶ Spend a half day, before or after your journey, exploring the engaging city of Portland or delving into viticulture in the Willamette Valley. Check out our extensions at [expeditions.com/portland](http://expeditions.com/portland).

(See the day-by-day itinerary on the following pages.)

## EXPEDITION DETAILS

DATES: 2018 Apr. 12, 18\*; Sep. 17, 23\*, 29; Oct. 5\*, 11, 17\* 2019 Apr. 25; May 1\*, Sep. 15, 21\*, 27; Oct. 3\*, 9, 15\*

\*These departures travel from Clarkston, Washington to Portland, Oregon.

🐦 These departures will be joined by a Year of the Bird Ambassador.

## SPECIAL OFFERS:

- Book now and receive a **\$500 AIR CREDIT** on select 2018 departures.
- Book the Apr. 12 or Apr. 18, 2018 departure and also enjoy a free overnight + half-day city tour in Portland.
- Solo travelers on the Apr. 12, 2018 voyage may waive the solo premium on solo cabins. Call for details.

### DAY 1: PORTLAND, OREGON/EMBARK

Board our ship and cruise the center of Portland on the Willamette River before reaching the Columbia River. (D)

### DAY 2: ASTORIA

We begin our journey by navigating the Columbia to the mouth of the river at Astoria. At Fort Clatsop, where the explorers hunkered down for the wet winter of 1805-1806, we walk through the full-scale reconstructed fort. Visit the Columbia River Maritime Museum, which chronicles the history of river navigation and this port town. In the afternoon explore more of Lewis and Clark history with several options to choose from. (B,L,D)

### FORT CLATSOP

The intrepid spirit of Meriwether Lewis and William Clark permeates this corner of the continental U.S. where they led the Corps of Discovery expedition. At this impeccable replica of the fort, gain a deeper understanding of what these men endured that arduous winter and the ardent curiosity that spurred them to go on.

### DAY 3: COLUMBIA RIVER GORGE/HOOD RIVER

This morning we begin our orientation to the Gorge. You'll get a fresh perspective on such highlights as Bonneville Lock and Dam, Beacon Rock, and Multnomah Falls. Continue through the Gorge to Hood River, where we'll visit the Western Antique Aeroplane & Automobile Museum, home to one of the largest collections of still-functioning antique cars and planes in the country. (B,L,D)

### BONNEVILLE LOCK & DAM

Located 145 river miles from the mouth of the Columbia River, this is the first in an impressive system of eight locks that can lift or lower ships some 700 feet—nearly 10 times what the Panama Canal entails! Before passing through the locks, we sail in the wake of Lewis and Clark to reach Beacon Rock, a giant basalt volcanic plug.

*Riding bikes back from the Columbia Gorge Discovery Center.*



## EXTEND YOUR ADVENTURE—DISCOVER PORTLAND AND THE WILLAMETTE VALLEY

### PORTLAND HALF-DAY CITY TOUR

Explore must-see highlights of the quirky and picturesque city of Portland on our guided tour. Start by taking in iconic views of the city and surrounding volcanic peaks at the historic Pittock Mansion (pictured right). From there, discover the diverse neighborhoods in Portland's four main quadrants: Northeast, Northwest, Southeast, and Southwest. Each has its own distinct feel and unique attractions including art galleries, boutiques, and restaurants. And finally, your naturalist guide will bring to life at least two of the following parks—Washington Park, Rocky Butte, McCall Waterfront Park—by interpreting history, flora and fauna, and spotting birds.

*(SPRING 2018—Book now on the Apr. 12 or 18, 2018 departure and receive a FREE city tour plus an overnight stay in Portland. See page 12.)*



#### DAY 4: THE DALLES/MARYHILL MUSEUM

Visit the Columbia River Gorge Discovery Center to learn about the region's natural history. Hike or take bicycles along the beautiful river trail. In the afternoon we'll visit the Maryhill Museum with its impressive collection of Rodin sculptures and drawings, extensive collection of Native American baskets, and other fascinating exhibits. End the day with a tour and tasting at a local vineyard and winery. (B,L,D)



*Zodiac and kayak adventures on the Palouse River.*

#### PALOUSE FALLS

The geology of this region reveals the story of a restless land forged through the eons. Palouse Falls, created by cataclysmic Ice Age floods, is one stunning result of these phenomena. Prepare to witness the true force of nature as the 198-foot-tall falls drop dramatically into the cavernous plunge pool below.

#### DAY 5: EXPLORING THE PALOUSE RIVER

The still water of the Palouse River is the perfect mirror for the surrounding basalt cliffs as we set off cruising on our Zodiac and kayak adventures. Visit Palouse Falls, where cascading waters plunge into the pool below. Afterwards, sail up the Snake River, enjoying a taste of local specialties. (B,L,D)

#### DAY 6: CLARKSTON, WASHINGTON

At Clarkston, we find ourselves at the confluence of the Snake and Clearwater rivers, more than 450 miles from the sea. Travel by comfortable jet boat up the Snake River into one of North America's most scenic spots, spectacular Hells Canyon. (B,L,D)

#### HELLS CANYON

Rugged and remote, Hells Canyon is America's deepest, river-cut canyon. Board jet boats for a front-row seat to the towering canyon cliffs formed from layer after layer of basaltic lava flows. And keep your cameras close for stellar photo ops—the Seven Devil Mountains rise as high as 8,000 feet above the Snake River here and Rocky Mountain bighorn sheep graze on the steep hillsides.

#### DAY 7: CLARKSTON/DISEMBARK

Transfer to Lewiston, Idaho or Spokane, Washington for connecting flights home. (B)

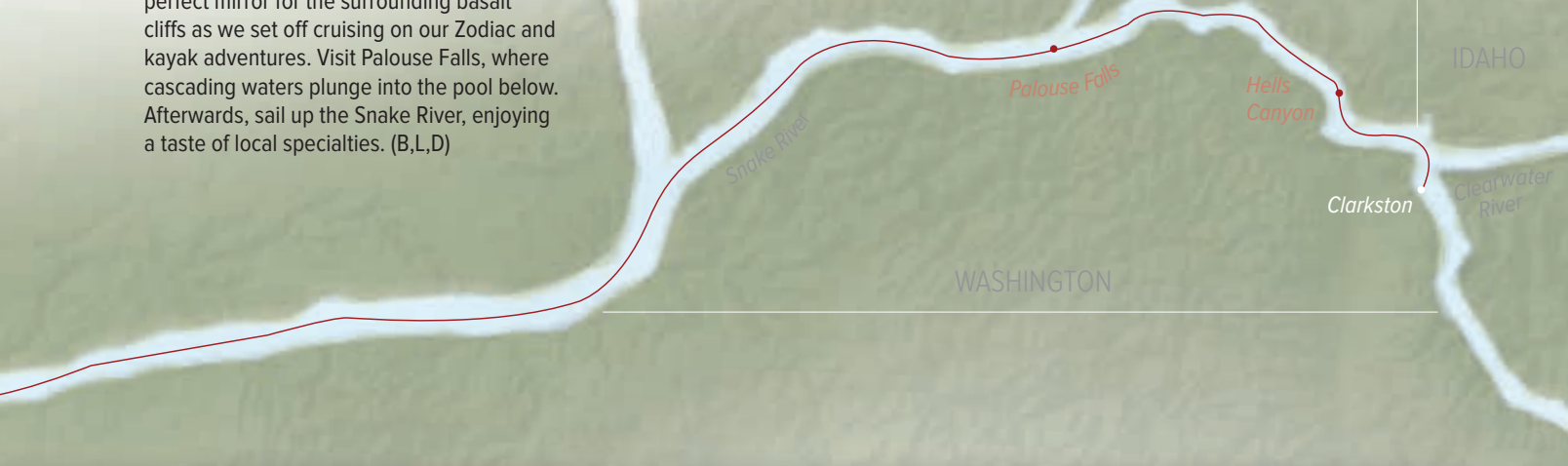

#### WILLAMETTE VALLEY WINE TOUR

On this half-day tour, visit three of the following award-winning boutique wineries located just outside Portland: Winter's Hill, Durant, Stoller, Rex Hill, Fox Farm, and Laurel Ridge. From the first stop to the last, you'll discover that each winery represents distinctive elements of the Willamette Valley, from biodynamic farming practices to unique single-block wines. We'll enjoy tastings, while learning about the art of viticulture from an expert guide and sometimes the winemakers themselves. A locally sourced picnic lunch is included. In the evening, you're free to explore Portland's booming restaurant scene on your own.



#### PRE- AND POST-EXTENSION OPTIONS

Both extensions can be combined with an overnight at the Portland Marriott Downtown Waterfront Hotel. Take either extension on its own or make a full day of it and do both. Extension options starting at \$100 per person. Visit [expeditions.com/portland](http://expeditions.com/portland) or call for details.

# THE PERFECT BASE CAMP FOR EXPLORING

Traveling expedition-style, we experience this historic corner of the Pacific Northwest with all our senses—seeing its majestic beauty, hearing its rushing waterfalls and wild silences, feeling its fresh air. And tasting it daily in the delectable food served aboard, grown in the region’s rich soil, and sourced from sustainable local farms and providers—with wines and craft beers from the region’s vintners and brewers. All the while our expedition team weaves a cohesive regional narrative in onboard talks, excursions, or field walks.

And you’ll find *National Geographic Quest*, our brand-new, state-of-the-art expedition ship to be equally engaging. Join us in 2018 for her first season sailing the Columbia & Snake and you’ll feel at home in no time as you settle into your well-appointed cabin and get acquainted with the welcoming public spaces. In the dramatic window-lined lounge—the heart of the expedition community—enjoy spirited cocktail hours, our lively daily Recap sessions, and informative presentations. Dine with a rotating cast of fellow guests and expedition staffers in our spacious dining room where no-assigned seating makes for easy mingling. Congregate with newfound friends on the bow or sundeck to watch as we glide through time layered in stone on the banks of the river. And since *Quest* is equipped with specialty tools for exploration—from Zodiacs to kayaks and more—you’ll get an incredibly close-up perspective on the region’s geologic, historic, and wild wonders.



John Day Lock and Dam.



Our new, best-in-class expedition ship National Geographic Quest.



# SEE, DO & LEARN MORE WITH A FIRST-RATE TEAM

Your time on the river and ashore will be spent in the company of a veteran expedition team that's passionate about the region's rich history. Relive the heroic tales of the Corps of Discovery through the eyes of your historian. Join your geologist and naturalist to marvel at layers of ancient basaltic lava. Capture a great blue heron perched sentinel-like on the river bank with help from a Lindblad-National Geographic certified photo instructor. Or unwind one evening with a massage from your wellness specialist. With one expert aboard for every 15 guests, you're ensured diverse knowledge, varied points of view and engaging companionship.



**MARYLOU BLAKESLEE,**  
**Expedition Leader**

Naturalist, lecturer, and artist, Marylou spends her summers as a park ranger at Glacier Bay National Park and has traveled the world sharing her love of wild places.



**LINDA BURBACK,**  
**Certified Photo Instructor**

An accomplished photographer and horticulturalist, Linda has worked in the commercial cactus industry as well as the interpretive division of Saguaro National Park.

▶ PLEASE VISIT [EXPEDITIONS.COM/EXPERTBIOS](https://www.expeditions.com/expertbios) AND SELECT AN ITINERARY TO FIND OUT WHICH STAFF WILL BE ABOARD.

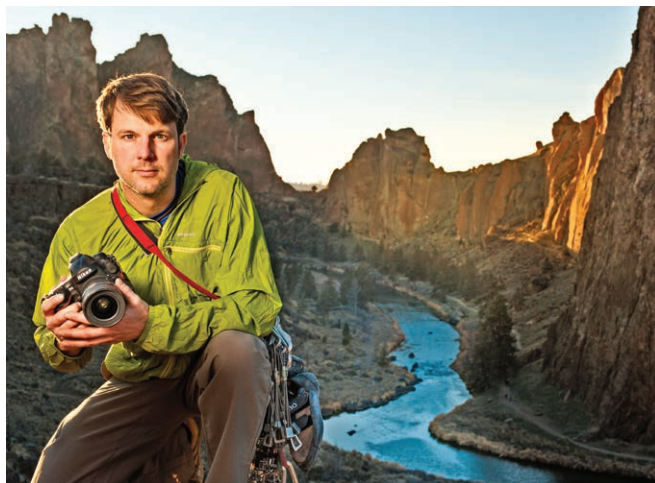

Join National Geographic photographer **Jonathan Kingston** on the Sep. 29 & Oct. 5, 2018 departures.

## CAPTURE THE STORY OF YOUR EXPEDITION WITH NATIONAL GEOGRAPHIC

From the unrivaled beauty of the Columbia River Gorge to the moody silhouette of Mount Hood, you'll find photo ops around every bend. And thanks to our Expedition Photography program, you'll be able to make the most of them. A Lindblad-National Geographic certified photo instructor is aboard every voyage to help you with camera settings, basics, and more. And on select departures, a National Geographic photographer provides inspiration, tips and pro guidance. All levels are invited to participate in the fun of what we call "aim & create!"

# SAVOR THE FLAVORS OF THE REGION

We are proud to provision our ships in perfect harmony with the terrain we explore. As you follow these grand rivers, our menus follow the flow of the seasons, providing you with the freshest, most local fare possible. Our dedicated team has crafted a culinary program that raises the bar on locality, sustainability, and seasonality. Throughout the journey you'll taste the region's very soil, air, and water in the form of delicious fruit, vegetables, cheese, fish, and meat, plus wines and craft beer.



*“We’re turning our guests into locavores by supporting Pacific Northwest producers almost exclusively. Our goal is to cross-utilize ingredients from a 150-mile radius, manage our fisheries, and provision sustainable products with minimal processing, no added hormones or antibiotics. We also continue to rely on providers who have earned a Food Alliance certification—this esteemed designation ensures that food is produced by well-treated workers; that meat products come from humanely raised animals; and that the regional soil, water, and wildlife habitats are protected and enhanced.”*

—Ana Esteves, Manager Hotel Operations, Lindblad Expeditions



*Home to roughly 40,000 farms, Washington state's rich soils and diverse climates make it one of the most fertile regions in the world.*



*Above: Handmade goat cheeses; gourds from a farmer along the Columbia River; dished, locally sourced cuisine.*

### **SALMON STRAIGHT FROM THE RIVER**

Weekly updates on salmon runs sent by our supplier help us map out our menu. Dine on Sockeye and Coho salmon fished directly from the Columbia and, depending on time of year, from surrounding tributaries like the Cowlitz, Kalama, and Lewis rivers.

### **FORAGED MUSHROOMS**

A special delivery in Portland brings us the best of the hunt from fields and forests within a 50-mile radius, changing with the seasons and availability.

### **UPCYCLING-SUSTAINED MEAT AND BEER**

New to our vendor list, Fulton Farms and Oregon Natural Meats upcycle over 20 million pounds of

brewer's grain from Ninkasi Brewery each year. Normally disposed of in landfills, this grain now feeds the cattle from which they produce ground beef. Enjoy both their meat and beer on board.

### **FARM-TO-SHIP PRODUCE**

We've cultivated deep relationships in the region allowing our chefs to handpick produce from places like Moscow Farmers Market, Draper Girl Farm, Pullman Farmers Market, and Wilson Banner Ranch where we buy local apples, multiple types of squash, hackberries, pears, and fresh apple cider. Customized produce deliveries from Duck Delivery bring additional seasonal delicacies aboard.



## **CHEERS TO LOCAL WINE & BEER**

Local wines served aboard represent the various growing areas and grape varieties which embody the region's best—including vintners like Sokol Blosser whom we have worked directly with for eight years. Located on 85 acres of organic estate in the Willamette Valley, this family-owned and -run winery is committed to sustainable practices, from reducing water and energy usage to maintaining beehives that contribute to the bee population. Enjoy their wines by the glass or the bottle at dinner and Recap each evening. And for beer aficionados aboard we also serve an array of the region's best craft brews like Full Sail or Deschutes.

NEW SHIP



# NATIONAL GEOGRAPHIC QUEST

**CAPACITY:** 100 Guests in 50 cabins.  
**REGISTRY:** United States.  
**OVERALL LENGTH:** 238 feet.

*National Geographic Quest* (launched in 2017) is the latest addition to our fleet. Designed with over 50 years of expedition heritage and built in the U.S.A., *Quest* sets a new standard in exploration and comfort.

**PUBLIC AREAS:** Global gallery; fitness center, LEXspa, lounge with full service bar and facilities for films and presentations; observation deck, mudroom with lockers for expedition gear, and a partially covered sundeck with chairs and tables. Our “open bridge” provides guests an opportunity to meet our officers and captain and learn about navigation.

**MEALS:** Served in single seatings with unassigned tables for an informal atmosphere and easy mingling. Breakfast and lunch are wide selection buffets with chef action stations, while dinners are primarily served plated. Menu emphasizes local fare.

**CABINS:** All cabins face outside with windows or portholes, private facilities and climate controls. Category 4 cabins have step-out balconies.

**EXPEDITION EQUIPMENT:** A fleet of 8 Zodiacs and 24 kayaks, Remotely Operated Vehicle (ROV), hydrophone, splashcam, underwater video camera, video microscope, paddleboards, snorkeling gear for all guests (where applicable).

**SPECIAL FEATURES:** Guest internet access, elevator, Lindblad-National Geographic certified photo instructor, a video chronicler and undersea specialist.

**WELLNESS:** The vessel is staffed by a wellness specialist and features a gym with an elliptical machine, treadmill, exercycles, handweights and resistance bands. Treatments in the LEXspa are available by appointment.



*Insets clockwise from top: The lounge, with 270° views, is the hub of the expedition community; a spacious and open sundeck will provide unparalleled views.*



Clockwise from top-right: Category 5 cabin is our most spacious; dining room; Category 4 cabin with lower single beds (which can be converted to a Queen) and a private step-out balcony. Select cabins connect via an inside doorway.

**CATEGORY 1:** Main Deck #301-306 Cabins feature two lower single beds that can convert to a Queen, a writing desk and two portholes.

**CATEGORY 2:** Main Deck #307-315 Cabins feature two lower single beds that can convert to a Queen, a writing desk and two portholes.

**CATEGORY 3:** Upper Deck #201-206 Cabins feature two lower single beds that can convert to a Queen, a writing desk and two large view windows.

**CATEGORY 4:** Upper Deck #207-229 Cabins feature two lower single beds that can convert to a Queen, a writing desk, sliding glass door, and small, private balcony.

**CATEGORY 5 (SUITE):** Observation Deck #101-108 Cabins feature two lower single beds that can convert to a Queen, large view windows, an expanded bathroom, writing desk, ample storage space, and a convertible sofa bed to accommodate a third person.

**NOTE:** Sole Occupancy cabins are available in Categories 1 and 2 only. Third person rates are available in Category 5 cabins at one half the double occupancy rate.

**Connecting Cabins via internal doorway access:** Main Deck: #312-314, #311-315, #306-308, #305-307; Upper Deck: #224-226, #225-227

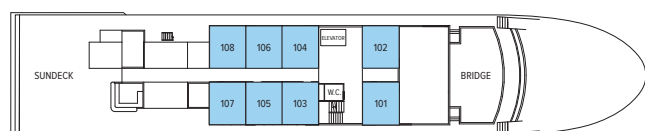

OBSERVATION DECK

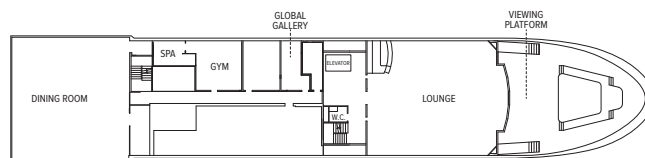

LOUNGE DECK



UPPER DECK



MAIN DECK

Prices are per person, double occupancy unless indicated as solo.

ITINERARY	YEAR	CAT. 1	CAT. 2	CAT. 3	CAT. 4	CAT. 5 SUITE	CAT. 1 SOLO	CAT. 2 SOLO	ADVANCE PAYMENT	NOTE
Columbia & Snake Rivers Journey: Harvests, History, and Landscapes	2018	\$4,890	\$5,690	\$6,650	\$7,390	\$8,190	\$7,340	\$8,540	\$750	We will gladly assist in making your air arrangements. Please call for airfares from your departure city.
	2019	\$4,940	\$5,750	\$6,720	\$7,460	\$8,270	\$7,410	\$8,630		

# TAKE ADVANTAGE OF OUR SPECIAL OFFERS

**\$500 AIR CREDIT:** Book by Jul. 31, 2018 to receive a \$500 air credit per person on select departures. Valid for new bookings only, subject to availability, and may not be combined with other offers, or extensions. Call for details.

**FREE EXTENSION:** Book the Apr. 12 or Apr. 18, 2018 departure and also enjoy a FREE overnight + half-day city tour in Portland. Please call for details.

**SOLO EXPLORERS OFFER:** Waive the solo traveler premium on Columbia and Snake Rivers Journey departing Apr. 12, 2018 only. Subject to availability. Please call for details.

**TRAVELING AS A GROUP:** Save 5% when traveling as a group of 8 or more people. Take advantage of these great savings, while enjoying traveling with your friends and family. This savings is applicable to voyage fares only, and is not valid on extensions or airfare. Deposit, final payments, and cancellation policies for group travel vary from our regular policies.

**BRINGING THE KIDS:** We believe sharing an expedition with your kids or grandkids is a life-enhancing experience. So, take \$500 off for each child under the age of 18.

**COMBINING OFFERS:** Certain offers may be combinable, up to two savings opportunities except where noted otherwise. For example, travel with a group of 8 or more, including kids under 18, and take advantage of both savings!



## INCLUSIVE PRICING

We include just about everything you have the opportunity to do as part of your expedition aboard ship and ashore. The only things not included are of a personal nature—alcohol (except complimentary tastings), internet usage, tips to the crew, wellness treatments, and other specialized arrangements.

### ABOARD SHIP

- ✓ All meals and non-alcoholic beverages
- ✓ Complimentary wine and beer tastings
- ✓ Cappuccinos, lattes & complimentary environmentally friendly refillable water bottle
- ✓ 24-hour coffee, tea & soda on demand
- ✓ Hors d'oeuvres & snacks during lounge recap
- ✓ Fully-stocked library
- ✓ The guidance and company of our expedition staff
- ✓ Fitness center

### ASHORE

- ✓ Meals on land, as indicated in itinerary
- ✓ Special access permits, entry fees, port taxes
- ✓ Transfers to and from group flights
- ✓ The expertise of our expedition staff

### ACTIVITIES

- ✓ All excursions
- ✓ Jet boat, Zodiac, kayak, and bicycle explorations
- ✓ Lectures & presentations in the lounge
- ✓ Morning stretch classes with wellness specialist



## LOG ON TO EXPEDITIONS.COM

Find everything you need to dream, research or plan travel to 40+ destinations worldwide.

## BE PART OF OUR EXPEDITION COMMUNITY

Join in! Here's how:

- ✓ Check our daily blog for interesting posts, video clips and Photos of The Week: [expeditions.com/blog](http://expeditions.com/blog)
- ✓ Like us on Facebook: hear what our travelers have to say, get inspired and chime in: [facebook.com/LindbladExpeditions](https://facebook.com/LindbladExpeditions)
- ✓ Preview an expedition before you go or subscribe to our videos on [youtube.com/lindbladexpeditions](https://youtube.com/lindbladexpeditions)
- ✓ Follow us [@LindbladExp](https://twitter.com/LindbladExp) and our founder, Sven Lindblad [@SvenLEX](https://twitter.com/SvenLEX), on Twitter; and on Instagram [@SOLindblad](https://instagram.com/SOLindblad) for his interesting view of the world.
- ✓ Check out Expedition Snapshots from guests—and upload your own on the [expeditions.com](http://expeditions.com) homepage.



# RESERVATION INFO

**Costs Include:** All accommodations aboard ships per itinerary or similar, all meals and nonalcoholic beverages aboard ship, meals on land as indicated, complimentary wine and beer tastings, air transportation where indicated as included, shore excursions, sightseeing and entrance fees, use of kayaks (where available), special access permits, transfers to and from group flights, tips (except to ship's crew), taxes and service charges, and services of our expedition staff.

**Not Included:** Air transportation (except where shown as included), extensions, passport, visa, immigration fees, meals not indicated, travel protection plan, items of a personal nature such as alcoholic beverages (except wine and beer tastings on board), e-mail, voyage DVD, laundry. Gratuities to ship's crew are at your discretion.

**Airfare:** For all programs, airfare is an additional cost unless otherwise indicated. We will gladly assist in making your air arrangements for a \$50 per person service fee.

## TERMS & CONDITIONS

**Reservations:** To reserve your place, an advance payment is required at the time of reservation. The per person advance payment amount varies by program, and is outlined in our brochures, as well as on our website. Payment is accepted by Visa, MasterCard, American Express, Discover, or by check. Receipt of your initial payment indicates your acceptance of our complete Terms and Conditions. We require written notice at the time of reservation for any physical condition, diet, or treatment requiring special attention. Once your reservation is confirmed, we urge you to use your personalized online account for important information to help you prepare for your voyage. Managing your documents online will facilitate fast and accurate communication, and allow you to provide us with pertinent details we require, in order to complete your reservation. Your online account gives you access to your Expedition Guide, which includes valuable information specific to your voyage. You can also use your online account to make easy payments, view recommended flights and reading material, packing list, and so much more.

**Final Payment:** Final payment is due 90 days prior to departure.

**Travel Protection Plan:** We recommend that you take advantage of our Travel Protection Plan. This plan offers comprehensive coverage to protect you from cancellation fees, costs incurred due to trip delays/interruption, damaged or lost luggage, medical assistance, and evacuation during your travels. Our Travel Protection Plan is available for U.S. and Canadian residents only, and may be purchased any time prior to final payment due date. If you are not satisfied for any reason, you may return your plan within 10 days after purchase. Your premium will be refunded if cancelled within 10 days, provided you have not already departed on the trip or filed a claim. When so returned, the coverage under the plan is void from the original date of purchase.

**Smoking Policy:** Smoking is allowed only in designated outdoor areas.

**Responsibility and Other Terms & Conditions:** Among other things, limitations of Lindblad Expeditions' and the National Geographic Society's liability for loss of property, injury, illness or death during the voyage will be provided to all guests on the ship's ticket sent prior to departure, and are also available on our website at [www.expeditions.com/terms](http://www.expeditions.com/terms), or upon request. By registering for a trip, the guest agrees to all such terms and conditions.

**Note:** Itineraries and prices listed in this brochure are as of publication date, and are subject to change. The company reserves the right to impose surcharges based on increases in the company's actual cost of fuel or other unexpected expenses.

CANCELLATION POLICY	
Number of Days Prior to Expedition Start	Per Person Cancellation Fee
120 or more days	\$350
119-90 days	Advance payment cost
89-60 days	25% of total fare
59-45 days	50% of total fare
44-0 days	No refund

\$350 will be rewarded in the form of a Lindblad Expeditions Travel Certificate. This cancellation policy applies to expeditions, extensions (with the exception of Denali), as well as all other additional services. The effective date of a cancellation will be the date on which your cancellation notice is received. Any revisions you make within the cancellation penalty period, such as departure date or choice of voyage, are subject to cancellation fees.

Note: Airline cancellation policies vary by carrier, as well as the type of fare used to issue your ticket.

Our group cancellation policy is listed in the Terms and Conditions section of our website, or you may call us for details. We stress the importance of purchasing a travel protection plan to protect yourself from fees in the event you need to cancel your reservation.

**United States Tour Operators Association**  
**\$1 Million Travelers Assistance Program**

Lindblad Expeditions, as an Active Member of USTOA, is required to post \$1 Million with USTOA to be used to reimburse, in accordance with the terms and conditions of the USTOA \$1 Million Travelers Assistance Program, the advance payments of Lindblad Expeditions customers in the unlikely event of Lindblad Expeditions bankruptcy, insolvency or cessation of business. Further, you should understand that the \$1 Million posted by Lindblad Expeditions may be sufficient to provide only a partial recovery of the advance payments received by Lindblad Expeditions. More details of the USTOA Travelers Assistance Program may be obtained by writing to USTOA at 345 Seventh Avenue, Suite 1801, New York, New York 10001, or by email to [information@ustoa.com](mailto:information@ustoa.com) or by visiting their website at [www.USTOA.com](http://www.USTOA.com).



We are proud to be a Founding Member of Adventure Collection—a family of the world's most trusted and experienced active travel companies. Each member company of Adventure Collection is dedicated to enriching the lives of its guests and to giving back to the areas in which it travels. For more information visit [www.AdventureCollection.com](http://www.AdventureCollection.com).



©2018 Lindblad Expeditions  
 Lindblad Expeditions and the Eye are the trademarks of Lindblad Expeditions. All rights reserved.  
 NATIONAL GEOGRAPHIC and the Yellow Border are the trademarks of the National Geographic Society. All rights reserved.

Photo Credits: Marc Cappelletti, Larry Geddis/Alamy, Ralph Lee Hopkins, Jonathan Kingston, Rich Kirchner, Jeff Litton, Craig Lovell/Alamy, Jeff Mauritzen, Susan Moebus, Emily Mount, Michael S. Nolan, Ryder Redfield, Rich Reid, Marco Ricca, Rikki Swenson, David Vargas, Leon Werdinger/Alamy.

For a list of Lindblad Expeditions' selected honors and awards, go to [WWW.EXPEDITIONS.COM/AWARDS](http://WWW.EXPEDITIONS.COM/AWARDS)

**For Reservations:**  
**Contact your travel advisor or Lindblad Expeditions**  
**1.800.EXPEDITION (1.800.397.3348)**  
**Reservation Hours: Monday – Friday 9am – 10pm ET**  
**Saturday & Sunday 10am – 5pm ET**

**Lindblad Expeditions, Inc., 96 Morton Street, New York, NY 10014**  
**Phone: 212.261.9000 • Fax: 212.265.3770**

**email: [explore@expeditions.com](mailto:explore@expeditions.com) For additional information and online reservations, visit us on the Web: [www.expeditions.com](http://www.expeditions.com)**



96 Morton Street  
New York, NY 10014

PRSR STD  
U.S. POSTAGE  
PAID  
LINDBLAD  
EXPEDITIONS

Account Number:



Expedition Code:

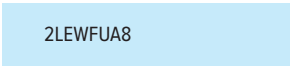

2LEWFUA8

1.800.EXPEDITION | WWW.EXPEDITIONS.COM

♻️ Printed on 10% recycled content paper with soy-based inks. We recommend that you pass this along for others to enjoy or recycle.

LEW-018

**BOOK NOW: \$500 AIR CREDIT & SOLO EXPLORER SAVINGS (ON SELECT DEPARTURES). SEE PAGE 12.**

# BE OUR GUEST:

Apr. 12 & 18, 2018—Complimentary Portland  
Hotel Stay + City Tour. See Page 12.



▶ VISIT [EXPEDITIONS.COM/PORTLAND](http://EXPEDITIONS.COM/PORTLAND) FOR MORE  
WAYS TO ENHANCE YOUR EXPEDITION.