

COLUMBIA & SNAKE RIVERS

FOLLOW THE
LEWIS & CLARK
PAST INTO THE
PRESENT PACIFIC
NORTHWEST

ABOARD NATIONAL GEOGRAPHIC SEA BIRD & SEA LION | 2017
AND NATIONAL GEOGRAPHIC QUEST | 2018



Lindblad
Expeditions



NATIONAL
GEOGRAPHIC™



Lindblad
Expeditions



NATIONAL
GEOGRAPHIC™

Lindblad Expeditions and National Geographic have joined forces to further inspire the world through expedition travel. Our collaboration in exploration, research, technology and conservation will provide extraordinary travel experiences and disseminate geographic knowledge around the globe.

DEAR TRAVELER,

History—the foundational American saga of the Lewis and Clark expedition—is the most common reason people choose our Columbia and Snake River expedition. As we explore from Cape Disappointment to the basalt cliffs of the Snake River, we follow in the wake of the Corps of Discovery to present you with the same views the legendary explorers saw, and give you the same sense of awe and majesty they experienced. And since we travel with an onboard historian, you're actively learning, not merely passively sightseeing in these historic locales.

Traveling by ship allows us to see time layered in the riverbanks, where the Missoula Floods of 15,000 years ago carved much of the route we transit, and the landslides of 500 years ago altered the river's course by a full mile—something your expedition's geologist will cover. And our ship's hotel staff, integral members of your expedition team, will help establish the connection between the landscapes and the land, as they introduce you to Oregon and Washington's burgeoning food and wine scene. Our carefully curated food program (see pages 10-11) is designed to do more than reward you (our style of exploring definitely kindles your appetite!) with delicious food daily, plus complimentary tastings. It's an opportunity to experience the culture, and the people, of the contemporary Pacific Northwest, too.

And there's more—natural beauty is on display all season long here. Our April departures reveal the unique awakening of spring in the region. And our autumn departures take full advantage of the fall foliage—a highlight for photographers. Don't consider yourself a photographer? You might find traveling with a Lindblad-National Geographic certified photo instructor aboard opens new possibilities for you, and that you'll be thrilled with the photos you take home.

The exclusive itinerary, our expedition team's ability to weave a coherent narrative from all you'll see and do, and their engaging talks and presentations, plus the comfort of life aboard adds up to the best experience of one of America's most vital regions you could have.

We promise if you choose to join us, you'll make a big deposit in your memory bank.

All the best,



Sven-Olof Lindblad

SPECIAL AIRFARE SAVINGS

Book now on select 2017 & 2018 departures and receive a \$500 air credit. See page 7.

SAIL THROUGH AMERICAN HISTORY ON THE MOST ADVANCED INTRODUCING THE NATIONAL



Starting April 2018 the brand-new *National Geographic Quest* will join our beloved sister ships, *National Geographic Sea Bird* and *Sea Lion*, in plying the Columbia and Snake rivers. When we wanted to build the perfect ship to explore from Alaska and the Pacific Northwest to Central America, we naturally turned to Nichols Brothers Boat Builders on Whidbey Island,

Washington, the same company that built the very vessels we've used for the last 36 years. Nichols Brothers has grown from a family-run operation to a great shipyard, employing 400 people, more than any other Whidbey Island company except the Navy. And their shipbuilding know-how—combined with our 50+ years of expedition experience—has produced a best-in-class expedition ship, outfitted with the latest in marine engineering, technology, and interior design, plus a full suite of tools designed for up-close, personal encounters with the grand natural beauty of these two great rivers.

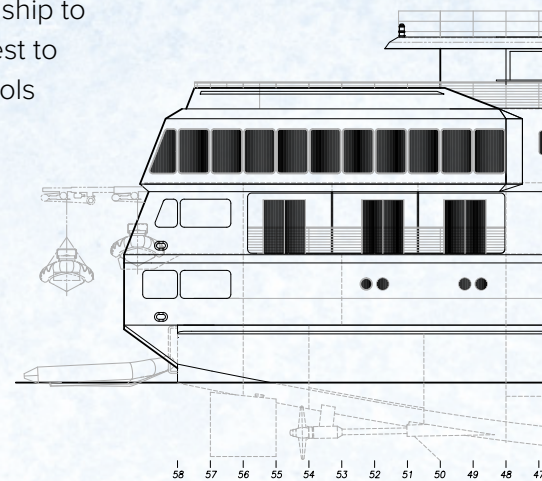

▶ SHIPBUILDING IS A FASCINATING ART, WATCH *QUEST*'S PROGRESS AT EXPEDITIONS.COM/QUESTBUILD

EXPEDITION SHIP BUILT ENTIRELY IN THE USA GEOGRAPHIC QUEST

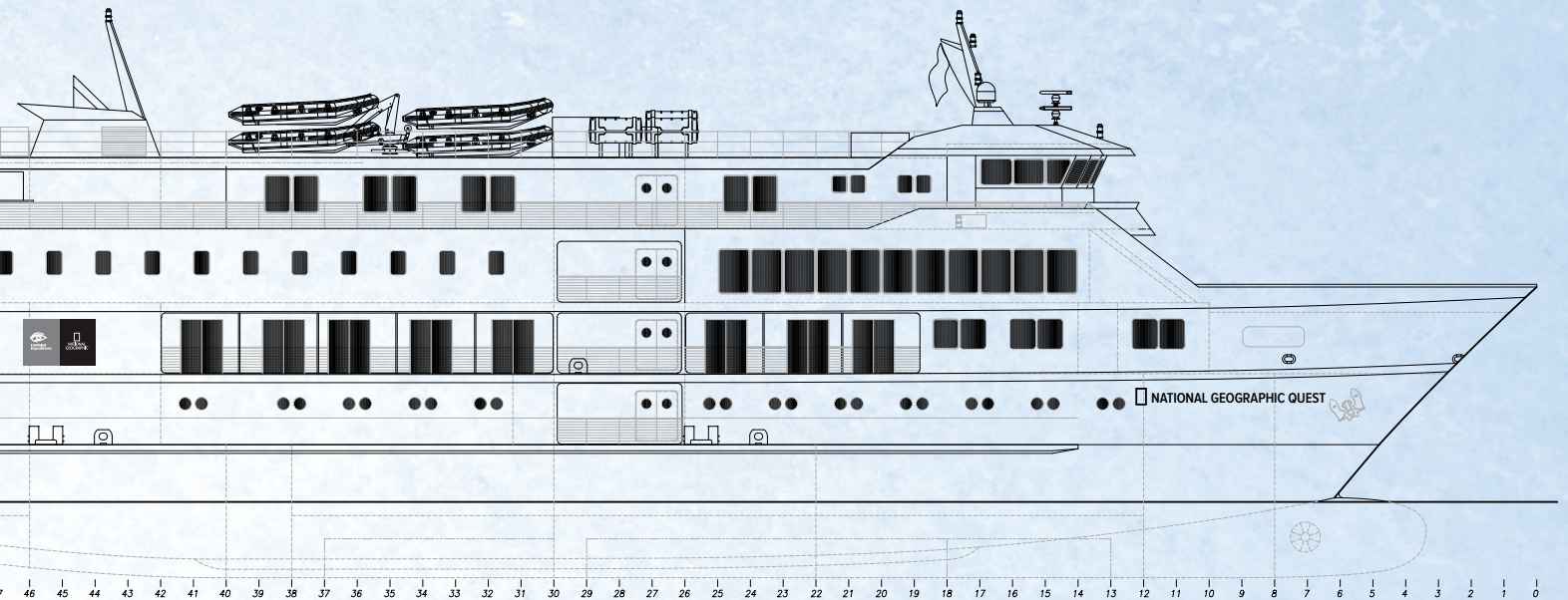

SEA LION & SEA BIRD: INTIMATELY SCALED, TRIED-AND-TRUE EXPEDITION SHIPS

Explore on the *National Geographic Sea Bird* or *Sea Lion* and you'll experience the Columbia and Snake rivers in a way you otherwise couldn't, thanks to their nimble size and maneuverability. Able to navigate the shifting silhouette of the rivers, enter the numerous locks, and dock at places larger ships cannot, they'll deliver an up-close, one-of-a-kind perspective of the region's fascinating geology and wildlife. Plus, these 62-guest sister ships foster a sense of shipboard life where everyone is integral to the adventure, and a friendly, convivial community quickly forms on board. Departures remain for both vessels this fall so book now and be there in September or October.



Above: The intimate, nimble National Geographic Sea Lion. Opposite page, counter-clockwise from top: A worker soldering; original storefront for Nichols Brothers Boat Builders, founded over 50 years ago on Whidbey Island, Washington; bulbous bow and hull of National Geographic Quest.

Caledonian Canal.

EXPEDITION ADVENTURE IN COMFORT & STYLE

Traveling expedition-style, we experience this historic corner of the Pacific Northwest with all our senses—seeing its majestic beauty, hearing its rushing waterfalls and wild silences, feeling its fresh air. We taste it daily in the delectable food served aboard, grown in the region’s rich soil, sourced from sustainable local farms and providers—with wines and craft beers from the region’s vintners and brewers. All the while our expedition team weaves a cohesive regional narrative in onboard talks, excursions, or field walks.



And you’ll find all three of our ships to be equally engaging. Whichever one you choose, you’ll feel at home in no time as you settle into the cossetting ambiance of your cabin and get acquainted with the warm and welcoming public spaces. In the dramatic window-lined lounges—the heart of the expedition community—enjoy spirited cocktail hours, our lively daily Recap sessions and informative presentations. Dine with a rotating cast of fellow guests and expedition staffers in our spacious dining rooms where no-assigned seating makes for easy mingling. Congregate with newfound friends on the bow or sun decks to watch as we glide through time layered in stone on the banks of the river. And as always you have an open invitation to the Bridge, a hallmark of Lindblad expeditions, where you can observe the riveting business of navigation unfold.



Clockwise from top left: Staff member aboard National Geographic Sea Lion serving signature cocktails; ceviche salad with white wine pairing; our vessel heads toward one of eight locks along our journey; Fremont Bridge across the Willamette at sunset.





ITINERARY

COLUMBIA & SNAKE RIVERS JOURNEY: HARVESTS, HISTORY & LANDSCAPES

7 DAYS/6 NIGHTS—ABOARD NATIONAL GEOGRAPHIC SEA BIRD, NATIONAL GEOGRAPHIC SEA LION & NATIONAL GEOGRAPHIC QUEST

PRICES FROM: \$4,890 to \$8,540 (See pages 15-16 for complete prices.)

The Corps of Discovery expedition, led by Lewis and Clark from 1804 to 1806, was a dramatic episode in American history. Conceived by President Thomas Jefferson as more than a geographic exploration, it studied native cultures, collected specimens, and, through maps, put form to what was terra incognita. Retrace Lewis & Clark's rich history of exploration. Visit campsites of the Corps of Discovery and learn about their relationships with the Native American tribes. Plus see diverse landscapes, travel through a series of eight locks, and enjoy locally and sustainably sourced cuisine, including award-winning wines and craft brews.

EXPEDITION HIGHLIGHTS

- ▶ Follow the path of Lewis and Clark's expedition, stopping at some of their campsites and learning about the Nez Perce people they encountered.
- ▶ Explore the Palouse River via kayak or zodiac and hike around the impressive Palouse Falls.
- ▶ Enjoy locally sourced, sustainable food on board, from providers along the way, so it's literally as fresh as can be.

(See the day-by-day itinerary on the following pages.)

EXPERIENCE & EXPERTISE



Our unparalleled 4-person expedition team aboard the *National Geographic Sea Bird* and *National Geographic Sea Lion* or 6-person team

aboard the *National Geographic Quest* is key to an in-depth experience in this region. An expedition leader, historian, geologist and naturalist/Lindblad-National Geographic certified photo instructor, plus a wellness specialist and video chronicler, will ensure unparalleled understanding and enjoyment of the places and people along our route.

Visit our website to read staff bios for this expedition.

EXPEDITION DETAILS

DATES: 2017 Sep. 19, 20, 26*; Oct. 1, 2, 7*, 8*, 13, 19*, 20* (*Sea Bird/Sea Lion*)
2018 Apr. 12, 18*; Sep. 17, 23*, 29; Oct. 5*, 11, 17* (*Quest*)

**These departures travel from Clarkston, Washington to Portland, Oregon.*

SPECIAL OFFER:

Book now and receive a **\$500 AIR CREDIT** on select 2017 & 2018 departures. New bookings only; subject to availability. Please call for details.

Waves crash at Cape Disappointment, Oregon.

DAY 1: PORTLAND, OREGON/EMBARK

Board our ship and cruise the center of Portland on the Willamette River before reaching the Columbia River. (D)



Sacagawea and son, Fort Clatsop.

DAY 2: ASTORIA

We begin our journey by navigating the Columbia to the mouth of the river at Astoria. At Fort Clatsop, where the explorers hunkered down for the wet winter of 1805-1806, we walk through the full-scale reconstructed fort. Visit the Columbia River Maritime Museum, which chronicles the history of river navigation and this port town. In the afternoon explore more of Lewis and Clark history with several options to choose from. (B,L,D)

FORT CLATSOP

The intrepid spirit of Meriwether Lewis and William Clark permeates this corner of the continental U.S. where they led the Corps of Discovery expedition. At this impeccable replica of the fort, gain a deeper understanding of what these men endured that arduous winter and the ardent curiosity that spurred them to go on.

DAY 3: COLUMBIA RIVER GORGE/HOOD RIVER

This morning we begin our orientation to the Gorge. You'll get a fresh perspective on such highlights as Bonneville Lock and Dam, Beacon Rock, and Multnomah Falls. Continue through the Gorge to Hood River, where we'll visit the Western Antique Aeroplane & Automobile Museum, home to one of the largest collections of still-functioning antique cars and planes in the country, and taste award-winning wines at a local vineyard. (B,L,D)

BONNEVILLE LOCK & DAM

Located 145 river miles from the mouth of the Columbia River, this is the first in an impressive system of eight locks that can lift or lower ships some 700 feet—nearly 10 times what the Panama Canal entails! Before passing through the locks, we sail in the wake of Lewis and Clark to reach Beacon Rock, a giant basalt volcanic plug.

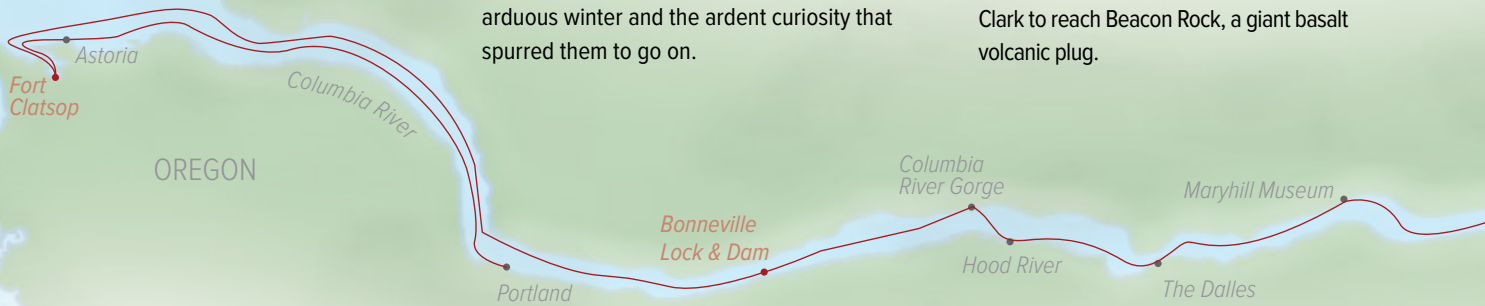

The Dalles, Oregon and Mt. Hood.

DAY 4: THE DALLES/MARYHILL MUSEUM

Visit the Columbia River Gorge Discovery Center to learn about the region's natural history. Hike or take bicycles along the beautiful river trail. In the afternoon we'll visit the Maryhill Museum with its impressive collection of Rodin sculptures and drawings, extensive collection of Native American baskets, and other fascinating exhibits. (B,L,D)



Riding bikes back from the Columbia Gorge Discovery Center.

PALOUSE FALLS

The geology of this region reveals the story of a restless land forged through the eons. Palouse Falls, created by cataclysmic Ice Age floods, is one stunning result of these phenomena. Prepare to witness the true force of nature as the 198-foot-tall falls drop dramatically into the cavernous plunge pool below.



DAY 5: EXPLORING THE PALOUSE RIVER

The still water of the Palouse River is the perfect mirror for the surrounding basalt cliffs as we set off cruising on our Zodiac and kayak adventures. Visit Palouse Falls, where cascading waters plunge into the pool below. Afterwards, sail up the Snake River, enjoying a taste of local specialties. (B,L,D)

DAY 6: CLARKSTON, WASHINGTON

At Clarkston, we find ourselves at the confluence of the Snake and Clearwater rivers, more than 450 miles from the sea. Travel by comfortable jet boat up the Snake River into one of North America's most scenic spots, spectacular Hells Canyon. (B,L,D)

HELLS CANYON

Rugged and remote, Hells Canyon is America's deepest, river-cut canyon. Board jet boats for a front-row seat to the towering canyon cliffs formed from layer after layer of basaltic lava flows. And keep your cameras close for stellar photo ops—the Seven Devil Mountains rise as high as 8,000 feet above the Snake River here and Rocky Mountain bighorn sheep graze on the steep hillsides.

DAY 7: CLARKSTON/DISEMBARK

Transfer to Lewiston, Idaho or Spokane, Washington for connecting flights home. (B)

NATIONAL GEOGRAPHIC PHOTOGRAPHERS

Join National Geographic photographer and naturalist **Jeff Mauritzen** (pictured right) on the Oct. 1 & 7, 2017



departures and National Geographic photographer **Jonathan Kingston** (pictured left) on the Sep. 19 & Oct. 5, 2018 departures.



PRE- AND POST-EXTENSIONS

Both extensions can be combined with an overnight in Portland. Please call for details.

Portland City Tour

Half-day guided exploration of the city's must-see highlights, neighborhoods and lush parks.

Willamette Valley Wine Tour

Combine the Portland City Tour with a visit to a few of the region's most acclaimed boutique wineries.



Zodiac and kayak adventures on the Palouse River.

SAVOR THE FLAVORS OF THE REGION

We are proud to provision our ships in perfect harmony with the terrain we explore. As you follow these grand rivers, our menus follow the flow of the seasons, providing you with the freshest, most local fare possible. Our dedicated team has crafted a culinary program that raises the bar on local-ity, sustainability, and seasonality. Throughout the journey you'll taste the region's very soil, air, and water in the form of delicious fruit, vegetables, cheese, fish, and meat, plus wines and craft beer.



“We’re turning our guests into locavores by supporting Pacific Northwest producers almost exclusively. Our goal is to cross-utilize ingredients from a 150-mile radius, manage our fisheries, and provision sustainable products with minimal processing, no added hormones or antibiotics. We also continue to rely on providers who have earned a Food Alliance certification—this esteemed designation ensures that food is produced by well-treated workers; that meat products come from humanely raised animals; and that the regional soil, water, and wildlife habitats are protected and enhanced.”

—Ana Esteves, Manager Hotel Operations, Lindblad Expeditions





SALMON STRAIGHT FROM THE RIVER

Weekly updates on salmon runs sent by our supplier help us map out our menu. Dine on King (chinook) and Coho salmon fished directly from the Columbia and, depending on time of year, from surrounding tributaries like the Cowlitz, Kalama and Lewis rivers.

FORAGED MUSHROOMS

A special delivery in Portland brings us the best of the hunt from fields and forests within a 50-mile radius, changing with the seasons and availability.

UPCYCLING-SUSTAINED MEAT AND BEER

New to our vendor list, Fulton Farms and Oregon Natural Meats upcycle over 20 million pounds of brewer's grain from Ninkasi Brewery each year. Normally disposed of in landfills, this grain now feeds the cattle from which they produce ground beef. Enjoy both their meat and beer on board.

FARM-TO-SHIP PRODUCE

We've cultivated deep relationships in the region allowing our chefs to handpick produce from places like Moscow Farmers Market, Drapers Girl Farm, Pullman Farmers Market and Wilson Banner Ranch where we buy local apples, multiple types of squash, hackberries, pears, and fresh apple cider. Customized produce deliveries from Duck Delivery bring additional seasonal delicacies aboard.

CHEERS TO LOCAL WINE & BEER



Local wines served aboard represent the various growing areas and grape varieties which embody the region's best—including vintners like Sokol Blosser whom we have

worked directly with for eight years. Located on 85 acres of organic estate in the Willamette Valley, this family-owned and -run winery is committed to sustainable practices, from reducing water and energy usage to maintaining beehives that contribute to the bee population. Enjoy their wines by the glass or the bottle at dinner and Recap each evening. And for beer aficionados aboard we also serve an array of the region's best craft brews like Full Sail or Deschutes.

Above: Gourds from one of our vendors, a family farm along the Columbia River; bell peppers; display of handmade goat cheeses. Opposite page: Cascade Cliffs vineyard.



Oregon's Mt. Hood emerges from the clouds with autumn vine maple ablaze.

SEE, DO & LEARN MORE WITH A FIRST-RATE TEAM

Your time on the river and ashore will be spent in the company of a veteran expedition team that's passionate about the region's rich history. Relive the heroic tales of the Corps of Discovery through the eyes of your historian. Join your geologist and naturalist to marvel at layers of ancient basaltic lava. Capture a great blue heron perched sentinel-like on the river bank with help from a Lindblad-National Geographic certified photo instructor. Or unwind one evening with a massage from your wellness specialist. With one expert aboard for every 15 guests, you're ensured diverse knowledge, varied points of view and engaging companionship.

MARYLOU BLAKESLEE, Expedition Leader

Naturalist, lecturer and artist, Marylou spends her summers as a park ranger at Glacier Bay National Park and has traveled the world sharing her love of wild places.



LINDA BURBACK, Certified Photo Instructor

An accomplished photographer and horticulturalist, Linda has worked in the commercial cactus industry as well as the interpretive division of Saguaro National Park.



DR. ROBERT GATTEN, JR., Historian

Emeritus Professor of Biology at the University of North Carolina at Greensboro and former President of the Lewis and Clark Trail Heritage Foundation.



GRACE WINER, Geologist

An educator, naturalist, and expert geologist, Grace has studied volcanism in Alaska, the geology of diamonds, and much more.



▶ PLEASE VISIT [EXPEDITIONS.COM/EXPERTBIOS](https://www.expeditions.com/expertbios) AND SELECT YOUR ITINERARY TO FIND OUT WHICH STAFF WILL BE ABOARD.

NATIONAL GEOGRAPHIC

CAPTURE THE STORY OF YOUR EXPEDITION WITH NATIONAL GEOGRAPHIC

From the unrivaled beauty of the Columbia River Gorge to the moody silhouette of Mount Hood, you'll find photo ops around every bend. A Lindblad-National Geographic certified photo instructor is aboard every voyage to offer assistance, instructions, and shooting tips in the field to ensure you go home with your best photos ever.



NEW SHIP



NATIONAL GEOGRAPHIC QUEST

CAPACITY: 100 Guests in 50 cabins.
REGISTRY: United States.
OVERALL LENGTH: 238 feet.

National Geographic Quest (launching 2017) will be the latest addition to our fleet. Designed with over 50 years of expedition heritage and built in the U.S.A., *Quest* will set a new standard in exploration and comfort.

PUBLIC AREAS: Global gallery; fitness center, LEXspa, lounge with full service bar and facilities for films and presentations; observation deck, mudroom with lockers for expedition gear, and a partially covered sundeck with chairs and tables. Our “open bridge” provides guests an opportunity to meet our officers and captain and learn about navigation.

MEALS: Served in single seatings with unassigned tables for an informal atmosphere and easy mingling. Breakfast is a wide selection buffet and dinner is served family-style. Menu emphasizes local fare.

CABINS: All cabins face outside with windows or portholes, private facilities and climate controls. Category 4 cabins have step-out balconies.

EXPEDITION EQUIPMENT: A fleet of 8 Zodiacs and 24 kayaks, Remotely Operated Vehicle (ROV), hydrophone, splashcam, underwater video camera, video microscope, paddleboards, snorkeling gear for all guests (where applicable).

SPECIAL FEATURES: Guest internet access, elevator, Lindblad-National Geographic certified photo instructor, a video chronicler and undersea specialist.

WELLNESS: The vessel is staffed by a wellness specialist and features a gym with an elliptical machine, treadmill, exercycles, handweights and resistance bands. Treatments in the LEXspa are available by appointment.



Insets clockwise from top (Artist’s renderings): The lounge, with 270° views, is the hub of the expedition community; a spacious and open sundeck will provide unparalleled views.



Clockwise from top left (Artist's renderings): Category 5 cabins accommodate a third guest on a comfortable fold down sofa bed; dining room; Category 4 cabin with its step-out balcony.

CATEGORY 1: Main Deck #301-306 Cabins feature two lower single beds that can convert to a Queen, a writing desk and two portholes.

CATEGORY 2: Main Deck #307-315 Cabins feature two lower single beds that can convert to a Queen, a writing desk and two portholes.

CATEGORY 3: Upper Deck #201-206 Cabins feature two lower single beds that can convert to a Queen, a writing desk and two large view windows.

CATEGORY 4: Upper Deck #207-229 Cabins feature two lower single beds that can convert to a Queen, a writing desk, sliding glass door, and small, private balcony.

CATEGORY 5 (SUITE): Observation Deck #101-108 Cabins feature two lower single beds that can convert to a Queen, large view windows, an expanded bathroom, writing desk, ample storage space, and a convertible sofa bed to accommodate a third person.

NOTE: Sole Occupancy cabins are available in Categories 1 and 2 only. Third person rates are available in Category 5 cabins at one half the double occupancy rate.

Connecting Cabins via internal doorway access: Main Deck: #312-314, #311-315, #306-308, #305-307; Upper Deck: #224-226, #225-227

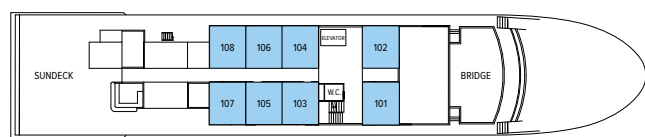

OBSERVATION DECK

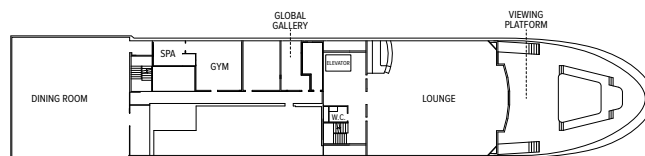

LOUNGE DECK



UPPER DECK



MAIN DECK

Prices are per person, double occupancy unless indicated as solo.

ITINERARY	YEAR	CAT. 1	CAT. 2	CAT. 3	CAT. 4	CAT. 5 SUITE	CAT. 1 SOLO	CAT. 2 SOLO	ADVANCE PAYMENT	NOTE
Columbia & Snake Rivers Journey: Harvests, History & Landscapes	2018	\$4,890	\$5,690	\$6,650	\$7,390	\$8,190	\$7,340	\$8,540	\$750	We will gladly assist in making your air arrangements. Please call for airfares from your departure city.

NATIONAL GEOGRAPHIC SEA BIRD & SEA LION

CAPACITY: 62 guests in 31 outside cabins.

REGISTRY: United States.

OVERALL LENGTH: 152 feet.

PUBLIC AREAS: Our ships feature a library; global market; lounge with full-service bar and facilities for films, slide shows and presentations; observation deck; partially covered sundeck with chairs and tables, and LEXspa. Our “open bridge” provides guests an opportunity to meet our officers and captain and learn about navigation.

MEALS: Served in single seatings with unassigned tables for an informal atmosphere and easy mingling. Breakfast is a wide-selection buffet and lunch is often served family style. Menu emphasizes local fare.

CABINS: All face outside with windows, private facilities, and climate controls.

EXPEDITION EQUIPMENT: Bow camera, hydrophone, kayaks, Splash-Cam, underwater video camera, video microscope, and expedition landing craft.

SPECIAL FEATURES: Guest Internet access. A video chronicler and undersea specialist are on board all voyages.

WELLNESS: The vessel is staffed by a wellness specialist and features exercise equipment, LEXspa, and outdoor stretching area.

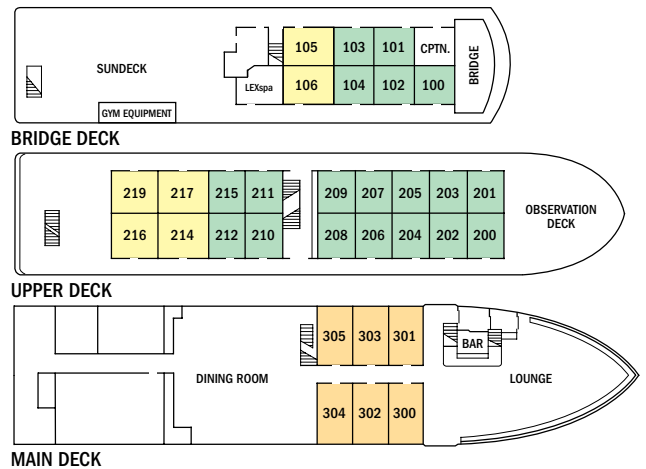

Prices are per person, double occupancy unless indicated as solo.

CATEGORY 1: Main Deck #300-305 — Conveniently positioned between the dining room & lounge, these cabins feature two single lower beds, and a large view window.

CATEGORY 2: Bridge Deck #100-104; Upper Deck #200-212, 215 — These well-located cabins include two lower single beds & a view window.

CATEGORY 3: Bridge Deck #105, 106; Upper Deck #214, 216, 217, 219 — These cabins feature a seating unit with table and two large view windows. Upper Deck cabins include two lower single beds which can convert to a double bed and a pull-out single bed for a third person; Bridge Deck cabins include two lower single beds only.

Note: Sole Occupancy cabins are available in Categories 1 and 2 only. Third person rates are available in certain categories at one half the double occupancy rate.

Shared Accommodations: Shares can be arranged at the double occupancy rate in Categories 1 and 2 only.

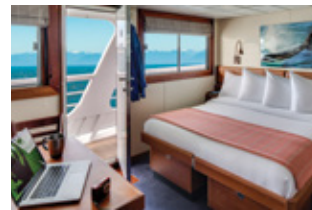

Clockwise from top left: twin beds can be pushed together to form a double in Category 3 cabins on the Upper Deck; enjoy an assortment of wines while dining; Category 2 cabin freshly redesigned.

Prices are per person, double occupancy unless indicated as solo.

ITINERARY	YEAR	CAT. 1	CAT. 2	CAT. 3	CAT. 1 SOLO	CAT. 2 SOLO	ADVANCE PAYMENT
Columbia & Snake Rivers Journey: Harvests, History & Landscapes	2017	\$4,890	\$5,690	\$6,650	\$7,340	\$8,540	\$750

RESERVATION INFO

Costs Include: All accommodations aboard ships per itinerary or similar, all meals and nonalcoholic beverages aboard ship, meals on land as indicated, complimentary wine and beer tastings, air transportation where indicated as included, shore excursions, sightseeing and entrance fees, use of kayaks (where available), special access permits, transfers to and from group flights, tips (except to ship's crew), taxes and service charges, and services of our expedition staff.

Not Included: Air transportation (except where shown as included), extensions, passport, visa, immigration fees, meals not indicated, travel protection plan, items of a personal nature such as alcoholic beverages (except wine and beer tastings on board), e-mail, voyage DVD, laundry. Gratuities to ship's crew are at your discretion.

Airfare: For all programs, airfare is an additional cost unless otherwise indicated. We will gladly assist in making your air arrangements for a \$50 per person service fee.

TERMS & CONDITIONS

Reservations: To reserve your place, an advance payment is required at the time of reservation. The per person advance payment amount varies by program, and is outlined in our brochures, as well as on our website. Payment is accepted by Visa, MasterCard, American Express, Discover, or by check. Receipt of your initial payment indicates your acceptance of our complete Terms and Conditions. We require written notice at the time of reservation for any physical condition, diet, or treatment requiring special attention. Once your reservation is confirmed, we urge you to use your personalized online account for important information to help you prepare for your voyage. Managing your documents online will facilitate fast and accurate communication, and allow you to provide us with pertinent details we require, in order to complete your reservation. Your online account gives you access to your Expedition Guide, which includes valuable information specific to your voyage. You can also use your online account to make easy payments, view recommended flights and reading material, packing list, and so much more.

Final Payment: Final payment is due 90 days prior to departure.

Travel Protection Plan: We recommend that you take advantage of our Travel Protection Plan. This plan offers comprehensive coverage to protect you from cancellation fees, costs incurred due to trip delays/interruption, damaged or lost luggage, medical assistance, and evacuation during your travels. Our Travel Protection Plan is available for U.S. and Canadian residents only, and may be purchased any time prior to final payment due date. If you are not satisfied for any reason, you may return your plan within 10 days after purchase. Your premium will be refunded if cancelled within 10 days, provided you have not already departed on the trip or filed a claim. When so returned, the coverage under the plan is void from the original date of purchase.

Smoking Policy: Smoking is allowed only in designated outdoor areas.

Responsibility and Other Terms & Conditions: Among other things, limitations of Lindblad Expeditions' and the National Geographic Society's liability for loss of property, injury, illness or death during the voyage will be provided to all guests on the ship's ticket sent prior to departure, and are also available on our website at www.expeditions.com/terms, or upon request. By registering for a trip, the guest agrees to all such terms and conditions.

Note: Itineraries and prices listed in this brochure are as of publication date, and are subject to change. The company reserves the right to impose surcharges based on increases in the company's actual cost of fuel or other unexpected expenses.

CANCELLATION POLICY	
Number of Days Prior to Expedition Start	Per Person Cancellation Fee
120 or more days	\$350
119–90 days	Advance payment cost
89–60 days	25% of total fare
59–45 days	50% of total fare
44–0 days	No refund

\$350 will be rewarded in the form of a Lindblad Expeditions Travel Certificate. This cancellation policy applies to expeditions, extensions (with the exception of Denali), as well as all other additional services. The effective date of a cancellation will be the date on which your cancellation notice is received. Any revisions you make within the cancellation penalty period, such as departure date or choice of voyage, are subject to cancellation fees.

Note: Airline cancellation policies vary by carrier, as well as the type of fare used to issue your ticket.

Our group cancellation policy is listed in the Terms and Conditions section of our website, or you may call us for details. We stress the importance of purchasing a travel protection plan to protect yourself from fees in the event you need to cancel your reservation.

**United States Tour Operators Association
\$1 Million Travelers Assistance Program**

Lindblad Expeditions, as an Active Member of USTOA, is required to post \$1 Million with USTOA to be used to reimburse, in accordance with the terms and conditions of the USTOA \$1 Million Travelers Assistance Program, the advance payments of Lindblad Expeditions customers in the unlikely event of Lindblad Expeditions bankruptcy, insolvency or cessation of business. Further, you should understand that the \$1 Million posted by Lindblad Expeditions may be sufficient to provide only a partial recovery of the advance payments received by Lindblad Expeditions. More details of the USTOA Travelers Assistance Program may be obtained by writing to USTOA at 345 Seventh Avenue, Suite 1801, New York, New York 10001, or by email to information@ustoa.com or by visiting their website at www.USTOA.com.



We are proud to be a Founding Member of Adventure Collection—a family of the world's most trusted and experienced active travel companies. Each member company of Adventure Collection is dedicated to enriching the lives of its guests and to giving back to the areas in which it travels. For more information visit www.AdventureCollection.com.



©2017 Lindblad Expeditions
Lindblad Expeditions and the Eye are the trademarks of Lindblad Expeditions. All rights reserved.
NATIONAL GEOGRAPHIC and the Yellow Border are the trademarks of the National Geographic Society. All rights reserved.

Photo Credits: Marc Cappelletti, Larry Geddis/Alamy, Ralph Lee Hopkins, Jonathan Kingston, Rich Kirchner, Jeff Litton, Craig Lovell/Alamy, Jeff Mauritzen, Susan Moebus, Emily Mount, Michael S. Nolan, Ryder Redfield, Rich Reid, Marco Ricca, Rikki Swenson, David Vargas, Leon Werdinger/Alamy.

For Reservations:
Contact your travel advisor or Lindblad Expeditions
1.800.EXPEDITION (1.800.397.3348)
Reservation Hours: Monday – Friday 9am – 10pm ET
Saturday & Sunday 10am – 5pm ET

Lindblad Expeditions, Inc., 96 Morton Street, New York, NY 10014
Phone: 212.261.9000 • Fax: 212.265.3770

email: explore@expeditions.com For additional information and online reservations, visit us on the Web: www.expeditions.com



96 Morton Street
New York, NY 10014

PRSR STD
U.S. POSTAGE
PAID
LINDBLAD
EXPEDITIONS

Account Number:



Expedition Code:

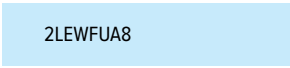

2LEWFUA8

1.800.EXPEDITION | WWW.EXPEDITIONS.COM

♻️ Printed on 10% recycled content paper with soy-based inks. We recommend that you pass this along for others to enjoy or recycle.

LEW-067

SPECIAL OFFER: \$500 AIR CREDIT ON SELECT 2017 & 2018 DEPARTURES—CALL FOR DETAILS

SELECTED HONORS & AWARDS

- » Condé Nast Traveler’s Readers’ Choice Award—Top Small Ship Cruise Lines, 2016, 2015, 2014
- » Virtuoso “Best VAST Partner” Award, 2016
- » Cruise Critic Editor’s Pick Awards “Best for Adventure,” 2016, 2013, 2012, 2011, 2010
- » 2016 World Tourism Award
- » Andrew Harper’s Reader Choice Awards: Best Cruise Lines, 2016
- » Town & Country Cruise Awards: Best for Families and Onboard Activities, Expedition Cruises, 2016
- » Porthole Cruise Magazine Readers’ Choice Awards: Best Expedition Cruise Line, 2015
- » Tourism Cares Travel Philanthropy Awards: Legacy in Travel Philanthropy, 2015
- » Condé Nast Traveler’s “Gold List,” 2013, 2009, 2008, 2007, 2006, 2005
- » Virtuoso “Sustainable Tourism Leadership-Supplier” Award, 2013
- » Travel + Leisure “World’s Best” Award for Small-Ship Cruise Lines, 2013, 2012, 2011, 2010, 2009, 2008
- » Travel + Leisure “World’s Best for Families” Award for Small-Ship Cruise Lines, 2012, 2011, 2010, 2009
- » Climate Champion Award to Sven Lindblad by Clean Air-Cool Planet, 2009

▶ GO TO WWW.EXPEDITIONS.COM/AWARDS FOR AN EXTENDED LIST.

