

PATAGONIA

EXPLORE THE
GREATEST SYSTEM
OF CONNECTED
NATIONAL PARKS
ON EARTH

TORRES DEL PAINE
CHILEAN FJORDS
STATEN ISLAND
CAPE HORN

+ SUPERB LODGES
IN CHILEAN
PATAGONIA



Bernal Glacier, Patagonia, Chile.

51°52' S, 73°18' W

Setting eyes on the spectacular
glaciers of Patagonia is one
thing, setting foot? That's the
exhilaration of discovery.







EXPLORE ONE OF THE PLANET'S
REMOTEST PLACES AND
EXPERIENCE FAR-FLUNG
ECOSYSTEMS—EFFORTLESSLY





FOR MANY TRAVELERS, THE DESIRE TO VISIT PATAGONIA WAS SPARKED by reading Bruce Chatwin. Published in 1977, his *In Patagonia* was hailed as a masterpiece, revolutionizing the travel genre and making its author famous overnight. It certainly provided our expedition teams with lasting inspiration. We have explored Patagonia often over the decades. However, in 2017/18, we committed our passion and purpose, dedicating *National Geographic Explorer* and *National Geographic Orion* to full expedition seasons each year.

There are many reasons to explore Patagonia, and numerous hurdles to doing so. In Chatwin's time and long after, backpacking and car or bus travel were the only real means to cover great distances. Despite the recent surge of interest in Patagonia and an increase in air travel, getting from Point A to Point B has not improved dramatically, since many Patagonia flights route back up to Santiago and Buenos Aires before connecting back down to Patagonia.

Our four expeditions featured here provide ideal solutions. Not only will you be able to easily and enjoyably traverse great Patagonian distances to experience the astounding diversity, you will also enjoy access to places and opportunities you'd otherwise miss—in the company of our expert team, who will do whatever it takes to ensure you the consummate Patagonia experience.

“On no previous journey am I conscious of having done more. Patagonia is as I expected but more so... Physically it is magnificent... in the east you confront the great wall of the cordillera with bright turquoise lakes (some are milky white and others a pale jade green) with unbelievable colours to the rocks. Sometimes it seems that the Almighty has been playing at making Neapolitan ice cream... alternatively striped vanilla, strawberry and pistachio in bands of 100 feet or more. Imagine an upland lake where the rock face on one side is bright purple, the other bright green, with cracked orange mud and a white rim.”

— BRUCE CHATWIN,
Letter to his wife, Elizabeth



BE AMONG THE FIRST TO EXPERIENCE CHILE'S EPIC NEW ROUTE OF THE PARKS

UNTIL RECENTLY, TORRES DEL PAINE NATIONAL PARK WAS the dominant scenic destination in Chilean Patagonia. But the opening of Chile's *La Ruta de los Parques* (Route of the Parks) in late 2018 has vastly increased the supply of wonders. In March 2017, Kris Tompkins, on behalf of Tompkins Conservation and her late husband, Douglas Tompkins, made the largest donation of privately held land in the world—donating one million acres to the Chilean government, who matched it with an additional nine million acres of federal land. Overnight Patagonia became home to 85 percent of the country's protected lands. Expedition naturalist Eduardo Shaw describes the opportunity this creates for our voyages:



“Patagonia has been my home for almost 30 years. Now, thanks to the tireless work of Kris and the late Douglas Tompkins, Patagonia is enjoying a great moment. Today it is possible to travel over 1700 miles from Puerto Montt to Cape Horn and over that distance pass through 17 National Parks and the more than 60 communities that stand to benefit from an increase in tourism. Also thanks to Kris, we’ve enjoyed special access to Pumalín-Douglas Tompkins National Park; and have long explored the breathtaking Torres del Paine National Park. Now we will travel through Bernardo O’Higgins and Kawésqar National Parks to experience splendid southern Andean beech forests. Navigating the maze of channels and fjords between the Straits of Magellan and Beagle Channel, we will travel into Karukinka, a private reserve, and Alberto De Agostini National Park, and if we’re lucky, a view of the elusive Mount Sarmiento. We hope the finale of our voyage will be a landing at southernmost park on the route: Cape Horn National Park. We all must pray for good weather!”



BREAKING NEWS: KRIS TOMPKINS ABOARD!

We are delighted to announce that Kris Tompkins will join the Oct. 8, 2020 departure of *Epic Patagonia* as a special guest speaker. She will be sharing the adventure with guests October 8-18, from Puerto Montt to Puerto Natales.

THE PARKS INCLUDED IN OUR EXPEDITIONS. ROUTE OF THE PARK NAMES ARE IN ITALICS:

ABOARD NATIONAL GEOGRAPHIC EXPLORER:

1. *Pumalín Douglas Tompkins National Park*
2. *Bernardo O’Higgins National Park*
3. *Torres del Paine National Park*
4. *Kawésqar National Park*
5. *Alberto de Agostini National Park*
6. *Cabo de Hornos National Park*
7. *Laguna San Rafael National Park*
8. Karukinka, special access from the Wildlife Conservation Society
9. Tantauco Park

ABOARD NATIONAL GEOGRAPHIC ORION AND NATIONAL GEOGRAPHIC ENDURANCE

1. *Torres del Paine National Park*
2. *Kawésqar National Park*
3. *Alberto de Agostini National Park*
4. *Cabo de Hornos National Park*
5. Karukinka, special access from the Wildlife Conservation Society.
6. Francisco Coloane Marine Park, *Southern Patagonia* expedition only
7. Magellanes National Reserve, *Southern Patagonia* expedition only





ENJOY EXTRAORDINARY CULTURAL EXPERIENCES

THE CULTURAL HISTORY OF PATAGONIA IS fascinating, and we encounter elements of it on all our voyages, including the culture and long history of the indigenous people of the region, as well as the vibrant *huaso* (gaucho in Argentina) culture. However, *Epic Patagonia* offers a rare opportunity to steep in the unique culture of Chiloé Island on an in-depth visit. Chile's second largest island—Tierra del Fuego is the largest—Chiloé has a layered history featuring ancient indigenous people, who

impressed the Spanish conquistadores with their exceptional canoe dexterity; French whalers; and settlement by Europeans and the introduction of farming. The island also has a diversity of marine fauna, including humpback whales, Peale's dolphins, sea lions, marine otters, plus, Magellanic penguins. What makes Chiloé remarkable, making it a magnet for our time and curiosity, is its vernacular architecture—specifically, its incomparable, beautiful wooden churches, designated UNESCO World Heritage status.



A TRADITIONAL CURANTO EXPERIENCE

Archaeologists have found a number of ancient middens along Chiloé's coast, testifying that the early inhabitants were nomads who hunted, fished, and collected clams and mussels—the essential ingredients of the enduring *curanto* tradition. A *curanto* is prepared by digging a one and a half-yard hole in the ground, covering the bottom with logs and stones, and lighting a bonfire on top to bring the stones to red-hot. Traditional ingredients—shellfish, certain types of fish, meat, potatoes, *chapaleles* (potato dumplings) and vegetables—are layered over the stones. Each layer is covered with fig or white cabbage leaves. The “oven” is then covered with wet sacks, earth and grass chunks—creating a giant pressure cooker. In approximately one hour, it's done. Our authentic *curanto* lunch (on the *Epic Patagonia* itinerary only) will be delicious and highly memorable—for the setting as well as the appetizing flavors and textures.



THE CHURCHES OF CHILOÉ ISLAND

Enduring structures made of wood are wonderful to encounter in any context, and Chiloé's native timber churches are outstanding, unique in a South American architectural tradition dominated by Spanish colonial architecture. They represent a tradition, initiated by the Jesuit Peripatetic Mission in the 17th and 18th centuries, and continued and enriched by the Franciscans during the 19th century. More importantly, they originated through a fusion of Spanish (Jesuit) culture and the local population's skills and traditions. Chiloé is a place beloved by the Chileans and it is a privilege to experience it. A rewarding learning opportunity, exploring Chiloé is also a chance to benefit from our National Geographic photographer's expertise—to capture truly unique and beautiful subjects, and document a memory-bank worthy part of your expedition.

PRIVILEGED ACCESS TO THE ISLAND AT THE END OF THE WORLD





ISLA DE LOS ESTADOS, ALSO KNOWN AS STATEN ISLAND, HAS been so seldom seen that it holds a near-mythic place in the region's collective consciousness. In 2015, ours was the first outside expedition ship granted the privilege to travel here since it was essentially closed off to tourism decades ago. Since 2012, members of our expedition staff have worked with authorities to develop guidelines for responsible tourism. Now, you can enjoy an island of exceptional interest with extraordinary wildlife. Blue-eyed shags nesting in the tussock grass. Magellanic penguins heading down to the sea to feed. South American fur seals basking on the rocky shoreline, and in the crystal clear waters, South American sea lions swirling through the beautiful kelp beds.

We are proud to have helped to pave the way for sustainable eco-tourism to the island. All of our voyages call at Staten Island, so no matter which you choose, you'll have the unique opportunity to discover it. Hike through the last stands of forest before the Andes disappear into the Atlantic Ocean, to a knoll overlooking the placid bay where 'the lighthouse at the end of the world' stands, the inspiration for Jules Verne's adventure novel of the same name. (Perhaps you'll join fellow guests reading it on location!) See the evidence of natural forces that impressed Verne. And experience the moving sense of being in sovereign nature.

THE PERFECT PLATFORMS FOR EXPLORING PATAGONIA

NATIONAL GEOGRAPHIC EXPLORER, NATIONAL GEOGRAPHIC ORION, and *National Geographic Endurance* are all equipped for exploring a region that boasts scenic fjords, monumental glaciers, granite spires, rolling pampas, forests, a beckoning island—and little infrastructure of docks or piers. We'll revel in our remoteness, using the ships' fleet of Zodiacs to land on a Staten Island beach. Or deploying the fleet of kayaks to experience the calm beauties of a Chilean fjord. The onboard ROV, guided by our undersea specialist, might discover something even few scientists have seen. And when we're at sea heading to a new destination, each ship is designed to keep you connected to the stunning scenery outside—with expansive decks, acres of glass windows, a warm and welcoming Bridge, plus an observation lounge, library and main lounge conducive to seeing all there is to see and do, including informative talks and presentations. Each ship's galley team is dedicated to keeping your appetite for adventure kindled and sated. And the onboard amenities contrast nicely with the vagaries of Patagonia weather. Cossetting cabins and suites, with our signature feather duvets, offer the perfect ending to active expedition days.



“To the extent our company has a mantra, it's the ‘**tonic of wildness.**’ We believe, as **Henry David Thoreau** did, in the healing power of wild places for the human spirit.”

— SVEN-OLOF LINDBLAD
CEO & Founder
Lindblad Expeditions

▶ See our **NEW** ship, *National Geographic Endurance*
expeditions.com/Endurance

PERFECT PLATFORM





OUR VETERAN TEAM IS ACE AT DOING WHAT IT TAKES

BECAUSE YOU DESERVE AN ABSOLUTELY UNFORGETTABLE

experience, our team will do whatever it takes—from manning the spotting scopes at sea and on land so you don't miss a single wildlife sighting, hiking at your pace, slowing shutter speed to capture a waterfall, or lingering to observe and photograph a guanaco, to ferrying you hot chocolate across the icy straits as you Zodiac-explore spectacular fjords. Our team has the knowledge and the passion for Patagonia that will kindle yours. You'll explore under the expert guidance of a veteran expedition leader, naturalists, a certified photo instructor, and a National Geographic photographer, plus an undersea specialist, wellness specialist, and video chronicler. And our generous expedition staff-to-guest ratio means you can gravitate to the naturalists whose personalities and interests match yours. They'll help you to see, do, and absorb all the extraordinary experiences—in comfort, with inspiration, great conversations, and excellent dining included.



“The tall snow-capped mountains were beautifully lit by the morning sun, and the vast openness of remote Karukinka made one feel small and humbled. As we cruised to shore in our Zodiacs, our naturalist staff spotted the largest existing pinniped, the southern elephant seal. We saw around 100 Andean condors circling and feeding on a dead elephant seal—a rare thing to see! We walked over driftwood, through meadows, and into the fungi-heavy forest. Guests feeling extra adventurous trekked to a scenic waterfall. It was a wonderful introduction to the southern Chilean ecosystem.”

— DAILY EXPEDITION REPORT,
National Geographic Explorer,
Karukinka Park, 2018

A photograph of a person with curly hair, wearing a dark blue jacket, standing on the wooden railing of a ship's deck. They are holding binoculars to their eyes, looking out over a vast, icy landscape. In the background, a massive glacier flows down a snow-covered mountain into a body of water. The sky is bright blue with scattered white clouds. On the ship's railing, there is a red life preserver with the word 'GEOGRAPHIC' visible, and a yellow buoy is attached to the railing. The overall scene is one of a scenic expedition or travel.

WHAT WILL YOU
CREATE WITH
NATIONAL GEOGRAPHIC
PHOTOGRAPHERS TO
INSPIRE YOU?

THERE WILL BE COUNTLESS PHOTO OPS IN PATAGONIA.

Chilotan architecture, beloved by Chileans, including UNESCO World Heritage site churches. Andean condors drifting on the thermals. Towering alerce trees, and the granite spires of Torres del Paine. While you're discovering Patagonia, you'll have the benefit of a National Geographic photographer, plus a Lindblad-National Geographic certified photo instructor (CPI) at your side and at your service. They can help you with anything from camera settings to the basics of composition. Our CPIs are also trained naturalists so they'll help you better understand wildlife behavior. And your National Geographic photographer will help you capture the 'story' and telling details of your experience. Now, every guest—from iPhone camera users to advanced hobbyists can stand side-by-side with top photographers, pick up tips in the field, and take great photos you'll be proud to share.

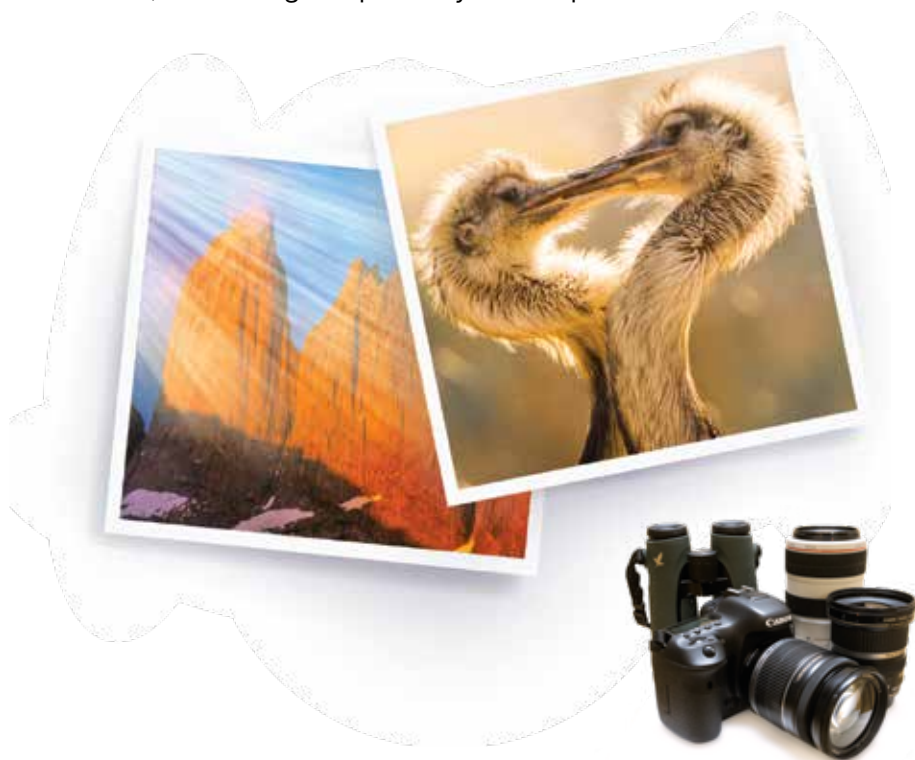

KIKE CALVO

*Patagonia: Chilean Fjords &
Argentina's Staten Island*
Mar. 8, 2020

*Best of Chilean Patagonia: From
Torres del Paine to Cape Horn*
Mar. 8, 2020 (voyage only)

KRYSTLE WRIGHT

*Epic Patagonia: Fjords, Peaks &
Forests*
Oct. 8, 2020

JAY DICKMAN

*Southern Patagonia: Glaciers,
Fjords & Wildlife*
Feb. 25, 2021

▶ Visit expeditions.com/ngps to learn more about these National Geographic Photographers and see the entire roster.



**EXCLUSIVE
GEAR LOCKER**

Our partnership with acclaimed retailer B&H

Photo Video enables us to offer our guests the opportunity to field test the best new lenses from Sigma, camera bodies from Canon, mirrorless cameras from Olympus and Sony and more during their expedition. Yearning to try some big glass? Looking to research a new camera purchase? Excited to aim binoculars with Swarovski optics on Patagonian subjects? Dive in to the B&H gear locker with our compliments. Take advantage of our exclusive booked guest B&H discounts pre-trip, too. Ask an Expedition Specialist, or visit expeditions.com/BHPHOTO.



THE EXPEDITIONS MAPPED OUT AND ROUTED FOR YOU ON THE following pages offer you the luxury of choice—without precluding any highlights. The 16-day *Best of Chilean Patagonia* offers you a combination of land and sea experiences. You'll savor the grandeur of Torres del Paine's sunrises and sunsets, its iconic landscapes, and its profusion of wildlife during a three-day stay at the Tierra Patagonia Hotel & Spa, a National Geographic Unique Lodge of the World, or Explora Patagonia Hotel Salto Chico. Then explore fjords, glaciers, and panoramic vistas aboard *National Geographic Orion*. Venturing out on Zodiac forays, kayaking the pristine fjords, or hiking virgin trails, you'll breathe the rarefied air of a near-mythic region. Enjoy special access to Argentina's Isla de los Estados (Staten Island)—a seldom-seen island covered in wind-sculpted flora, with abundant South American fur seals. Discover the vast parklands of Karukinka. And if the weather gods are with us, you can check viewing legendary Cape Horn off your life list. The 12-day *Patagonia: Chilean Fjords & Argentina's Staten Island* provides the same peak experiences, but in a more compact timeframe, and without the land stay.

EAGER TO EXPLORE MORE? Consider one of our rewarding extensions. See pages 28-29.

BEST OF CHILEAN PATAGONIA: TORRES DEL PAINE TO CAPE HORN—INCLUDES ARGENTINA'S STATEN ISLAND

16 DAYS/13 NIGHTS ABOARD

NATIONAL GEOGRAPHIC ORION

PRICING FROM: \$16,230*

EXPEDITION DETAILS

DATES 2020: Oct. 22; Nov. 15; 2021: Mar. 7*

*This voyage travels in reverse.

ITINERARY AT-A-GLANCE

- Days 1 & 2 U.S./Santiago, Chile
- Day 3 Fly to Punta Arenas/Drive to Puerto Natales
- Days 4-6 Torres Del Paine National Park/Spend three days in an outstanding lodge
- Day 7 Torres Del Paine National Park/
Puerto Natales/Embark
- Days 8 & 9 Kirke Narrows & Exploring Chilean Fjords
- Day 10 Exploring Tierra Del Fuego/
Karukinka Natural Park
- Day 11 Exploring the Beagle Channel
- Day 12 Cape Horn
- Days 13 & 14 Isla de los Estados (Staten Island), Argentina
- Days 15 & 16 Ushuaia/Disembark/Santiago, Chile/U.S.

▶ Find the complete day-by-day ITINERARY, DATES, AND RATES at expeditions.com/patagonia

*Per person, double occupancy based on Category 1, valid as of the time of printing, subject to modification, and not guaranteed until booking and required deposit are made. See all terms and conditions at expeditions.com/terms

GATEWAYS TO WILDNESS

Puerto Natales is one of Patagonia's southern gateways. Check into The Singular Hotel Patagonia. Tour the town and dine at the hotel.

ICONIC PARKLANDS

Explore Torres del Paine National Park by hiking, horseback riding, sailing among icebergs to the foot of the immense Grey Glacier, visiting the Salto Grande waterfall, and seeing the towers of the central massif from the Blue Lagoon. Look for guanacos, rheas, and condors.

STUNNING FJORDS

Myriad fjords or *senos* indent the coast. Cruise deep into the *senos*, punctuated at the end by tidewater glaciers. We'll look to make stops in the extensive maze of channels and islands of the Chilean fjords, where we may go out to explore by Zodiac and kayak or take a forest walk.



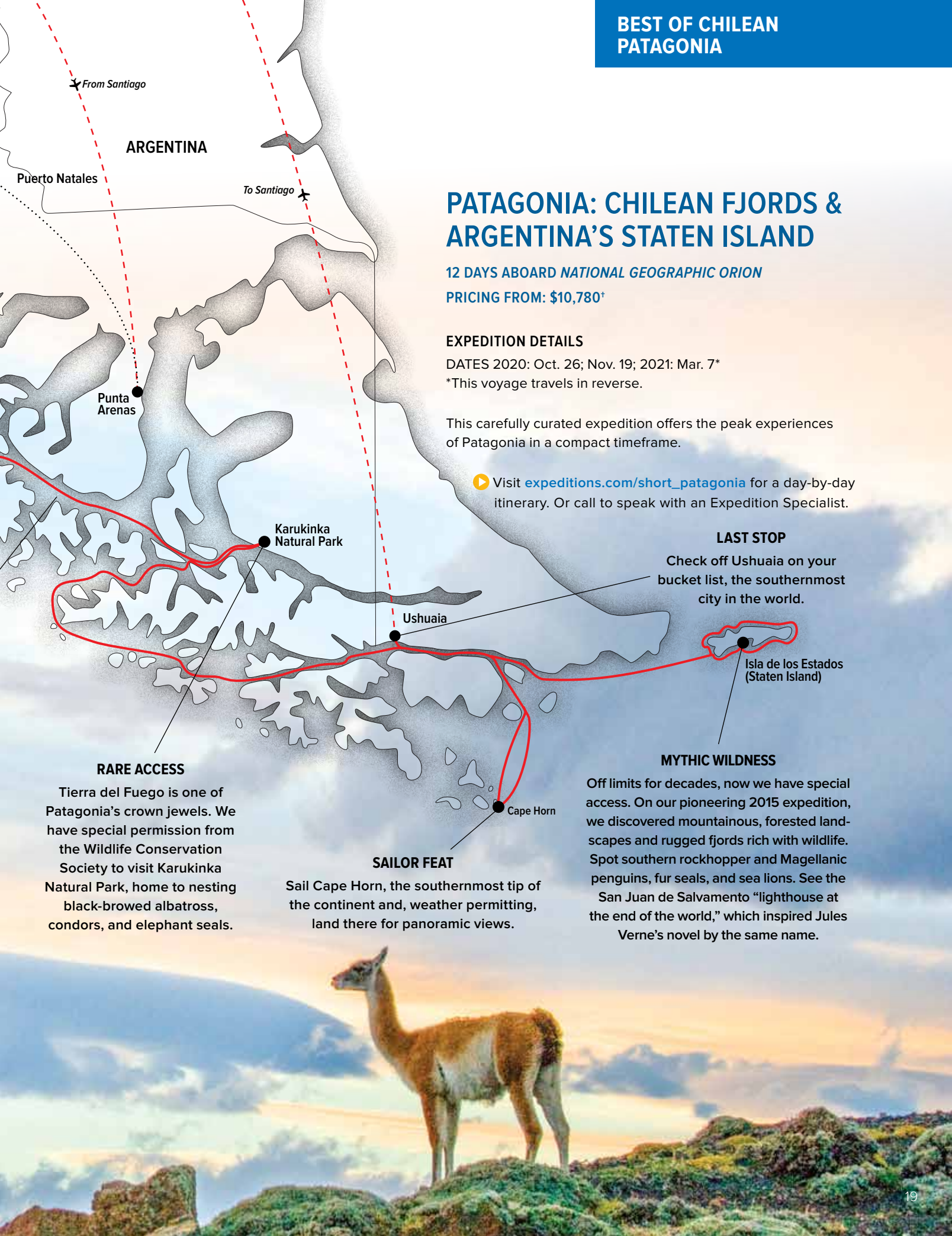

PATAGONIA: CHILEAN FJORDS & ARGENTINA'S STATEN ISLAND

12 DAYS ABOARD *NATIONAL GEOGRAPHIC ORION*

PRICING FROM: \$10,780*

EXPEDITION DETAILS

DATES 2020: Oct. 26; Nov. 19; 2021: Mar. 7*

*This voyage travels in reverse.

This carefully curated expedition offers the peak experiences of Patagonia in a compact timeframe.

▶ Visit expeditions.com/short_patagonia for a day-by-day itinerary. Or call to speak with an Expedition Specialist.

LAST STOP

Check off Ushuaia on your bucket list, the southernmost city in the world.

Isla de los Estados
(Staten Island)

MYTHIC WILDNESS

Off limits for decades, now we have special access. On our pioneering 2015 expedition, we discovered mountainous, forested landscapes and rugged fjords rich with wildlife. Spot southern rockhopper and Magellanic penguins, fur seals, and sea lions. See the San Juan de Salvamento "lighthouse at the end of the world," which inspired Jules Verne's novel by the same name.

SAILOR FEAT

Sail Cape Horn, the southernmost tip of the continent and, weather permitting, land there for panoramic views.

RARE ACCESS

Tierra del Fuego is one of Patagonia's crown jewels. We have special permission from the Wildlife Conservation Society to visit Karukinka Natural Park, home to nesting black-browed albatross, condors, and elephant seals.





FROM CHILOÉ ISLAND TO THE WILDS OF TIERRA DEL FUEGO TO THE pinnacles of Torres del Paine National Park and the legendary Beagle Channel, experience the full sweep of Patagonia at close range aboard *National Geographic Explorer* on our 20-day *Epic Patagonia*. Venture deep into Chile's glorious fjords. Pass incandescent icebergs and massive glaciers, and watch for elephant seals, Andean condors, guanacos, and penguins. Experience a swath of the newly minted Route of the Parks, and enter the private reserve of Karukinka by special permission. Explore Chiloé, beloved by Chileans, with its vernacular architecture and unique UNESCO World Heritage-designated timber churches. Enjoy a *curanto* lunch, a tradition that dates back to the original people who inhabited the archipelago some 7,000 years ago. Chile is 4,300 miles long and contains many different climates, so it produces the widest array of ingredients of any country in the world. And, of course, there are the wines. *National Geographic Explorer* will add a sommelier to the expedition team to enhance your enjoyment. Cap off the adventure on Argentina's Staten Island, coming face-to-face with unspoiled nature and thriving wildlife—with our expedition team naturalists, justifiably proud of their role in helping to devise sustainable tourism practices here, and their ability to share this marvelous place with you. And in tribute to mariners' history, we'll sail Cape Horn, earning permission to say, "I've seen it." Or in the very rare event we can land, you'll achieve an explorer's milestone.

EPIC PATAGONIA: FJORDS, PEAKS & FORESTS

20 DAYS/17 NIGHTS ABOARD
NATIONAL GEOGRAPHIC EXPLORER
PRICING FROM: \$19,950*

EXPEDITION DETAILS

DATE 2020: Oct. 8

SPECIAL OFFER

Book by Mar. 31, 2020 for
FREE ROUND-TRIP AIRFARE.
See page 31 for details.

ITINERARY AT-A-GLANCE

Days 1 & 2 U.S./Santiago, Chile
Day 3 Puerto Montt/Embark
Day 4 Chiloé Island: Quellón/Tantauco Park
Day 5 Pumalín National Park
Days 6-10 The Inside Passage & The Chilean Fjords
Day 11 Puerto Natales/Torres del Paine National Park
Days 12 & 13 Tierra del Fuego/Karukinka Natural Park
Days 14 & 15 The Chilean Fjords, Beagle Channel, Cape Horn
Days 16-18 Isla de los Estados (Staten Island), Argentina
Days 19 & 20 Ushuaia/Disembark/Buenos Aires/U.S.

► Find the complete day-by-day ITINERARY, DATES, AND
RATES at expeditions.com/chileanfjords

*Per person, double occupancy based on Category 1,
valid as of the time of printing, subject to modification, and not
guaranteed until booking and required deposit are made. See
all terms and conditions at expeditions.com/terms

PATAGONIA GATEWAY

From Santiago, fly by private
charter air to Puerto Montt,
Chile's northern gateway to
the fjords and Patagonia, and
embark *National Geographic
Explorer*.

TOWERING ICE WALL

Chile's icefield is the longest
in the Southern Hemisphere
and a towering ice wall.
Explore among the fjords of
the Pio XI Glacier, Falcon,
Penguin, or Europa.

SELDOM-SEEN FJORDS

Explore the fjords, tiny
isles, and azure lakes of
the Chilean Fjords by foot,
kayak, and Zodiac.

ICONIC WILDNESS

Search for abundant rheas,
foxes, and guanacos in
the shadow of the iconic
saw-toothed peaks of Torres
del Paine National Park, a
UNESCO Biosphere reserve.

PATAGONIA'S CROWN JEWELS

Venture into Karukinka Natural
Park in Tierra del Fuego, a wildlife
refuge not easily accessible to
the public, to see nesting black-
browed albatross, condors, and
elephant seals.

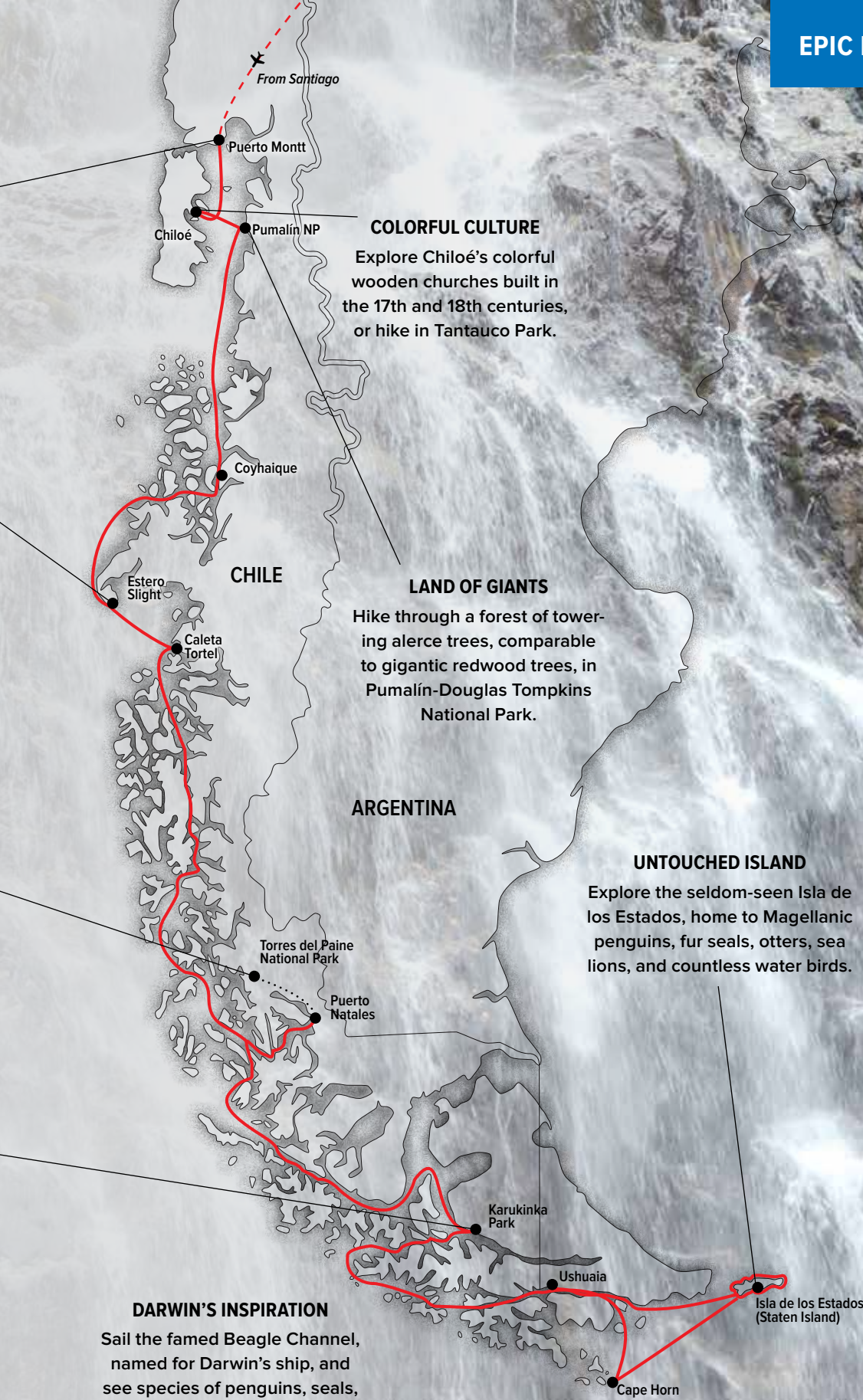

COLORFUL CULTURE

Explore Chiloé's colorful wooden churches built in the 17th and 18th centuries, or hike in Tantauco Park.

LAND OF GIANTS

Hike through a forest of towering alerce trees, comparable to gigantic redwood trees, in Pumalín-Douglas Tompkins National Park.

UNTOUCHED ISLAND

Explore the seldom-seen Isla de los Estados, home to Magellanic penguins, fur seals, otters, sea lions, and countless water birds.

DARWIN'S INSPIRATION

Sail the famed Beagle Channel, named for Darwin's ship, and see species of penguins, seals, and sea lions that he saw and documented.







LONG BEFORE HUMANS ARRIVED ON THE CONTINENT, GLACIERS carved the landscapes of Southern Patagonia and the Chilean fjords. Now aboard the brand-new ultimate polar ship *National Geographic Endurance*, small enough to navigate the Kirke Narrows, and the perfect viewing platform, Patagonia becomes the set of the grandest nature adventures as you cruise where myriad *senos* (fjords) cut between soaring granite walls and cascading waterfalls. “Glacier Alley,” part of the UNESCO-designated Cape Horn Biosphere, contains multitudes. Explore secluded Seno Pia and its impressive glacier; dramatic Seno Garibaldi with the stunning wall of ice that is Garibaldi Glacier; and Seno Agostini, the source of glaciers originating at more than 6,600 feet in elevation. Watch massive calving, spot dolphins and marine life; Zodiac cruise among icebergs; hike rugged landscapes; and observe penguins by the thousands. Explore with all your senses, as we enjoy fine Chilean wines aboard ship. Discover the thrilling scale of iconic Torres del Paine, where guanacos roam the vast steppe. Discover private reserves such as Karukinka; visit the newest marine reserve on the Chilean coast; enjoy special access to Argentina’s extraordinary Isla de los Estados (Staten Island), where you’ll discover the “lighthouse at the end of the world.” And experience the ultimate voyage finale—as we sail Cape Horn. Will we land there so you claim bragging rights for life? The weather on arrival holds the key!

SOUTHERN PATAGONIA: GLACIERS, FJORDS & WILDLIFE

19 DAYS/16 NIGHTS ABOARD

NATIONAL GEOGRAPHIC ENDURANCE

PRICING FROM: \$19,450*

EXPEDITION DETAILS

DATE 2021: Feb. 25

ITINERARY AT-A-GLANCE

Days 1 & 2 U.S./Buenos Aires, Argentina
Day 3 Fly to Ushuaia/Embark
Days 4 & 5 Exploring the Chilean Fjords: Beagle Channel
Day 6 Francisco Coloane Marine Park
Days 7 & 8 Puerto Natales/Torres del Paine National Park
Days 9 & 10 Kirke Narrows & Chilean Fjords
Day 11 Punta Arenas & Isla Magdalena
Days 12 & 13 Tierra del Fuego: Karukinka Natural Park
Days 14-17 Cape Horn/Isla de los Estados
(Staten Island), Argentina
Days 18 & 19 Ushuaia/Disembark/Buenos Aires/U.S.

▶ Find the complete day-by-day ITINERARY, DATES, AND RATES at expeditions.com/glaciers

*Per person, double occupancy based on Category 1, valid as of the time of printing, subject to modification, and not guaranteed until booking and required deposit is made. See all terms and conditions at expeditions.com/terms

CHILE

Torres del Paine National Park

EPIC LANDSCAPES

Discover the gem-colored lagoons, forests, grasslands, glaciers, and saw-toothed peaks of Torres del Paine where rheas, foxes, and herds of guanaco roam.

VERDANT FJORDS

Sail through the Kirke Narrows and discover a maze of pristine channels and islands to be explored by Zodiac and kayak.

GLACIER ALLEY

Spend two days exploring stunning glaciers where the Andes meet the sea among soaring granite walls, mirror-still lakes, waterfalls galore, and tiny islands blanketed in vegetation.

MASSIVE MARINE PARK

Venture into the fast-moving, wildlife-rich channels of the vast Francisco Coloane Marine Park where humpback whales and other cetaceans congregate.





ARGENTINA

Puerto Natales

From/To Buenos Aires ✈

URBAN CULTURE

Explore Punta Arenas, Patagonia's largest city, with a local guide to learn about its archaeology and buy local handicrafts, or hike the Magallanes National Reserve with sweeping views of the valley and city.

SELDOM-SEEN WILDNESS

By special permission explore the private reserve of Karukinka with its abundant wildlife, including endangered culpeo foxes, guanacos, black-browed albatross, Andean condors, and elephant seals. At Isla Magdalena, visit the Penguins National Nature Reserve, home to 120,000 nesting Magellanic penguins.

SOUTHERNMOST CITY

Begin and end your adventure in Ushuaia, the city at the end of the world, and sail the Beagle Channel, a mariner milestone.

SAILOR MILESTONE

Sail Cape Horn, the southernmost tip of South American, and make a landing if conditions permit to look south to the Drake Passage.

WILD ISLAND

Discover remote Isla de los Estados, home to Magellanic penguins, fur seals, otters, sea lions, and countless water birds, and see the "lighthouse at the end of the world," which inspired Jules Verne's novel of the same name.



MAKE THE MOST OF YOUR TIME IN THE REGION—EXTEND & EXPLORE MORE

ADD SANTIAGO & THE CASABLANCA WINE VALLEY

PRE-VOYAGE/2 DAYS/2 NIGHTS

2020/21*: \$2,850 per person, double occupancy.

Get a taste for Santiago's world-famous cuisine at premier restaurants, and venture into wine country for tastings at Chile's top wineries. Visit Santiago's charming neighborhoods, backed by the spectacular Andes, and then head outside the city for private tours of historic wineries, meeting the winemakers, and sampling their wares in scenic settings.



ADD BUENOS AIRES

PRE-VOYAGE/2 DAYS/2 NIGHTS

2020/21*: \$2,390 per person,
double occupancy

Explore vibrant Buenos Aires on a curated two-day extension that showcases the city's beguiling personality. See its famous Beaux-Arts architecture, and the brightly painted bohemian communities of La Boca and San Telmo, with their cafes, galleries, and street art. Visit top museums and take in an authentic tango performance.



ADD IGUAZÚ FALLS

POST-VOYAGE/3 DAYS/3 NIGHTS

2020/21*: \$3,050 per person,
double occupancy.

Taller than Niagara, Iguazú Falls' monumental Devil's Throat thunders 350 feet down into a river canyon—an incredible display of power. Get close on catwalks to experience the raw force and noise of the cascades. Stay at the only hotel within Argentina's Iguazú National Park, a UNESCO World Heritage site, owing to its beautiful landscapes and subtropical forest, with 450 species of birds, including toucans and parrots, butterflies, orchids, and howler monkeys.



ADD EASTER ISLAND

POST-VOYAGE/4 DAYS/4 NIGHTS

2020/21*†: \$4,680 per person, double occupancy.

Take advantage of proximity to one of the most remote and mysterious places on Earth—Easter Island. Home to more than 600 giant *moai*, or stone statues, carved by the ancient Rapa Nui, this tiny island is almost 1,200 miles from its nearest island neighbor. Where did these people come from and why did they carve these giant stone statues? Learn from key archaeologists about the ancient Rapa Nui culture that grew up in isolation.

**Note: Due to airline schedules, on select departures the extension spends an additional night in Buenos Aires; additional cost applies.*

**Note: On all extensions airfare is not included; additional cost applies.*





NATIONAL GEOGRAPHIC EXPLORER

CAPACITY: 148 guests in 81 outside cabins.

REGISTRY: Bahamas. **OVERALL LENGTH:** 367 feet.

National Geographic Explorer is a state-of-the-art expedition ship. It is a fully stabilized, ice-class vessel, with an ice-reinforced hull, enabling it to navigate polar passages while providing exceptional comfort. It carries kayaks and a fleet of Zodiac landing craft. An undersea specialist operates a Remotely Operated Vehicle (ROV) and sophisticated video equipment, extending access to the underwater world.

PUBLIC AREAS: Bistro bar; chart room; restaurant; global gallery; library; lounge with full service bar and state-of-the-art facilities for films, slideshows, and presentations; mudroom with lockers for expedition gear; and observation lounge. Our "open Bridge" provides guests an opportunity to meet our officers and captain and learn about navigation.

MEALS: Served in single seatings with unassigned tables for an informal atmosphere and easy mingling. Menu is international with local flair.

CABINS: All cabins face outside with windows or portholes, private facilities, and climate controls. Some cabins have balconies. Cabins are equipped with Ethernet and Wi-Fi connections and USB ports for mobile devices.

EXPEDITION EQUIPMENT: Zodiac landing craft, kayaks, Remotely Operated Vehicle (ROV), hydrophone, splash-cam, underwater video camera, aerial remote controlled camera and video microscope.

SPECIAL FEATURES: A full-time doctor, undersea specialist, National Geographic photographer, Lindblad-National Geographic certified photo instructor and video chronicler, internet café and laundry.

WELLNESS: The vessel is staffed by a wellness specialist and features a glass-enclosed fitness center, outdoor stretching area, a LEXspa treatment room and sauna.

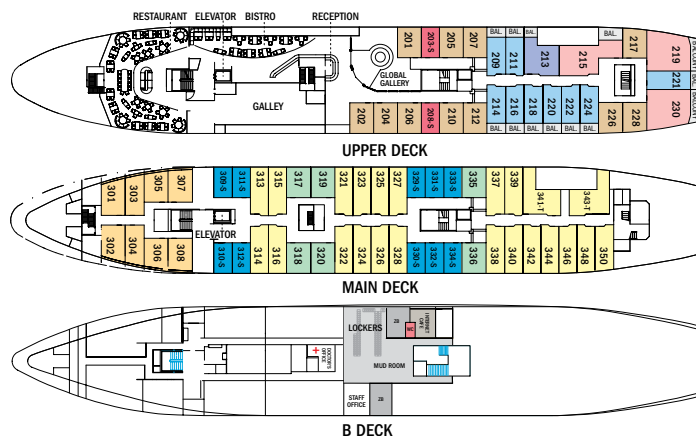
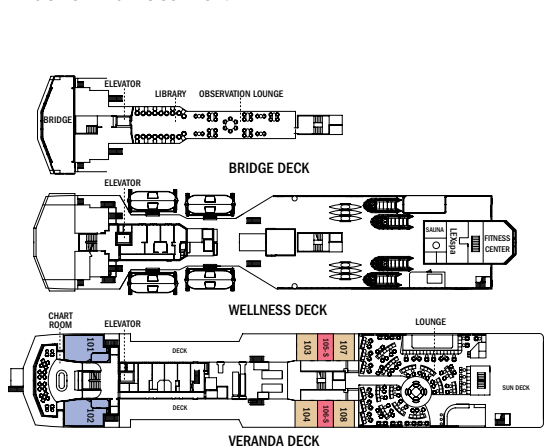



Left to right: Dining is completely casual with no assigned seating; relax in the spa; Category 7 suite; Upper Deck cabin with balcony; standard bathroom.

CATEGORY 1: Main Deck with one or two portholes
#301-308

CATEGORY 2: Main Deck with window #317-320, 335-336

CATEGORY 3: Main Deck with window #313-316, 321-328,
337-340, 342, 344, 346, 348, 350

CATEGORY 4: Upper and Veranda Decks with window
#103-104, 107-108, 201-202, 204-207, 210, 212, 217, 226, 228

CATEGORY 5: Upper Deck with balcony #209, 211, 214,
216, 218, 220-222, 224

CATEGORY 6: Veranda Deck—Suite #101-102;
Upper Deck—Suite with balcony #213

CATEGORY 7: Upper Deck—Suite with balcony
#215, 219, 230

CATEGORY A SOLO: Main Deck with window #309-312,
329-334

CATEGORY B SOLO: Upper and Veranda Decks with
window #105-106, 203, 208

CATEGORY 3 TRIPLE: Main Deck with window #341, 343

Note: Solo occupancy cabins available in Categories A and B. Shared accommodations available in Categories 1 and 2. Note: Cabins #209, 211, 214, 216-218, 220, 222, 224, 226, 228, 303-306—These cabins have one queen-sized bed. All other double cabins have two lower single beds; some can convert to a queen-sized bed. Third person rates available at one-half the double occupancy rate in designated triple occupancy cabins. Cabins \$341, 343, 101, 102, 215, 219, and 230 can accommodate a third person.

SPECIAL OFFER: Book by Mar. 31, 2020 for FREE ROUND-TRIP economy airfare Miami/Santiago, Buenos Aires/Miami, and internal flights Santiago/Puerto Montt, Ushuaia/Buenos Aires. Plus, we will cover your bar tab and tips to the crew.

Prices are per person, double occupancy unless indicated otherwise.

ITINERARY	YEAR	CAT. 1	CAT. 2	CAT. 3	CAT. 4	CAT. 5	CAT. 6	CAT. 7	CAT. A SOLO	CAT. B SOLO	ADVANCE PAYMENT	NOTE
Epic Patagonia: Fjords, Peaks & Forests—Pages 20-23	2020	\$19,950	\$21,450	\$22,330	\$23,660	\$27,970	\$32,560	\$37,300	\$26,770	\$27,800	\$2,500	Includes one hotel night in Santiago. Immigration fees are not included. Sample Airfares: Miami/Santiago, Buenos Aires/Miami: Economy from \$1,000; Business from \$3,300. Internal airfare from \$805 (Santiago/Puerto Montt, Ushuaia/Buenos Aires).

Prices quoted in this brochure are valid as of the time of printing, are subject to modification, and are not guaranteed until booking and required deposit are made. For current rates and details visit [expeditions.com/chileanfjords-rates](https://www.expeditions.com/chileanfjords-rates), call an Expedition Specialist, or your Travel Advisor. For best pricing book early.



NATIONAL GEOGRAPHIC ORION

CAPACITY: 102 guests in 53 outside cabins.

REGISTRY: Bahamas. **OVERALL LENGTH:** 338 feet.

The state-of-the-art *National Geographic Orion* is a fully stabilized, ice-class vessel with an ice reinforced hull. *National Geographic Orion* is at home navigating polar ice, as well as island harbors in the South Pacific.

PUBLIC AREAS: Outdoor café, lounge with bar and state-of-the-art facilities, restaurant, sundeck, reception desk, observation lounge and library, global gallery, and marina platform. The whirlpool hot tub doubles as a plunge pool in warm climates. Our “open bridge” allows guests to meet our captain and officers and learn about navigation.

MEALS: All meals are served in a single seating with unassigned tables for an informal atmosphere and easy mingling. The cuisine is international with local flair, featuring tastes of the regions we explore.

CABINS: All cabins feature ocean views, private facilities, climate controls, and a flat-screen TV. Equipped with Ethernet and Wi-Fi connections and USB ports for mobile devices. Some cabins have French balconies. Single cabins in Category 1 and Category 3 include #301, 322, 323, and 512.

EXPEDITION EQUIPMENT: Zodiac landing craft, a fleet of 24 double kayaks, crow's nest camera, hydrophone, underwater video cameras, splash-cam, video microscope, and a Remotely Operated Vehicle (ROV).

SPECIAL FEATURES: Laundry, a full-time doctor, National Geographic photographer and Lindblad-National Geographic certified photo instructor, plus an undersea specialist and video chronicler.

WELLNESS: A wellness specialist, fitness center, LEXspa treatment room and sauna are on board.

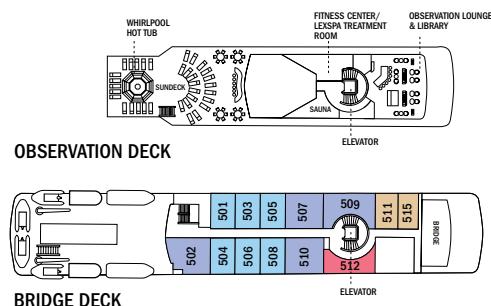
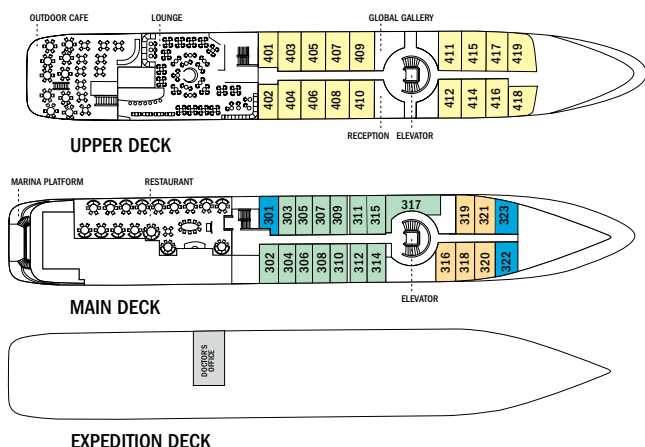



Left to right: Main lounge; National Geographic Orion; our hotel staff will do whatever it takes to ensure your comfort and satisfaction aboard; National Geographic Orion's dining room features no assigned seating for casual, easy mingling; Category 3 suite with window; Category 6 Owner's suite with French balcony.

CATEGORY 1: Main Deck with oval window #316, 318, 319-321

CATEGORY 2: Main Deck with oval window #302-312, 314, 315, 317

CATEGORY 3: Upper Deck—Suite with window #401-412, 414-419

CATEGORY 4: Bridge Deck—Deluxe suite with window #511, 515

CATEGORY 5: Bridge Deck—Suite with French balcony #501, 503-506, 508

CATEGORY 6: Bridge Deck—Owner's suite with French balcony #502, 507, 509*, 510

*Cabin 509 has two windows in lieu of a French balcony.

CATEGORY 1 SOLO: Main Deck with oval window or two portholes #301, 322, 323

CATEGORY 3 SOLO: Bridge Deck—Suite with two windows #512

Note: Solo occupancy cabins available in Categories 1 and 3. Shared accommodations available in Categories 1 and 2. Third person rates available at one-half the double occupancy rate in designated triple occupancy cabins.

ITINERARY	YEAR	CAT. 1	CAT. 2	CAT. 3	CAT. 4	CAT. 5	CAT. 6	CAT. 1 SOLO	CAT. 3 SOLO	ADVANCE PAYMENT	NOTE
Patagonia: Chilean Fjords & Argentina's Staten Island—pages 16-19	2020/2021	\$10,780	\$11,580	\$12,790	\$15,120	\$17,650	\$20,150	\$16,160	\$19,190	\$1,500	Includes one hotel night in Santiago. Immigration fees are not included. Sample Airfares: Round-trip Miami/Santiago: Economy from \$1,000; Business from \$4,000. Internal airfare from \$1,000-\$1,090 (Santiago/Punta Arenas, Ushuaia/Santiago).
Best of Chilean Patagonia: Torres del Paine to Cape Horn—Pages 16-19	2020/2021	\$16,230	\$17,030	\$18,240	\$20,570	\$23,100	\$25,600	\$24,340	\$27,360	\$2,500	Includes one hotel night in Santiago, one hotel night in Puerto Natales and three hotel nights in Torres del Paine. Immigration fees are not included. Sample Airfares: Round-trip Miami/Santiago: Economy from \$1,000; Business from \$4,000. Internal airfare from \$1,000-\$1,090 (Santiago/Punta Arenas, Ushuaia/Santiago).

Prices quoted in this brochure are valid as of the time of printing, are subject to modification, and are not guaranteed until booking and required deposit are made. For all categories, current rates, and details, visit expeditions.com/patagonia-rates, call an Expedition Specialist, or your Travel Advisor. For best pricing book early.



NATIONAL GEOGRAPHIC ENDURANCE

CAPACITY: 126 guests in 69 outside cabins.

REGISTRY: Bahamas. **OVERALL LENGTH:** 406 feet.

National Geographic Endurance is a next-generation expedition ship, purpose-built for polar navigation. A fully stabilized, ice-class Polar Code PC5 (Category A) vessel, it is designed to navigate polar passages year-round, while providing exceptional comfort. Its patented X-bow® provides an extremely smooth ride even in adverse conditions.

PUBLIC AREAS: Two restaurants, a chef's table, observation lounge with bar, gym, wellness area, outdoor hot tubs, library, main lounge with bar, 24-hour beverage station, state-of-the-art facilities for films and presentations, a photo workshop area; lockers for expedition gear, and an "open Bridge" for access to our captain and officers.

MEALS: Two restaurants, featuring local, sustainable choices and unassigned seating for flexible, inclusive dining.

CABINS: All cabins face outside with large windows, private facilities and climate controls. 53 cabins have balconies. Cabins are equipped with expedition command centers with tablets and USB/mobile device docking, TVs, Wi-Fi connections, and hair dryers.

EXPEDITION TOOLS: Zodiac landing craft, kayaks, snowshoes, cross-country skis, Remotely Operated Vehicle (ROV), underwater video camera, hydrophone, aerial remote-controlled camera and video microscope.

SPECIAL FEATURES: A full-time doctor, undersea specialist, National Geographic photographer, Lindblad-National Geographic certified photo instructor, video chronicler, an internet café, and laundry.

WELLNESS: The vessel is staffed by a wellness specialist and features a glass-enclosed yoga studio, gym, spa treatment rooms, and sauna.

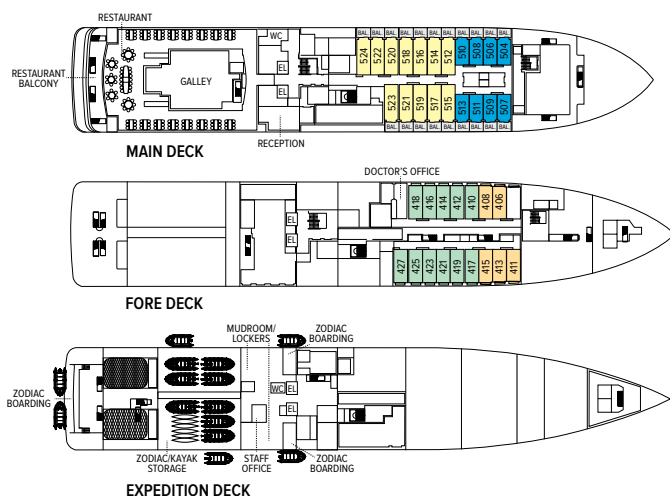
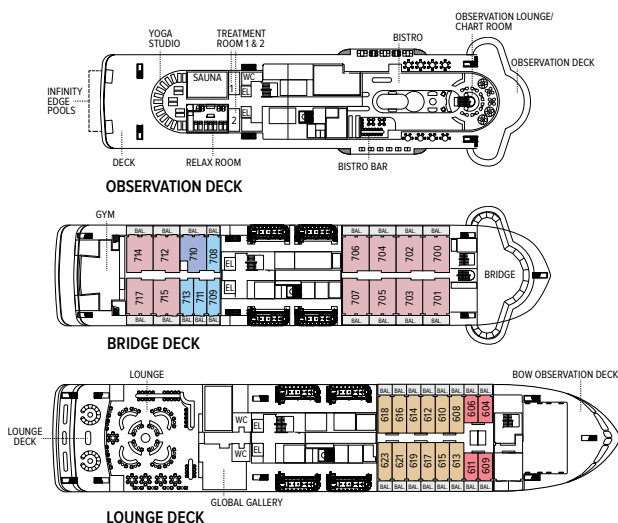



Left to right (artist's renderings): Main restaurant Two Seven Zero°; one of three dining options; *National Geographic Endurance*; fitness center; mudroom; standard cabin; suite with balcony.

CATEGORY 1: Fore Deck with two large windows, alcove seating, relax chair #406, 408, 411, 413, 415

CATEGORY 2: Fore Deck with two large windows, alcove seating, relax chair #410, 412, 414, 416-419, 421-427

CATEGORY 3: Main Deck—Suite with balcony and sofa #512-524

CATEGORY 4: Lounge Deck—Suite with balcony and sofa #608, 610, 612, 613-623

CATEGORY 5: Bridge Deck—Suite with balcony and sofa #708, 709, 711, 713

CATEGORY 6: Bridge Deck—Junior Balcony Suite with large balcony, sofa bed #710

CATEGORY 7: Bridge Deck—Large Balcony Suite with large balcony, sofa bed, bathtub, walk-in closet #700-707, 712, 714-717

CATEGORY A SOLO: Main Deck—Suite with balcony and sofa #504-510, 513

CATEGORY B SOLO: Lounge Deck—Suite with balcony and sofa #604, 606, 609, 611

All cabins have: Ability to set up as queen or two twins, command center with docking for multiple devices, atlas, clock, barometer, TV, phone, digital tablet for onboard info, hair dryer, safe, refrigerator

Prices are per person, double occupancy unless indicated otherwise.

ITINERARY	YEAR	CAT. 1	CAT. 2	CAT. 3	CAT. 4	CAT. 5	CAT. 6	CAT. 7	CAT. A SOLO	CAT. B SOLO	ADVANCE PAYMENT	NOTE
Southern Patagonia: Glaciers, Fjords & Wildlife—Pages 24-27	2021	\$19,450	\$19,990	\$24,380	\$26,990	\$29,990	\$34,500	\$38,260	\$30,450	\$33,760	\$2,500	Includes one hotel night in Buenos Aires. Immigration fees are not included. Sample Airfares: Round-trip Miami/Buenos Aires: Economy from \$1,100; Business from \$3,100. Internal airfare from \$990-\$1,100 (Buenos Aires/Ushuaia/Buenos Aires).

Prices quoted in this brochure are valid as of the time of printing, are subject to modification, and are not guaranteed until booking and required deposit are made. For current rates and details visit [expeditions.com/glaciers-rates](https://www.expeditions.com/glaciers-rates), call an Expedition Specialist, or your Travel Advisor. For best pricing book early.

TAKE ADVANTAGE OF OUR SPECIAL OFFERS

FREE AIRFARE—BOOK BY MAR. 31, 2020: Offers are available on select departures, and based on availability at the time of booking. On voyages with complimentary air offers, airfare is based on economy group flights that must be ticketed by Lindblad Expeditions. In the event that Lindblad's group flights are no longer available at time of booking, we reserve the right to issue a credit. All offers are valid for new bookings only, and may not be combined with other offers and pre- and post-extensions. Call for details.

COMPLIMENTARY BAR TAB & CREW GRATUITIES: We will cover your crew gratuities and shipboard bar tab (excepting certain super-premium brands of alcohol.)

TRAVELING AS A GROUP: Save 5% when traveling as a group of 8 or more people. Take advantage of this great saving, while enjoying traveling with your friends and family. This saving is

applicable to voyage fares only, and is not valid on extensions or airfare. Deposit, final payments, and cancellation policies for group travel vary from our regular policies.

BRINGING THE KIDS: We believe sharing an expedition with your kids or grandkids is a life-enhancing experience. So, take \$500 off for each child under the age of 18.

BACK-TO-BACK SAVINGS: Save 10% on any consecutive journeys taken aboard our ships. This saving is applicable on voyage fares only, and is not valid on extensions or airfare.

COMBINING OFFERS: Certain offers may be combinable, up to two savings opportunities except where noted otherwise. For example, travel with a group of 8 or more on back-to-back expeditions, and take advantage of both savings!

INCLUSIVE PRICING

We include just about everything you have the opportunity to do as part of your expedition aboard ship and ashore. The only things not included are those of a personal nature—internet usage, wellness treatments and other specialized arrangements.

ABOARD SHIP

- ✓ All meals and beverages (excepting certain super-premium brands of alcohol)
- ✓ Cappuccinos, lattes & complimentary refillable water bottle
- ✓ 24-hour coffee, tea & soda on demand
- ✓ Hors d'oeuvres & snacks during lounge recap; teatime with pastries
- ✓ Sauna
- ✓ Fitness center
- ✓ Fully stocked library
- ✓ Mac computers for downloading your camera's memory card & internet access
- ✓ Access to the B+H Photo locker with the latest gear to try out on loan
- ✓ The guidance and company of our expedition staff
- ✓ Complimentary gratuities to the crew

ASHORE

- ✓ Meals on land, as indicated in itinerary, and nonalcoholic beverages with meals
- ✓ Special access permits, park fees, port taxes
- ✓ Transfers to and from group flights
- ✓ Hotel accommodations as indicated in itinerary
- ✓ The expertise of our expedition staff

ACTIVITIES

- ✓ All excursions
- ✓ Zodiac & kayak explorations
- ✓ Lectures & presentations in the lounge

LOG ON TO EXPEDITIONS.COM

Find everything you need to dream, research or plan travel to 60+ destinations worldwide.

**Be part of our expedition community
Join in! Here's how:**

- Check our daily blog:
expeditions.com/blog
- Like us on Facebook: get inspired and chime in: facebook.com/LindbladExpeditions
- Subscribe to our videos on youtube.com/lindbladexpeditions
- Follow [@LindbladEXP](https://twitter.com/LindbladEXP) on Instagram and Twitter, and find Sven Lindblad on Instagram at [@SOLindblad](https://www.instagram.com/SOLindblad).



A MOST EXCEPTIONAL BOOK CLUB



Jules Verne is world famous for his monster classics, *Around the World in Eighty Days* and *Twenty Thousand Leagues Under the Sea*. But he's at his storytelling best in *The Lighthouse at the End of the World*, an adventure story set off the extreme tip of South America—right on Staten Island—and inspired by its actual lighthouse, San Juan del Salvamento. What better opportunity to savor this classic



tale than to discuss it—in anticipation, and on location? Guests on *Epic Patagonia* (10/8/20) can participate in advance on our virtual Facebook Book Club, where we'll post discussion points and intriguing questions about this work, and in person, while taking in the real-life setting of his wild and remote scenes. You'll receive a complimentary copy and Facebook invitation link prior to departure. Happy reading!

RESERVATION INFORMATION

Terms & Conditions: For complete terms and conditions, please visit expeditions.com/terms

Costs Include: All accommodations aboard ship or in hotels per itinerary or similar, all meals and beverages aboard ship (excepting certain super-premium brands of alcohol), meals on land as indicated accompanied by nonalcoholic beverages, air transportation where indicated as included, shore excursions, sightseeing and entrance fees, special access permits, transfers to and from group flights, use of kayaks, tips (including gratuities to ship's crew), taxes and service charges, services of a ship physician and services of our expedition staff.

Not Included: Air transportation (except where shown as included), extensions, passport, visa, immigration fees, meals not indicated, travel protection plan, items of a personal nature, such as internet access, voyage DVD, laundry.

Airfare: For all programs, airfare is an additional cost unless otherwise indicated. Sample airfares are subject to change. We will gladly assist in making your air arrangements for a \$50 per person service fee.

Reservations: To reserve your place, an advance payment is required at the time of reservation as shown on the ship pages. Payment is accepted by Visa, MasterCard, American Express, Discover, or by check. Receipt of your initial payment indicates your acceptance of our complete Terms and Conditions. We require written notice at the time of reservation for any physical condition, diet, or treatment requiring special attention. Once your reservation is confirmed, we urge you to use your personalized online account for important information to help you prepare for your voyage. Managing your documents online will facilitate fast and accurate communication, and allow you to provide us with pertinent details we require, in order to complete your reservation. Your online account gives you access to your Expedition Guide, which includes valuable information specific to your voyage. You can also use your online account to make easy payments, view recommended flights and reading material, packing list, and more.

Final Payment: Final payment is due 120 days prior to departure. Payment schedules may vary for certain longer voyages, due to high demand for these voyages. We reserve the right to cancel your reservation if payment has not been received by final payment due date.

Travel Protection Plan: We strongly recommend that you take advantage of our Travel Protection Plan. This plan offers comprehensive coverage to protect you from cancellation fees, costs incurred due to trip delays/interruption, medical assistance, and damaged or lost baggage, and provides medical assistance and evacuation during your travels. Our Travel Protection Plan is available for U.S. residents only, and may be purchased any time prior to final payment due date. If you are not satisfied for any reason, you may return your plan within 10 days after purchase. Your premium will be refunded if canceled within 10 days, provided you have not already departed on the trip or filed a claim. When so returned, the coverage under the plan is void from the original date of purchase.

Smoking Policy: Smoking is allowed only in designated outdoor areas.

Cancellation Policy: Cancellation penalties may apply after payment is received.

Please visit www.expeditions.com/terms for complete cancellation policies.

Responsibility and Other Terms & Conditions: Certain other provisions concerning, among other things, limitations of Lindblad Expeditions' and the National Geographic Society's liability for loss of property, injury, illness or death during the voyage will be provided to all guests on the ship's ticket sent prior to departure, and are also available on our website at www.expeditions.com/terms, or upon request. By registering for a trip, the guest agrees to all such terms and conditions.

Note: Itineraries and prices listed in this brochure are valid as of publication date, and are subject to change. Under normal conditions, the total expedition cost is guaranteed at the time of booking. However, the published price is determined far in advance of initial departure on the basis of then-existing projections of fuel and other costs. In the event of increases in those costs, including but not limited to increases in the price of fuel, currency fluctuations, increases in government taxes or levies, or increased security costs, we reserve the right to adjust the price of your expedition or add a surcharge to cover such unexpected increases. We will always provide an explanation of the reason for increase in costs. Unused services or items included in our programs are non-refundable.

©2019 Lindblad Expeditions

Lindblad Expeditions and the Eye are the trademarks of Lindblad Expeditions. All rights reserved.

NATIONAL GEOGRAPHIC and the Yellow Border are the trademarks of the National Geographic Society. All rights reserved.

Photo Credits: Norbert Bieberstein/istock, Kike Calvo, Stewart Cohen, David Cothran, Rab Cummings, Danita Delimont/Alamy, Jack Dykinga/NPL, John Elk III / Alamy, Luis Garcia, Andrey Gudkov/istock, Eric Guth, Robert Harding/Alamy, Hemis/Alamy, Ralph Lee Hopkins, Jan Butchofsky Houser, Daniel Ferreira Leitao/Alamy, John Warburton-Lee Photography/Alamy, Luxy Images Limited/Alamy, LightRocket/Getty Images, Michael Luppino, Jeff Mauritzen, Michael S. Nolan, Ocean/Corbis, Design Pics Inc/Alamy, Wayne Ranney, Marco Ricca, Krista Rossow, Gabriel Rojo/Naturepl, Susan Seubert, Superstock, Therin-Weise/Alamy, Craig Wilson, World Pictures, Art Wolfe.

For Reservations:

Contact your travel advisor or Lindblad Expeditions

1.800.EXPEDITION (1.800.397.3348)

Reservation Hours: Monday – Friday 9am –9pm ET

Saturday & Sunday 10am – 5pm ET

Lindblad Expeditions, Inc., 96 Morton Street, New York, NY 10014

Phone: 212.261.9000 • Fax: 212.265.3770

For additional information and online reservations, visit us on the

Web: www.expeditions.com

Account Number:

1.800.EXPEDITION | WWW.EXPEDITIONS.COM

 Printed on 10% recycled content paper with soy-based inks. We recommend that you pass this along for others to enjoy or recycle.

PAT-011

**COMPLIMENTARY
ROUNDTRIP AIRFARE**

Find complete details on page 31.

