

CONVENIENT SEATTLE TO VANCOUVER
ITINERARY, FROM \$4,990

EXPLORING BRITISH COLUMBIA & THE SAN JUAN ISLANDS

GO DEEP INTO WILDLIFE & MYTHIC WONDERS—
WITHOUT GOING FAR FROM HOME

**BOOK NOW AND RECEIVE
\$500 AIR CREDIT PER PERSON ON THE
SEPT. 21, 28 AND OCT. 5, 2017 DEPARTURES**

(PLEASE CALL FOR DETAILS)

BORN IN THESE WATERS, BRAND NEW NATIONAL
GEOGRAPHIC QUEST SETS SAIL! BE AMONG
THE FIRST ABOARD | FALL 2017 INAUGURAL SEASON



Lindblad
Expeditions



NATIONAL
GEOGRAPHIC™

DEAR TRAVELER,

Because you live near the West Coast, you definitely have “the home court advantage.” Every year, travelers from the Midwest, the East Coast, even Europe and Australia fly for hours to join us to experience waters rich in whales, sea lions, harbor seals, and studded with pods of killer whales, among the most interesting animals on earth to many scientists, and among the most photogenic to nature photographers. They’re drawn by the abundant wildlife, and the calm, picturesque waters—a dream to explore aboard our nimble expedition ship, and even more intimately by using our fleet of Zodiacs, kayaks and paddle boards. And to enjoy the fabled wildness and wonder of this region, you just have a short hop to Seattle and/or Vancouver— lucky!

So, if you haven’t already done so, I invite you to experience the diverse nature, native culture and beauty in your own backyard, so to speak. Be among the first to explore these waters aboard the brand-new *National Geographic Quest*—the only expedition ship of its kind to be built in Washington state, on beautiful Whidbey Island. Proudly made in America, *National Geographic Quest* is designed to navigate these waters—threading slender channels and cruising bays, inlets and islands with ease, where large cruise ships cannot go. And she’s a spacious, gracious, and supremely comfortable mobile base camp—rewarding your desires to explore, enjoy the delicious bounty of the region, and retire to a wonderful cabin after each eventful day.

We also have friends here, which is why we can bring you to incredible places off the beaten path and offer private receptions and visits with people who truly care about this region.

I hope you’ll take advantage of your proximity to explore British Columbia and the San Juan Islands with us.

All the best,



Sven-Olof Lindblad



Lindblad
Expeditions



NATIONAL
GEOGRAPHIC™

Lindblad Expeditions and National Geographic have joined forces to further inspire the world through expedition travel. Our collaboration in exploration, research, technology and conservation will provide extraordinary travel experiences and disseminate geographic knowledge around the globe.

Book Now and Receive

**\$500 Air Credit per person on the Sept. 21, 28
and Oct. 5, 2017 departures**

New bookings only; subject to availability
(Please call for details)



Clockwise from top left: Hiking through a forest in the San Juan Islands; Bald Eagle catching fish; Expedition craft; Coastal British Columbia; Guests watch a performance in the big house in Alert Bay; Stream flowing over rocks in forest, San Juan Islands, Washington State; Namgis burial grounds; Sea lion haul-out, Gulf Islands.





Parliament Buildings on the Inner Harbour.

EXPERIENCE A MORE INTIMATE, EXCLUSIVE EXPLORATION OF THE PACIFIC NORTHWEST

that includes access to protected lands, private garden tours—and an after-hours museum reception. Acclaimed natural history artist Robert Bateman is among our worldwide network of friends, and has scheduled a private cocktail reception for our guests at his incredible Victoria museum, which houses seven decades of his sought-after wildlife paintings.

CRUISE THE SAN JUAN ISLANDS ABOARD THE IDEAL SHIP FOR THESE WATERS

These remote and scenic islands are where killer whales are most reliably found in the Northern Hemisphere, so keep your cameras and binoculars at the ready for spectacular sightings. Then get even closer to the picturesque coastlines and wildlife-rich waters on kayaks and Zodiac rides. You'll discover the powerful wildness and warm charm of the San Juan Islands all in the company of the naturalists who know it best and our special access ensures that you'll see and do more.

DISCOVER ALERT BAY'S MYTHS, BEAUTY & LIVING TRADITION

when you go off the beaten path at this thriving First Nations center of art and tradition. Feel history in the drumbeats at a moving, private dance performance in the Big House at **U'mista Cultural Centre**, one of the first established in Canada to preserve the traditions of First Nations people and a cultural beacon for the planet. See the regalia for yourself, illuminated through our experts' extensive local knowledge. Exploring the Centre's stunning displays you'll quickly understand why it is often called, with great affection by elders in the community, 'our box of treasures.'

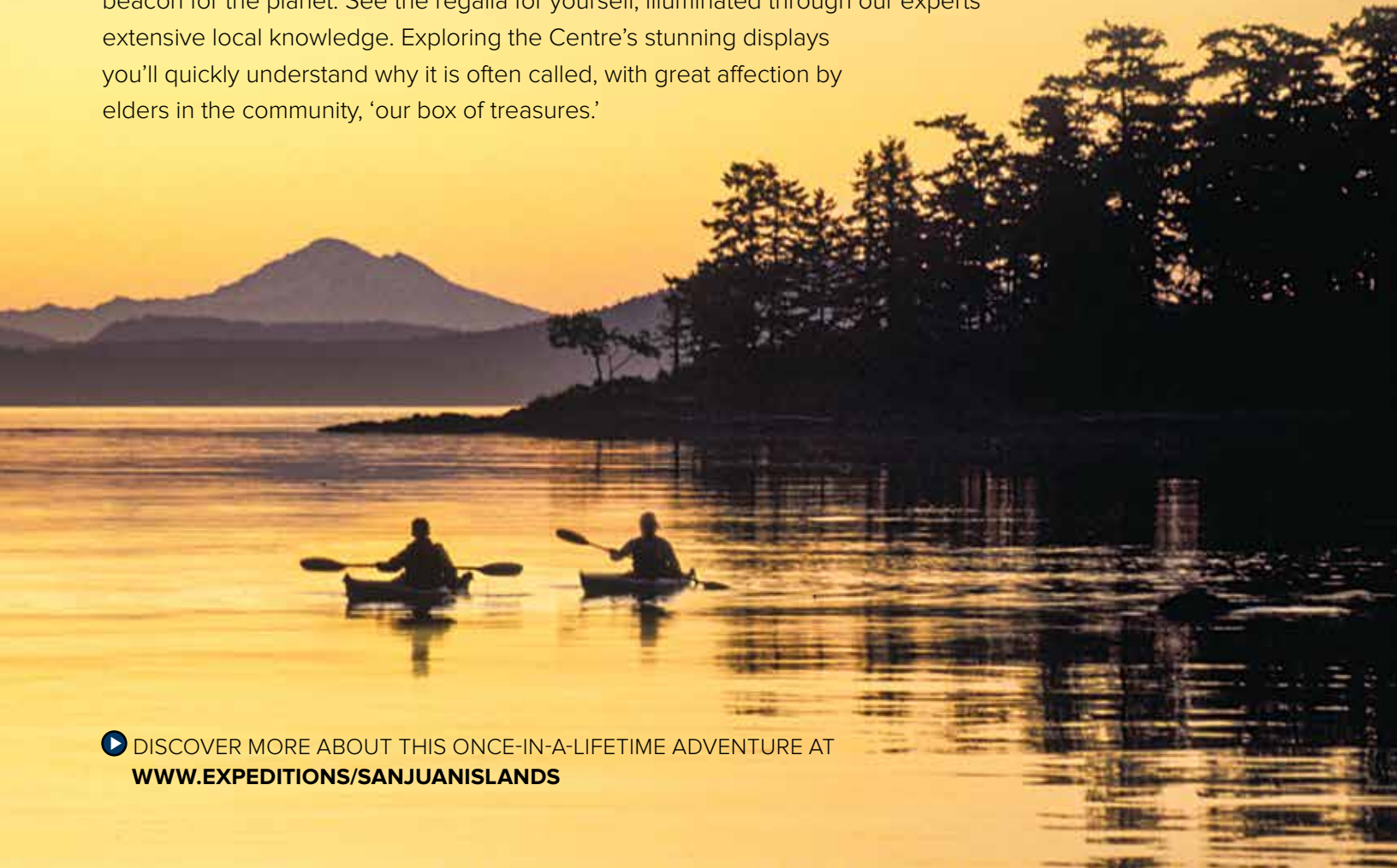

 DISCOVER MORE ABOUT THIS ONCE-IN-A-LIFETIME ADVENTURE AT WWW.EXPEDITIONS/SANJUANISLANDS

EXPLORING BRITISH COLUMBIA & THE SAN JUAN ISLANDS

8 DAYS/7 NIGHTS—PRICES FROM: \$4,990 TO \$8,540

EXPEDITION HIGHLIGHTS

- ▶ Kayak, hike, and expedition landing craft cruise the wildlife-rich coasts of Desolation Sound and the Gulf Islands.
- ▶ Learn the histories of First Nations people through their art and powerful dance performances.
- ▶ Search for killer whales where they're most reliably found in the Northern Hemisphere.
- ▶ Enjoy a private reception at the acclaimed natural history artist Robert Bateman's museum.

DAY 1: SEATTLE/EMBARK

Arrive in Seattle and transfer to *National Geographic Quest* to begin your expedition.(D)

DAY 2: EXPLORING THE SAN JUAN ISLANDS

Today we'll visit the more remote of the San Juan Islands, an archipelago in northern Washington State perfect for kayaking, exploring by Zodiac, and hiking. Search for seals, sea lions, river otters, bald eagles, and killer whales. (B,L,D)

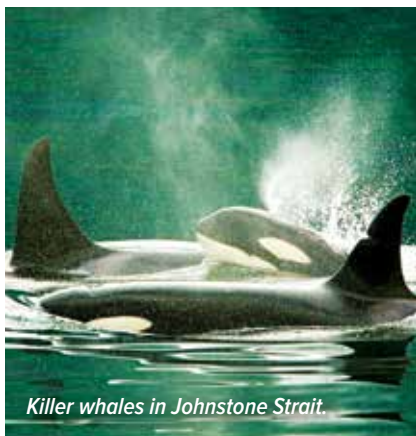

Killer whales in Johnstone Strait.

DAY 3: FRIDAY HARBOR

Explore Friday Harbor, a picturesque town on San Juan Island. Visit the Whale Museum, with its fascinating collection of artifacts, artwork, and whale skeletons. Stop in at small shops and galleries. Later, we'll search for killer whales on our way to British Columbia. (B,L,D)

DAY 4: VICTORIA, BRITISH COLUMBIA

Clear into Canada in the charming city of Victoria and choose from several tailor-made options to explore based on your interests. Visit private gardens, bike along the

waterfront, or peruse the collections at local art galleries. In the evening, enjoy a private reception at the Robert Bateman Centre while taking in the incredible collection of paintings. (B,L,D)

DAY 5: EXPLORING THE GULF ISLANDS

Wake this morning among the Gulf Islands, a rich archipelago in the Strait of Georgia, and a yachter's paradise. We'll take our pick of perfect spots to kayak, hike, and search for wildlife. (B,L,D)

DAY 6: JOHNSTONE STRAIT/ALERT BAY

Sail through Johnstone Strait, a waterway cut through a magnificently wild and scenic area of mountains and islands. These ocean waters are also home to extraordinary whale and bird watching. Today marks a visit to one of the oldest First Nations village sites in British Columbia. Alert Bay on Cormorant Island has been and continues to be the home of the Kwakwaka'wakw people and a center for the living culture found throughout the Northwest Coast. We will visit the U'mista Cultural Centre, opened in 1980. This centre houses one of the finest collections of elaborately carved potlatch masks, regalia and coppers. We'll then walk or ride to the Big House a short distance away where the Tsasala Cultural Group continues the sharing of culture, "educating the world about their songs, dances, teachings and values." (B,L,D)

DAY 7: DESOLATION SOUND

Desolation Sound, on the north end of British Columbia's Sunshine Coast, is a mecca for kayakers and small yachts. It's easy to



understand why, with its calm, sheltered waters and outstanding natural beauty. By kayak there are many isolated bays to poke into and islets that beckon for exploration. On land there are meadows and forest trails for hiking. Tonight, enjoy Captain's Farewell dinner. (B,L,D)

DAY 8: VANCOUVER/DISEMBARK

Vancouver is British Columbia's largest city and the major port for all of western Canada. It lies in a stunning setting, surrounded almost completely by water, with snow-capped mountains rising vertically from its very backyard. After breakfast, disembark the ship for connecting flights home. (B)

EXPEDITION DETAILS

DATES: 2017 Sep 14, 21*, 28; Oct. 5*

*These departures travel in reverse from Vancouver to Seattle making all the same stops.



Victoria, British Columbia.

EXPERIENCE INTRIGUING CULTURES & WILD LANDS UP CLOSE

You'll benefit from our long history of exploring the Pacific Northwest. We've been sailing here for over 35 years forging an institutional knowledge of the best places to reliably find wildlife such as killer whales where these apex predators hunt their prey in narrow, fast moving channels. Our ship is ideally sized to enter and position us for close encounters. You'll be joined by the best team in the business—and with more staff aboard the 100-guest *National Geographic Quest* you'll enjoy a wider breadth of expertise and personality. Explore with expert naturalists, a Lindblad-National Geographic certified photo instructor, cultural experts with deep local knowledge, plus a veteran expedition leader, an undersea specialist, and a wellness specialist.



Representing our full team from left to right: Expedition leader Rab Cummings; Emily Mount naturalist and certified photo instructor; Sharon Grainger cultural expert and certified photo instructor; Eric Guth naturalist and certified photo instructor.



NATIONAL GEOGRAPHIC

TRAVEL WITH NATIONAL GEOGRAPHIC PHOTOGRAPHERS

JEFF MAURITZEN



National Geographic photographer and naturalist Jeff Mauritzen has traveled the world on assignment photographing wildlife for the Society's most recently published *Animal Encyclopedia*. He is a seasoned and popular photography expert, leading adventures that have immersed him in vivid landscapes in all seven continents and more than 60 countries around the world. He joins our **Sept. 14, 2017** voyage to lead photo hikes and offer shooting tips in the field.

PHIL SCHERMEISTER



In the past 25 years, Phil Schermeister has completed more than 40 major assignments for *National Geographic* magazine, its Book division and other publications, including *Range of Light*, *Our National Parks* and *America's Western Edge*. He seeks to find drama in the changing light and seasons as the forces of nature continue to sculpt an unfinished natural landscape. He's the ideal companion for our **Sept. 21, Sept. 28** and **Oct. 5, 2017** voyages.

▶ PLEASE VISIT EXPEDITIONS.COM/EXPERTBIOS AND SELECT YOUR ITINERARY TO LEARN WHICH STAFF IS TRAVELING ON YOUR DEPARTURE

NATIONAL GEOGRAPHIC QUEST

CAPACITY: 100 Guests in 50 cabins.

REGISTRY: United States. **OVERALL LENGTH:** 238 feet.

The *National Geographic Quest* will be the latest addition to the Lindblad-National Geographic fleet. Designed with over 50 years of expedition heritage, *National Geographic Quest* is able to explore the same remote locations we've sought out for decades while setting a new standard in comfort and style.

PUBLIC AREAS: Global gallery; fitness center; LEXspa; lounge with full service bar and facilities for films and presentations; observation deck; mudroom with lockers for expedition gear, and a partially covered sundeck with chairs and tables. Our "open bridge" provides guests an opportunity to meet our officers and captain and learn about navigation.

MEALS: Served in single seatings with unassigned tables for an informal atmosphere and easy mingling. Breakfast is a wide selection buffet and dinner is served family-style. Menu emphasizes local fare.

CABINS: All cabins face outside with windows or portholes, private facilities and climate controls. Category 4 cabins have step-out balconies.

EXPEDITION EQUIPMENT: A fleets of 9 Zodiacs and 24 kayaks, Remotely Operated Vehicle (ROV), hydrophone, splashcam, underwater video camera, video microscope, paddleboards, snorkeling gear for all guests (where applicable).

CATEGORY 1: Main Deck #301-306 Cabins feature two lower single beds that can convert to a Queen, a writing desk and two portholes. **\$4,990**

CATEGORY 2: Main Deck #307-315 Cabins feature two lower single beds that can convert to a Queen, a writing desk and two portholes. **\$5,690**

CATEGORY 3: Upper Deck #201-206 Cabins feature two lower single beds that can convert to a Queen, a writing desk and two large view windows.. **\$6,190**

CATEGORY 4: Upper Deck #207-229 Cabins feature two lower single beds that can convert to a Queen, a writing desk, sliding glass door, and small, private balcony. **\$6,990**

CATEGORY 5 (SUITE): Observation Deck #101-108 Cabins feature two lower single beds that can convert to a Queen, large view windows, an expanded bathroom, writing desk, ample storage space, and a convertible sofa bed to accommodate a third person. **\$7,490**

Note: Sole Occupancy cabins are available in Categories 1 and 2 only. Third person rates are available in Category 5 at one half the double occupancy rate.

Connecting Cabins via internal doorway access: Main Deck: #312-314, #311-315, #306-308, #305-307; Upper Deck: #224-226, #225-227

For Reservations: Contact your travel advisor or Lindblad Expeditions

1.800.EXPEDITION (1.800.397.3348) WWW.EXPEDITIONS.COM

TERMS AND CONDITIONS

Cost Includes: All accommodations aboard ship or in hotels per itinerary or similar, all meals and nonalcoholic beverages aboard ship, meals on land as indicated, air transportation where indicated as included, shore excursions, sightseeing, and entrance fees, use of kayaks (where available), special access permits, transfers to and from group flights, tips (except to ship's crew), taxes and service charges, and services of our expedition staff.

Not Included: Air transportation, (except where shown as included), extensions, passport, visa, immigration fees, meals not indicated, travel protection plan, items of personal nature such as alcoholic beverages, e-mail, voyages DVD, laundry. Gratuities to ship's crew are at your discretion.

Airfare: For all programs, airfare is an additional cost unless otherwise indicated. Sample airfares are subject to change. We will gladly assist in making your air arrangements for a \$50 per person service fee.

Advance Payment: \$750 due at time of booking. Responsibility and Other Terms & Conditions: Among other things, limitations of Lindblad Expeditions' and the National Geographic Society's liability for loss of property, injury, illness or death during the voyage will be provided to all guests on the ship's ticket sent prior to departure, and are also available on our website at www.expeditions.com/terms, or upon request. By registering for a trip, the guest agrees to all such terms and conditions.

Important: Cancellations are subject to penalty. Visit our website for details on our Cancellation Policy and travel Protection Plan.

Note: Itineraries and prices listed in this brochure are as of publication date, and are subject to change.

Photo Credits: All Canada Photos/Alamy, Jennifer Davidson, Danita Delimont/Alamy, Design Pics Inc/Alamy, Sharon Grainger, Rolf Hicker/Alamy, Ralph Lee Hopkins, Jeff Mauritzen/National Geographic Creative, Ron Niebrugge/Alamy, Purestock Rich Reid, David Vargas, Pascal Walschots/agefotostock.

©2017 Lindblad Expeditions and the Eye are the trademarks of Lindblad Expeditions. All rights reserved. NATIONAL GEOGRAPHIC and the Yellow Border are the trademarks of the National Geographic Society. All rights reserved.

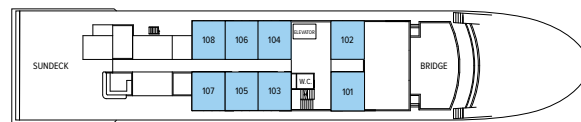

OBSERVATION DECK

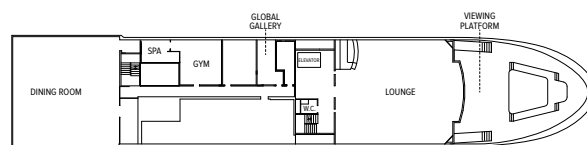

LOUNGE DECK



UPPER DECK



MAIN DECK



Above from left to right: (Artist's renderings): The lounge, with 270° views, is the hub of the expedition community; a spacious and open sun deck will provide unparalleled views.



96 Morton Street
New York, NY 10014

PRSR STD
U.S. POSTAGE
PAID
LINDBLAD
EXPEDITIONS

Account Number:

Expedition Code: 4PNWPA67

1.800.EXPEDITION | WWW.EXPEDITIONS.COM

♻️ Printed on 10% recycled content paper with soy-based inks. We recommend that you pass this along for others to enjoy or recycle.

PNW-067

CONVENIENT ITINERARIES STARTING AT \$4,995

SELECTED HONORS & AWARDS

- » Condé Nast Traveler’s Readers’ Choice Award—Top Small Ship Cruise Lines, 2016, 2015, 2014
- » Virtuoso “Best VAST Partner” Award, 2016
- » Cruise Critic Editor’s Pick Awards “Best for Adventure,” 2016, 2013, 2012, 2011, 2010
- » 2016 World Tourism Award
- » Andrew Harper’s Reader Choice Awards: Best Cruise Lines, 2016
- » Town & Country Cruise Awards: Best for Families and Onboard Activities, Expedition Cruises, 2016
- » Porthole Cruise Magazine Readers’ Choice Awards: Best Expedition Cruise Line, 2015
- » Tourism Cares Travel Philanthropy Awards: Legacy in Travel Philanthropy, 2015
- » Condé Nast Traveler’s “Gold List,” 2013, 2009, 2008, 2007, 2006, 2005
- » Virtuoso “Sustainable Tourism Leadership-Supplier” Award, 2013
- » Travel + Leisure “World’s Best” Award for Small-Ship Cruise Lines, 2013, 2012, 2011, 2010, 2009, 2008
- » Travel + Leisure “World’s Best for Families” Award for Small-Ship Cruise Lines, 2012, 2011, 2010, 2009
- » Climate Champion Award to Sven Lindblad by Clean Air-Cool Planet, 2009

▶ GO TO WWW.EXPEDITIONS.COM/AWARDS FOR AN EXTENDED LIST.

