

WILD ESCAPES

NEW! 11 SHORT
ADVENTURES
IN 8 THRILLING
DESTINATIONS

WILDNESS
WELLNESS &
WONDER
IN LESS TIME

PLUS
SPECIAL
OFFERS

Magdalena Bay, Baja California

24.35° N 112.00° W

THE MOMENT YOU GRASP THAT GRAY WHALES ARE AS INTERESTED IN YOU AS YOU ARE IN THEM

You know the charge you get when you come upon something wild and unexpected, something rare and beautiful? We live for those moments. We sail to the ends of the earth to find them, to discover them anew, and conjure them for our guests.

THAT'S THE EXHILARATION OF DISCOVERY



TABLE OF CONTENTS

Welcome to our new *Wild Escapes* collection.

Choose from 11 action-packed opportunities, from 5 to 9 days.

- 2** Where Awesome Is
- 4** Our Ships
- 6** Go Your Own Way
- 8** All About Teamwork
- 10** National Geographic Photography
- 12** Where Families Connect
- 14** Galápagos & Peru
- 16** Alaska
- 18** Baja California
- 20** California Coast
- 22** Iceland
- 24** Central America
- 26** Dining Aboard
- 28** *National Geographic Islander*
- 30** *National Geographic Quest* and *National Geographic Venture*
- 32** *National Geographic Sea Bird* and *National Geographic Sea Lion*
- 34** *National Geographic Explorer*
- 36** Special Offers
- 37** Reservation Information

A scenic coastal landscape featuring a rocky shoreline in the foreground. Two people are standing on the rocks, looking out at the ocean. The water is a vibrant blue, and the sky is a clear, deep blue with a few wispy clouds. In the distance, there are rolling hills or mountains. The overall mood is serene and adventurous.

INTRODUCING THE *ESCAPES* COLLECTION—
EXPERIENCE WILDNESS, WELLNESS
AND WONDER IN LESS TIME



OUR *WILD ESCAPES* EXPLORE THE SAME EXHILARATING regions as our classic expeditions. They're simply shorter—and, as a result, more convenient for travelers, without the luxury of time to commit to an extended sojourn.

In just five days you can explore a pristine, species-rich U.S. national park, effortlessly traversing the ocean that separates it from California. Or on a weeklong voyage in Galápagos, see the iconic creatures that inspired Darwin, from blue-footed boobies to giant tortoises. Add two days and visit Machu Picchu, too. Go beyond the Blue Lagoon in Iceland to discover far more. Or enjoy close-up encounters with gray whales and their calves in Baja's Magdalena Bay. All in the engaging company of our naturalists for in-depth insights.



Our new *Escapes* collection, 11 action-packed voyages lasting 5 to 9 days, is designed to make every single day of your travels spectacular. So, make the most of your valuable time; spend less of it while having more thrilling moments. Escape with us and discover the best each wild destination has to offer.

SHIPS NIMBLE ENOUGH TO GET YOU DEEP INTO AWESOME PLACES

TO OFFER GUESTS AUTHENTIC, UP-CLOSE EXPERIENCES

in the planet's wild, remote places, we've built a fleet of expedition ships to venture where larger cruise ships can't. They are equipped with landing craft that enables us to explore pristine wild places where there are no docks, ports, or piers. It's this kind of access that lets our guests discover what they might otherwise miss: quiet kayak-able inlets; bike-friendly trails; fjords or mangrove habitats; the thunderous crack of glaciers and foraging bears, or the lush green highlands and grazing giant tortoises; acrobatic sea lions or feeding puffins, and much more. Unparalleled access is what gives you incredible stories to share, a priceless stock of memories, and the best photos of your life.

▶ See each of our ships ahead—on pages 28-35

“We are delighted to introduce you to these ships in our fleet, designed to give a complement of 48 to 148 guests an intimate, inclusive experience of the awesome geographies featured in this brochure. Each ship is well-adapted to the regions it explores, able to give you the exhilaration of authentic, up-close, personal exploring with expert naturalists, and curious, intelligent fellow guests. Choose the itinerary that interests you, assured that any of our purpose-built ships will provide an incomparable feeling.”

— SVEN-OLOF LINDBLAD
CEO & Founder

OUR SHIPS



YOU'RE ON AN ADVENTURE YOU SHOULD HAVE THE FREEDOM TO EXPLORE AS YOU CHOOSE

EACH DAY, WE PROVIDE A FRESH SET OF OPPORTUNITIES, all kinds of choices of what to do. Hike, paddleboard, kayak, snorkel (where relevant), and more. Hang out on deck with binoculars or with your photo instructor. But should you decide to sleep in, have a long, slow breakfast, and get a massage, nobody will look at you funny. You're on vacation. Your vacation. Our schedules are flexible and our itineraries are more a function of what's to see than where we need to be. So, if you want to work up a sweat on your walk, bike, hit the gym, or sit and breathe it all in—do it. It's your adventure. Our generous staff-to-guest ratio means you can always find a naturalist whose interests and approach you share. You're free to explore the ship, find your nook or cranny. And you're always welcome to come up to the Bridge and shoot the breeze with the captain and officers.

There is no U in “group.” Okay, maybe there is—but only if you want there to be. Our idea of group travel means never being herded like cattle. Each day, you choose what activities interest you, which members of the expedition team you want to join, and what other guests you want to hang out with. You may all be on the same ship, but you aren't in the same boat.

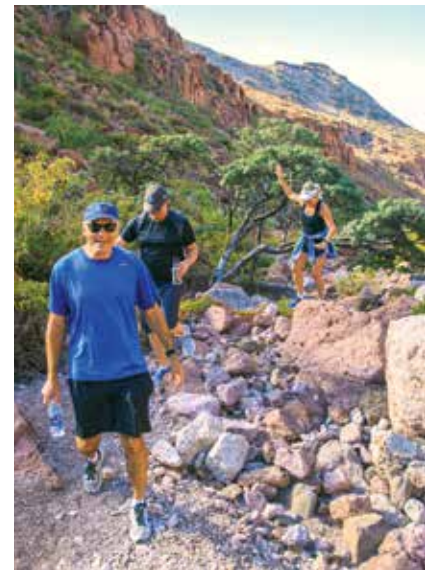





OUR ESCAPES TEAMS ARE
ACE AT DOING WHAT IT TAKES





SOMETIMES EVEN THE MOST INTREPID OF ADVENTURERS NEED a guide—and that’s where we come in. Our team has the knowledge and the passion for the wild world that will kindle yours. They will do whatever it takes, from standing watch so you don’t miss a single passing whale; lingering as long as you want on deck to watch bubble-net feeding or diving pelicans; to offering an extra-long kayak when conditions enable it. They’ll help you to see, do, and absorb all the extraordinary experiences—with inspiration, great conversations, and excellent dining included. Because the undersea is vital to your understanding, we’ve committed the resources to offer what no other expedition travel company does—an exploration of the vivid and surprising world beneath our ships. During voyages, our undersea specialist will don gear, layers of cold-water diving gear where necessary, to explore and shoot video of the marine environment to share during entertaining and informative presentations.



Cool Tools for Exploring

In addition to a fleet of expedition landing craft, kayaks, and stand-up paddleboards, our ships (where relevant) are also stocked with full snorkel gear, including shortie wet suits for all sizes. And many are outfitted with hydrophones to listen to whales and sea lions underwater, and video microscopes for seeing plankton.

A woman in a khaki uniform is taking a photograph of a large tortoise in a grassy field. The tortoise is in the foreground, and the woman is in the background, slightly out of focus. The text is overlaid on the image.

WHAT WILL YOU CREATE WITH
LINDBLAD-NATIONAL GEOGRAPHIC
CERTIFIED PHOTO INSTRUCTORS
TO ASSIST YOU?

WHILE YOU'RE DISCOVERING WONDERS YOU'LL HAVE THE benefit of a Lindblad-National Geographic certified photo instructor (CPI) at your side and at your service. He or she can help you with anything from camera settings to the basics of composition. Now, every guest—from smartphone users to advanced DSLR hobbyists—can stand side-by-side with top photographers, pick up tips in the field, and take great photos. Our CPIs are also trained naturalists so they'll help you better understand wildlife behavior. Whether you're choosing a shutter speed to capture a waterfall or framing a leaping dolphin against a setting sun, in-the-moment tips from accomplished pros will help you return home with your best photos ever.



EXCLUSIVE ONBOARD GEAR LOCKER

Dive into the onboard B&H Photo Video Gear Locker to field test new glass, camera bodies, and more—free (excluding Galápagos). Plus, ask your Expedition Specialist about pre-voyage discounts and benefits.

PHOTO EXPEDITIONS

Trips designated as Photo Expeditions (with this symbol 📷) are select departures on which the pace of travel is optimized to provide abundant opportunities to maximize wildlife encounters, and cover landscapes in the best possible light. They include one-on-one critiques and onboard photo presentations to hone your skills. The following list is representative; to see all 📷 departures and National Geographic photographers, visit expeditions.com/photo

DREW RUSH

Wild Alaska Escape:
Sitka to Juneau
National Geographic Sea Lion
Jul. 15 and Jul. 30, 2020

RICH REID

Wild Alaska Escape:
Juneau to Ketchikan
National Geographic Sea Lion
Jun. 10 and 15, 2020

ERIKA SKOGG

Wild Iceland Escape
National Geographic Explorer
Jul. 12, 2020

▶ A National Geographic photographer might also be traveling on a date that interests you. To learn who is on specific dates, visit expeditions.com/NGPS



THE MOST EXHILARATING DISCOVERIES ARE THE ONES YOU MAKE TOGETHER

WHETHER IT'S KAYAKING OFF A SHORE STUDED WITH FORAGING bears, or cheering on dolphins as they race alongside the ship, we believe shared activities in a wild and exciting environment can bring a family together. Our expeditions ensure seamless family getaways where everything is taken care of. Kids thrive in the safe, comfortable space of the ship where they can exercise a measure of autonomy. Our naturalists and National Geographic certified field educators (on Galápagos and Alaska only) are excellent role models who ably embed learning into every activity. On our Alaska and Galápagos departures we offer the exclusive program described to the right. And since we believe in the value of sharing any of the adventures featured in this brochure with your kids and grandkids for fun, learning, or to celebrate a milestone, we're offering \$500 off on every departure for each child under 18.



Our exclusive program for families, in both Alaska and Galápagos, is the only one of its kind. Developed in conjunction with National Geographic Education, it's designed to help kids and their families develop the attitudes, skills, and knowledge of an explorer. Families discover a unique way to explore and connect with each other and the natural world. And kids engage in a variety of cool optional activities, guided by a National Geographic certified field educator. Visit expeditions.com/family for program details.





ALL THE MAGIC OF GALÁPAGOS

GALÁPAGOS IS A DREAM DESTINATION FOR MANY TRAVELERS. We know: we've been taking thrilled guests there for 50+ years. And now, we're making it possible for those who yearn for the Galápagos experience to have it—in just one week. Adventurous. Exhilarating. Action-packed. From awesome sunrises to dramatic sunsets, plus blue-footed boobies, marine iguanas, giant tortoises, playful sea lions, and much more, you'll experience it all aboard the yacht-scaled 48-guest *National Geographic Islander*.

Don't be surprised if you want to return for more—many have. Or perhaps, you want to take advantage of being there to explore more. In that case, our *Wild Galápagos & Peru Escape* delivers a full dose of natural and human history in one compact illuminating sojourn.



WILD GALÁPAGOS ESCAPE

7 DAYS/6 NIGHTS—ABOARD *NATIONAL GEOGRAPHIC ISLANDER*

FROM: \$5,730 (SEE PAGES 28-29 FOR DETAILS)

Pack a ton of adventure into one action-packed week. With multiple activities each day on land and undersea—including options for walks and hikes, kayaking, paddleboarding, and snorkeling—you'll be assured of the full Lindblad-National Geographic experience.

EXPEDITION DETAILS

2019 Dates: **Aug. 31**; Sep. 5, 14, 19; Oct. 31

2020 Dates: **Feb. 1, 6**; May 9, 14, 23, 28; Jul. 4, 9, 18, 23; Aug. 1, 6, 29; Sep. 3; Nov. 7, 12, 21, 26

Limited Availability

ITINERARY AT A GLANCE

Day 1	U.S./Guayaquil, Ecuador
Day 2	Guayaquil/Galápagos/Embark
Days 3-6	Galápagos aboard <i>National Geographic Islander</i>
Day 7	Disembark/Baltra/Guayaquil/Depart

▶ Visit expeditions.com/wildgala for a day-by-day itinerary.



SPECIAL OFFERS:

- Book by Jul. 31, 2019 for **FREE AIRFARE** from Ecuador to Galápagos on select 2019 and 2020 departures.
- Your bar tab and Wi-Fi are complimentary on all departures. See page 36 or call for details.
- Book six or more under one booking and save 10% on select departures. See page 36 or call for details.

WILD GALÁPAGOS & PERU ESCAPE

9 DAYS/8 NIGHTS—ABOARD *NATIONAL GEOGRAPHIC ISLANDER*

FROM: \$6,570 (SEE PAGES 28-29 FOR DETAILS)

Discover two iconic destinations on one trip. Begin in Peru where you'll journey on the first-class Inca rail between Ollantaytambo and Machu Picchu. Remain late in the day to experience sunset at the fabled sacred site. Then, head to Galápagos to experience the remarkable wildlife and otherworldly terrains.

EXPEDITION DETAILS

2019 Dates: Sep. 7, **21**; **Nov. 2**

2020 Dates: **Feb. 8**; **May 16**, 30; Jul 25; Aug. 8; Sep. 5; Nov. 14, 28

Limited Availability

ITINERARY AT A GLANCE

Day 1	U.S./Lima, Peru
Day 2	Lima/Cusco/Sacred Valley
Day 3	Machu Picchu
Day 4	Sacred Valley/Guayaquil
Days 5-8	Guayaquil/Galápagos aboard <i>National Geographic Islander</i>
Day 9	Disembark/Baltra/Guayaquil/Depart

▶ Visit expeditions.com/wildgalaperu for a day-by-day itinerary.



SPECIAL OFFERS:

- Book by Jul. 31, 2019 for **FREE AIRFARE** from Ecuador to Galápagos on select 2019 and 2020 departures.
- Your bar tab and Wi-Fi are complimentary on all departures. See page 36 or call for details.
- Book six or more under one booking and save 10% on select departures. See page 36 or call for details.

DISCOVER SOUTHEAST ALASKA

WE INTRODUCED OUR *WILD ALASKA ESCAPE: SITKA TO JUNEAU VOYAGE*

in 2017 and it has proved very popular. Highly active, it delivers a thrilling experience of the northern sector of Southeast Alaska—hitting the iconic highlights, like Haines, Alaska’s adventure capital—in an ideal six-day time frame. Now, by popular demand, we’re offering a mirror version: our new *Wild Alaska Escape: Juneau to Ketchikan* that heads south, for more off-the-beaten-track exploration and discovery.

Choose to head north or south to experience Southeast Alaska. Or, elect to do both and experience double the sights, sightings, and wildness—and save 10% on the combined voyage price. Interested? We invite you to speak with an Expedition Specialist for complete details.



WILD ALASKA ESCAPE: SITKA TO JUNEAU

6 DAYS/5 NIGHTS—ABOARD NATIONAL GEOGRAPHIC SEA BIRD AND NATIONAL GEOGRAPHIC SEA LION

FROM: \$4,390 (SEE PAGES 32-33 FOR DETAILS)

Visit Alaskan port cities, then go deep into wildness to seek killer whales, humpback whales, brown bears, bald eagles, and more. Kayak rugged coastlines and secluded inlets, and explore the world's largest temperate rain forest.

EXPEDITION DETAILS

2019 Dates: Jul. 4, 9*, 14, 19*; Aug. 13, 18*, 23, 28* **Limited Availability**

2020 Dates: From May through August, expeditions depart every week.

See our website for specific departure dates.

📷 Photo Expeditions (2020): Jun. 5📷, 20📷; Jul. 15📷, 30📷

*These departures travel in the reverse order, from Juneau to Sitka, making all the same stops.

ITINERARY AT A GLANCE

Day 1	Sitka/Embark
Day 2	Exploring Baranof or Chichagof Island
Day 3	Icy Strait & the Inian Islands
Day 4	Haines
Day 5	Tracy Arm-Fords Terror Wilderness
Day 6	Juneau/Disembark

▶ Visit [expeditions.com/wildalaskanorth](https://www.expeditions.com/wildalaskanorth) for a day-by-day itinerary.

NEW! WILD ALASKA ESCAPE: JUNEAU TO KETCHIKAN

6 DAYS/5 NIGHTS—ABOARD NATIONAL GEOGRAPHIC SEA LION

FROM: \$4,420 (SEE PAGES 32-33 FOR DETAILS)

Discover an Alaska unreachable by big white boats. Board a landing craft to explore Hole in the Wall State Marine Park on Prince of Wales Island, or kayak into salmon-studded waters to trace the wildlife-rich shorelines of Kupreanof and Kuiu Islands—and more.

EXPEDITION DETAILS

2020 Dates: May 21, 26*; Jun. 10📷, 15📷, 30; Jul. 5*, 20📷, 25📷*; Aug. 9, 14*

📷 Photo Expeditions

*These departures travel in the reverse order, from Ketchikan to Juneau, making all the same stops.

ITINERARY AT A GLANCE

Day 1	Juneau/Embark
Day 2	LeConte Glacier/Thomas Bay
Day 3	Exploring Sumner Strait
Day 4	Wrangell
Day 5	Behm Canal/Misty Fjords National Monument
Day 6	Ketchikan/Disembark

▶ Visit [expeditions.com/wildalaskasouth](https://www.expeditions.com/wildalaskasouth) for a day-by-day itinerary.



SPECIAL OFFERS:

- Book now and receive **FREE ROUND-TRIP AIRFARE** between Seattle and Alaska on the Aug. 18 and 23, 2019 departures. See page 36 or call for details.
- Book six or more under one booking and save 10% on select departures. See page 36 or call for details.



SPECIAL OFFERS:

- Elect to take both *Wild Alaska Escape* itineraries and you'll save 10% on the combined price.
- Book six or more under one booking and save 10% on select departures. See page 36 or call for details.

WHALES, PRISTINE BEACHES, AND SERENITY IN BAJA

THE BEST OF BAJA IN A PERFECT TIMEFRAME—MAGDALENA BAY, aboard *National Geographic Sea Lion*, puts you at anchor among the gray whale mothers and calves. Playful, and friendly, they often approach us in our expedition landing crafts for close-up views. Watch diving pelicans and ospreys, marvel at leaping dolphins; and wander sand dunes, bike, kayak the mangroves, or go birding. For a balance of wildness and wellness, choose our *Serenity & Sea Life Escape* aboard *National Geographic Venture*. In addition to wildlife interactions, enjoy yoga on deck and a robust program of outdoor activities—Beach Boot Camp, paddleboarding, kayaking, a trail walk with naturalists, or hiking. Both *Escapes* promise delicious food daily and beach BBQs under stars.



NEW! WILD BAJA ESCAPE: THE WHALES OF MAGDALENA BAY

6 DAYS/5 NIGHTS—ABOARD NATIONAL GEOGRAPHIC SEA LION

FROM: \$3,740 (SEE PAGES 32-33 FOR DETAILS)

On this Escape, the ship literally anchors *among* the gray whale mothers and calves as we explore Magdalena Bay. You'll even venture out in expedition landing craft for up-close friendly encounters. Plus, there are sand dunes to wander, stretches of beach to bike, mangroves to kayak under, and many species of birds to spot and add to your life list.

EXPEDITION DETAILS

2020 Dates: Jan. 17, 22, 27; Feb. 1, 6, 11, 16, 21; Mar. 7, 12, 17

ITINERARY AT A GLANCE

Day 1	Loreto/San Carlos/Embark
Day 2	Bahía Almejas/Rehusa Channel/Isla Magdalena
Day 3	Transit the Hull Canal/Boca de Soledad
Days 4-5	Boca de Soledad
Day 6	Lopez Mateos/Disembark/Loreto

▶ Visit expeditions.com/magbay for a day-by-day itinerary.



SPECIAL OFFER:

- Book six or more under one booking and save 10%. See page 36 or call for details.

WILD BAJA ESCAPE: SERENITY & SEA LIFE IN THE SEA OF CORTEZ

5 DAYS/4 NIGHTS—ABOARD NATIONAL GEOGRAPHIC VENTURE

FROM: \$2,780 (SEE PAGES 30-31 FOR DETAILS)

Wake each morning to gentle yoga on deck or a Boot Camp workout. Enjoy trail walks with naturalists and hike to exhilarating panoramas of the Sea of Cortez. Paddle sea-carved caves and inlets. Snorkel with sea lions. Hang out with your certified photo instructor for tips on taking your best photos ever. And discover a menu of treatments and massages.

EXPEDITION DETAILS

2019 Dates: Dec. 23, 29

2020 Dates: Jan. 2, 6

ITINERARY AT A GLANCE

Day 1	San José Del Cabo/La Paz/Embark
Days 2-3	San José Channel/Isla San José/Isla San Francisco
Day 4	Isla Partida/Los Islotes
Day 5	La Paz/Disembark/San José Del Cabo

▶ Visit expeditions.com/basecamp for a day-by-day itinerary.



SPECIAL OFFER:

- Book six or more under one booking and save 10%. See page 36 or call for details.

THE NEW GOLD RUSH: DISCOVER THE CALIFORNIA COAST

WHEN YOU LOOK AT CALIFORNIA THROUGH AN EXPLORER'S LENS, there's so much to discover; an exciting prospect for 'left coast' lovers. Take the Channel Islands, for example. Five islands cupped within the span from Santa Barbara to L.A.'s San Pedro neighborhood, these islands are the best kept secret in the National Park system; the largest U.S. Park, with 2,000 species of plants and animals, including 145 endemics. Now the swath of ocean that has kept these remote islands protected is effortlessly traversed aboard our expedition ships. Explore acres of trails, paddle sea caves, snorkel, or photograph landscapes and bird colonies.

Think San Francisco is dazzling seen from a car or taxi coming from the airport? It's even better viewed from the deck of the *National Geographic Venture* as we embark the city's port for an exploration of the Bay Area. You will also enjoy behind-the-scenes access to Northern California's acclaimed Monterey Bay Aquarium, and be able to participate in our future-focused conservation program in the Monterey Bay area.



WILD CALIFORNIA ESCAPE: CHANNEL ISLANDS NATIONAL PARK

5 DAYS/4 NIGHTS—ABOARD *NATIONAL GEOGRAPHIC SEA BIRD*,
NATIONAL GEOGRAPHIC SEA LION, *NATIONAL GEOGRAPHIC QUEST*,
AND *NATIONAL GEOGRAPHIC VENTURE*

FROM: \$2,620 (SEE PAGES 30-33 FOR DETAILS)

To reach the awe-inspiring Channel Islands National Park, you need a ship—and everything you want to truly explore them is aboard ours. Paddleboards, kayaks, and expedition landing craft, a welcoming crew, smart naturalists, a wellness specialist, even a Lindblad-National Geographic certified photo instructor. Explore natural wonders by day, then enjoy a sunset cocktail party on deck, and nights gazing at stars.

EXPEDITION DETAILS

2019 Dates: Sep. 28; Oct. 2; Dec. 3

2020 Dates: Apr. 11, 15; Sep. 26; Oct. 11, 16; Nov. 17, 21

ITINERARY AT A GLANCE

Day 1	Los Angeles/Embark
Day 2	Anacapa and Santa Cruz Islands, Channel Islands National Park
Day 3	Santa Rosa Island, Channel Islands National Park
Day 4	Catalina Island
Day 5	Los Angeles/Disembark

▶ Visit [expeditions.com/channel](https://www.expeditions.com/channel) for a day-by-day itinerary.

NEW! WILD CALIFORNIA ESCAPE: SAN FRANCISCO TO MONTEREY BAY

6 DAYS/5 NIGHTS—ABOARD *NATIONAL GEOGRAPHIC VENTURE*

FROM: \$3,770 (SEE PAGES 30-31 FOR DETAILS)

Enjoy the wildness, culture, and serenity of these spectacular bays. Visit historic Angel Island. Tour California wine country and enjoy lunch and an interactive cooking demonstration at the famed Culinary Institute of America's campus in St. Helena. Get a private behind-the-scenes visit to the Monterey Bay Aquarium. Take in the stunning vistas on hikes, kayaking excursions, or with a cocktail on the deck of our ship.

EXPEDITION DETAILS

2019 Dates: Nov. 21, 26*

*This departure travels in the reverse order, making all the same stops. Exact order of stops may vary to maximize your experience.

ITINERARY AT A GLANCE

Day 1	San Francisco/Embark
Day 2	Angel Island
Day 3	Monterey Bay & Point Lobos State Natural Reserve
Day 4	Monterey Bay Conservation Program
Day 5	Vallejo, California Wine Country
Day 6	San Francisco/Disembark

▶ Visit [expeditions.com/SF_escape](https://www.expeditions.com/SF_escape) for a day-by-day itinerary.



SPECIAL OFFER:

- Book six or more under one booking and save 10%. See page 36 or call for details.



SPECIAL OFFERS:

- Book by Jul. 31, 2019 and receive a **\$350 AIR CREDIT** per person on all departures.
- Book six or more under one booking and save 10%. See page 36 or call for details.

THE BLUE LAGOON & BEYOND IN ICELAND

TRAVELERS WHO DELVE DEEP INTO ICELAND, TYPICALLY FIND MUCH more than they knew or expected. To start with, it's stunningly beautiful: giant waterfalls, colorful mud pots, brilliant green hillsides, blue lagoons, massive glaciers, and stark, imposing mountains. Traveling by ship opens up so many possibilities to encounter these natural wonders. We'll help you explore Iceland's pristine fjords and fascinating tundra, accompanied by a dedicated team of naturalists. Encounter evidence of volcanic activity as you hike over cooled lava fields and view Iceland's newest isle, Surtsey. Discover the rich biodiversity of the remote Westfjords, spotting nesting puffins and gannets on the Látrabjarg cliffs and watching for humpback and minke whales in the surrounding waters. We'll even take you ashore in small villages that were isolated and only accessible by boat until the late 20th century.

Want more? Combine your voyage with one of five optional trip extensions for a truly personal Iceland odyssey!





DISCOVER WHY ICELAND IS KNOWN AS THE “LAND OF FIRE AND ICE”

on a voyage to the remote fjords and volcanic isles along the country’s western coast. Explore stark volcanic landscapes. Set out by Zodiac to view towering cliffs teeming with nesting seabirds. Feel the legacy of Viking explorers as you visit historic villages, where arriving by ship feels uniquely right. Then add on to your voyage with your choice of land-based extensions—for a truly one-of-a-kind Iceland experience.

ITINERARY: WILD ICELAND ESCAPE

**6 DAYS/5 NIGHTS—ABOARD NATIONAL GEOGRAPHIC EXPLORER
FROM: \$5,030**

(SEE PAGES 34-35 FOR DETAILS)

EXPEDITION DETAILS

DATES: 2020 Jun. 29; Jul. 12

ITINERARY AT A GLANCE

Days 1 & 2	U.S./Reykjavík, Iceland/Embark
Day 3	Djúpavík
Day 4	Arnafjörður and Látrabjarg Cliffs
Day 5	Islands of Surtsey & Heimaey, Westman Islands
Day 6	Reykjavík/Disembark/U.S.

- ▶ Visit [expeditions.com/iceescape](https://www.expeditions.com/iceescape) for a day-by-day itinerary. Or call to speak with an Expedition Specialist.

SPECIAL OFFER:

- Your bar tab and crew tips are on us. You’re welcome!
- Book six or more under one booking and save 10%. See page 36 or call for details.

DO MORE—ADD AN ADVENTURE

1. REYKJAVÍK’S GOLDEN CIRCLE & BLUE LAGOON

PRE-VOYAGE | 1 DAY/1 NIGHT

2020: From \$1,290*

Enjoy the surreal Blue Lagoon, and have a guided in-depth experience along the famed Golden Circle with its boiling pools, geysers and waterfalls.

2. ICELAND’S HIGHLANDS AND LOWLANDS: AN ACTIVE ADVENTURE

POST-VOYAGE | 4 DAYS/3 NIGHTS

2020: From \$3,990*

Discover Iceland’s southern coast highlands and lowlands via super jeep and on foot. Hike through Landmannalaugar’s dramatic lava fields. Glide past blue icebergs in the Jökulsárlón Glacier Lagoon. Explore Svínafellsjökull Glacier on foot, and encounter incredible views and stunning regional geology.

3. SNAEFELLSNES: FIRE & ICE

POST-VOYAGE | 3 DAYS/2 NIGHTS

2020: From \$2,900*

Enter Langjökull Glacier’s aquamarine Ice Cave and venture inside Víðgelmir lava tube cave. Drive and walk parts of the coastline of the stunning Snaefellsnes National Park to see black pebble beaches, basalt sea stack columns, and perhaps a glimpse of the imposing Snaefellsjökull Mountain.

4. ICELAND’S VOLCANIC NORTHEAST

POST-VOYAGE | 3 DAYS/2 NIGHTS

2020: From \$2,970*

Explore the volcanic Lake Mývatn region. Walk through Dimmuborgir lava field of stacks and caves, hike the black sand of Hverfjall Crater, hear the thundering roar of Dettifoss Waterfall, Iceland’s largest. Venture into Asbyrgi canyon. Relax in two different geothermal spas.

5. ICELAND HELI-HIKING

POST-VOYAGE | 3 DAYS/2 NIGHTS

2020: From \$7,990*

Take a scenic helicopter tour to two different glaciers where you’ll have the rare opportunity to go on a glacier hike. Plus, explore the world’s only man-made ice cave and go deep underground to see the brilliant-blue ice that’s been forming over centuries.

*All pricing is per person, double occupancy. Airfare is not included on all extensions.

DISCOVER CENTRAL AMERICA

SINCE THE DAYS OF THE ANCIENT MAYA, WHO FLOURISHED ALONG this coast some 1,500 years ago, civilization has had relatively little impact. Much of Belize remains genuine wilderness, with large expanses of dense tropical forest, miles of wild rivers, abundant bird life—and the largest, healthiest coral reef systems in North America. Few cruise lines venture into the areas we visit; *National Geographic Quest* is your only access, and the perfect platform for exploring. Using our fleet of Zodiacs, kayaks, and paddleboards, you'll explore crystalline waters, and land on isolated cays, some inhabited by seabird colonies, others mere patches of sugar-white sand with a scatter of palm trees.

Guanacaste's scenery is remarkably varied, ranging from towering active volcanos, to intricate mangrove and coral systems and pristine beaches, Try canyoning for the first time, or horseback riding through the jungle, kayaking, and paddleboarding. Take a hike to spot kinkajous, howler monkeys, and sloths—and maybe even the tracks of a puma or jaguar. Strap on a snorkel to spot rays, turtles, and a colorful array of tropical fish. And take home indelible memories of a sojourn in a dry tropical forest.

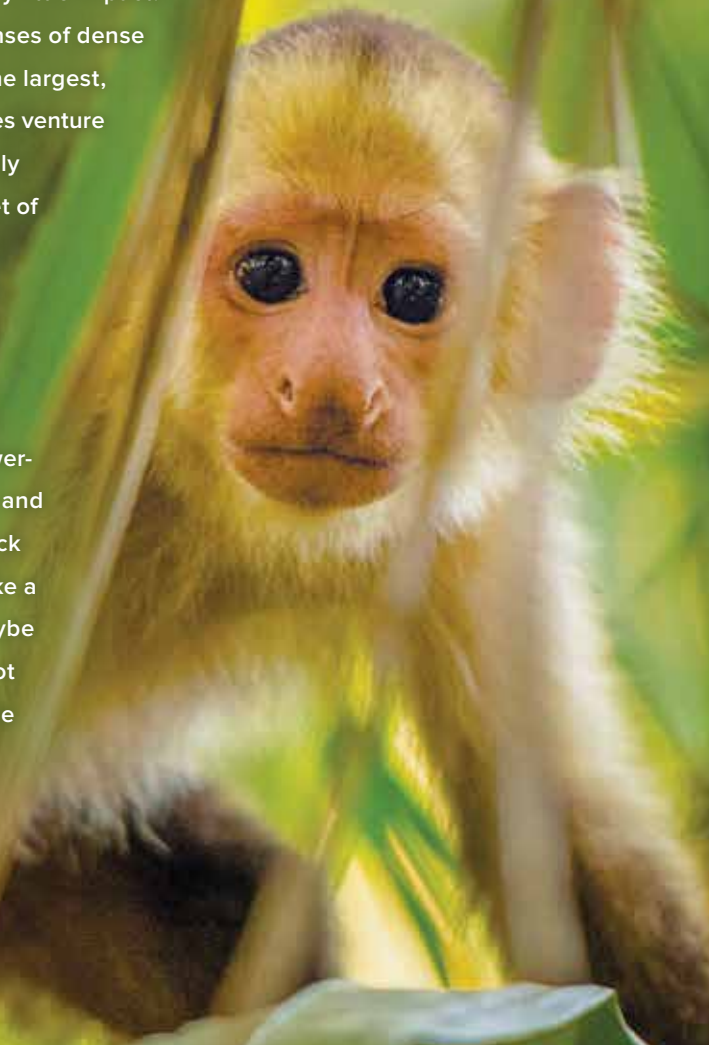

WILD BELIZE ESCAPE: WILDLIFE, REEFS & RIVERS

6 DAYS/5 NIGHTS—ABOARD *NATIONAL GEOGRAPHIC QUEST*

FROM: \$3,970 (SEE PAGES 30-31 FOR DETAILS)

Discover the tropical wonders of Belize on a voyage along the country's remote southern coast. Snorkel the colorful corals of the Belize Barrier Reef, explore the lush jungles on foot, and cruise coastal rivers in Zodiacs. Choose to explore further on our extension, and you will learn about the extensive Maya ruins of the Petén region, once the hub of classic Maya civilization.

EXPEDITION DETAILS

2020 Dates: Feb. 13, 18, 23, 28

ITINERARY AT A GLANCE

Day 1	Guatemala City, Guatemala/Puerto Barrios/Embark
Day 2	Northern Belize Barrier Reef
Day 3	Sittee or Manatee River/Central Belize Reef Exploration
Day 4	Cockscomb Basin Wildlife Reserve
Day 5	Southern Belize Barrier Reef Exploration
Day 6	Puerto Santo Tomás, Guatemala/Disembark

▶ Visit expeditions.com/belize_escape for a day-by-day itinerary.

NEW! WILD COSTA RICA ESCAPE: GUANACASTE'S CORAL REEFS & VOLCANIC PEAKS

6 DAYS/5 NIGHTS—ABOARD *NATIONAL GEOGRAPHIC SEA LION*

FROM: \$3,740 (SEE PAGES 32-33 FOR DETAILS)

The Guanacaste region of Costa Rica hosts one of Central America's largest dry tropical forests—a rare ecosystem more arid than a rain forest but still teeming with flora and fauna. From towering active volcanos, to intricate mangrove and coral systems, to pristine beaches, the scenery is remarkably varied. You might spot kinkajous, howler monkeys, and sloths—maybe even the tracks of a puma or jaguar—or see rays and turtles while snorkeling.

EXPEDITION DETAILS

2019 Dates: Nov. 30; Dec. 5, 10, 15, 23, 28

2020 Dates: Jan. 2

ITINERARY AT A GLANCE

Day 1	San José, Costa Rica/Embark
Day 2	Bat Islands/Santa Rosa National Park
Day 3	National Park Rincón de la Vieja
Day 4	Zapotal Beach/Tamarindo
Day 5	Curu National Wildlife Refuge and Isla Tortuga
Day 6	San José/Disembark

▶ Visit expeditions.com/guanacaste for a day-by-day itinerary.



SPECIAL OFFER:

- Book six or more under one booking and save 10%. See page 36 or call for details.



SPECIAL OFFER:

- Book six or more under one booking and save 10%. See page 36 or call for details.

EVERYWHERE YOU GO, SAVOR
THE FLAVORS OF THE REGION





NO MATTER THE DESTINATION, LOCAL CUISINE—fresh, sustainably-produced and expertly prepared—will be a highlight of your experience. Not only will you enjoy delightful new tastes, the food will act as a revealing window on the culture you're visiting.

In the Galápagos Islands, dine on Andean super foods and find exotic, invigorating fresh

juices on the breakfast buffet. In Iceland, try fresh dayboat fish, seasonal produce, berries from coastal farms, and local craft beers. Or in Alaska, indulge in fresh-off-the-boat Dungeness crab for our spectacular crabfest, and salmon sticks to delight kids. With a well-nourished body and mind, you'll be ready for your next discovery.



NATIONAL GEOGRAPHIC ISLANDER

YACHT-SCALED AND TRIM, OFFERING EXPEDITION AMENITIES FOR JUST 48 GUESTS

CAPACITY: 48 guests in 24 outside cabins.

REGISTRY: Ecuador. **OVERALL LENGTH:** 164 feet.

PUBLIC AREAS: Open-air observation deck, second covered outside deck with hammocks, tables and chairs. Lounge and bar accommodating all guests for presentations and gatherings, dining room, library, Mac kiosks and Internet. The captain and officers welcome guests to visit the open bridge.

MEALS: Served in a single, unassigned seating in a sociable, informal atmosphere with Ecuadorian flair.

CABINS: All have a window with an outside view, private facilities, ample storage and climate controls. Bed can be configured as two twins or as a single queen.

EXPEDITION EQUIPMENT: Zodiacs, a fleet of kayaks and paddleboards, snorkel gear and wetsuits for both adults and children, video microscope and underwater video camera.

SPECIAL FEATURES: Shipboard doctor, Lindblad-National Geographic certified photo instructor, video chronicler, snorkel instruction, Wi-Fi access, laundry service, National Geographic Global Explorers family program, Global Gallery.

WELLNESS: LEXSpa and fitness center, exercise classes, and wellness specialist.

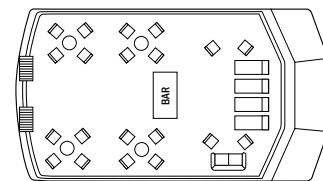

SUN DECK

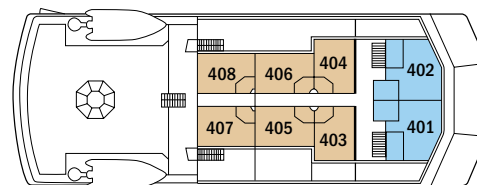

UPPER DECK

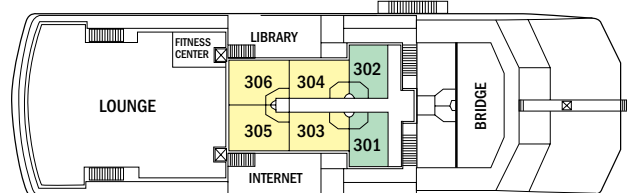

BRIDGE DECK

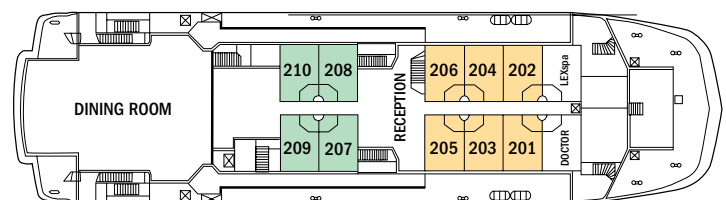

MAIN DECK



Above photos, from left: relax in a hammock on *National Geographic Islander's* covered deck; the ship anchored close to shore; enjoy fine dining aboard; have a quiet moment in the ship's library; a category 4 cabin and a category 5 cabin offer spacious accommodation.

CATEGORY 1: Main Deck, Forward #201-206

CATEGORY 2: Main Deck #207-210, Bridge Deck #301, 302

CATEGORY 3: Bridge Deck #303-306. Cabins 305 and 306 can accommodate a third person with sofa bed.

CATEGORY 4: Upper Deck #403-408—with outside, glassed-in terraces with windowed door and seating.

CATEGORY 5: Upper Deck, #401 and 402—forward facing with additional seating, desk, wrap-around windows, glassed-in terrace with seating. Largest cabins aboard.

NOTE: All cabins offer two twin beds that can be converted to a queen. Solo occupancy in categories 1 and 2 only. Third person rates for cabins 305 and 306 are one-half per person double occupancy rate.

SHARED ACCOMMODATIONS: Shares can be arranged at the double occupancy rate in Categories 1 and 2 only.

Prices are per person, double occupancy unless indicated as solo.

ITINERARY	YEAR	CAT. 1	CAT. 2	CAT. 3	CAT. 4	CAT. 5	CAT. 1 SOLO	CAT. 2 SOLO	ADVANCE PAYMENT	NOTE
Wild Galápagos Escape – Page 15	2019	\$5,730	\$6,530	\$7,220	\$7,690	\$9,350	\$8,490	\$9,720	\$750	Galápagos flights included. International tickets must be issued separately. Sample international airfares: Round-trip Miami/Guayaquil: Economy \$500.
	2020	\$5,800	\$6,610	\$7,300	\$7,710	\$9,330	\$8,620	\$9,810	\$750	
Wild Galápagos & Peru Escape – Page 15	2019	\$6,570	\$7,210	\$7,750	\$8,150	\$9,430	\$9,220	\$10,230	\$750	Galápagos flights included. International and internal Peru tickets must be issued separately. Sample international airfares: Round-trip Miami/Lima/Guayaquil Economy \$500. Sample Lima/Cusco/Lima plus Lima/Guayaquil from \$935.
	2020	\$6,660	\$7,310	\$7,860	\$8,190	\$9,490	\$9,380	\$10,330	\$750	

Prices quoted in this brochure are valid as of the time of printing, are subject to modification, and are not guaranteed until booking and required deposit is made. See our website at www.expeditions.com for the most up-to-date pricing.



NATIONAL GEOGRAPHIC QUEST & NATIONAL GEOGRAPHIC VENTURE

CAPACITY: 50 cabins accommodating 100 guests
REGISTRY: United States. **OVERALL LENGTH:** 238 feet.

Sister ships *National Geographic Quest* and *National Geographic Venture* (launched 2018) are the latest additions to our fleet. Designed with over 50 years of expedition heritage and built in the U.S.A., both ships will set a new standard in exploration and comfort.

PUBLIC AREAS: Global gallery; fitness center; LEXspa; lounge with full service bar and facilities for films and presentations; observation deck; mudroom with lockers for expedition gear, and a partially covered sundeck with chairs and tables. Our “open bridge” provides guests an opportunity to meet our officers and captain and learn about navigation.

MEALS: Served in single seatings with unassigned tables for an informal atmosphere and easy mingling. Breakfast and lunch are wide selection buffets with chef action stations, while dinners are primarily served plated. Menu emphasizes local fare.

CABINS: All cabins face outside with windows or portholes, private facilities and climate controls. Category 4 cabins have step-out balconies.

EXPEDITION EQUIPMENT: A fleet of 8 Zodiacs and 24 kayaks, Remotely Operated Vehicle (ROV), hydrophone, splash-cam, underwater video camera, video microscope, paddleboards.

SPECIAL FEATURES: Guest internet access, elevator, Lindblad-National Geographic certified photo instructor, a video chronicler and undersea specialist.

WELLNESS: The vessel is staffed by a Wellness Specialist and features a gym with an elliptical machine, treadmill, exercycles, handweights and resistance bands. Treatments in the LEXspa are available by appointment.

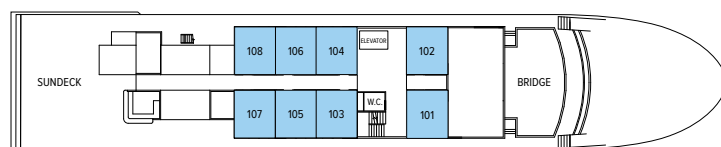

OBSERVATION DECK

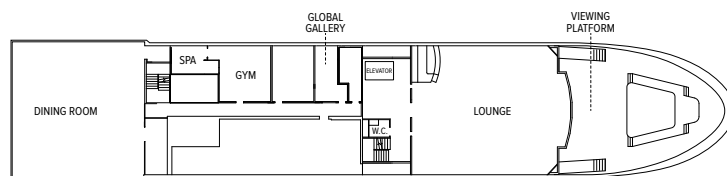

LOUNGE DECK



UPPER DECK

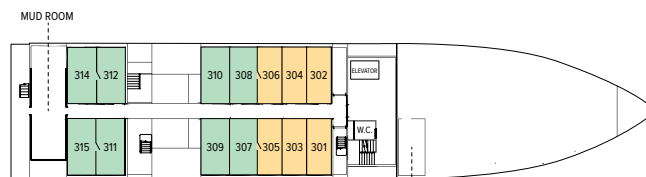

MAIN DECK



Left to right: Captain Cook raises a glass; *National Geographic Venture*; our lounge is the hub of the expedition community; viewing platform; Category 5 cabin; Category 4 cabin with lower single beds (which can be converted to a Queen) and a private step-out balcony. Select cabins connect via an inside doorway.

CATEGORY 1: Main Deck #301-306 Cabins feature two lower single beds that can convert to a Queen, a writing desk and two portholes.

CATEGORY 2: Main Deck #307-315 Cabins feature two lower single beds that can convert to a Queen, a writing desk and two portholes.

CATEGORY 3: Upper Deck #201-206 Cabins feature two lower single beds that can convert to a Queen, a writing desk and two large view windows.

CATEGORY 4: Upper Deck #207-229 Cabins feature two lower single beds that can convert to a Queen, a writing desk, sliding glass door, and small, private balcony.

CATEGORY 5 (SUITE): Observation Deck #101-108 Cabins feature two lower single beds that can convert to a Queen, large view windows, an expanded bathroom, writing desk, ample storage space, and a convertible sofa bed to accommodate a third person.

NOTE: Solo Occupancy cabins are available in Categories 1 and 2 only. Third person rates are available in Category 5 cabins at one half the double occupancy rate.

Connecting Cabins via internal doorway access: Main Deck: #312-314, #311-315, #306-308, #305-307; Upper Deck: #224-226, #225-227

Prices are per person, double occupancy unless indicated as solo.

ITINERARY	YEAR	CAT. 1	CAT. 2	CAT. 3	CAT. 4	CAT. 5 SUITE	CAT. 1 SOLO	CAT. 2 SOLO	ADVANCE PAYMENT	NOTE
Wild Baja Escape: Serenity & Sea Life in the Sea of Cortez – Page 19	2019	\$2,780	\$3,560	\$4,190	\$4,720	\$5,190	\$4,180	\$5,350	\$750	Sample Airfares: Round-trip Los Angeles/Los Cabos: Economy from \$300; Business from \$900.
	2020	\$2,780	\$3,390	\$3,990	\$4,490	\$4,950	\$3,980	\$5,090		
Wild California Escape: Channel Islands National Park – Page 21	2019	\$3,010	\$3,680	\$4,220	\$4,770	\$5,310	\$4,520	\$5,540	\$750	We will gladly assist in making your air arrangements. Please call for airfares from your departure city.
	2020	\$3,100	\$3,790	\$4,350	\$4,910	\$5,470	\$4,660	\$5,710		
Wild California Escape: San Francisco to Monterey Bay – Page 21	2019	\$3,770	\$4,600	\$5,280	\$5,960	\$6,640	\$5,650	\$6,930	\$750	We will gladly assist in making your air arrangements. Please call for airfares from your departure city.
Wild Belize Escape: Wildlife, Reefs & Rivers – Page 25	2020	\$3,970	\$4,230	\$4,510	\$4,770	\$5,520	\$5,820	\$6,220	\$750	Sample Airfares: Round-trip Miami/Guatemala City: Economy from \$550; Business from \$850.

Prices quoted in this brochure are valid as of the time of printing, are subject to modification, and are not guaranteed until booking and required deposit is made. See our website at expeditions.com for the most up-to-date pricing.



NATIONAL GEOGRAPHIC SEA BIRD & NATIONAL GEOGRAPHIC SEA LION

CAPACITY: 62 guests in 31 outside cabins.

REGISTRY: United States. **OVERALL LENGTH:** 152 feet.

PUBLIC AREAS: Our twin sister ships feature a library; global market; lounge with full-service bar and facilities for films, slide shows and presentations; observation deck; partially covered sun deck with chairs and tables, and LEXspa. Our “open bridge” provides guests an opportunity to meet our officers and captain and learn about navigation.

MEALS: Served in single seatings with unassigned tables for an informal atmosphere and easy mingling. Breakfasts are wide selection buffets and lunch is often served family style. Dinners are primarily served plated. Menu emphasizes local fare.

CABINS: All face outside with windows, private facilities and climate controls.

EXPEDITION EQUIPMENT: Bow camera, hydrophone, kayaks, fleet of paddleboards, splash-cam, underwater video camera, video microscope, and expedition landing craft.

SPECIAL FEATURES: Guest internet access. A certified photo instructor and a video chronicler are on board all voyages. An undersea specialist is on board in Alaska.

WELLNESS: The vessel is staffed by a wellness specialist and features exercise equipment, LEXspa and outdoor stretching area.

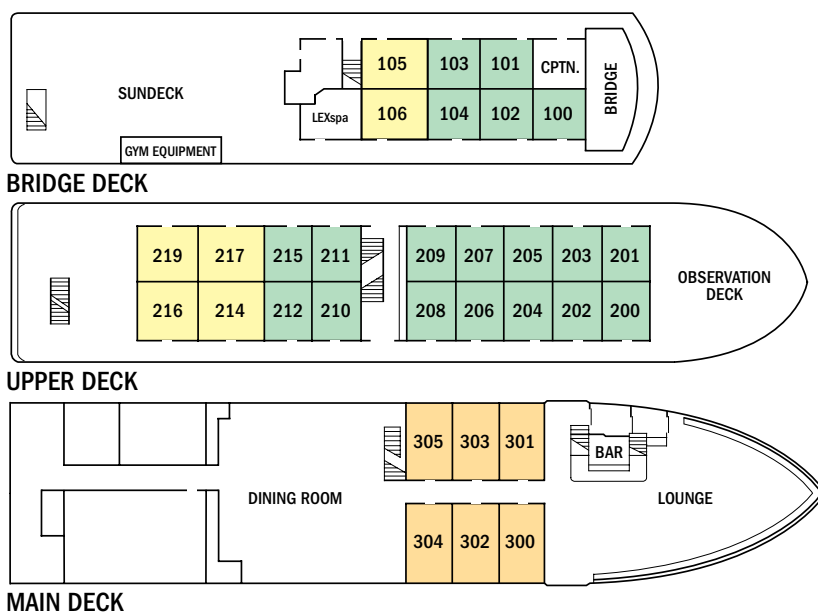



Left to right: Sightseeing from bow; *National Geographic Sea Bird*; bartender in our newly refurbished lounge; dining room where meals are served in single seating with unassigned tables for easy mingling; Category 2 cabin freshly redesigned; twin beds can be pushed together to form a double bed in Category 3 cabins on the upper decks.

CATEGORY 1: Main Deck #300-305—Conveniently positioned between the dining room and lounge, these cabins feature two single lower beds, and a large view window.

CATEGORY 2: Bridge Deck #100-104; Upper Deck #200-212, 215—These well-located cabins include two lower single beds & a view window.

CATEGORY 3: Bridge Deck #105, 106; Upper Deck #214, 216, 217, 219—These cabins feature a seating unit with table and two large view windows. Upper Deck cabins

include two lower single beds which can convert to a double bed and a pull-out single bed for a third person; Bridge Deck cabins include two lower single beds only.

Note: Solo Occupancy cabins are available in Categories 1 and 2 only. Third person rates are available in certain categories at one half the double occupancy rate.

Shared Accommodations: Shares can be arranged at the double occupancy rate in Categories 1 and 2 only.

Prices are per person, double occupancy unless indicated as solo.

ITINERARY	YEAR	CAT. 1	CAT. 2	CAT. 3	CAT. 1 SOLO	CAT. 2 SOLO	ADVANCE PAYMENT	NOTE
Wild Alaska Escape: Sitka to Juneau – Page 17	2019	\$4,390	\$4,990	\$5,990	\$6,590	\$7,490	\$750	Sample Airfares: Seattle/Juneau, Sitka/Seattle (or vice versa); Economy from \$400; Business from \$800.
	2020	\$4,420	\$5,140	\$6,170	\$6,630	\$7,710		
Wild Alaska Escape: Juneau to Ketchikan – Page 17	2020	\$4,420	\$5,140	\$6,170	\$6,630	\$7,710	\$750	Sample Airfares: Seattle/Juneau, Ketchikan/Seattle (or vice versa); Economy from \$415; Business from \$750.
Wild Baja Escape: The Whales of Magdalena Bay – Page 19	2020	\$3,740	\$4,370	\$4,930	\$5,620	\$6,550	\$750	Sample Airfares: Round-trip Los Angeles/Loreto: Economy from \$475; Business from \$1,140.
Wild California Escape: Channel Islands National Park – Page 21	2019	\$2,620	\$3,200	\$3,670	\$3,930	\$4,820	\$750	We will gladly assist in making your air arrangements. Please call for airfares from your departure city.
	2020	\$2,990	\$3,490	\$3,940	\$4,490	\$5,240		
Wild Costa Rica Escape: Guanacaste's Coral Reefs & Volcanic Peaks – Page 25	2019	\$3,740	\$4,370	\$4,930	\$5,620	\$6,550	\$750	Sample Airfares: Round-trip Miami/San José: Economy from \$400; Business from \$1,100.

Prices quoted in this brochure are valid as of the time of printing, are subject to modification, and are not guaranteed until booking and required deposit is made. See our website at expeditions.com for the most up-to-date pricing.



NATIONAL GEOGRAPHIC EXPLORER

CAPACITY: 148 guests in 81 outside cabins.
REGISTRY: Bahamas. Overall Length: 367 feet.

National Geographic Explorer is a state-of-the-art expedition ship, fully stabilized, ice-class vessel, with an ice-reinforced hull, enabling it to navigate polar passages while providing exceptional comfort. It carries kayaks and a fleet of Zodiac landing craft. An undersea specialist operates a Remotely Operated Vehicle (ROV) and sophisticated video equipment, extending access to the underwater world.

PUBLIC AREAS: Bistro bar; chart room; restaurant; global gallery; library, lounge with full service bar and state-of-the-art facilities for films, slideshows and presentations; mudroom with lockers for expedition gear, and observation lounge. Our “open bridge” provides guests an opportunity to meet our officers and captain and learn about navigation.

MEALS: Served in single seatings with unassigned tables for an informal atmosphere and easy mingling. Menu is international with local flair.

CABINS: All cabins face outside with windows or portholes, private facilities and climate controls. Some cabins have balconies. Cabins are equipped with Ethernet and Wi-Fi connections and USB ports for mobile devices.

EXPEDITION EQUIPMENT: Zodiac landing craft, kayaks, Remotely Operated Vehicle (ROV), hydrophone, splash-cam, underwater video camera, aerial remote controlled camera and video microscope.

SPECIAL FEATURES: A full-time doctor, undersea specialist, National Geographic

photographer, Lindblad-National Geographic certified photo instructor and video chronicler, internet café and laundry.

WELLNESS: The vessel is staffed by a wellness specialist and features a glass-enclosed fitness center, outdoor stretching area, a LEXspa treatment room and sauna.

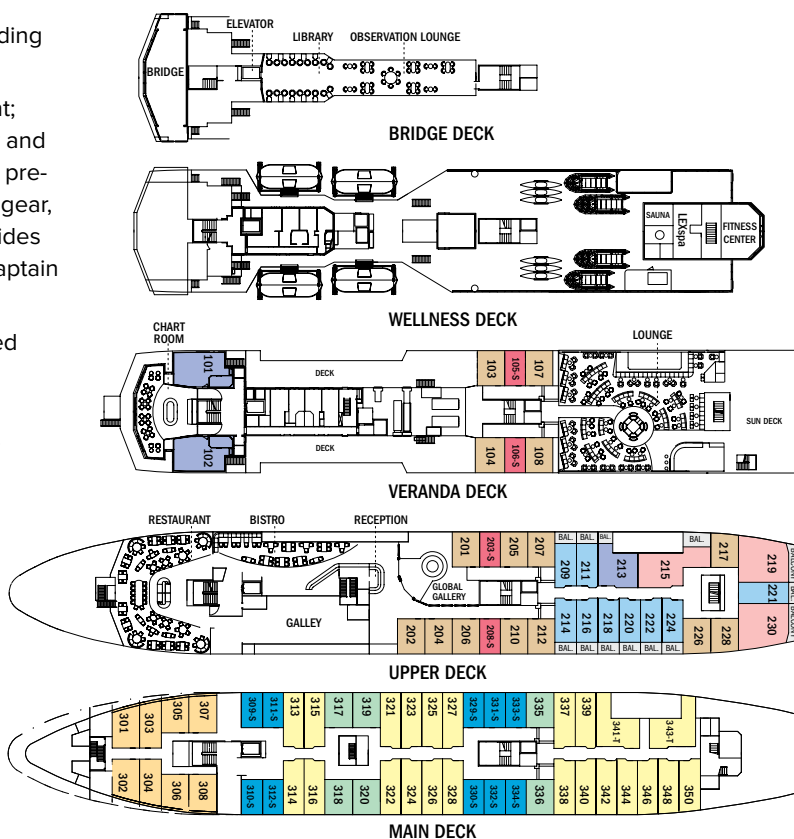



Left to right: Browse the library; dining is completely casual with no assigned seating; standard bathroom; Upper Deck cabin with balcony; Category 6 suite.

CATEGORY 1: Main Deck with one or two portholes #301-308

CATEGORY 2: Main Deck with window #317-320, 335-336

CATEGORY 3: Main Deck with window #313-316, 321-328, 337-340, 342, 344, 346, 348, 350

CATEGORY 4: Upper and Veranda Decks with window #103-104, 107-108, 201-202, 204-207, 210, 212, 217, 226, 228

CATEGORY 5: Upper Deck with balcony #209, 211, 214, 216, 218, 220-222, 224

CATEGORY 6: Veranda Deck–Suite #101-102; Upper Deck–Suite with balcony #213

CATEGORY 7: Upper Deck–Suite with balcony #215, 219, 230

CATEGORY A SOLO: Main Deck with window #309-312, 329-334

CATEGORY B SOLO: Upper and Veranda Decks with window #105-106, 203, 208

CATEGORY 3 TRIPLE: Main Deck with window #341, 343

SHARED ACCOMMODATIONS: Available in Categories 1 and 2.

SOLO OCCUPANCY: Cabins available in Categories A and B. **NOTE:** Cabins #209, 211, 214, 216-218, 220, 222, 224, 226, 228, 303-306—These cabins have one queen-sized bed. All other double cabins have two lower single beds; some can convert to a queen-sized bed. Third person rates are available in the designated triple occupancy cabins at one-half the double occupancy rate. Cabins #341, 343, 101, 102, 215, 219 and 230 can accommodate a third person.

WITH COMPLIMENTS, YOUR BAR TAB AND ALL CREW GRATUITIES ARE INCLUDED.

Prices are per person, double occupancy unless indicated otherwise.

ITINERARY	YEAR	CAT. 1	CAT. 2	CAT. 3	CAT. 4	CAT. 5	CAT. 6	CAT. 7	CAT. A SOLO	CAT. B SOLO	ADVANCE PAYMENT	NOTE
Wild Iceland Escape – Page 23	2020	\$5,030	\$5,650	\$5,880	\$6,730	\$7,320	\$8,770	\$10,170	\$7,070	\$7,350	\$750	Sample Airfares: Round-trip New York/Reykjavik: Economy from \$525; Business from \$2,300.

Prices quoted in this brochure are valid as of the time of printing, are subject to modification, and are not guaranteed until booking and required deposit is made. See our website at expeditions.com for the most up-to-date pricing.

OUR INTRODUCTORY & OTHER OFFERS

**WILD ESCAPES INTRODUCTORY OFFER:
TRAVEL WITH 6 OR MORE & SAVE 10%**

Traveling with family or sharing an adventure with friends often doubles the pleasure. So, we're doubling the incentive on select departures—save 10% when traveling as a group of 6 or more. Simply book by July 31, 2019.

On departure dates not included in this Introductory offer, save 5% when traveling as a group of 8 or more. These savings are applicable to voyage fares only, and are not valid on extensions or airfare. Deposit, final payments, and cancellation policies for group travel vary from our regular policies.

SPECIAL OFFERS—BOOK BY JUL. 31, 2019.

Offers are available on select departures, and based on availability at the time of booking. All offers are valid for new bookings only, subject to availability at the time of booking, and may not be combined with other offers and pre- and post-extensions. Call for details.

AIRFARE OFFERS: On voyages with complimentary air offers, airfare is based on economy group flights

that must be ticketed by Lindblad Expeditions. In the case that Lindblad's group or charter flights are no longer available at time of booking, we reserve the right to issue a credit. See pages 15, 17 and 21 for applicable voyages.

BRINGING THE KIDS: We believe sharing an expedition with your kids or grandkids is a life-enhancing experience. So take \$500 off for each child under the age of 18 on any departure.

WITH COMPLIMENTS: We will cover your bar tab and tips to the ship's crew on all departures aboard *National Geographic Explorer*.

BACK-TO-BACK SAVINGS: Save 10% on any consecutive journeys taken on board our expedition ships. This savings is applicable on voyage fares only, and are not valid on extensions or airfare.

COMBINING OFFERS: Certain offers may be combinable, up to two savings opportunities except where noted otherwise. For example, travel with a group of eight or more on back-to-back expeditions, and take advantage of both savings!



EXTENDING YOUR TRAVEL

Making the most of the travel you've invested to get to a region is smart—and many of our *Wild Escapes* offer extensions, enabling you to see, do and learn more while you're already there. To learn about any Extensions on the *Escape* that interests you, call an Expedition Specialist for assistance.

INCLUSIVE PRICING MEANS VALUE + EXPERIENCES

We include just about everything you have the opportunity to do as part of your expedition aboard ship and ashore. The only things not included are those of a personal nature—alcohol*, internet usage, wellness treatments, tips to the crew*, and other specialized arrangements.

ABOARD SHIP

- ✓ All meals and nonalcoholic beverages
- ✓ 24-hour coffee, tea and soda on demand
- ✓ Hors d'oeuvres and snacks during nightly Recap
- ✓ Environmentally friendly refillable water bottle
- ✓ Morning stretch classes with wellness specialist
- ✓ Sauna (*National Geographic Explorer* only)
- ✓ Fitness equipment
- ✓ Fully stocked library
- ✓ The guidance and company of our expedition staff

ASHORE

- ✓ Meals on land, as indicated in itinerary
- ✓ Special access permits, park fees, port taxes
- ✓ Transfers to and from group flights
- ✓ The expertise of our expedition staff

ACTIVITIES

- ✓ Expedition landing craft explorations
- ✓ Kayaking
- ✓ Stand-up paddleboarding
- ✓ Lectures & presentations in the lounge

*All departures aboard *Explorer* include alcoholic beverages aboard ship and also include tips to the ship's crew. All departures aboard *Islander* include alcoholic beverage, and free Wi-Fi, up to one hour a day per person.

Photo Credits: Alamy, Jose R. Calvo Samayoa, Marc Cappelletti, Rab Cummings, Stewart Cohen, Alberto Montaudon Ferrer, Justin Hofman, Ralph Lee Hopkins, John Hyde, Dagný Ivarsdóttir, iStockphoto, Jonathan Kingston, Sven-Olof Lindblad, Jeff Litton, Michael Luppino, Jeff Mauritzen, Michael Melford, Michael S. Nolan, R. Aaron Raymond, Rich Reid, Marco Ricca, Carlos Romero, Krista Rossow, Max Seigal, David M. Schrader, David Spiegel, Shutterstock, David Vargas.

RESERVATION INFORMATION

Terms & Conditions: For complete terms and conditions please visit www.expeditions.com/terms

Costs Include: All accommodations aboard ship or in hotels per itinerary or similar, all meals and nonalcoholic beverages aboard ship, meals on land as indicated, air transportation where indicated as included, all shore excursions except flightseeing (except where noted), sightseeing and entrance fees, special access permits, transfers to and from group flights, use of kayaks (where available), tips (except to ship's crew), taxes and service charges, services of a ship physician on international expeditions, and services of our expedition staff.

Not Included: Air transportation (except where shown as included), extensions, passport, visa, immigration fees, meals not indicated, travel protection plan, items of a personal nature such as alcoholic beverages, internet access, voyage DVD, flightseeing, laundry. Gratuities to ship's crew are at your discretion.

Airfare: For all programs, airfare is an additional cost unless otherwise indicated. Sample airfares are subject to change. We will gladly assist in making your air arrangements for a \$50 per person service fee.

Reservations: To reserve your place, an advance payment is required at the time of reservation. A per-person deposit begins at \$750 and is dependent upon itinerary.

Final Payment: For expeditions aboard all ships with the exception of *Explorer*, payment is due 90 days prior to departure. For expeditions aboard *Explorer* payment is due 120 days prior to departure. Payment schedules may vary for certain longer voyages, due to high demand for these voyages. We reserve the right to cancel your reservation if payment has not been received by final payment due date.

Travel Protection Plan: We strongly recommend that you take advantage of our Travel Protection Plan. This plan offers comprehensive coverage to protect you from cancellation fees, costs incurred due to trip delays/interruption, medical assistance, and damaged or lost baggage, and provides medical assistance and evacuation during your travels. Our Travel Protection Plan is available for U.S. and Canadian residents only, and may be purchased any time prior to final payment due date. If you are not satisfied for any reason, you may return your plan within 10 days after purchase. Your premium will be refunded if canceled within 10 days, provided you have not already departed on the trip or filed a claim. When so returned, the coverage under the plan is void from the original date of purchase.

Responsibility and Other Terms & Conditions: Certain provisions concerning, among other things, limitations of Lindblad Expeditions' and the National Geographic Society's liability for loss of property, injury, illness or death during the voyage will be provided to all guests on the ship's ticket sent prior to departure, and are also available on our website at www.expeditions.com/terms, or upon request. By registering for a trip, the guest agrees to all such terms and conditions.

Note: Itineraries and prices listed in this brochure are as of publication date and are subject to change. Under normal conditions the total expedition price is guaranteed at the time of booking. However, our expedition pricing is determined far in advance of initial departure on the basis of then-existing projections of fuel and other costs. In the event of increases in those costs, including but not limited to increases in the price of fuel, currency fluctuations, increases in government taxes or levies, or increased security costs, we reserve the right to adjust the price of your expedition or add a surcharge to cover such unexpected increases. We will always provide an explanation of the reason for increase in costs.

Cancellation Policy: Cancellation penalties may apply after payment is received. Please visit www.expeditions.com/terms for complete cancellation policies.

Unused services or items included in our programs are non-refundable.

©2019 Lindblad Expeditions

Lindblad Expeditions and the Eye are the trademarks of Lindblad Expeditions. All rights reserved.

NATIONAL GEOGRAPHIC and the Yellow Border are the trademarks of the National Geographic Society.

All rights reserved.

For Reservations: Contact your travel advisor or Lindblad Expeditions

1.800.EXPEDITION (1.800.397.3348)

Reservation Hours: Monday – Friday 9am – 9pm ET

Saturday & Sunday 10am – 5pm ET

Lindblad Expeditions, Inc., 96 Morton Street, New York, NY 10014

Phone: 212.261.9000 • Fax: 212.265.3770

For additional information and online reservations, visit us on the Web: www.expeditions.com

Account Number:

1.800.EXPEDITION | WWW.EXPEDITIONS.COM

♻️ Printed on 10% recycled content paper with soy-based inks. We recommend that you pass this along for others to enjoy or recycle.

SES-059

GET THE GROUP ONBOARD—SAVE 10%

Family annual, friends & neighbors, mothers & daughters and more—double the pleasure of traveling with double our group savings.

Take 10% off the total price. (See page 36 for details)

