

COSTA RICA + PANAMA

EXPLORE THE
RAINFOREST &
MEET THE PEOPLE



A BUCKET LIST-
WORTHY PANAMA
CANAL TRANSIT
& MORE



EXCLUSIVE
OFFER & SAVINGS

ABOARD NATIONAL GEOGRAPHIC QUEST 2017- 2018



Lindblad
Expeditions





Lindblad
Expeditions



NATIONAL
GEOGRAPHIC

Lindblad Expeditions and National Geographic have joined forces to further inspire the world through expedition travel. Our collaboration in exploration, research, technology and conservation will provide extraordinary travel experiences and disseminate geographic knowledge around the globe.

DEAR EXPLORER,

Ever consider a Costa Rica safari? Sounds surprising, doesn't it. Well, if you join us to explore Costa Rica & Panama as we do, by ship, it feels very much like being on safari.

I know this because I spent my formative years in Africa, working with a safari operator, creating extraordinary immersive experiences for travelers. Then, when I went to work for my father, Lars-Eric Lindblad (who pioneered ship-based expedition travel to Antarctica in 1966, and to Galapagos in 1967) I realized that ships are exactly like bush camps, only better—they move, allowing you cover great expanses of interesting, diverse geography in complete comfort. Plus, you experience the sea, stars and sightings that make being aboard a ship magical.



That's what we have been doing for the past 50 years. And that's what we do in Costa Rica. Our base camp, *National Geographic Quest*, the newest ship in our fleet, enables you to not only see and do more, but to have experiences you couldn't otherwise have—like transiting the Panama Canal and overnighting in Gatun Lake, and visiting Barro Colorado Nature Monument, home of the Smithsonian Tropical Research Institute.

You'll learn the history of the Panama Canal, and transit all three sets of locks.

And, you'll discover Costa Rica as an active explorer, not a tourist—a distinction that will be clear to you if you choose to join us. We've eliminated any of the now-overrun spots from our itinerary, and replaced them with more exclusive opportunities that bring you more deeply into the authentic, pura vida of Costa Rica—including meeting Costa Ricans making their living as they preserve Costa Rica's legendary natural beauty.

I hope you'll decide join us this December, so you can benefit from some very special savings. Costa Rica, and expedition ship travel, offers the kind of tonic the human soul needs.

All the best,

A handwritten signature in blue ink, appearing to read 'Sven-Olof Lindblad'. The signature is fluid and cursive, with the first letters of the first and last names being capitalized and prominent.

Sven-Olof Lindblad

SPECIAL OFFER: FREE AIR OR A FREE EXTENSION

- **Free Air** Round-trip between Miami and Costa Rica/Panama City, **OR**
- **Free overnight & sightseeing in booming Panama City**, including a private dinner at the Miraflores Locks, city tour, visit to Frank Gehry-designed BioMuseum, and more.



Main image: Guest dwarfed by an enormous ajo tree. Inset: Snorkeling, Panama.

GET EVERYTHING COSTA RICA OFFERS AND A WHOLE LOT MORE



National Geographic Quest is your front row seat on the legendary diversity of Costa Rica as you actively explore on land and sea. Transit the Panama Canal, see its engineering wonders, learn its history & explore the idyllic islands as well. No terra firma stay can deliver all this expedition can—it's Costa Rica plus-plus-plus! See what's ahead.



THE RENOWNED BEAUTY OF COSTA RICA

The Osa Peninsula is the crown jewel of Costa Rica. Explore its coastline by ship and on shore. Search for monkeys, frogs, sloths and brightly colored birds; go horseback riding on a pristine beach, hike, and more.

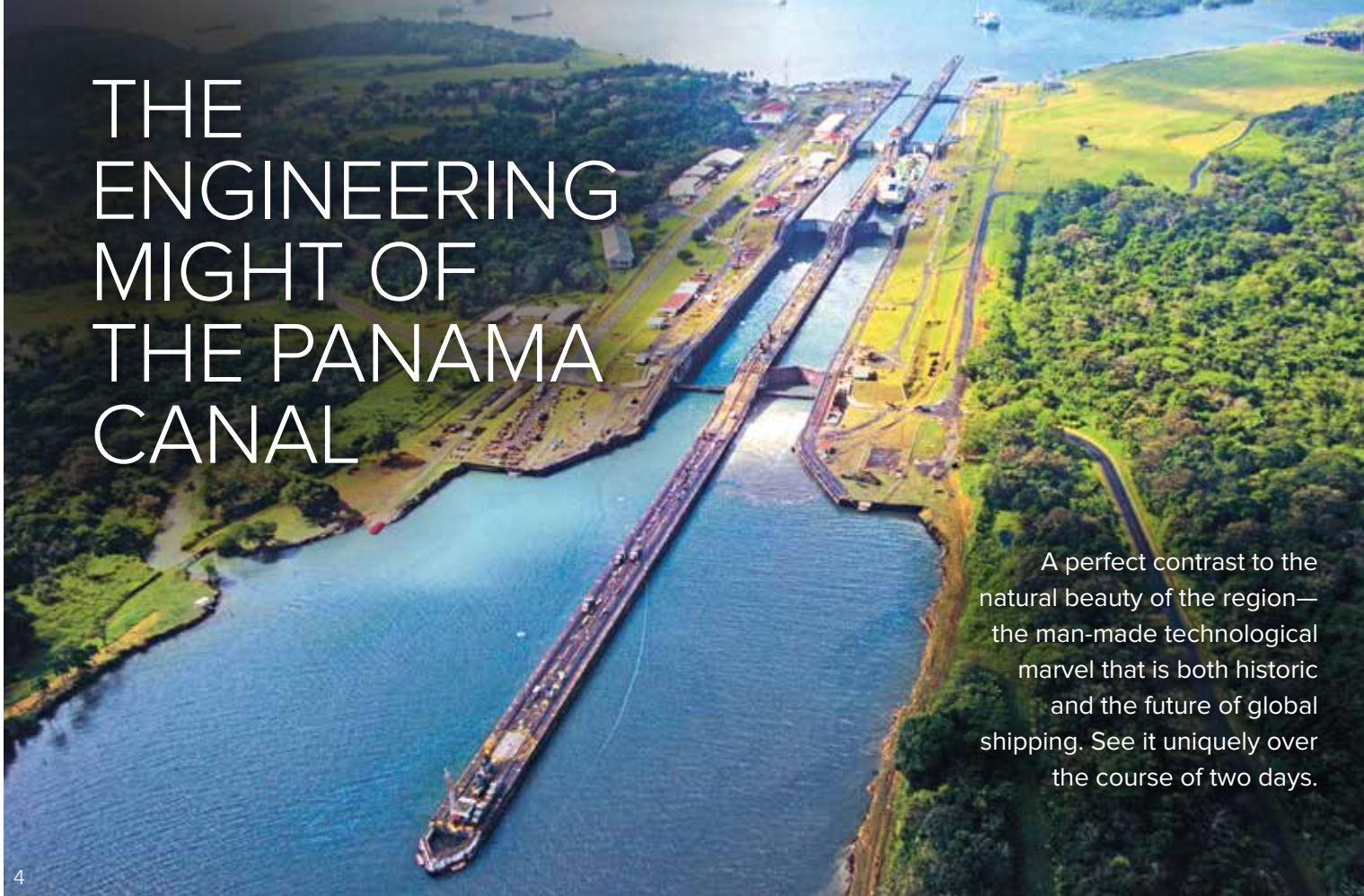

THE ENGINEERING MIGHT OF THE PANAMA CANAL

A perfect contrast to the natural beauty of the region—the man-made technological marvel that is both historic and the future of global shipping. See it uniquely over the course of two days.

THE WARMTH OF COSTA RICAN PEOPLE

See what happens when local rural people in Corcovado take responsibility for preserving Costa Rica's natural beauty. Meet and share with local entrepreneurs, families and explore untrammelled rainforest.



THE TROPICAL LUSHNESS OF PANAMA

Few travelers who want to see Costa Rica consider Panama—and the surprise and delight Coiba National Park, a UNESCO World Heritage site, creates in our guests, gratifies our expedition team every season.

STATE OF THE ART: NATIONAL GEOGRAPHIC QUEST



Our small ships have been exploring Costa Rica and Panama for more than three decades, and we've learned what matters to our travelers. We designed the 100-guest *National Geographic Quest*—and its twin ship the *National Geographic Venture*, debuting in June 2018—to bring our travelers the best possible expedition cruising experience. Along with top amenities and comfort on the inside, and bow and deck spaces designed for easy access to the world outdoors, we've added a variety of enhancements that make this one of the top exploration vessels out there.

✓ TOOLS FOR EXPLORATION

Quest carries a new fleet of customized expedition landing craft, kayaks and paddleboards, a hydrophone and ROV (remotely operated vehicle), a splash-cam, an underwater video camera, and snorkel gear.

✓ FRONT ROW SEATS ON WILDNESS

The ship's new bow design adds tiered observation platforms. Now, multiple rows of guests can gather on the bow and enjoy unobstructed view. Plus, stairways lead to an expansive observation deck one level up, for a more commanding perspective.

✓ AN ENHANCED BRIDGE

Outfitted with the latest in technology, the bridge design has been enhanced—with a forward standing area with clear views, and settees surrounding the room's state-of-the-art navigation equipment, so that you can linger comfortably.

✓ A CLEARER VIEW

Premium glass, straight-tinted for the clearest, most natural view possible, was used in the dining room's and the lounge's floor-to-ceiling wraparound windows. And in the cabins, too—in portholes, large windows, or sliding glass doors.

Ship rendering of the Quest.



Guests hiking in Corcovado National Park; Stand-up paddle boarding; Kayaks allow for water-level explorations; Zodiac cruise, Colba National Park; Snorkeling the abundant waters of Colba National Park.

COSTA RICA: NATURE + AUTHENTIC CULTURE

The Osa Peninsula, largely inaccessible and seldom visited, is the focus of our expedition. It contains four percent of the world's biodiversity and Corcovado National Park—one of the largest protected areas left on the entire Pacific Coast of Central America. Experts consider it one of the world's top parks—for its size, isolation, high diversity of species (including endemics), wealth of ecosystems, and the pristine condition it has maintained. The rural entrepreneurs of Caminos de Osa, a community-based tourism destination,



practice sustainable development. We've arranged for you to meet them and see what they're accomplishing. Visit a local palm farm to learn the process from planting to putting it on the plate. Then, take a short cooking class, and make a tasty local dish. Or, visit a private reserve where a small path opens the door to virgin rainforest—with giant trees, thousands of plant species, birds, insects, mammals, and other forest creatures. Or, visit an artisanal gold mine, accompanied by Juan Cubillo, a former gold digger



turned conservationist—pan for gold, and learn the techniques used to obtain clean 24 carat gold. These and other opportunities will immerse you in the essence of Costa Rica’s national character, and it’s famed “Pura Vida.”

Across Golfo Dulce, you’ll enjoy another unique experience—a site of scenic beauty and natural wonder, unmarred by any development, thanks to local opposition. Learn about the plate tectonics beneath the gulf, and visit a 25+-year-old private tropical garden, created and managed by two American expats, and more.



Clockwise from left: Panning for gold; learn the techniques used to obtain clean 24 carat gold; naturalist and kids; scarlet macaw; horseback riding; Heliconia.

VISITING CAMINOS DE OSA IS A NEW FEATURE OF OUR COSTA RICA EXPEDITION

Enter the green heart of the Osa Peninsula and meet local people who will introduce you to Costa Rica’s authentic culture





PANAMA: A TROPICAL LAND & SEA SANCTUARY



Two hundred islands populate Coiba Island National Park, part of the Marine Life Corridor created in September 2016 by the Presidents of three nations—Costa Rica, Ecuador and Columbia—to safeguard sea turtles, sharks, and a host of other species off their coasts. Only the Great Barrier Reef and the Galapagos National Park are larger. Coiba was a prison until the end of the 20th century, literally suspending this 55 thousand-acre land mass in time, keeping it secluded and pristine.

You'll have opportunities for kayaking or paddle boarding, swimming, snorkeling or herding scuttling hermit crabs on white sand beaches. We'll also be able to take rainforest walks, find photos ops or bird watch—soaking up the lush tropical beauty, the bright reef fish, the ancient lava flows and much more—before we set sail for our one-of-a-kind Panama Canal transit.



SPECIAL PANAMA OFFER: FREE AIR OR A FREE EXTENSION

ENJOY FREE ROUND-TRIP AIRFARE between Miami and Costa Rica/Panama City.

OR

BE OUR GUEST For an urban mini-adventure, too. Spend the night at the Panama Marriott Hotel and take an in-depth tour of burgeoning Panama City and environs—to see the highlights and make discoveries. Explore the acclaimed Frank Gehry-designed BioMuseum, dine overlooking the Canal's Miraflores Locks, and enjoy other cultural highlights. Visit explorations.com/PanamaOffer for details

Panama city at night.



Main image: Get up close to explore diverse habitats on Zodiac forays, Panama. Inset: Snorklers.

AN EXTRAORDINARY PANAMA CANAL TRANSIT

Be sure to be out on deck, or on the Bridge, as we approach the Canal entrance, to see the distant silhouette of the very modern capital city of Panama emerge; to see skyscrapers against the sky instead of tall rainforest trees. We'll hold our position entrance as we wait for our canal pilot to board—observing the gargantuan Panamax and Neopanamax vessels holding position for their transit. We'll see the landmarks: The Amador Causeway, the Bridge of the Americas. The Centennial Bridge frames the entrance of Gaillard Cut, as we cruise through to enter the Miraflores locks. And the best is yet to come.

Only aboard *National Geographic Quest* can you wake up anchored in the middle of the Panama Canal; she is the only ship allowed to overnight, and complete the transit over the course of 2 eventful days, enabling you to see the Canal by day and night. We'll experience the thriving life in the Bay of Panama and within; on a sunrise outing to see brown and blue-footed boobies, magnificent frigatebirds; and meet the denizens of Iguana Island. And we'll enjoy an added privilege: Barro Colorado Nature Monument, home to the Smithsonian Tropical Research Institute. Whether it's a bucket list must, or simply a bonus on your Costa Rica & Panama expedition, you will remember your Canal transit forever.





Clockwise from above: Smithsonian Tropical Research Institute; Panama Canal, Guests; Green Iguana, Barro Colorado Island; Aerial view of the Centennial bridge crossing the Panama canal. Inset: Magnificent frigatebirds.





Dining room (artist's rendering).

LIFE IS GREAT ABOARD YOUR EXPEDITION SHIP

Modern and elegant with a gracious, sunlit ambiance, *National Geographic Quest* will be your base for this unforgettable adventure. A stylish setting that is also relaxed and informal, Quest's interiors are designed to serve the expedition community—and foster the esprit de corps that is a hallmark of our expeditions. Roam freely to discover all her nooks and crannies, including the Bridge where you are welcome to watch the captain and his officers navigate, and help the naturalists scan for birdlife and whales. Enjoy spirited cocktail hours, our lively daily Recap sessions and informative presentations, in the dramatic window-lined main lounge. No assigned seating in the informal indoor dining room makes for easy mingling with fellow guests, expedition staffers and special guest speakers. And on deck there are plenty of spaces to congregate to delight in the warm tropical air and brilliant rainforest views.



Cuisine on board is fresh, sustainable, and accented with regional flair.



“While our operations team and a band of shipbuilders have been readying the brand new National Geographic Quest for her inaugural season, my team and the ship’s chefs have been working with Lindblad’s sustainable sea food providers, and discovering others for fresh produce, craft beers and more local delights. We’ve developed menus with flavors that will open another window on the region’s “Pura Vida” for you. Prepare to experience Costa Rica with ALL your senses.”

—Ana Esteves, Manager Hotel Operations, Lindblad Expeditions

THE LINDBLAD EXPEDITIONS-NATIONAL GEOGRAPHIC FUND SUPPORTS MARVIVA

A regional non-profit organization with the mission to promote the conservation and responsible use of marine and coastal ecosystems, MarViva trains artisanal fishermen on responsible practices and their importance to the environment. Fishers learn about fishing gear, proper species identification, recommended sizes for different species, legal fishing grounds, and seasonal area closures.



WITH LEX-NG FUND SUPPORT, MARVIVA HAS IMPLEMENTED A TRACEABILITY PROGRAM, starting at catch-receiving centers in several communities in the Gulf of Nicoya region in Costa Rica, they track the fish product information all the way to partner points of sale.

AND MARVIVA ALSO HELPS ARTISANAL FISHER GROUPS DEVELOP THE TECHNICAL CAPACITY TO SELL THEIR CATCH to corporate buyers for a better price and under more favorable conditions. And they work with corporate buyers to spread awareness and encourage rewarding fishers who use responsible fishing techniques with economic incentives.



AT YOUR SERVICE: AN A+ EXPEDITION TEAM

Stay in a resort, hotel or Airbnb, and you're either relying on your own spotting skills and knowledge, or hiring a guide to fully experience Costa Rica's legendary flora and fauna. Travel with us and you're accompanied by an expert team of naturalists who know every aspect of this region. You'll see, do and learn more. You can gravitate to those whose interests—birds, plants, photography and more—mirror yours. Or sample and benefit from a great variety of expertise and engaging personalities. Plus, you'll enjoy perfectly sized groups on activities and personal attention; you're never lost in a crowd.

▶ LEARN MORE AT [EXPEDITIONS.COM/EXPERTBIOS](https://www.nationalgeographic.com/expeditions.com/expertbios) FOR FULL BIOS ON OUR STAFF



Some expedition team members aboard National Geographic Quest (clockwise from left) Jose Calvo, Isabella Vindas, Amanda Clare.





AN EXCLUSIVE EXPEDITION BENEFIT—PHOTOGRAPHY

Lindblad-National Geographic certified photo instructors are on every Costa Rica & Panama departure—to assist you with camera settings, composition basics and useful tips. Because each is also a naturalist, they'll teach you about the wildlife so you can learn to anticipate behaviors that make for great photos. Smart phone, point & shoot camera and DSLR users will find themselves developing their observation skills, and taking home their best photos ever.



NATIONAL GEOGRAPHIC

TRAVEL WITH NATIONAL GEOGRAPHIC PHOTOGRAPHER KIKE CALVO

Award-winning photographer, journalist, and author Kike Calvo (pronounced key-keh) specializes in culture and environment. His images have been exhibited around the world, and are represented by the National Geographic Image Collection. Kike teaches photography workshops and has been a guest lecturer at leading institutions like the School of Visual Arts and Yale University.

TWO DEPARTURES: DEC 9-16, 2017; MARCH 19-26, 2018

COSTA RICA & THE PANAMA CANAL

8 DAYS/7 NIGHTS—ABOARD NATIONAL GEOGRAPHIC QUEST
PRICES FROM: \$5,990 to \$9,890 (See pages 22-23 for complete prices.)

Immerse yourself in natural wonders along the Pacific coast of Costa Rica and Panama on a voyage aboard the *National Geographic Quest*. Venture into the forests of Osa Peninsula; search for monkeys, frogs, sloths and brightly colored birds; and take an optional horseback ride on a pristine beach. Cap off your voyage with a crossing of the legendary Panama Canal.

EXPEDITION HIGHLIGHTS

- ▶ Discover hidden pools and waterfalls deep within the rain forest of the Osa Peninsula.
- ▶ Explore the tiny islands of the Gulf of Panama and snorkel off Isla Coiba.
- ▶ Enjoy special access to the protected forests of Barro Colorado Nature Monument.
- ▶ Examine the fascinating lock system that made the Panama Canal one of the greatest engineering achievements of its era.
- ▶ **New!** Meet and share with inspiring local families living in remote communities on the Osa Peninsula.

EXPERIENCE & EXPERTISE



Every expedition sails with a veteran expedition leader and a handpicked team of six local naturalists including a Lindblad-National Geographic certified photo instructor. Each naturalist is deeply knowledgeable about Costa Rica and Panama and dedicated to sharing their passion for the region with you. Other key members of the expedition team include a wellness specialist, and a video chronicler. National Geographic experts are on select departures.

Visit our website to read staff bios for this expedition.



Keel-billed Toucan

DAY 1: U.S./SAN JOSÉ, COSTA RICA/ PUERTO CALDERA/EMBARK

Upon arrival in San José, transfer by land to Puerto Caldera and embark our ship *National Geographic Quest*. (D)

DAY 2: CORCOVADO NATIONAL PARK

Anchor off the Osa Peninsula to see some of the most pristine lowland rain forest on the Pacific coast. In the environs of Corcovado National Park, swim in waterfall pools, take an optional horseback ride on the coast, or trek through the rain forest for a chance to see four species of monkeys—howler, spider, capuchin, and squirrel. (B,L,D)



Golden-mantled howler monkeys.

DAY 3: GOLFO DULCE/OSA PENINSULA

Go ashore in the pristine waters of Playa Blanca. Head inland to meet and share with inspiring local families living in remote communities and working with cocoa, heart of palm, and sugar cane. Hike mature rain forest or kayak in peaceful waters in Golfo Dulce, the only tropical fiord in the continent. In the evening, enjoy drinks ashore and, hopefully, a beautiful sunset. (B,L,D)

DAY 4: GOLFO DULCE

Enter the mangrove-fringed Golfo Dulce along the southwestern edge of Costa Rica. Visit Casa Orquídeas, a tropical paradise of ornamental palms, bromeliads, heliconias, and orchids, closed to the general public and reached by boat only. Keep your eye out for tanagers, parrots, and toucans. Later, explore the placid bay, ideal for kayaking, stand-up paddleboarding, Zodiac rides, and swimming. (B,L,D)

DAY 5: COIBA NATIONAL PARK, PANAMA

The first stop in Panama this morning is at the remote Isla Coiba, one of the many islands of Coiba National Park, a UNESCO World Heritage site. Once a penal colony, the island has long been protected and accessible by special permit only. Among its many endemic



species are the Coiba Island agouti and the mantled howler monkey, as well as four varieties of sea turtle. Discover rich marine life while snorkeling, go kayaking or hiking, try stand-up paddleboarding, or simply relax on the beach. (B,L,D)

DAY 6: GULF OF PANAMA ISLETS/ PANAMA CANAL TRANSIT

Today, explore the tiny islets of the Gulf of Panama by Zodiac or kayak. Here we might spot frigatebirds, brown pelicans, neotropical cormorants, and brown boobies. Set sail for the Panama Canal this afternoon. Stretching more than 50 miles, the canal was a colossal engineering feat completed in 1914. It is still traversed by some 14,000 ships every year. As cargo ships tend to pass through the canal during the day, we'll most likely begin our crossing at night, when the canal is dramatically lit. (B,L,D)

DAY 7: GATÚN LAKE/PANAMA CANAL TRANSIT

Board our Zodiac to visit Barro Colorado Nature Monument in Gatún Lake by special arrangement. Scientists have worked at the Smithsonian Tropical Research Institute on Barro Colorado Island since 1923, researching its 120 mammals and diverse tree species. It is also the site of a National Geographic-supported project that tracks tagged animals using automated radio signals and wireless technology. Join local guides for a walk through the forests. This evening, continue through the complex lock system of the canal. (B,L,D)

DAY 8: COLÓN/PANAMA CITY/U.S.

After breakfast, disembark in Colón and transfer to the airport in Panama City for your flight home. (B)

EXPEDITION DETAILS

DATES: 2017 Dec. 2, 9*, 16, 23*, 30
2018 Jan. 6*, 13, 20*, 27; Mar 19*

*These departures travel in reverse order, from Panama City to San Jose, making all the same spots.

SPECIAL OFFER:

Book by **Sep. 30, 2017** and receive **FREE ROUND-TRIP AIRFARE** from Miami OR a **FREE Panama City Extension** on select 2017/18 departures.

NEW ACTIVITY!

National Geographic Quest now has stand-up paddleboarding available, creating a whole new way to explore Costa Rica & Panama.



Stand-up paddleboarding.

NATIONAL GEOGRAPHIC PHOTOGRAPHER

Travel with award-winning photographer, **Kike Calvo** on the Dec. 9, 2017 and Mar. 19, 2018 departures.



Panama canal.

COSTA RICA TO PANAMA + MONTEVERDE CLOUD FOREST

11 DAYS/10 NIGHTS—ABOARD NATIONAL GEOGRAPHIC QUEST

PRICES FROM: \$7,790 to \$11,920 (See pages 62-63 for complete prices.)

DAY 1: MIAMI/SAN JOSE, COSTA RICA
Depart Miami mid-morning on a non-stop flight to San Jose, Costa Rica. Upon arrival, a short drive brings us to the Costa Rica Marriott Hotel. (D)

DAYS 2 AND 3: MONTEVERDE CLOUD FOREST

A scenic drive takes us to Monteverde Cloud Forest, an acclaimed private reserve. Bathed in cool, year-round moisture, the forest is covered with mosses and 300 species of orchids. Walk trails rich with butterflies and

bird life. Ascend the Skywalk, a series of suspension bridges, for a bird's-eye view of the rain forest canopy. Learn about life in the early Monteverde community from one of the original Quaker homesteaders. Spend each night at a charming, family-owned lodge. (B,L,D)

DAY 4: MONTEVERDE/ PUERTO CALDERA/EMBARK

Visit a butterfly farm before transferring to Puerto Caldera to embark our ship. (B,L,D)



Guests explore on the Skywalk in Monteverde.

DAYS 4-11 FOLLOW “COSTA RICA & THE PANAMA CANAL” ITINERARY ON PAGES 18-19

EXPEDITION DETAILS

DATES: 2017 Nov. 29; Dec. 13, 27
2018 Jan. 10, 24

PANAMA TO COSTA RICA + MONTEVERDE, ARENAL VOLCANO & TORTUGUERO

15 DAYS/14 NIGHTS—ABOARD NATIONAL GEOGRAPHIC QUEST

PRICES FROM: \$10,410 to \$14,810 (See pages 62-63 for complete prices.)

DAYS 1-7 FOLLOW “COSTA RICA & THE PANAMA CANAL” ITINERARY IN REVERSE (PAGES 4-5)

NOTE: DAYS 8-15 CAN BE TAKEN AS A STAND-ALONE EXPEDITION. SEE PAGE 7.

DAY 8: PUERTO CALDERA/ MONTEVERDE

Disembark and transfer to the Tarcoles River to bird watch. Later, visit the Bat Jungle exhibit or hear from an early Quaker settler. Stay at a peaceful retreat with plenty of picturesque views. (B,L,D)

DAYS 9 AND 10: MONTEVERDE/ARENAL
Enjoy a visit to a butterfly farm and a tour of the Monteverde reserve. Get a new perspective on the region as you sail across Lake Arenal. Check into your hotel and relax in thermal pools heated by Arenal Volcano. (B,L,D)

DAYS 11 AND 12: ARENAL/TORTUGUERO

Walk the Arenal Hanging Bridges, strung through two miles of dense rain forest canopy, then experience the traditional sugar-making process. A charter flight will bring us to Tortuguero, a spectacular lowland forest on Costa Rica's northeast coast. Tour the wildlife-rich canals of Tortuguero National Park in small guided boats. Later, check into a rustic lodge at the water's edge for dinner. (B,L,D)

DAYS 13 AND 14: TORTUGUERO/ SAN JOSÉ

Today, continue to explore the Tortuguero National Park canals by boat or kayak. Enjoy a visit to the Sea Turtle Conservancy to learn the area's history and go for a stroll through the carless village. Then, partake in a workshop on



Kayaking in the canals of Tortuguero National Park.

preparing chocolate at Sibú Chocolatier. The day ends with a farewell dinner. (B,L,D)

DAY 15: SAN JOSÉ/U.S.

Transfer to the San José airport for flights home. (B)

EXPEDITION DETAILS

DATES: 2017 Dec. 9, 23
2018 Jan. 6, 20; Mar. 19

EXPLORING COSTA RICA: CLOUD FOREST TO THE CARIBBEAN

9 DAYS/8 NIGHTS—LAND-ONLY EXCURSION

PRICES FROM: \$4,720 per person double occupancy and \$5,220 sole occupancy

EXPEDITION HIGHLIGHTS

- ▶ Experience the mist-shrouded cloud forest on a naturalist-led hike through Monteverde Cloud Forest Reserve.
- ▶ Walk suspension bridges in the shadow of active Arenal Volcano, and then relax in springs warmed by volcanic activity.
- ▶ Visit the remote, car-free town of Tortuguero and venture into the rain forest via green-canopied canals.

DAY 1: U.S./SAN JOSÉ

Fly to the airport in San José, Costa Rica and transfer to your hotel. Meet your naturalist guide and enjoy a welcome dinner. (D)

DAY 2: SAN JOSÉ/TÁRCOLES RIVER/MONTEVERDE

Search for American crocodiles on the Tárcoles River before venturing to the nearby Bat Jungle exhibit. We'll check into a family-owned retreat with expansive grounds and picturesque views of the cloud forest. (B,L,D)

DAY 3: MONTEVERDE

Begin the day at a butterfly farm where we'll have the opportunity to see dozens of local species. After lunch, we'll tour the Monteverde Cloud Forest Reserve and search for monkeys, hummingbirds and possibly the rare resplendent quetzal. (B,L,D)

DAY 4: MONTEVERDE/ARENAL

After breakfast, drive to Lake Arenal and cross in small boats for a fresh perspective on the volcano. We'll dine at a restaurant on the lake's far side before checking into an elegant hotel surrounded by gardens and pastures with grazing animals and views of the smoldering Arenal Volcano. (B,L,D)

DAY 5: ARENAL VOLCANO

Walk the Arenal Hanging Bridges strung more than two miles through the rain forest canopy.

Later, relax in the naturally heated thermal pools. (B,L,D)

DAY 6: ARENAL/TORTUGUERO

A charter flight will bring us to Tortuguero, a spectacular lowland forest on Costa Rica's northeast coast. Tour the wildlife-rich canals of Tortuguero National Park in small guided boats. Later, check into a rustic lodge at the water's edge for dinner. (B,L,D)

DAYS 7 AND 8: TORTUGUERO/SAN JOSÉ

Today, continue to explore the Tortuguero National Park canals by boat or kayak to spot monkeys, caiman and myriad bird species. Enjoy a visit to the Sea Turtle Conservancy to learn the area's history and go for a stroll through the carless village. Then, partake in a workshop on



preparing chocolate at Sibú Chocolatier. Both days end with a delicious dinner prepared at the lodge, including a farewell dinner. (B,L,D)

DAY 9: SAN JOSÉ/U.S.

After breakfast, transfer to the San José airport for flights home. (B)

EXPEDITION DETAILS

DATES: 2017 Dec. 1, 15, 29; 2018 Jan. 12, 26; Feb. 17, 22, 27; Mar. 4, 9, 14, 19, 25; Apr. 2, 16

EXTEND YOUR ADVENTURE

Take advantage of your proximity—add this Exploring Costa Rica: Cloud Forest to the Caribbean journey as a Post-Extension for the [Belize to Tikal](https://www.expeditions.com/BelizeToTikal) ship-based expedition visit: [expeditions.com/BelizeToTikal](https://www.expeditions.com/BelizeToTikal)



NEW SHIP



NATIONAL GEOGRAPHIC QUEST

CAPACITY: 100 Guests in 50 cabins.
REGISTRY: United States. **OVERALL LENGTH:** 238 feet.
The *National Geographic Quest* is the latest addition to our fleet. Designed with over 50 years of expedition heritage and built in the U.S.A., it will set a new standard in exploration and comfort.

PUBLIC AREAS: Global gallery; fitness center; LEXspa; lounge with full service bar and facilities for films and presentations; observation deck; mudroom with lockers for expedition gear, and a partially covered sundeck with chairs and tables. Our “open bridge” provides guests an opportunity to meet our officers and captain and learn about navigation.



MEALS: Served in single seatings with unassigned tables for an informal atmosphere and easy mingling. Breakfast is a wide selection buffet and Breakfast and lunch are wide selection buffets with chef action stations, while dinners are primarily served plated. Menu emphasizes local fare.

CABINS: All cabins face outside with windows or portholes, private facilities and climate controls. Category 4 cabins have step-out balconies.

EXPEDITION EQUIPMENT: A fleet of 8 Zodiacs and 24 kayaks, Remotely Operated Vehicle (ROV), hydrophone, splashcam, underwater video camera, video microscope, stand-up paddleboards, and snorkeling gear for all guests (where applicable).

SPECIAL FEATURES: Guest internet access, elevator, Lindblad-National Geographic certified photo instructor, a video chronicler, and undersea specialist.

WELLNESS: The vessel is staffed by a wellness specialist, and features a gym with an elliptical machine, treadmill, exercycles, handweights and resistance bands. Treatments in the LEXspa are available by appointment.



Insets clockwise from top: (Artist's renderings): The lounge, with 270° views, is the hub of the expedition community; a spacious and open sun deck will provide unparalleled views.



Left to right: (Artist's renderings) Category 5 cabin is our most spacious. Category 4 cabin with lower single beds converted to a Queen and a private balcony.

CATEGORY 1: Main Deck #301-306 Cabins feature two lower single beds that can convert to a Queen, a writing desk and two portholes.

CATEGORY 2: Main Deck #307-315 Cabins feature two lower single beds that can convert to a Queen, a writing desk and two portholes.

CATEGORY 3: Upper Deck #201-206 Cabins feature two lower single beds that can convert to a Queen, a writing desk and two large view windows.

CATEGORY 4: Upper Deck #207-229 Cabins feature two lower single beds that can convert to a Queen, a writing desk, sliding glass door, and small, private balcony.

CATEGORY 5 (SUITE): Observation Deck #101-108 Cabins feature two lower single beds that can convert to a Queen, large view windows, an expanded bathroom, writing desk, ample storage space, and a convertible sofa bed to accommodate a third person.

NOTE: Sole Occupancy cabins are available in Categories 1 and 2 only. Third person rates are available in Category 5 cabins at one half the double occupancy rate.

Connecting Cabins via internal doorway access: Main Deck: #312-314, #311-315, #306-308, #305-307; Upper Deck: #224-226, #225-227

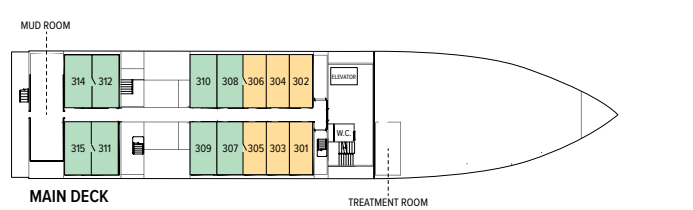
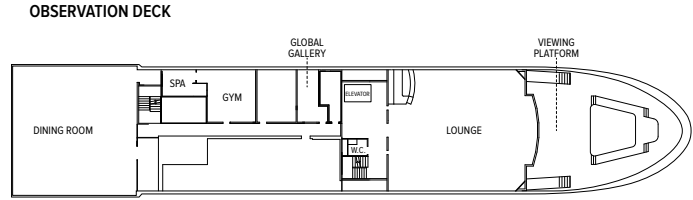
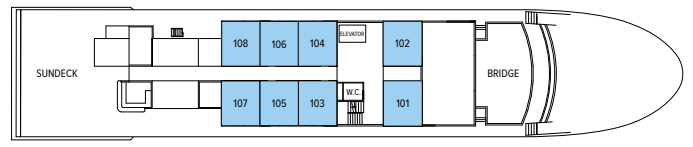

Prices are per person, double occupancy unless indicated as solo.

ITINERARY	YEAR	CAT. 1	CAT. 2	CAT. 3	CAT. 4	CAT. 5 SUITE	CAT. 1 SOLO	CAT. 2 SOLO	ADVANCE PAYMENT	NOTE
Costa Rica & the Panama Canal – Page 19	2017/18	\$5,990	\$6,590	\$6,990	\$7,790	\$8,690	\$8,990	\$9,890	\$750	Sample Airfares: Miami/Panama City, San José/Miami or vice versa: Economy from \$500; Business from \$1,200.
Monteverde + Costa Rica to Panama – Page 20	2017/18	\$7,790	\$8,390	\$8,790	\$9,590	\$10,490	\$11,020	\$11,920	\$750	Sample Airfares: Miami/San José, Panama City/Miami Economy from \$500; Business from \$1,200.
Panama to Costa Rica + Monteverde, Arenal & Tortuguero – Page 21	2017/18	\$10,410	\$11,010	\$11,410	\$12,210	\$13,110	\$13,910	\$14,810	\$1,500	Sample Airfares: Miami/Panama City, San José/Miami: Economy from \$500; Business from \$1,200.

TAKE ADVANTAGE OF OUR SPECIAL OFFERS

COMPLIMENTARY AIRFARE OR FREE EXTENSION ON SELECT COSTA RICA & PANAMA DEPARTURES:

Book by Sep. 30, 2017 and receive FREE ROUND-TRIP AIRFARE from Miami OR a FREE Panama City Extension.

On voyages with complimentary air offers, airfare is based on economy group flights that must be ticketed by Lindblad Expeditions. In the case that Lindblad's group or charter flights are no longer available at time of booking, we reserve the right to issue a credit. All offers are valid for new bookings only, subject to availability at the time of booking, and may not be combined with other offers and pre- and post-extensions. Call for details.

BRINGING THE KIDS: We believe sharing an expedition with your kids or grandkids is a life-enhancing experience. So take \$500 off for each child under the age of 18.

BACK-TO-BACK SAVINGS: Save 10% on any consecutive journeys taken on board one of our expedition ships. This savings is applicable on voyage fares only, and are not valid on extensions or airfare.

TRAVELING AS A GROUP: Save 5% when traveling as a group of 8 or more people. Take advantage of these great savings, while enjoying traveling with your friends and family. This savings is applicable to voyage fares only, and is not valid on extensions or airfare. Deposit, final payments, and cancellation policies for group travel vary from our regular policies.

COMBINING OFFERS: Certain offers may be combinable, up to two savings opportunities except where noted otherwise. For example, travel with a group of 8 or more on back-to-back expeditions, and take advantage of both savings!

INCLUSIVE PRICING

We include just about everything you have the opportunity to do as part of your expedition aboard ship and ashore. The only things not included are those of a personal nature—alcohol, internet usage, tips to the crew, wellness treatments and other specialized arrangements.

ABOARD SHIP

- ✓ All meals & non-alcoholic beverages
- ✓ Cappuccinos, lattes & complimentary refillable water bottle
- ✓ 24-hour coffee, tea & soda on demand
- ✓ Hors d'oeuvres & snacks during lounge recap
- ✓ Fitness center
- ✓ Fully stocked library
- ✓ The guidance & company of our expedition staff

ASHORE

- ✓ Meals on land, as indicated in itinerary
- ✓ Special access permits, park fees, port taxes
- ✓ Transfers to & from group flights
- ✓ The expertise of our expedition staff

ACTIVITIES

- ✓ All excursions
- ✓ Zodiac & kayak explorations
- ✓ Snorkeling & paddleboarding (where indicated)
- ✓ Lectures & presentations in the lounge



BE PART OF OUR EXPEDITION COMMUNITY

Join in! Here's how:

- ✓ Check our daily blog for interesting posts, video clips and Photos of The Week: expeditions.com/blog
- ✓ Like us on Facebook: hear what our travelers have to say, get inspired and chime in: facebook.com/LindbladExpeditions
- ✓ Preview an expedition before you go or subscribe to our videos on youtube.com/lindbladexpeditions
- ✓ Follow us @LindbladExp and our founder, Sven Lindblad @SvenLEX, on Twitter; and on Instagram @SOLindblad for his interesting view of the world.
- ✓ Check out Expedition Snapshots from guests - and upload your own on the expeditions.com homepage.



RESERVATION INFORMATION

Costs Include: All accommodations aboard ships or in hotels per itinerary or similar, all meals and non-alcoholic beverages aboard ship, meals on land as indicated, air transportation where indicated as included, shore excursions, sightseeing and entrance fees, special access permits, transfers to and from group flights, use of snorkeling equipment and wetsuits (where applicable), use of kayaks and/or stand-up paddleboards (where available), tips (except to ship's crew), taxes and service charges, services of a ship physician on most voyages, and services of our expedition staff.

Not Included: Air transportation, extensions, passport, visa, immigration fees, meals not indicated, travel protection plan, items of a personal nature, such as alcoholic beverages, internet access, voyage DVD (where available) and laundry.

Airfare: For all programs, airfare is an additional cost unless otherwise indicated. Sample airfares are subject to change. We will gladly assist in making your air arrangements for a \$50 per person service fee.

TERMS & CONDITIONS

Reservations: To reserve your place, an advance payment is required at the time of reservation. The per person advance payment amount varies by program, and is outlined in our brochures, as well as on our website. Holiday departure dates and certain longer voyages may carry additional advance deposit requirements due to high demand for these voyages. Payment is accepted by Visa, MasterCard, American Express, Discover, or by check.

Receipt of your initial payment indicates your acceptance of our complete Terms and Conditions. We require written notice at the time of reservation for any physical condition, diet, or treatment requiring special attention.

Once your reservation is confirmed, we urge you to use your personalized online account for important information to help you prepare for your voyage. Managing your documents online will facilitate fast and accurate communication, and allow you to provide us with pertinent details we require, in order to complete your reservation. Your online account gives you access to your Expedition Guide, which includes valuable information specific to your voyage. You can also use your online account to make easy payments, view recommended flights and reading material, packing list, and so much more.

Final Payment: Due 90 days prior to departure.

Travel Protection Plan: We recommend that you take advantage of our Travel Protection Plan. This plan offers comprehensive coverage to protect you from cancellation fees, costs incurred due to trip delays/interruption, damaged or lost luggage, medical assistance, and evacuation during your travels. Our Travel Protection Plan is available for U.S. and Canadian residents only, and may be purchased any time prior to final payment due date. If you are not satisfied for any reason, you may return your plan within 10 days after purchase. Your premium will be refunded if canceled within 10 days, provided you have not already departed on the trip or filed a claim. When so returned, the coverage under the plan is void from the original date of purchase.

Smoking Policy: Smoking is allowed only in designated outdoor areas.

Entry and Visa Requirements: All guests are advised to verify travel documents (passport/transit visa/entry visa) for the country through which they are transiting and/or entering. Reliable and most current information regarding international travel can be found by contacting the consulate/embassy of the country(s) you are visiting or transiting through. We will not be responsible if you are denied entry or transit into a country if you are unable to provide valid documents as per the country's requirement.

Responsibility and Other Terms & Conditions: Certain other provisions concerning, among other things, limitations of Lindblad Expeditions' and the National Geographic Society's liability for loss of property, injury, illness or death during the voyage will be provided to all

guests on the ship's ticket sent prior to departure, and are also available on our website at www.expeditions.com/terms, or upon request. By registering for a trip, the guest agrees to all such terms and conditions.

Note: Itineraries and prices listed in this brochure are valid as of publication date, and are subject to change. Under normal conditions, the total expedition cost is guaranteed at the time of booking. However, the published price is determined far in advance of initial departure on the basis of then-existing projections of fuel and other costs. In the event we determine that current costs create an unsustainable financial model, including but not limited to increases in the price of fuel, currency fluctuations, increases in government taxes or levies, or increased security costs, we reserve the right to pass on these costs to you, to cover such unexpected increases. We will always provide a transparent accounting of the reason for such an increase in costs.

CANCELLATION POLICY	
Number of Days Prior to Expedition Start	Per Person Cancellation Fee
120 or more days	\$350*
119–90 days	Advance payment cost
89–60 days	25% of total fare
59–45 days	50% of total fare
44–0 days	No refund

*\$350 will be refunded in the form of a Lindblad Expeditions Travel Certificate.

This cancellation policy applies to expeditions, extensions, as well as all other additional services. The effective date of a cancellation will be the date on which your cancellation notice is received. Any revisions you make within the cancellation penalty period, such as departure date or choice of voyage, are subject to cancellation fees.

Note: Airline cancellation policies vary by carrier, as well as the type of fare used to issue your ticket.

Cancellation policy for certain longer voyages and Holiday departures may vary due to high demand for these voyages. Our group cancellation and Denali cancellation policies are listed in the Terms and Conditions section of our website, or you may call us for details. We stress the importance of purchasing a travel protection plan to protect yourself from fees in the event you need to cancel your reservation.

United States Tour Operators Association \$1 Million Travelers Assistance Program

Lindblad Expeditions, as an Active Member of USTOA, is required to post \$1 Million with USTOA to be used to reimburse, in accordance with the terms and conditions of the USTOA \$1 Million Travelers Assistance Program, the advance payments of Lindblad Expeditions customers in the unlikely event of Lindblad Expeditions bankruptcy, insolvency or cessation of business. Further, you should understand that the \$1 Million posted by Lindblad Expeditions may be sufficient to provide only a partial recovery of the advance payments received by Lindblad Expeditions. More details of the USTOA Travelers Assistance Program may be obtained by writing to USTOA at 345 Seventh Avenue, Suite 1801, New York, New York 10001, or by email to information@ustoa.com or by visiting their website at www.USTOA.com.



We are proud to be a Founding Member of Adventure Collection—a family of the world's most trusted and experienced active travel companies. Each member company of Adventure Collection is dedicated to enriching the lives of its guests and to giving back to the areas in which it travels. For more information visit www.AdventureCollection.com.





TRAVEL PLANNING WITH A DIFFERENCE

Half of travel planning is learning what you don't know and generating questions. The other half is getting answers.

When you call **1.800.EXPEDITION**, you can ask for any one of our Expedition Specialists who have been on our expeditions. They are full members of the Lindblad Expeditions team—students of the natural world and born explorers, not trained call center telemarketers.

SO WHY NOT TAKE ADVANTAGE OF THEIR EXPERTISE? Don't hesitate to call with your questions—they're equipped to provide answers based on their knowledge and personal experience.

Ask them about how we explore, our ships, our itineraries, and more. We think you'll find the conversation rewarding.

©2017 Lindblad Expeditions. Lindblad Expeditions and the Eye are the trademarks of Lindblad Expeditions. All rights reserved.

NATIONAL GEOGRAPHIC and the Yellow Border are the trademarks of the National Geographic Society. All rights reserved.

Photo Credits: Willy Alfaro, Steffen Binke/Alamy, Kike Calvo, Alexandra C. Daley-Clark, Rob Crandall/Alamy, Peter Frauchiger/Alamy, Bill Gozansky/Alamy, Ralph Lee Hopkins, Jonathan Kingston, Sven-Olof Lindblad, Oyvind Martinsen Documentary Collection/Alamy, Jeff Mauritzen, Nancy Nehring/istock, Kelvin Rumsby/Alamy, Kevin Schafer, Jack Swenson, Roy Toft, David Vargas, Christian Ziegler/agefotostock.

For Reservations: Contact your travel advisor or Lindblad Expeditions

1.800.EXPEDITION
(1.800.397.3348)

Reservation Hours:
Monday - Friday 9am - 8pm ET,
Saturday & Sunday 10am - 5pm ET
Lindblad Expeditions, Inc.

96 Morton Street, New York, NY 10014
Phone: 212.261.9000

Email: explore@expeditions.com
For additional information and online reservations, visit us on the Web:
www.expeditions.com.



96 Morton Street
New York, NY 10014

PRSR STD
U.S. POSTAGE
PAID
LINDBLAD
EXPEDITIONS

Account Number:

Expedition Code: 2WLDFA8

1.800.EXPEDITION | WWW.EXPEDITIONS.COM

Printed on 10% recycled content paper with soy-based inks. We recommend that you pass this along for others to enjoy or recycle.

WLD-178



FREE AIRFARE OR A FREE PANAMA STAY

FREE AIRFARE between Miami and Costa Rica/Panama City
OR Complimentary night at the Panama Marriott Hotel.
Extend your stay with an in-depth tour of Panama city.

VISIT [EXPEDITIONS.COM/ PANAMAOFFER](http://EXPEDITIONS.COM/PANAMAOFFER) FOR DETAILS